

INDEX OF SHEETS
SEE SHEET 2

STATE OF VERMONT
AGENCY OF TRANSPORTATION

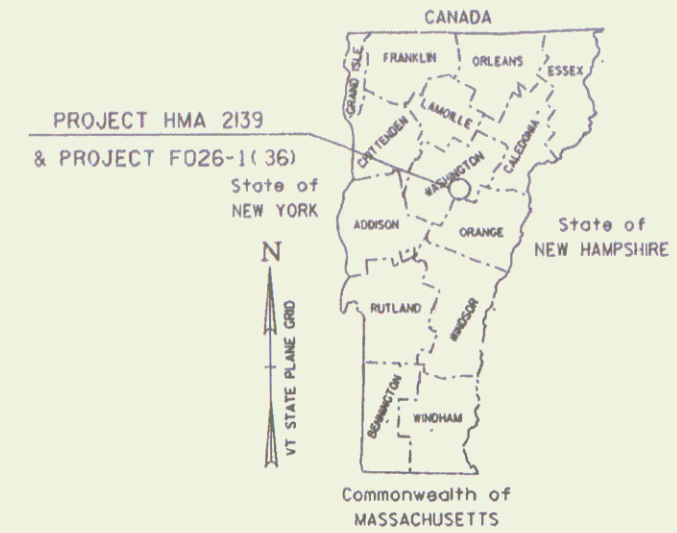

PROPOSED IMPROVEMENT
TOWN OF BARRE
COUNTY OF WASHINGTON
ROUTE US 302 (F.A.P.)
(MINOR ARTERIAL HIGHWAY)



BARRE TOWN
STP 2139(1)S
BEGINNING IN THE TOWN OF BARRE, ON U.S. 302, AT MM 1.170
AND EXTENDING EASTERLY 0.850 MILES TO MM 2.020 IN THE TOWN OF BARRE.
LENGTH OF ROADWAY: 4488 FT=0.850 MILES
LENGTH OF ROADWAY: 4488 FT=0.850 MILES
WORK ON THIS PROJECT CONSISTS OF RESURFACING U.S. 302, INCLUDING SHOULDERS AND NEW PAVEMENT MARKINGS.

BARRE TOWN
F026-(136)
BEGINNING IN THE TOWN OF BARRE, ON U.S. 302, AT MM 0.975 AND EXTENDING 0.195 MILES EASTERLY TO MM 1.170 AND BEGINNING AGAIN AT MM 2.020 AND EXTENDING EASTERLY 0.69 MILES TO MM 2.710 IN THE TOWN OF BARRE.

LENGTH OF ROADWAY: 4471 FT= 0.847 MILES
LENGTH OF BRIDGE: 202 FT= 0.038 MILES
LENGTH OF PROJECT: 4673 FT= 0.885 MILES

WORK ON THIS PROJECT INCLUDES REHABILITATION TO THE DECK OF BRIDGE # 14 (AT MM 2.216), UPGRADING SUBSTANDARD BRIDGE RAIL, OVERLAYING WITH A LEVELING COURSE AND A 1/2" BITUMINOUS CONCRETE PAVEMENT WEARING COURSE, UPGRADING SUBSTANDARD GUARD RAIL AND DRAINAGE PLUS NEW SIGNS AND PAVEMENT MARKINGS.

RECORD PLANS
CONTRACTOR J.A. McDONALD INC. - LYNDON CTR, VT.
RESIDENT ENGINEER RICHARD COMI
CONSTRUCTION BEGAN 4-25-94
CONSTRUCTION COMPLETED 6-23-95
RECORD PLANS BY FRED DONALD
I hereby certify that all the construction required by this set of drawings has been accomplished as indicated herein.
By Richard P. Comi Resident Engineer
Date 05/12/98

NOTE: Any further information concerning final quantities, amounts or other details relative to this project may be found on microfilm in Central Files.

TRAFFIC DATA

1991 ADT	6240	2001 ADT	7480
DHV	810	DHV	930
		%T	3
		%D	68
1991 - 2001 18 KIP ESAL	1,470,000		
DESIGN SPEED	50 MPH		

CONVENTIONAL SIGNS

- COUNTY LINE
- TOWN LINE
- LIMITS OF ACCESS
- POINT OF ACCESS
- FENCE LINE
- STONE WALL
- TRAVELED WAY
- GUARD RAIL
- RAILROAD
- SURVEY LINE
- CULVERT
- POWER POLE
- TELEPHONE POLE
- TREES
- CONTROL OF ACCESS
- PROPERTY LINE
- R.O.W. TAKING LINE
- SLOPE RIGHTS
- TOP OF CUT
- TOE OF SLOPE

DATUM
VERTICAL N/A
HORIZONTAL N/A



THESE PLANS ARE SUBJECT TO SUCH ENGINEERING CHANGES AS MAY BE REQUIRED BY THE FEDERAL HIGHWAY ADMINISTRATION OR THE CHIEF ENGINEER. CONSTRUCTION IS TO BE CARRIED ON IN ACCORDANCE WITH THESE PLANS AND THE STANDARD SPECIFICATIONS FOR CONSTRUCTION DATED 1990, AS APPROVED BY THE FEDERAL HIGHWAY ADMINISTRATION ON MARCH 15, 1990 FOR USE ON THIS PROJECT, INCLUDING ALL SUBSEQUENT REVISIONS AND SUCH REVISED SPECIFICATIONS AND SPECIAL PROVISIONS AS ARE INCORPORATED IN THESE PLANS.

Pin # 90B070

SUBMITTED BY ORDER OF THE STATE TRANSPORTATION BOARD
APPROVED: Richard P. Comi DIRECTOR OF ENGINEERING
DEPARTMENT OF TRANSPORTATION
FEDERAL HIGHWAY ADMINISTRATION
APPROVED: _____ DATE _____
DIVISION ADMINISTRATOR
PROJECT: BARRE TOWN F026-1(36) C-1 & STP 2139(1)S
SHEET 1 OF 119 SHEETS

DRAWING 14
US 302
066-1(36) 1

REPLACE GUARD RAIL BEAM UNIT
 54+50L+ ~ 54+75L+ 1 PANEL
 54+50R+ ~ 54+75R+ 2 PANELS
 55+98.5R+ ~ 57+00R+ 2 PANELS
 55+98.5L+ ~ 57+00L+ 2 PANELS

COLD PLANING - BIT, PVM 'T'
 51+50 ~ 54+99.04 (1 1/2")
 55+75.54 ~ 56+74 (SEE DETAIL ON SHT 3)

RELOCATE MAILBOXES, SINGLE SUPPORT
 51+83 RT 65+81R
 53+50 RT

RELOCATE MAILBOXES, MULTIPLE SUPPORTS
 53+75 RT (3 MULTIPLES OF 2)
 53+85 ~ 53+87

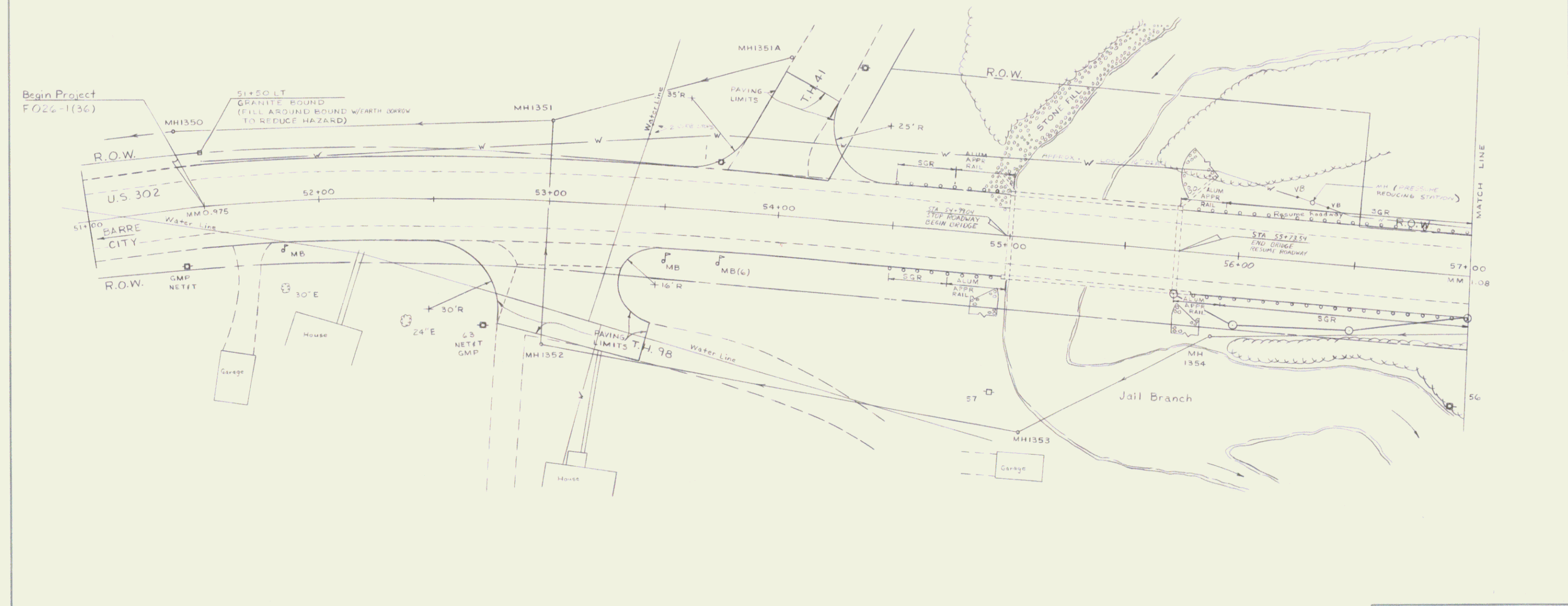

DATUM	
VERTICAL	N/A
HORIZONTAL	N/A

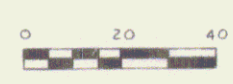

SURVEYED BY	RECORD PLANS	DATE	N/A
DRAWN BY	MUTTER	DATE	9/27/90
SQUAD LEADER	SHERIDAN		
DESIGN FILE NO.		DATE PLOTTED	
PROJ. NAME	BARRE TOWN		
PROJ. NO.	F026-1(36) C-1		
SHEET	10	OF	119 SHEETS

REPLACE GUARD RAIL BEAM UNIT
 57+00 LT ~ 60+00 LT 1 PANEL
 57+00 RT ~ 57+82 RT 2 PANELS

STEEL BEAM GUARD RAIL
 58+90 RT ~ 61+00 RT

RELOCATE MAILBOXES, MULTIPLE SUPPORT
 59+12 RT (1 MULTIPLE OF 2)

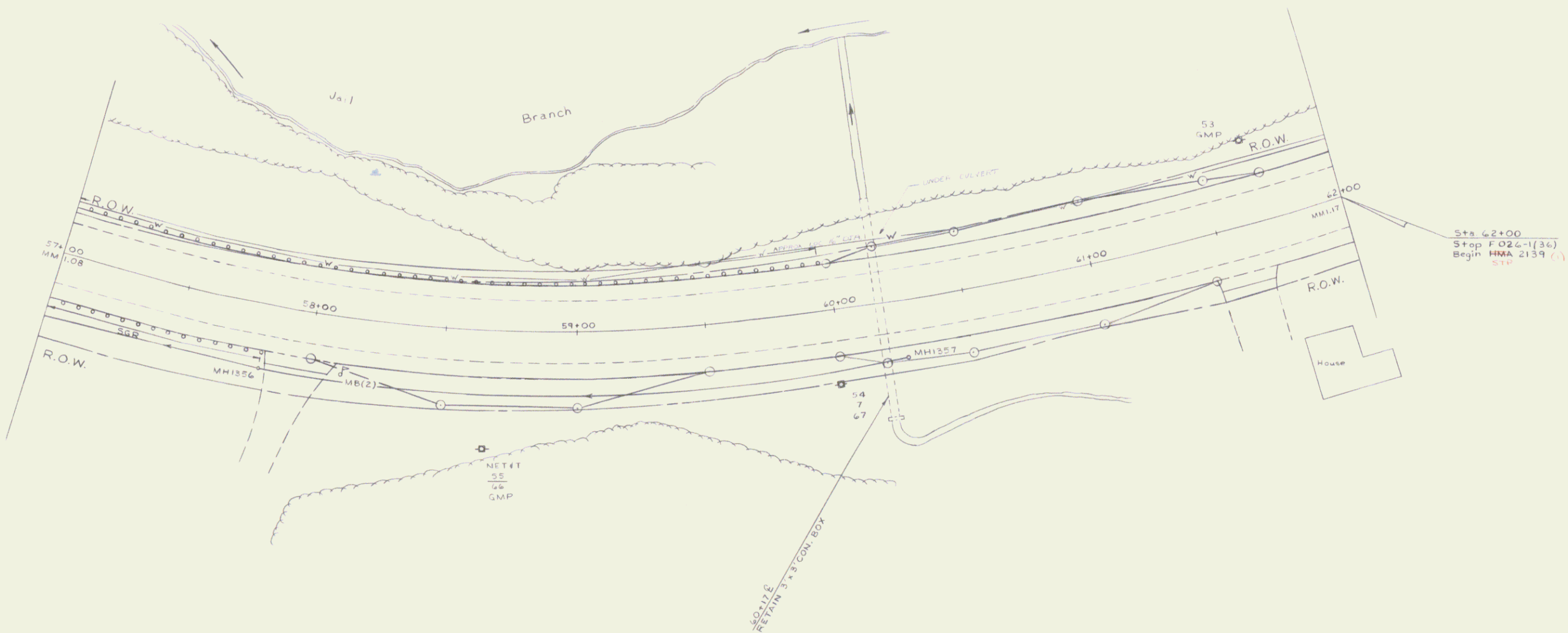

DATUM	
VERTICAL	N/A
HORIZONTAL	N/A

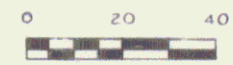

SURVEYED BY	RECORD PLANS	DATE	N/A
DRAWN BY	NUTTER	DATE	9/27/90
SQUAD LEADER	SHERIDAN		
DESIGN FILE NO.		DATE PLOTTED	
PROJ. NAME	BARRE TOWN		
PROJ. NO.	F026-1(36) C-1		
SHEET	11	OF	119 SHEETS

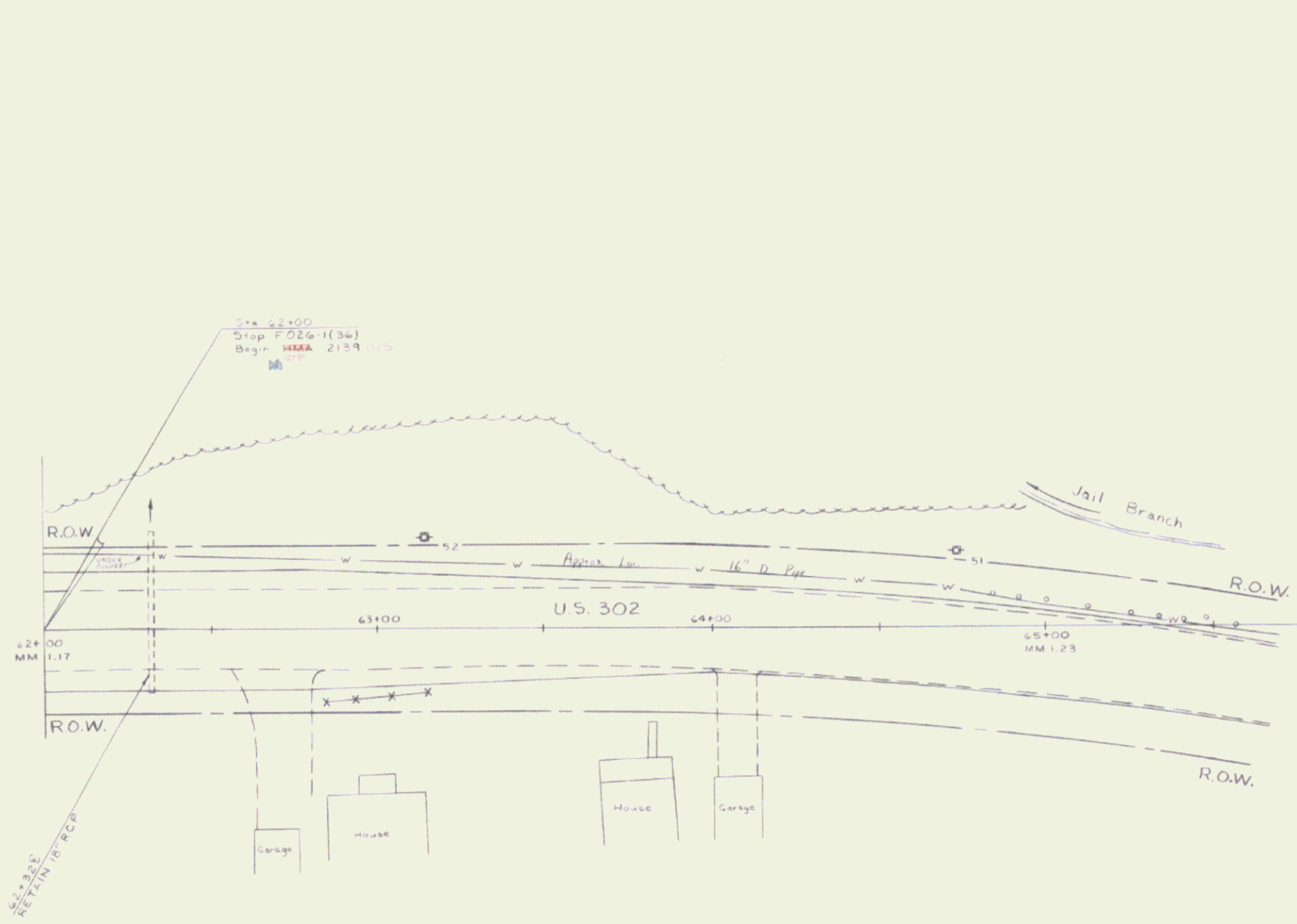

DATUM	
VERTICAL	N/A
HORIZONTAL	N/A



SURVEYED BY RECORD PLANS DATE N/A
 DRAWN BY HJITER DATE 9/27/90
 SQUAD LEADER SHERIDAN
 DESIGN FILE NO. N/A DATE PLOTTED N/A
 PROJ. NAME BARRE TOWN
 PROJ. NO. STP 2139(1)5
 SHEET 12 OF 119 SHEETS

REMOVAL AND DISPOSAL OF GUARD RAIL

98+52.1+/- 106+77.1+/-
98+99.8+/- 103+08.1+/-
3 AD

STEEL BEAM GUARD RAIL

98+50.1+/- 106+87.5+/-
98+95.5+/- 103+08.1+/-
3 AD

GRANITE SLOPE EDGING

107+83.1+/- 108+87.1+/- (TRAFFIC ISLAND)
AS

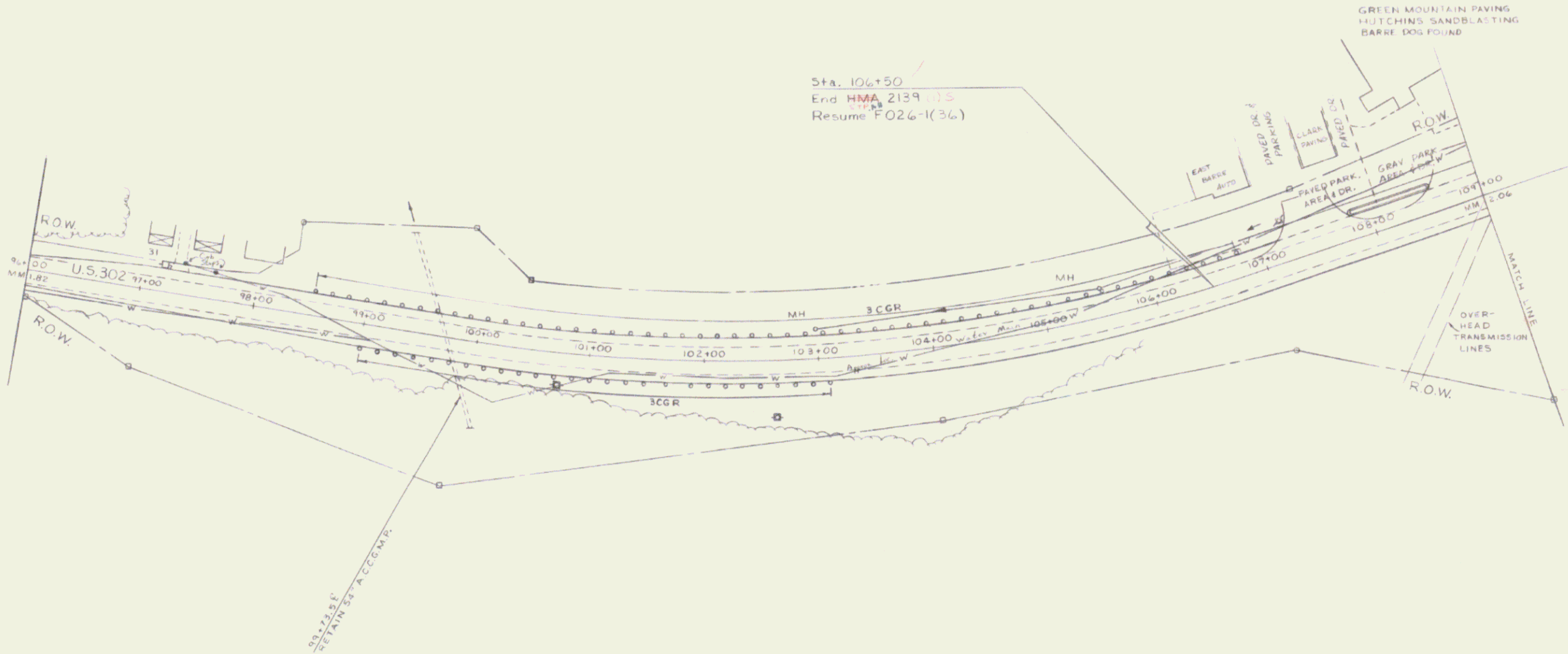
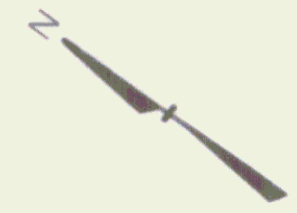

DATUM	
VERTICAL	N/A
HORIZONTAL	N/A

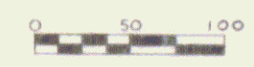

SURVEYED BY RECORD PLANS DATE N/A
 DRAWN BY NUTTER DATE 3/28/90
 SQUAD LEADER SHERIDAN
 DESIGN FILE NO. N/A DATE N/A
 PROJ. NAME BARRE TOWN
 PROJ. NO. STP 2139(1)5 + F026-1(36) C-1
 SHEET 18 OF 119 SHEETS

REMOVAL AND DISPOSAL OF GUARD RAIL

109+75.1 L+ - 112+17.1 L+
 112+07.8 R+ - 112+47.8 R+
 114+25.5 L+ - 115+60.1 L+
 114+51.5 R+ - 115+161.5 R+
 117+72.1 L+ - 122+93.1 L+
 123+73.1 L+ - 124+00.1 L+

STEEL BEAM GUARD RAIL

109+56.5 L+ - 111+69.1 L+
 114+26.5 L+ - 116+26.5 L+
 115+11.8 R+ - 118+11.8 R+
 117+65.1 L+ - 123+15.1 L+
 123+50.1 L+ - 124+00.1 L+

GUARD RAIL APPROACH SECTION, TYPE I

111+67.1 L+ - 112+17.1 L+
 112+12.1 R+ - 112+47.8 R+ W/35°R
 114+25.5 L+ - 114+75.5 L+
 114+61.5 R+ - 115+11.5 R+

STONE FILL, TYPE II FOR SLOPE STABILIZATION

122+75.1 L+ - 123+15.1 L+
 123+47.1 L+ - 123+75.1 L+

GOLD PLANING - BIT. PVM'T

114+37 - 112+37 *
 114+39.1 - 115+40 *
 *SEE DETAIL ON SHT 3

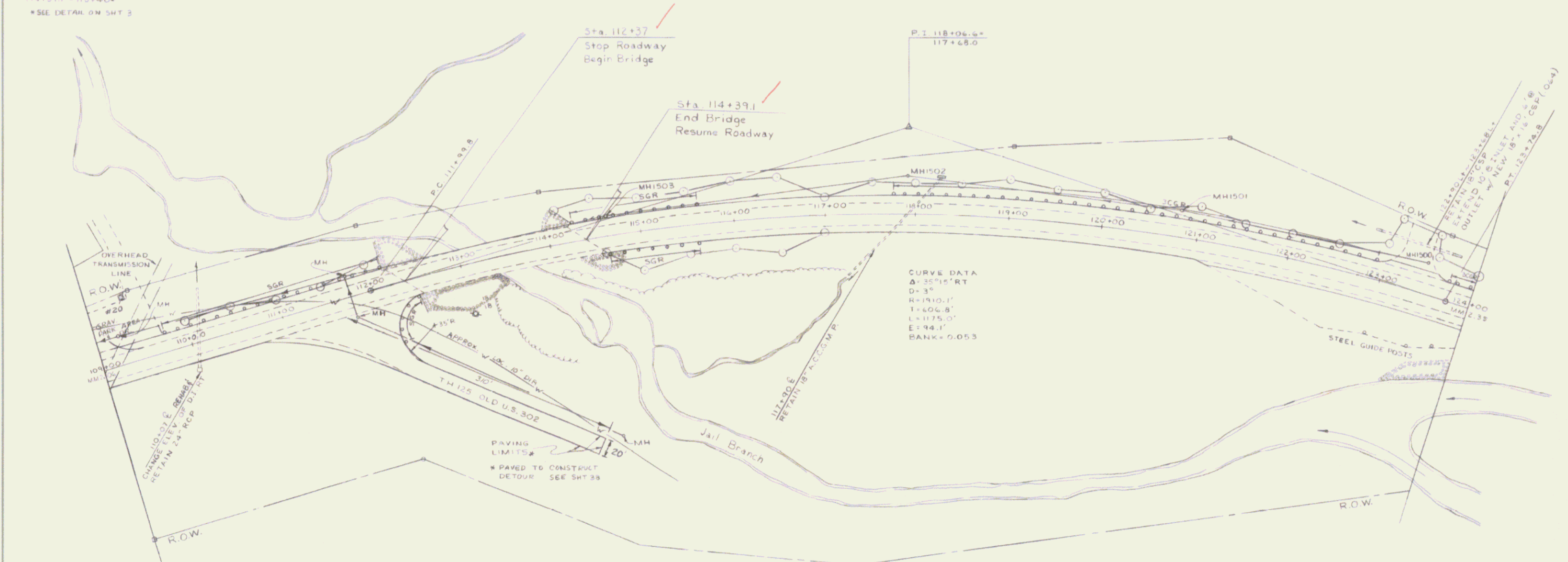

CURVE DATA
 Δ = 35°15' RT
 D = 3°
 R = 1110.1'
 T = 606.8'
 L = 1175.0'
 E = 94.1'
 BANK = 0.053

DATUM	
VERTICAL	N/A
HORIZONTAL	N/A



SURVEYED BY	RECORD PLANS	DATE	N/A
DRAWN BY	HUTTER	DATE	3/28/70
SQUAD LEADER	SHERIDAN		
DESIGN FILE NO.		DATE PLOTTED	
PROJ. NAME	BARRE TOWN		
PROJ. NO.	FO26-1(36) C-2		
SHEET	14	OF	119 SHEETS

REMOVAL AND DISPOSAL OF GUARD RAIL
4100L+~127+60L+
4100R+~128+90R+

STEEL BEAM GUARD RAIL
124+00L+~128+20L+
124+00R+~129+00R+

COLD PLANING - BIT. PAVT
134+00~140+00(1 1/2")

GRANITE SLOPE EDGIN
131+43~131+83 RT (TRAFFIC ISLAND)
132+48~132+93 RT (TRAFFIC ISLAND)
133+73~134+04 RT (TRAFFIC ISLAND)

RELOCATE 1" X SINGLE SW.
139+17 RT

TOM PAGE, UTILITIES ENGINEER

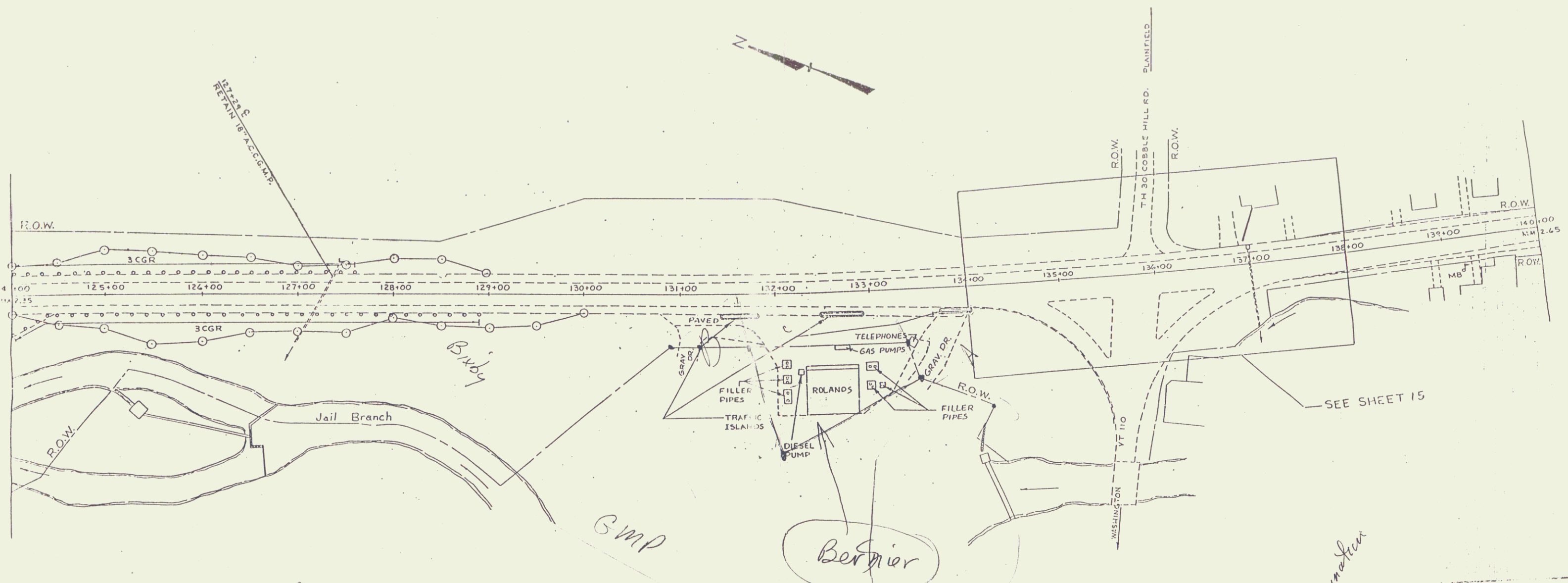

Bradford Oil Company, Inc
 To George Pratt, Jr. Pres.
 Box 394
 Bradford VT 05033
 222-5251

A & B Condemnation
 C WDOE
 Bridge -
 Mueller

RECORDED
 JAN 13 1976
 UTILITIES
 SECTION

VERTICAL	N/A
HORIZONTAL	N/A

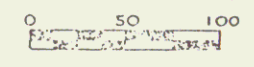

SURVEYED BY	RECORD PLANS DATE
DRAWN BY	NOTED DATE
SOUND LEADER	SHERIDAN
DESIGN FILE NO.	DATE PLOTTED
PROJ. NAME	BARRE TOWN
PROJ. NO.	FO24-1(36)S
SHEET 16	OF 7 SHEETS

7

COLD PLANING-BIT PAV'T

142+00 ~ 143+09 (1 1/2")
143+00 ~ 144+00 AB

RELOCATE MAILBOX - SINGLE SUPPORT

140+73 RT.

REMOVAL AND DISPOSAL OF GUIDE POSTS

1 @ STA 141+63 LT
1 @ STA 144+10 LT

REMOVING AND RESETTING CURB

140+00 LT ~ 140+20 LT 20'
140+00 RT ~ 140+75 RT 75' 1" AB
+3.5' AB +17' AB

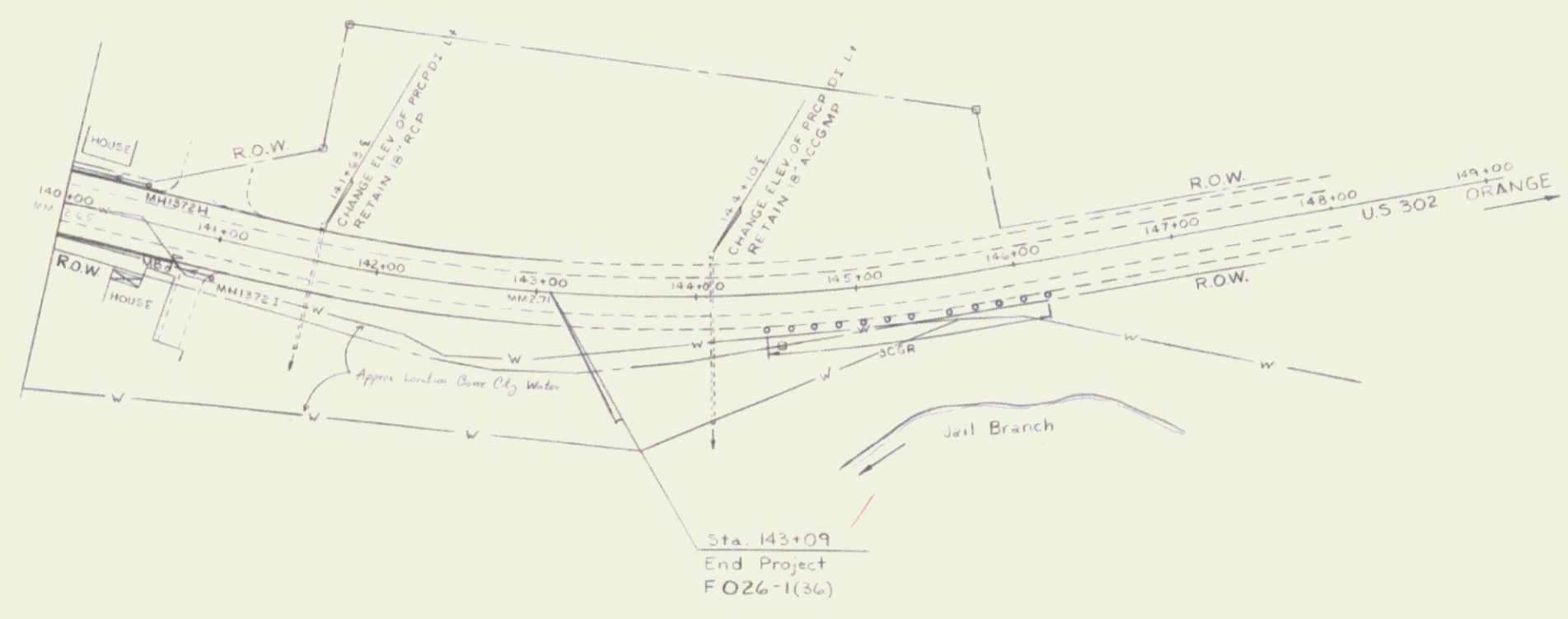
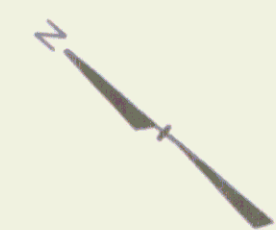

Sta. 143+09
End Project
FO26-1(36)

DATUM	
VERTICAL	N/A
HORIZONTAL	N/A

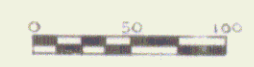

SURVEYED BY	RECORD PLANS	DATE	N/A
DRAWN BY	NUTTER	DATE	10/5/90
SQUAD LEADER	SHERIDAN		
DESIGN FILE NO.		DATE	
PROJ. NAME	BARRE TOWN	PLOTTED	
PROJ. NO.	FO26-1(36)	C-1	
SHEET	18	OF	17
		SHEETS	

8