

REMOVAL AND DISPOSAL OF GUARD RAIL
4100L+~127+60L+
4100R+~128+90R+

STEEL BEAM GUARD RAIL
124+00L+~128+20L+
124+00R+~129+00R+

COLD PLANING - BIT. PAVT
134+00~140+00(1 1/2")

GRANITE SLOPE EDGIN
131+43~131+83 RT (TRAFFIC ISLAND)
132+48~132+93 RT (TRAFFIC ISLAND)
133+73~134+04 RT (TRAFFIC ISLAND)

RELOCATE 1" X SINGLE SW.
139+17 RT

TOM PAGE, UTILITIES ENGINEER

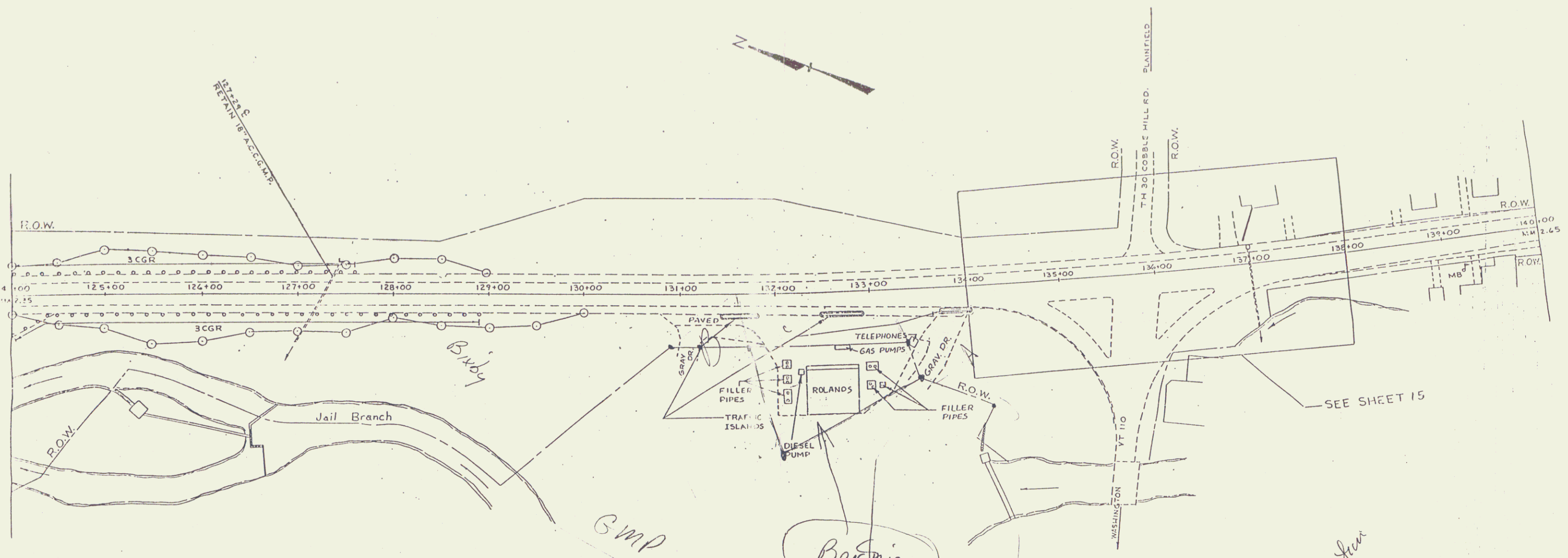

Bradford Oil Company, Inc
 To George Pratt, Jr. Pres.
 Box 394
 Bradford VT 05033
 222-5251

A & B Condemnation
 C WDOE
 Bridge -
 Mueller

RECORDED
 JAN 13 1976
 UTILITIES
 SECTION

VERTICAL	N/A
HORIZONTAL	N/A

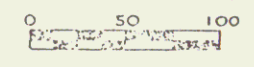

SURVEYED BY	RECORD PLANS DATE
DRAWN BY	MUTTER DATE
SOUND LEADER	SHERIDAN
DESIGN FILE NO.	DATE PLOTTED
PROJ. NAME	BARRE TOWN
PROJ. NO.	FO24-1(36)S
SHEET 16	OF 7 SHEETS

7