

Handwritten: 05 219 (4)

BANK  
SIT/EVP  
Elev. (h) 442.24

BANK  
SIT/EVP  
Abund. Elev. 453.48

TH 49 Curve #2  
D 42.4974  
L 9.00  
E 4.7574  
R 1.14

TH 49 Curve #1  
D 42.4974  
L 9.00  
E 4.7574  
R 1.14

PC 5329.66  
PT 5329.70

PC 43742.47

PT 4518.02

PC 45192.94

PC 42191.5

PT 4717.27

PT 4717.27

USL PD 262.00  
SL POT 250.00

PT 4112.73

PT 4112.73

PT 4112.73

PT 4112.73

MP 5.045

MP 5.045

PC 5329.85



Scale in Feet

Pin # 48807  
Route US4  
Date 7/26/77

MP 5.045-5.248  
Checked by: [Signature]  
Prepared by: [Signature]

SHEET 1

PLAN	
DATE	10/1/54
BY	W. H. BROWN
CHECKED BY	W. H. BROWN
APPROVED BY	W. H. BROWN
SCALE	AS SHOWN

PROFILE	
DATE	10/1/54
BY	W. H. BROWN
CHECKED BY	W. H. BROWN
APPROVED BY	W. H. BROWN
SCALE	AS SHOWN

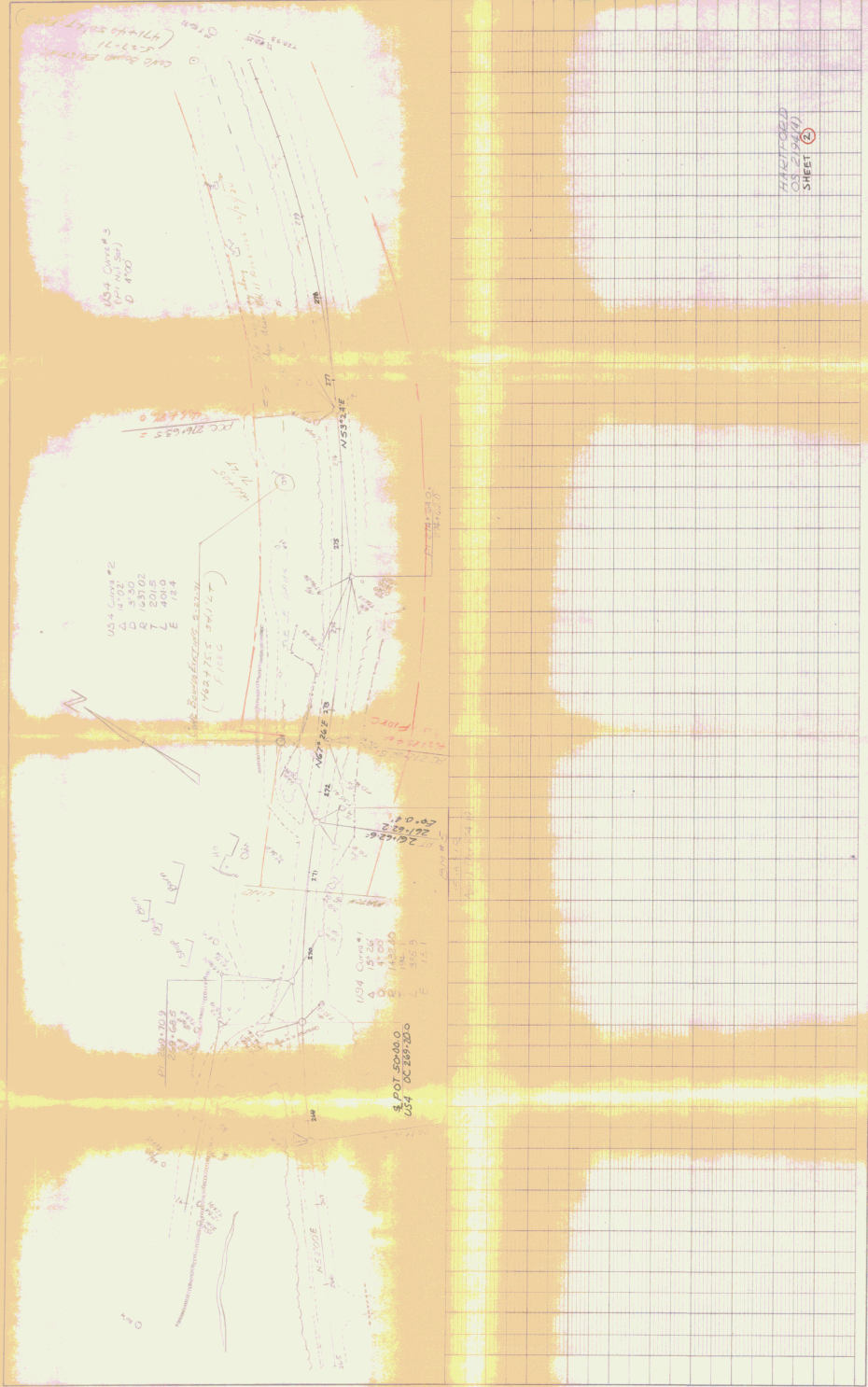

HIGHWAY ENGINEERING DEPARTMENT  
 UNIVERSITY OF CALIFORNIA  
 BERKELEY, CALIF.

HAZELWOOD  
 SHEET 2