

STATE OF VERMONT
AGENCY OF TRANSPORTATION

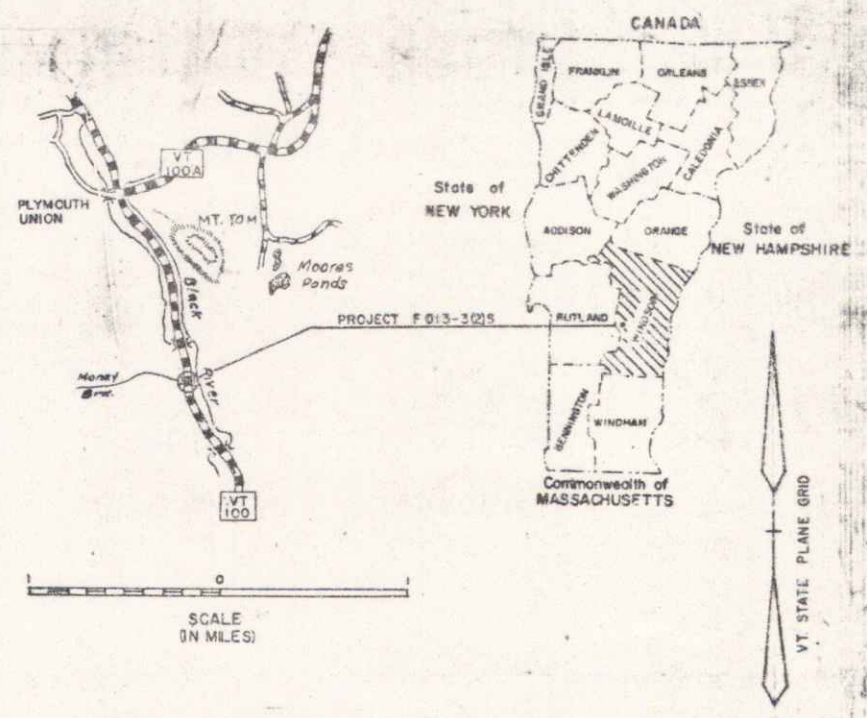

PROPOSED IMPROVEMENT
TOWN OF PLYMOUTH
COUNTY OF WINDSOR
VERMONT ROUTE 100 (FAP)



R.O.W. PLANS

IN THE TOWN OF PLYMOUTH, BEGINNING AT A POINT ON VT. ROUTE 100 WHICH IS 1.098 MI. SOUTHERLY OF THE INTERSECTION OF VT. ROUTE 100 WITH VT. ROUTE 100-A AND PROCEEDING NORTHERLY FOR 0.066 MI. PROJECT TERMINUS IS LOCATED APPROXIMATELY 5.539 MI. SOUTHERLY OF THE PLYMOUTH-BRIDGewater TOWN LINE.

WORK TO BE PERFORMED UNDER THIS PROJECT INCLUDES GRADING, DRAINAGE, SUBBASE AND PAVEMENT FOR A STATE HIGHWAY ON EXISTING LOCATION, AND THE REPLACEMENT OF AN EXISTING STRUCTURE WITH A NEW CONCRETE SLAB BRIDGE.

1982 ADT	1130
2002 ADT	1530
2002 DHV	210
D	57%
T	5%
V	40mph

LENGTH OF ROADWAY	321.89 FEET	• 0.061 MILES
LENGTH OF BRIDGES	28.11 FEET	• 0.005 MILES
LENGTH OF PROJECT	350.00 FEET	• 0.066 MILES
LENGTH OF R.O.W. PROJECT	650.00 FEET	• 0.123 MILES

BEGIN R.O.W. PROJECT *MP 4.16*
F 013-3(2)S TRAV. STA. 233+00

END R.O.W. PROJECT *MP 4.28*
F 013-3(2)S TRAV. STA. 239+50

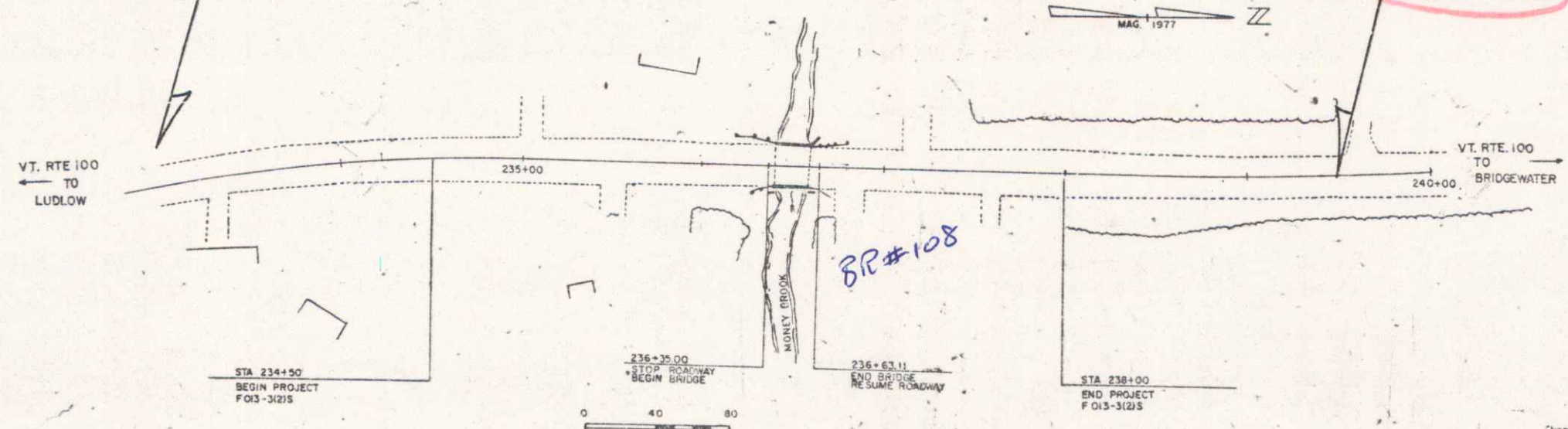

Date: 03/26/1982
PIN: 90A042

- CONVENTIONAL SIGNS
- COUNTY LINE
 - TOWN LINE
 - LIMITS OF ACCESS
 - POINT OF ACCESS
 - FENCE LINE
 - STONE WALL
 - TRAVELED WAY
 - GUARD RAIL
 - RAILROAD
 - FURVEY LINE
 - CULVERT
 - POWER POLE
 - TELEPHONE POLE
 - TREES
 - CONTROL OF ACCESS
 - PROPERTY LINE
 - R.O.W. TAKING LINE
 - SLOPE RIGHTS
 - TOP OF CUT
 - TOE OF SLOPE

DATUM

VERTICAL	NGVD 1929
HORIZONTAL	NA

These plans are subject to such engineering changes as may be required by the Federal Highway Administration or the Chief Engineer. Construction is to be carried on in accordance with these plans and the Standard Specifications for Highway and Bridge Construction dated March, 1976, as approved by the Federal Highway Administration on October 27, 1976 for use on this project, including all subsequent revisions and such revised specifications and special provisions as are incorporated in these plans.

APPROVED *[Signature]*
CHIEF, PROPERTY ADMINISTRATION
DATE *3-26-82*

SUBMITTED BY ORDER OF THE STATE TRANSPORTATION BOARD
ADMINISTRATION OF THE CHIEF ENGINEER
APPROVED *[Signature]* DATE *3-24-82*
CHIEF ENGINEER
DEPARTMENT OF TRANSPORTATION
FEDERAL HIGHWAY ADMINISTRATION
APPROVED _____ DATE _____
DIVISION ADMINISTRATOR
PROJECT F 013-3(2)S
SHEET 1 OF 7
SAS 02/10/70

CONSTRUCT DRIVE

LT	RT
235+00 (12' wide)	233+32 (12' wide)
237+22 (14' wide)	235+50 (14' wide)
	237+09 (12' wide)
	237+60 (10' wide)

WOOD MARKER POSTS ITEM 619.15	NORWAY SPRUCE ITEM 656.144
237+52.5 35' RT	237+13 37' RT
237+67.5 35' RT	237+09.5 42' RT
(SEE SPECIAL PROVISIONS)	237+07 48' RT
	237+05 54' RT
	237+09 60' RT
	237+06 67' RT

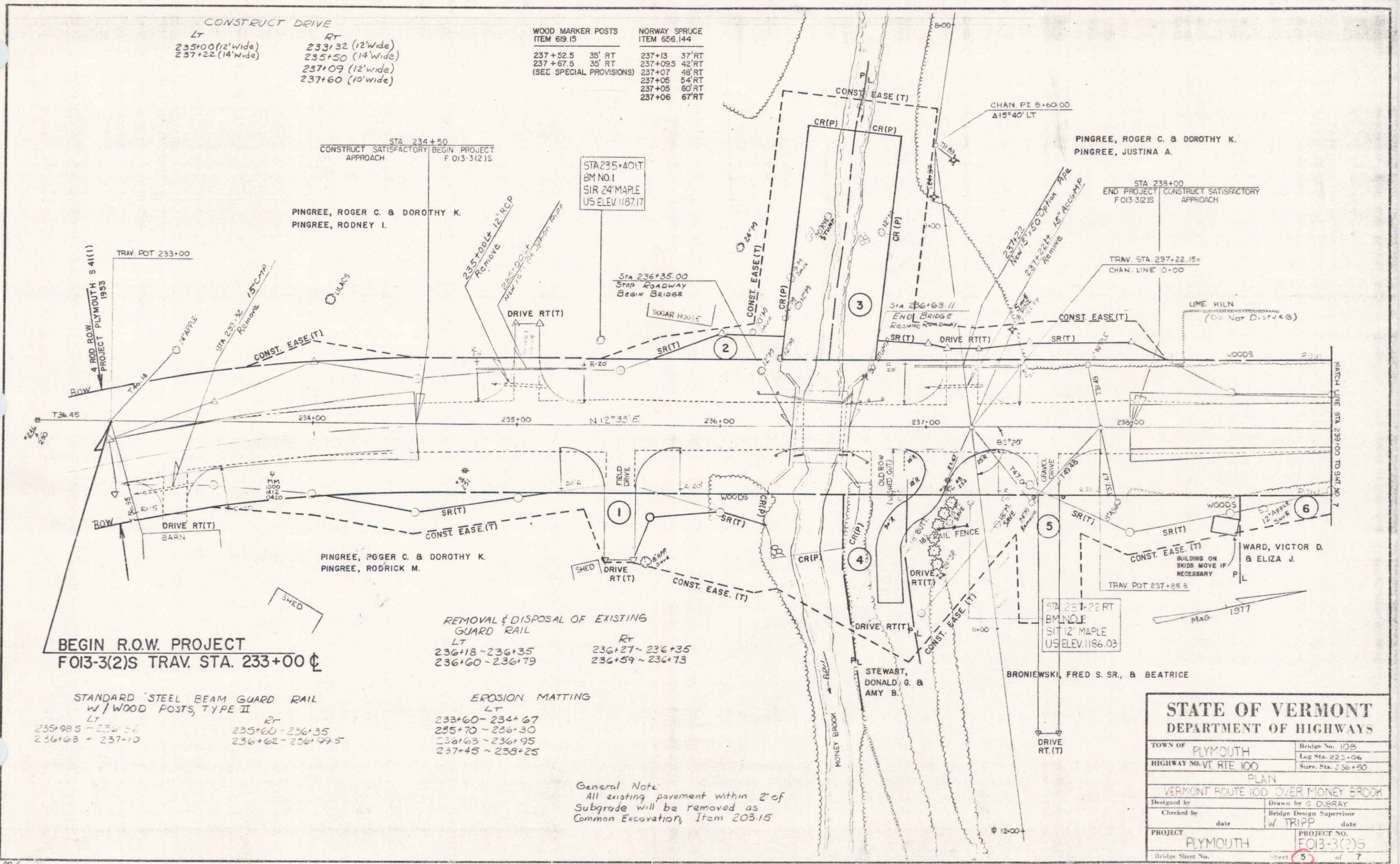

BEGIN R.O.W. PROJECT
FO13-3(2)S TRAV. STA. 233+00

STANDARD STEEL BEAM GUARD RAIL
W/ WOOD POSTS, TYPE II

LT	RT
235+98.5 - 236+32	235+60 - 236+35
236+63 - 237+10	236+62 - 236+99.5

REMOVAL & DISPOSAL OF EXISTING GUARD RAIL

LT	RT
236+18 - 236+35	236+27 - 236+35
236+60 - 236+79	236+59 - 236+73

EROSION MATTING

LT	RT
233+60 - 234+67	
235+70 - 236+30	
236+63 - 236+95	
237+45 - 238+25	

General Note
All existing pavement within 2' of Subgrade will be removed as Common Excavation, Item 203.15

STATE OF VERMONT	
DEPARTMENT OF HIGHWAYS	
TOWN OF PLYMOUTH	Bridge No. 108
HIGHWAY NO. VT. RTE. 100	Log Sta. 233+06
	Surv. Sta. 236+50
PLAN	
VERMONT ROUTE 100 OVER MONEY BROOK	
Designed by	Drawn by G. DUBRAY
Checked by	Bridge Design Supervisor
date	W. TRIPP
date	date
PROJECT PLYMOUTH	PROJECT NO. FO13-3(2)S
Bridge Sheet No.	Sheet 5 of 7

BR 6

