

RESEARCH DRAWER SET

STATE OF VERMONT  
AGENCY OF TRANSPORTATION



PROPOSED IMPROVEMENT  
**TOWN OF BENNINGTON**  
COUNTY OF BENNINGTON

**VT. ROUTE 67A (F.A.U.) (MAJOR COLLECTOR)**

BEGINNING IN BENNINGTON AT A POINT 0.061 MILES NORTHERLY OF THE VT 7A/VT 67A INTERSECTION,  
AND EXTENDING NORTHERLY ALONG VT. ROUTE 67A FOR A  
DISTANCE OF 0.836 MILES TO MILE MARKER 0.897.

LENGTH OF ROADWAY 4413.16 FEET=0.836 MILES  
LENGTH OF PROJECT 4413.16 FEET=0.836 MILES  
LENGTH OF R.O.W. PROJECT 91.00 FEET=0.017 MILES

WORK TO BE PERFORMED UNDER THIS PROJECT INCLUDES UPGRADING THE BRIDGE RAIL ON BRIDGE #1,  
RESURFACING OF THE EXISTING HIGHWAY WITH A LEVELING COURSE AND A WEARING COURSE, NEW  
PAVEMENT MARKINGS, UPGRADING EXISTING GUARDRAIL, REPLACING OR RESETTING CURB, REPLACEMENT  
OF SIGNS AND NEW ELECTRICAL CONDUIT FOR TRAFFIC SIGNALS AND STREET LIGHTS.

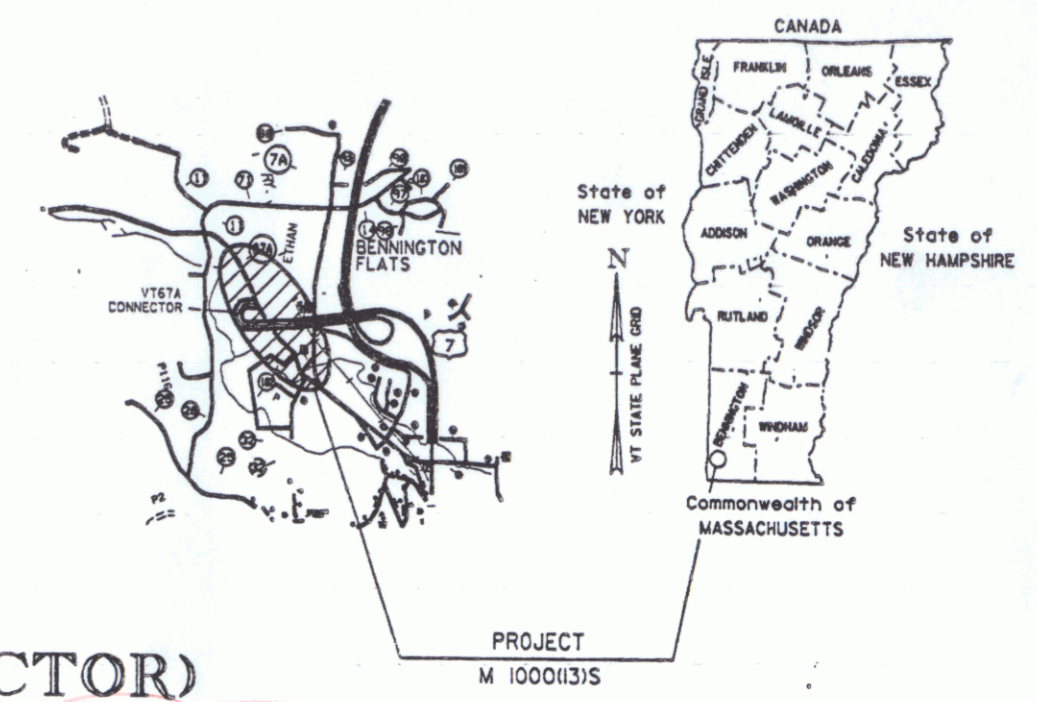

R.O.W. PLANS

RIGHT-OF-WAY DIVISION  
TOWN FILE  
PERPETUAL  
Town of Bennington, VT RTE 67A  
(To Be Returned To R.O.W. Division)

BEGIN R.O.W. PROJECT  
M 1000(13)S STA. 11+52 23' LT.

STA. 55+43.16 = M.M. 0.897  
END PROJECT  
M 1000(13)S

STA. 11+30.00 = M.M. 0.061  
BEGIN PROJECT  
M 1000(13)S

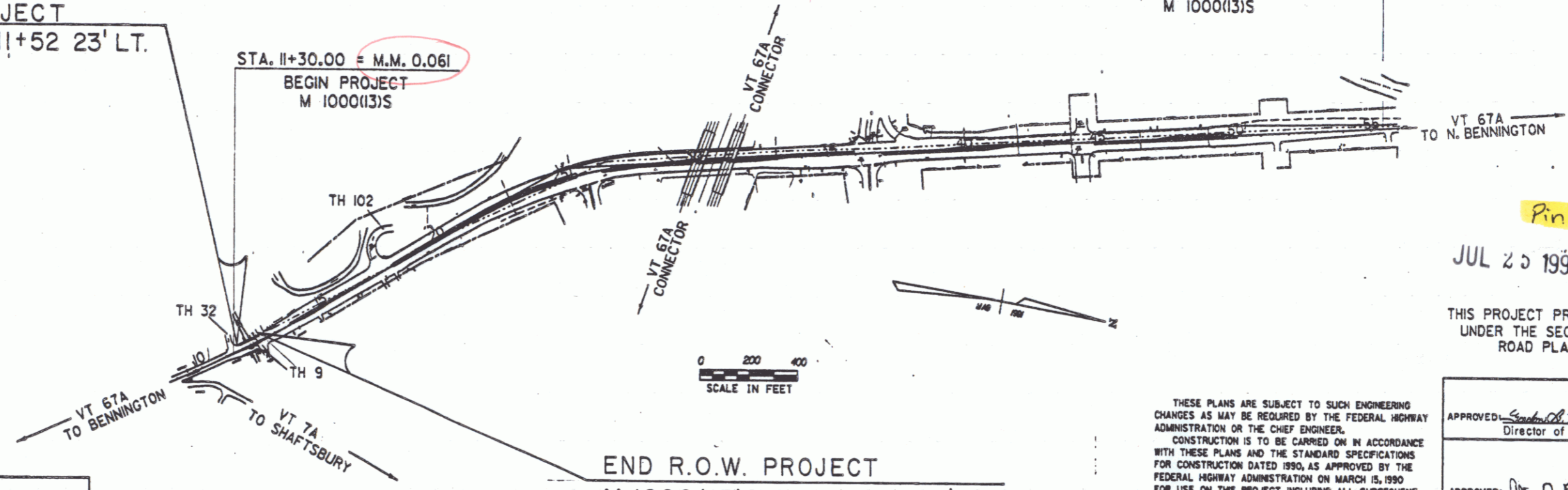

CONVENTIONAL SIGNS

COUNTY LINE	---
TOWN LINE	- - - -
LIMITS OF ACCESS	— X —
POINT OF ACCESS	— X —
FENCE LINE	— X —
STONE WALL	— X —
TRAVELED WAY	— X —
GUARD RAIL	— X —
RAILROAD	— X —
SURVEY LINE	— X —
CULVERT	— X —
POWER POLE	— X —
TELEPHONE POLE	— X —
TREES	— X —
CONTROL OF ACCESS	— X —
PROPERTY LINE	— X —
R.O.W. TAKING LINE	— X —
SLOPE RIGHTS	— X —
TOP OF CUT	— X —
TOE OF SLOPE	— X —

DATUM  
VERTICAL NGVD 1929  
HORIZONTAL N/A

SCALE IN FEET  
0 200 400

END R.O.W. PROJECT  
M 1000(13)S STA. 12+43 31' LT.

Pin # 89D030

JUL 20 1994

THIS PROJECT PROCESSED  
UNDER THE SECONDARY  
ROAD PLAN

THESE PLANS ARE SUBJECT TO SUCH ENGINEERING  
CHANGES AS MAY BE REQUIRED BY THE FEDERAL HIGHWAY  
ADMINISTRATION OR THE CHIEF ENGINEER.  
CONSTRUCTION IS TO BE CARRIED ON IN ACCORDANCE  
WITH THESE PLANS AND THE STANDARD SPECIFICATIONS  
FOR CONSTRUCTION DATED 1990, AS APPROVED BY THE  
FEDERAL HIGHWAY ADMINISTRATION ON MARCH 15, 1990  
FOR USE ON THIS PROJECT, INCLUDING ALL SUBSEQUENT  
REVISIONS AND SUCH REVISED SPECIFICATIONS AND  
SPECIAL PROVISIONS AS ARE INCORPORATED IN THESE  
PLANS.

APPROVED: *[Signature]* DATE: 7/14/94  
Director of Engineering

APPROVED: *[Signature]* DATE: 7/14/94  
Chief of Right of Way

BENNINGTON  
M 1000(13) S  
R.O.W. SHEET 1 OF 6

**SEEDING FORMULA  
URBAN AREAS**

% WT.	LBS./A.	NAME	PUR %	GERM %
37.5	30	CREeping RED FESCUE	98	85
31.25	25	KENTUCKY BLUE GRASS	85	75
31.25	25	PERENNIAL RYE GRASS	95	90
100.00	80			

THE SEED MIXTURE SHALL NOT HAVE A WEED CONTENT EXCEEDING 0.40% BY WEIGHT AND SHALL BE FREE OF ALL NOXIOUS WEED SEED.  
 SEED- TO BE APPLIED PER SEEDING FORMULA DIRECTED BY THE ENGINEER.  
 FERTILIZER- FORMULA 10-20-10 TO BE USED WITH SEED, APPLIED AT THE RATE OF 500 LBS./ACRE.  
 AGRICULTURAL LIMESTONE- TO BE APPLIED AT THE RATE OF 2 TONS/ACRE OR AS DIRECTED BY THE ENGINEER.  
 HAY MULCH- TO BE PLACED ON EARTH SLOPES AT THE RATE OF 2 TONS/ACRE, OR AS DIRECTED BY THE ENGINEER.  
 TOPSOIL- TO BE USED WITH SEED AS INDICATED ON THE PLANS, OR AS DIRECTED BY THE ENGINEER.  
 MARKER POSTS- TO BE PLACED AS DIRECTED BY THE ENGINEER.  
 SLOPE ROUNDING- ALL CUT SLOPES TO BE ROUNDED IN ACCORDANCE WITH STANDARD SHEET B-5.  
 PAY LIMITS OF SAND BORROW WHEN USED IN CONJUNCTION WITH UNDERDRAIN- SEE STANDARD SHEET D-2.

**TYPICAL SECTION**

1 1/2" BITUMINOUS CONCRETE PAVEMENT (± 1/4")  
 700 TONS PER/MILE LEVELING COURSE OF BITUMINOUS CONCRETE PAVEMENT  
 EMULSIFIED ASPHALT, TO BE APPLIED AT THE RATE OF .015 GAL./SQ. YD.  
 OR AS DIRECTED BY THE ENGINEER.

NOTE: THE WEARING COURSE WILL BE TYPE III.  
 THE LEVELING COURSE MAY BE TYPE III OR TYPE IV,  
 AS DIRECTED BY THE ENGINEER.

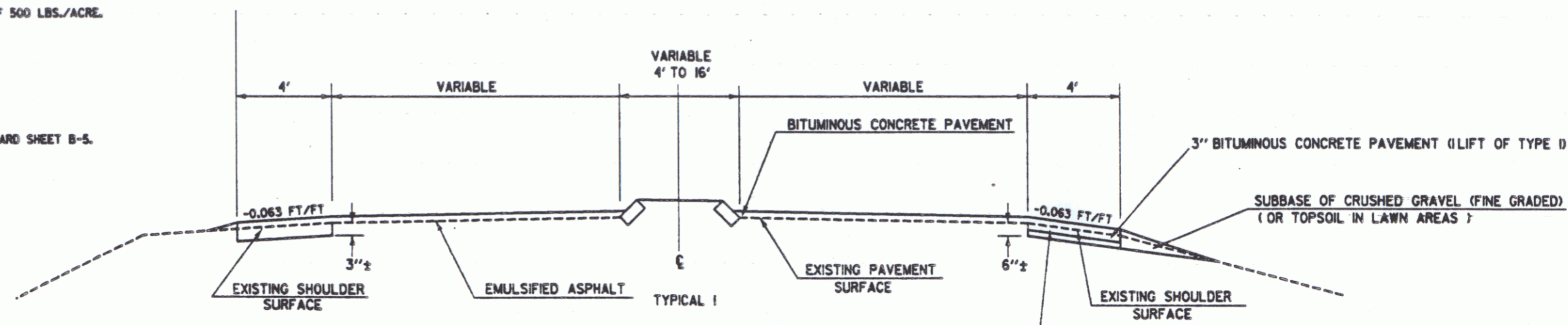

NORMAL SECTION  
 STA. 12+44 ~ 14+05  
 STA. 17+33 ~ 18+00  
 STA. 49+15 ~ 55+43

IF EXISTING SHOULDER MATERIAL IS DEEMED UNSUITABLE BY THE RESIDENT ENGINEER, IT SHALL BE EXCAVATED TO A DEPTH OF 6"± AS DIRECTED BY THE ENGINEER. EXCAVATION SHALL BE PAID AS ALL PURPOSE EXCAVATOR RENTAL OR GRADER RENTAL. MATERIAL REMOVED SHALL BE REPLACED WITH 3" OF SUBBASE OF CRUSHED GRAVEL (FINE GRADED) AND 3" OF BITUMINOUS CONCRETE PAVEMENT. EXCAVATED MATERIAL TO BE SPREAD ON SLOPES OR REMOVED FROM PROJECT, AS DIRECTED BY THE ENGINEER.

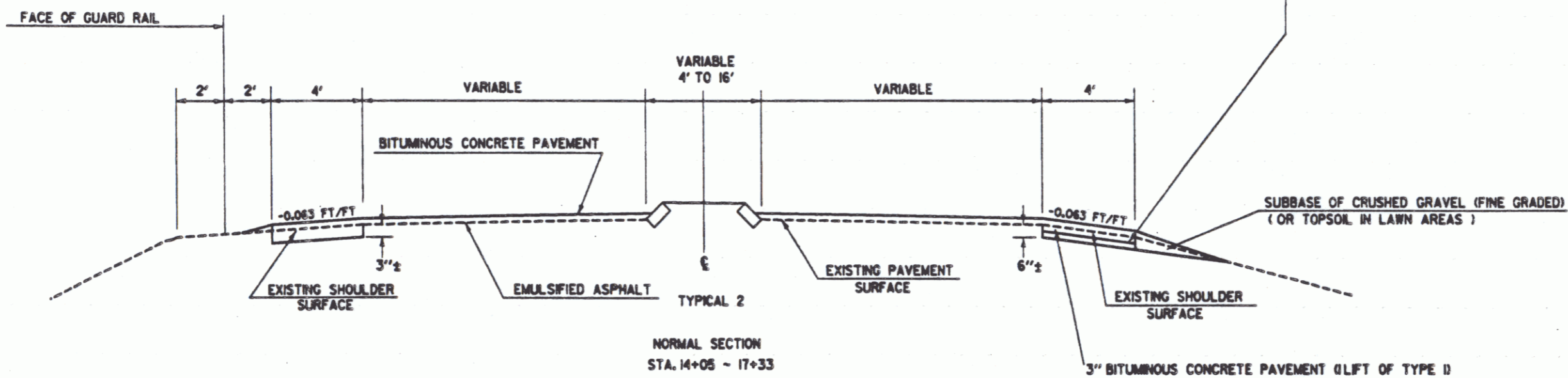

NORMAL SECTION  
 STA. 14+05 ~ 17+33

DATUM	
VERTICAL	N/A
HORIZONTAL	N/A

JUL 25 1994

R.O.W. PLANS

SURVEYED BY	MAGOON	DATE	4-15-91
DRAWN BY	SHERIDAN		
SQUAD LEADER			
DESIGN FILE NO.	890030.DGN		
POP FILE	890030TLP.PRF	DATE PLOTTED	20-DEC-1991
PROJ. NAME	BENNINGTON		
PROJ. NO.	M 1000(13)S		
SHEET	2	OF	6 SHEETS

# TYPICAL SECTION

1 1/2" BITUMINOUS CONCRETE PAVEMENT (± 1/4")  
 700 TONS PER/MILE LEVELING COURSE OF BITUMINOUS CONCRETE PAVEMENT  
 EMULSIFIED ASPHALT, TO BE APPLIED AT THE RATE OF .015 GAL./SQ. YD.  
 OR AS DIRECTED BY THE ENGINEER.

NOTE: THE WEARING COURSE WILL BE TYPE III.  
 THE LEVELING COURSE MAY BE TYPE III OR TYPE IV,  
 AS DIRECTED BY THE ENGINEER.

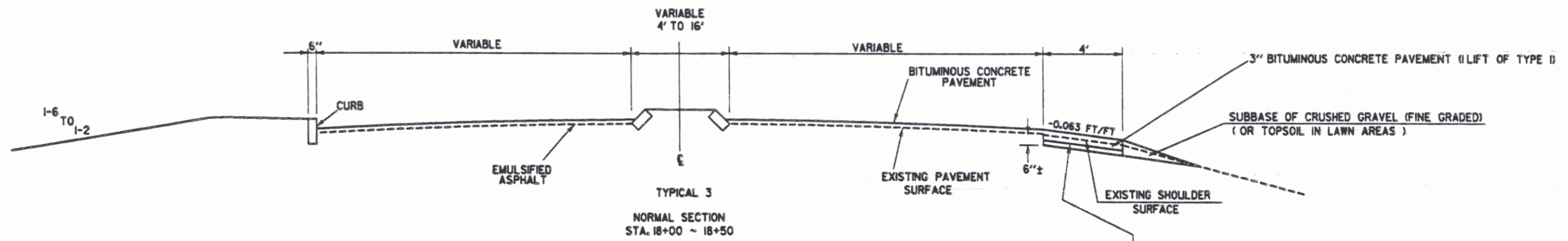

IF EXISTING SHOULDER MATERIAL IS DEEMED UNSUITABLE BY THE  
 RESIDENT ENGINEER, IT SHALL BE EXCAVATED TO A DEPTH OF 6"±  
 AS DIRECTED BY THE ENGINEER. EXCAVATION SHALL BE PAID AS ALL PURPOSE  
 EXCAVATOR RENTAL OR GRADER RENTAL. MATERIAL REMOVED SHALL BE REPLACED  
 WITH 3" OF SUBBASE OF CRUSHED GRAVEL (FINE GRADED) AND 3" OF BITUMINOUS  
 CONCRETE PAVEMENT. EXCAVATED MATERIAL TO BE SPREAD ON SLOPES OR  
 REMOVED FROM PROJECT, AS DIRECTED BY THE ENGINEER.

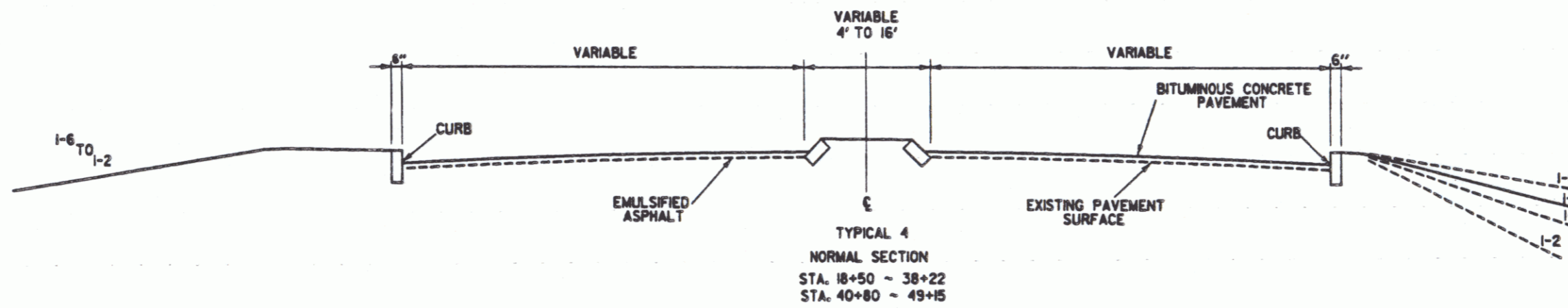

JUL 25, 1994

DATUM  
 VERTICAL N/A  
 HORIZONTAL N/A

R.O.W. PLANS	
SURVEYED BY	DATE
DRAWN BY <u>MAGOON</u>	DATE <u>4-15-94</u>
SOUND LEADER <u>SHERIDAN</u>	
DESIGN FILE NO. <u>89D030.DGN</u>	
PROJ. FILE <u>89D030TP2.PRF</u>	DATE PLOTTED <u>20-DEC-1994</u>
PROJ. NAME <u>BENNINGTON</u>	
PROJ. NO. <u>M 1000(13)S</u>	
SHEET <u>5</u> OF <u>6</u> SHEETS	

# TYPICAL SECTION

NOTE: THE WEARING COURSE WILL BE TYPE III.  
THE LEVELING COURSE MAY BE TYPE III OR TYPE IV,  
AS DIRECTED BY THE ENGINEER.

1 1/2" BITUMINOUS CONCRETE PAVEMENT (± 1/4")  
700 TONS PER/MILE LEVELING COURSE OF BITUMINOUS CONCRETE PAVEMENT  
EMULSIFIED ASPHALT, TO BE APPLIED AT THE RATE OF .015 GAL./SQ. YD.  
OR AS DIRECTED BY THE ENGINEER.

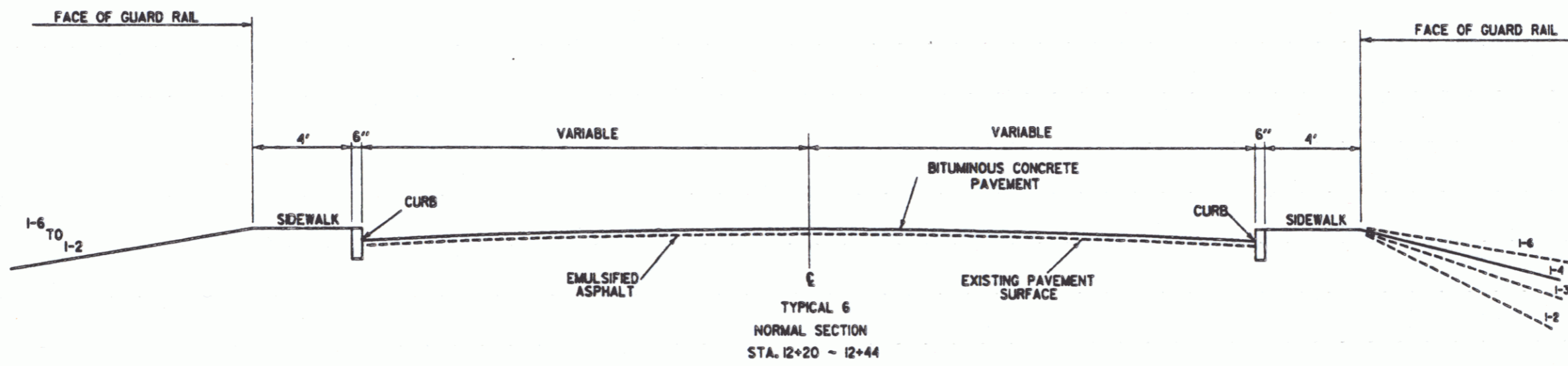
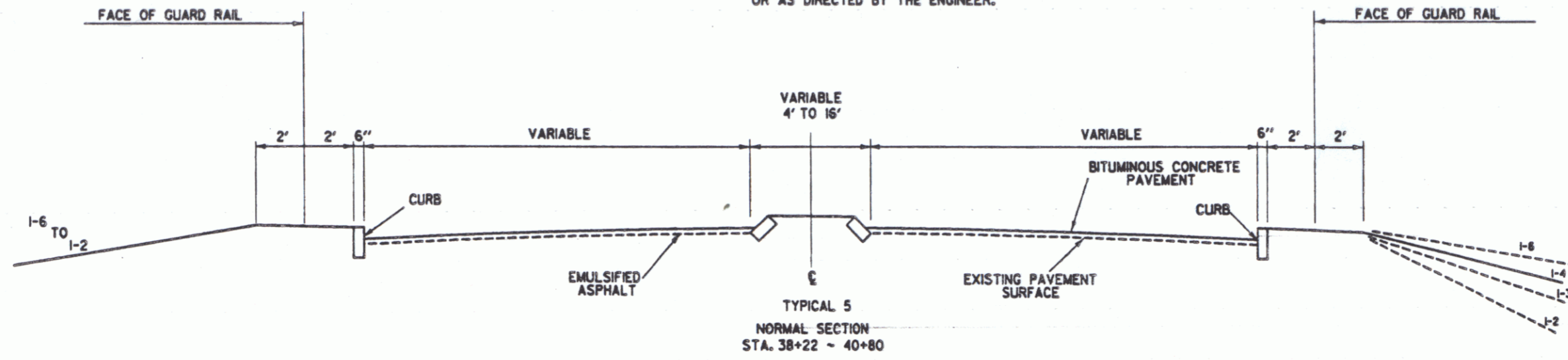

DATUM  
VERTICAL N/A  
HORIZONTAL N/A

JUL 25 1994

R.O.W. PLANS  
SURVEYED BY MAGOON DATE 4-15-91  
DRAWN BY SHERIDAN  
SQMAD LEADER SHERIDAN  
DESIGN FILE NO. 89D030.DGN  
PLOT FILE 89D030TP3.PRF DATE PLOTTED 20-DEC-1991  
PROJ. NAME BENNINGTON  
PROJ. NO. M 1000(13)S  
SHEET 4 OF 6 SHEETS

4

TABLE OF PROJECT PROPERTY ACQUISITION

STATE OF VERMONT  
 AGENCY OF TRANSPORTATION  
 RIGHT OF WAY PLANS  
 DETAIL SHEET

PARCEL NO.	GRANTOR	SHEET NO.	BEGINNING STATION	ENDING STATION	TAKING	REM.	RIGHTS	TITLE TAKEN	DATE	TOWN OR CITY RECORDED	BK.	PG.	REMARKS	REVISION NO.	SHEET	DESCRIPTION OF REVISION	DATE	MADE BY	APPROVED BY	
1	WOLFE, TERRANCE R. & VIRGINIA A.	6	11+52 LT.	11+56 LT.			INSTALL & MAINTAIN (P)	MOE					GUARDRAIL							
2	HAYNES REALTY CORPORATION	6	11+54 RT.	11+64 RT.			INSTALL & MAINTAIN (P)	MOE					GUARDRAIL							
3	BAUER, DAVID D. & NIERZWICKI-BAUER, SANDRA A.	6	12+38 LT.	12+43 LT.			INSTALL & MAINTAIN (P)	MOE					GUARDRAIL							
4	BENNINGTON VILLAGE WATER & SEWER												UTILITY							

03-3516 1805 090030  
 ACCT.root  
 /prop/89d030/r0030d.dgn  
 DATE PLOTTED 20-JUL-1994

DR. (P)- DRAINAGE RIGHT  
 DIT. (P)- DITCHING RIGHT  
 CH. (P)- CHANNEL RT.  
 DRIVE (T)- DRIVE RIGHT  
 CUL. (P)- CULVERT RIGHT  
 W- WATER SOURCES

PRESENT R.O.W.  
 TAKING WITHOUT ACCESS  
 TAKING WITHOUT ACCESS ALONG PROPERTY LINE  
 TAKING WITH ACCESS  
 PERMANENT EASEMENT  
 TEMPORARY EASEMENT

LEGEND  
 . . . . . CZ (P) . . . . . CLEAR ZONE  
 --- CONST. (T) --- CONSTRUCTION EASEMENT  
 SR SR SLOPE RIGHTS  
 P PROPERTY LINE  
 L TOP OF CUT  
 O O TOE OF SLOPE

JUL 25 1994

APPROVED: LAWRENCE BLISS L.S. DATE: 02-06-92  
 AGENT D. PLANS & TITLES

R. O. W. PLANS  
 BENNINGTON  
 M 1000(13) S  
 SHEET 5 OF 6

**REMOVING AND RESETTING CURB**  
 STA. 13+63 (END OF TRAFFIC ISLAND) (20') \*  
 \* RESET GRANITE SLOPE EDGING AROUND END OF TRAFFIC ISLAND TO CONFORM TO STANDARD C-1

**REMOVING SMALL STUMPS**  
 STA. 12+95 LT (REMOVE 24" STUMP)

**RELOCATE MAILBOX, SINGLE SUPPORT**  
 (MAILBOXES SHALL BE RELOCATED IN THEIR EXISTING POSITION, SEE SHT. #62 FOR MAILBOX SUPPORT DETAILS)  
 STA. 12+84 LT  
 STA. 14+84 RT

**BEGIN R.O.W. PROJECT**  
 M 1000(13)S STA. 11+52 23' LT.

**REMOVAL AND DISPOSAL OF GUARD RAIL**  
 STA. 12+12 ~ 12+26 RT (25')

**ALUMINUM APPROACH RAILING**  
 STA. 11+53 ~ 11+73 RT (20') 15' RAD.  
 STA. 11+50 ~ 11+73 LT (24') 15' RAD.  
 STA. 12+18 ~ 12+27 RT (28') 15' RAD.  
 STA. 12+23 ~ 12+42 LT (20') 10' RAD.

**COLD PLANING - BITUMINOUS PAVEMENT**  
 STA. 12+20 ~ 13+12  
 (SEE SHT. #10 FOR DETAILS)

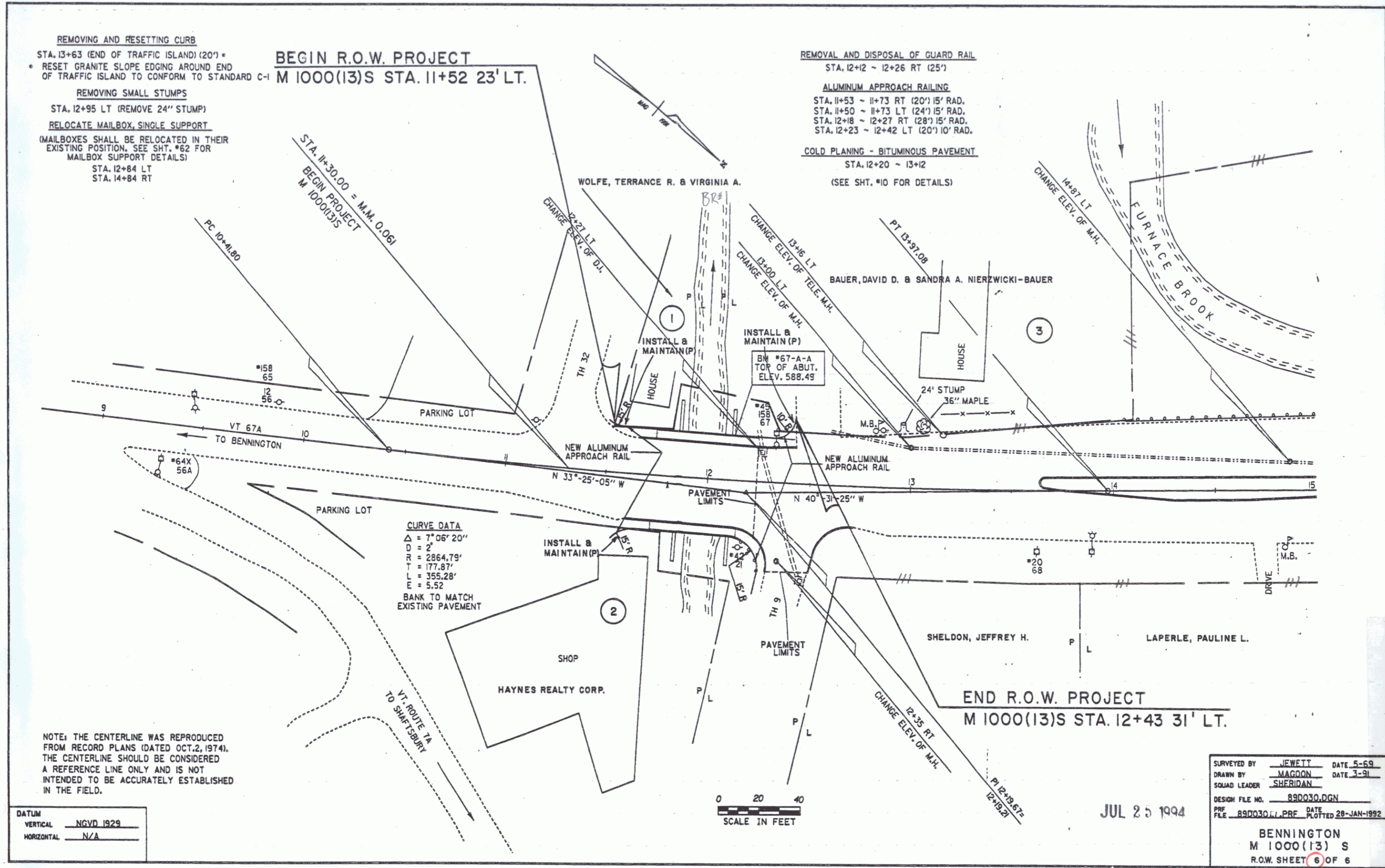

**CURVE DATA**  
 $\Delta = 7^{\circ} 06' 20''$   
 $D = 2$   
 $R = 2864.79'$   
 $T = 177.87'$   
 $L = 355.28'$   
 $E = 5.52$   
 BANK TO MATCH EXISTING PAVEMENT

NOTE: THE CENTERLINE WAS REPRODUCED FROM RECORD PLANS (DATED OCT. 2, 1974). THE CENTERLINE SHOULD BE CONSIDERED A REFERENCE LINE ONLY AND IS NOT INTENDED TO BE ACCURATELY ESTABLISHED IN THE FIELD.

DATUM  
 VERTICAL NGVD 1929  
 HORIZONTAL N/A

SURVEYED BY JEWETT DATE 5-89  
 DRAWN BY MAGOON DATE 3-91  
 SQUAD LEADER SHERIDAN  
 DESIGN FILE NO. 890030.DGN  
 PLOT FILE 890030.LL.PRF DATE PLOTTED 28-JAN-1992

JUL 25 1994

BENNINGTON  
 M 1000(13) S  
 R.O.W. SHEET 6 OF 6