

REMOVING AND RESETTING CURB
 STA. 13+63 (END OF TRAFFIC ISLAND) (20') *
 * RESET GRANITE SLOPE EDGING AROUND END OF TRAFFIC ISLAND TO CONFORM TO STANDARD C-1

REMOVING SMALL STUMPS
 STA. 12+95 LT (REMOVE 24" STUMP)

RELOCATE MAILBOX, SINGLE SUPPORT
 (MAILBOXES SHALL BE RELOCATED IN THEIR EXISTING POSITION, SEE SHT. #62 FOR MAILBOX SUPPORT DETAILS)
 STA. 12+84 LT
 STA. 14+84 RT

BEGIN R.O.W. PROJECT
 M 1000(13)S STA. 11+52 23' LT.

REMOVAL AND DISPOSAL OF GUARD RAIL
 STA. 12+12 ~ 12+26 RT (25')

ALUMINUM APPROACH RAILING
 STA. 11+53 ~ 11+73 RT (20') 15' RAD.
 STA. 11+50 ~ 11+73 LT (24') 15' RAD.
 STA. 12+18 ~ 12+27 RT (28') 15' RAD.
 STA. 12+23 ~ 12+42 LT (20') 10' RAD.

COLD PLANING - BITUMINOUS PAVEMENT
 STA. 12+20 ~ 13+12
 (SEE SHT. #10 FOR DETAILS)

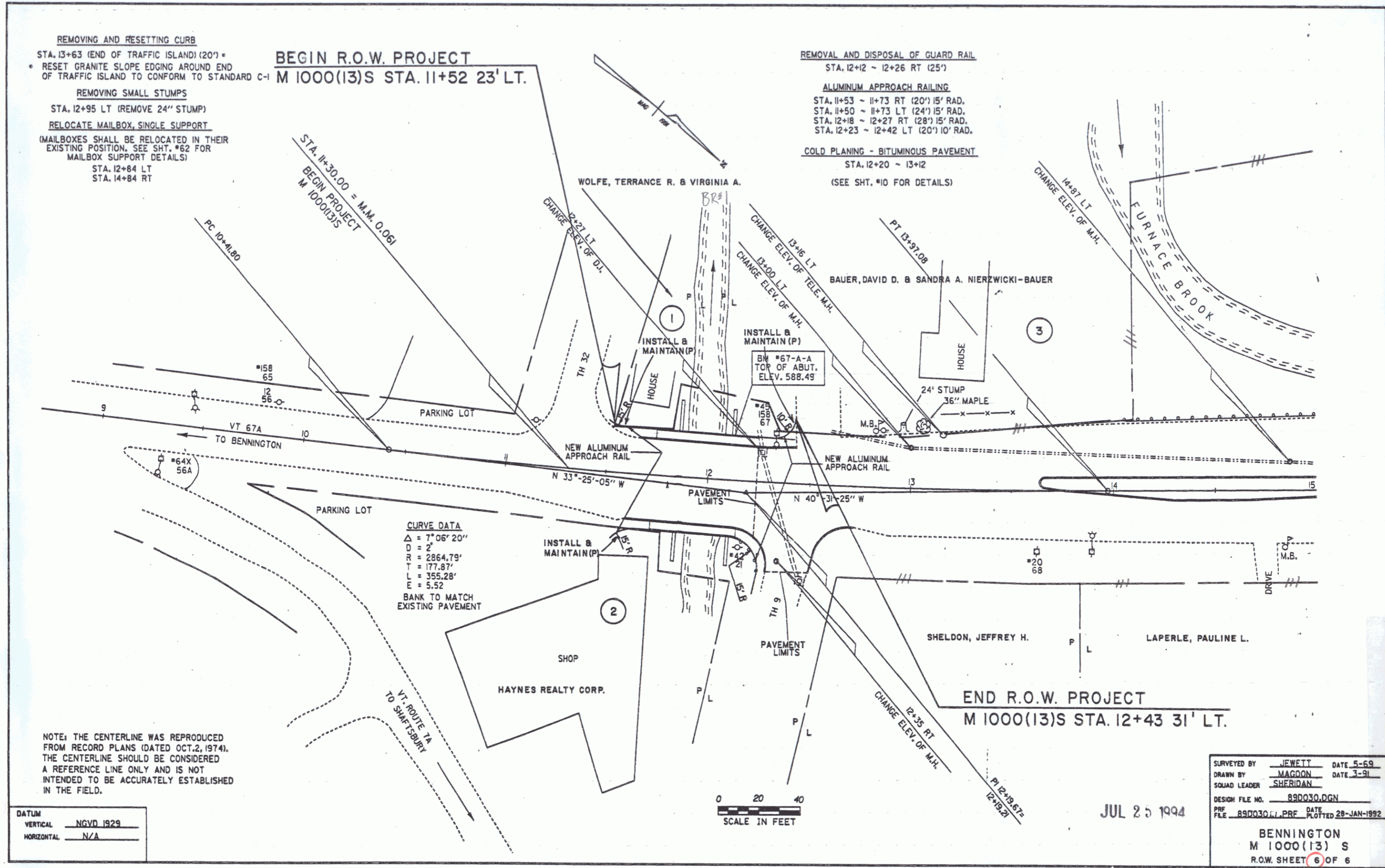

CURVE DATA
 $\Delta = 7^{\circ}06'20''$
 $D = 2$
 $R = 2864.79'$
 $T = 177.87'$
 $L = 355.28'$
 $E = 5.52$
 BANK TO MATCH EXISTING PAVEMENT

NOTE: THE CENTERLINE WAS REPRODUCED FROM RECORD PLANS (DATED OCT. 2, 1974). THE CENTERLINE SHOULD BE CONSIDERED A REFERENCE LINE ONLY AND IS NOT INTENDED TO BE ACCURATELY ESTABLISHED IN THE FIELD.

DATUM
 VERTICAL NGVD 1929
 HORIZONTAL N/A

0 20 40
 SCALE IN FEET

JUL 25 1994

SURVEYED BY JEWETT DATE 5-89
 DRAWN BY MAGOON DATE 3-91
 SQUAD LEADER SHERIDAN
 DESIGN FILE NO. 890030.DGN
 PRF 890030.LL PRF DATE 28-JAN-1992
 PLOTTED 28-JAN-1992

BENNINGTON
 M 1000(13) S
 R.O.W. SHEET 6 OF 6