

CONSTRUCT DRIVE
 TH 85+16, LT

CONSTRUCT APPROACH
 Rev 86+30, RT, TH 10

**EXCAVATION AND REMOVAL OF
 EXISTING CURBS AND PAVEMENT**
 TH 85+12 - 86+34, RT

**REMOVAL AND DISPOSAL OF
 EXISTING CURBS**
 Rev 85+49.5 - 86+07, LT
 Rev 87+68 - 88+06, LT
 Rev 86+06 - 86+43, RT
 Rev 87+85 - 88+34, RT

**GUARD RAIL HEAVY DUTY STEEL BEAM
 WINDUP TYPE III**
 Rev 85+49.5 - 86+07, LT
 Rev 87+68 - 88+06, LT
 Rev 86+45 - 86+60, RT
 Rev 88+02 - 88+27, RT

APPROACH RAILING
 Rev 86+07 - 86+31, LT
 Rev 87+60 - 87+84, LT
 Rev 86+60 - 86+84, RT
 Rev 87+78 - 88+02, RT

**STONE FILL TYPE III
 For Slope Protection**
 TH 10 Rev 0+24 - 0+57, RT

CONSTRUCT PARKING AREA
 TH 87+90 - 86+25, RT

BEGIN MAINTENANCE AGREE. AREA NO. 1
 REV. STA. 86+30 12' RT

END MAINTENANCE AGREE. AREA NO. 1
 REV. STA. 86+30 45' RT

END ROW PROJECT
 BR# 028-3(19)S REV. STA. 90+00

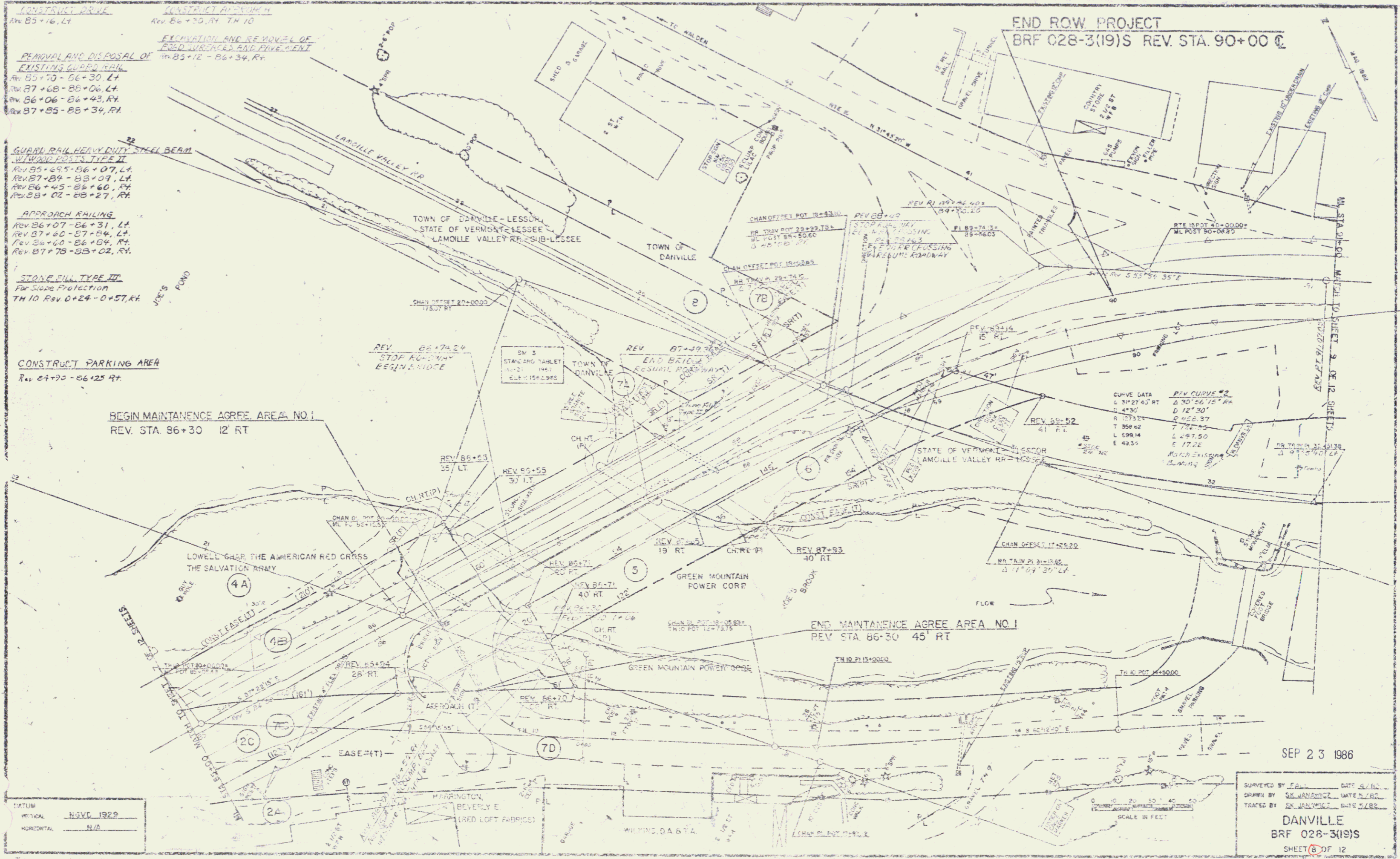

VERTICAL: N/S
 HORIZONTAL: N/S

SEP 23 1986

SURVEYED BY: J.E.W. DATE: 4/86
 DRAWN BY: S.K. JANSING DATE: 7/86
 TRACED BY: S.K. JANSING DATE: 7/86

DANVILLE
 BR# 028-3(19)S
 SHEET 6 OF 12