

CONSTRUCTION NOTES

CONSTRUCT SIDEWALK  
STA 10+575.0 - STA 10+603.0, LT  
STA 10+613.3 - STA 10+660.0, LT

CONSTRUCT SIDEWALK RAMP, TYPE I  
(SEE STD. C-3M)  
STA 10+599.7 - STA 10+603.0, LT  
STA 10+613.3 - STA 10+616.3, LT

CONSTRUCT CONCRETE CURB  
STA 10+575 - STA 10+629.5, RT  
STA 10+575 - STA 10+602.1, LT  
STA 10+613.9 - STA 10+660, LT

DURABLE 100 mm WHITE LINE  
STA 10+575 - STA 10+660, LT & RT  
STA 10+648 - STA 10+660, RT TURNING LANE

DURABLE 100 mm YELLOW LINE (DOUBLE CENTER LINE)  
STA 10+575 - STA 10+627.5

DURABLE 100 mm YELLOW LINE (SINGLE CENTER LINE)  
STA 10+627.5 - STA 10+660, LT & RT  
STA 10+627.5 - STA 10+648.5, LT & RT

DURABLE 200 mm DIAGONAL YELLOW LINE  
STA 10+627.5 - STA 10+648

DURABLE SYMBOL  
STA 10+653, RT ARROW-LEFT TURN  
STA 10+653, RT ARROW-RIGHT TURN

CONSTRUCT DRIVE  
STA 10+608, LT  
50 BCP TYPE 1111, 6000 WIDE

STA 10+639, RT  
COLD PLANE, 2000 APRON  
50 BCP TYPE 1111, 2000 APRON

TRAVEL LANE TAPER  
STA 10+625.4, LT (3300) TO  
STA 10+660, LT (1560)

STA 10+598, RT (3300) TO  
STA 10+648.5, RT (6300)

PAVED SHOULDER TAPER  
STA 10+598, LT (1800) TO  
STA 10+617.2, LT (2800) TO  
STA 10+625.4, LT (2910) TO  
STA 10+638.8, LT (3110) TO  
STA 10+660, LT (300)

STA 10+598, RT (1800) TO  
STA 10+630, RT (300)

COLD PLANNING  
STA 10+645 - STA 10+660

FOR R.O.W. USE ONLY

STATE OF VERMONT AGENCY OF TRANSPORTATION

Table with project details: Town of Colchester-South Burlington, Bridge No. 6, Highway No. TH 4/3, etc.

Table with design and project info: PLAN (5 OF 5), Designed By A.J. CRAWFORD, Checked By J.A. MERCER, etc.

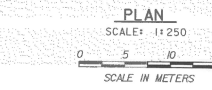
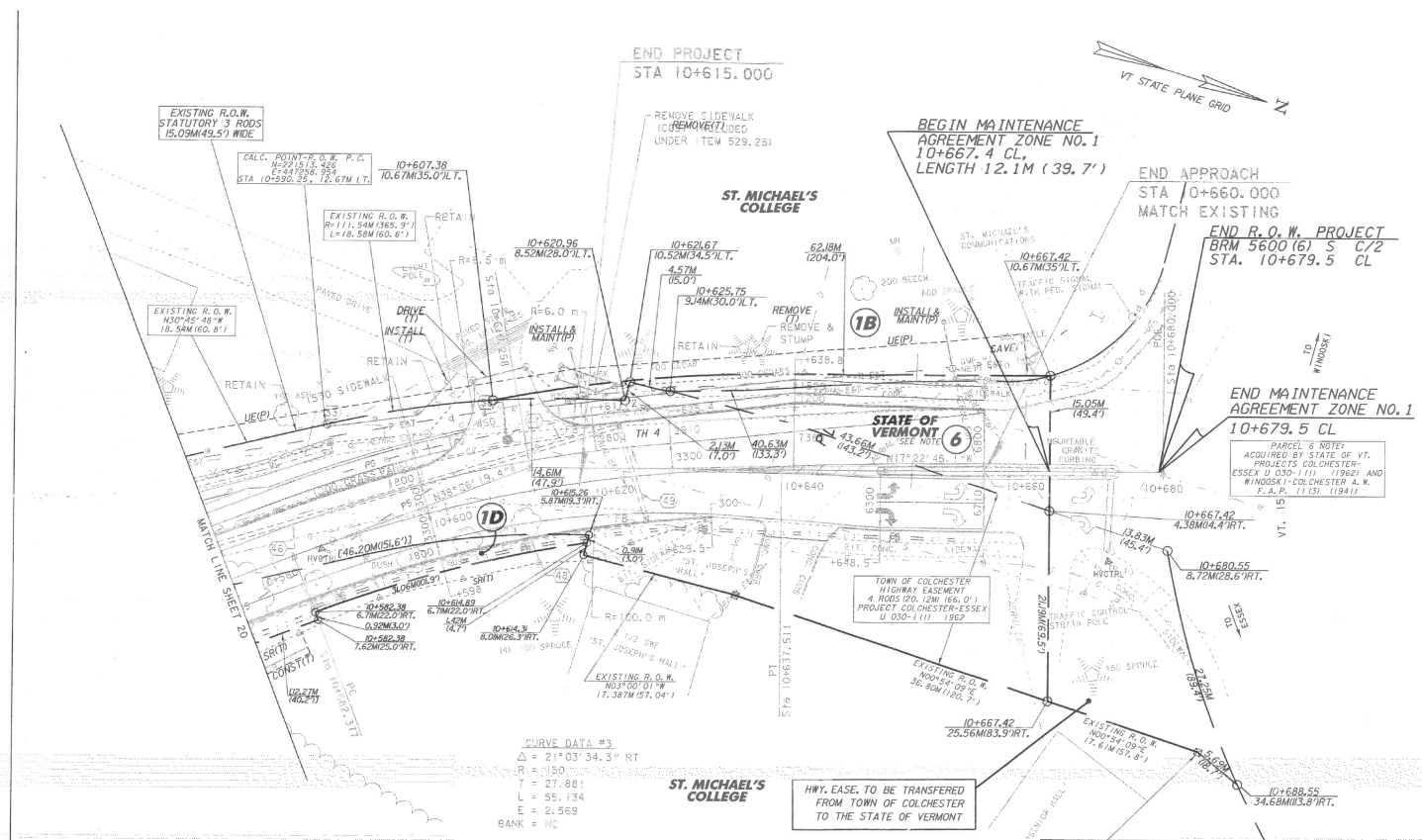

- LEGEND: UT - EXISTING UNDERGROUND TELEPHONE LINE, W - EXISTING UNDERGROUND WATER LINE, G - EXISTING UNDERGROUND GAS LINE, S - EXISTING UNDERGROUND SEWER LINE, AERIAL E&T - EXISTING OVERHEAD ELECTRIC & TELEPHONE LINE, FM - EXISTING FORCED MAIN SEWER LINE, SD - EXISTING STORM DRAIN, HYD - HYDRANT, VALVE, MANHOLE, MAILBOX, SIGNS, UTILITY POLE GUY WIRE, GAS SHUTOFF, LIGHT POLE, P E&T - PROPOSED OVERHEAD ELECTRIC & TELEPHONE BY OTHERS, PS - PROPOSED SEWER LINE, PG - PROPOSED GAS LINE BY OTHERS, PW - PROPOSED WATER LINE BY OTHERS, PB - PROPOSED PULL BOX BY OTHERS, FB - PROPOSED FLUSHING BASIN, TOP OF CUT TO MATCH EXISTING, TOE OF SLOPE TO MATCH EXISTING

- SIGN LEGEND: N = NEW, R = REMOVE, B-B = BACK-TO-BACK, RET = RETAIN, R & S = REMOVE AND RESET, R & N = REMOVE AND NEW, RETURN TO CITY OF SO. BURLINGTON

Lines shown on this plan as existing property lines P/L are believed to be accurate but should not be relied upon for purposes unrelated to the town of Colchester's acquisition of land and rights for this project.

SEE DRAINAGE AND SEWER NOTES & DETAILS ON SHEETS 13 & 14 (R.O.W. SHEETS 5 & 6)

VANASSE HANGEN BRUSTLIN, INC.

DATUM: VERTICAL NAVD 88, HORIZONTAL NAD 83 (92)