

INDEX OF SHEETS

STATE OF VERMONT  
AGENCY OF TRANSPORTATION

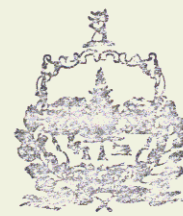

R.O.W. PLANS

PROPOSED IMPROVEMENT

TOWN OF BRIDGEWATER  
COUNTY OF WINDSOR

ROUTE NO. US 4 BRIDGE NO. 44

PROJECT LOCATION: BEGINNING AT A POINT ON US4 APPROXIMATELY 1 MILE NW OF JUNCTION US 4 AND 100A AND EXTENDING EASTERLY 0.0545 MILE.  
PROJECT DESCRIPTION: REPLACEMENT OF DECK, APPROACH SLABS, CURBS, SUBSTANDARD RAILS AND REMOVAL OF PYLONS WITH MINIMUM ROADWAY APPROACH WORK.

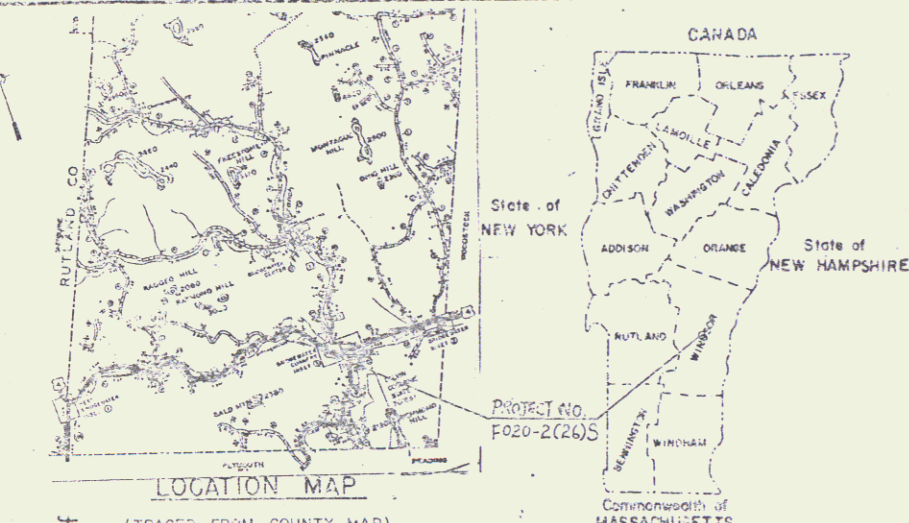

GENERAL NOTES

1) MAINTAIN TWO-WAY TRAFFIC ON THE TEMPORARY BRIDGE.

STRESS LEVELS	LOAD RATING (TONS)							
	H	HS	SS	SAKLE	SA-STR	SA-STR	SA-STR	SA-STR
UNWEIGHTED	32.2	38.6						
POSTER	47.8	57.4	73.5		52.3	53.0	64.2	
OVERALL		70.0	73.5	108.6				

LENGTH OF STRUCTURE: 138.00 FEET  
LENGTH OF PARTICIPATION ROADWAY: 150.00 FEET  
LENGTH OF NON-PARTICIPATION ROADWAY: 0.00 FEET  
LENGTH OF PROJECT: 288.00 FEET  
LENGTH OF R.O.W. PROJECT: 193.00 FEET

2-RAIL GALVANIZED BOX BEAM BRIDGE RAILING

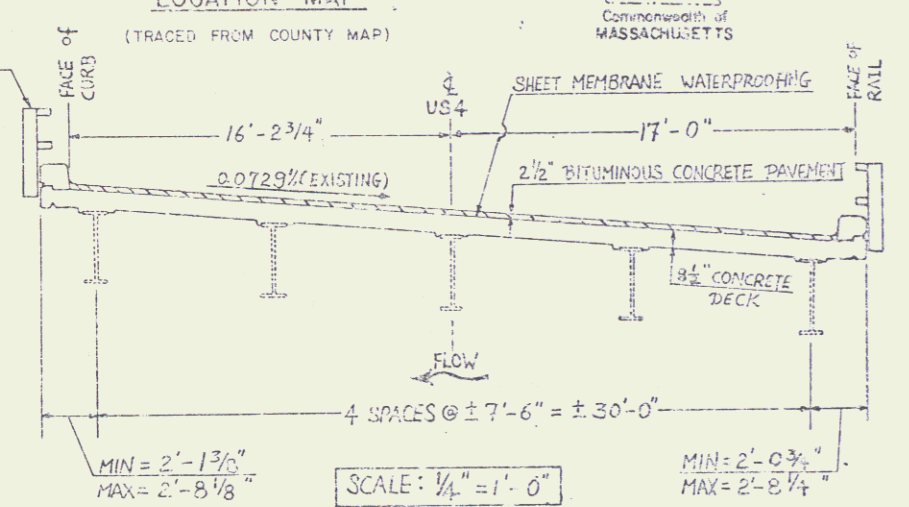

ROW PLANS

BEGIN R.O.W. PROJECT  
F 020-2(26) STA. 341+32.60' LT.

END R.O.W. PROJECT  
F 020-2(26) STA. 343+85.50' LT.

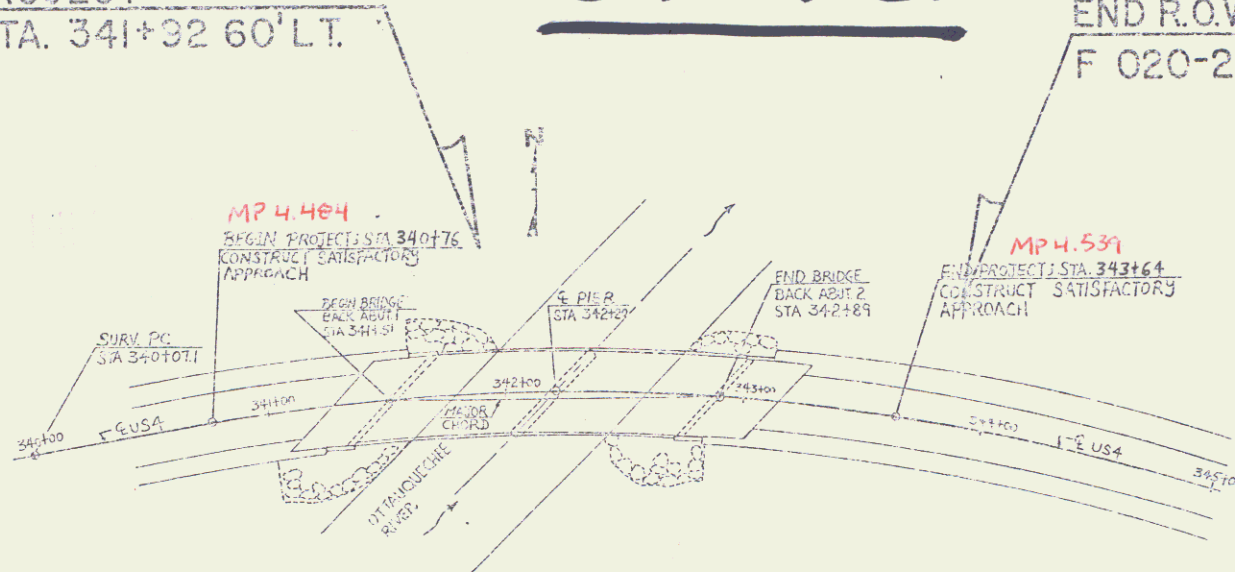

RIGHT-OF-WAY DIVISION  
TOWN FILE  
PERPETUAL  
TOWN OF BRIDGEWATER  
(To Be Returned To R.O.W. Division)

TYPICAL ROADWAY SECTION

CONVENTIONAL SIGNS

- COUNTY LINE
- TOWN LINE
- LIMITS OF ACCESS
- POINT OF ACCESS
- FENCE LINE
- STONE WALL
- TRAVELED WAY
- GUARD RAIL
- RAILROAD
- SURVEY LINE
- CULVERT
- POWER POLE
- TELEPHONE POLE
- TREES
- CONTROL OF ACCESS
- PROPERTY LINE
- R.O.W. TAKING LINE
- SLOPE RIGHTS
- TOP OF CUT
- TOE OF SLOPE

DATUM	VERTICAL	N/A
	HORIZONTAL	N/A

SCALE: 1" = 40'-0"

THESE PLANS ARE SUBJECT TO SUCH ENGINEERING CHANGES AS MAY BE REQUIRED BY THE FEDERAL HIGHWAY ADMINISTRATION OR THE CHIEF ENGINEER. CONSTRUCTION IS TO BE CARRIED ON IN ACCORDANCE WITH THESE PLANS AND THE STANDARD SPECIFICATIONS FOR CONSTRUCTION DATED 1986, FOR USE ON THESE PROJECTS, INCLUDING ALL SUBSEQUENT PROVISIONS AS ARE INCORPORATED IN THESE PLANS.

Pin# 87B501

APPROVED: *[Signature]* DATE: 9/18/90  
Dir., Dept. of Planning & Preconstruction

APPROVED: *[Signature]* DATE: 9/5/90  
Chief, Property Administration

BRIDGEWATER  
Project No. F 020-2(26)3  
R.O.W. SHEET 1 OF 4

JAN 06 1993

EXISTING CURVE DATA (CHORD DEFINITION)

$\Delta = 56^{\circ}-44'-00''$  RT.  
 $D = 6^{\circ}-00'-00''$   
 $R = 955.4'$   
 $T = 515.9'$   
 $L = 945.6'$   
 $E = 130.4'$   
 BANKING = 0.0729%

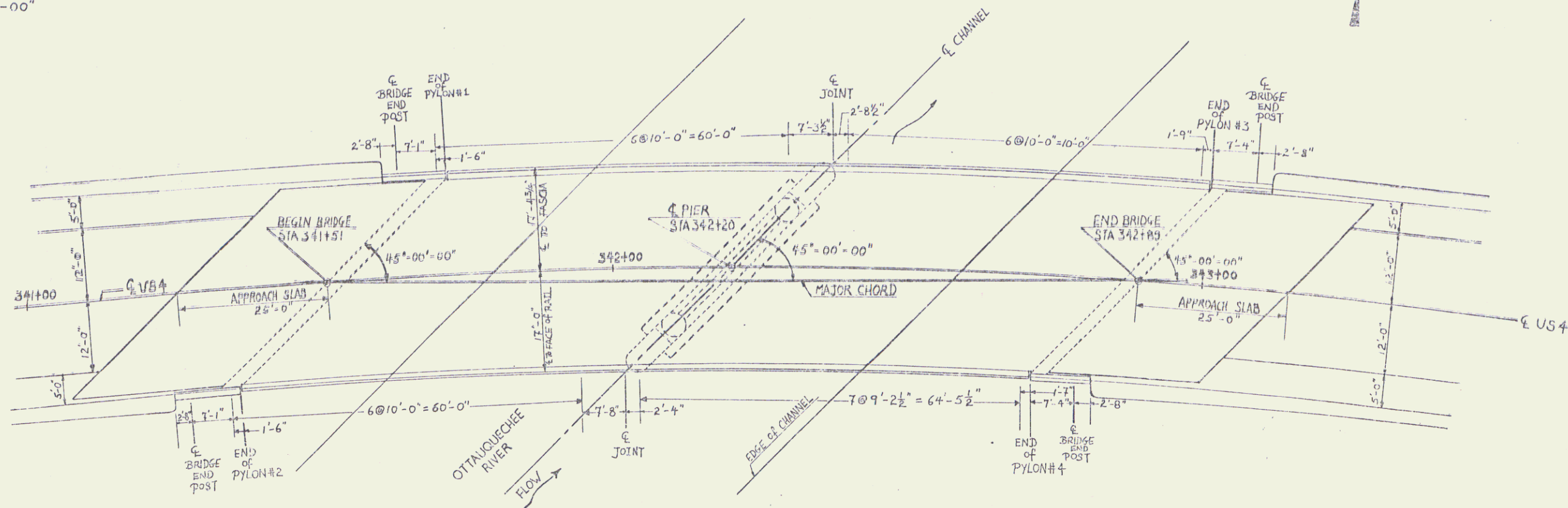

PLAN

1" = 10'-0"

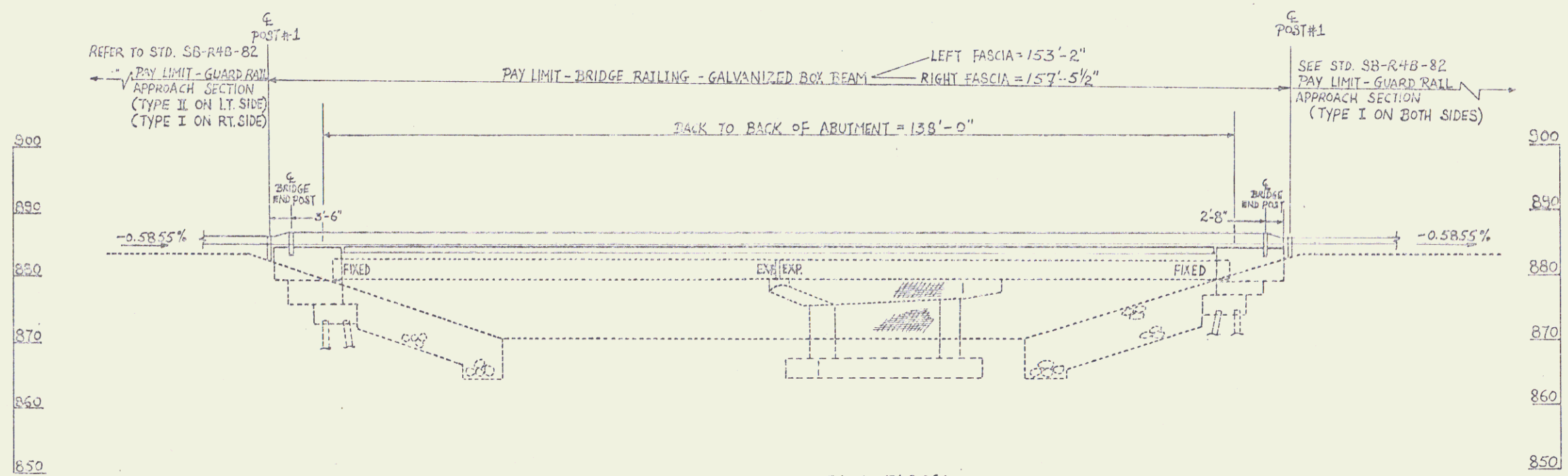

ELEVATION VIEW ALONG UPSTREAM FASCIA

1" = 10'-0"

<b>STATE OF VERMONT</b>	
<b>AGENCY OF TRANSPORTATION</b>	
Town of BRIDGEWATER	Bridge No. 47
Highway No. US 4	Log Sta. ---
PLAN & ELEVATION VIEWS	
Designed By T. SOO	Drawn By T. SOO
BRIDGEWATER	
F 020-2(2)S	
R.O.W. SHEET 2 OF 4	

JAN 06 1993

2

TABLE OF PROJECT PROPERTY ACQUISITION

STATE OF VERMONT  
AGENCY OF TRANSPORTATION  
RIGHT OF WAY PLANS  
DETAIL SHEET

PARCEL NO.	GRANTOR	SHEET NO.	BEGINNING STATION	ENDING STATION	TAKING	REM.	RIGHTS	TITLE TAKEN	DATE	TOWN OR CITY RECORDED	BK.	PG.	REMARKS	REVISION NO.	SHEET	DESCRIPTION OF REVISION	DATE	MADE BY	APPROVED BY	
1	RAYMOND, WINSTON & HAZEL	4	341+92 LT.	342+75 LT.			EASE. (T) 0.01A±	AGREE.					TEMPORARY BRIDGE DETOUR 555 S.F.±	1	3,4	PARCEL NO. 2 ROGERS. CHANGE NAME TO ROGERS, ERLENE A. PER C.O. 7974.  <i>MyLARS to Structures 1-15-91</i>	9-14-90	C.C.P.	F. J. M.	
2	ROGERS, ERLENE A.	4	342+70 LT.	343+85 LT.			EASE. (T) 0.03A±	AGREE.					TEMPORARY BRIDGE DETOUR 1340 S.F.±	2	4	PARCEL NO. 1 RAYMOND. ADD DRIVE NOTATION REGARDING DRIVE AT 341+27 LT. 342+00LT PER C.O. 8008.	01-17-91	M. J. R.	F. J. M.	
3	CONTINENTAL TELEPHONE CO.												UTILITY							
4	CENTRAL VERMONT PUBLIC SERVICE CORP.												UTILITY							

ACCT. RYAN  
ZFH70J087850D.DGN  
PREP  
DATE PLOTTED 4-SEP-1990

DR. (T)- DRAINAGE RIGHT  
DIT. (T)- DITCHING RIGHT  
CH. (T)- CHANNEL RT.  
DRIVE (T)- DRIVE RIGHT  
CUL. (T)- CULVERT RIGHT  
[W]- WATER SOURCES

PRESENT R.O.W.  
TAKING WITHOUT ACCESS  
TAKING WITHOUT ACCESS ALONG PROPERTY LINE  
TAKING WITH ACCESS  
PERMANENT EASEMENT  
TEMPORARY EASEMENT

LEGEND

CONST. (T) ---  
SR --- SR  
P ---  
TOP OF CUT  
TOE OF SLOPE

CONSTRUCTION EASEMENT  
SLOPE RIGHTS  
PROPERTY LINE  
TOP OF CUT  
TOE OF SLOPE

APPROVED: *Lawrence B. L.* DATE: 9/15/90  
AGENT D. PLANS & TITLES

R. O. W. PLANS

BRIDGEWATER  
F 020-2(26) S  
SHEET 3 OF 4

JAN 06 1993 3

**NOTE:** ACCESS TO ALL DRIVES SHALL BE MAINTAINED DURING CONSTRUCTION OF THIS PROJECT.

ANY PORTION OF THE DRIVE (STA. 341+27+LT. - STA. 342+00+LT.) DISTURBED BY CONSTRUCTION OF THIS PROJECT WILL BE REGRADED AND MODIFIED TO PREVENT PONDING OF WATER, INCLUDING THAT SECTION NEAR THE LILAC BUSH, AND INSURE THAT ITS CONDITION WILL BE NO WORSE THAN WHAT PRESENTLY EXISTS.

**BEGIN R.O.W. PROJECT**  
F 020-2(26) STA. 341+92 60' LT.

**END R.O.W. PROJECT**  
F 020-2(26) STA. 343+85 50' LT.

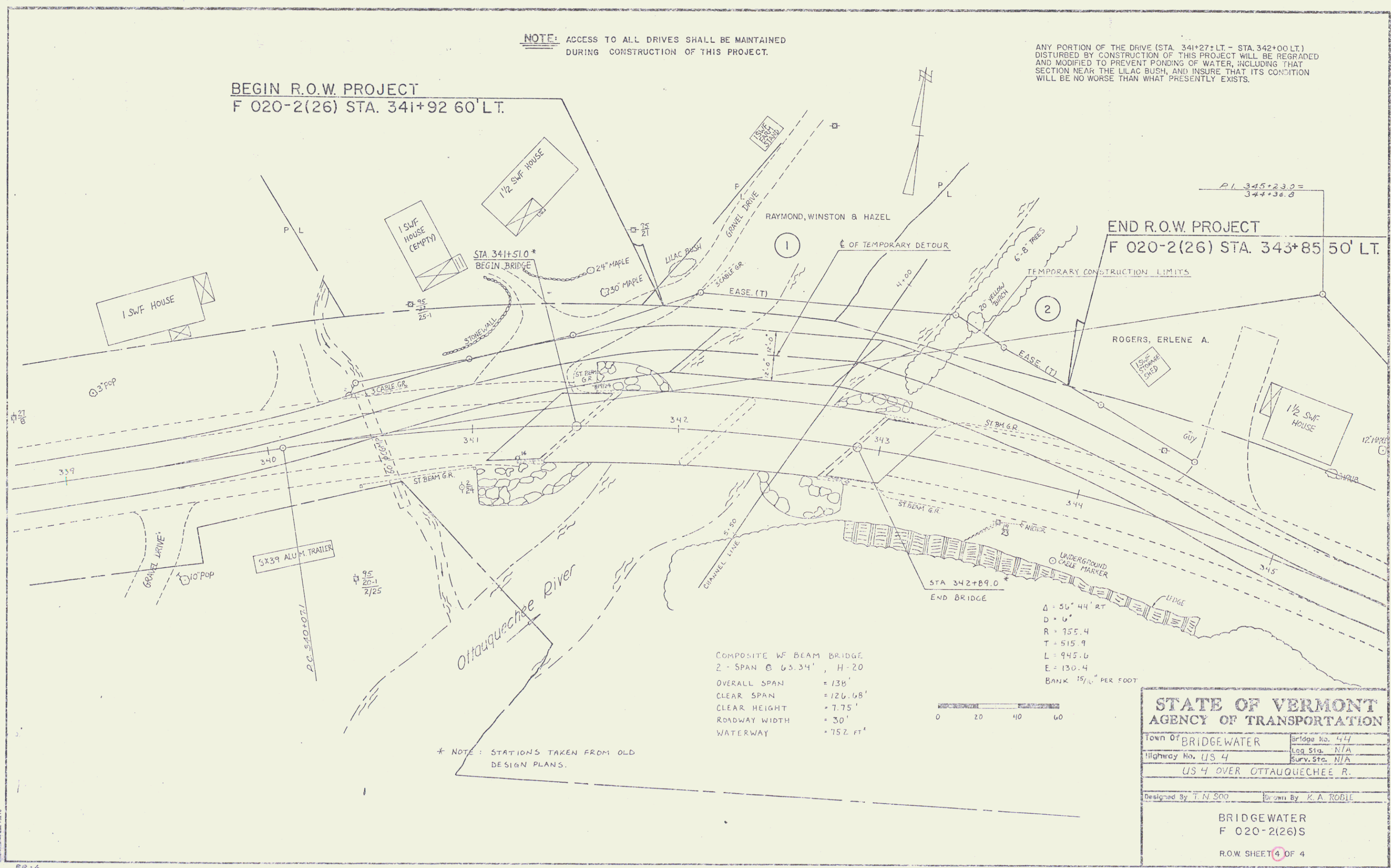

COMPOSITE WF BEAM BRIDGE  
2 - SPAN @ 63.34', H-20  
OVERALL SPAN = 138'  
CLEAR SPAN = 126.68'  
CLEAR HEIGHT = 7.75'  
ROADWAY WIDTH = 30'  
WATERWAY = 75.2 FT'

Δ = 56° 44' RT  
D = 6'  
R = 155.4  
T = 515.9  
L = 945.6  
E = 130.4  
BANK 1 1/2" PER FOOT

\* NOTE: STATIONS TAKEN FROM OLD DESIGN PLANS.

STATE OF VERMONT AGENCY OF TRANSPORTATION	
Town Of BRIDGEWATER	Bridge No. 44
Highway No. US 4	Log Sta. N/A
	Surv. Sta. N/A
US 4 OVER OTTAUQUECHEE R.	
Designed by T. N. SOO	Drawn by K. A. ROBLE
BRIDGEWATER F 020-2(26)S R.O.W. SHEET 4 OF 4	

JAN 0 6 1993

4