

INDEX OF SHEETS  
SEE SHEET # 2

STATE OF VERMONT  
AGENCY OF TRANSPORTATION



PROPOSED IMPROVEMENT

**TOWN OF MARSHFIELD**  
COUNTY OF WASHINGTON  
**U.S. ROUTE 2 - F.A.P.**

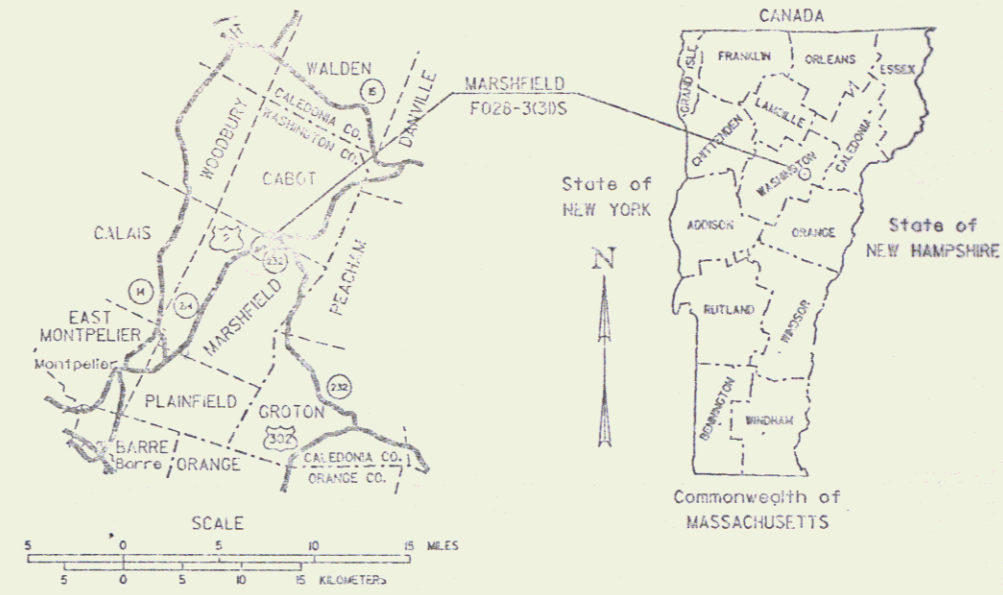

R.O.W. PLANS

BEGINNING AT A POINT APPROXIMATELY 7.333 MILES EASTERLY OF THE PLAINFIELD - MARSHFIELD TOWN LINE AND EXTENDING EASTERLY ALONG U.S. ROUTE 2 FOR A DISTANCE OF 3685.44 FEET .

LENGTH OF ROADWAY 3685.44 FEET= 0.698 MILES  
LENGTH OF PROJECT 3685.44 FEET= 0.698 MILES  
LENGTH OF R.O.W. PROJECT 898.00 FEET= 0.170 MILES

WORK TO BE PERFORMED UNDER THIS PROJECT INCLUDES RESURFACING OF AN EXISTING HIGHWAY, WITH A LEVELING COURSE TO CORRECT SUPERELEVATION DEFICIENCIES AND A 1 1/4" BITUMINOUS CONCRETE OVERLAY, APPLYING NEW PAVEMENT MARKINGS AND REHABILITATION TO GUARD RAIL AND SIGNS.

BEGIN R.O.W. PROJECT  
F 028-3(31)S 80+79 34' LT.

END R.O.W. PROJECT  
F 028-3(31)S STA. 89+77 43' RT.

CONVENTIONAL SIGNS	
COUNTY LINE	---
TOWN LINE	---
LIMITS OF ACCESS	---
POINT OF ACCESS	X
FENCE LINE	---
STONE WALL	---
TRAVEL WAY	---
RAILROAD	---
SURVEY LINE	---
CULVERT	---
POWER POLE	○
TELEPHONE POLE	○
TREES	⊗
CONTROL OF ACCESS	---
PROPERTY LINE	---
FLYING BUTTRESS	---
SLOPE GRADES	---
TOP OF CUT	---
TOE OF SLOPE	---

DATUM	
VERTICAL	USGS 1929
HORIZONTAL	N/A

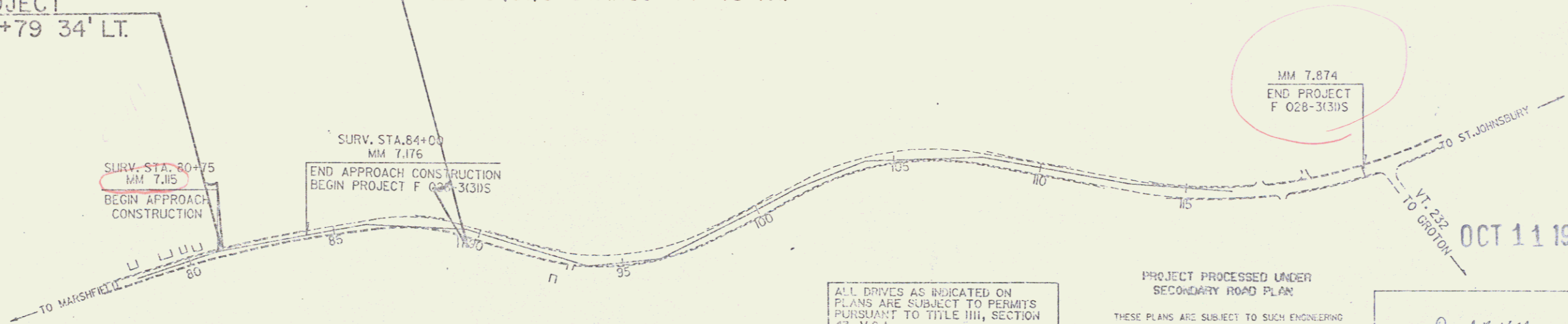

ALL DRIVES AS INDICATED ON PLANS ARE SUBJECT TO PERMITS PURSUANT TO TITLE III, SECTION 43, V.S.A.

0 200 400  
SCALE IN FEET

PROJECT PROCESSED UNDER  
SECONDARY ROAD PLAN

THESE PLANS ARE SUBJECT TO SUCH ENGINEERING CHANGES AS MAY BE REQUIRED BY THE FEDERAL HIGHWAY ADMINISTRATION OR THE CHIEF ENGINEER. CONSTRUCTION IS TO BE CARRIED ON IN ACCORDANCE WITH THESE PLANS AND THE STANDARD SPECIFICATIONS FOR CONSTRUCTION DATED 1985 AS APPROVED BY THE FEDERAL HIGHWAY ADMINISTRATION ON NOVEMBER 21, 1985 FOR USE ON THIS PROJECT, INCLUDING ALL SUBSEQUENT REVISIONS AND SUCH REVISED SPECIFICATIONS AND SPECIAL PROVISIONS AS ARE INCORPORATED IN THESE PLANS.

APPROVED: *David H. Kelly* DATE: 9/29/88  
Dir., Dept. of Engineering and Construction

APPROVED: *James A. ...* DATE: 10/3/88  
Chief, Property Administration

**MARSHFIELD**  
Project NO F 028-3(31)S  
R.O.W. SHEET 1 OF 11

Pin # 87B200

OCT 11 1989

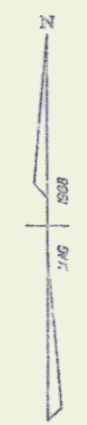

TABLE OF PROJECT PROPERTY ACQUISITION

STATE OF VERMONT  
 AGENCY OF TRANSPORTATION  
 RIGHT OF WAY PLANS  
 DETAIL SHEET

PARCEL NO.	GRANTOR	SHEET NO.	BEGINNING STATION	ENDING STATION	TAKING	REM.	RIGHTS	TITLE TAKEN	DATE	TOWN OR CITY RECORDED	BK.	PG.	REMARKS	REVISION NO.	SHEET	DESCRIPTION OF REVISION	DATE	MADE BY	APPROVED BY
1	LASHOONES, RICHARD H. & DIANNE C.	4, 5	80+79 LT. 80+86 LT. 81+28 LT. 82+16 LT. 84+06 LT. 84+86 LT. 87+78 LT.	88+86 LT. 88+56 LT.  84+00 LT. 88+77 LT.			CONST. EASE. (T) 0.18A± SLOPE (P) 0.15A± DRIVE (T) CUL., DIT. & DR. (P) CUL., DIT. & DR. (P)	WDOE	5-09-89	MARSHFIELD	39	342-4	12' GRAVEL MM 0713  BARBED WIRE FENCE BARBED WIRE FENCE			<i>Years to Design 3-7-87</i>			
2	ROBERTS, RUTH S.	6	89+37 RT. 89+44 RT. 89+44 RT. 89+45 RT.	89+72 RT. 89+77 RT. 89+63 RT.			DRIVE (T) SLOPE (P) 0.01A± CONST. EASE. (T) 0.01A± INSTALL & MAINT. (P)	WDOE	05-28-89	MARSHFIELD	39	281-92	17' GRAVEL MM 0730 165 S.F. ± 230 S.F. ± GUARDRAIL						
3	CONTINENTAL TELEPHONE COMPANY												UTILITY						
4	GREEN MOUNTAIN POWER CORPORATION												UTILITY						

OCT 11 1989

DR. RT.- DRAINAGE RIGHT  
 DIT. RT.- DITCHING RIGHT  
 CH. RT.- CHANNEL RT.  
 DRIVE RT.- DRIVE RIGHT  
 CUL. RT.- CULVERT RIGHT  
 (D)- DEMOLITION OR REMOVAL  
 (W)- WATER SOURCES

PRESENT R.O.W.  
 TAKING WITHOUT ACCESS  
 TAKING WITHOUT ACCESS ALONG PROPERTY LINE  
 TAKING WITH ACCESS  
 PERMANENT EASEMENT  
 TEMPORARY EASEMENT

LEGEND  
 CONST. EASE. ————  
 SR ———— SR  
 P ————  
 L ————  
 △ ———— △  
 ○ ———— ○

CONSTRUCTION EASEMENT  
 SLOPE RIGHTS  
 PROPERTY LINE  
 TOP OF CUT  
 TOE OF SLOPE

APPROVED: \_\_\_\_\_ DATE: 9-29-88  
 AGENT D. PLANS & TITLES

R. O. W. PLANS  
 MARSHFIELD  
 F 028-3(31)S  
 SHEET 3 OF 11

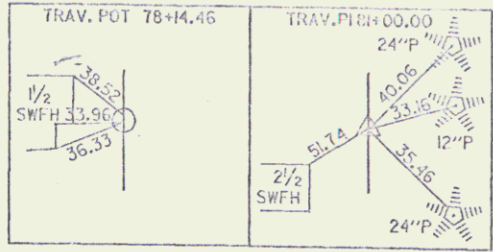

STEEL BEAM GUARD RAIL  
81+75 ~ 83+00 LT  
CONSTRUCT DRIVE  
81+28 LT.

BEGIN R.O.W. PROJECT  
F 028-3(31)S STA. 80+79 LT.

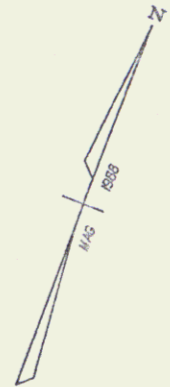
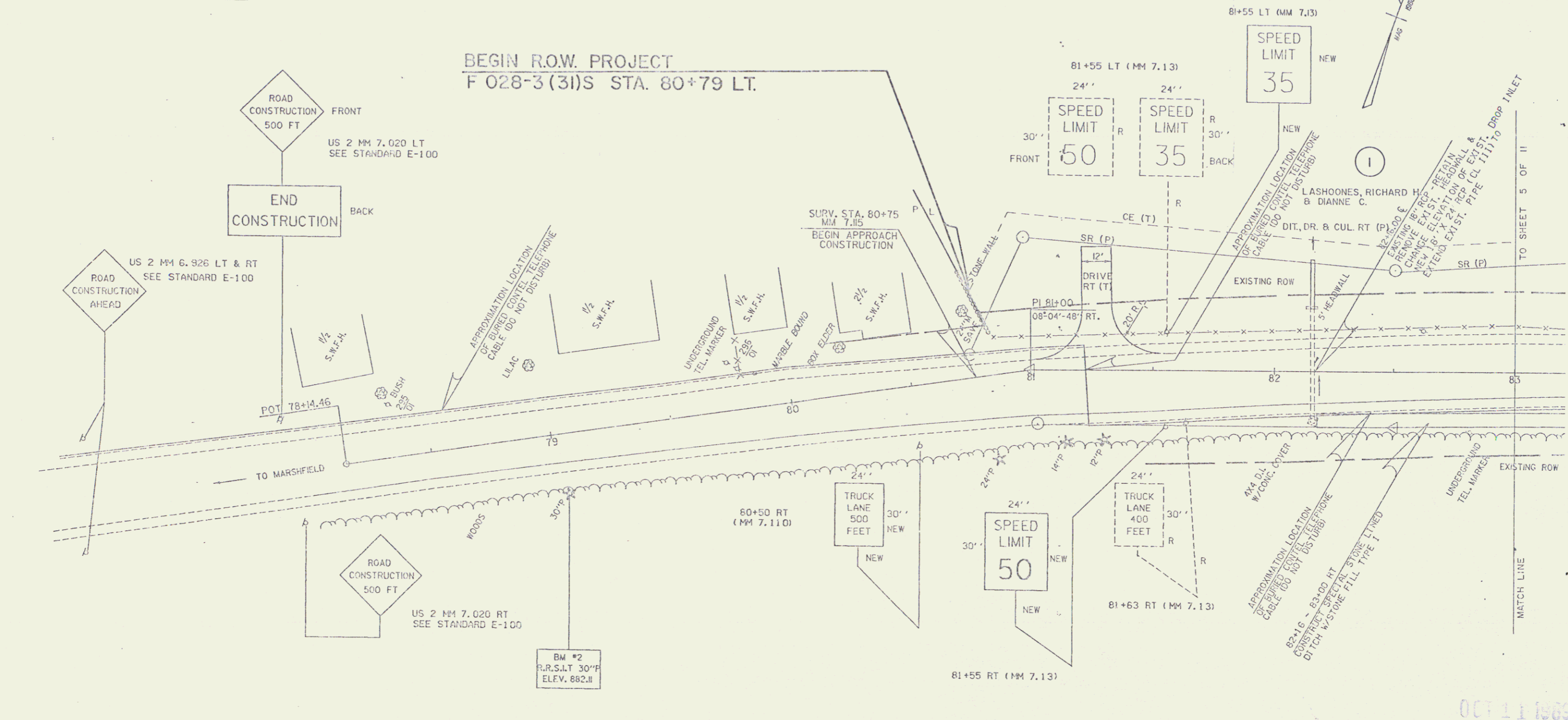

OCT 11 1989

DATUM	
VERTICAL	USGS 1628
HORIZONTAL	N/A

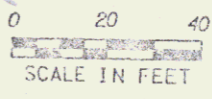

SURVEYED BY	MOREAU	DATE	01/88
DRAWN BY	MELNER	DATE	01/83
SQUAD LEADER	BOYD		
DESIGN FILE NO.	878202	DATE	09/12/85
		PLOTTED	
	MARSHFIELD		
	F028-3(3)S		
	4	OF 11	SHEETS

3

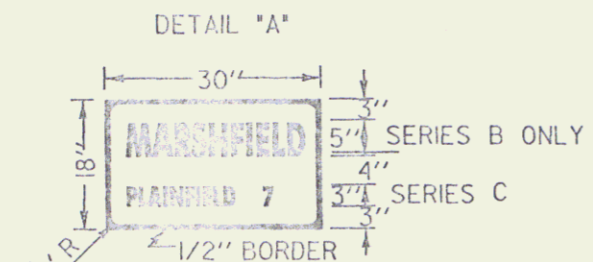
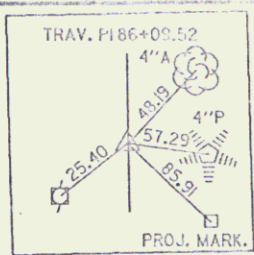

STEEL BEAM GUARD RAIL  
83+00 ~ 89+00 LT

REMOVAL AND DISPOSAL  
OF GUARD RAIL  
84+00 ~ 87+80 LT  
89+75 ~ 89+00 LT

NOTE: FOR MATERIAL REQUIREMENTS  
SEE STD. E-141

COLOR: GREEN RELF. (ENG. GRADE) BACKGROUND  
WHITE RELF. TEXT

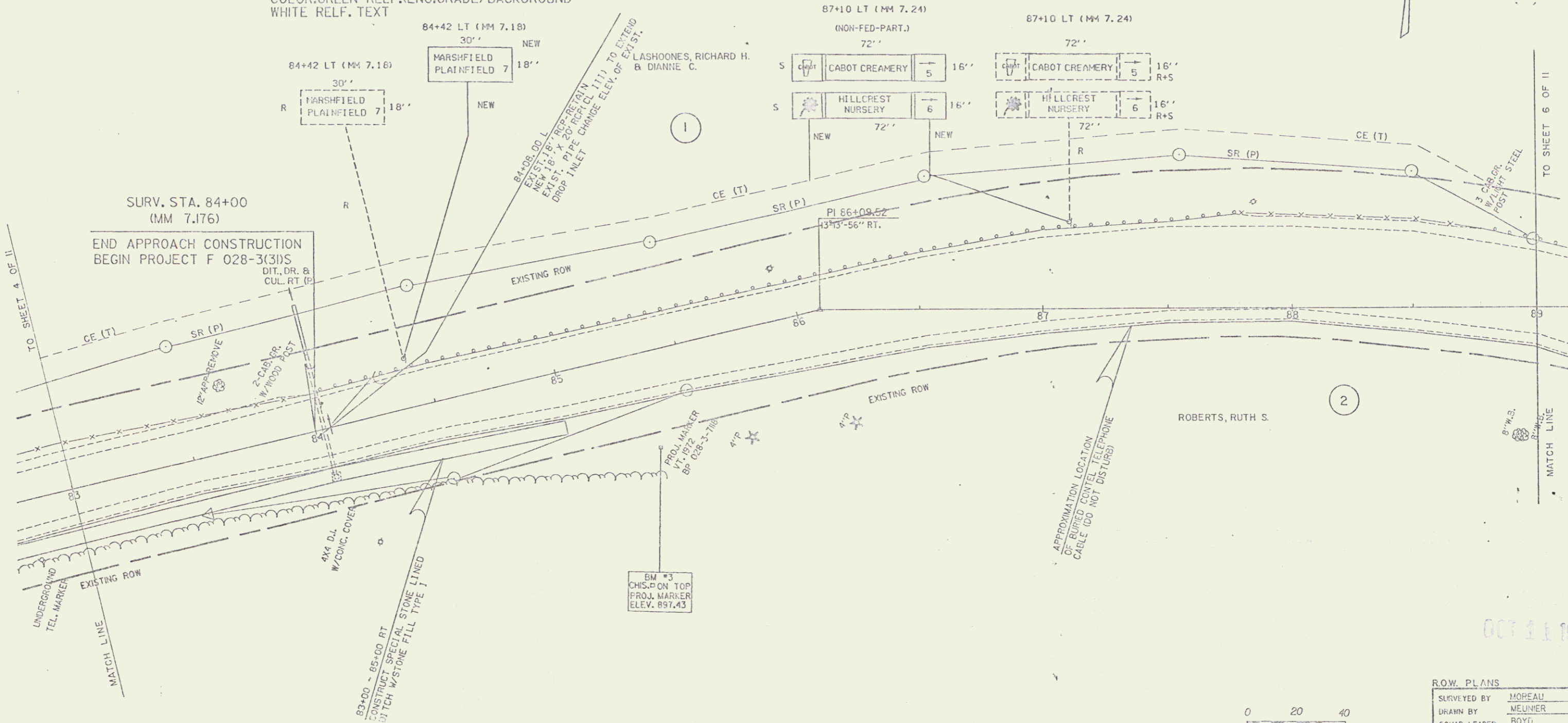

DATUM	
VERTICAL	USGS 1928
HORIZONTAL	N/A

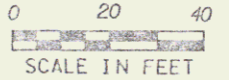

ROW PLANS	
SURVEYED BY	MOBEAU DATE 01/88
DRAWN BY	MEUNIER DATE 04/88
SOIAD LEADER	BOYD
DESIGN FILE NO.	878202 DATE 09/15/88 PLOTTED
MARSHFIELD F028-3(3)S	
5 OF 11 SHEETS	

OCT 11 1989

4

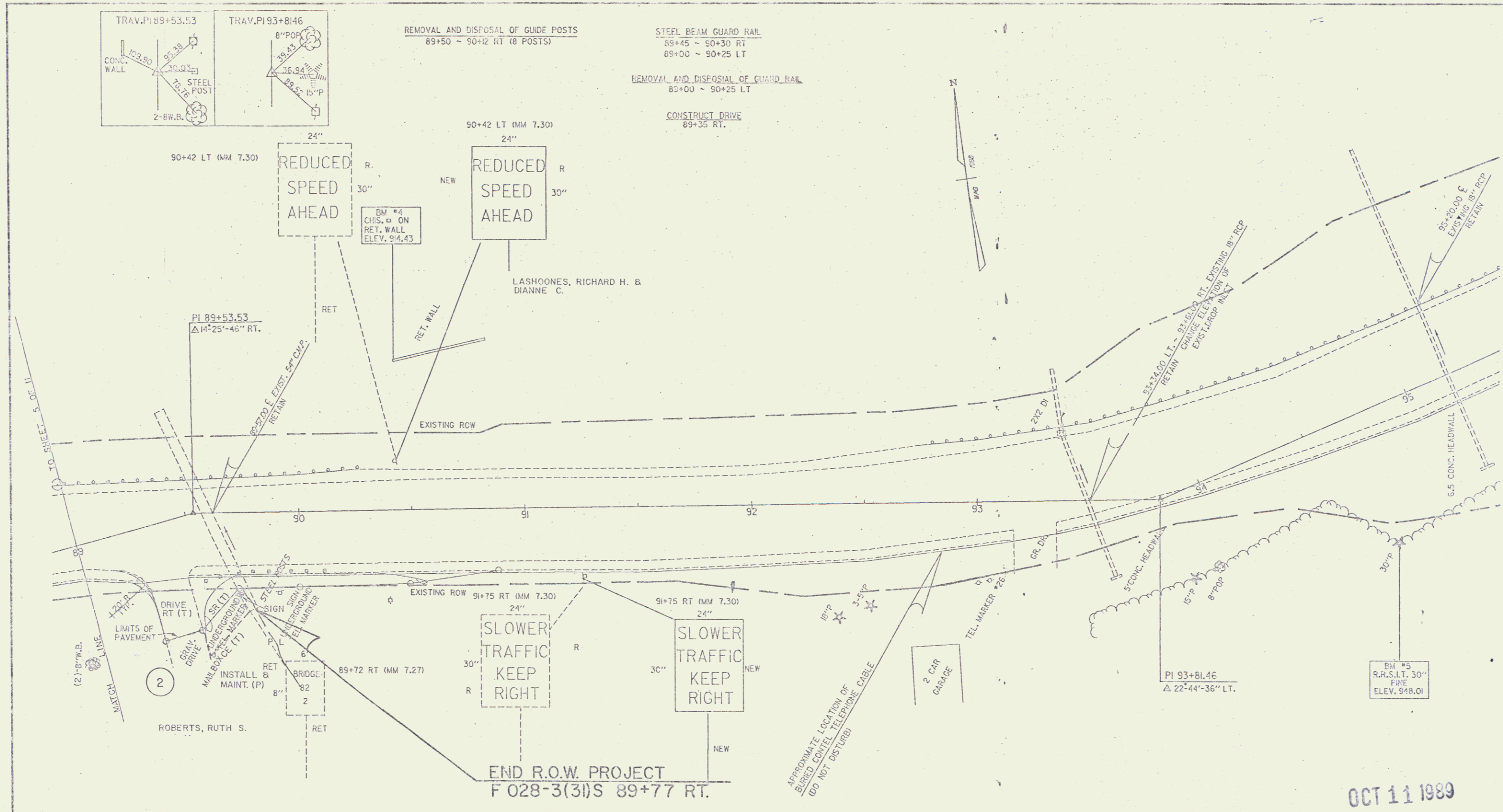

DATUM  
 VERTICAL USGS 1923  
 HORIZONTAL N/A

0 20 40  
 SCALE IN FEET

OCT 11 1989

ROW PLANS			
SURVEYED BY	MOREAU	DATE	02/88
DRAWN BY	MEURER	DATE	02/88
FOCAL LEADER	BOYD		
DESIGN FILE NO.	878202	DATE	09/15/88
	MARSHFIELD	PLOTTED	
	F028-3(3)S		
	OF 11	SHEET 5	

5

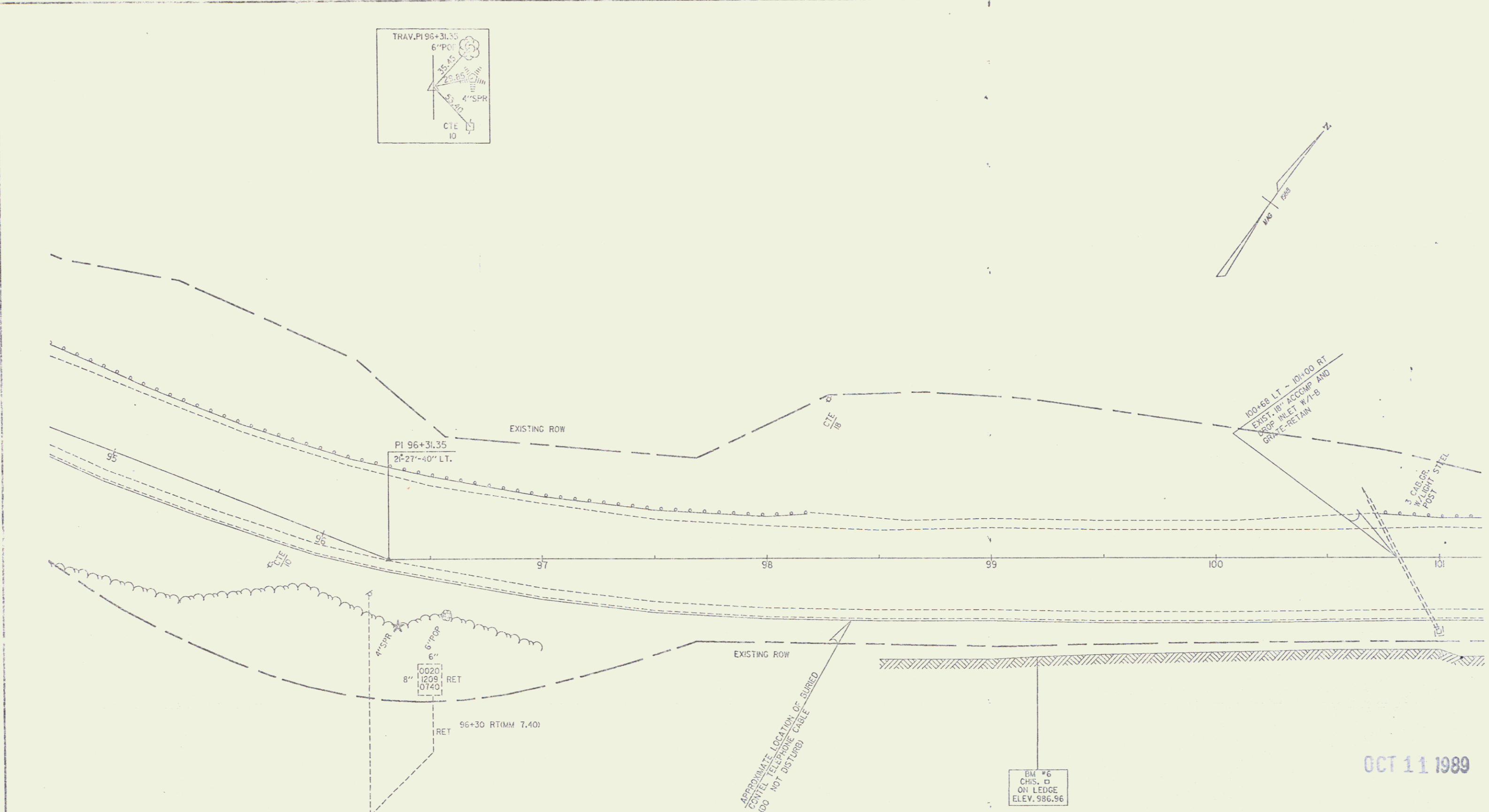
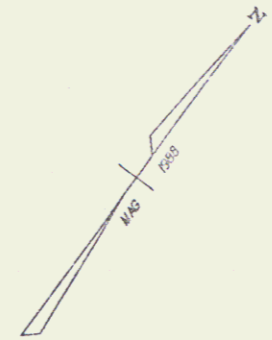
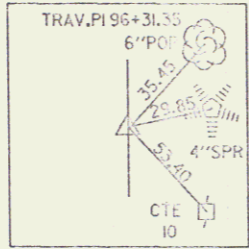

DATUM  
 VERTICAL UEGS 1/28  
 HORIZONTAL N/A

0 20 40  
 SCALE IN FEET

OCT 11 1989

ROW PLANS		#78202L4
SURVEYED BY	MOREAU	DATE 01/88
DRAWN BY	MEUNER	DATE 04/88
SOLID LEADER	BOYD	
DESIGN FILE NO.	87B202	DATE 09/15/88
		PLOTTED
	MARSHFIELD	
	FO28-3(3)S	
SHEET	7	OF 11 SHEETS

6

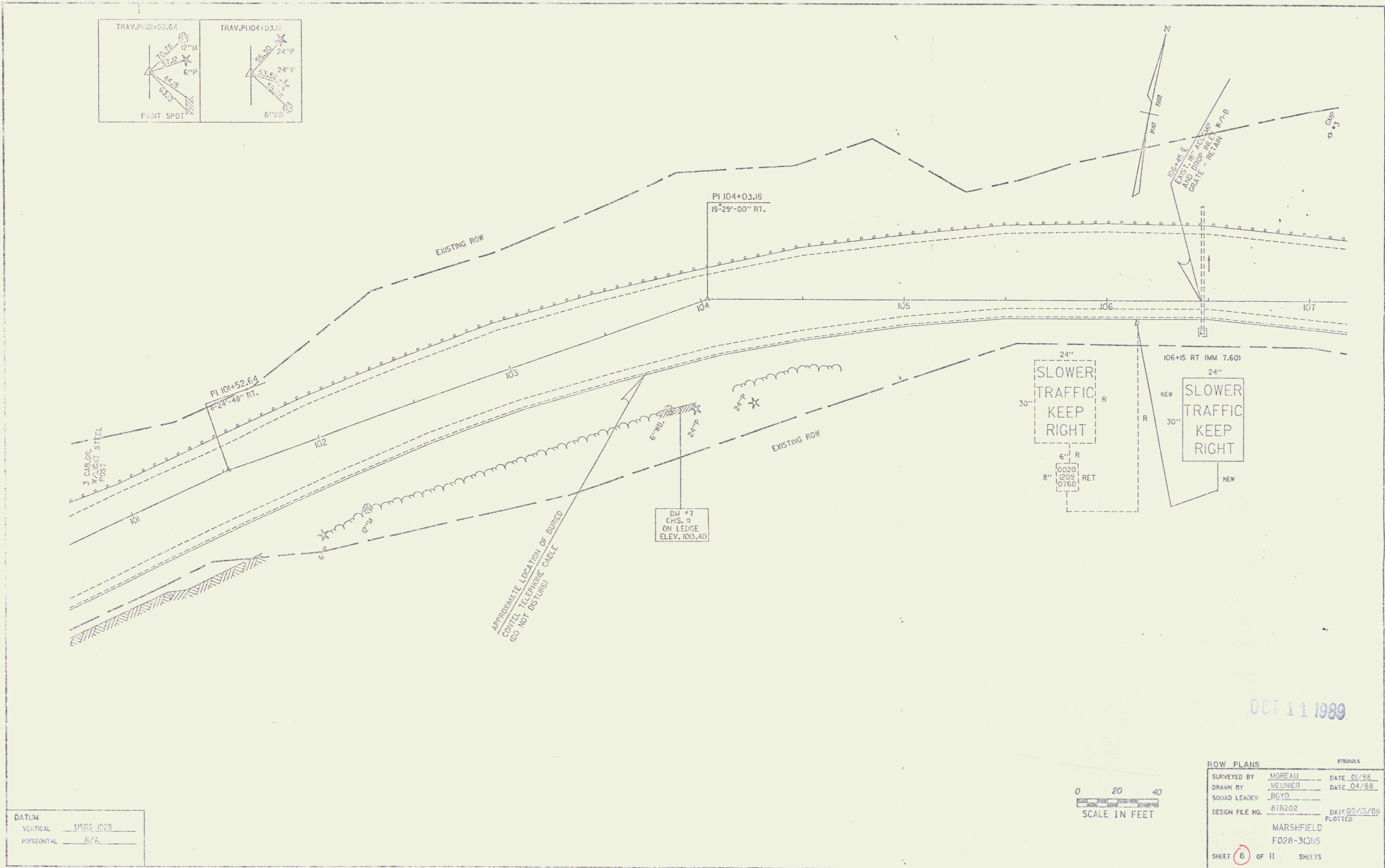
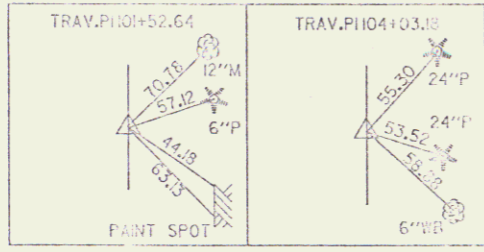

OCT 11 1989

DATUM  
 VERTICAL USGS 1928  
 HORIZONTAL N/A

0 20 40  
 SCALE IN FEET

ROW PLANS		878202LS
SURVEYED BY	MOREAU	DATE 01/88
DRAWN BY	MEUNIER	DATE 04/88
SQUAD LEADER	BOYD	
DESIGN FILE NO.	878202	DATE 02/15/88
		PLOTTED
	MARSHFIELD	
	F028-310HS	
SHEET	8	OF 11 SHEETS

7

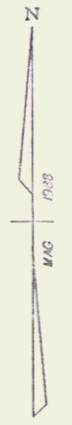
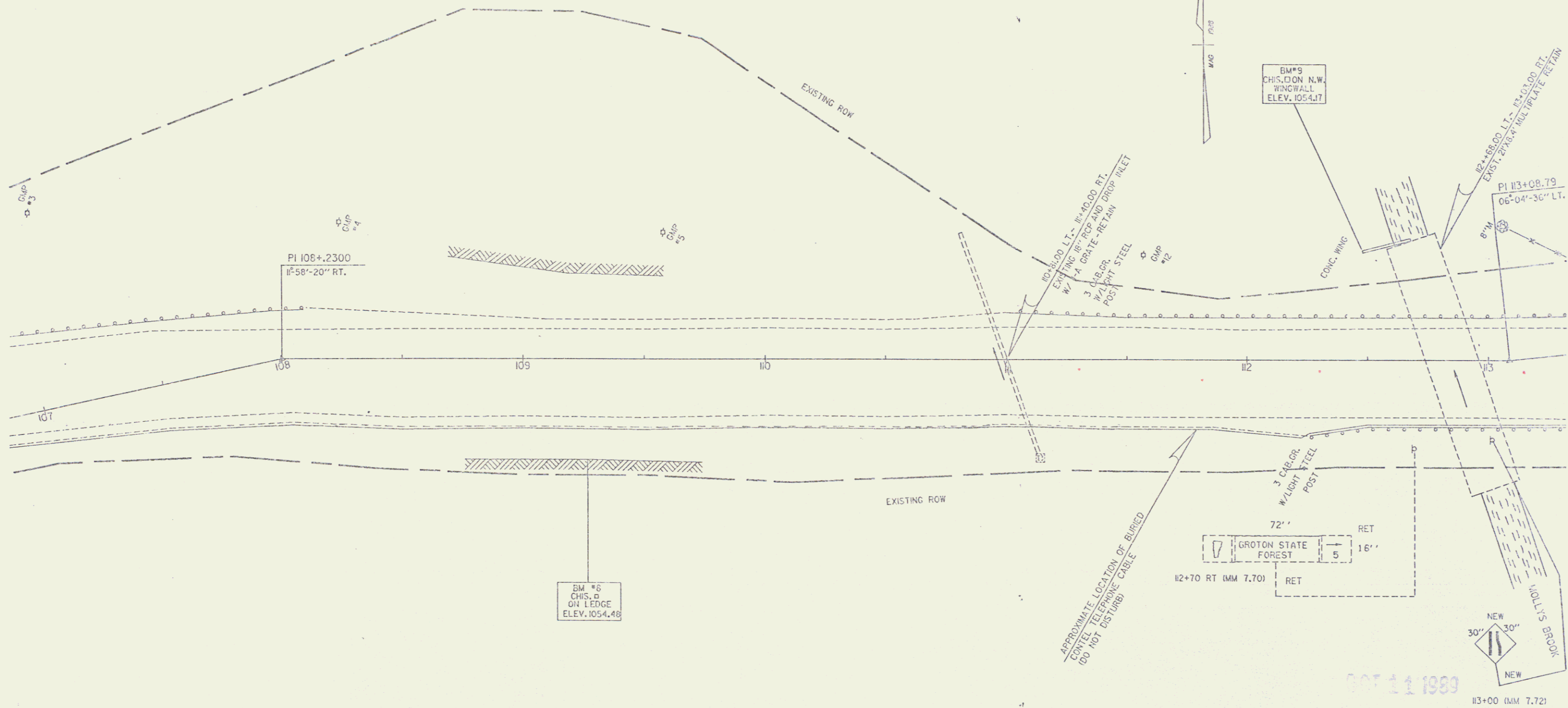
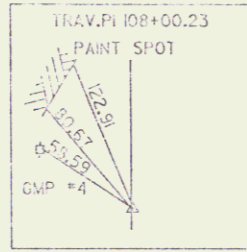

BM\*9  
CHIS. ON N.W.  
CORNER  
ELEV. 1054.17

PI 113+08.79  
06'-04"-30" LT.

BM\*5  
CHIS. ON  
LEDGE  
ELEV. 1054.48

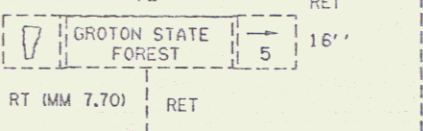

APPROXIMATE LOCATION OF BURIED  
CABLE TELEPHONE CABLE  
DO NOT DISTURB

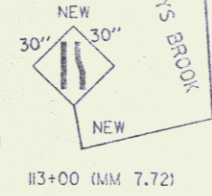

SEP 11 1988

DATUM  
VERTICAL USGS 1928  
HORIZONTAL N/A

0 20 40  
SCALE IN FEET

ROW PLANS			
SURVEYED BY	MOREAU	DATE	01/88
DRAWN BY	MELINIER	DATE	04/88
SQUAD LEADER	BOYD		
DESIGN FILE NO.	876202	DATE PLOTTED	09/11/88
MARSHFIELD F028-3431S			
SHEET 9		OF 11 SHEETS	

8

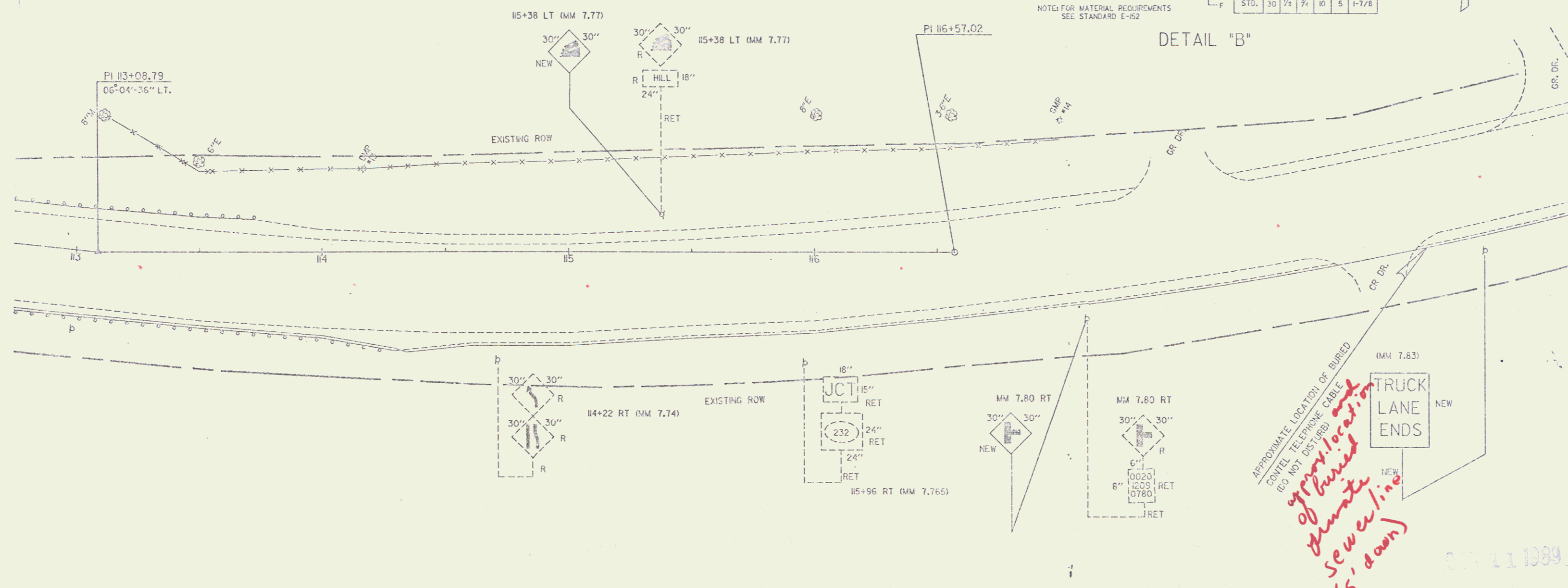
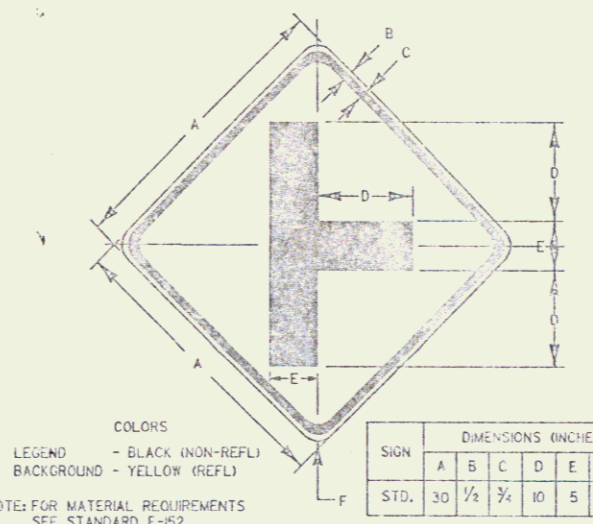
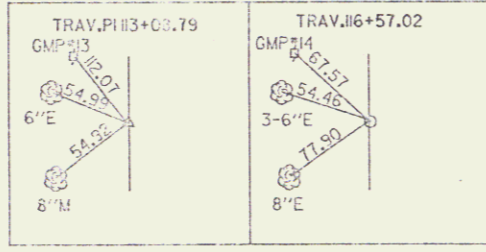

*APPROXIMATE LOCATION OF BURIED CONTROL TELEPHONE CABLE (DO NOT DISTURB)*  
*approx. location of buried sewer line (5' down)*

DATUM  
 VERTICAL 1:55 1928  
 HORIZONTAL N/A

0 20 40  
 SCALE IN FEET

ROW PLANS  
 SURVEYED BY MOREAU DATE 02/88  
 DRAWN BY MEINER DATE 04/88  
 SQUAD LEADER BOYD  
 DESIGN FILE NO. 875202 DATE 09/05/88  
 MARCHFIELD  
 F028-3131S  
 SHEET 10 OF 11 SHEETS

SEP 11 1989

9

0787

MM 7.874  
END PROJECT  
F 028-31395

ROAD  
CONSTRUCTION  
500 FT

US 2 MM 7.969 LT  
SEE STANDARD E-100

ROAD  
CONSTRUCTION  
AHEAD

US 2 MM 6.063 LT & RT  
SEE STANDARD E-100

END  
CONSTRUCTION

FRONT

ROAD  
CONSTRUCTION  
500 FT

BACK

US 2 MM 7.969 RT  
SEE STANDARD E-100

ROAD  
CONSTRUCTION  
AHEAD

SEE STANDARD E-100  
(500' FROM US 2 ~ VT 232 INTERSECTION)

END  
CONSTRUCTION

500' FROM US-2 ~ VT 232  
INTERSECTION  
SEE STANDARD E-100

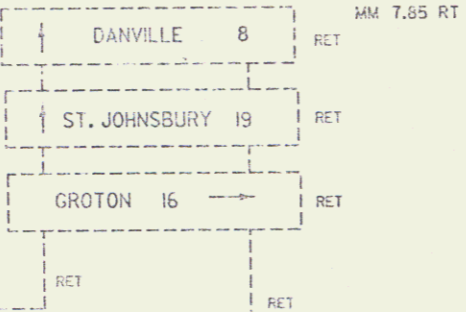

APPROXIMATE LOCATION OF  
BURIED CABLES (CABLES NOT DISTURBED)

USGS B21  
N/A

0 20 40  
SCALE IN FEET

ROW PLANS		
SURVEYED BY	MOREAU	DATE 01/88
DRAWN BY	WELNER	DATE 04/88
SQUAD LEADER	BOYD	
DESIGN FILE NO.	67B202	DATE 08/17/88
		PLOTTED
	MARSHFIELD	
	F028-3(3)S	
SHEET 11	OF 11	SHEETS

10

BEING PART OF THE SAME LAND ACQUIRED BY THE STATE OF VERMONT AS PART OF THE ORIGINAL U.S. RTE. 2 TAKEN INTO THE STATE HIGHWAY SYSTEM ON APRIL 1, 1931 BY ORDER OF THE STATE HIGHWAY BOARD.

STATE OF VERMONT  
TO  
RICHARD H. & DIANNE C. LASHOONES

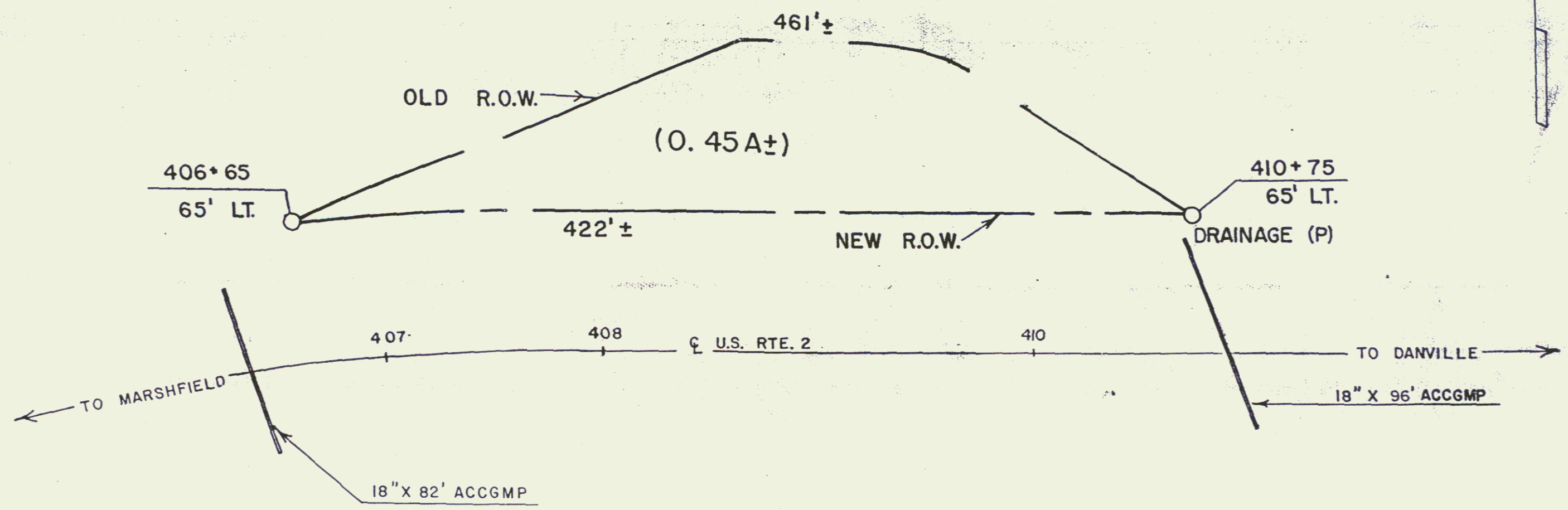

RF MARSHFIELD BP-028-3-7116  
SH. 13 OF 56

STATE OF VERMONT  
AGENCY OF TRANSPORTATION  
TOWN OF MARSHFIELD  
11A

