

STATE OF VERMONT
AGENCY OF TRANSPORTATION



PROPOSED IMPROVEMENT

PROJECT DESCRIPTION

TOWNS OF : MONTPELIER, WATERBURY, RICHMOND, WILLISTON,
SOUTH BURLINGTON, BURLINGTON, COLCHESTER AND
WESTMINSTER.

COURTIES OF : WASHINGTON, CHITTENDEN AND WINDHAM.

THE PROJECT CONSISTS OF THE INSTALLATION OF STREET LIGHTING
AT SEVERAL INTERCHANGES ON I-89 & I-91 AND THE UPGRADING OF EXISTING
STREET LIGHTING IN THE WILLISTON SOUTHBOUND REST AREA. I-89.

PROJECT LOCATIONS FOR CONTRACT

1. WESTMINSTER, INTERCHANGE # 5, I-91
2. MONTPELIER, INTERCHANGE # 8, I-89
3. WATERBURY, INTERCHANGE # 10, I-89
4. RICHMOND, INTERCHANGE # 11, I-89
5. WILLISTON, REST AREA S.B., I-89
6. WILLISTON, INTERCHANGE # 12, I-89
7. SO. BURLINGTON, INTERCHANGE # 13, I-89 & I-189
8. SO. BURLINGTON, INTERCHANGE # 14, I-89
9. COLCHESTER, INTERCHANGE # 17, I-89

R.O.W. PLANS

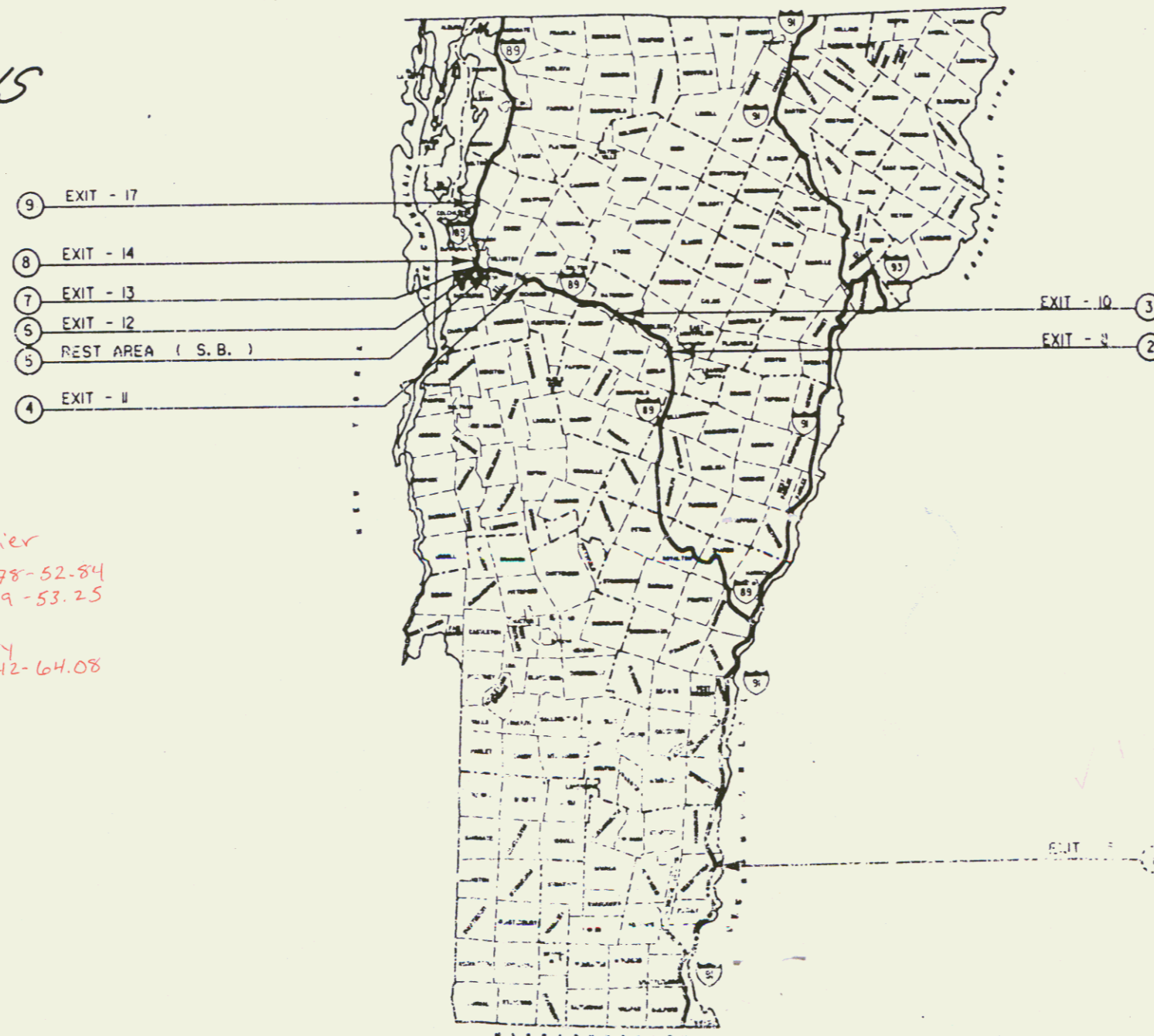

Montpelier
MP 52.78-52.84
MP 53.19-53.25

Waterbury
MP 63.42-64.08

Route I89

Pm # 87A083

9/6/1989.



AGENCY OF TRANSPORTATION
DESIGN DIVISION

OCT 28 1989

THESE PLANS ARE SUBJECT TO SUCH ENGINEERING
CHANGES AS MAY BE REQUIRED BY THE FEDERAL HIGHWAY
ADMINISTRATION OR THE SECRETARY OF TRANSPORTATION
CONSTRUCTION & TO BE CARRIED ON IN ACCORDANCE
WITH THESE PLANS AND THE STANDARD SPECIFICATIONS
FOR CONSTRUCTION DATED 1986, AS APPROVED BY THE
FEDERAL HIGHWAY ADMINISTRATION ON NOVEMBER 10, 1986
FOR USE IN THIS PROJECT, INCLUDING ALL SUBSEQUENT
REVISED AND SUCH REVISED SPECIFICATIONS AND
SPECIAL PROVISIONS AS ARE INCORPORATED IN THESE
PLANS.

APPROVED: *William J. ...* DATE: 9/6/89
Director of Planning

APPROVED: *...* DATE: 7/25/89
Chief, Property Administration

STATEWIDE
IR LITE (1)

R.O.W. SHEET 1 OF 4

STATE OF VERMONT
AGENCY OF TRANSPORTATION
RIGHT-OF-WAY PLANS
DETAIL SHEET

TABLE OF PROJECT PROPERTY ACQUISITION

| PARCEL NO. | GRANTOR | SHEET NO. | BEGINNING STATION | ENDING STATION | TAKING | REM | RIGHTS | TITLE TAKEN | DATE | TOWN OR CITY RECORDED | BK. | P.G. | REMARKS |
|------------|----------------------|-----------|------------------------|----------------|--------|-----|--|-------------|----------|-----------------------|-----|------|----------------------|
| 1 | CITY OF MONTPELIER | 3 | SB 229+58 LT | SB 230+42 LT | | | INSTALL-MAINT. & ACCESS RT. (P) DONATION AGREE | | | | | | POWER SUPPLY & LINES |
| 2 | VILLAGE OF WATERBURY | 4 | VT RTE. 100 7+10 RT | | | | INSTALL-MAINT. & ACCESS RT. (P) QCD | QCD | 12-30-89 | WATERBURY | 116 | 429 | POWER POLE & LINE |

TABLE OF REVISIONS

| REVISION NO. | SHEET NO. | DESCRIPTION OF REVISION | DATE | MADE BY | APPROVED BY |
|--------------|-----------|--|--------|---------|--------------------|
| 1 | 2,3 | PARCEL NO. 1 CITY OF MONTPELIER CHANGE ENDING STA. TO SB 230+42 LT. SUBSTITUTE NEW LAYOUT INTO PLANS. PER CO. 7875. <i>MyLARS to Design 5-8-90</i> <i>PLANS TO FHWA 12-16-91</i> | 2-8-90 | M.J.R. | <i>[Signature]</i> |

MADE BY: _____ DATE: _____
CHECKED BY: _____ DATE: _____

DR. RT. - DRAINAGE RIGHT
D.T. RT. - DITCHING RIGHT
CH. RT. - CHANNEL RIGHT
DRIVE RT. - DRIVE RIGHT
CL. RT. - CULVERT RIGHT
⊖ - DEMOLITION OR REMOVAL
[W] - WATER SURFACES

PRESENT R.O.W.
--- TAKING WITHOUT ACCESS
--- TAKING WITHOUT ACCESS ALONG PROPERTY LINES
--- TAKING WITH ACCESS
(P) PERMANENT EASEMENT
(T)

LEGEND
--- CONSL. EASE. --- CONST. EASEMENT
--- SR --- SLOPE RIGHTS
--- P --- PROPERTY LINE
--- Δ --- TOP OF CUT
--- ○ --- TOE OF SLOPE

APPROVED: _____ DATE: _____
CHIEF OF PLANS & TITLES

ROW PLANS

OCT 28 1994

PROJECT STATEWIDE
NO. IR LITE (I)
SHEET 2 OF 4

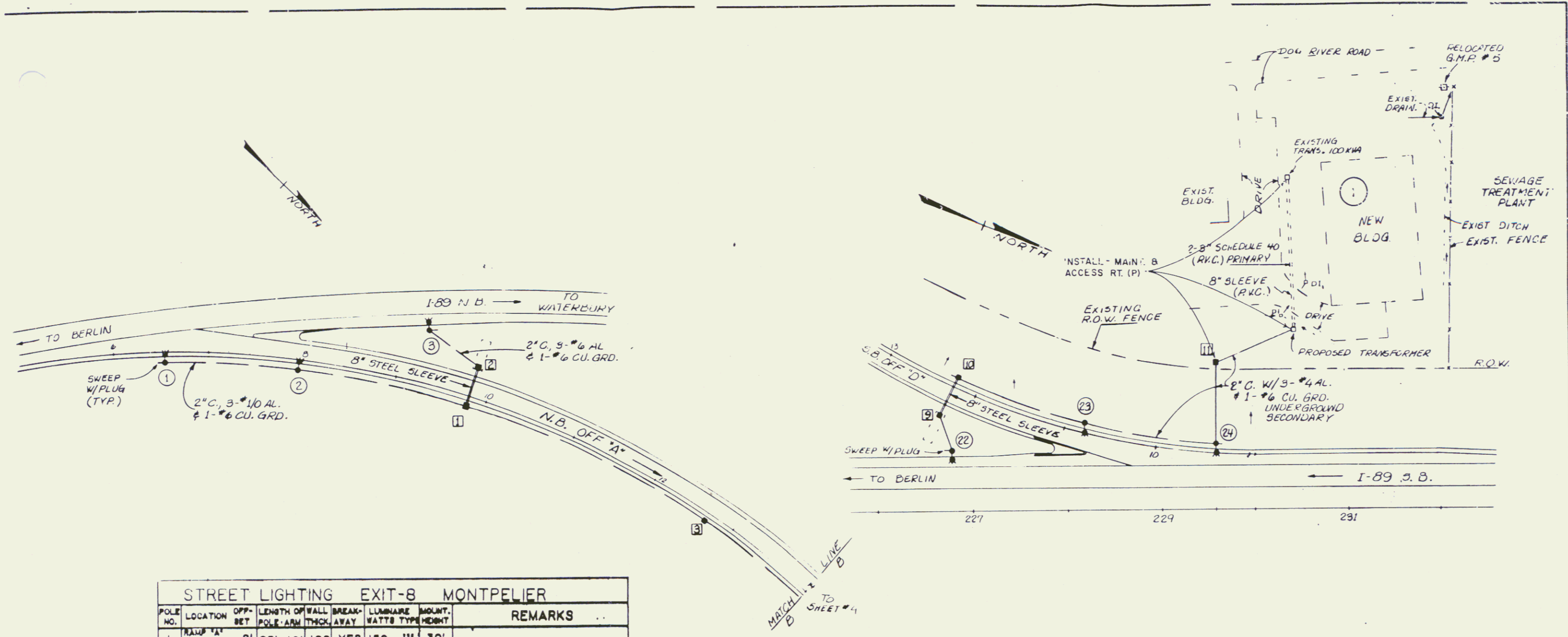

| STREET LIGHTING EXIT-8 MONTPELIER | | | | | | |
|-----------------------------------|--------------------------|-----------|----------------|--------------|-----------------------|---------|
| POLE NO. | LOCATION | OPP. BET. | LENGTH OF WALL | BREAK-WATT'S | LUMINAIRE MOUNT. TYPE | REMARKS |
| 1 | RAMP "A" 810 RT. | 8' | 28' 10" | .188 YES | 150 III 30' | |
| 2 | RAMP "A" 1150 RT. | 8' | 28' 10" | .188 YES | 150 III 30' | |
| 3 | RAMP "A" 1474 LT. | 58' | 28' 10" | .188 YES | 150 III 30' | |
| 22 | S.B. I-89 227+30 LT. 05' | 28' | 10' | .188 YES | 150 III 30' | |
| 23 | S.B. I-89 228+70 LT. 94' | 29' | 10' | .188 YES | 150 III 30' | |
| 24 | S.B. I-89 229+10 LT. 70' | 29' | 10' | .188 YES | 150 III 30' | |

- LEGEND**
- PROPOSED STREET LIGHT #NO (1)
 - PROPOSED PULL BOX #NO
 - PROPOSED SLEEVE
 - PROPOSED CONDUIT
 - PROPOSED TRANSFORMER
 - EXISTING UTILITY POLE

OCT 28 1994

0' 50' 100'

I-89, EXIT-8, MONTPELIER

| | |
|----------------------------------|---|
| STREET LIGHTING LAYOUT AND NOTES | PREPARED BY RPD DATE _____ |
| | CHECKED BY _____ DATE _____ |
| | DESIGN SUPERVISOR DAB DATE _____ |
| | PROJ. STATEWIDE I-R LITE (1) ROW SHEET 3 OF 4 |

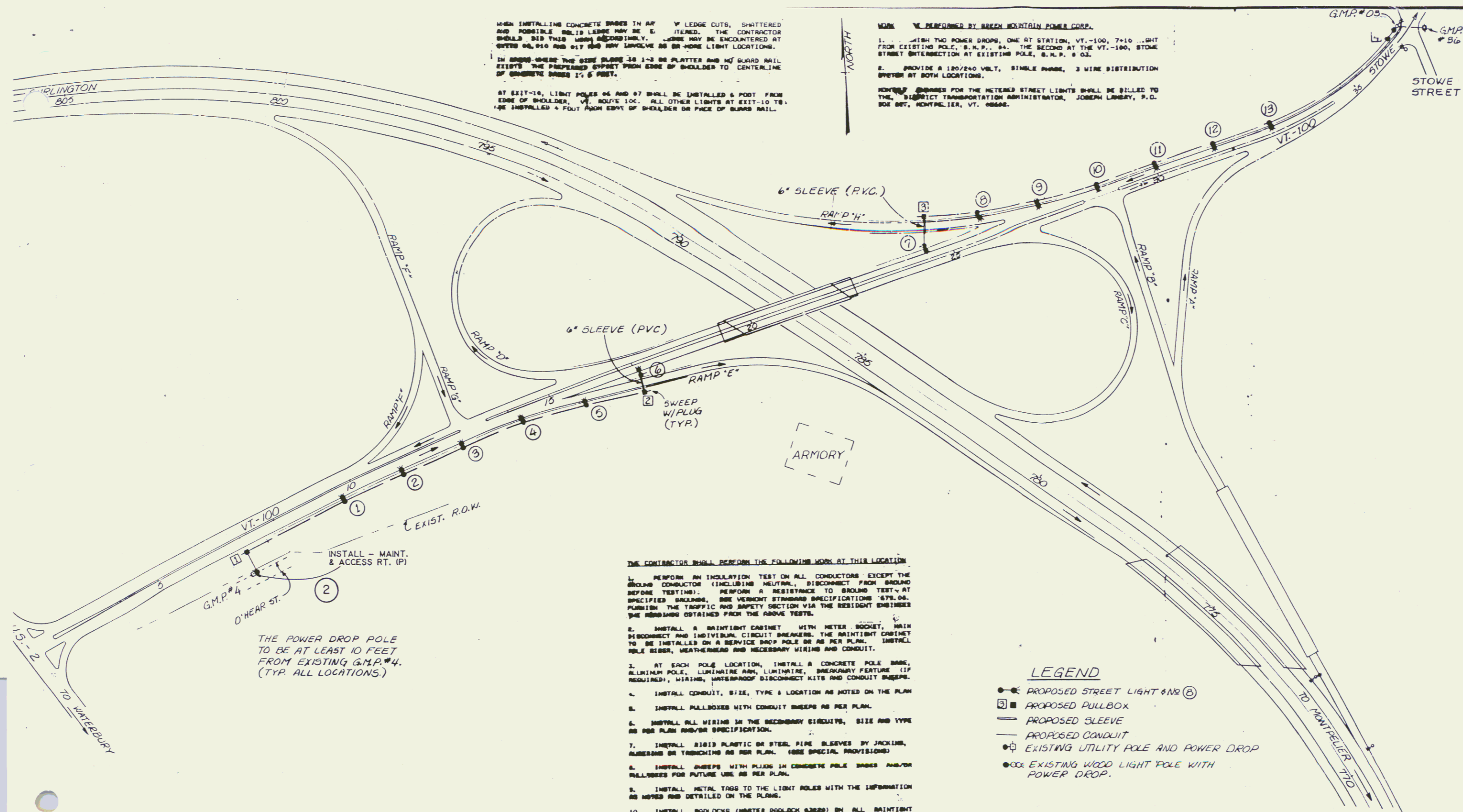

WHEN INSTALLING CONCRETE BASES IN ANY V LEDGE CUTS, SHATTERED AND POSSIBLE SOLID LEGS MAY BE ENCOUNTERED. THE CONTRACTOR SHOULD BID THIS WORK RESPONSIBLY. SOME MAY BE ENCOUNTERED AT STATIONS 80.910 AND 81.7 AND MAY INVOLVE AS SHOWN LIGHT LOCATIONS.

IN AREAS WHERE THE GISE SLABS 1-3 OR PLATTER AND NO CURB RAIL EXISTS THE PREPARED SWEEP FROM EDGE OF SHOULDER TO CENTERLINE OF CONCRETE BASES 1' & POST.

AT EXIT-10, LIGHT POLES 06 AND 07 SHALL BE INSTALLED 6 FOOT FROM EDGE OF SHOULDER, V.F. ROUTE 100. ALL OTHER LIGHTS AT EXIT-10 TO BE INSTALLED 4 FOOT FROM EDGE OF SHOULDER OR FACE OF BARRIAD RAIL.

WORK TO BE PERFORMED BY GREEN MOUNTAIN POWER CORP.

1. PROVIDE TWO POWER DROPS, ONE AT STATION, VT.-100, 7+10 LIGHT FROM EXISTING POLE, S.N.P. # 84. THE SECOND AT THE VT.-100, STONE STREET INTERSECTION AT EXISTING POLE, S.N.P. # 02.

2. PROVIDE A 120/240 VOLT, SINGLE PHASE, 3 WIRE DISTRIBUTION SYSTEM AT BOTH LOCATIONS.

NOTIFY CHARGES FOR THE METERED STREET LIGHTS SHALL BE BILLED TO THE DISTRICT TRANSPORTATION ADMINISTRATOR, JOSEPH LANSKY, P.O. BOX 807, MONTPELIER, VT. 05602.

- THE CONTRACTOR SHALL PERFORM THE FOLLOWING WORK AT THIS LOCATION:
- PERFORM AN INSULATION TEST ON ALL CONDUCTORS EXCEPT THE GROUND CONDUCTOR (INCLUDING NEUTRAL, DISCONNECT FROM GROUND BEFORE TESTING). PERFORM A RESISTANCE TO GROUND TEST AT SPECIFIED SPACINGS. SEE VERMONT STANDARD SPECIFICATIONS 679.08. FURNISH THE TRAFFIC AND SAFETY SECTION VIA THE RESIDENT ENGINEER THE READINGS OBTAINED FROM THE ABOVE TESTS.
 - INSTALL A MOUNTING CABINET WITH METER SOCKET, MAIN DISCONNECT AND INDIVIDUAL CIRCUIT BREAKERS. THE MOUNTING CABINET TO BE INSTALLED ON A SERVICE DROP POLE OR AS PER PLAN. INSTALL POLE SIZES, WEATHERHEAD AND NECESSARY WIRING AND CONDUIT.
 - AT EACH POLE LOCATION, INSTALL A CONCRETE POLE BASE, ALUMINUM POLE, LUMINAIRE ARM, LUMINAIRE, BREAKAWAY FEATURE (IF REQUIRED), WIRING, WATERPROOF DISCONNECT KITS AND CONDUIT SHEEPS.
 - INSTALL CONDUIT, SIZE, TYPE & LOCATION AS NOTED ON THE PLAN.
 - INSTALL PULLBOXES WITH CONDUIT SHEEPS AS PER PLAN.
 - INSTALL ALL WIRING IN THE SECONDARY CIRCUITS, SIZE AND TYPE AS PER PLAN AND/OR SPECIFICATION.
 - INSTALL 2" RIGID PLASTIC OR STEEL PIPE SLEEVES BY JACKING, ALIGNED ON TRENCHING AS PER PLAN. (SEE SPECIAL PROVISIONS)
 - INSTALL SHEEPS WITH PLUGS IN CONCRETE POLE BASES AND/OR PULLBOXES FOR FUTURE USE AS PER PLAN.
 - INSTALL METAL TAGS TO THE LIGHT POLES WITH THE INFORMATION AS NOTED AND DETAILED ON THE PLAN.
 - INSTALL PADLOCKS (MASTER PADLOCK 6388) ON ALL MOUNTING CABINETS. KEYS TO BE GIVEN TO THE DISTRICT TRANSPORTATION ADMINISTRATOR IN THE HIGHWAY DISTRICT WHERE PROJECT IS LOCATED.
- ALL THE ABOVE WORK WHICH IS NOT PAID FOR UNDER A SEPARATE ITEM NUMBER, SHALL BE PAID FOR UNDER ITEM 679.15 STREET LIGHTING.

- LEGEND**
- PROPOSED STREET LIGHT AND (C)
 - PROPOSED PULLBOX
 - PROPOSED SLEEVE
 - PROPOSED CONDUIT
 - ⊕ EXISTING UTILITY POLE AND POWER DROP
 - ⊙ EXISTING WOOD LIGHT POLE WITH POWER DROP.

THE POWER DROP POLE TO BE AT LEAST 10 FEET FROM EXISTING G.M.P.#4. (TYP. ALL LOCATIONS.)

STREET LIGHTING LAYOUT AND NOTES

OCT 28 1994

0' 100' 200'
SCALE IN FEET

I-89, EXIT-10, WATERBURY

PREPARED BY RRD DATE _____
CHECKED BY _____ DATE _____
DESIGN SUPERVISOR ds DATE _____

STATEWIDE IR LITE (I)
R.O.W. SHEET 4 OF 4