

Original Drawing - Ink on Polymer meeting the requirements of 27 V.S.A. § 1403

- CONSTRUCT 5' WIDE PAVED APRON
VT 14 STA 388+02.2 LT - VT 14 STA 388+43.1 LT
- RELOCATE MAILBOX, SINGLE SUPPORT
FROM DRIVE NO.3 STA 30+50.5 RT TO VT 14 STA 392+50.0 LT.
- BOX BEAM GUARDRAIL
VT 14 STA 388+00.0 RT - VT 14 STA 389+66.8 RT
VT 14 STA 388+57.9 LT - VT 14 STA 389+56.3 LT
VT 14 STA 391+63.1 LT - VT 14 STA 391+89.7 LT
VT 14 STA 391+73.7 RT - VT 14 STA 392+74.1 RT
- SPECIAL PROVISION (GUARDRAIL APPROACH SECTION TO CONCRETE COMBINATION BRIDGE RAILING)
VT 14 STA 389+56.3 LT - VT 14 STA 389+90.3 LT
VT 14 STA 389+66.8 RT - VT 14 STA 390+00.8 RT
VT 14 STA 391+29.2 LT - VT 14 STA 391+63.1 LT
VT 14 STA 391+39.7 RT - VT 14 STA 391+73.7 RT
- CONSTRUCT GRAVEL DRIVE (12' WIDE)
VT 14 STA 388+25.0 LT
DRIVE NO.3 STA 30+32.6 LT
- REMOVING AND RESETTING FENCE
VT 14 STA 390+78.7 LT - VT 14 STA 392+04.7 LT
VT 14 STA 390+89.7 LT - VT 14 STA 393+50.0 RT
VT 14 STA 391+48.7 RT - VT 14 STA 393+50.0 RT
VT 14 STA 393+44.9 LT - VT 14 STA 393+50.0 LT
- MANUFACTURED TERMINAL SECTION, TANGENT
VT 14 STA 388+00.0 LT - VT 14 STA 388+02.6 LT
VT 14 STA 388+44.0 LT - VT 14 STA 388+57.9 LT
VT 14 STA 391+89.7 LT - VT 14 STA 392+03.5 LT
VT 14 STA 391+74.1 RT - VT 14 STA 392+88.3 RT
- BRIDGE RAILING, GALVANIZED STEEL TUBING/CONCRETE COMBINATION
VT 14 STA 389+90.3 LT - VT 14 STA 391+29.2 LT
VT 14 STA 390+00.8 RT - VT 14 STA 391+39.7 RT
- CONSTRUCT PAVED DRIVE (10' WIDE)
VT 14 STA 392+31.5 LT
- SPECIAL PROVISION (REINFORCED SOIL SLOPE) W/ STONE FILL, TYPE II
VT 14 STA 388+00.0 RT - VT 14 STA 388+50.0 RT

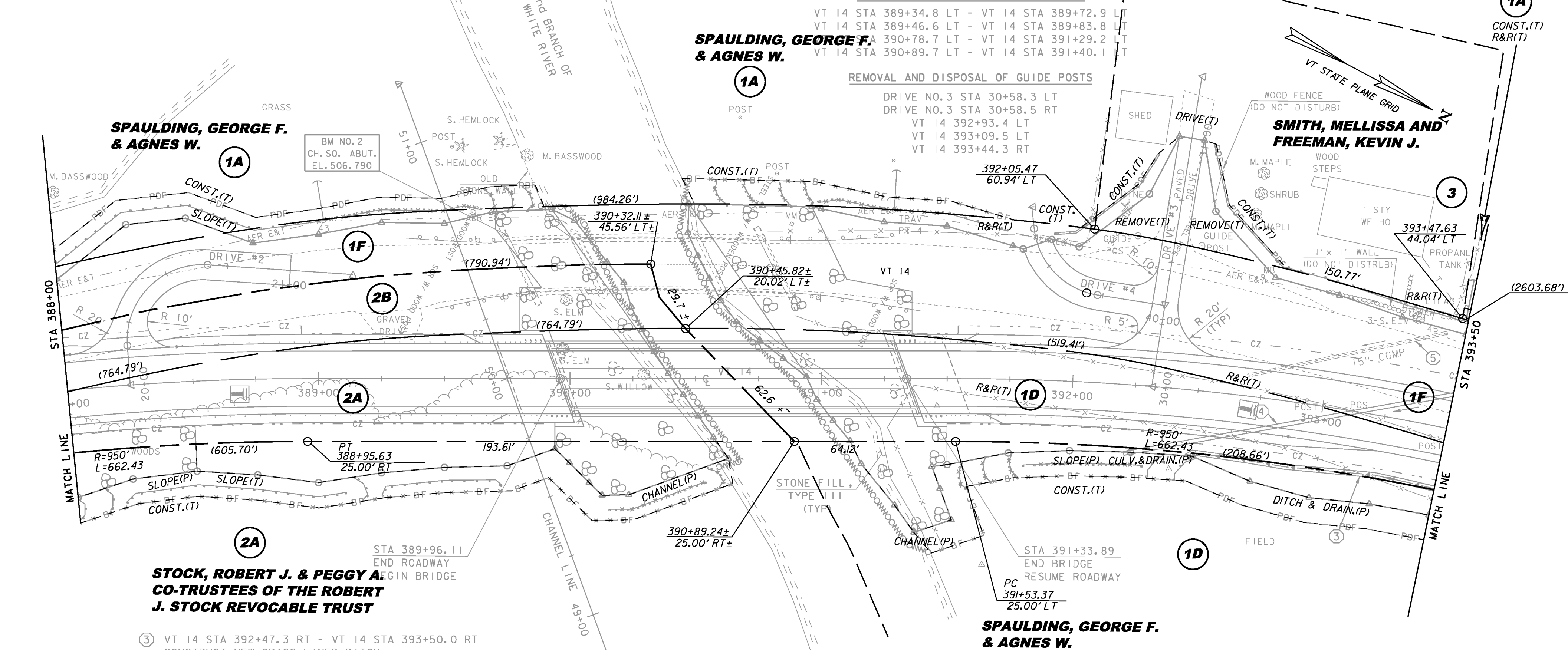

- ③ VT 14 STA 392+47.3 RT - VT 14 STA 393+50.0 RT
CONSTRUCT NEW GRASS-LINED DITCH
- ④ VT 14 STA 392+22.2 RT - VT 14 STA 393+74.4 LT
NEW 18" X 160" PCCSP (0.064), CAAP (0.060),
RCP CL. III OR CPEP (SL) OPTION
- ⑤ VT 14 STA 392+68.9 LT - VT 14 STA 393+43.0 LT
EXISTING 15" CGMP & INLET HEADWALL - REMOVE

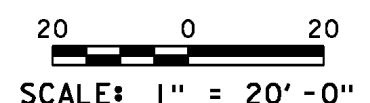

EXISTING BRIDGE DATA

THREE-SPAN CONCRETE T-BEAM SUPERSTRUCTURE WITH ASPHALT OVERLAY

CAST-IN-PLACE CONCRETE ABUTMENTS, WINGWALLS AND PIERS

BRIDGE LENGTH: 105'
BRIDGE WIDTH (FASCIA TO FASCIA): 23.7'
VERTICAL CLEARANCE UNDER BRIDGE: 12'

LINE SHOWN ON THIS PLAN AS EXISTING PROPERTY LINES P/L ARE BELIEVED TO BE ACCURATE BUT SHOULD NOT BE RELIED UPON FOR PURPOSES UNRELATED TO THE STATE OF VERMONT'S ACQUISITION OF LAND AND RIGHTS FOR THIS PROJECT.

| | |
|--------------------------------|--------------------------|
| 86E055 | |
| PROJECT NAME: | ROYALTON |
| PROJECT NUMBER: | BRS 0147(I3) |
| FILE NAME: | \BRIDGE 27 \Layout 2.dgn |
| PROJECT LEADER: | C. CARLSON |
| DESIGNED BY: | D. PETERSON |
| BRIDGE 27 ROW LAYOUT SHEET (2) | |
| PLOT DATE: | 12-APR-2017 |
| DRAWN BY: | MR |
| CHECKED BY: | JB |
| ROW SHEET | 5 OF 38 |