

INDEX OF SHEETS

STATE OF VERMONT AGENCY OF TRANSPORTATION



PROPOSED IMPROVEMENT TOWN OF BURKE VT. RTE. 114



R.O.W. PLANS

RIGHT-OF-WAY DIVISION
TOWN FILE
PERPETUAL
Town of _____
(To Be Returned To R.O.W. Division)

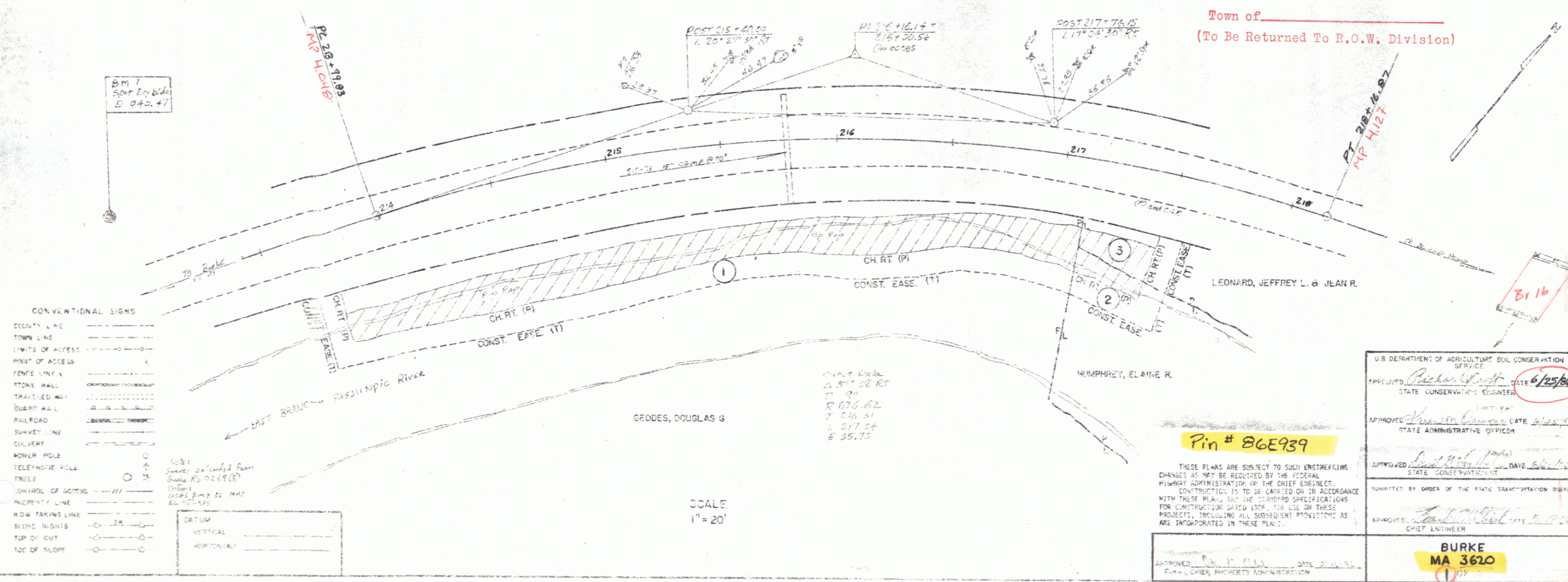

CONVENTIONAL SIGNS

COUNTY LINE	---
TOWN LINE	---
LIMITS OF ACCESS	---
POINT OF ACCESS	X
FENCE LINE	---
STONE WALL	---
TRAVELLED WAY	---
GUARD RAIL	---
RAILROAD	---
SURVEY LINE	---
CULVERT	---
POWER POLE	○
TELEPHONE POLE	○
TREE	○
CONTROL OF ACCESS	---
ADJACENT LINE	---
HOW TAKING LINE	---
SLOPE RIGHTS	---
TOP OF CUT	---
TOE OF SLOPE	---

U.S. DEPARTMENT OF AGRICULTURE SOIL CONSERVATION SERVICE

APPROVED: *[Signature]* DATE: 6/25/64
STATE CONSERVATION ENGINEER

APPROVED: *[Signature]* DATE: 6/25/64
STATE ADMINISTRATIVE OFFICER

APPROVED: *[Signature]* DATE: 6/25/64
STATE CONSERVATIONIST

QUARANTEED BY ORDER OF THE STATE TRANSPORTATION BOARD

APPROVED: *[Signature]* DATE: 6/25/64
CHIEF ENGINEER

**BURKE
MA 3620**

Pin # 86E939

THESE PLANS ARE SUBJECT TO SUCH ENGINEERING CHANGES AS MAY BE REQUIRED BY THE FEDERAL HIGHWAY ADMINISTRATION OR THE CHIEF ENGINEER. CONSTRUCTION IS TO BE CARRIED ON IN ACCORDANCE WITH THESE PLANS AND THE STANDARD SPECIFICATIONS FOR CONSTRUCTION DATED 1964. FOR USE ON THESE PROJECTS, INCLUDING ALL SUBSEQUENT PROVISIONS AS ARE INCORPORATED IN THESE PLANS.

APPROVED: *[Signature]* DATE: 6/25/64
CHIEF, PROPERTY ADMINISTRATION

SCALE
1" = 20'