

LINES SHOWN ON THIS PLAN AS EXISTING PROPERTY LINES P/L ARE BELIEVED TO BE ACCURATE BUT SHOULD NOT BE RELIED UPON FOR PURPOSES UNRELATED TO THE STATE OF VERMONT'S ACQUISITION OF LAND AND RIGHTS FOR THIS PROJECT.

REMOVAL AND DISPOSAL OF GUARD RAIL
 STA 109+76 LT - 110+03 LT
 STA 109+77 RT - 110+03 RT
 STA 111+18 LT - 112+26 LT
 STA 111+18 RT - 112+27 RT
 SPECIAL PROVISION (BRIDGE RAILING, GALVANIZED 2 RAIL BOX BEAM/CURB MOUNTED)
 STA 109+93.7 - 111+26.9 LT
 STA 109+93.6 - 111+26.9 RT
 SPECIAL PROVISION (GUARDRAIL APPROACH SECTION, GALVANIZED 2 RAIL BOX)
 STA 109+72.0 - 109+93.7 LT
 STA 109+68.3 - 109+93.6 RT
 STA 111+26.9 - 111+51.9 LT & RT
 REMOVAL OF STRUCTURE
 STA 110+50 RT

EXISTING BRIDGE DATA
 STEEL THROUGH TRUSS
 LENGTH = 113 FT
 WIDTH = 21.3 FT CURB TO CURB
 BUILT IN 1928
 TEMPORARY INSTALLED DECEMBER, 2005

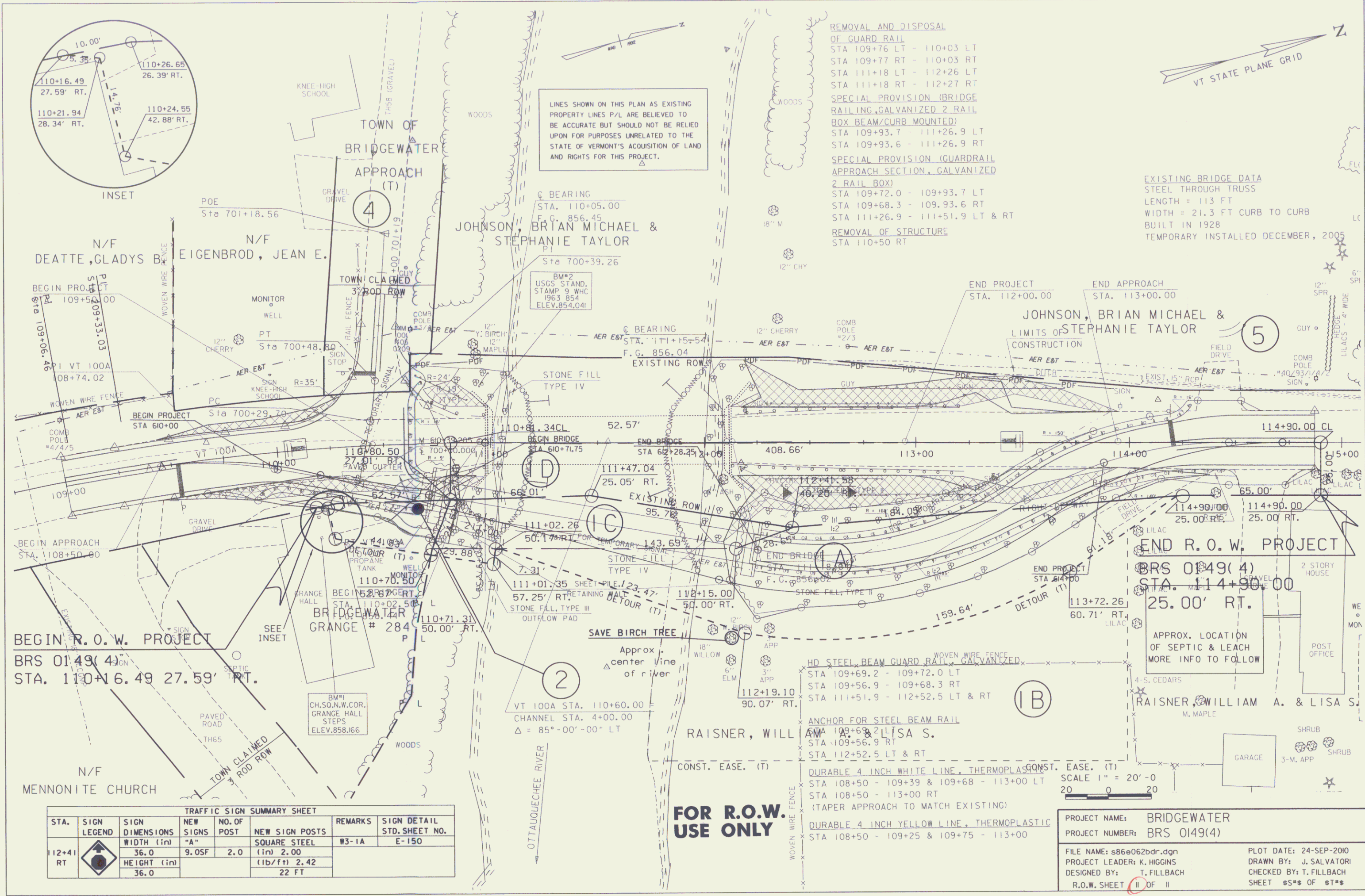

BEGIN R.O.W. PROJECT
 BRS 0149(4)
 STA. 110+16.49 27.59' RT.

END R.O.W. PROJECT
 BRS 0149(4)
 STA. 114+90.00
 25.00' RT.

FOR R.O.W. USE ONLY

TRAFFIC SIGN SUMMARY SHEET						
STA.	SIGN LEGEND	SIGN DIMENSIONS	NEW SIGNS	NO. OF POSTS	REMARKS	SIGN DETAIL STD. SHEET NO.
112+41 RT		WIDTH (in) 36.0 HEIGHT (in) 36.0	9.0SF	2.0	NEW SIGN POSTS SQUARE STEEL (in) 2.00 (lb/ft) 2.42	W3-1A E-150

PROJECT NAME: BRIDGEWATER
 PROJECT NUMBER: BRS 0149(4)
 FILE NAME: s86e062bdr.dgn
 PROJECT LEADER: K. HIGGINS
 DESIGNED BY: T. FILLBACH
 R.O.W. SHEET 11 OF 11
 PLOT DATE: 24-SEP-2010
 DRAWN BY: J. SALVATORI
 CHECKED BY: T. FILLBACH
 SHEET 55*6 OF 51*6