

STATE OF VERMONT
AGENCY OF TRANSPORTATION



R. O. W. PLANS

PROPOSED IMPROVEMENT
BRIDGE PROJECT
TOWN OF BRIDGEWATER
COUNTY OF WINDSOR
VT. ROUTE 100A - MAJOR COLLECTOR

Length of ROW Project = 473.51 ft
Length of Project = 300 ft
Length of Roadway = 150 ft
Length of Bridge = 150 ft

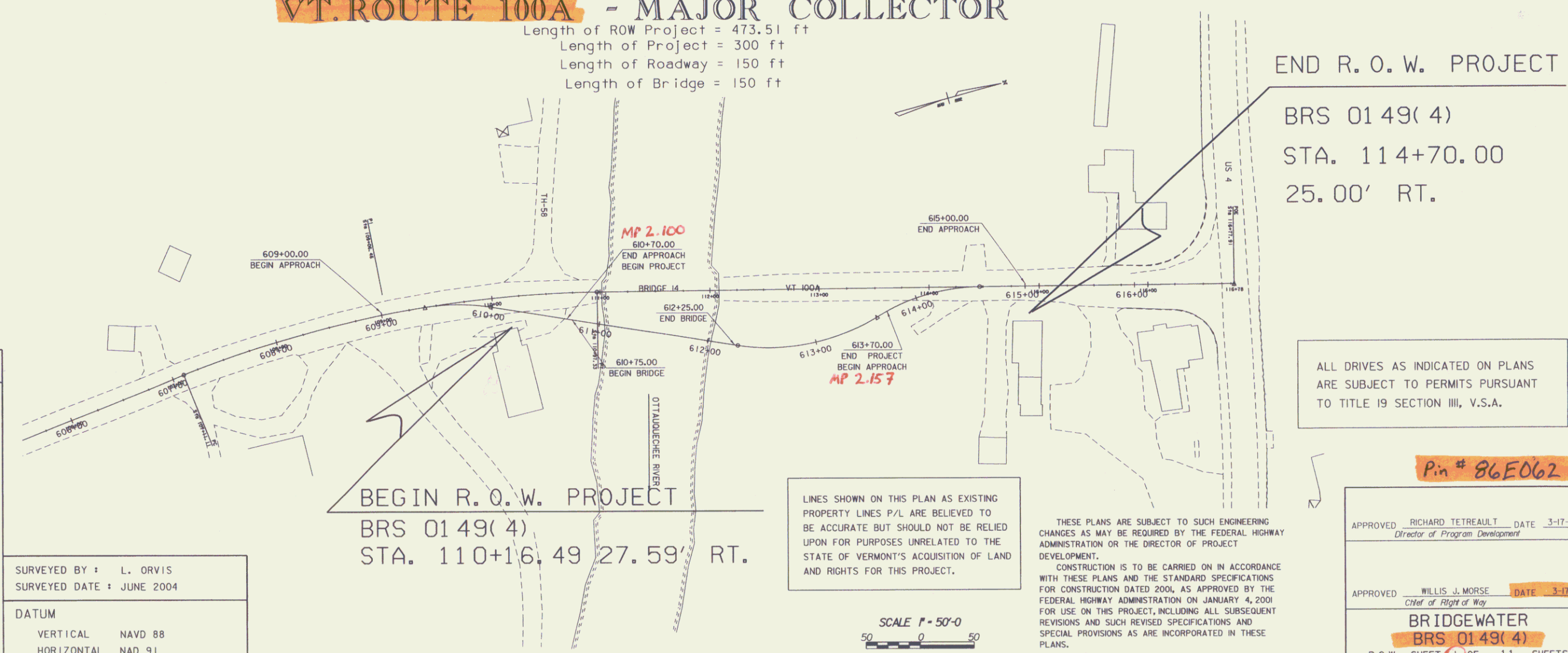
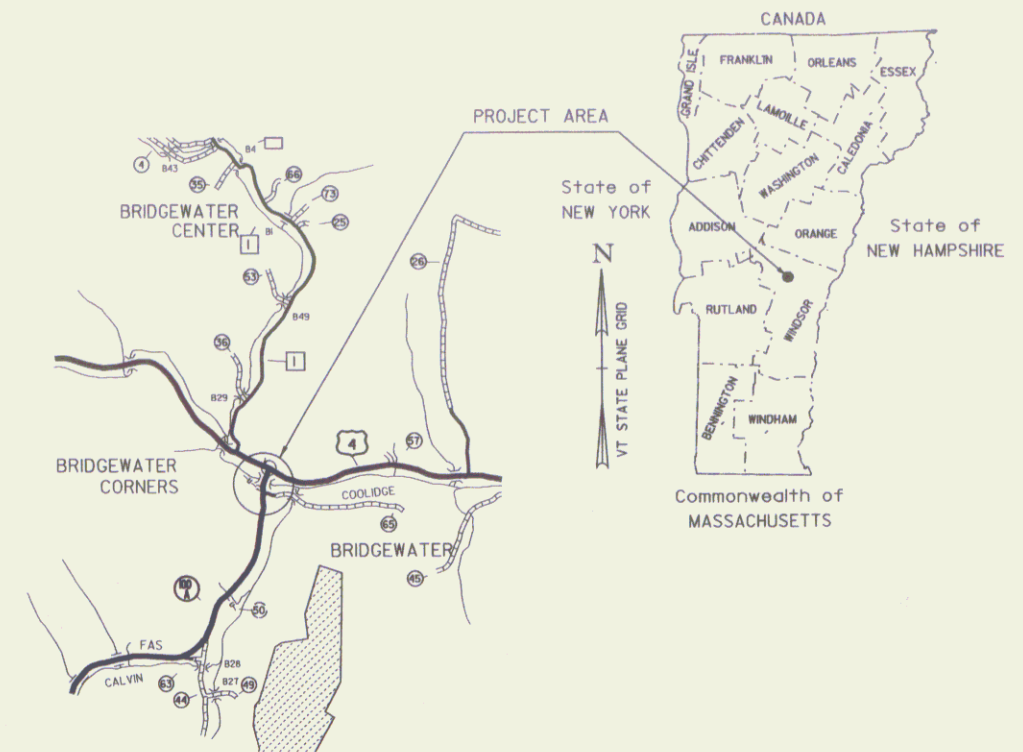

CONVENTIONAL SYMBOLS	
COUNTY LINE	
TOWN LINE	
LIMITS OF ACCESS	
POINT OF ACCESS	
FENCE LINE	
STONE WALL	
TRAVELED WAY	
GUARD RAIL	
RAILROAD	
SURVEY LINE	
CULVERT	
POWER POLE	
TELEPHONE POLE	
TREES	
CONTROL OF ACCESS	
PROPERTY LINE	
R.O.W. TAKING LINE	
SLOPE RIGHTS	
TOP OF CUT	
TOE OF SLOPE	

SURVEYED BY : L. ORVIS
SURVEYED DATE : JUNE 2004
DATUM
VERTICAL NAVD 88
HORIZONTAL NAD 91

BEGIN R. O. W. PROJECT
BRS 0149(4)
STA. 110+16.49 27.59' RT.

LINES SHOWN ON THIS PLAN AS EXISTING
PROPERTY LINES P/L ARE BELIEVED TO
BE ACCURATE BUT SHOULD NOT BE RELIED
UPON FOR PURPOSES UNRELATED TO THE
STATE OF VERMONT'S ACQUISITION OF LAND
AND RIGHTS FOR THIS PROJECT.

SCALE 1" = 50'-0"

THESE PLANS ARE SUBJECT TO SUCH ENGINEERING
CHANGES AS MAY BE REQUIRED BY THE FEDERAL HIGHWAY
ADMINISTRATION OR THE DIRECTOR OF PROJECT
DEVELOPMENT.
CONSTRUCTION IS TO BE CARRIED ON IN ACCORDANCE
WITH THESE PLANS AND THE STANDARD SPECIFICATIONS
FOR CONSTRUCTION DATED 2004, AS APPROVED BY THE
FEDERAL HIGHWAY ADMINISTRATION ON JANUARY 4, 2004
FOR USE ON THIS PROJECT, INCLUDING ALL SUBSEQUENT
REVISIONS AND SUCH REVISED SPECIFICATIONS AND
SPECIAL PROVISIONS AS ARE INCORPORATED IN THESE
PLANS.
/P/W/86e062/ee062d11.dgn ee062d11

END R. O. W. PROJECT
BRS 0149(4)
STA. 114+70.00
25.00' RT.

ALL DRIVES AS INDICATED ON PLANS
ARE SUBJECT TO PERMITS PURSUANT
TO TITLE 19 SECTION III, V.S.A.

Pin # 86E062

APPROVED RICHARD TETREault DATE 3-17-05
Director of Program Development

APPROVED WILLIS J. MORSE DATE 3-17-05
Chief of Right of Way

BRIDGEWATER
BRS 0149(4)
R.O.W. SHEET 1 OF 11 SHEETS