

END MAINTENANCE AGREEMENT ZONE NO. 1
T.H. #35 5+010.1 CL.

BEGIN MAINTENANCE AGREEMENT ZONE NO. 1
T.H. #35 5+003.6 CL
[LENGTH 6.5M (21')]]

Lines shown on this plan as existing property lines (P/L) are believed to be accurate but should not be relied upon for purposes unrelated to the state of Vermont's acquisition of land and rights for this project.

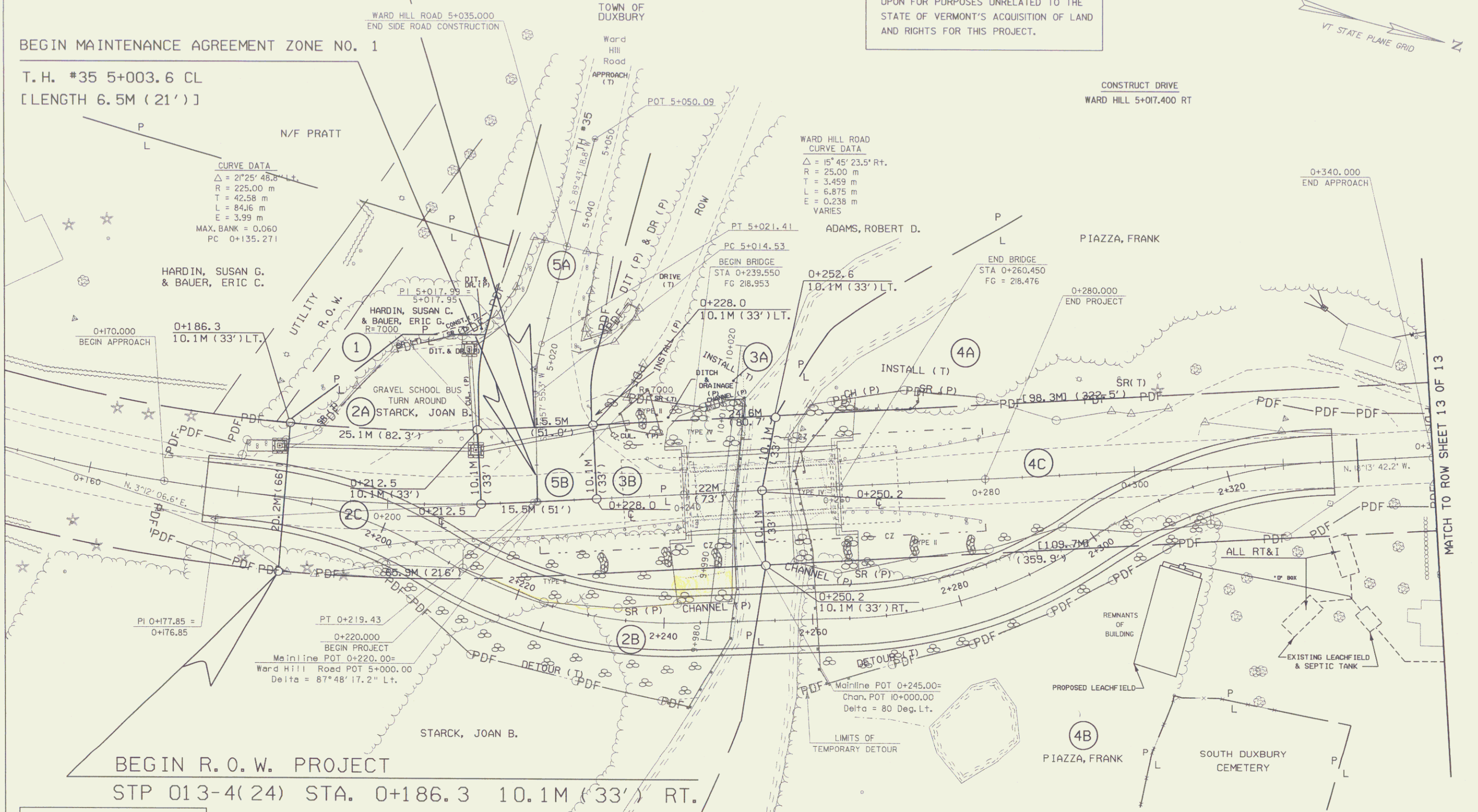
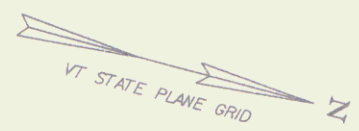

BEGIN R.O.W. PROJECT
STP 013-4(24) STA. 0+186.3 10.1M (33') RT.

Existing Bridge Data
Bridge Width = 20'-0"
Roadway Width = 17'-0"
Bridge Length = 63'
Clear Span = 58'

The existing structure is a concrete deck on rolled beam stringers. The existing abutments are poured in-place concrete.

NOTE:
SEE R.O.W. SHEET 9 OF 13 FOR EROSION CONTROL DETAIL

ALL UTILITIES CURRENTLY ON THE EXISTING BRIDGE WILL BE ABANDONED. THESE UTILITIES WILL BE MOVED TO THE EXISTING AERIAL UTILITY LINE JUST WEST OF THE BRIDGE.

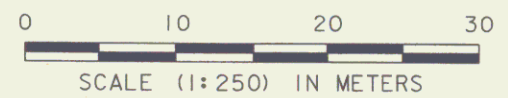

FOR R.O.W. USE ONLY

PROJECT NAME: DUXBURY	PLOT DATE: 09-AUG-2004
PROJECT NUMBER: STP 013-4(24)	DRAWN BY: Graw
FILE NAME: /str5/86e059/ae05911e.dgn	CHECKED BY: T. SUMNER
PROJECT LEADER: C. KELLER	R.O.W. SHEET 9 OF 58
DESIGNED BY: B. NYQUIST	

PLAN SHEET