

RICHARD A. GROSSMAN & ROBERT C. BAKER, TRUSTEES FOR
 RISSA W. GROSSMAN-LOOMIS J. GROSSMAN, JR. AND
 ROBERT C. BAKER, TRUSTEES FOR RACHEL GROSSMAN
 AND JOSHUA J. GROSSMAN- ROBERT C. BAKER AND
 LOOMIS J. GROSSMAN JR. AS TRUSTEES FOR LAUREN S.
 BAKER, NELSON J. BAKER AND RICHARD A. BAKER

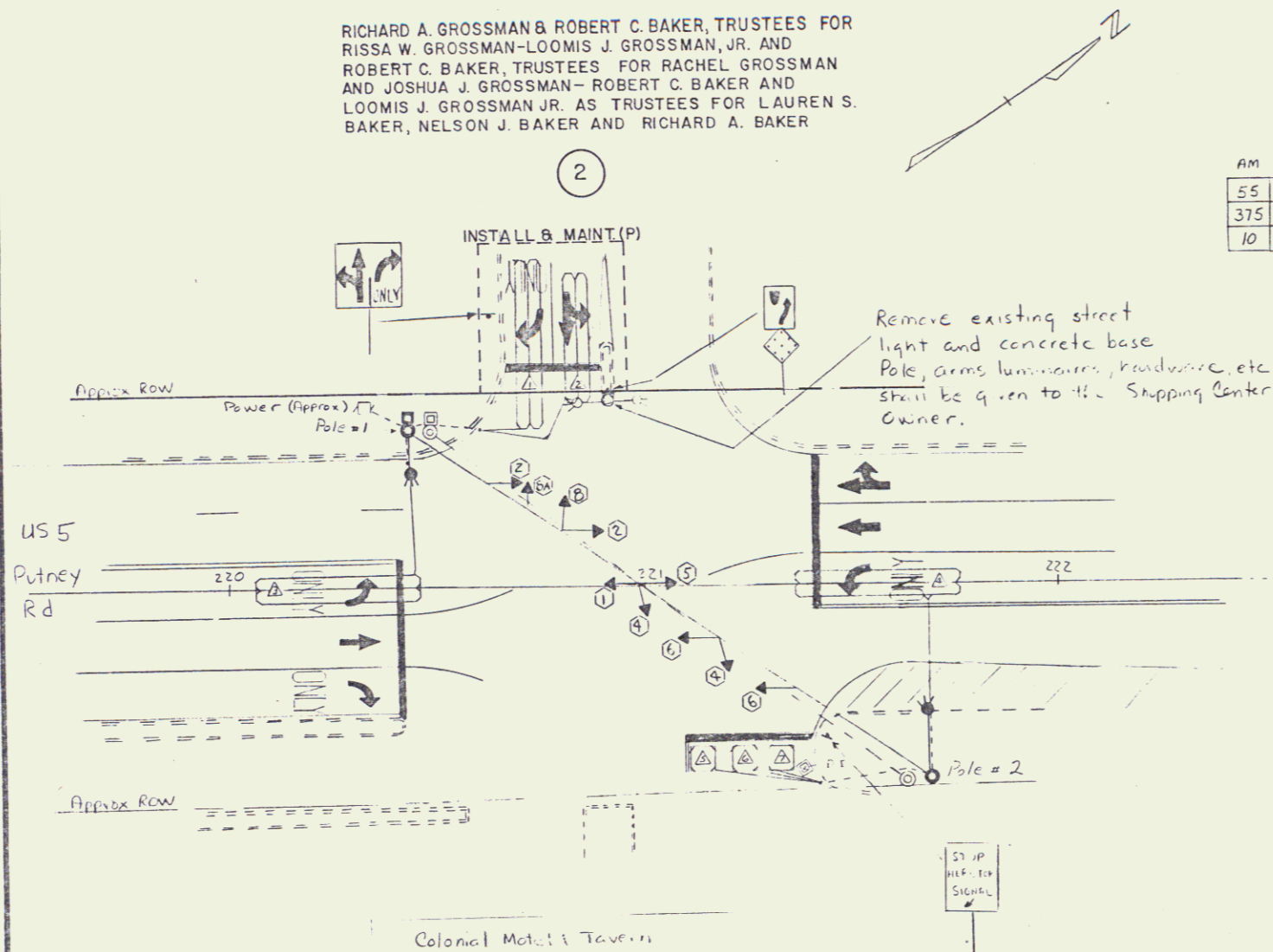

AM OFF PM NITE

35	155	195	195
5	20	10	10
20	160	160	105

55	130	125	20
375	530	575	375
10	25	20	20

60	180	170	110
500	500	550	360
10	40	20	20

1988 "Average Weekday"
 Hourly Traffic
 (for Signal Timing)

SIGNAL PHASING & TIMING

INITIAL	Phase A (Dwell)				Phase B				Phase C			Phase D	
	W	R	L	D	W	R	L	D	W	R	L	W	R
EXT	1.5	1.5	1.5	1.5	1.5	1.5	1.5	1.5	1.5	1.5	1.5	1.5	1.5
MIN	?	4.2	4.2	4.2	?	4.2	4.2	4.2	?	4.1	4.1	?	4.2
MAX AM	1.5	4.2	4.2	4.2	1.5	4.2	4.2	4.2	1.5	4.1	4.1	1.5	4.2
MAX OFF	2.5	4.2	4.2	4.2	2.5	4.2	4.2	4.2	2.5	4.1	4.1	2.5	4.2
MAX PM	2.5	4.2	4.2	4.2	2.5	4.2	4.2	4.2	2.5	4.1	4.1	2.5	4.2
MAX NITE	1.5	4.2	4.2	4.2	1.5	4.2	4.2	4.2	1.5	4.1	4.1	1.5	4.2

FACE	1	2	4	5	6	8	8A	FR
1	RRR	RRR	RRR	RRR	RRR	RRR	RRR	FR
2	GGG	GGG	GGG	GGG	GGG	GGG	GGG	FR
4	RRR	RRR	RRR	RRR	RRR	RRR	RRR	FR
5	RRR	RRR	RRR	RRR	RRR	RRR	RRR	FR
6	GGG	GGG	GGG	GGG	GGG	GGG	GGG	FR
8	RRR	RRR	RRR	RRR	RRR	RRR	RRR	FR
8A	RRR	RRR	RRR	RRR	RRR	RRR	RRR	FR

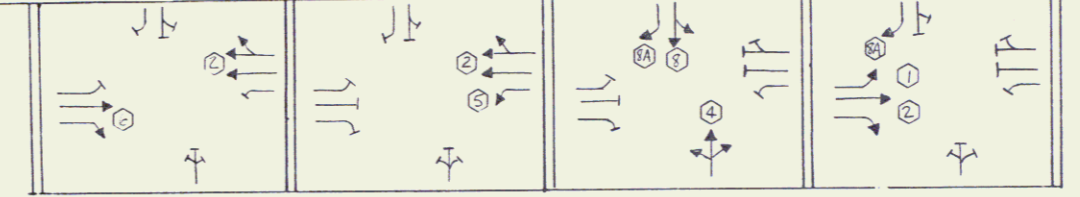

Durable 24" Stopbar
 220+67 ~ 220+91, 53' LT

Durable Arrow
 220+73, 57-65' LT (1)
 220+85, 57-70' LT (2)

Durable Letter in Word Marking
 220+73, 69-77' LT (4) "ONLY"

Durable 4" White Line
 220+80, 53' LT ~ 77' LT

Durable 4" Yellow Line
 220+91, 47' LT ~ 220+93, 77' LT
 220+95, 47' LT ~ 220+93, 77' LT

New Face Arrangement



Faces 4 shall be optically programmed and masked as shown below.

Vehicle Loop Detectors

LANE	LOOP No	SIZE	TYPE	NO. TURNS	CALL #
DRIVE RT	1	6'x40'	QUAD		ΦC
DRIVE LT	2	6'x30'	QUAD		ΦC
NB LT	3	6'x90'	QUAD		ΦD
SB LT	4	6'x40'	QUAD		ΦB
DRIVE LT	5	6'x6'	RECT		ΦC
DRIVE CT	6	6'x6'	RECT		ΦC
DRIVE RT	7	6'x6'	RECT		ΦC

Loops 1&2 shall be on separate amplifiers with #1 a delay call amp. set at 0.
 Loops 5,6,7 shall be combined on a separate delay call amp. set at 0.

NOTES:

- RETAIN EXISTING SIGNALS UNTIL NEW ONES HAVE BEEN INSTALLED. TEMPORARY GUYING OF EXISTING POLE(S) MAY BE REQUIRED.
- REPLACE ALL EXISTING SIGNAL EQUIPMENT (POLES, SIGNALS, WIRING, ETC.) WITH NEW AS SHOWN.
- RETAIN EXISTING POWER AND RELOCATE TO NEW POLE.
- INSTALL NEW LOOPS AS SHOWN. LOOP LEAD-INS FOR LOOPS 4, 5, 6 & 7 SHALL CROSS US 5 VIA THE SPAN WIRE.
- INSTALL CONDUITS AS SHOWN.
- INSTALL NEW CONTROLLER, CABINET, ETC. ON POLE #1.
- INSTALL CONCRETE PAD UNDER CABINET. SEE SHEET 8 FOR DETAIL.
- INSTALL SIGNS AND PAVEMENT MARKINGS AS SHOWN.
- SEE SHEETS 18-21 FOR OFFSETS.
- SEE SHEET 16 FOR SIGN AND POST QUANTITIES.
- SEE SHEETS 8-9 FOR NOTES AND ADDITIONAL INFORMATION.
- REMOVE TOP OF THE EXISTING BASES TO A POINT 1' +/- BELOW GROUND, BACKFILL AND SEED.
- SEE SHEETS 14 FOR STRAIN POLE INFORMATION.
- REMOVE EXISTING STREET LIGHT POLE & CONCRETE BASE. BACKFILL HOLE AND PLACE CURBING AROUND ISLAND NOSE. SEE DETAIL ON SHEET 8.

Vehicle Loop Detectors

- NB Left Turn (1)
- SB Left Turn (1)
- Brattleboro North Lt/RT (2)
- Commercial Drive (2)
- + Lead ins
- See table at right for sizes

Electrical Conduit

- US 5 Curb to Pole #1
- US 5 Curb to Pole #2
- Brattleboro North Curb to Pole #1
- Commercial Drive Curb to Pole #2

It is assumed that all other markings will be placed as part of another project (HMA 2811).

TIME OF DAY PLAN

6-7 AM	NITE
7-9 AM	AM
9 AM-3:30 PM	OFF
3:30-5:30 PM	PM
5:30-7 PM	OFF
7-10 PM	NITE
10 PM-6 AM	FLASH

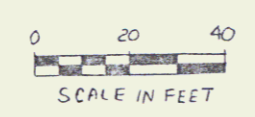
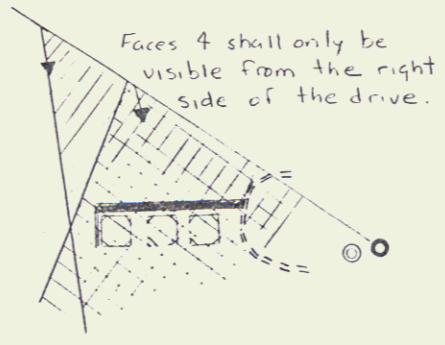

EXISTING	NEW	LEGEND
○	○	UTILITY POLE
○	○	LUMINAIRE
○	○	WOOD POLE
○	○	STRAIN POLE
□	□	CONTROLLER CABINET
□	□	PULL BOX / JUNCTION BOX
○	○	SIGNAL HEAD
---	---	CONDUIT
---	---	VEHICLE LOOPS
□	□	SIGNS

ROW PLANS

TRAFFIC SIGNAL DETAILS PUTNEY RD & BRATTLEBORO NORTH MALL	DESIGNED BY: LKA DATE: 3/88 DRAWN BY: DATE: TRACED BY: LKA DATE: 11/87 BRATTLEBORO PROJ. MG- NO. 2000(15) S SHEET 4 OF 6
---	---

DATUM	_____
VERTICAL	_____
HORIZONTAL	_____

DEC 11 1990