

**REMOVE EXISTING SIDEWALK (COMMON EXCAVATION)**

- 45+00 - 45+53 LT
- 45+69 - 45+95 LT
- 46+8 - 47+36 LT
- 47+65 - 48+40 LT
- 48+40 - 48+88 RT
- 49+18 - 50+00 RT

**EXISTING DRAINAGE**

- 26+19.2 RT - 25+40 RT (SAUNDERS AVE)
- EXISTING PIPE - REMOVE
- 46+17 LT - 46+65.2 RT
- EXISTING (DI) LT - REMOVE
- EXISTING (DI) RT - RETAIN
- EXISTING PIPE - PLUG
- 47+12 LT
- EXISTING DI - REMOVE
- EXISTING PIPE - PLUG
- 48+79 LT
- EXISTING DI - REMOVE
- EXISTING PIPE - PLUG
- 30+43 LT - 30+48 LT (PIERCE ST.)
- EXISTING DI - REMOVE
- EXISTING PIPE - PLUG
- 30+48 LT - 30+98.6 LT (PIERCE ST.)
- EXISTING PIPE & (DI) - REMOVE
- 30+48 LT - SEWER (PIERCE ST.)
- EXISTING PIPE - REMOVE AND PLUG AT SEWER
- 30+76 LT - 30+76 RT (PIERCE ST.)
- EXISTING PIPE & DI - REMOVE

**NEW DRAINAGE**

- 44+00 RT - 45+10 RT
- NEW 30"x60" RCP/CPEP (SL)
- W/D @ 45+10 RT
- 26+19.2 RT - 25+44.06 RT (SAUNDERS AVE)
- NEW 18"x72" RCP/CPEP (SL)
- W/J @ 26+19.2 (SAUNDERS AVE)
- 25+44.06 RT (SAUNDERS AVE) - 45+10 RT
- NEW 18"x60" RCP/CPEP (SL)
- W/D @ 25+44.06 RT (SAUNDERS AVE)
- 45+50 LT - 45+10 RT
- NEW 18"x54" RCP/CPEP (SL)
- W/D @ 45+50 LT
- 45+10 RT - 46+15 RT
- NEW 24"x104" RCP/CPEP (SL)
- W/D @ 46+15 RT
- 46+65.2 RT - 46+15 RT
- NEW 18"x54" RCP/CPEP (SL)
- 46+15 RT - 47+10 RT
- NEW 18"x54" RCP/CPEP (SL)
- 49+40 LT - 50+30 RT
- NEW 18"x88" RCP/CPEP (SL)
- W/D @ 47+10 RT

**NEW DRAINAGE (CONT.)**

- 47+10 LT - 47+10 RT
- NEW 18"x38" RCP/CPEP (SL)
- W/D @ 47+10 LT
- 47+10 RT - 49+40 RT
- NEW 24"x229" RCP/CPEP (SL)
- W/D @ 49+40 RT
- 30+98.0 LT - 30+38.73 RT (PIERCE ST.)
- NEW 18"x60" RCP/CPEP (SL)
- W/J @ 30+98.0 LT
- 30+34.5 LT - 30+38.73 RT (PIERCE ST.)
- NEW 18"x22" RCP/CPEP (SL)
- W/D @ 30+36.94 LT
- 30+38.73 RT (PIERCE ST.) - 49+40 LT
- NEW 18"x24" RCP/CPEP (SL)
- W/D @ 30+38.73 RT
- 49+40 LT - 49+40 RT
- NEW 18"x38" RCP/CPEP (SL)
- W/D @ 49+40 LT
- 49+40 RT - 50+30 RT
- NEW 18"x88" RCP/CPEP (SL)
- W/J @ 50+30 RT

**REHABING DI, CB OR MH, CLASS II**

- 46+65.2 RT

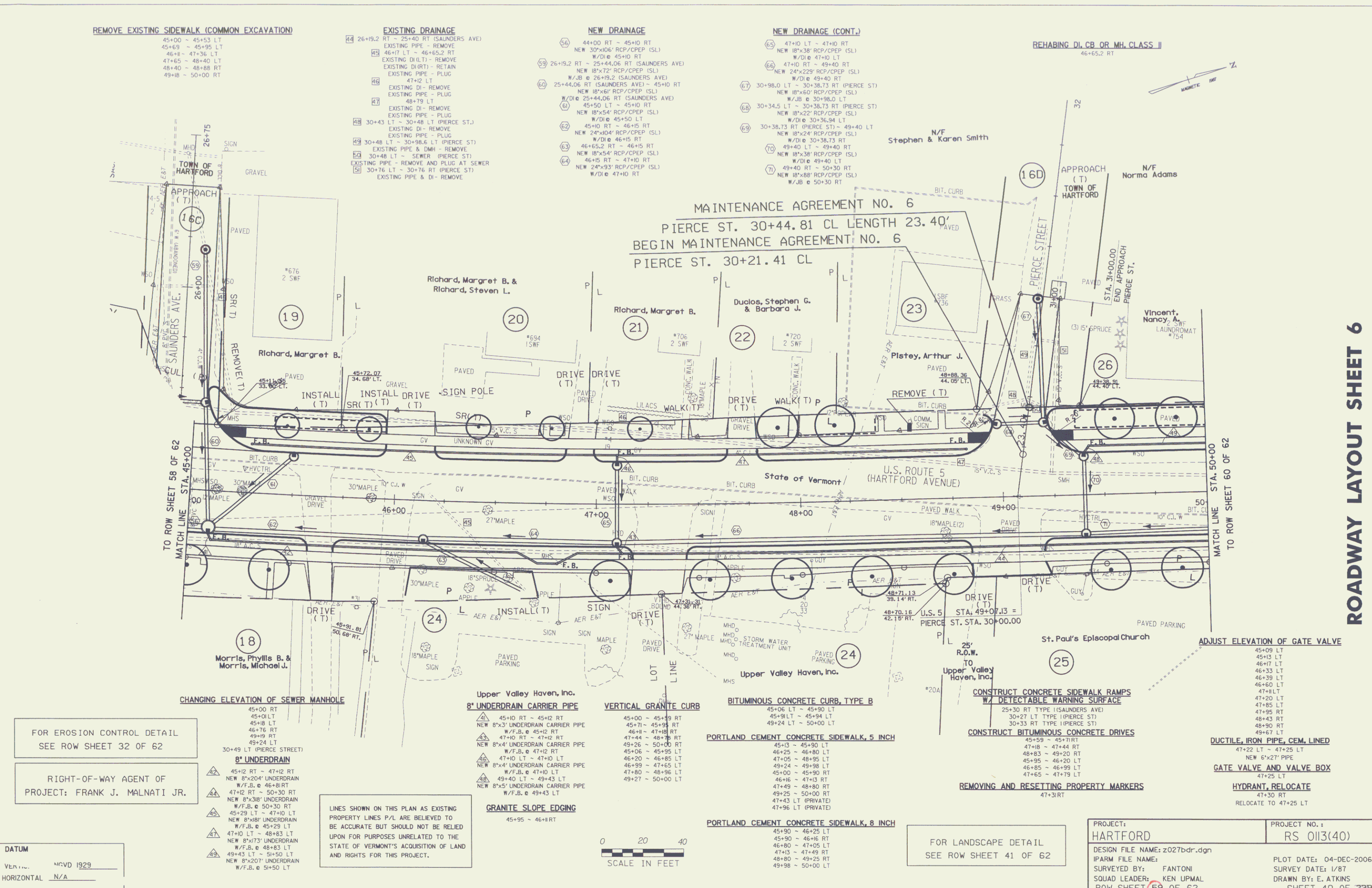

FOR EROSION CONTROL DETAIL  
SEE ROW SHEET 32 OF 62

RIGHT-OF-WAY AGENT OF  
PROJECT: FRANK J. MALNATI JR.

**DATUM**  
VERTICAL: NVD 1929  
HORIZONTAL: N/A

LINES SHOWN ON THIS PLAN AS EXISTING  
PROPERTY LINES P/L ARE BELIEVED TO  
BE ACCURATE BUT SHOULD NOT BE RELIED  
UPON FOR PURPOSES UNRELATED TO THE  
STATE OF VERMONT'S ACQUISITION OF LAND  
AND RIGHTS FOR THIS PROJECT.

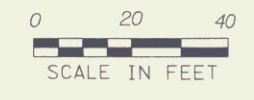

FOR LANDSCAPE DETAIL  
SEE ROW SHEET 41 OF 62

PROJECT:  
**HARTFORD**  
DESIGN FILE NAME: z027bdr.dgn  
IPARM FILE NAME:  
SURVEYED BY: FANTONI  
SQUAD LEADER: KEN UPMAL  
ROW SHEET 59 OF 62

PROJECT NO.:  
**RS 0113(40)**  
PLOT DATE: 04-DEC-2006  
SURVEY DATE: 1/87  
DRAWN BY: E. ATKINS  
SHEET 40 OF 239

**ROADWAY LAYOUT SHEET 6**