

REMOVE EXISTING SIDEWALK (COMMON EXCAVATION)
30+00 - 35+00 LT

EXISTING DRAINAGE
19 3+70 LT
EXISTING DI - REMOVE
EXISTING PIPE - PLUG
20 32+00 LT
EXISTING DI - REMOVE
EXISTING PIPE - PLUG
21 33+28 LT
EXISTING DI - REMOVE
EXISTING PIPE - PLUG

RETAINING WALL
30+26 RT - 35+00 RT

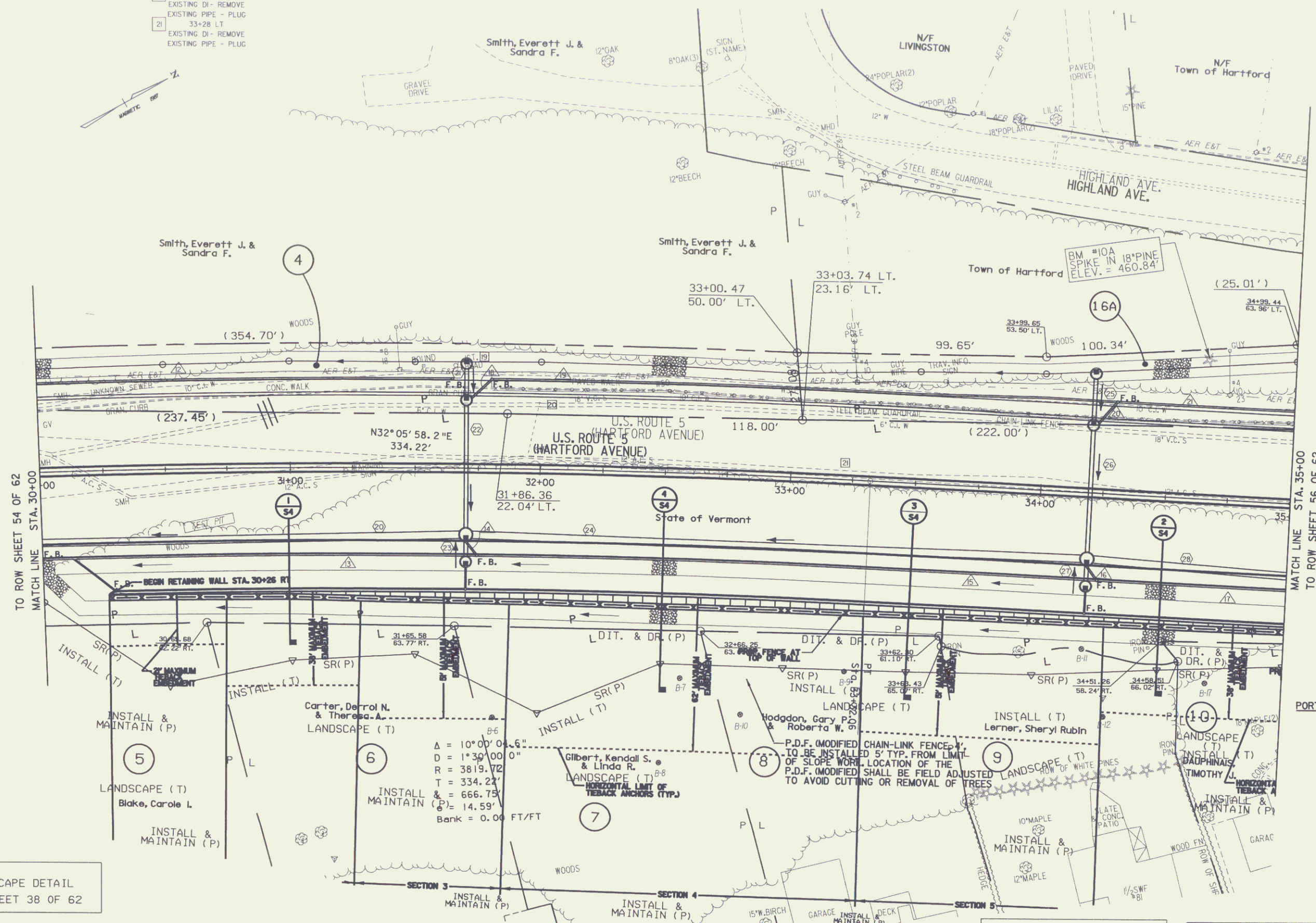
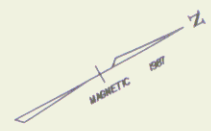

FOR LANDSCAPE DETAIL
SEE ROW SHEET 38 OF 62

DATUM
VERTICAL NGVD 1929
HORIZONTAL N

RIGHT-OF-WAY AGENT OF
PROJECT: FRANK J. MALNATI JR.



FOR EROSION CONTROL DETAIL
SEE ROW SHEET 29 OF 62

Lines shown on this plan as existing property lines P/L are believed to be accurate but should not be relied upon for purposes unrelated to the State of Vermont's acquisition of land and rights for this project.

PROJECT:
HARTFORD
DESIGN FILE NAME: z027bdr.dgn
IPARM FILE NAME:
SURVEYED BY: FANTONI
SQUAD LEADER: KEN UPMAL
ROW SHEET 55 OF 62

PROJECT NO.:
RS 0113(40)
PLOT DATE: 04-DEC-2006
SURVEY DATE: 1/87
DRAWN BY: E. ATKINS
SHEET 36 OF 239

- NEW DRAINAGE**
- 29 29+20 RT - 3+70 RT
NEW 36"x24" CAAP
W/DI @ 3+70 RT
 - 20 3+70 LT - 3+70 LT
NEW 18"x13" RCP/CPEP (SL)
W/DI @ 3+70 LT
 - 22 3+70 LT - 3+70 RT
NEW 18"x13" RCP/CPEP (SL)
W/DI @ 3+70 LT
 - 23 3+70 RT - 3+70 RT
NEW 18"x13" RCP/CPEP (SL)
W/DI @ 3+70 RT
 - 24 3+70 RT - 3+70 RT
NEW 18"x13" RCP/CPEP (SL)
W/DI @ 3+70 RT
 - 25 3+70 RT - 3+70 RT
NEW 18"x13" RCP/CPEP (SL)
W/DI @ 3+70 RT
 - 26 3+70 RT - 3+70 RT
NEW 18"x13" RCP/CPEP (SL)
W/DI @ 3+70 RT
 - 27 3+70 RT - 3+70 RT
NEW 18"x13" RCP/CPEP (SL)
W/DI @ 3+70 RT
 - 28 3+70 RT - 3+70 RT
NEW 18"x13" RCP/CPEP (SL)
W/DI @ 3+70 RT
- 8" UNDERDRAIN**
- 29 29+20 RT - 3+70 RT
NEW 8"x20" UNDERDRAIN
W/F.B. @ 3+70 RT
 - 30 30+00 RT - 3+75 RT
NEW 8"x20" UNDERDRAIN
W/F.B. @ 3+75 RT
 - 31 3+75 RT - 3+75 RT
NEW 8"x20" UNDERDRAIN
W/F.B. @ 3+75 RT
 - 32 3+75 RT - 3+75 RT
NEW 8"x20" UNDERDRAIN
W/F.B. @ 3+75 RT
 - 33 3+75 RT - 3+75 RT
NEW 8"x20" UNDERDRAIN
W/F.B. @ 3+75 RT
 - 34 3+75 RT - 3+75 RT
NEW 8"x20" UNDERDRAIN
W/F.B. @ 3+75 RT
 - 35 3+75 RT - 3+75 RT
NEW 8"x20" UNDERDRAIN
W/F.B. @ 3+75 RT
- 8" UNDERDRAIN CARRIER PIPE**
- 3+70 RT - 3+75 RT
NEW 8"x8" UNDERDRAIN CARRIER PIPE
W/F.B. @ 3+75 RT
 - 3+75 RT - 3+75 RT
NEW 8"x8" UNDERDRAIN CARRIER PIPE
W/F.B. @ 3+75 RT
 - 3+75 RT - 3+75 RT
NEW 8"x8" UNDERDRAIN CARRIER PIPE
W/F.B. @ 3+75 RT
 - 3+75 RT - 3+75 RT
NEW 8"x8" UNDERDRAIN CARRIER PIPE
W/F.B. @ 3+75 RT
 - 3+75 RT - 3+75 RT
NEW 8"x8" UNDERDRAIN CARRIER PIPE
W/F.B. @ 3+75 RT
 - 3+75 RT - 3+75 RT
NEW 8"x8" UNDERDRAIN CARRIER PIPE
W/F.B. @ 3+75 RT
- CHANGING ELEVATION OF SEWER MANHOLE**
- 30+05 LT
30+10 LT
30+36 RT
3+95 LT
- STONE FILL, TYPE I**
- 32+75 RT - 35+00 RT (ABOVE WALL)
- STONE FILL, TYPE II**
- 30+00 LT - 35+00 LT
 - 30+00 RT - 35+00 RT
 - 30+00 RT - 32+75 RT (ABOVE WALL)
- VERTICAL GRANITE CURB**
- 30+00 - 35+00 RT
 - 30+00 - 35+00 RT (MEDIAN)
 - 30+00 - 35+00 LT (MEDIAN)
- REMOVAL OF EXISTING CURB**
- 30+00 - 3+80 LT
- REMOVING AND RESETTING PROPERTY MARKERS**
- 3+53 LT
- PORTLAND CEMENT CONCRETE SIDEWALK, 5 INCH**
- 30+00 - 35+00 RT
 - 30+00 - 35+00 LT
- CHAIN-LINK FENCE, 6 FEET**
- 30+26 - 35+00 RT
- REMOVAL OF EXISTING FENCE**
- 3+81 - 35+00 LT
- CONCRETE MEDIAN BARRIER**
- 30+00 - 35+00 RT
- REMOVAL AND DISPOSAL OF EXISTING GUARDRAIL**
- 3+81 - 35+00 LT
- ADJUST ELEVATION OF VALVE BOX**
- 30+05 LT
 - 32+45 LT
 - 33+00 LT

ROADWAY LAYOUT SHEET 3