

BOTANICAL NAME	COMMON NAME	SIZE	QUANTITY	SPECIFICATIONS
ACER X FREEMANI 'CELEBRATION'	FREEMAN MAPLE 'CELEBRATION'	2.5'-3" CAL.	2	B&B CLEAR STEM TO 6'
ACER TATARICUM	TATARIAN MAPLE	3'-3.5" CAL.	6	B&B CLEAR STEM TO 6'
GLEDITSIA TRIACANTHOS 'SHADEMASTER'	HONEY LOCUST 'SHADEMASTER'	2.5'-3" CAL.	5	B&B

**TOPSOIL (BACKFILL MIX)**  
 51+33 ~ 51+70 LT (2' DEEP X 10' WIDE)  
 51+87 ~ 52+16 LT (2' DEEP X 10' WIDE)  
 52+40 ~ 53+50 LT (2' DEEP X 10' WIDE)  
 53+75 ~ 54+14 LT (2' DEEP X 10' WIDE)  
 54+44 ~ 55+00 LT (2' DEEP X 10' WIDE)

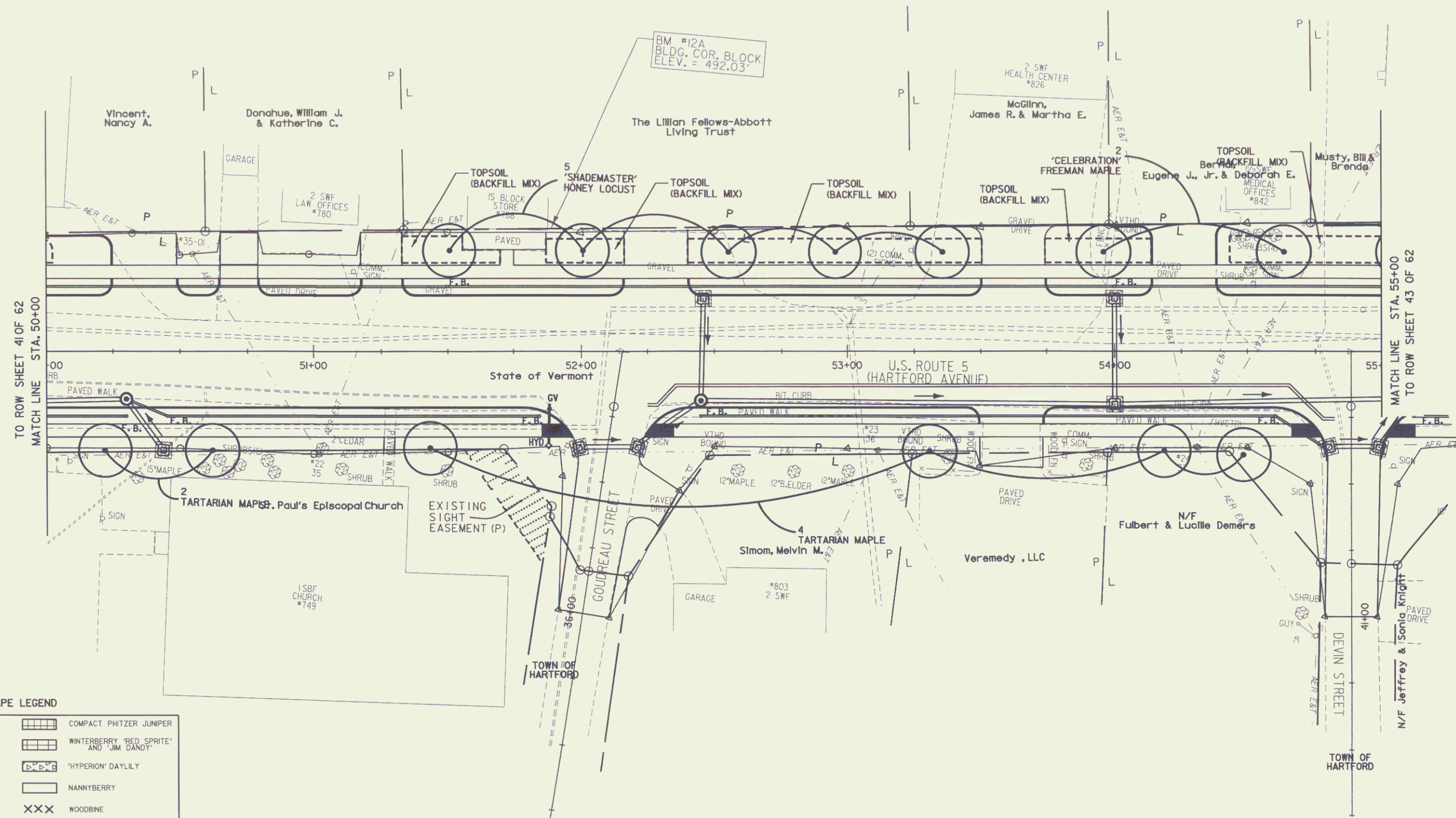
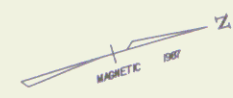

**LANDSCAPE LEGEND**

	PROPOSED CONIFEROUS TREE/SHRUB		COMPACT PFITZER JUNIPER
	PROPOSED DECIDUOUS TREE/SHRUB		WINTERBERRY 'RED SPRITE' AND 'JIM DANDY'
	PROPOSED GRANITE BLOCK		'HYPERION' DAYLILY
	TOPSOIL (BACKFILL MIX)		NANNYBERRY
	FRAGRANT SUMAC		WOODBINE
	LILAC		ARBORVITAE
	NINEBARK 'DIABLO'		EXISTING EVERGREEN TREE/SHRUB
	PROJECT BOUNDARY		EXISTING DECIDUOUS TREE/SHRUB
			PROJECT BOUNDARY FENCE

**DATUM**  
 VERTICAL NGVD 1929  
 HORIZONTAL N/A

**NOTES:** 1.) UNLESS OTHERWISE NOTED, THE SEEDING FORMULA FOR URBAN AREAS SHALL BE USED.  
 2.) REFER TO LANDSCAPING DETAIL SHEETS FOR SEEDING FORMULAS AND PLANTING DETAILS.

0 20 40  
 SCALE IN FEET

FOR EROSION CONTROL DETAIL  
 SEE ROW SHEET 33 OF 62

RIGHT-OF-WAY AGENT OF  
 PROJECT: FRANK J. MALNATI JR.

LINES SHOWN ON THIS PLAN AS EXISTING PROPERTY LINES P/L ARE BELIEVED TO BE ACCURATE BUT SHOULD NOT BE RELIED UPON FOR PURPOSES UNRELATED TO THE STATE OF VERMONT'S ACQUISITION OF LAND AND RIGHTS FOR THIS PROJECT.

PROJECT: <b>HARTFORD</b>	PROJECT NO.: RS 0113(40)
DESIGN FILE NAME: z027bdr.dgn	PLOT DATE: 13-JUL-2006
IPARM FILE NAME:	SURVEY DATE: 1/87
SURVEYED BY: FANTONI	DRAWN BY: E. ATKINS
SQUAD LEADER: KEN UPMAL	ROW SHEET 42 OF 62

LANDSCAPING LAYOUT SHEET 7