

**CLEARING AND GRUBBING
(INCLUDING INDIVIDUAL TREES AND STUMPS)**

35+00 - 36+75 RT
 35+00 - 36+85 LT
 1+55 - 1+75 RT (WORCESTER AVE)
 37+72 LT (S)
 37+83 LT (S)
 37+90 LT (W)
 1+26 RT (W) (WORCESTER AVE)
 2+85 LT (S) (WORCESTER AVE)
 3+16 RT (S) (WORCESTER AVE)
 10+88 LT (S) (HIGHLAND AVE)

**TEMPORARY FENCE FOR PROTECTION
OF EXISTING TREES TO REMAIN**

1+80 - 2+00 RT (WORCESTER AVE) - 48 FT
 38+90 - 39+02 RT - 34 FT

TOPSOIL (BACKFILL MIX)

35+73 - WORCESTER AVE, 1+33 RT (2' DEEP)
 36+71 - 38+27 RT (ENTIRE ISLAND 2' DEEP)
 HIGHLAND AVE 10+43 - 11+35 (ENTIRE ISLAND 2' DEEP)
 35+00 - 36+52 LT 10' WIDE X 2' DEEP
 HARTFORD AVE, 36+98 LT - HIGHLAND AVE, 13+67 LT
 95' WIDE X 2' DEEP

LANDSCAPE LEGEND

- PROPOSED CONIFEROUS TREE/SHRUB
- PROPOSED DECIDUOUS TREE/SHRUB
- PROPOSED GRANITE BLOCK
- TOPSOIL (BACKFILL MIX)
- FRAGRANT SUMAC
- LILAC
- 'CRIMSON PYGMY' BARBERRY
- NINEBARK 'DIABLO'
- COMPACT PHITZER JUNIPER
- WINTERBERRY 'RED SPRITE' AND 'JIM DANDY'
- 'HYPERION' DAYLILY
- NANNYBERRY
- WOODBINE
- ARBORVITAE
- EXISTING EVERGREEN TREE/SHRUB
- EXISTING DECIDUOUS TREE/SHRUB
- PROJECT DEMARCATION FENCE

DATUM

VERTICAL NGVD 1929
 HORIZONTAL N/A

BOTANICAL NAME	COMMON NAME	SIZE	QUANTITY	SPECIFICATIONS
QUERCUS ROBUR	NORTHERN RED OAK	2-2.5" CAL.	27	B&B CLEAR STEM TO 6'
MALUS	HARVEST GOLD FLOWERING CRAB	2-2" CAL.	6	B&B CLEAR
PINUS NIGRA	AUSTRIAN PINE	5-6' HT	9	B&B
PICEA OLIACA DENSATA	BLACK HILLS SPRUCE	5-6' HT	3	B&B
PICEA ABIES	NORWAY SPRUCE	5-6' HT	3	B&B
PHYSOCARPUS OULIFOLIUS	WINTERBERRY	30-36" HT	100	CONTAINER
PICEA GLAUCA	WHITE SPRUCE	5-6' HT	9	B&B

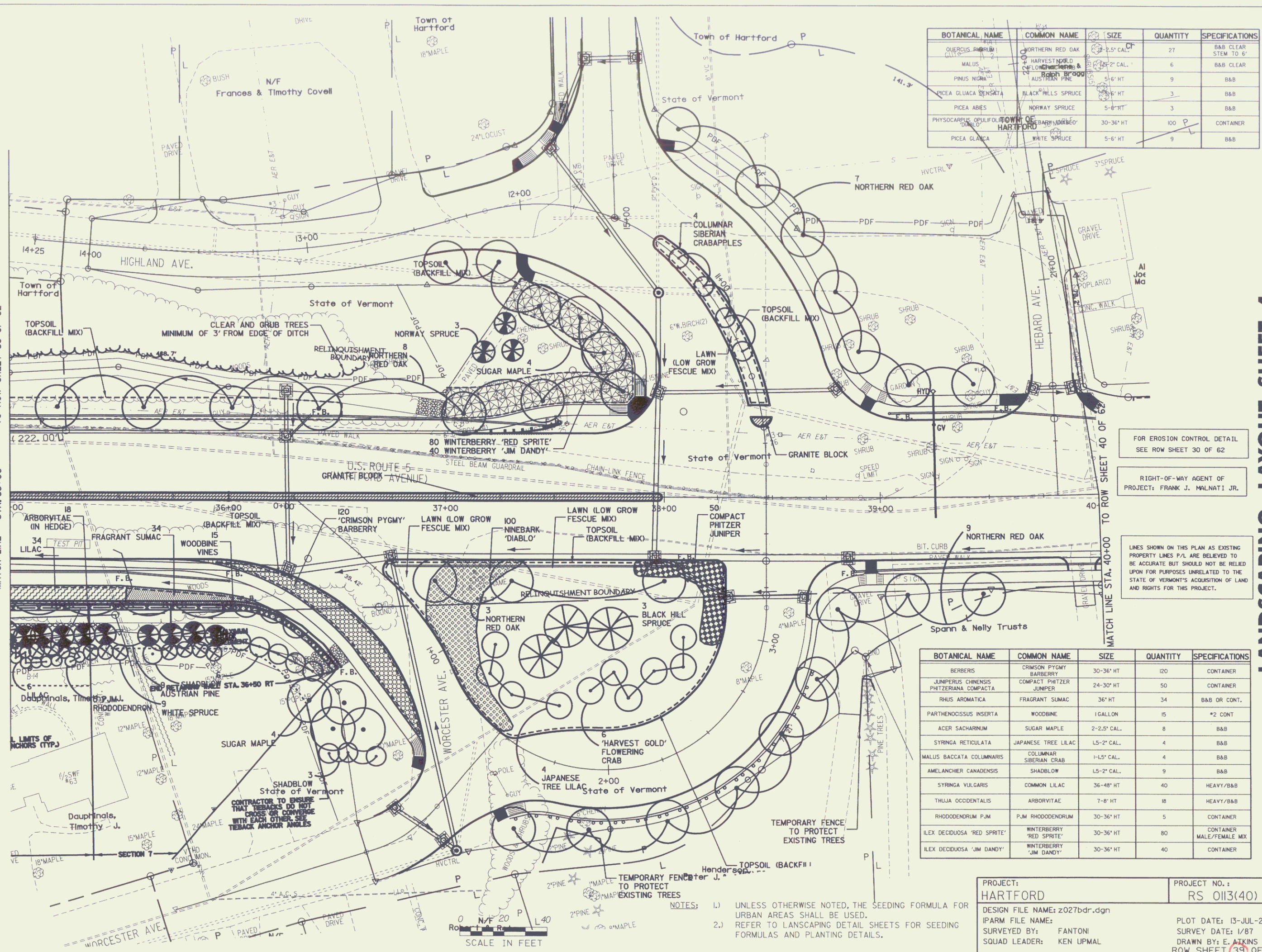

BOTANICAL NAME	COMMON NAME	SIZE	QUANTITY	SPECIFICATIONS
BERBERIS	CRIMSON PYGMY BARBERRY	30-36" HT	120	CONTAINER
JUNIPERUS CHINENSIS	COMPACT PHITZER JUNIPER	24-30" HT	50	CONTAINER
RHUS AROMATICA	FRAGRANT SUMAC	36" HT	34	B&B OR CONT.
PARTHENOCISSUS INSERTA	WOODBINE	1 GALLON	15	*2 CONT
ACER SACHARINUM	SUGAR MAPLE	2-2.5" CAL.	8	B&B
SYRINGA RETICULATA	JAPANESE TREE LILAC	1.5-2" CAL.	4	B&B
MALUS BACCATA COLUMNARIS	COLUMNAR SIBERIAN CRAB	1-1.5" CAL.	4	B&B
AMELANCHIER CANADENSIS	SHADBLow	1.5-2" CAL.	9	B&B
SYRINGA VULGARIS	COMMON LILAC	36-48" HT	40	HEAVY/B&B
THUJA OCCIDENTALIS	ARBORVITAE	7-8" HT	18	HEAVY/B&B
RHODODENDRUM P.J.M.	P.J.M. RHODODENDRUM	30-36" HT	5	CONTAINER
ILEX DECIDUOSA 'RED SPRITE'	WINTERBERRY 'RED SPRITE'	30-36" HT	80	CONTAINER MALE/FEMALE MIX
ILEX DECIDUOSA 'JIM DANDY'	WINTERBERRY 'JIM DANDY'	30-36" HT	40	CONTAINER

PROJECT: **HARTFORD** PROJECT NO.: **RS 0113(40)**

DESIGN FILE NAME: z027bdr.dgn PLOT DATE: 13-JUL-2006

IPARM FILE NAME: SURVEYED BY: FANTONI SURVEY DATE: 1/87

SQUAD LEADER: KEN UPMAL DRAWN BY: E. ATKINS

ROW SHEET **39** OF 62

LANDSCAPING LAYOUT SHEET 4