

BOTANICAL NAME	COMMON NAME	SIZE	QUANTITY	SPECIFICATIONS
QUERCUS RUBRUM	NORTHERN RED OAK	3.5-4" CAL.	3	B&B CLEAR STEM TO 6'
PINUS NIGRA	AUSTRIAN PINE	5-6' HT	10	B&B
BIG PINUS STROBUS	WHITE PINE	5-6' HT	10	B&B
SMALL PINUS STROBUS	WHITE PINE	3-4' HT	48	B&B
PICEA ABIES	NORWAY SPRUCE	5-6' HT	3	B&B
PICEA GLAUCA	WHITE SPRUCE	5-6' HT	26	B&B
PARTHENOCISSUS INSERTA	WOODBINE	1 GALLON	60	*2 CONT.
AMELANCHER CANADENSIS	SHADBLow	1-1.5' CAL.	30	B&B
SYRINGA VULGARIS	LILAC	30-36" HT	71	CONT./HEAVY
VIBURNUM LENTAGO	NANNY BERRY	36-40" HT	65	CONT./HEAVY
PHYSOCARPUS OPULIFOLIUS	NINEBARK	30-36" HT	30	CONTAINER
WEIGELIA FLORIDA	WEIGELIA	30-36" HT	5	CONTAINER
VIBURNUM DENTATUM	ARROWWOOD	30-36" HT	11	CONTAINER
RHOODODENDRUM PJM	PJM RHODODENDRUM	30-36" HT	5	CONTAINER
ILEX DECIDUA	DECIDUOUS HOLLY	30-36" HT	3	CONTAINER MALE&FEMALE MIX

Smith, Everett J. & Sandra F.

CLEARING AND GRUBBING  
(INCLUDING INDIVIDUAL TREES AND STUMPS)  
30+00 - 35+00 RT  
30+00 - 35+00 LT

TOPSOIL (BACKFILL MIX)  
30+05 - 35+00 RT 18" WIDE X 2' DEEP @ TOE OF WALL  
34+30 - 35+00 LT 00" WIDE X 2' DEEP

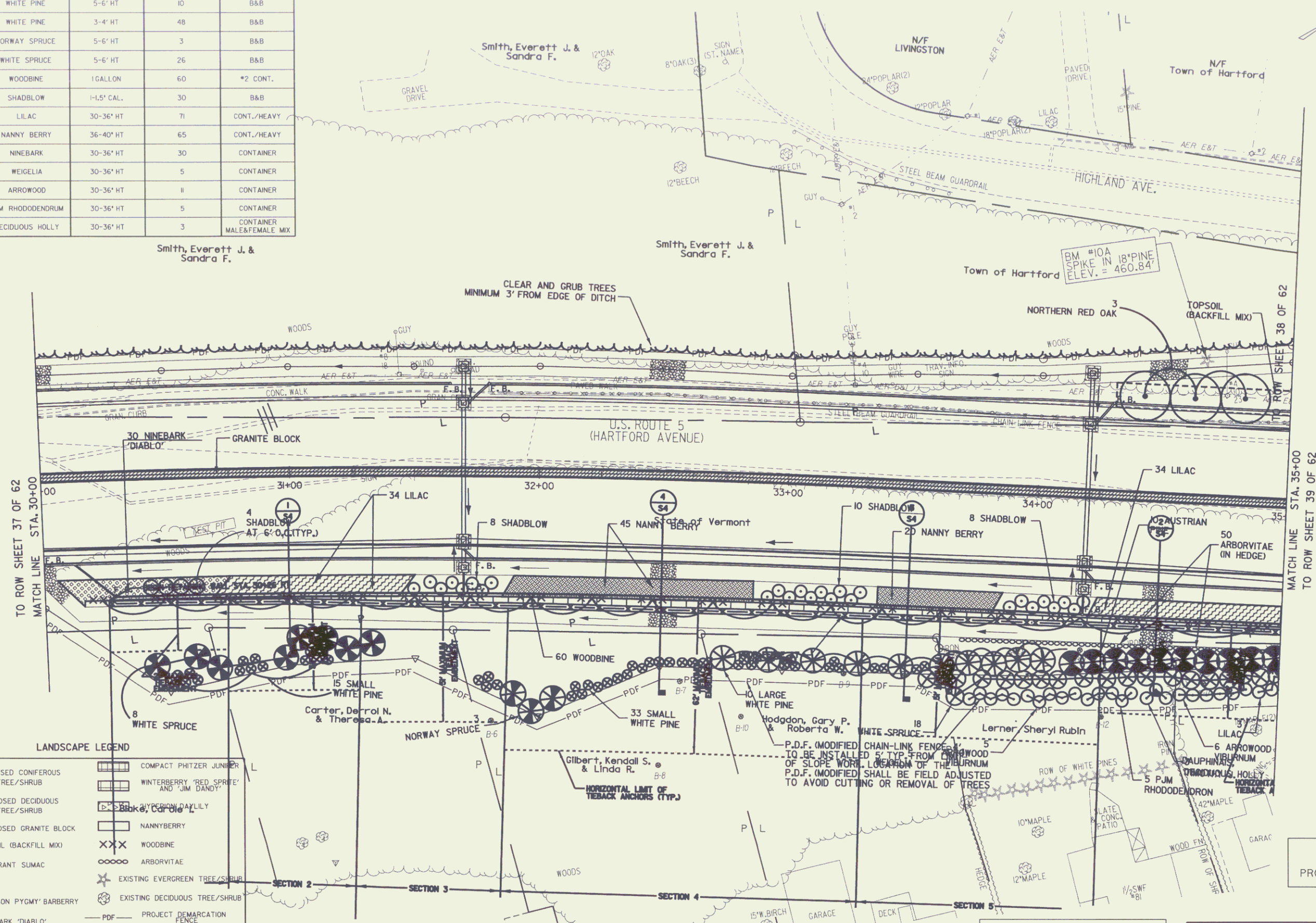

LANDSCAPE LEGEND

	PROPOSED CONIFEROUS TREE/SHRUB		COMPACT PHYTZER JUNIPER
	PROPOSED DECIDUOUS TREE/SHRUB		WINTERBERRY 'RED SPRUCE' AND 'JIM DANDY'
	PROPOSED GRANITE BLOCK		NANNYBERRY
	TOPSOIL (BACKFILL MIX)		WOODBINE
	FRAGRANT SUMAC		ARBORVITAE
	LILAC		EXISTING EVERGREEN TREE/SHRUB
	'CRIMSON PYGMY' BARBERRY		EXISTING DECIDUOUS TREE/SHRUB
	NINEBARK 'DIABLO'		PROJECT FENCE

DATUM  
VERTICAL NGVD 1929  
HORIZONTAL N

NOTES: 1) UNLESS OTHERWISE SPECIFIED, SEEDING FORMULA FOR ALL PLANTINGS SHALL BE USED.  
2) REFER TO LANDSCAPING DETAIL SHEETS FOR SEEDING FORMULAS AND PLANTING DETAILS.

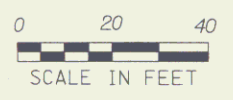

FOR EROSION CONTROL DETAIL  
SEE ROW SHEET 29 OF 62

Lines shown on this plan as existing property lines P/L are believed to be accurate but should not be relied upon for purposes unrelated to the state of Vermont's acquisition of land and rights for this project.

PROJECT: HARTFORD  
DESIGN FILE NAME: z027bdr.dgn  
IPARM FILE NAME:  
SURVEYED BY: FANTONI  
SQUAD LEADER: KEN UPMAL

PROJECT NO.: RS 013(40)  
PLOT DATE: 13-JUL-2006  
SURVEY DATE: 1/87  
DRAWN BY: E. ATKINS  
ROW SHEET 38 OF 62

RIGHT-OF-WAY AGENT OF PROJECT: FRANK J. MALNATI JR.

LANDSCAPING LAYOUT SHEET 3