

CLEARING AND GRUBBING
(INCLUDING INDIVIDUAL TREES AND STUMPS)
29+50 ~ 30+00 RT
26+45 ~ 30+00 LT

TOPSOIL (BACKFILL MIX)
26+50 ~ 29+20 LT (2' DEEP)
25+00 ~ 29+20 RT (60' WIDE X 2' DEEP)
25+00 ~ 25+90 (MEDIAN ISLAND - VARIABLE WIDTH X 2' DEEP)

BOTANICAL NAME	COMMON NAME	SIZE	QUANTITY	SPECIFICATIONS
ULMUS AMERICANA 'VALLEY FORGE'	AMERICAN ELM 'VALLEY FORGE'	2.5-3' CAL.	4	B&B CLEAR STEM TO 6'
AMELANCHIER CANADENSIS	SHADBLOW	10-12FT	9	B&B
PHYTOSCARPUS OPULIFOLIUS 'DIABLO'	NINEBARK 'DIABLO'	30-36" HT	120	CONTAINER
ACER X FREEMANI	FREEMAN MAPLE 'AUTUMN BLAZE'	2.5-3' CAL.	4	B&B
ZELKOVA SERATA	ZELKOVA 'GREEN VASE'	2.5-3' CAL.	4	B&B

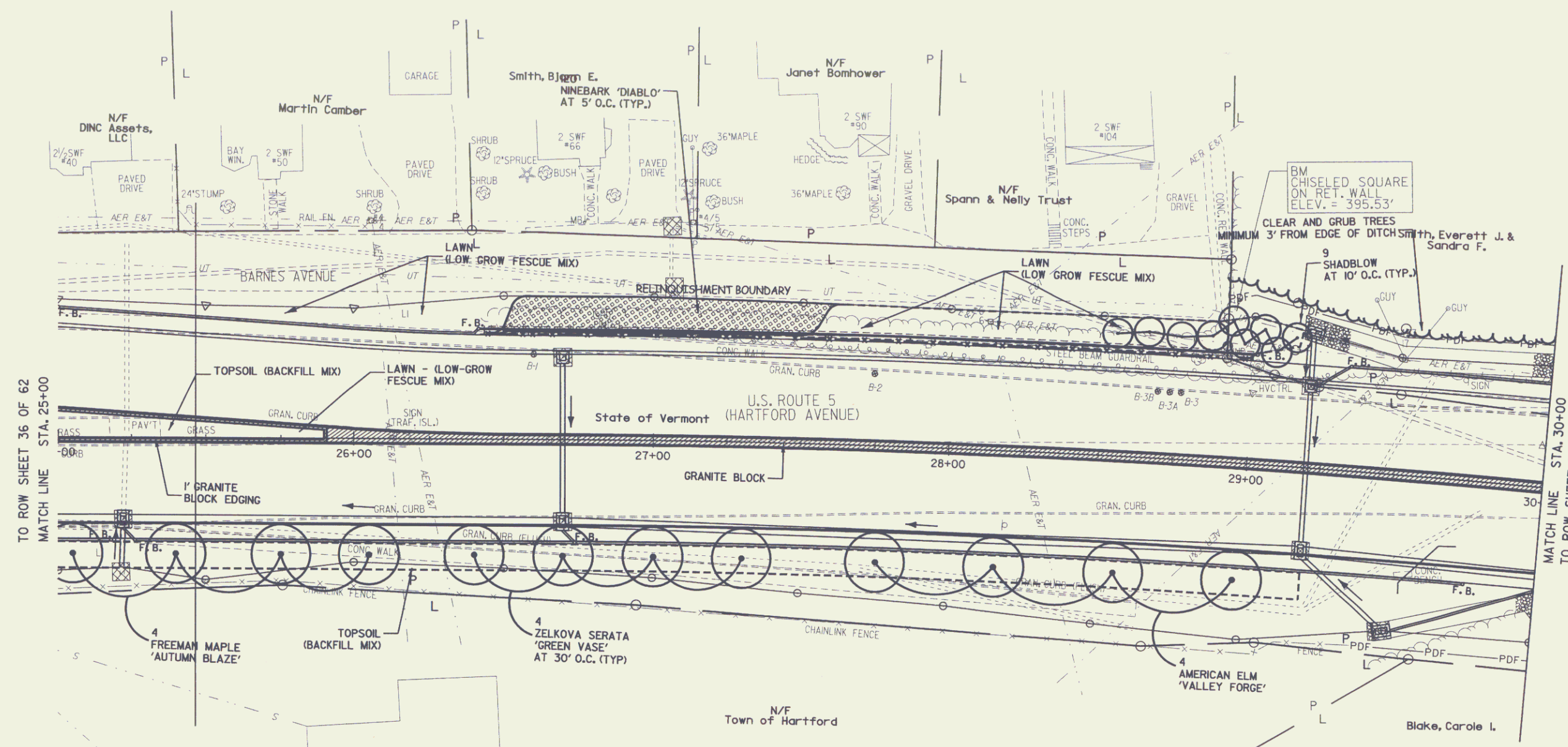

LANDSCAPING LAYOUT SHEET 2

LANDSCAPE LEGEND

	PROPOSED CONIFEROUS TREE/SHRUB		COMPACT PFTZER JUNIPER
	PROPOSED DECIDUOUS TREE/SHRUB		WINTERBERRY 'RED SPRITE' AND 'JIM DANDY'
	PROPOSED GRANITE BLOCK		NANNYBERRY
	TOPSOIL (BACKFILL MIX)		WOODBINE
	FRAGRANT SUMAC		ARBORVITAE
	LILAC		EXISTING EVERGREEN TREE/SHRUB
	'CRIMSON PYGMY' BARBERRY		EXISTING DECIDUOUS TREE/SHRUB
	NINEBARK 'DIABLO'		PROJECT DEMARCATION FENCE

DATUM
VERTICAL N/A
HORIZONTAL N/A

NOTES: 1) UNLESS OTHERWISE NOTED, THE SEEDING FORMULA FOR URBAN AREAS SHALL BE USED. SHEETS FOR SEEDING FORMULAS AND PLANTING DETAILS.

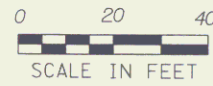

FOR EROSION CONTROL DETAIL
SEE ROW SHEET 28 OF 62

RIGHT-OF-WAY AGENT OF
PROJECT: FRANK J. MALNATI JR.

LINES SHOWN ON THIS PLAN AS EXISTING PROPERTY LINES P/L ARE BELIEVED TO BE ACCURATE BUT SHOULD NOT BE RELIED UPON FOR PURPOSES UNRELATED TO THE STATE OF VERMONT'S ACQUISITION OF LAND AND RIGHTS FOR THIS PROJECT.

PROJECT: HARTFORD	PROJECT NO.: RS 0113(40)
DESIGN FILE NAME: z027bdr.dgn	PLOT DATE: 13-JUL-2006
IPARM FILE NAME:	SURVEY DATE: 1/87
SURVEYED BY: FANTONI	DRAWN BY: E. ATKINS
SQUAD LEADER: KEN UPMAL	ROW SHEET 37 OF 62