

LANDSCAPING LAYOUT SHEET 1

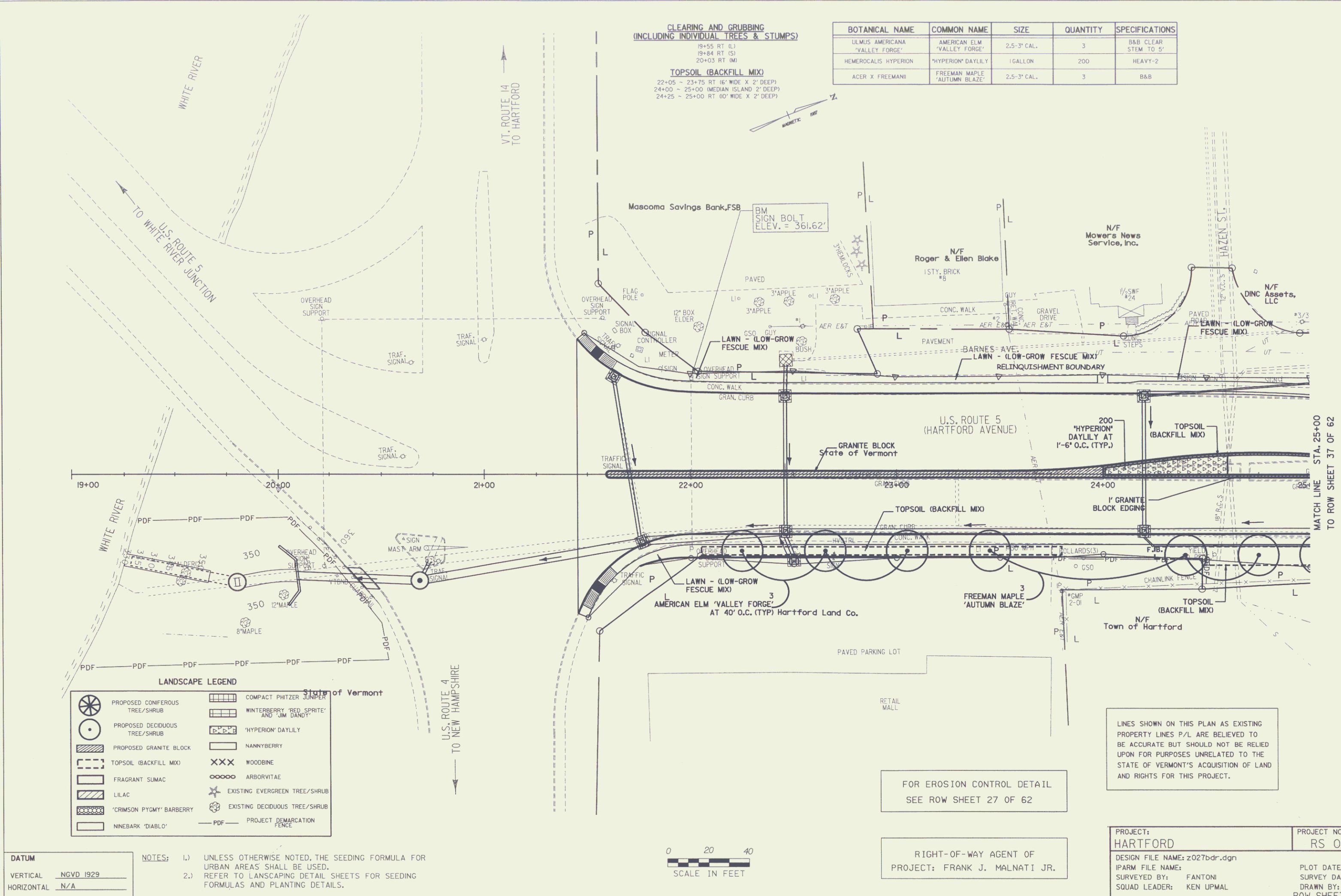

**CLEARING AND GRUBBING
(INCLUDING INDIVIDUAL TREES & STUMPS)**
 19+55 RT (L)
 19+84 RT (S)
 20+03 RT (M)

TOPSOIL (BACKFILL MIX)
 22+05 - 23+75 RT (6' WIDE X 2' DEEP)
 24+00 - 25+00 (MEDIAN ISLAND 2' DEEP)
 24+25 - 25+00 RT (10' WIDE X 2' DEEP)

BOTANICAL NAME	COMMON NAME	SIZE	QUANTITY	SPECIFICATIONS
ULMUS AMERICANA 'VALLEY FORGE'	AMERICAN ELM 'VALLEY FORGE'	2.5-3" CAL.	3	B&B CLEAR STEM TO 5'
HEMEROCALIS HYPERION	'HYPERION' DAYLILY	1 GALLON	200	HEAVY-2
ACER X FREEMANI	FREEMAN MAPLE 'AUTUMN BLAZE'	2.5-3" CAL.	3	B&B

LANDSCAPE LEGEND

	PROPOSED CONIFEROUS TREE/SHRUB		COMPACT PFITZER JUNIPER
	PROPOSED DECIDUOUS TREE/SHRUB		WINTERBERRY 'RED SPRITE' AND 'JIM DANDY'
	PROPOSED GRANITE BLOCK		'HYPERION' DAYLILY
	TOPSOIL (BACKFILL MIX)		NANNYBERRY
	FRAGRANT SUMAC		WOODBINE
	LILAC		ARBORVITAE
	'CRIMSON PYGMY' BARBERRY		EXISTING EVERGREEN TREE/SHRUB
	NINEBARK 'DIABLO'		EXISTING DECIDUOUS TREE/SHRUB
	PROJECT DEMARCATION FENCE		

DATUM
 VERTICAL NGVD 1929
 HORIZONTAL N/A

NOTES: 1.) UNLESS OTHERWISE NOTED, THE SEEDING FORMULA FOR URBAN AREAS SHALL BE USED.
 2.) REFER TO LANDSCAPING DETAIL SHEETS FOR SEEDING FORMULAS AND PLANTING DETAILS.



FOR EROSION CONTROL DETAIL
 SEE ROW SHEET 27 OF 62

RIGHT-OF-WAY AGENT OF
 PROJECT: FRANK J. MALNATI JR.

LINES SHOWN ON THIS PLAN AS EXISTING PROPERTY LINES P/L ARE BELIEVED TO BE ACCURATE BUT SHOULD NOT BE RELIED UPON FOR PURPOSES UNRELATED TO THE STATE OF VERMONT'S ACQUISITION OF LAND AND RIGHTS FOR THIS PROJECT.

PROJECT: HARTFORD	PROJECT NO.: RS 0113(40)
DESIGN FILE NAME: z027bdr.dgn	PLOT DATE: 13-JUL-2006
FARM FILE NAME:	SURVEY DATE: 1/87
SURVEYED BY: FANTONI	DRAWN BY: E. ATKINS
SQUAD LEADER: KEN UPMAL	ROW SHEET (36) OF 62