

526+00 to 535+70
 It is the intent of the plans to save as many trees as possible on the left trees to be cut as directed by the Engineer and to be paid for under bid Item 101 or Item 109

PARCEL INSTRUMENT DATE GRANTOR GRANTEE RECORDED RETURN
 A. B. W.D.B.E. 4-11-41 J.C. HOYT, H.K. HOYT & ETHEL TONNE ST. OF VT. VOLCOTT BOOK PAGE DATE 3012 1-3-41

Sta 532+00 to Sta 535+79
 Crossed timber cord Item 78
 2 1/2" Refined Bit Gravel Shoulder Course
 Item 30 B with Refined Tar Item 30

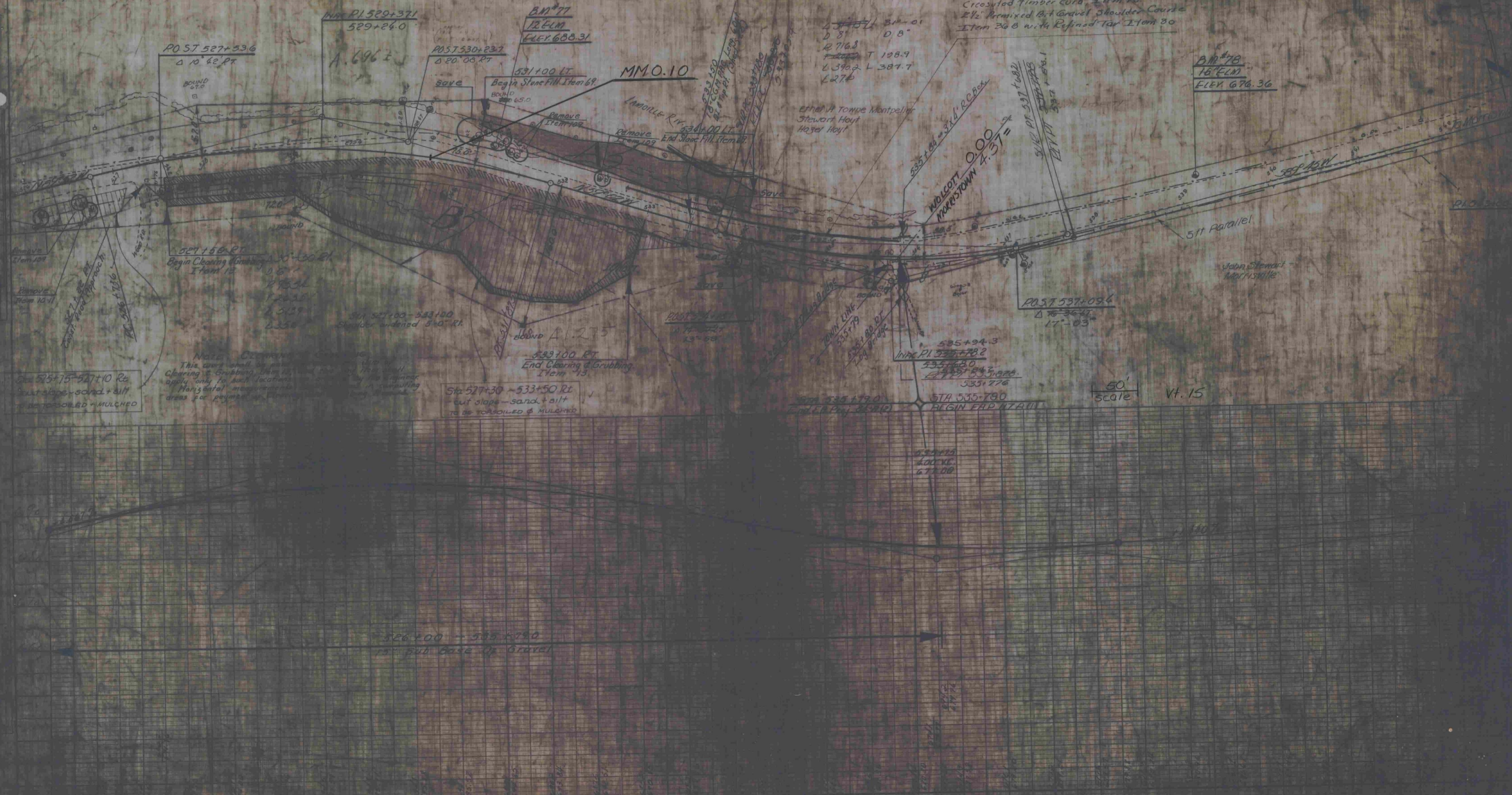

Note: Clearing
 This work shall be paid for under bid Item 101 or Item 109. The work shall be paid for under bid Item 101 or Item 109. Horizontal measurements apply only to such locations as shown in computing areas for payment in Item 101 or Item 109.

Sta 525+15-527+10 R/L
 cut slope - sand + silt
 to be troweled + mulched

Sta 527+30-533+50 R/L
 cut slope - sand + silt
 to be troweled & mulched

526+00 - 535+70
 sub base of gravel

MORRISTOWN-VOLCOTT
 F 030-2(10)
 sheet 64 of 108