

VERMONT R.O.W. PLANS

STATE OF VERMONT
 AGENCY OF TRANSPORTATION
 &
 THE STATE OF NEW HAMPSHIRE
 DEPARTMENT OF TRANSPORTATION

RIGHT-OF-WAY
 PLANS OF PROPOSED
 FEDERAL AID PROJECT

DPR-BRM-T-0038(001)
 N.H. PROJECT NO. 10029-A
 N.H. ROUTE 10A
 VT. ROUTE 10A & SA2
 LENGTH OF VT. R.O.W. PROJECT 401.00 FT.
 LEDYARD BRIDGE REPLACEMENT

BEGIN VT. R.O.W. PROJECT
 HANOVER-NORWICH BRM 5203(4)
 STA. 405+10 CL RIVER RD. SA#2

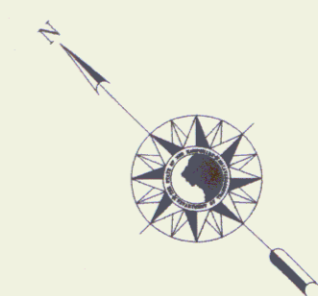
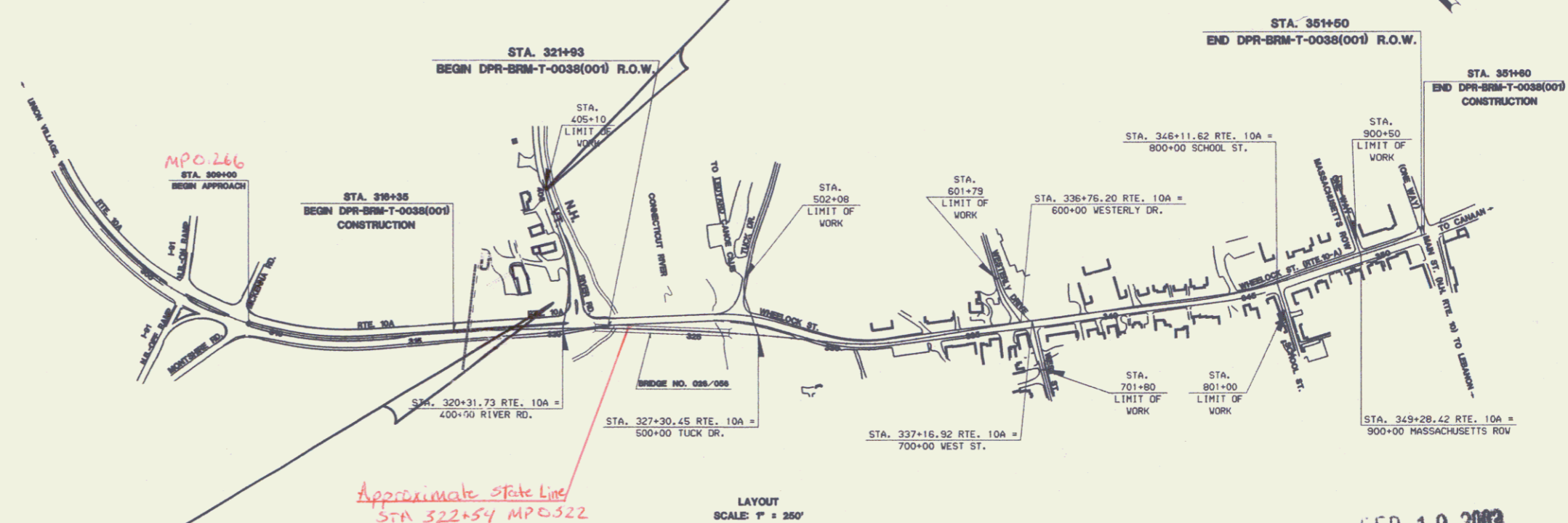
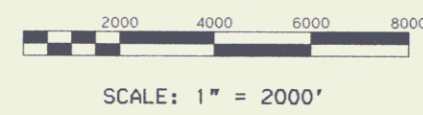
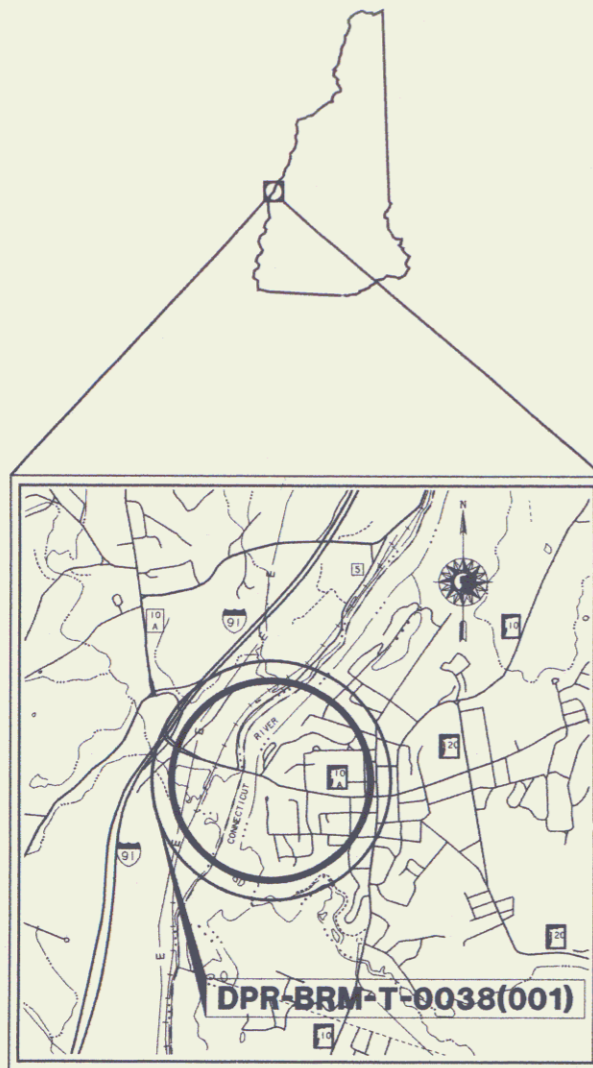

END VT. R.O.W. PROJECT
 HANOVER-NORWICH BRM 5203(4)
 STA. 401+09 67' LT. RIVER RD. SA#2

ALL DRIVES AS INDICATED ON PLANS
 ARE SUBJECT TO PERMITS PURSUANT
 TO TITLE 19 SECTION III, V.S.A.

TOWNS OF HANOVER, NH AND NORWICH, VT
 COUNTIES OF GRAFTON, NH AND WINDSOR, VT

PRELIMINARY PLANS
 SUBJECT TO CHANGE
 DATE APRIL 6, 1995

Pin # 85E05B
 VT. AOT
 APPROVED: *[Signature]* DATE: 5/19/95
 Director of Engineering
 APPROVED: *[Signature]* DATE: 5/19/95
 Chief, Right of Way
 TOWNS NORWICH-HANOVER
 Project BRM 5203(4)
 R.O.W. SHEET 1 OF 14 SHEETS

FEB 19 2003

NHDOT THE STATE OF NEW HAMPSHIRE DEPARTMENT OF TRANSPORTATION	
RECOMMENDED FOR APPROVAL:	
DIRECTOR OF PROJECT DEVELOPMENT	DATE
ADMINISTRATOR, BUREAU OF MUNICIPAL HIGHWAYS	DATE
APPROVED: _____	DATE
COMMISSIONER	DATE
U. S. DEPARTMENT OF TRANSPORTATION FEDERAL HIGHWAY ADMINISTRATION	
APPROVED: _____	DATE
DIVISION ADMINISTRATOR	DATE
FEDERAL PROJECT NO. DPR-BRM-T-0038(001)	STATE PROJECT NO. 10029-A
SHEET NO. 1	TOTAL SHEETS 25

DRAWN BY: J. DEWIRST
 CHECKED BY: P. SALO
 DATE: 4/15/95
 DATE: 5/15/95

ENGINEERING

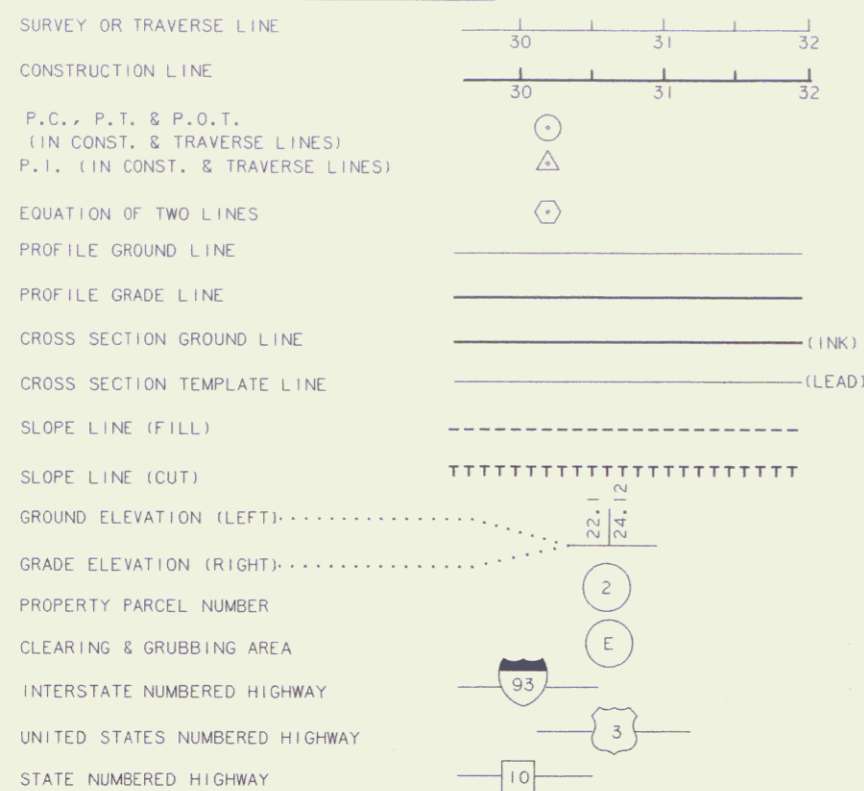

DRAINAGE



BOUNDARIES

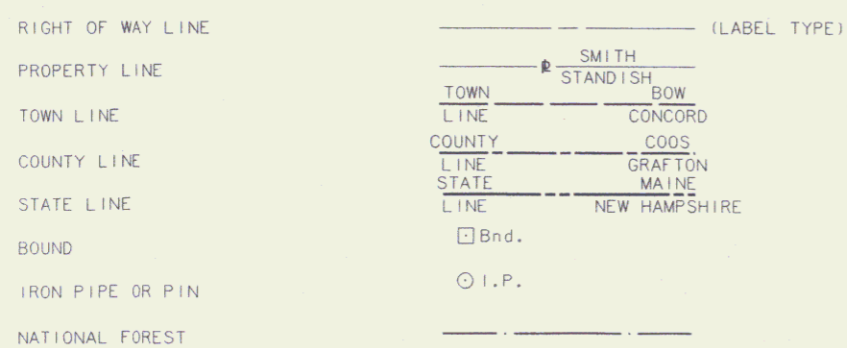

UTILITIES

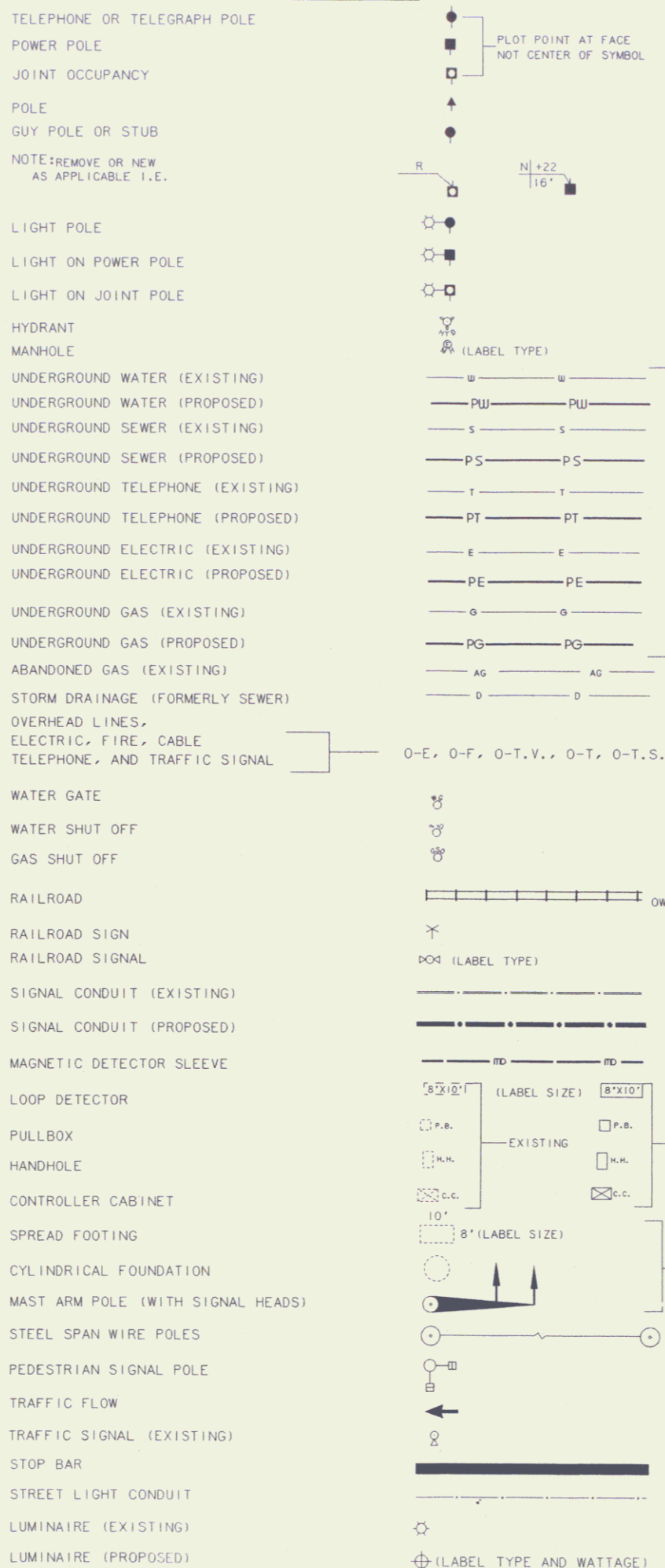

GENERAL CULTURE

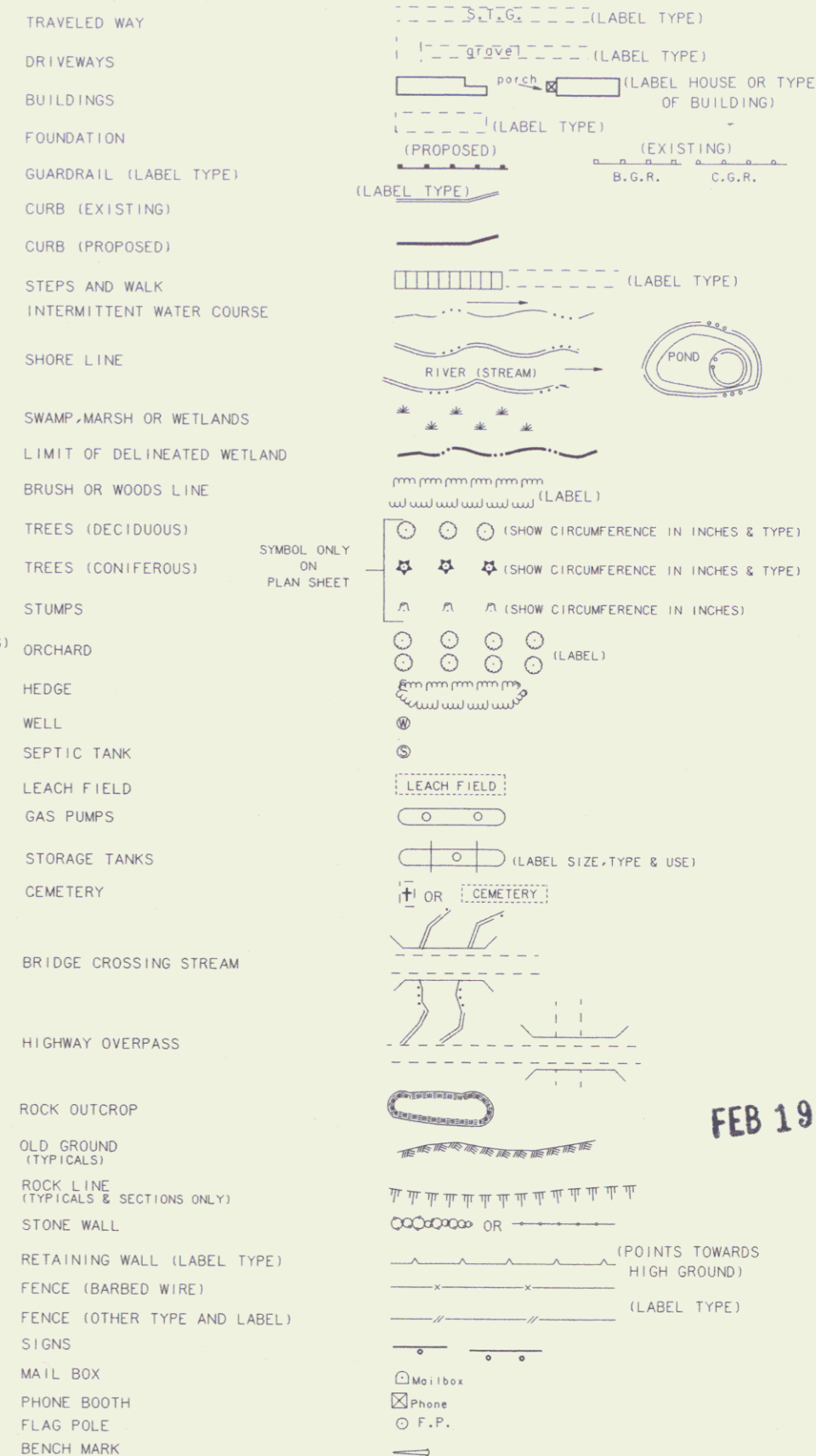

FEB 19 2003

NORWICH-HANOVER BRM 5203(4)
VERMONT ROW SHEET 2 OF 14

STATE OF NEW HAMPSHIRE
DEPARTMENT OF TRANSPORTATION - BUREAU HIGHWAY DESIGN

STANDARD SYMBOLS

2

REVISION DATE	WINDOW NAME	.JFB FILENAME	FEDERAL PROJECT NO.	STATE PROJECT NO.	SHEET NO.	TOTAL SHEETS
★ 3-17-92	SYMBOL	TYPICALS	DPR-BRM-1-0038(1001)	10029A	2	25

EXISTING DETAIL	DATE	DATE	DATE	DATE
	PROPOSED DESIGN	5-22-94	5-22-94	
SHEET CHECKED	BY	BY	BY	BY
	K. RUSSELL	P. SHLO		
AS BUILT DETAILS	DATE	DATE	DATE	DATE
NOTEBOOKS	BOOK	PAGE	BOOK	PAGE
REVISIONS AFTER PROPOSAL	NUMBER	DATE	STATION	DESCRIPTION

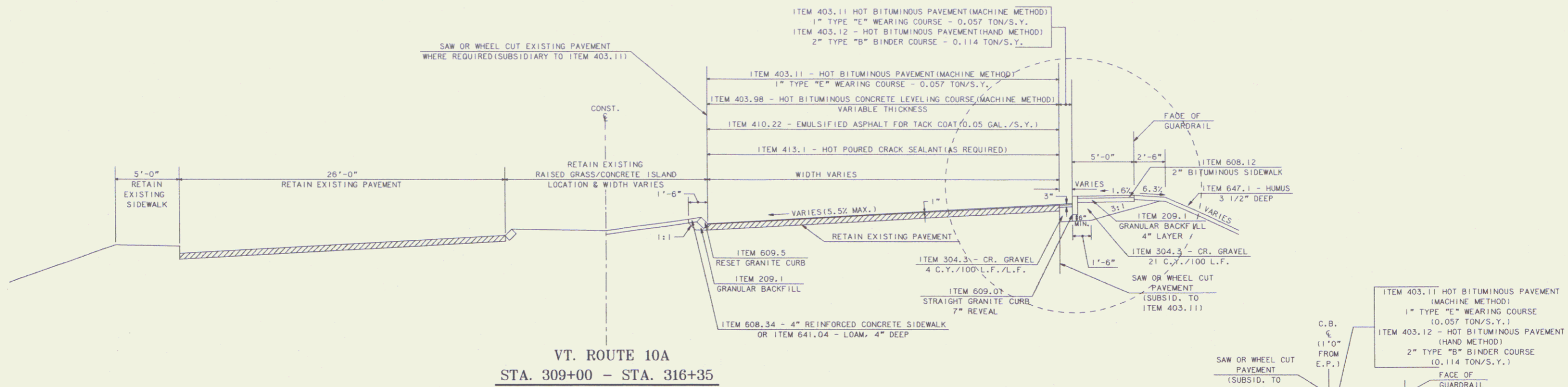

VT. ROUTE 10A
STA. 309+00 - STA. 316+35

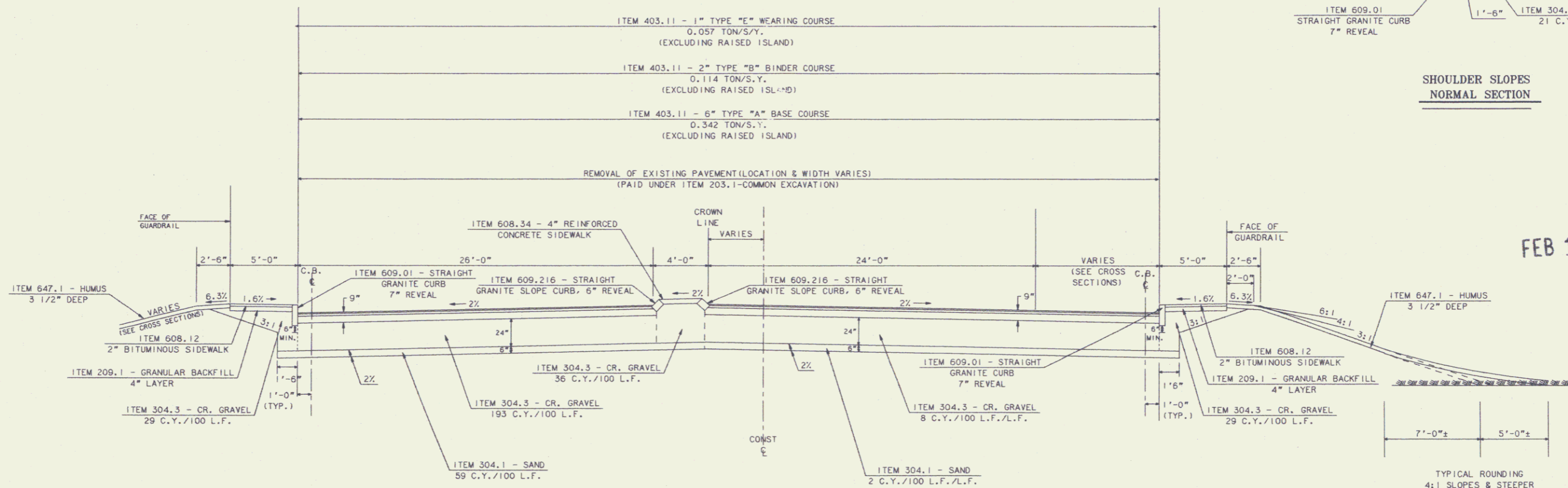

VT. ROUTE 10A
STA. 317+28 - STA. 320+00

FEB 19 2003

NORWICH-HANOVER BRM 5203 (4)
VERMONT ROW SHEET (3) OF 14
STATE OF NEW HAMPSHIRE
DEPARTMENT OF TRANSPORTATION • BUREAU HIGHWAY DESIGN
TYPICAL SECTIONS OF IMPROVEMENT

SCALE: 1" = 4'

REVISION DATE	WINDOW NAME	FOR FILENAME	FEDERAL PROJECT NO.	STATE PROJECT NO.	SHEET NO.	TOTAL SHEETS
4-4-95	VTROUTE10A	TYPICALS	DPR-BRM-T-0038(001)	10029A	X	25

EXISTING DETAIL	DATE	BY	REVISIONS AFTER PROPOSAL	DESCRIPTION
PROPOSED DESIGN	7-08-84	K. RUSSELL		
SHEET CHECKED	7-08-84	P. SNAPO		
AS BUILT DETAILS				

NOTEBOOKS	STATION	DATE	NUMBER
BOOK			
BOOK			
BOOK			

REVISIONS	DATE	BY	DESCRIPTION

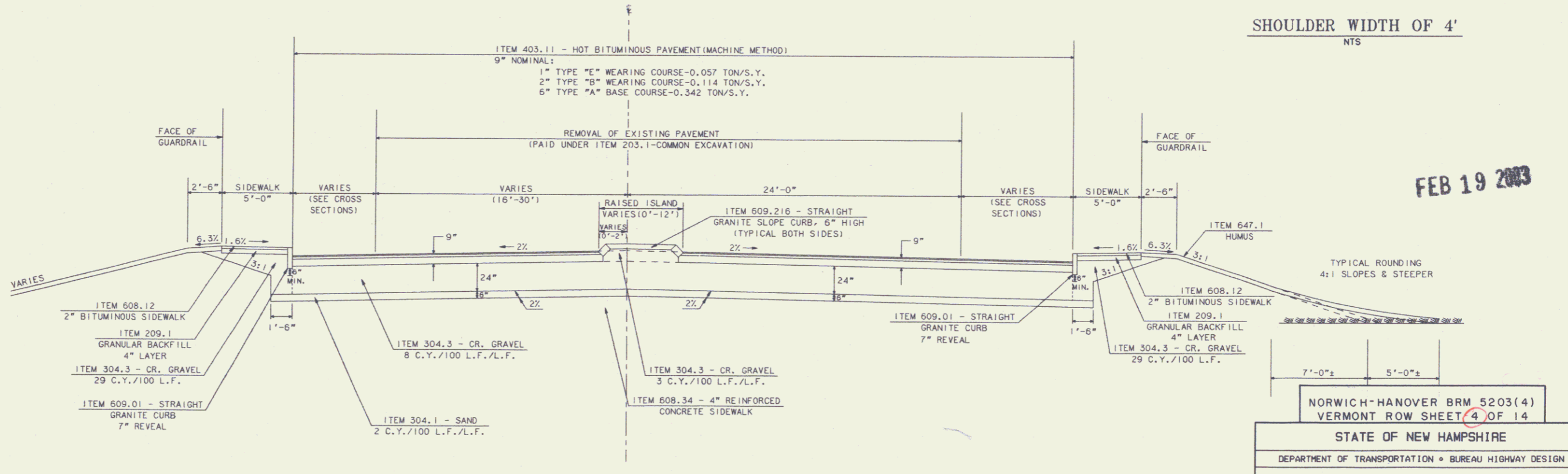
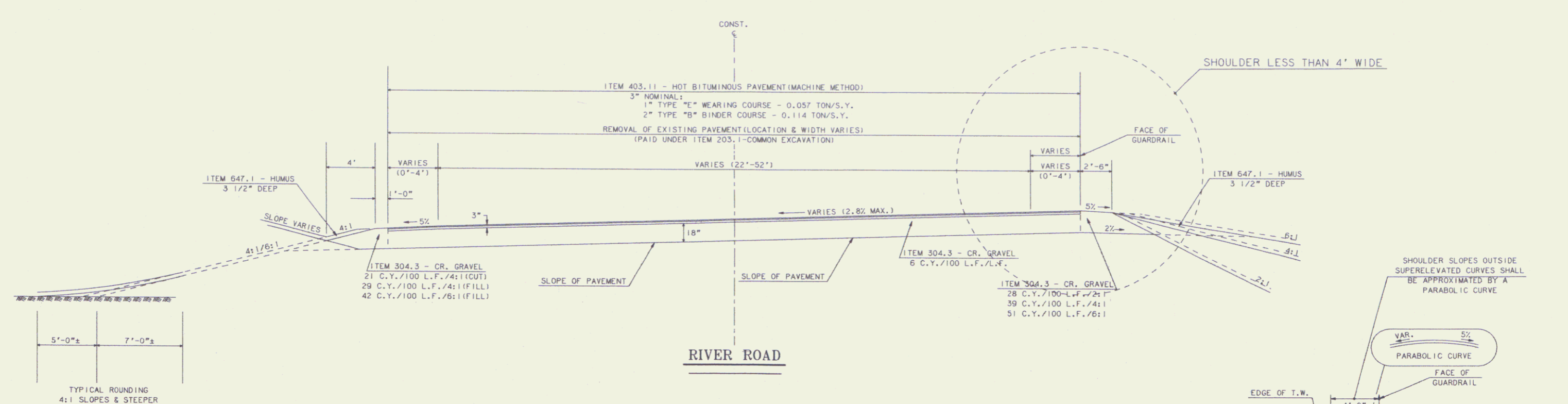

FEB 19 2003

VT. ROUTE 10A
STA. 320+00 - 321+62.5

NORWICH-HANOVER BRM 5203(4)
VERMONT ROW SHEET 4 OF 14
STATE OF NEW HAMPSHIRE
DEPARTMENT OF TRANSPORTATION • BUREAU HIGHWAY DESIGN
TYPICAL SECTIONS OF IMPROVEMENT

SCALE: 1" = 4'						
REVISION DATE	WINDOW NAME	FILE NAME	FEDERAL PROJECT NO.	STATE PROJECT NO.	SHEET NO.	TOTAL SHEETS
4-2-95	RIVERRD	TYPICALS	DPR-BRM-T-0038(001)	10029A	X	25

EXISTING DETAIL	K. BULL	DATE	10-27-94
PROPOSED DESIGN	J. BULL	DATE	10-27-94
SHEET CHECKED	J. DENHIRST	DATE	11-04-94
AS BUILT DETAILS		DATE	

REVISIONS AFTER PROPOSAL	NUMBER	DATE	STATION	DESCRIPTION

NOTEBOOKS	NUMBER	DATE	STATION	DESCRIPTION

BOOK	PAGE
BOOK	PAGE
BOOK	PAGE

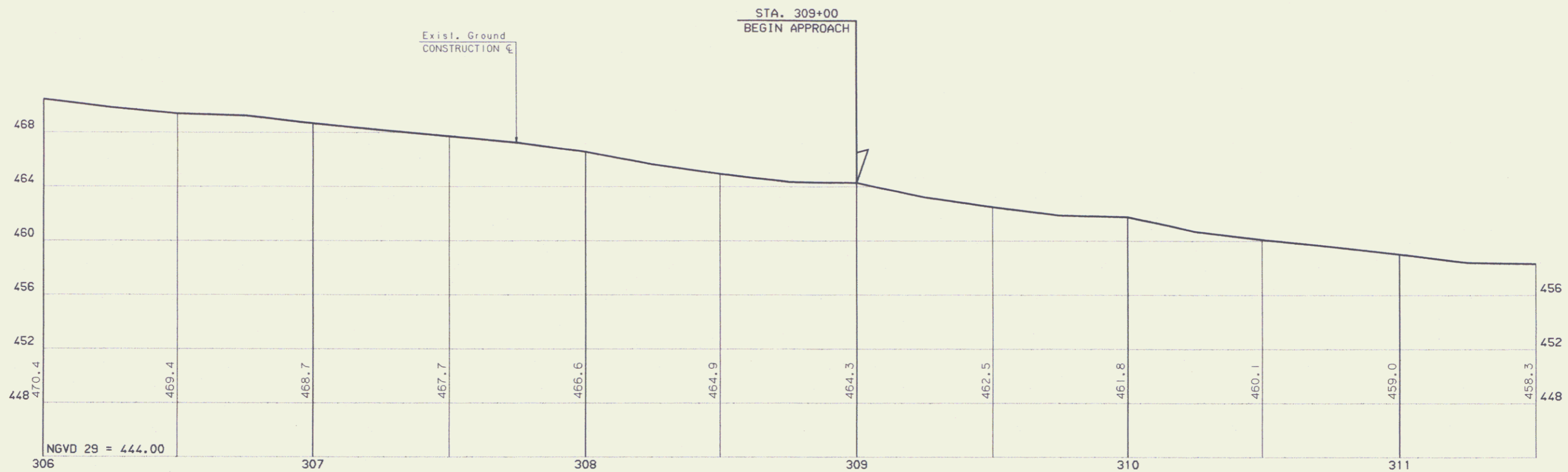

VERMONT RTE. 10A

SCALE: 1" = 20' HORIZ.
1" = 4' VERT.

FEB 19 2003

FOR INFORMATION ONLY

NORWICH-HANOVER BRM 5203(4)
VERMONT ROW SHEET 5 OF 14

STATE OF NEW HAMPSHIRE
DEPARTMENT OF TRANSPORTATION • BUREAU HIGHWAY DESIGN
VERMONT RTE. 10A PROFILE
STA. 306+00 TO STA. 311+50

WINDOW NAME	.JOB FILENAME	FEDERAL PROJECT NO.	STATE PROJECT NO.	SHEET NO.	TOTAL SHEETS
PROFILE1	PROFILES	DPR-BRN-T-0038(001)	10029A	14	25

5

EXISTING DESIGN	K. RUS	DATE	10-27-94
PROPOSED DESIGN	J. BUTLER	DATE	10-27-94
SHEET CHECKED	J. DEWHRST	DATE	11-04-94
AS BUILT DETAILS		DATE	

REVISIONS AFTER PROPOSAL	NUMBER	DATE	STATION	DESCRIPTION

NOTEBOOKS	BOOK	PAGE

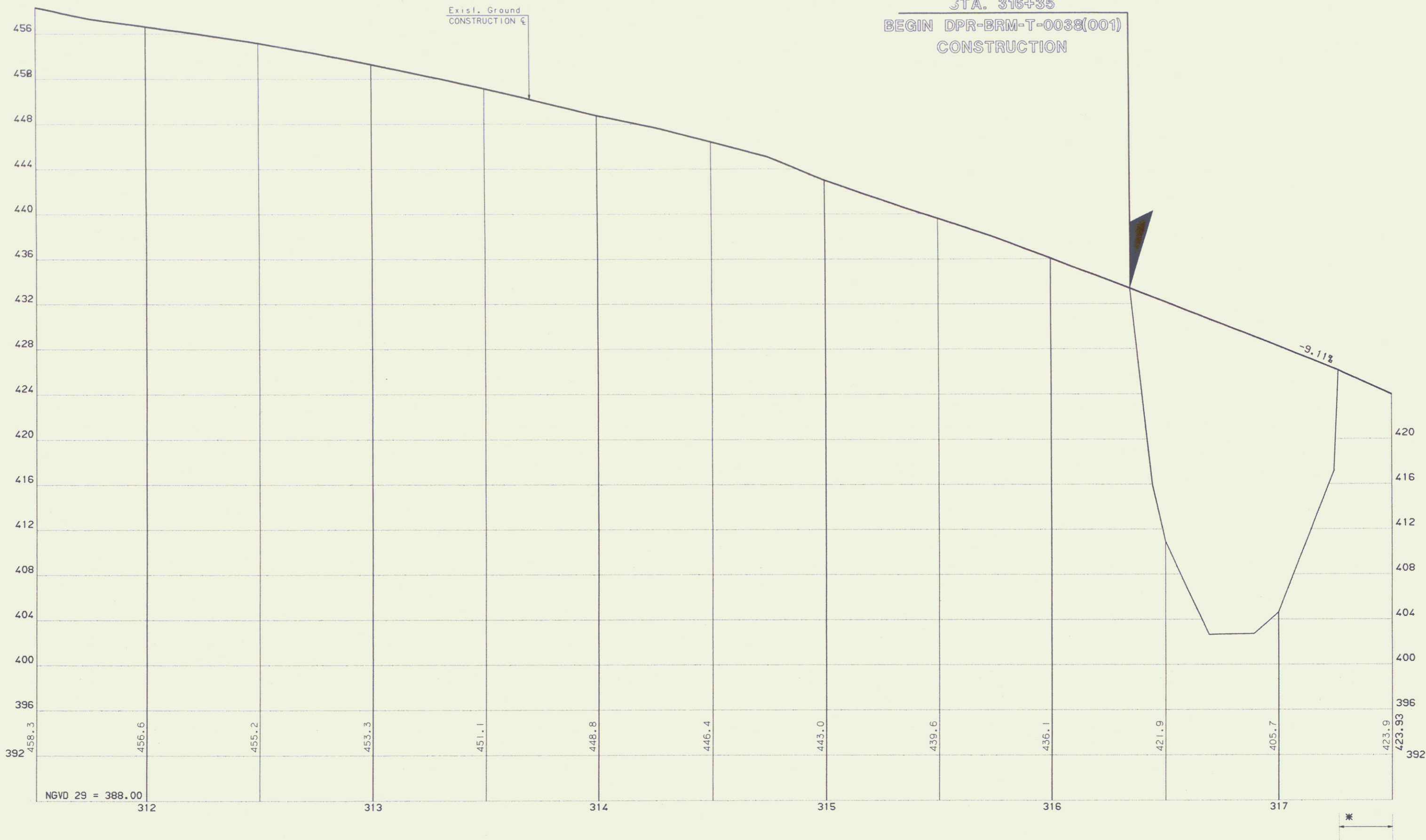

FOR INFORMATION ONLY

VERMONT RTE. 10A

SCALE: 1" = 20' HORIZ.
1" = 4' VERT.

* NOTE: APPROACH SLAB LOCATION
24" CRUSHED GRAVEL
6" SAND

NORWICH-HANOVER BRM 5203(4)
VERMONT ROW SHEET 6 OF 14

FEB 19 2003

STATE OF NEW HAMPSHIRE
DEPARTMENT OF TRANSPORTATION • BUREAU HIGHWAY DESIGN
VERMONT RTE. 10A PROFILE
STA. 311+50 TO STA. 317+50

WINDOW NAME	.JFB FILENAME	FEDERAL PROJECT NO.	STATE PROJECT NO.	SHEET NO.	TOTAL SHEETS
PROFILEZ	PROFILES	DPR-BRM-T-0038(001)	10029A	15	25

EXISTING DETAIL		K. RUSSELL		DATE	10-27-84
PROPOSED DESIGN		J. EB		DATE	10-27-84
SHEET CHECKED		J. BL		DATE	11-04-84
AS BUILT DETAILS				DATE	

REVISIONS AFTER PROPOSAL		NUMBER	DATE	STATION	DESCRIPTION

NOTEBOOKS		BOOK	PAGE

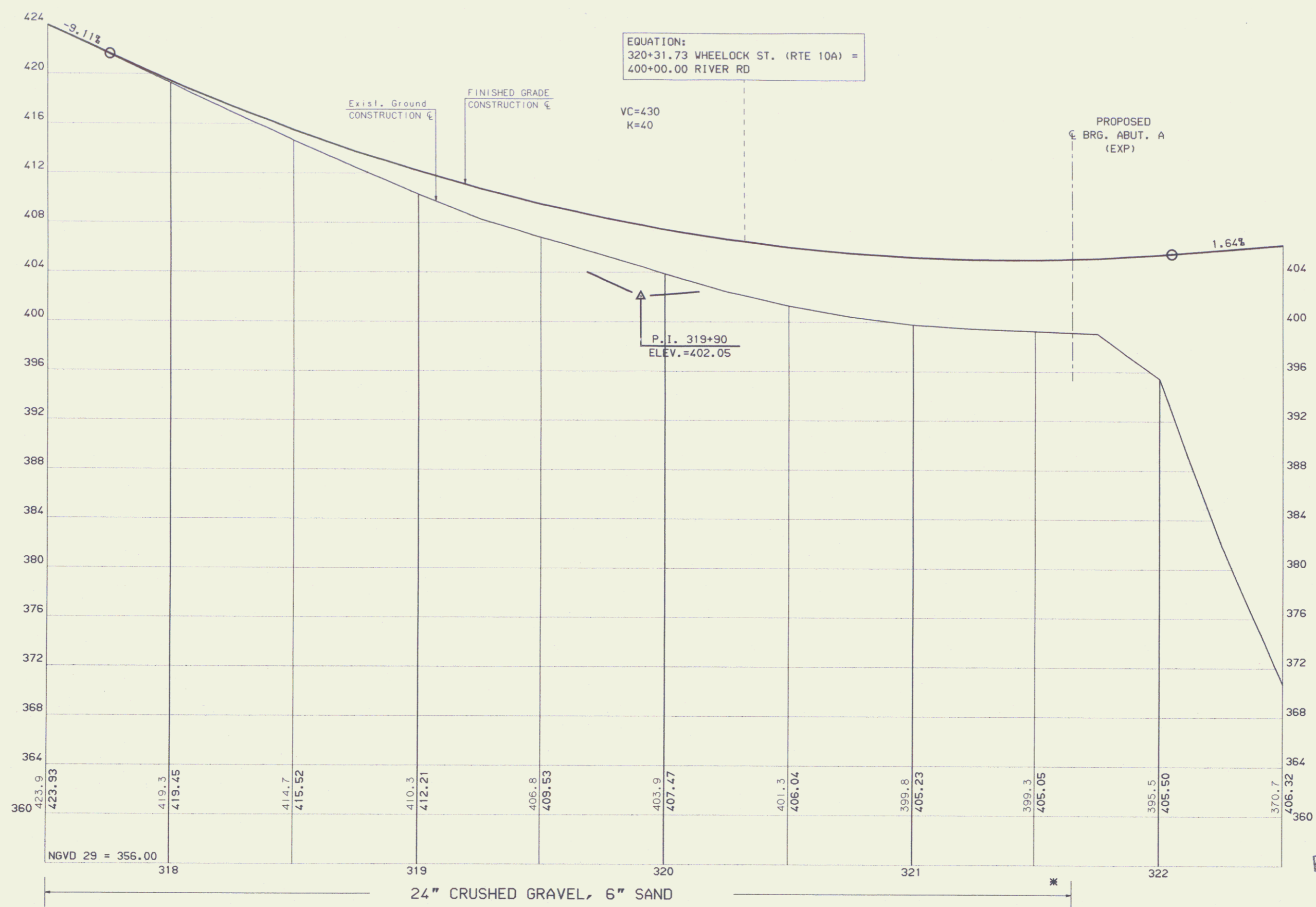

FEB 19 2003

* NOTE: APPROACH SLAB LOCATION

VERMONT RTE. 10A

SCALE: 1" = 20' HORIZ.
1" = 4' VERT.

NORWICH-HANOVER BRM 5203(4)
VERMONT ROW SHEET 7 OF 14

STATE OF NEW HAMPSHIRE
DEPARTMENT OF TRANSPORTATION • BUREAU HIGHWAY DESIGN

VERMONT RTE. 10A PROFILE
STA. 317+50 TO STA. 322+50

WINDOW NAME	.FGB FILENAME	FEDERAL PROJECT NO.	STATE PROJECT NO.	SHEET NO.	TOTAL SHEETS
PROFILE3	PROFILES	DPR-BRM-T-0038(001)	10029A	16	25

7

EXISTING DETAIL	K. RUF	DATE	1-13-95
PROPOSED DESIGN	K. RUF	DATE	1-13-95
SHEET CHECKED		DATE	
AS BUILT DETAILS		DATE	

REVISIONS AFTER PROPOSAL	NUMBER	DATE	STATION	DESCRIPTION

NOTEBOOKS	BOOK	PAGE

EQUATION:
 400+00.00 RIVER RD =
 320+31.73 WHEELLOCK ST. (RTE 10A)

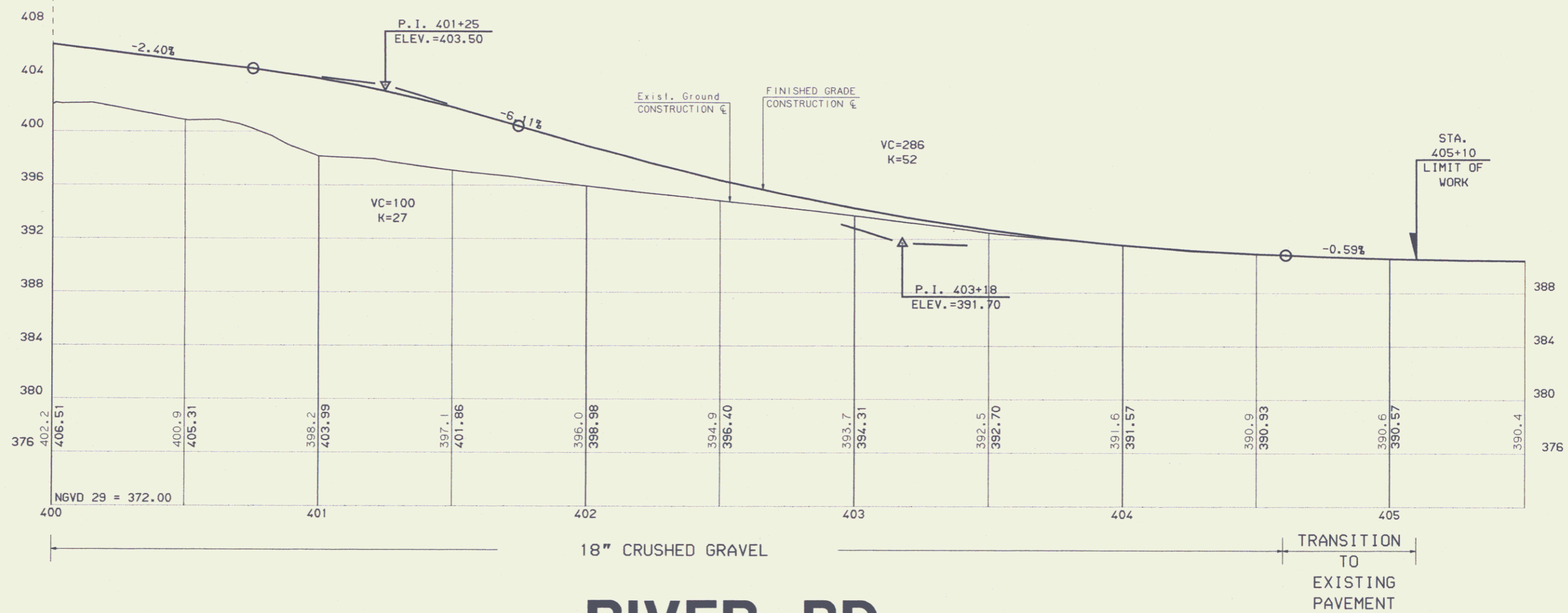

RIVER RD

SCALE: 1" = 20' HORIZ.
 1" = 4' VERT.

FEB 19 2003

NORWICH-HANOVER BRM 5203(4)
 VERMONT ROW SHEET 8 OF 14

STATE OF NEW HAMPSHIRE
 DEPARTMENT OF TRANSPORTATION • BUREAU HIGHWAY DESIGN

RIVER RD PROFILE

WINDOW NAME	.FGB FILENAME	FEDERAL PROJECT NO.	STATE PROJECT NO.	SHEET NO.	TOTAL SHEETS
PROFLAS1	PROFILES	DPR-BRM-T-0038(001)	10029A	XX	XX

TABLE OF PROJECT PROPERTY ACQUISITION

STATE OF VERMONT
AGENCY OF TRANSPORTATION
RIGHT OF WAY PLANS
DETAIL SHEET

PARCEL NO.	GRANTOR	SHEET NO.	BEGINNING STATION	ENDING STATION	TAKING	REM.	RIGHTS	TITLE TAKEN	DATE	TOWN OR CITY RECORDED	BK.	PG.	REMARKS	REVISION NO.	SHEET	DESCRIPTION OF REVISION	DATE	MADE BY	APPROVED BY	
1A	TRUSTEES OF DARTMOUTH COLLEGE	10,11	401+09 LT. 401+88 LT. 402+00 LT.	401+98 LT. 402+18 LT.			SLOPE (T) 0.02A± CONST. (T) 0.01A± CULVERT (P)	WD0E	09-27-95	NORWICH	118	409-411	700 S.F. ± DRAINAGE AREA 375 S.F. ±							
1B		10	402+64 LT. 403+40 LT. 404+22 LT.	403+40 LT. 403+60 LT.			INSTALL & MAINTAIN (P) 0.01A± CONST. (T) 0.01A±						RETAINING WALL 210 S.F. ± DRAINAGE AREA 200 S.F. ± GRAVEL DRIVE							
2	GREEN MOUNTAIN POWER CORPORATION												UTILITY							
3	NYNEX												UTILITY							
4	NORWICH FIRE DISTRICT												UTILITY							
5	TWIN STATE CABLE TV												UTILITY							
6	CVPS CORPORATION												UTILITY							

FEB 19 2003

<p>5203004 200 85E058</p> <p>ACCT.prop /prop/85e058/ree058d.dgn DATE PLOTTED 9-MAY-1995 r@058dlj</p>	<p>DR. (P)- DRAINAGE RIGHT DIT. (P)- DITCHING RIGHT CH. (P)- CHANNEL RT. DRIVE (T)- DRIVE RIGHT CUL. (P)- CULVERT RIGHT [W]- WATER SOURCES</p>	<p>PRESENT R.O.W. TAKING WITHOUT ACCESS TAKING WITHOUT ACCESS ALONG PROPERTY LINE TAKING WITH ACCESS PERMANENT EASEMENT TEMPORARY EASEMENT</p>	<p>LEGEND CZ (P) CLEAR ZONE CONST. (T) CONSTRUCTION EASEMENT SR SR SLOPE RIGHTS P PROPERTY LINE L TOP OF CUT △ TOP OF CUT ○ TOE OF SLOPE</p>	<p>R. O. W. PLANS</p> <p>NORWICH-HANOVER BRM 5203(4) SHEET 9 OF 14</p> <p>APPROVED: LAWRENCE W. BLISS DATE: 05-05-95 AGENT D, PLANS & TITLES</p>
--	--	--	--	---

EXISTING DETAIL		PROPOSED DESIGN		SHEET CHECKED		AS BUILT DETAILS	
DATE	BY	DATE	BY	DATE	BY	DATE	BY
4/94	J. DEMHIRST	4/94	J. DEMHIRST	4/94	P. SALD		

REVISIONS AFTER PROPOSAL	STATION	DATE	DESCRIPTION

NOTEBOOKS	PAGE
BOOK 11903	PAGE
BOOK 12051	PAGE
BOOK 12542	PAGE

**BEGIN VT. R.O.W. PROJECT
HANOVER-NORWICH BRM 5203(4)
STA. 405+10 @ RIVER RD. SA#2**

RIVER RD. - CURVE #2
 PI=404+88.59
 N = 49142.790
 E = 101163.020
 Δ = 08° - 08' - 08.0" RT.
 D = 06° - 30' - 00.0"
 T = 62.69'
 R = 881.47'
 L = 125.16'
 E = 2.23'

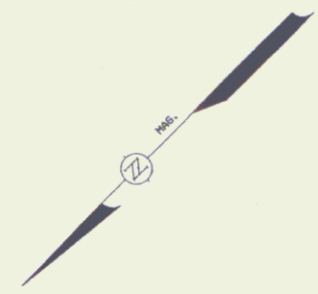

- PERMANENT RETAINING WALL EASEMENT
- TEMPORARY CONSTRUCTION EASEMENT
- DRAINAGE EASEMENT

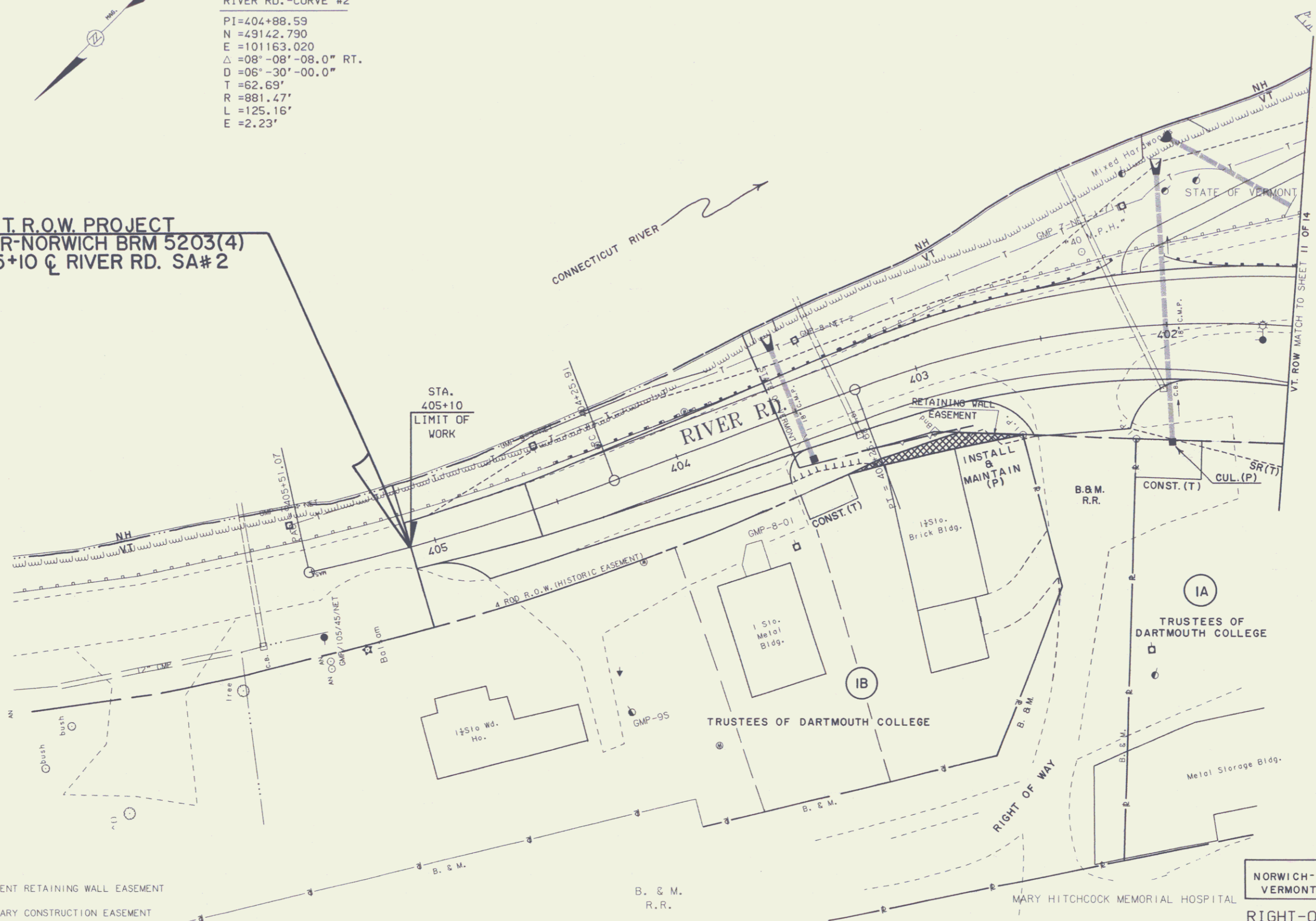

FEB 19 2003

NORWICH-HANOVER BRM 5203(4)
 VERMONT ROW SHEET 10 OF 14
RIGHT-OF-WAY PLANS

*.PGB FILE NAME	DRAWING NAME	WINDOW NAME	SHEET SCALE	FEDERAL PROJECT NO.	STATE PROJECT NO.	SHEET NO.	TOTAL SHEETS
ASSEMBLER	SHEET 11	ROWSH11	1" = 20'	DPB-BRM-T-0038(001)	10029-A	12	25

10

EXISTING DETAIL		PROPOSED DESIGN		SHEET CHECKED		AS BUILT DETAILS	
DATE	BY	DATE	BY	DATE	BY	DATE	BY
4/94	J. DEWIRST	4/94	J. DEWIRST	4/94	F. SARG		

REVISIONS AFTER PROPOSAL		NOTEBOOKS	
NUMBER	DATE	BOOK	PAGE
		11893	12853
		12853	12852

STATION	DESCRIPTION

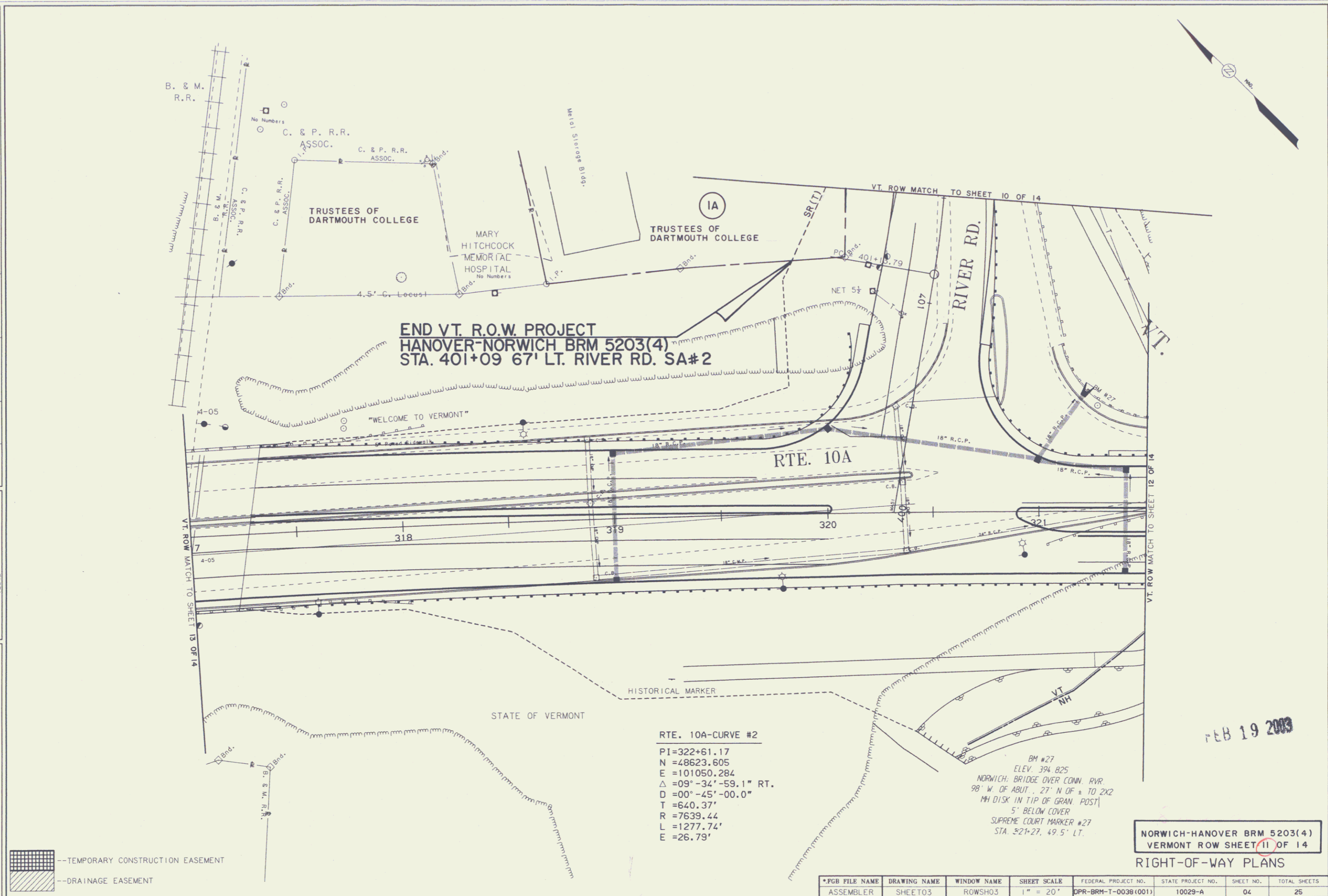



--TEMPORARY CONSTRUCTION EASEMENT
 --DRAINAGE EASEMENT

*.PDR FILE NAME	DRAWING NAME	WINDOW NAME	SHEET SCALE	FEDERAL PROJECT NO.	STATE PROJECT NO.	SHEET NO.	TOTAL SHEETS
ASSEMBLER	SHEET03	ROWSHO3	1" = 20'	DPR-BRM-T-0038(001)	10029-A	04	25

EXISTING DETAIL		DATE		DATE		DATE		DATE		DATE		DATE		DATE	
J. DEWHIRST	J. DEWHIRST	4/94	4/94	4/94	4/94	4/94	4/94	4/94	4/94	4/94	4/94	4/94	4/94	4/94	4/94
PROPOSED DESIGN		DATE		DATE		DATE		DATE		DATE		DATE		DATE	
J. DEWHIRST	J. DEWHIRST	4/94	4/94	4/94	4/94	4/94	4/94	4/94	4/94	4/94	4/94	4/94	4/94	4/94	4/94
SHEET CHECKED		DATE		DATE		DATE		DATE		DATE		DATE		DATE	
P. SALO	P. SALO	4/94	4/94	4/94	4/94	4/94	4/94	4/94	4/94	4/94	4/94	4/94	4/94	4/94	4/94
AS BUILT DETAILS		DATE		DATE		DATE		DATE		DATE		DATE		DATE	

NOTEBOOKS		DATE		DATE		DATE		DATE		DATE	
BOOK	11903	PAGE		BOOK	12051	PAGE		BOOK	12542	PAGE	

REVISIONS AFTER PROPOSAL		DATE		DATE		DATE		DATE		DATE		DATE		DATE	
NUMBER		STATION		STATION		STATION		STATION		STATION		STATION		STATION	
DESCRIPTION		DATE		DATE		DATE		DATE		DATE		DATE		DATE	

 --TEMPORARY CONSTRUCTION EASEMENT
 --DRAINAGE EASEMENT

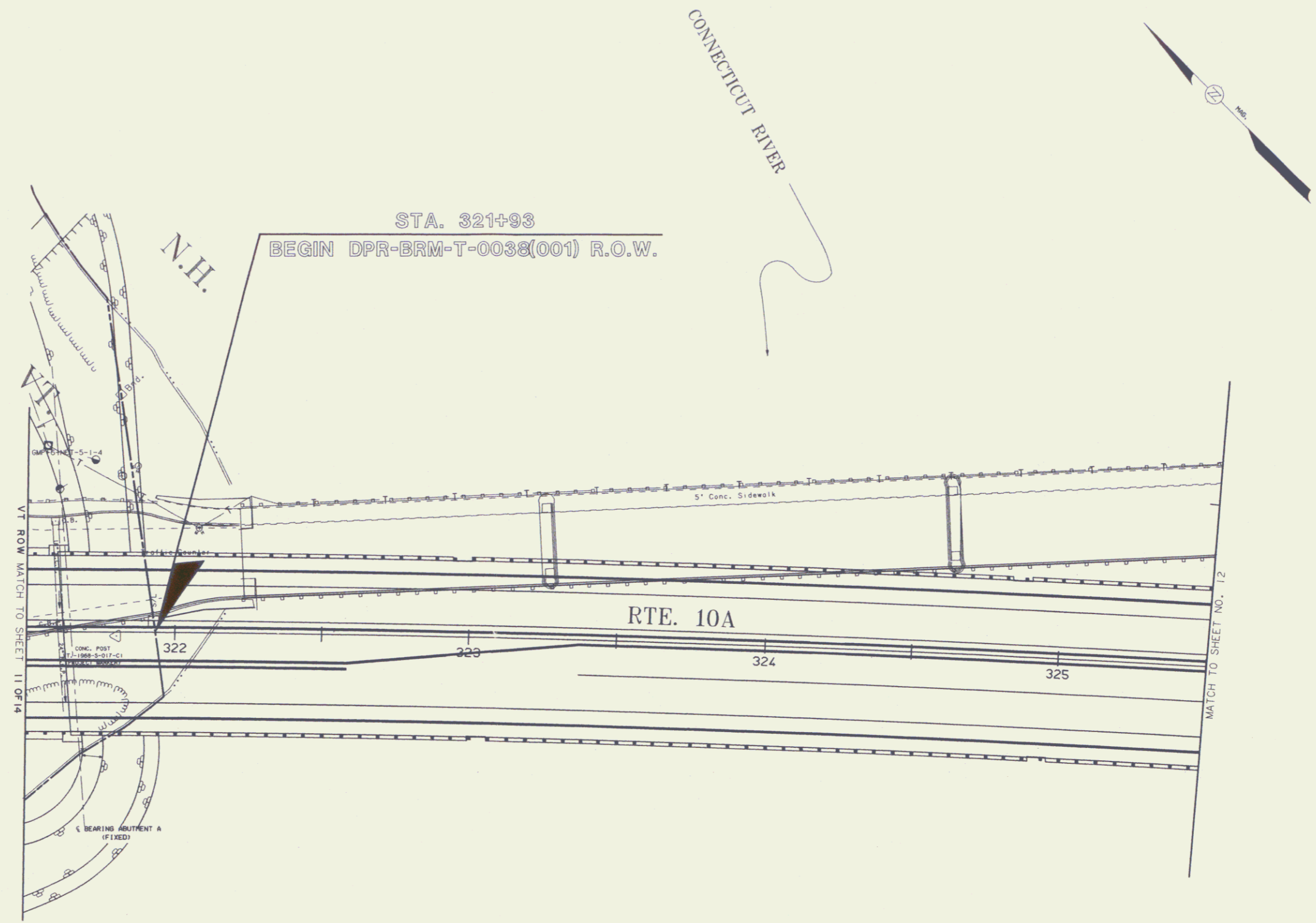

FEB 19 2003

NORWICH-HANOVER BRM 5203(4)
 VERMONT ROW SHEET 12 OF 14
 RIGHT-OF-WAY PLANS

*PCB FILE NAME	DRAWING NAME	WINDOW NAME	SHEET SCALE	FEDERAL PROJECT NO.	STATE PROJECT NO.	SHEET NO.	TOTAL SHEETS
ASSEMBLER	SHEET04	ROWSH04	1" = 20'	DPR-BRM-T-0038(001)	10029-A	10	25

EXISTING DETAIL	J. DEMHIRST	DATE	4/84
PROPOSED DESIGN	J. DEMHIRST	DATE	4/84
SHEET CHECKED	P. SALD	DATE	4/84
AS BUILT DETAILS		DATE	

REVISIONS AFTER PROPOSAL	STATION	DESCRIPTION

NOTEBOOKS	PAGE
BOOK 11803	PAGE
BOOK 12051	PAGE
BOOK 12542	PAGE

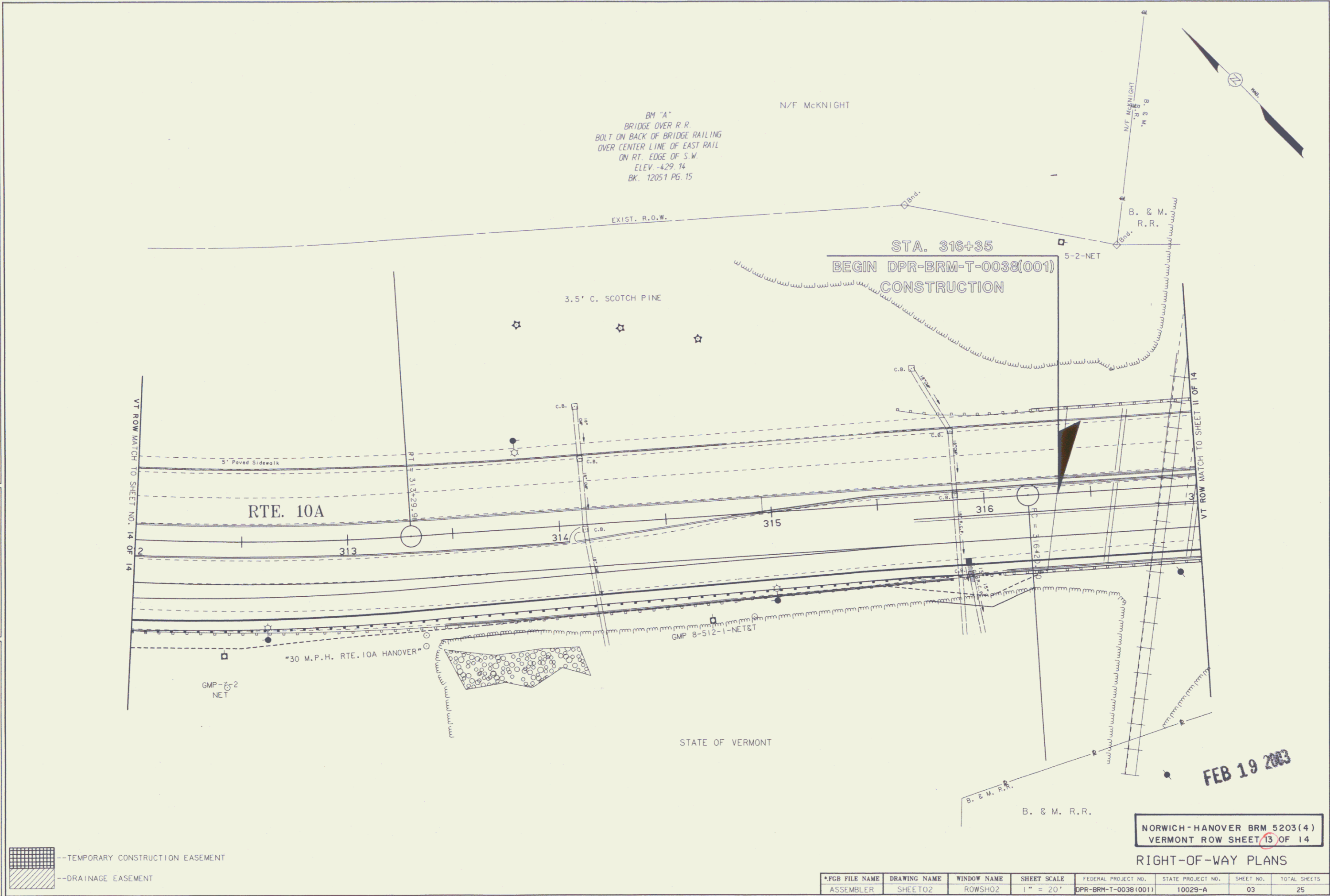

NORWICH-HANOVER BRM 5203(4)
VERMONT ROW SHEET 13 OF 14

RIGHT-OF-WAY PLANS

*PCB FILE NAME	DRAWING NAME	WINDOW NAME	SHEET SCALE	FEDERAL PROJECT NO.	STATE PROJECT NO.	SHEET NO.	TOTAL SHEETS
ASSEMBLER	SHEET02	ROWSH02	1" = 20'	DPR-BRM-T-0038(001)	10029-A	03	25

FEB 19 2003

EXISTING DETAIL	J. DEWHIRST	DATE	4/94
PROPOSED DESIGN	J. DEWHIRST	DATE	4/94
SHEET CHECKED	P. SALO	DATE	4/94
AS BUILT DETAILS		DATE	

REVISIONS AFTER PROPOSAL	NUMBER	DATE	STATION	DESCRIPTION

NOTEBOOKS	BOOK	PAGE
	11903	
	12051	
	12542	

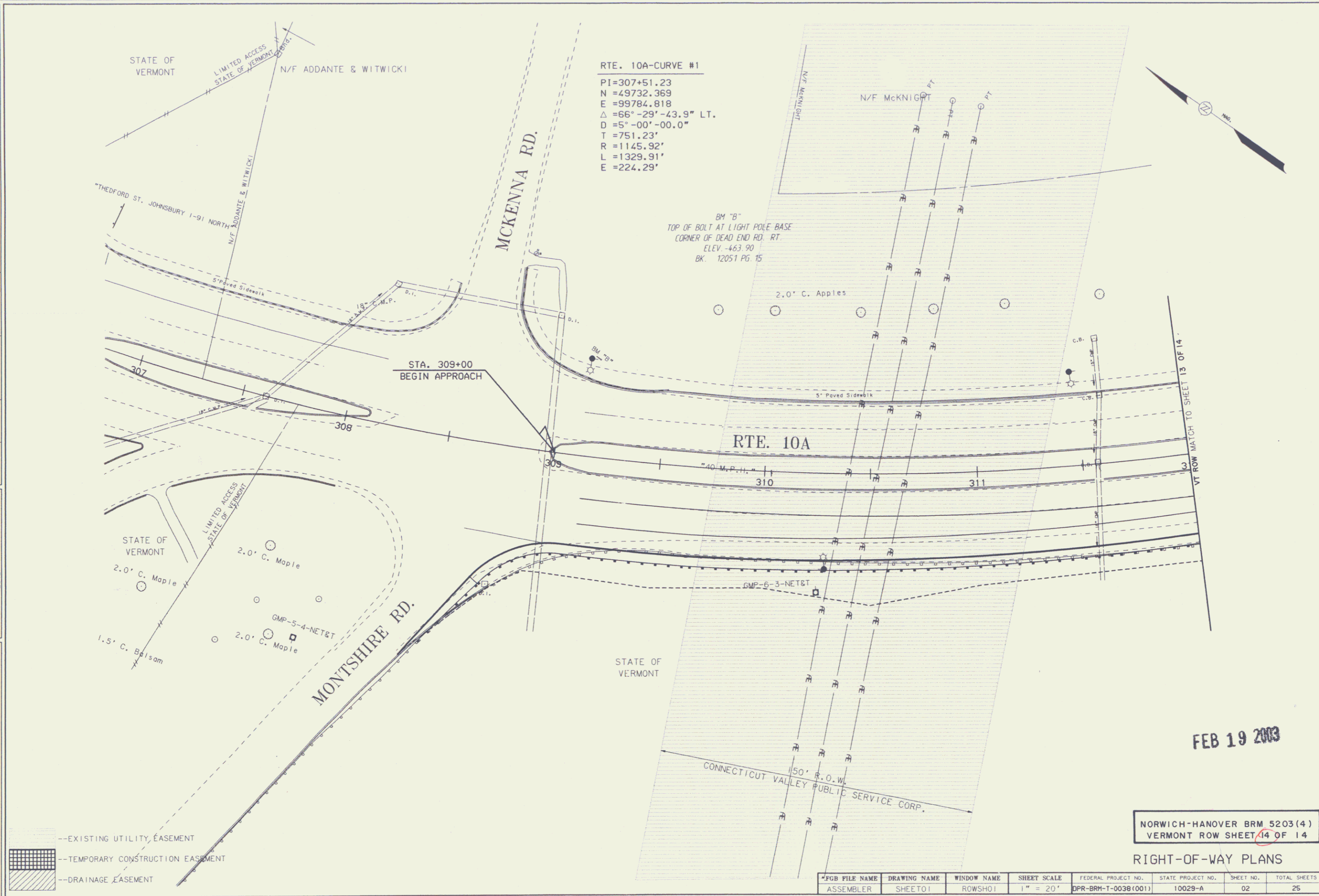

RTE. 10A-CURVE #1
 PI=307+51.23
 N = 49732.369
 E = 99784.818
 $\Delta = 66^\circ - 29' - 43.9''$ LT.
 D = 5' - 00' - 00.0"
 T = 751.23'
 R = 1145.92'
 L = 1329.91'
 E = 224.29'

BM "B"
 TOP OF BOLT AT LIGHT POLE BASE
 CORNER OF DEAD END RD. RT.
 ELEV. -463.90
 BK. 12051 PG. 15

NORWICH-HANOVER BRM 5203(4)
 VERMONT ROW SHEET 14 OF 14

RIGHT-OF-WAY PLANS

FILE NAME	DRAWING NAME	WINDOW NAME	SHEET SCALE	FEDERAL PROJECT NO.	STATE PROJECT NO.	SHEET NO.	TOTAL SHEETS
ASSEMBLER	SHEET01	ROWSH01	1" = 20'	DPR-BRM-T-0038(001)	10029-A	02	25

14