

**CLEARING AND GRUBBING,
INCLUDING INDIVIDUAL TREES AND STUMPS**
 I+040.00 ~ I+100.00
 I+081.4 LT (M) HICKORY
 I+087.4 RT (S) BOX ELDER
 I+089.3 RT (S) BOX ELDER
 I+098.9 RT S. ASH
COLD PLANING, BITUMINOUS PAVEMENT
 I+040.00 ~ I+060.00
STONE FILL, TYPE I
 I+040.0 LT. ~ I+100.0 LT.
 I+040.0 RT. ~ I+080.0 RT.
REMOVAL OF EXISTING FENCE
 I+040.0 RT ~ I+100.0 RT

MANUFACTURED TERMINAL SECTION, FLARED
 I+088.67 RT. ~ I+100.32 RT. (TRAILING END)
 I+089.89 LT. ~ I+101.54 LT. (TRAILING END)
REMOVAL AND DISPOSAL OF GUARDRAIL
 I+063.6 LT. ~ I+100.0 LT.
 I+064.0 RT. ~ I+100.0 RT.

**BEGIN R.O.W. PROJECT
BRS 0172(6)
STA. 1+040.000
10.146M (33.29') LT.**

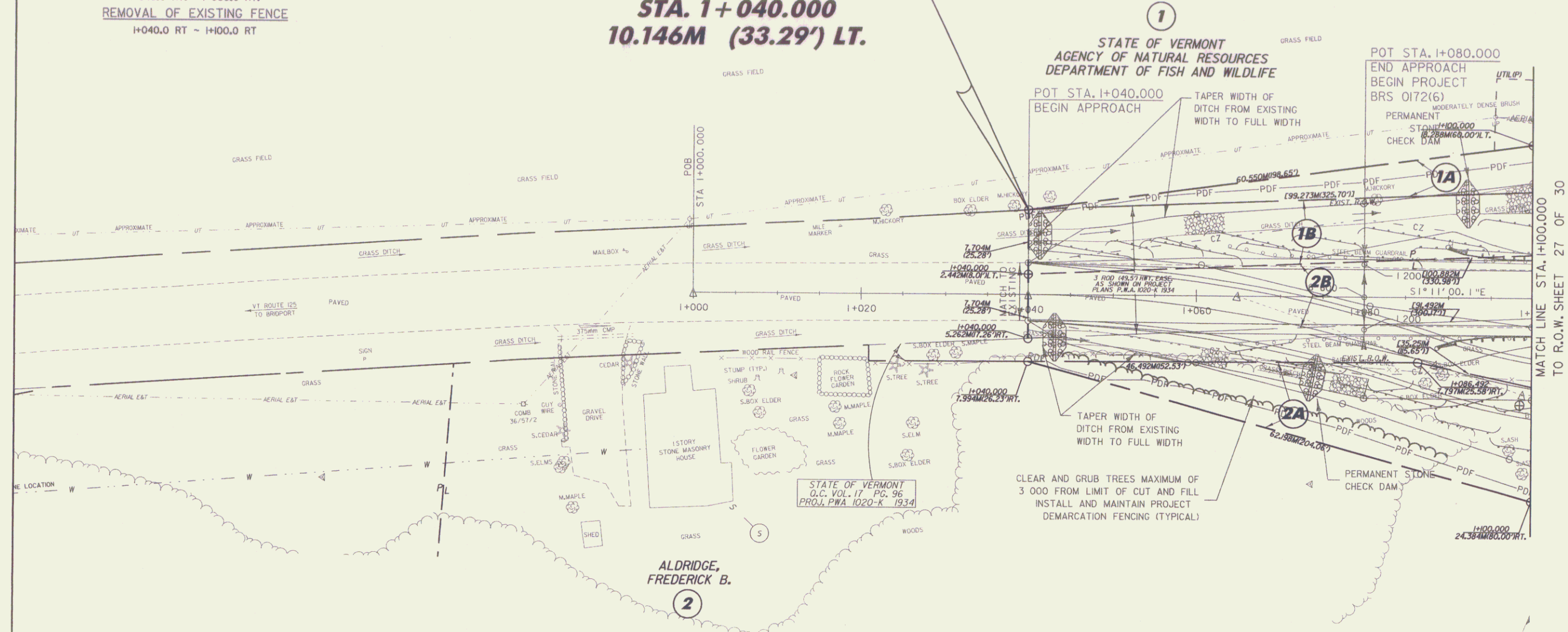

MATCH LINE STA. 1+000.000
TO R.O.W. SHEET 27 OF 30

ROADWAY LAYOUT SHEET 1

LINES SHOWN ON THIS PLAN AS EXISTING PROPERTY LINES P/L ARE BELIEVED TO BE ACCURATE BUT SHOULD NOT BE RELIED UPON FOR PURPOSES UNRELATED TO THE STATE OF VERMONT'S ACQUISITION OF LAND AND RIGHTS FOR THIS PROJECT.

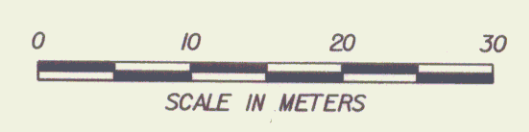

- LEGEND**
- STONE LINED DITCH
 - EROSION MATTING LINED DITCH

DATUM
 VERTICAL NAVD 88
 HORIZONTAL NAD 83(92)

PROJECT: CORNWALL	PROJECT NO.: BRS 0172(6)
DESIGN FILE NAME: ****FILENAME***	PLOT DATE: 23-OCT-2008
IPARM FILE NAME:	SURVEY DATE: 1996&1999
SURVEYED BY: VTRANS & VT SURVEY	DRAWN BY: ERIK ATKINS
SQUAD LEADER: MARTHA EVANS-MONGEON	ROW SHEET 26 OF 30