

R.O.W. PLANS

INDEX OF SHEETS

- 1 TITLE
- 2 LEGEND
- 3 DETAIL SHEET
- 4 LAYOUT SHEET
- 5 PRELIMINARY INFORMATION SHEET
- 6 TYPICAL BRIDGE SECTION
- 7 TYPICAL ROADWAY SECTION
- 8 TIE SHEET
- 9 ALIGNMENT SHEET
- 10 PROFILE SHEET
- 11 EPSC SHEET
- 12 PLAN & ELEVATION

STATE OF VERMONT AGENCY OF TRANSPORTATION



PROPOSED IMPROVEMENT BRIDGE PROJECT TOWN OF ROCHESTER COUNTY OF WINDSOR

ROUTE: VT 73 (RURAL MAJOR COLLECTOR), BRIDGE NO. 16

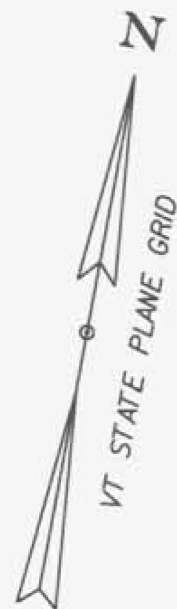
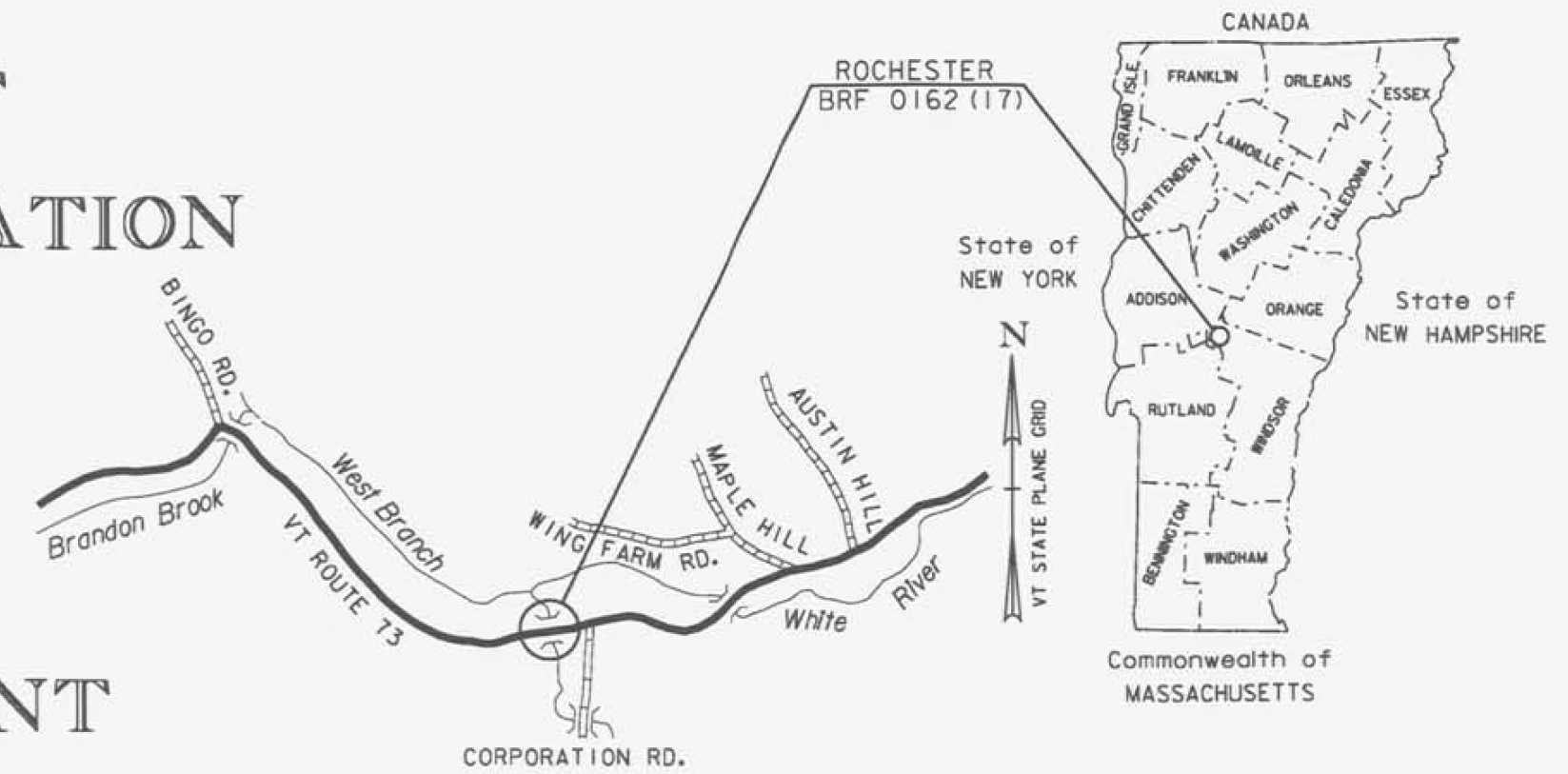

PROJECT LOCATION: LOCATED IN THE COUNTY OF WINDSOR, TOWN OF ROCHESTER, ON VT 73; BRIDGE NO. 16 OVER CORPORATION BROOK, APPROXIMATELY 2.50 MILES WEST OF THE INTERSECTION WITH VT 73 AND VT 100.

PROJECT DESCRIPTION: WORK TO BE PERFORMED UNDER THIS PROJECT INCLUDES THE REMOVAL AND REPLACEMENT OF EXISTING BRIDGE NO. 16 ON THE EXISTING ALIGNMENT, WITH ASSOCIATED ROADWAY AND CHANNEL WORK.

LENGTH OF STRUCTURE: 62.41 FT
LENGTH OF ROADWAY: 107.59 FT
LENGTH OF PROJECT: 170.00 FT
LENGTH OF ROW PROJECT: 393.00 FT

**BEGIN ROW PROJECT
BRF 0162(17)
STA. 331+57 24.75' LT**

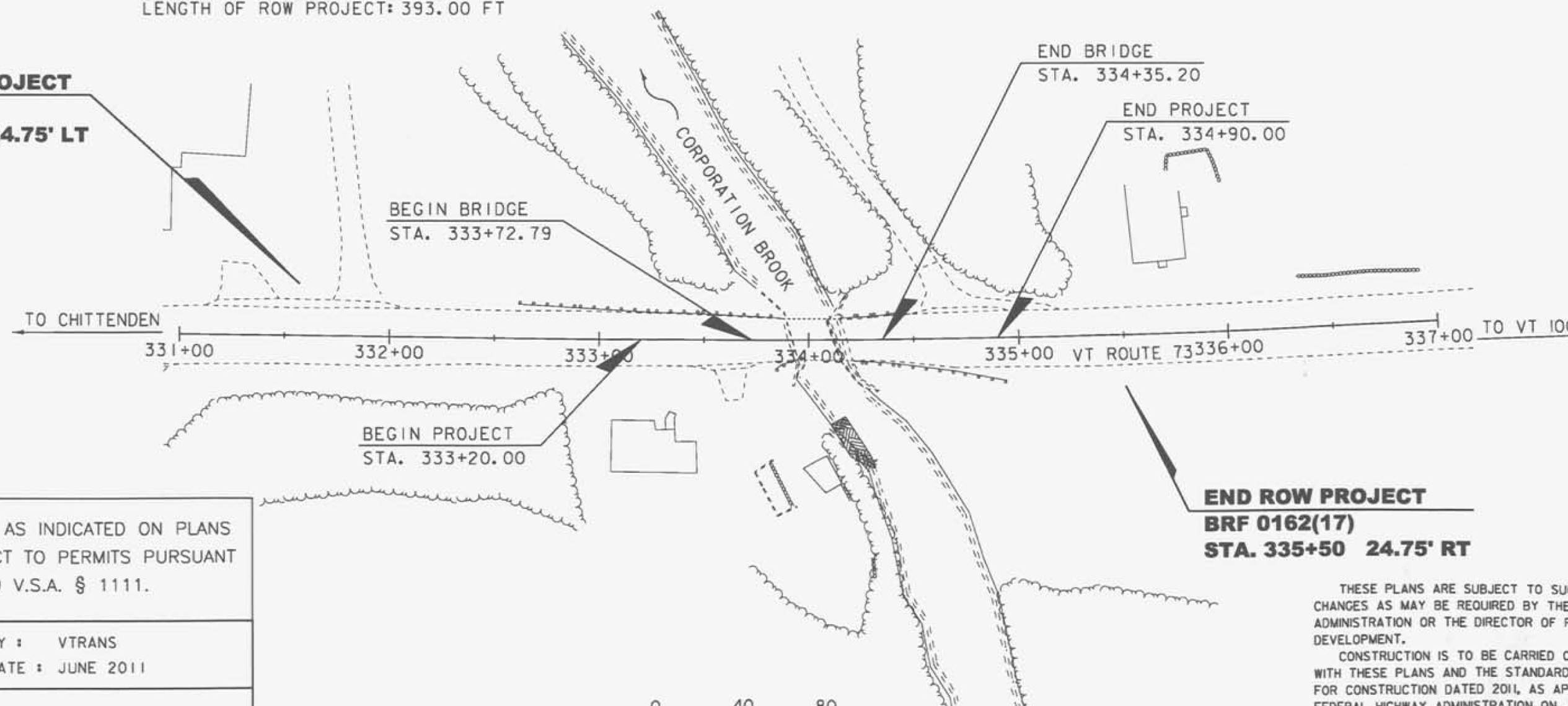

**END ROW PROJECT
BRF 0162(17)
STA. 335+50 24.75' RT**

CONVENTIONAL SYMBOLS

COUNTY LINE	
TOWN LINE	
LIMITS OF ACCESS	
POINT OF ACCESS	
FENCE LINE	
STONE WALL	
TRAVELED WAY	
GUARD RAIL	
RAILROAD	
SURVEY LINE	
CULVERT	
POWER POLE	
TELEPHONE POLE	
TREES	
CONTROL OF ACCESS	
PROPERTY LINE	
R.O.W. TAKING LINE	
SLOPE RIGHTS	
TOP OF CUT	
TOE OF SLOPE	

ALL DRIVES AS INDICATED ON PLANS ARE SUBJECT TO PERMITS PURSUANT TO TITLE 19 V.S.A. § 1111.

SURVEYED BY : VTRANS
SURVEYED DATE : JUNE 2011

DATUM
VERTICAL NAVD 88
HORIZONTAL NAD 83 (07)

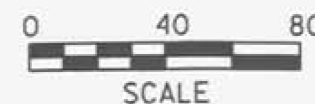

THESE PLANS ARE SUBJECT TO SUCH ENGINEERING CHANGES AS MAY BE REQUIRED BY THE FEDERAL HIGHWAY ADMINISTRATION OR THE DIRECTOR OF PROGRAM DEVELOPMENT.

CONSTRUCTION IS TO BE CARRIED ON IN ACCORDANCE WITH THESE PLANS AND THE STANDARD SPECIFICATIONS FOR CONSTRUCTION DATED 2011, AS APPROVED BY THE FEDERAL HIGHWAY ADMINISTRATION ON JULY 20, 2011 FOR USE ON THIS PROJECT, INCLUDING ALL SUBSEQUENT REVISIONS AND SUCH REVISED SPECIFICATIONS AND SPECIAL PROVISIONS AS ARE INCORPORATED IN THESE PLANS.

APPROVED RICHARD TETREAULT DATE 03-25-13
Director of Program Development

APPROVED ROBERT M. WHITE DATE 03-25-13
Chief of Right of Way

**ROCHESTER
BRF 0162(17)**

ROW SHEET 1 OF 12 SHEETS