

RESEARCH SET

# STATE OF VERMONT AGENCY OF TRANSPORTATION



## PROPOSED IMPROVEMENT **TOWN OF RANDOLPH** COUNTY OF ORANGE VERMONT ROUTE 14 (F.A.S.) MAJOR COLLECTOR

BEGINNING AT A POINT ON VT. ROUTE 14 6.680 MILES NORTH OF THE BETHEL-RANDOLPH TOWN LINE AND EXTENDING NORTHERLY 0.114 MILES.  
LENGTH OF ROADWAY 511.89 FEET = 0.097 MILES  
LENGTH OF BRIDGE 88.11 FEET = 0.017 MILES  
LENGTH OF PROJECT 600.00 FEET = 0.114 MILES  
THIS PROJECT CONSISTS OF THE REPLACEMENT OF BRIDGE 39 OVER WHITE RIVER WITH NECESSARY APPROACHES.  
LENGTH OF ROW PROJECT 950.00 FEET = 0.180 MILES

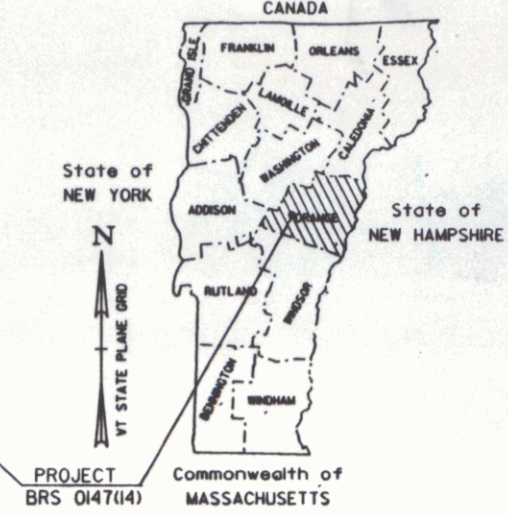
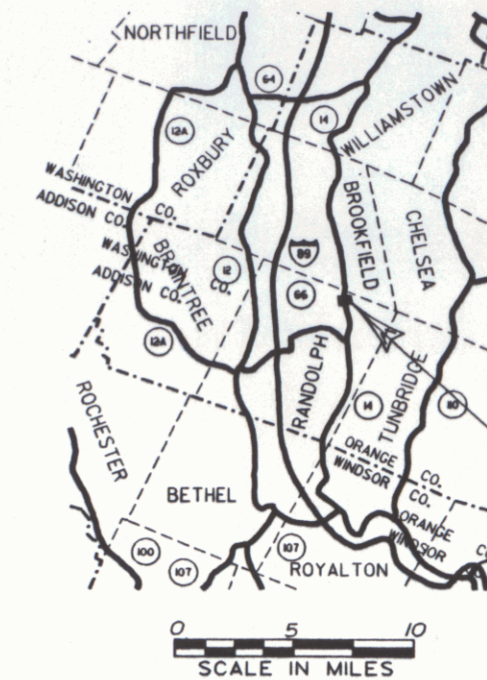

R.O.W. PLANS

BEGIN R. O. W. PROJECT  
BRS 0147(14) STA. 33+00 34' LT.

| CONVENTIONAL SIGNS |           |
|--------------------|-----------|
| COUNTY LINE        | ---       |
| TOWN LINE          | - - - -   |
| LIMITS OF ACCESS   | ○ ○ ○ ○   |
| POINT OF ACCESS    | X         |
| FENCE LINE         | - x - x - |
| STONE WALL         | ○ ○ ○ ○   |
| TRAVELED WAY       | ○ ○ ○ ○   |
| RAILROAD           | —+—+—+—+— |
| SURVEY LINE        | —+—+—+—+— |
| CULVERT            | —+—+—+—+— |
| POWER POLE         | ⊕         |
| TELEPHONE POLE     | ⊕         |
| WES                | ⊕         |
| CONTROL OF ACCESS  | ///       |
| PROPERTY LINE      | ---       |
| TAKING LINE        | ---       |
| RIGHTS             | SR        |
| CUT                | △         |
| TOE OF SLOPE       | ○         |

DATUM  
VERTICAL N/A  
HORIZONTAL NGVD 1929

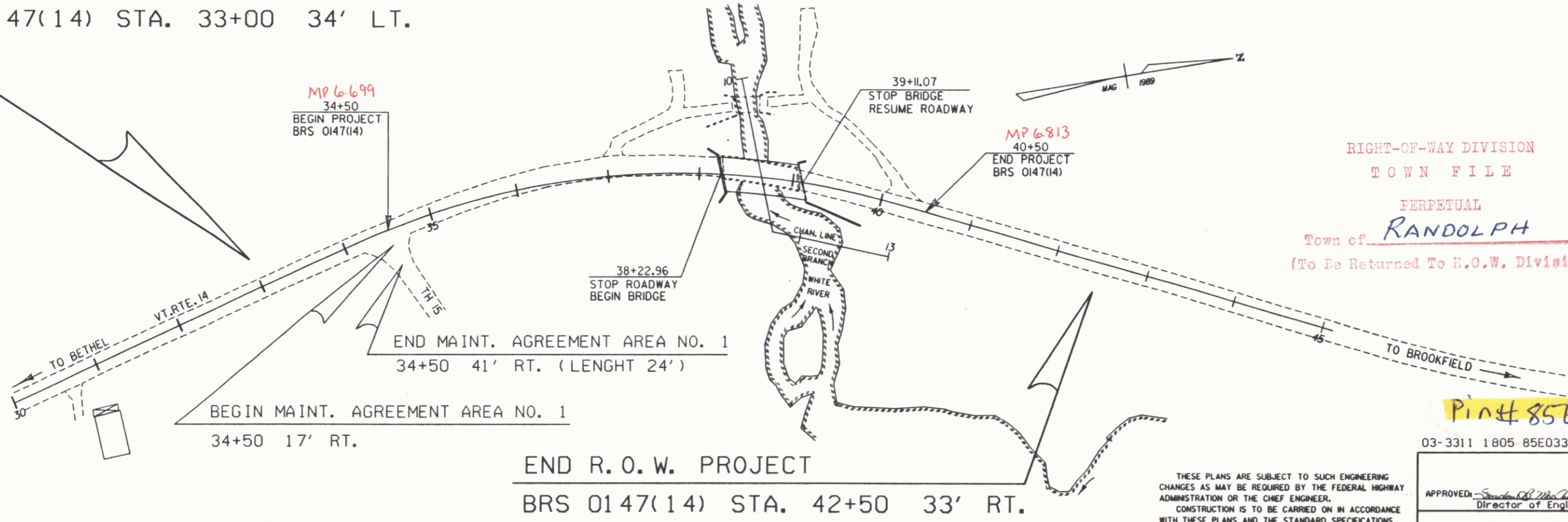

END R. O. W. PROJECT  
BRS 0147(14) STA. 42+50 33' RT.



Built as designed  
1/31/97

RIGHT-OF-WAY DIVISION  
TOWN FILE  
PERPETUAL  
Town of RANDOLPH  
(To Be Returned To R.O.W. Division)

Pin# 85E033

03-3311 1805 85E033 FJM

THESE PLANS ARE SUBJECT TO SUCH ENGINEERING CHANGES AS MAY BE REQUIRED BY THE FEDERAL HIGHWAY ADMINISTRATION OR THE CHIEF ENGINEER. CONSTRUCTION IS TO BE CARRIED ON IN ACCORDANCE WITH THESE PLANS AND THE STANDARD SPECIFICATIONS FOR CONSTRUCTION DATED 1990, AS APPROVED BY THE FEDERAL HIGHWAY ADMINISTRATION ON MARCH 15, 1990 FOR USE ON THIS PROJECT, INCLUDING ALL SUBSEQUENT REVISIONS AND SUCH REVISED SPECIFICATIONS AND SPECIAL PROVISIONS AS ARE INCORPORATED IN THESE PLANS.

APPROVED: *[Signature]* DATE: 11/1/93  
Director of Engineering

APPROVED: *[Signature]* DATE: 11/1/93  
Chief, Right of Way

RANDOLPH  
BRS 0147(14)  
R. O. W. SHEET (1) OF 11 SHEETS

DATE PLOTTED 02-NOV-1993

FEB 07 1997