



**CONSTRUCT DRIVE**  
 STA 8+764.000 RT GRAVEL  
 STA 8+860.000 LT GRAVEL

**STONE FILL TYPE II**  
 STA 8+885.143 TO STA 9+020.000 LT  
 STA 8+885.559 TO STA 9+020.000 RT

**EROSION MATTING (W/TE)**  
 STA 8+885.143 TO STA 9+020.000 LT  
 STA 8+885.559 TO STA 9+020.000 RT

**GEOTEXTILE UNDER STONE FILL**  
 STA 8+865.862 TO STA 9+020.000 LT

**STEEL BEAM GUARDRAIL**  
 STA 8+688.330 TO STA 8+761.548 RT  
 STA 8+706.935 TO STA 8+790.420 LT  
 STA 8+903.848 TO STA 9+020.000 RT  
 STA 8+900.047 TO STA 9+020.000 LT

**GRUBBING MATERIAL**  
 STA 8+885.143 TO STA 9+020.000 LT  
 STA 8+888.559 TO STA 9+020.000 RT

**REMOVING AND RESETTING FENCE**  
 STA 9+018.810 LT - 3M BACK  
 STA 9+018.810 TO STA 9+020.000 LT

**MANUFACTURED TERMINAL SECTION (TANGENTIAL)**  
 STA 8+884.807 TO STA 8+900.047 LT  
 STA 8+888.607 TO STA 8+903.848 RT

**ANCHOR FOR STEEL BEAM RAIL**  
 STA 8+688.330 RT  
 STA 8+706.935 LT  
 STA 8+761.548 RT  
 STA 8+790.420 LT

**CONSTRUCT SPECIAL DITCH**  
 STA 8+690.000 TO STA 8+750.000 RT  
 STA 8+710.000 TO STA 8+764.000 LT  
 STA 8+767.000 TO STA 8+790.000 RT

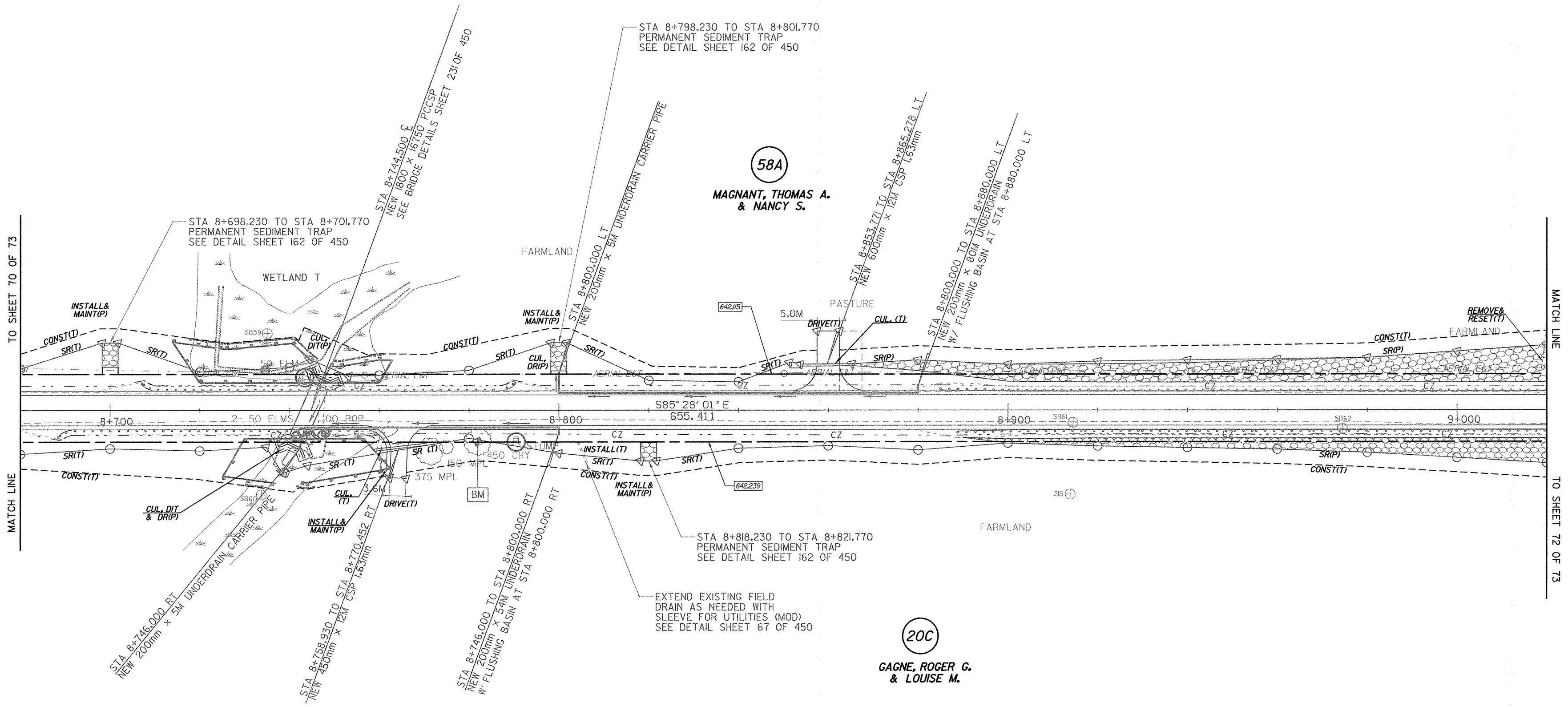

MATCH LINE TO SHEET 70 OF 73

MATCH LINE TO SHEET 72 OF 73



○ DENOTES TREE OR STUMP REMOVAL

- NOTES:**
1. ALL SIDE ROAD RADII SHALL BE 11M UNLESS OTHERWISE NOTED. REFER TO STD B-12M
  2. ALL DRIVE RADII SHALL BE 6M UNLESS OTHERWISE NOTED. REFER TO STD B-7M

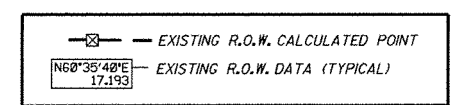

LINES SHOWN ON THIS PLAN AS EXISTING PROPERTY LINES P/L ARE BELIEVED TO BE ACCURATE BUT SHOULD NOT BE RELIED UPON FOR PURPOSES UNRELATED TO THE TOWN OF FRANKLIN'S ACQUISITION OF LAND AND RIGHTS FOR THIS PROJECT.

PROJECT NAME: HIGHGATE - FRANKLIN	
PROJECT NUMBER: STP RS 030(I) SA	
FILE NAME: ...85c060/design/dc060bdr.dgn	PLOT DATE: 23-FEB-2005
PROJECT LEADER: DELLASANTA	DRAWN BY: SQUAD B
DESIGNED BY: SQUAD B	CHECKED BY: SQUAD B
R. O. W. SHEET 71 OF 73 SHEETS	SHEET 65 OF 450