

STATE OF VERMONT  
AGENCY OF TRANSPORTATION



PROPOSED IMPROVEMENT  
**TOWN OF BRATTLEBORO**  
COUNTY OF WINDHAM  
**VT RTE 9 (F.A.P.)**

BEGINNING AT A POINT ON VT 9 IN BRATTLEBORO  
APPROXIMATELY 1.201 MILES EASTERLY OF THE MARLBORO-  
BRATTLEBORO TOWN LINE AND EXTENDING EASTERLY FOR  
0.454 MILES

LENGTH OF ROADWAY = 2399.20 FEET = 0.454 MILES.  
LENGTH OF PROJECT = 2399.20 FEET = 0.454 MILES  
LENGTH OF R.O.W. PROJECT 2830.20 FEET = 0.536 MILES  
WORK TO BE DONE UNDER THIS PROJECT INCLUDES  
RELOCATION OF A SECTION OF VT RTE 9 WITH  
GRADING, DRAINAGE, SUBBASE AND PAVEMENT.

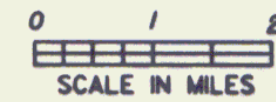
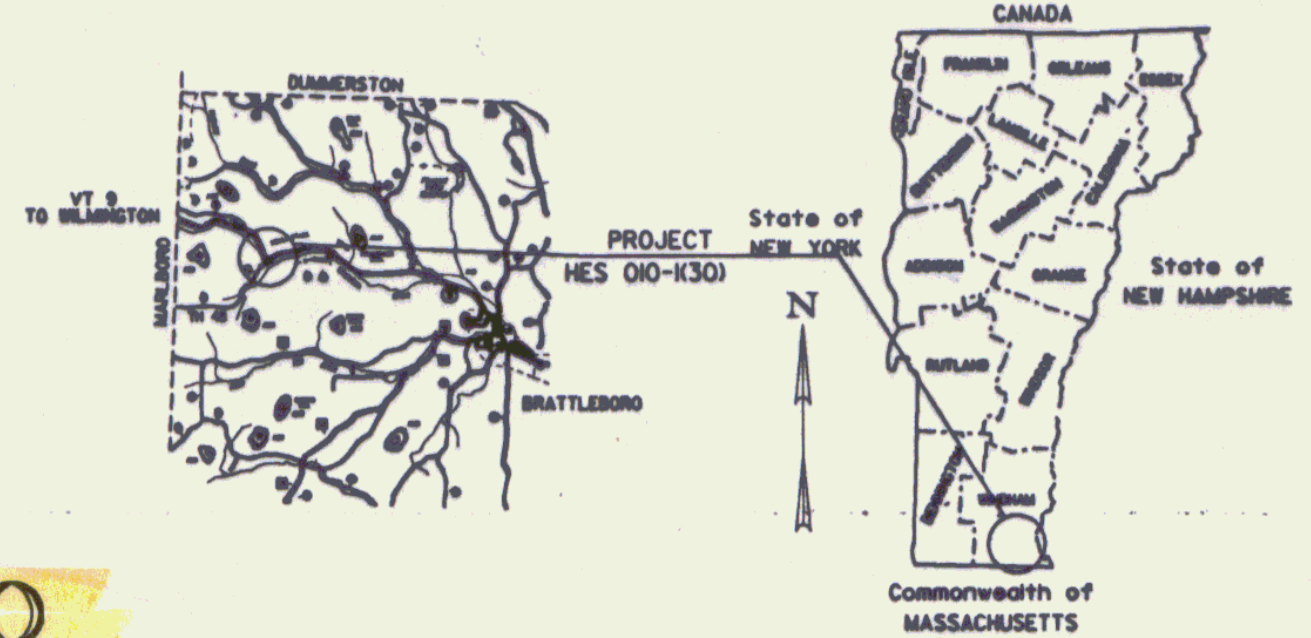

R.O.W. PLANS

END R.O.W. PROJECT  
HES 010-1(30)  
STA. 130+15 25' RT.

BEGIN R.O.W. PROJECT  
HES 010-1(30) STA. 101+84 25' RT.

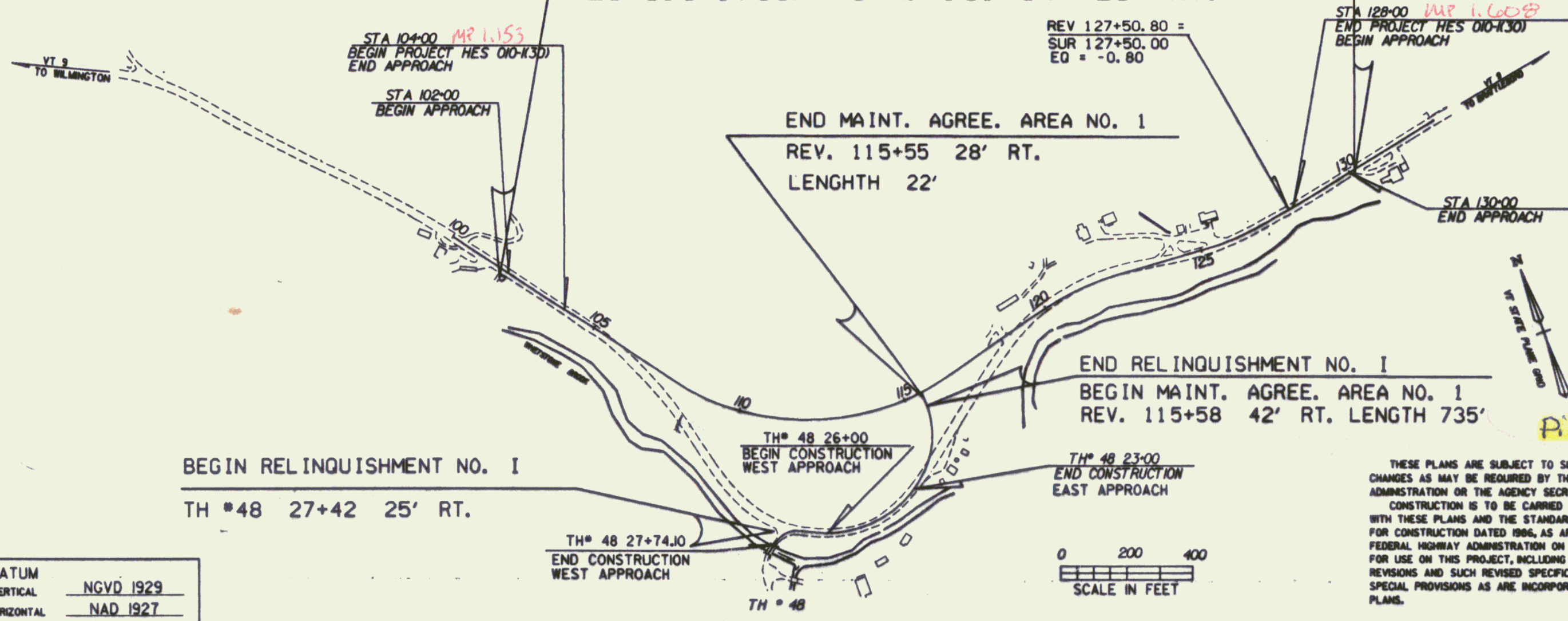

*Vt. Rte #9*  
RIGHT-OF-WAY DIVISION  
TOWN FILE  
PERPETUAL  
Town of BRATTLEBORO  
(To Be Returned To R.O.W. Division)

ALL DRIVES AS INDICATED ON PLANS  
ARE SUBJECT TO PERMITS PURSUANT  
TO TITLE 19 SECTION 11, V.S.A.

*Pin # 84E070* MAR 20 1996

CONVENTIONAL SIGNS

COUNTY LINE	---
TOWN LINE	- - - -
LIMITS OF ACCESS	—○—
POINT OF ACCESS	—X—
FENCE LINE	—X—X—
STONE WALL	—X—X—X—
TRAVELED WAY	—○—○—
GUARD RAIL	—○—○—
RAILROAD	— — — —
SURVEY LINE	—+—+—
CULVERT	—+—+—
POWER POLE	—□—
TELEPHONE POLE	—◇—
TREES	—●—
CONTROL OF ACCESS	—//—
PROPERTY LINE	— — —
R.O.W. TAKING LINE	— — —
SLOPE RIGHTS	—SR—
TOP OF CUT	—△—
TOE OF SLOPE	—○—

DATUM  
VERTICAL NGVD 1929  
HORIZONTAL NAD 1927

THESE PLANS ARE SUBJECT TO SUCH ENGINEERING  
CHANGES AS MAY BE REQUIRED BY THE FEDERAL HIGHWAY  
ADMINISTRATION OR THE AGENCY SECRETARY.  
CONSTRUCTION IS TO BE CARRIED ON IN ACCORDANCE  
WITH THESE PLANS AND THE STANDARD SPECIFICATIONS  
FOR CONSTRUCTION DATED 1986, AS APPROVED BY THE  
FEDERAL HIGHWAY ADMINISTRATION ON NOVEMBER 21, 1985  
FOR USE ON THIS PROJECT, INCLUDING ALL SUBSEQUENT  
REVISIONS AND SUCH REVISED SPECIFICATIONS AND  
SPECIAL PROVISIONS AS ARE INCORPORATED IN THESE  
PLANS.

APPROVED GORDON B. MCCARTHRUR DATE 8-22-92  
Director of Engineering

APPROVED ALLEN N. BLAKE DATE 8-22-91  
Chief of Right-of-Way

Project No. **BRATTLEBORO STP**  
**HES 010-1(30)**  
R.O.W. SHEET 1 OF 1 SHEETS

# CLIMBING LANE TYPICAL SECTIONS

FOR SEEDING FORMULA &  
GENERAL NOTES, SEE SHEET 3

• THE MINIMUM CLEAR ZONE EXTENDS FROM THE  
EDGE OF THE TRAVEL WAY TO A POINT 4 FEET  
BEYOND THE INTERSECTION POINT OF THE 1-4 SLOPE  
AND THE BACK SLOPE.

SHOULDERS :

- 3" BITUMINOUS CONCRETE PAVEMENT (TYPE II)
- 6" BITUMINOUS CONC. PAV'T. (2-3" LIFT TYPE I BASE COURSE)
- 24" SUBBASE OF DENSE GRADED CRUSHED STONE
- 1/2" BITUMINOUS CONCRETE PAVEMENT (TYPE III)
- 12" SAND BORROW (ONLY 3" REQUIRED IN LEDGE CUTS)

MATERIAL ITEM	THICKNESS TOLERANCE
PAVEMENT	± 1/4"
BASE COURSE	± 1/2"
SUBBASE	± 1"
SAND BORROW	± 1"

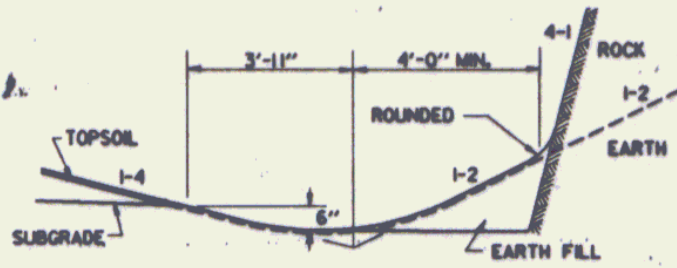

DETAILS OF DITCH AND BACKSLOPE FOR  
LOW SIDE OF BANK < 0.042 FT/FT  
WITH CLIMBING LANE

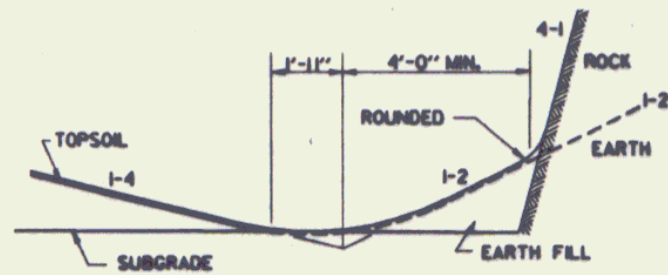

DETAILS OF DITCH AND BACKSLOPE FOR  
LOW SIDE OF BANK ≥ 0.042 FT/FT  
WITH CLIMBING LANE

FOR SLOPES IN SOLID ROCK EXCAVATION  
AND DRILLING AND BLASTING OF SOLID  
ROCK SUBGRADE, SEE STANDARD SHEET A-62.

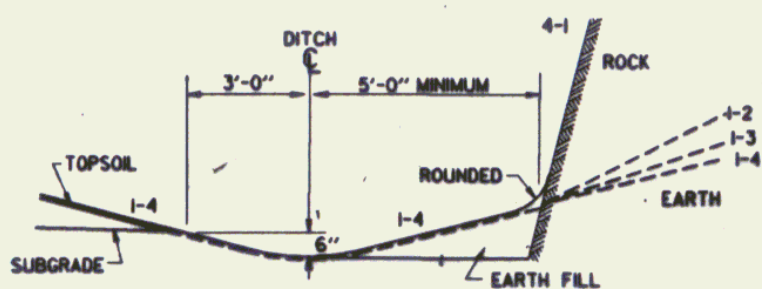

DETAILS OF DITCH AND BACKSLOPE FOR  
LOW SIDE OF BANK < 0.042 FT/FT  
WITHOUT CLIMBING LANE

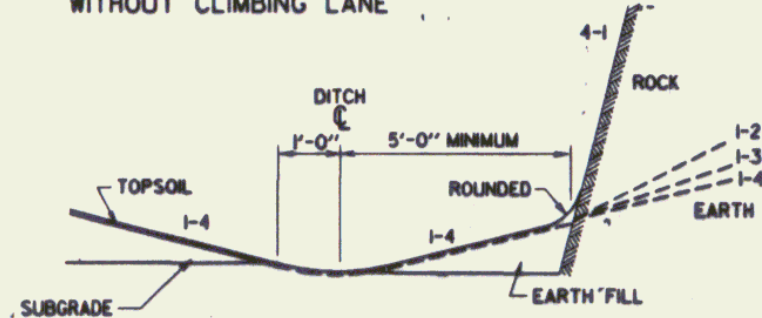

DETAILS OF DITCH AND BACKSLOPE FOR  
LOW SIDE OF BANK ≥ 0.042 FT/FT  
WITHOUT CLIMBING LANE

FOR SLOPES IN SOLID ROCK EXCAVATION  
AND DRILLING AND BLASTING OF SOLID  
ROCK SUBGRADE, SEE STANDARD SHEET A-60.

DATUM  
VERTICAL NGVD 1929  
HORIZONTAL NAD 1927

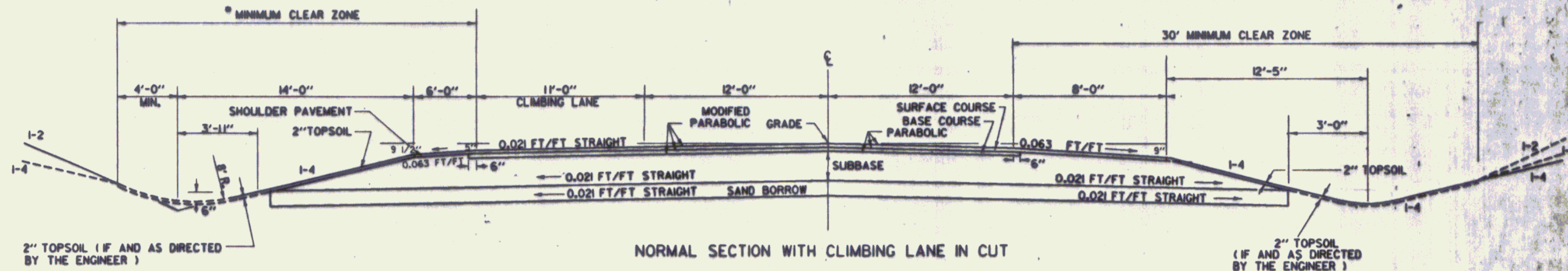

NORMAL SECTION WITH CLIMBING LANE IN CUT

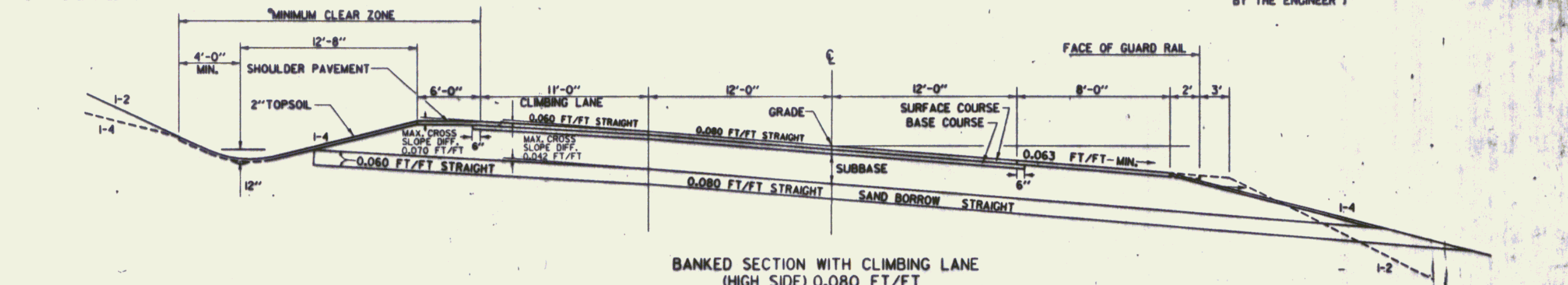

BANKED SECTION WITH CLIMBING LANE  
(HIGH SIDE) 0.080 FT/FT

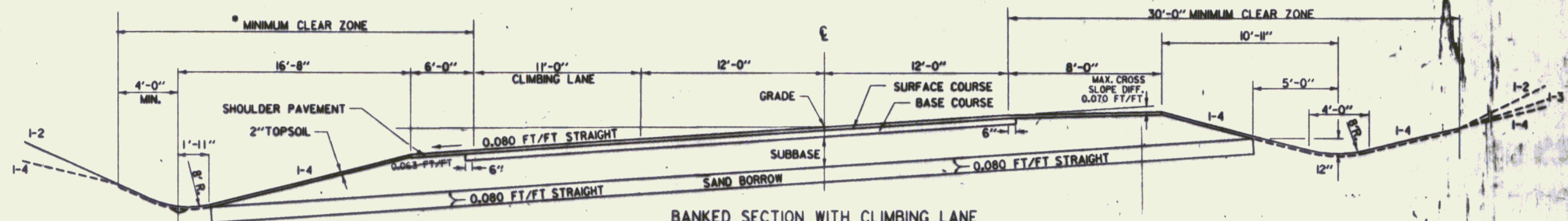

BANKED SECTION WITH CLIMBING LANE  
LOW SIDE 0.080 FT./FT.

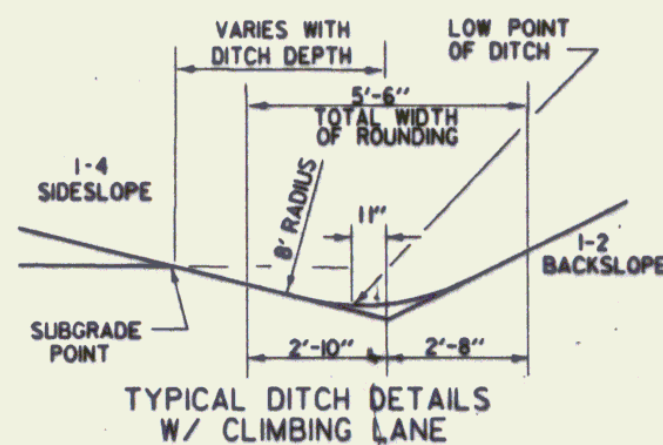

TYPICAL DITCH DETAILS  
W/ CLIMBING LANE

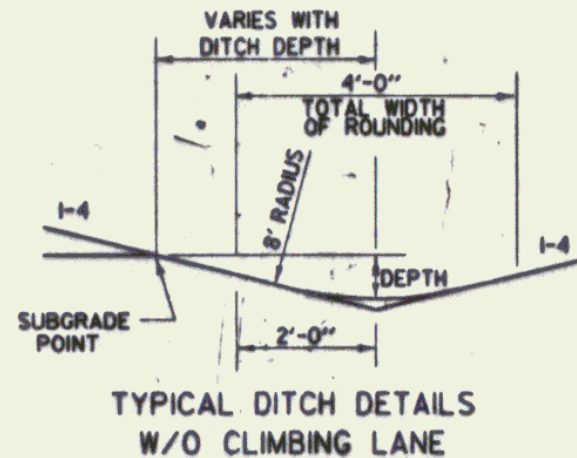

TYPICAL DITCH DETAILS  
W/O CLIMBING LANE

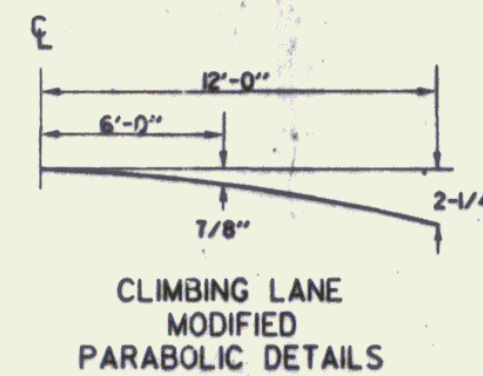

CLIMBING LANE  
MODIFIED  
PARABOLIC DETAILS

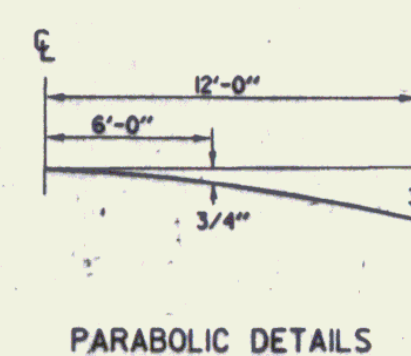

PARABOLIC DETAILS

MAR 20, 1998

SURVEYED BY	REDMOND	DATE	9/89
DRAWN BY	LJUNGVALL	DATE	9/89
DESIGN FILE NO.	ZG0150.67/84E070.DGN		
PRF FILE	84E070TY1	DATE PLOTTED	13-SEP-1990
BRATTLEBORO HES 010-1(30)			
R.O.W. SHEET 2 OF 11 SHEETS			

# TYPICAL SECTIONS TH 48 CONNECTOR

MATERIAL ITEM	THICKNESS TOLERANCE
PAVEMENT	± 1/4"
SUBBASE	± 1"
GRANULAR BORROW	± 1"
SAND BORROW	± 1"

2 - 1/2" BITUMINOUS CONCRETE PAVEMENT (2 LIFTS 1/4" TYPE III)  
18" SUBBASE OF GRAVEL  
SHOULDERS 1 - 1/2" BITUMINOUS CONCRETE PAVE

0" TO 12" GRANULAR BORROW (IN FILLS) } AS INDICATED ON THE PLANS OR  
0" TO 12" SAND BORROW (IN CUTS) } AS DIRECTED BY THE ENGINEER

• THE MINIMUM CLEAR ZONE EXTENDS FROM THE EDGE OF THE TRAVEL WAY TO THE BACK OF DITCH.

## SEEDING FORMULA RURAL AREAS

% WT.	LBS./A.	NAME	PUR %	GERM %
3.33	2	CROWN VETCH	97	75
50.00	30	CREeping RED FESCUE	98	85
8.33	5	TIMOTHY	99	85
16.67	10	PERENNIAL RYE GRASS (VAR. PENNINE)	95	85
8.34	5	ALFAPA (VAR. SARANAC)	99	85
8.33	5	BIRDFOOT TREFLOIL (VAR. EMPIRE)	98	85
5.00	3	HIGHLAND BENT GRASS	92	85
100.00	60			

THE SEED MIXTURE SHALL NOT HAVE A WEED CONTENT EXCEEDING 0.40% BY WEIGHT AND SHALL BE FREE OF ALL NOXIOUS WEED SEED.  
SEED- TO BE APPLIED PER SEEDING FORMULAS DIRECTED BY THE ENGINEER.  
FERTILIZER- FORMULA 10-20-10 TO BE USED WITH SEED, APPLIED AT THE RATE OF 500 LBS./ACRE.  
AGRICULTURAL LIMESTONE- TO BE APPLIED AT THE RATE OF 2 TONS/ACRE OR AS DIRECTED BY THE ENGINEER.  
HAY MULCH- TO BE PLACED ON EARTH SLOPES AT THE RATE OF 2 TONS/ACRE, OR AS DIRECTED BY THE ENGINEER.  
TOPSOIL- TO BE USED WITH SEED AS INDICATED ON THE PLANS, OR AS DIRECTED BY THE ENGINEER.  
MARKER POSTS- TO BE PLACED AS DIRECTED BY THE ENGINEER.  
SLOPE ROUNDING- ALL CUT SLOPES TO BE ROUNDED IN ACCORDANCE WITH STANDARD SHEET B-5  
PAY LIMITS OF SAND BORROW WHEN USED IN CONJUNCTION WITH UNDERDRAIN- SEE STANDARD SHEET D-2.

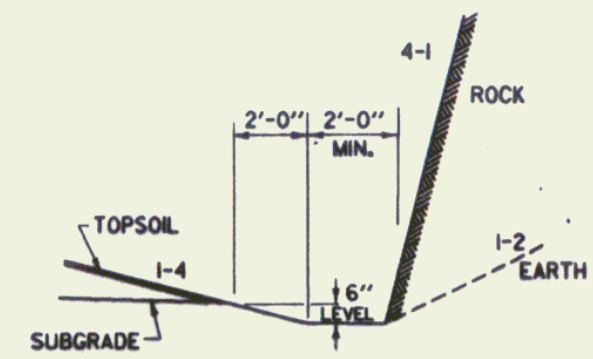
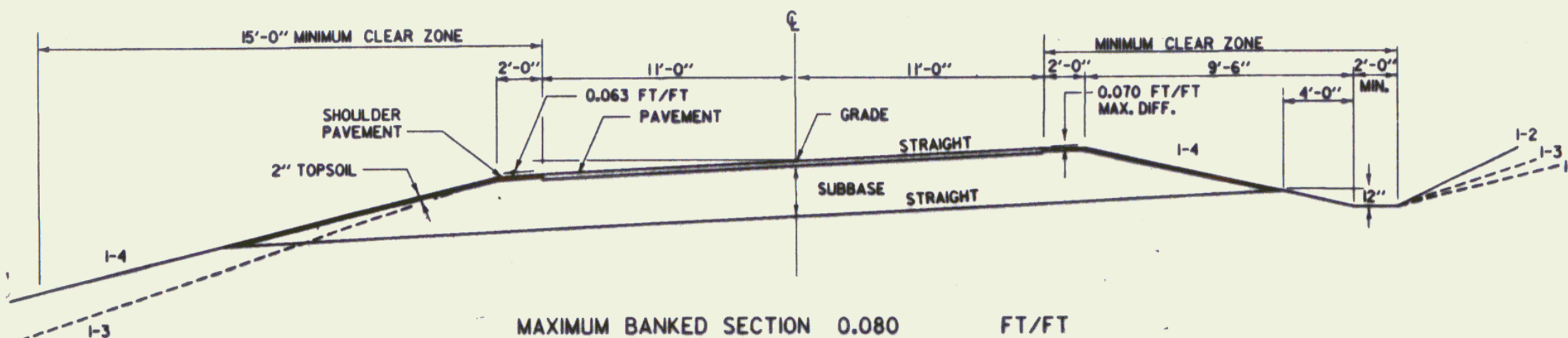
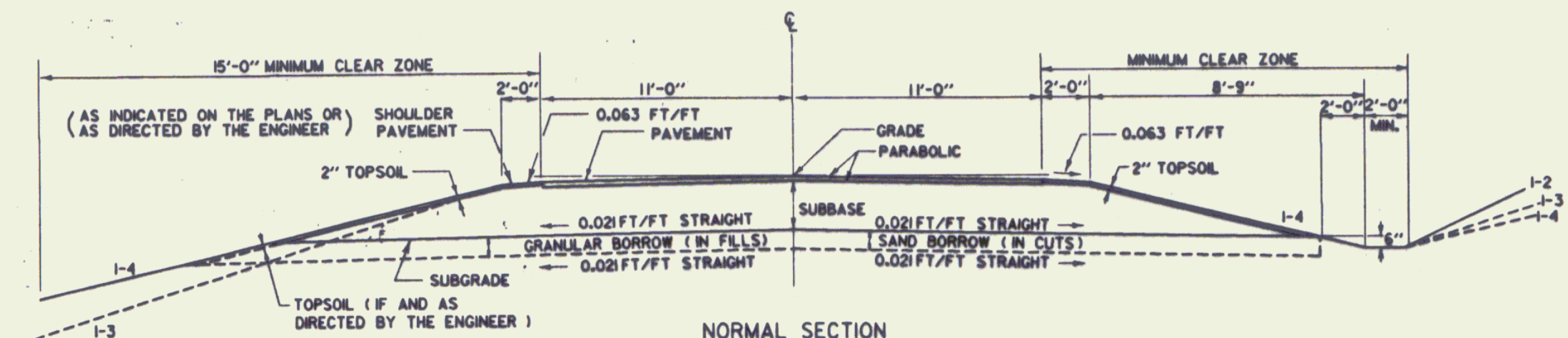

DETAILS OF DITCH AND BACKSLOPE FOR LOW SIDE OF BANK < 0.042 FT/FT

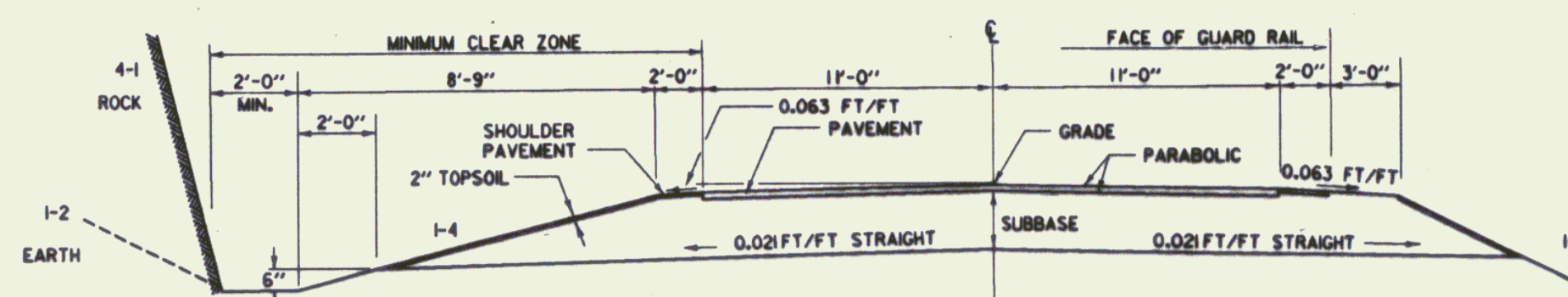

NORMAL SECTION IN ROCK CUT

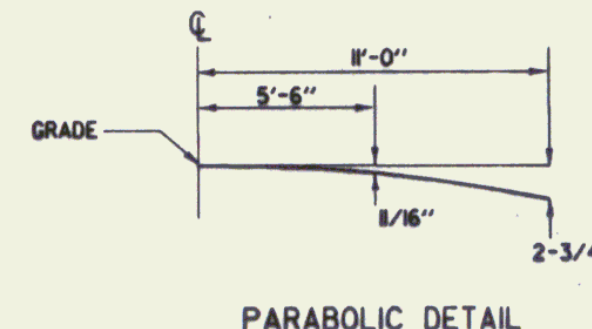

PARABOLIC DETAIL

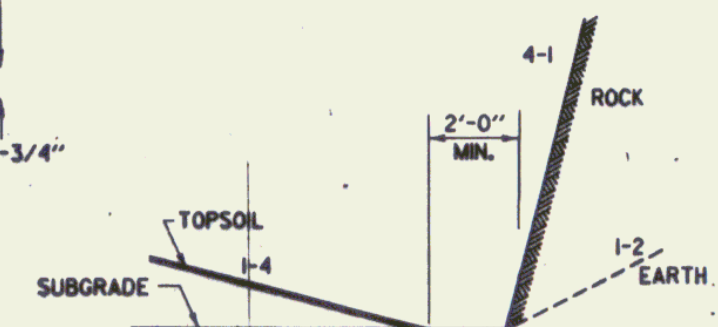

DETAILS OF DITCH AND BACKSLOPE FOR LOW SIDE OF BANK ≥ 0.042 FT/FT

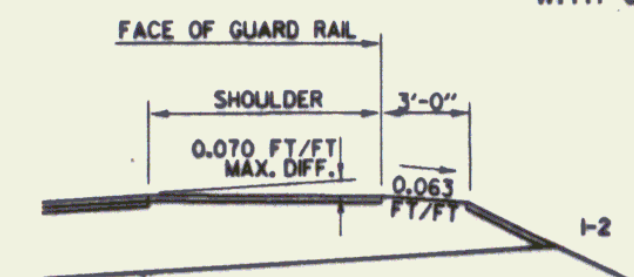

DETAIL OF GUARD RAIL ON HIGH SIDE OF BANKED SECTION

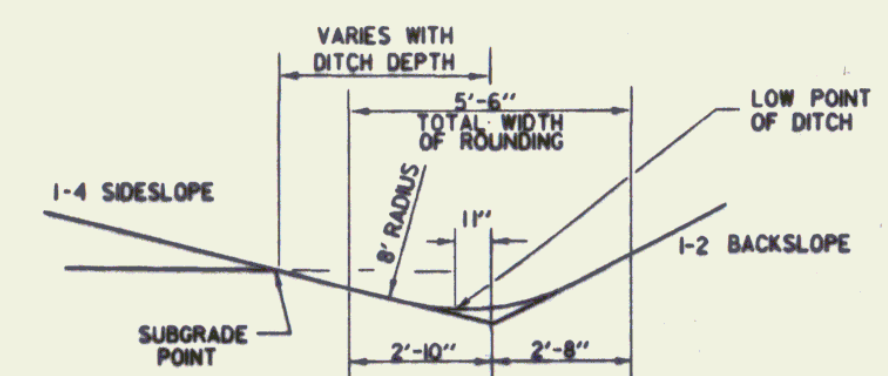

TYPICAL DITCH DETAILS

FOR SLOPES IN SOLID ROCK EXCAVATION AND DRILLING AND BLASTING OF SOLID ROCK SUBGRADE, SEE STANDARD SHEET A-61.

DATUM	VERTICAL	NGVD 1929
	HORIZONTAL	NAD 1927

MAR 20 1996

SURVEYED BY	REDMOND	DATE	9/88
DRAWN BY	LJUNGVALL		
SQUAD LEADER			
DESIGN FILE NO.	ZG0150.6734E070.DGN		
PRF FILE	B4E070TYT	DATE PLOTTED	15-JUN-1990

BRATTLEBORO  
HES 010-1(30)  
R.O.W. SHEET 3 OF 11 SHEETS

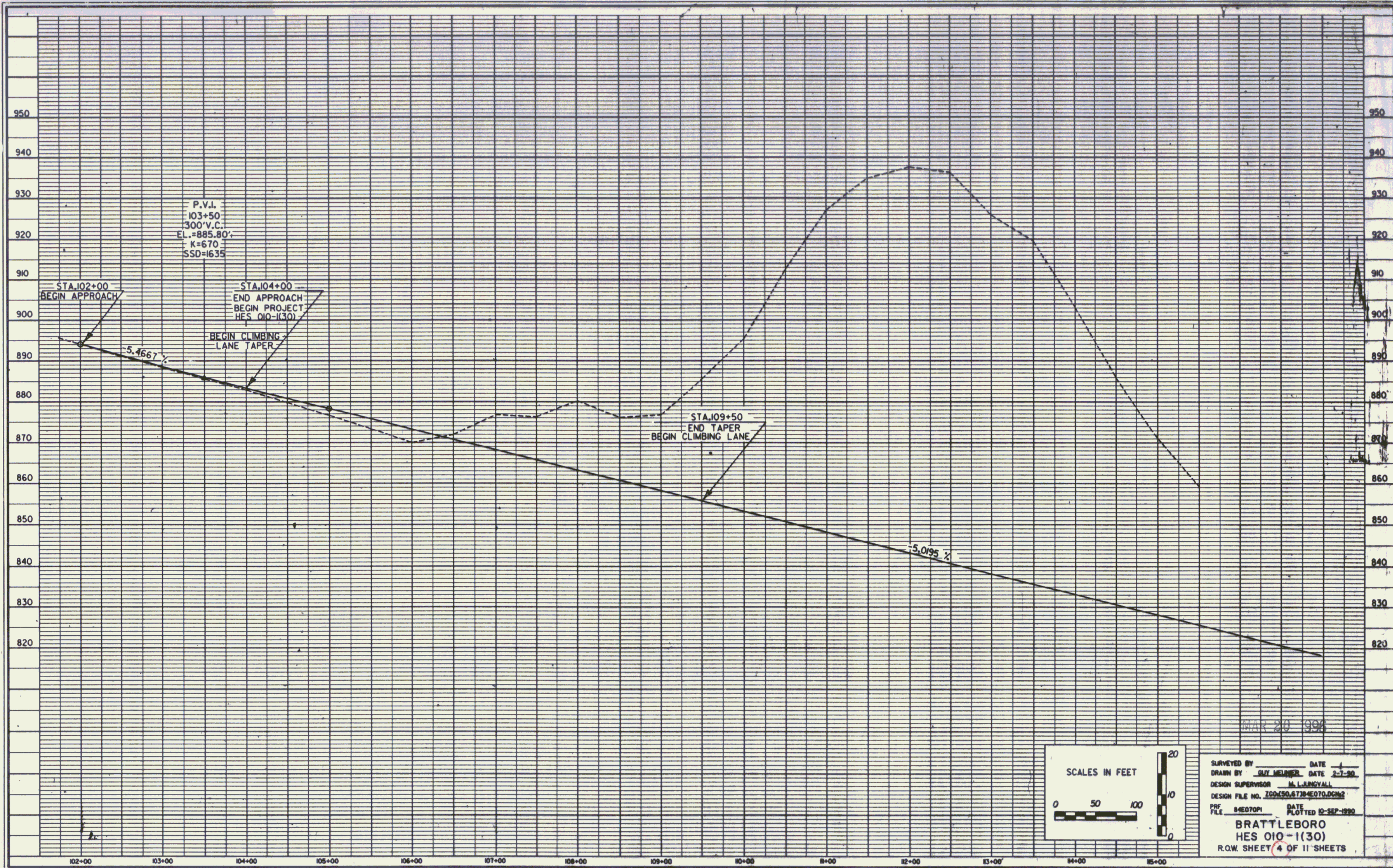

MAR 20 1996

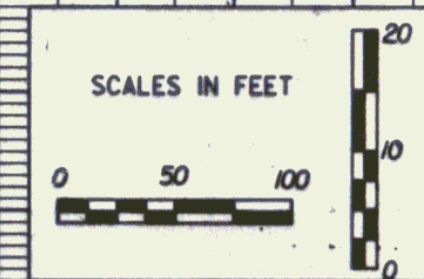

SURVEYED BY \_\_\_\_\_ DATE \_\_\_\_\_  
 DRAWN BY GUY MELNER DATE 2-7-90  
 DESIGN SUPERVISOR M. L. JUNGVAL  
 DESIGN FILE NO. 100(50.67)B4E070.DC12  
 PRF FILE 84E070P1 DATE PLOTTED 10-SEP-1990  
**BRATTLEBORO**  
**HES 010-1(30)**  
 R.O.W. SHEET 4 OF 11 SHEETS

TOWN HIGHWAY # 48

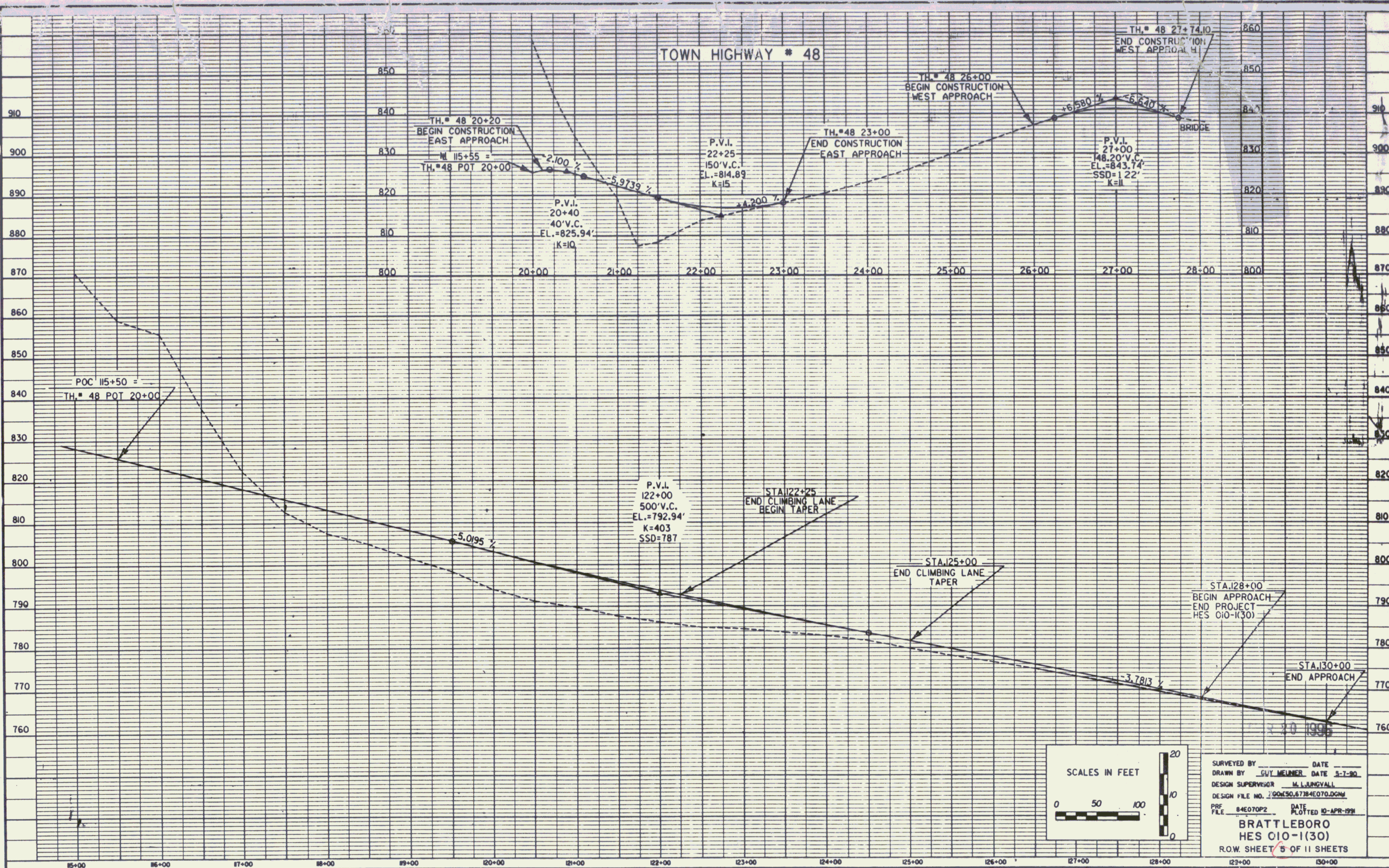

POC 115+50 =  
TH # 48 POT 20+00

TH # 48 20+20  
BEGIN CONSTRUCTION  
EAST APPROACH  
TH # 48 POT 20+00

P.V.I.  
20+40  
40' V.C.  
EL. = 825.94'  
K=10

P.V.I.  
22+25  
150' V.C.  
EL. = 814.89'  
K=15

TH # 48 23+00  
END CONSTRUCTION  
EAST APPROACH

P.V.I.  
27+00  
148.20' V.C.  
EL. = 843.74'  
SSD = 122'  
K=11

TH # 48 27+74.10  
END CONSTRUCTION  
WEST APPROACH

BRIDGE

P.V.I.  
122+00  
500' V.C.  
EL. = 792.94'  
K=403  
SSD=787

STA 122+25  
END CLIMBING LANE  
BEGIN TAPER

STA 125+00  
END CLIMBING LANE  
TAPER

STA 128+00  
BEGIN APPROACH  
END PROJECT  
HES 010-1(30)

STA 130+00  
END APPROACH

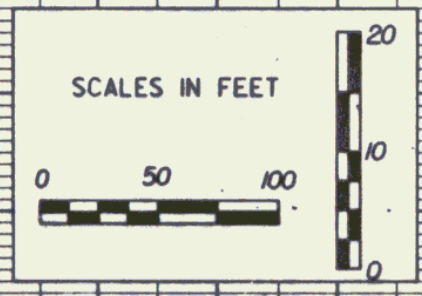

SURVEYED BY \_\_\_\_\_ DATE \_\_\_\_\_  
 DRAWN BY GUY MEINER DATE 3-1-90  
 DESIGN SUPERVISOR M. L. JUNGVAL  
 DESIGN FILE NO. 200130.67184070.DGN  
 PRF FILE 84E070P2 DATE PLOTTED 10-APR-1991  
**BRATTLEBORO**  
**HES 010-1(30)**  
 R.O.W. SHEET 5 OF 11 SHEETS

**STATE OF VERMONT  
AGENCY OF TRANSPORTATION  
RIGHT OF WAY PLANS  
DETAIL SHEET**

**TABLE OF PROJECT PROPERTY ACQUISITION**

PARCEL NO.	GRANTOR	SHEET NO.	BEGINNING STATION	ENDING STATION	TAKING	REM.	RIGHTS	TITLE TAKEN	DATE	TOWN OR CITY RECORDED	BK.	PG.	REMARKS	REVISION NO.	SHEET	DESCRIPTION OF REVISION	DATE	MADE BY	APPROVED BY
1	STARK, DONALD A.	10	101+84 RT. 101+84 RT.	102+02 RT. 102+00 RT.			CONST. (T) 0.01A± SLOPE (T) 0.01A±	AGREE.		BRATTLEBORO			80 S.F.± 150 S.F.±	1	7,10 11	PARCEL NO. 5 DODGE. ADD DODGE, ETTA M. - LESSEE TO TITLE. PER C.O. 8125.	10-07-91	M. J. R.	L. W. B.
2	STRONG, ANN S.	10	102+00 CL. 102+00 RT. 102+00 RT. 103+50 RT. 105+50 RT. 108+10 RT. 108+25 RT. TH 48 27+40 RT. TH 48 27+42 RT.	108+88 RT. 103+50 RT. 107+10 RT. 107+00 RT. 108+90 RT. 108+75 RT. TH 48 27+65 RT. TH 48 27+80 RT.	0.41A±		ALL R. T. & I. SLOPE (T) 0.13A± CONST. (T) 0.11A± SLOPE (P) 0.10A± CUL., DIT. & DR. (P) CONST. (T) 0.02A± DITCH & DRAINAGE (P) 0.02A± SLOPE (T) 0.01A± CONST. (T) 0.01A±	WD	02-17-93	BRATTLEBORO	233	501	VT. RTE. 9  1000 S.F.± 900 S.F.± 260 S.F.± 400 S.F.±	2	6,10	PARCEL NO. 2 STRONG. ADD ANN S. STRONG TO TITLE. PER C.O. 8124.	10-07-91	M. J. R.	L. W. B.
2A		10	103+40 RT.±				CUL., DIT. & DR. (P)	WDOE	07-21-95	BRATTLEBORO	249	478		3	6,10	PARCEL NO. 3 HAMILTON. CHANGE P/L ALIGNMENT. INCREASE TAKE, REMAINDER AND CHANGE ENDING STATION. PER C.O. 8168.	01-03-91	M. J. R.	F. J. M.
3A	HAMILTON, ELWIN R. & CINDY C.	10	102+00 LT. 109+00 RT. 105+50 LT. 109+60 RT. 113+22 LT.	113+69 RT. 113+69 RT. 113+22 LT. 113+38 RT. 113+10 LT.	4.71A±	2.58A±	SLOPE (P) 0.62A± CONST. (T) 0.12A± ALL R. T. & I.	WD		BRATTLEBORO			STONE WALL	4	7,10 11	PARCEL NO. 5 DODGE. CHANGE TAKE TO 2.94A± REMAINDER 0.33A±. CHANGE BEG. STA. OF REMAINDER TO 113+69 RT. ADD ALL R.T. & I. FOR STORAGE SHED AT 119+55 LT. ON PARCEL 5B CHANGE STA. 24+80 CL TO 23+86 CL, 0.40A±. ADD WALL, WALK & SHED TOPO. PER C.O. 8167.	01-03-92	M. J. R.	F. J. M.
3B		10	102+00 CL.	109+00 RT.	0.41A±		ALL R. T. & I.						VT. RTE. 9	5	7,11	PARCEL NO. 7 OLSON. CHANGE STA. TO REV. 124+28 LT. FOR ALL R.T. & I. IN ROW. PER C.O. 8164.	01-03-92	M. J. R.	F. J. M.
4A	BOYD, MARK A. & BOYD, EMILY A.	11	119+25 RT. 116+15 RT. 116+20 RT. 117+35 RT. 118+25 RT. 118+55 RT. REV. 121+60 RT. REV. 122+50 RT.	REV. 124+31 RT. 117+75 RT. 116+60 RT. 117+65 RT. REV. 124+31 RT. REV. 122+50 RT. REV. 124+12 RT.	0.23A±		CONST. (T) 0.07A± DITCH & DRAINAGE (P) 0.02A± DITCH & DRAINAGE (P) 0.01A± CONST. (T) 0.13A± SLOPE (P) 0.11A± CUL., DIT. & DR. (P) SLOPE (T) 0.06A±	WD		BRATTLEBORO			2934 S.F.± 765 S.F.± 225 S.F.±  2494 S.F.±	6	8,11	PARCEL NO. 8 OLSON. CHANGE STA. TO REVISED 124+28 LT. FOR ALL R.T. & I. IN ROW. CHANGE TAKE LINE NOT TO INCLUDE TOTAL COMMON ROW. REDUCE TAKE TO 0.12A±. PER C.O. 8163.	01-03-92	M. J. R.	F. J. M.
4B		11	115+95 RT.	REV. 124+31 RT.	0.51A±		ALL R. T. & I.						VT. RTE. 9	7	8,11	PARCEL NO. 9 FILION & STALKER. CHANGE STA. TO REV. 124+28 LT. FOR ALL R.T. & I. IN ROW. PER C.O. 8162.	01-03-92	M. J. R.	F. J. M.
	PARCEL 4 CONTINUED ON FOLLOWING SHEET													8	8,11	PARCEL NO. 10 BORST. CHANGE STA. TO REV. 124+28 LT. FOR ALL R.T. & I. IN ROW. PER C.O. 8165.	01-03-92	M. J. R.	F. J. M.
														9	8,11	PARCEL NO. 11 DEROSIA. CHANGE STA. TO REV. 124+28 LT. FOR ALL R.T. & I. IN ROW. PER C.O. 8166.	01-03-92	M. J. R.	F. J. M.
														10	7,11	PARCEL NO. 5 DODGE. CHANGE TAKE FROM 2.99 A± TO 2.94A±; CHANGE REMAINDER FROM 0.57A± TO 0.33A±; CHANGE BEGINNING STA. OF REMAINDER FROM 113+38 RT. TO 113+69 RT.; ADD ALL R. T. & I. AT STA. 119+55 LT. FOR STORAGE SHEDS.; ON PARCEL 5B, CHANGE STA. 24+80 CL. TO 23+86 CL. AND AREA FROM 0.45 A± TO 0.40A±; ADD NEW TOPO TO LAYOUT. PER C.O. 8167.	01-03-92	M. J. R.	F. J. M.
														11	7	PARCEL NO. 5 DODGE. REMOVE *PERSONAL PROPERTY* ON MOBILE HOME. PER C.O. 8177.	01-03-92	M. J. R.	F. J. M.

MAR 20 1996

03-3220 1805 84E070

DR. (P)- DRAINAGE RIGHT  
DIT. (P)- DITCHING RIGHT  
CH. (P)- CHANNEL RT.  
DRIVE (T)- DRIVE RIGHT  
CUL. (P)- CULVERT RIGHT  
[W]- WATER SOURCES

PRESENT R.O.W.  
TAKING WITHOUT ACCESS  
TAKING WITHOUT ACCESS ALONG PROPERTY LINE  
TAKING WITH ACCESS  
PERMANENT EASEMENT  
TEMPORARY EASEMENT

LEGEND  
CZ (P)  
CONST. (T)  
SR SR  
P  
L  
CLEAR ZONE  
CONSTRUCTION EASEMENT  
SLOPE RIGHTS  
PROPERTY LINE  
TOP OF CUT  
TOE OF SLOPE

REVISED 04-13-95

R. O. W. PLANS

ACCT. prop  
/prop/84e070/ra070d.dgn  
DATE PLOTTED 13-APR-1995  
84e070d.l

APPROVED: LAWRENCE BLISS L.S. DATE: 8-26-91  
AGENT D, PLANS & TITLES

BRATTLEBORO  
HES 010-1(30)

SHEET 6 OF 11

TABLE OF PROJECT PROPERTY ACQUISITION

STATE OF VERMONT  
AGENCY OF TRANSPORTATION  
RIGHT OF WAY PLANS  
DETAIL SHEET

PARCEL NO.	GRANTOR	SHEET NO.	BEGINNING STATION	ENDING STATION	TAKING	REM.	RIGHTS	TITLE TAKEN	DATE	TOWN OR CITY RECORDED	BK.	PG.	REMARKS	REVISION NO.	SHEET	DESCRIPTION OF REVISION	DATE	MADE BY	APPROVED BY
4C	PARCEL 4 CONTINUED FROM PREVIOUS SHEET BOYD, MARK A. & BOYD, EMILY A.	10	TH 48 27+14 LT. TH 48 26+55 LT. TH 48 26+30 LT.	TH 48 27+20 LT. TH 48 27+60 LT. TH 48 27+80 LT.			INSTALL & MAINTAIN (P) SLOPE (T) 0.01A± CONST. (T) 0.02A±						GUARDRAIL 150 S.F. ± 900 S.F. ±	12	9,10	RELINQUISHMENT NO. 1. CHANGE BEG. STA. TO TH 48 27+42 RT. AND REDUCE LENGTH TO 735'. PER C.O. 8194.	01-30-92	M. J. R.	F. J. M.
5A	BELLOWS FALLS TRUST COMPANY	10,11	113+22 LT. 113+22 LT. 117+90 LT. 119+00 LT. 118+50 LT. 119+55 LT. ±	119+65 RT. 113+10 LT.	2.94A±	NONE	ALL R. T. & I. ALL R. T. & I. ALL R. T. & I.	WD	07-07-93	BRATTLEBORO	236	572	STONE WALL ARTESIAN WELL SEPTIC TANK & APPURTENANCE DRIVE 12' GRAVEL M.P. 0147 STORAGE SHEDS	13	9,11	PARCEL NO. 17 OLSON. ADD NEW PARCEL NO. 17 OLSON, EDWARD W. & JOYCE M. PER C.O. 8198.	02-18-92	M. J. R.	F. J. M.
5B		10,11	TH 48 23+86 CL.	119+65 LT.	0.40A±		ALL R. T. & I.						VT RTE. 9	14	7,10	PARCEL NO. 18 DODGE. ADD NEW PARCEL (*18) FOR ETTA M. DODGE, ALL R. T. & I. IN HOUSE TRAILER, 118+85 LT. ~ 119+50 LT. PER C.O. 8205.	03-06-92	M. J. R.	L. W. B.
5C		10,11	113+69 RT.	114+50 RT.	0.33A±									15	7,10	PARCEL NO. 5 DODGE. CHANGE TITLE TO BELLOWS FALLS TRUST COMPANY. REMOVE ALL R. T. & I. IN HOUSE TRAILER. PER C.O. 8206.	03-06-92	M. J. R.	L. W. B.
5D		10,11	113+22 LT.	119+65 LT.	6.73A±									16	6,10	PARCEL NO. 2 STRONG. REMOVE RAYMOND B. STRONG, JR. FROM DETAIL SHEET AND LAYOUT. PER C.O. 8287.	11-09-92	C. C. P.	L. W. B.
6	AKELEY, MARIAN D. BOYD, EMILY E. STARK, ELIZABETH A. DODGE, ETTA M.	10,11	TH 48 23+38 CL. TH 48 22+25 LT. TH 48 22+25 RT.	116+15 RT.	0.15A±		ALL R. T. & I. DRIVE (T) ALL R. T. & I.	WD	10-08-92	BRATTLEBORO	230	668	VT RTE. 9 12' GRAVEL SPRING & APPURTENANCE	17	7,11	PARCEL NO. 5 BELLOWS FALLS TRUST CO. REMOVE ALL R. T. & I. IN RIGHTS COLUMN OF DETAIL SHEET AND ON LAYOUT FOR STORAGE SHEDS AT STA. 119+55 LT. ± PER C.O. 8289.	11-30-92	C. C. P.	L. W. B.
7A	OLSON, STEVEN M. & DIANE M.	11	119+65 LT. REV. 120+00 LT. REV. 120+25 LT. REV. 121+25 LT.	REV. 121+45 LT. REV. 121+45 LT. REV. 121+45 LT.	0.14A±		CONST. (T) 0.03A± DITCH (P) 0.01A± CULVERT (P)	WD		BRATTLEBORO			1237 S.F. ± 423 S.F. ±	18	8,11	PARCEL NO. 8 OLSON. REMOVE CAROL A. OLSON FROM TITLE. ADD PERSONAL PROPERTY, SIGN, AT STA. 124+78 LT. PER C.O. 8312.  MYLARS TO DESIGN 03-15-93	01-26-93	M. J. R.	L. W. B.
7B		11	119+65 CL.	REV. 121+45 LT.	0.10A±		ALL R. T. & I.						VT RTE. 9	19	7,10	PARCEL NO. 5 BELLOWS FALLS TRUST COMPANY. ADD PARCELS 5C AND 5D TO DETAIL AND LAYOUT SHEETS. ALSO DELETE REMAINDER LISTED IN PARCEL 5A. PER C.O. 8348.	04-02-93	C. C. P.	L. W. B.
7C		11	REV. 124+28 LT. REV. 124+65 LT.	REV. 125+70 LT.			ALL R. T. & I. DRIVE (T)						20' R.O.W. TO RTE. 9 30' GRAVEL M.P. 0159	20	7,10	PARCEL NO. 5A BELLOWS FALLS TRUST COMPANY. REMOVE SLOPE (P), 0.16A±, STA. 13+10 LT. ~ 117+20 LT. FROM LAYOUT & DETAIL SHEET. PER C.O. 8353.	04-07-93	C. C. P.	L. W. B.
														21	6,10	PARCEL NO. 2 STRONG. ADD NEW SUB-PARCEL 2A WITH 'CUL., DIT. & DR (P)' AT STA. 103+40 RT. ± PER C.O. 8679.	04-13-95	C. C. P.	L. W. B.

MAR 20 1996

ACCT.prop  
/prop/84e070/re070d.dgn  
DATE PLOTTED 13-APR-1995  
84e070d2.1

03-3220 1805 84E070

DR. (P)- DRAINAGE RIGHT  
DIT. (P)- DITCHING RIGHT  
CH. (P)- CHANNEL RT.  
DRIVE (T)- DRIVE RIGHT  
CUL. (P)- CULVERT RIGHT  
[W]- WATER SOURCES

PRESENT R.O.W.  
TAKING WITHOUT ACCESS  
TAKING WITHOUT ACCESS ALONG PROPERTY LINE  
TAKING WITH ACCESS  
PERMANENT EASEMENT  
TEMPORARY EASEMENT

LEGEND . . . CZ (P) . . . . . CLEAR ZONE  
CONST. (T) CONSTRUCTION EASEMENT  
SR SR SLOPE RIGHTS  
L L PROPERTY LINE  
P P TOP OF CUT  
O O TOE OF SLOPE

REVISED 04-13-95

APPROVED: LAWRENCE BLISS L.S. DATE: 8-26-91  
AGENT D. PLANS & TITLES

R. O. W. PLANS

BRATTLEBORO  
HES 010-1(30)  
SHEET 7 OF 11

**STATE OF VERMONT  
AGENCY OF TRANSPORTATION  
RIGHT OF WAY PLANS  
DETAIL SHEET**

**TABLE OF PROJECT PROPERTY ACQUISITION**

PARCEL NO.	GRANTOR	SHEET NO.	BEGINNING STATION	ENDING STATION	TAKING	REM.	RIGHTS	TITLE TAKEN	DATE	TOWN OR CITY RECORDED	BK.	PG.	REMARKS	REVISION NO.	SHEET	DESCRIPTION OF REVISION	DATE	MADE BY	APPROVED BY
8A	OLSON, MICHAEL J.	11	REV. 121+45 LT. REV. 121+45 LT. REV. 121+45 LT. REV. 124+24 LT. REV. 126+50 LT. REV. 126+50 LT. REV. 124+00 LT. REV. 124+65 LT. REV. 124+78 LT. REV. 125+20 LT.	REV. 125+70 LT. REV. 122+25 LT. REV. 124+00 LT. REV. 126+62 LT. REV. 126+62 LT. REV. 125+70 LT.	0.12A±		SLOPE (T) 0.01A± CONST. (T) 0.04A± CULVERT (P) ALL R. T. & I. SLOPE (T) 0.01A± DRIVE (T) SLOPE (T) 0.01A±	WD		BRATTLEBORO			516 S.F.± 1885 S.F.± STONE WALL 102 S.F.± SIGN - PERSONAL 30' GRAVEL M.P. 0159 SIGN - PERSONAL 330 S.F.±	22	10,11	REVISE RELINQUISHMENT NO. 1. REVISE MAINTENANCE AGREEMENT AREA NO. 1 ACCORDING TO THE MARKED UP PLANS. PER C.O. 8805.	08-20-96	M. J. R.	L. W. B.
8B		11	REV. 121+45 LT.	REV. 126+62 LT.	0.30A±		ALL R. T. & I.						VT RTE. 9						
8C		11	REV. 124+28 LT.	REV. 125+70 LT.			ALL R. T. & I.						20' R.O.W. TO RTE. 9						
9	FILION, PETER J. & STALKER, CYNTHIA D.	11	REV. 124+28 LT. REV. 124+65 LT.	REV. 125+70 LT.			ALL R. T. & I. DRIVE (T)	QCD		BRATTLEBORO			20' R.O.W. TO RTE. 9 30' GRAVEL M.P. 0159						
10	BORST, HARRY W. JR. & CAROLYN E.	11	REV. 124+28 LT. REV. 124+65 LT.	REV. 125+70 LT.			ALL R. T. & I. DRIVE (T)	QCD		BRATTLEBORO			20' R.O.W. TO RTE. 9 30' GRAVEL M.P. 0159						
11	DEROSIA, STEPHEN V. & KRIS A.	11	REV. 124+28 LT. REV. 124+65 LT.	REV. 125+70 LT.			ALL R. T. & I. DRIVE (T)	QCD		BRATTLEBORO			20' R.O.W. TO RTE. 9 30' GRAVEL M.P. 0159						
12A	GOLEMBIEWSKI, JOSEPH H. & KARIN G.	11	REV. 124+31 RT. REV. 127+25 RT. 128+00 RT. 129+50 RT. 129+80 RT.	130+00 RT. 130+00 RT. 129+70 RT. 130+15 RT.	0.31A±		CONST. (T) 0.06A± SLOPE (T) 0.02A± CUL., DIT. & DR. (P) REMOVE & RESET (T)	WD	02-12-93	BRATTLEBORO	233	433	2701 S.F.± 981 S.F.± FENCE						
12B		11	REV. 124+31 RT.	130+00 RT.	0.32A±		ALL R. T. & I.						VT RTE. 9						

03-3220 1805 84E070

ACCT.prop  
/prop/84e070/re070d.dgn  
DATE PLOTTED 19-AUG-1996  
84e070d3.i

DR. (P)- DRAINAGE RIGHT  
DIT. (P)- DITCHING RIGHT  
CH. (P)- CHANNEL RT.  
DRIVE (T)- DRIVE RIGHT  
CUL. (P)- CULVERT RIGHT  
[W]- WATER SOURCES

PRESENT R.O.W.  
TAKING WITHOUT ACCESS  
TAKING WITHOUT ACCESS ALONG PROPERTY LINE  
TAKING WITH ACCESS  
PERMANENT EASEMENT  
TEMPORARY EASEMENT

LEGEND  
CZ (P) . . . . . CLEAR ZONE  
CONST. (T) . . . . . CONSTRUCTION EASEMENT  
SR . . . . . SLOPE RIGHTS  
P . . . . . PROPERTY LINE  
L . . . . . TOP OF CUT  
△ . . . . . TOE OF SLOPE

APPROVED: LAWRENCE BLISS L.S. DATE: 8-26-91  
AGENT D. PLANS & TITLES

R. O. W. PLANS

BRATTLEBORO  
HES 010-1 (30)  
SHEET 8 OF 11

TABLE OF PROJECT PROPERTY ACQUISITION

STATE OF VERMONT  
AGENCY OF TRANSPORTATION  
RIGHT OF WAY PLANS  
DETAIL SHEET

PARCEL NO.	GRANTOR	SHEET NO.	BEGINNING STATION	ENDING STATION	TAKING	REM.	RIGHTS	TITLE TAKEN	DATE	TOWN OR CITY RECORDED	BK.	PG.	REMARKS	REVISION NO.	SHEET	DESCRIPTION OF REVISION	DATE	MADE BY	APPROVED BY	
13A	MCKAY, JOHN E. & CHRISTIE W.	11	REV. 126+62 LT. REV. 126+77 LT. REV. 128+70 LT.	130+00 LT. 130+00 LT. 130+00 LT.	0.17A±		CONST. (T) 0.06A± SLOPE (T) 0.01A±	WD	01-25-93	BRATTLEBORO	233	104	2813 S.F. ± 427 S.F. ±							
13B		11	REV. 126+62 LT.	130+00 LT.	0.19A±		ALL R. T. & I.						VT RTE. 9							
14	TOWN OF BRATTLEBORO	10	TH 48 26+73 CL.				APPROACH (T)						TH 48							
15	NEW ENGLAND TELEPHONE COMPANY												UTILITY							
16	CENTRAL VERMONT PUBLIC SERVICE CORP.												UTILITY							
17	OLSON, EDWARD W. & JOYCE M.	11	REV. 124+28 LT. REV. 124+65 LT.	REV. 125+70 LT.			ALL R. T. & I. DRIVE (T)	QCD	01-28-93	BRATTLEBORO	233	211	20' ROW TO RTE. 9 30' GRAVEL MP 0159							
18	DODGE, ETTA M.	11	118+85 LT.	119+50 LT.			ALL R. T. & I.						HOUSE TRAILER							
	RELINQUISHMENT NO. 1	10, 11	TH 48 27+42 RT.	REV. 115+58 RT.									LENGTH 1115' VT. RTE. 9							
	MAINTENANCE AGREE. NO. 1	11	REV. 115+58 RT.	REV. 115+55 RT.									LENGTH 22' NEW T. H. 48							

MAR 20 1996

03-3220 1805 84E070  
ACCT. PROP  
ZFAHCT0,70384E0700.DGN  
PRF: 84E07004  
DATE PLOTTED 6-MAR-1992

DR. (P)- DRAINAGE RIGHT  
DIP. (P)- DITCHING RIGHT  
CH. (P)- CHANNEL RT.  
DRIVE (T)- DRIVE RIGHT  
CUL. (P)- CULVERT RIGHT  
W- WATER SOURCES

--- PRESENT R.O.W.  
--- TAKING WITHOUT ACCESS  
--- TAKING WITHOUT ACCESS ALONG PROPERTY LINE  
--- TAKING WITH ACCESS  
--- PERMANENT EASEMENT  
--- TEMPORARY EASEMENT

LEGEND  
--- CZ (P) --- CLEAR ZONE  
--- CONST. (T) --- CONSTRUCTION EASEMENT  
--- SR --- SLOPE RIGHTS  
--- P --- PROPERTY LINE  
--- L --- TOP OF CUT  
--- O --- TOE OF SLOPE

APPROVED: LAWRENCE BLISS L.S. DATE: 8-26-91  
AGENT D, PLANS & TITLES

R. O. W. PLANS  
BRATTLEBORO  
HES 010-1 (30)  
SHEET 9 OF 11

**EXCAVATION OF SURFACES & PAVEMENTS**  
 107+25 ~ 111+50 RT. (ON EXIST. RT. 9)  
 (DO NOT SEED THIS AREA GRAVEL SURFACE ONLY IS TO REMAIN)

**DRILLING & BLASTING OF SOLID ROCK SUBGRADE**  
 106+00 CL ~ 117+50 CL

**CONSTRUCT STONE LINED DITCH**  
 102+00 ~ 106+00 LT.

**REMOVAL & DISPOSAL OF GUARDRAIL**  
 108+35 ~ 111+25 RT. (ON EXIST. RT. 9)  
 TH # 48 27+50 LT ~ 27+65 LT.

**STEEL BEAM GUARD RAIL W/STEEL POSTS**  
 102+25 ~ 107+00 RT.

**BREAKWAY CABLE TERMINAL**  
 102+00 ~ 102+25 RT.  
 107+00 ~ 107+25 RT.

**REMOVE AND RESET GUARD RAIL**

**TERMINAL CONNECTOR FOR STEEL BEAM GUARD RAIL**  
 TH # 48 27+74.10 LT.

**HEAVY DUTY STEEL BEAM GUARD RAIL W/STEEL POSTS, TYPE I**  
 TH # 48 27+50 ~ 27+74.10 LT. (FACTORED LENGTH)

**CONSTRUCT DRIVE**  
 109+34 RT 16' WIDE

**STONE FILL TYPE II FOR SLOPE STABILIZATION**  
 105+50 ~ 114+00 LT

**PLANK RAIL**  
 108+88 RT ~ 109+00 R.

**CURVE DATA**  
 $\Delta = 68^{\circ}06'44''$  LT  
 $D = 7^{\circ}30'$   
 $R = 763.94'$   
 $T = 516.38'$   
 $L = 908.16'$   
 $E = 158.15'$

HAMILTON, ELWIN R. & CINDY C.  
 BANK = 0.080 FT / FT & CINDY C.  
 MAXIMUM CONSTRUCTION LIMITS FOR UNSUITABLE MATERIAL. (SEE NOTE 1 BELOW.)

**BEGIN R.O.W. PROJECT**

HES 010-1 (30) STA. 101+84.25' RT.

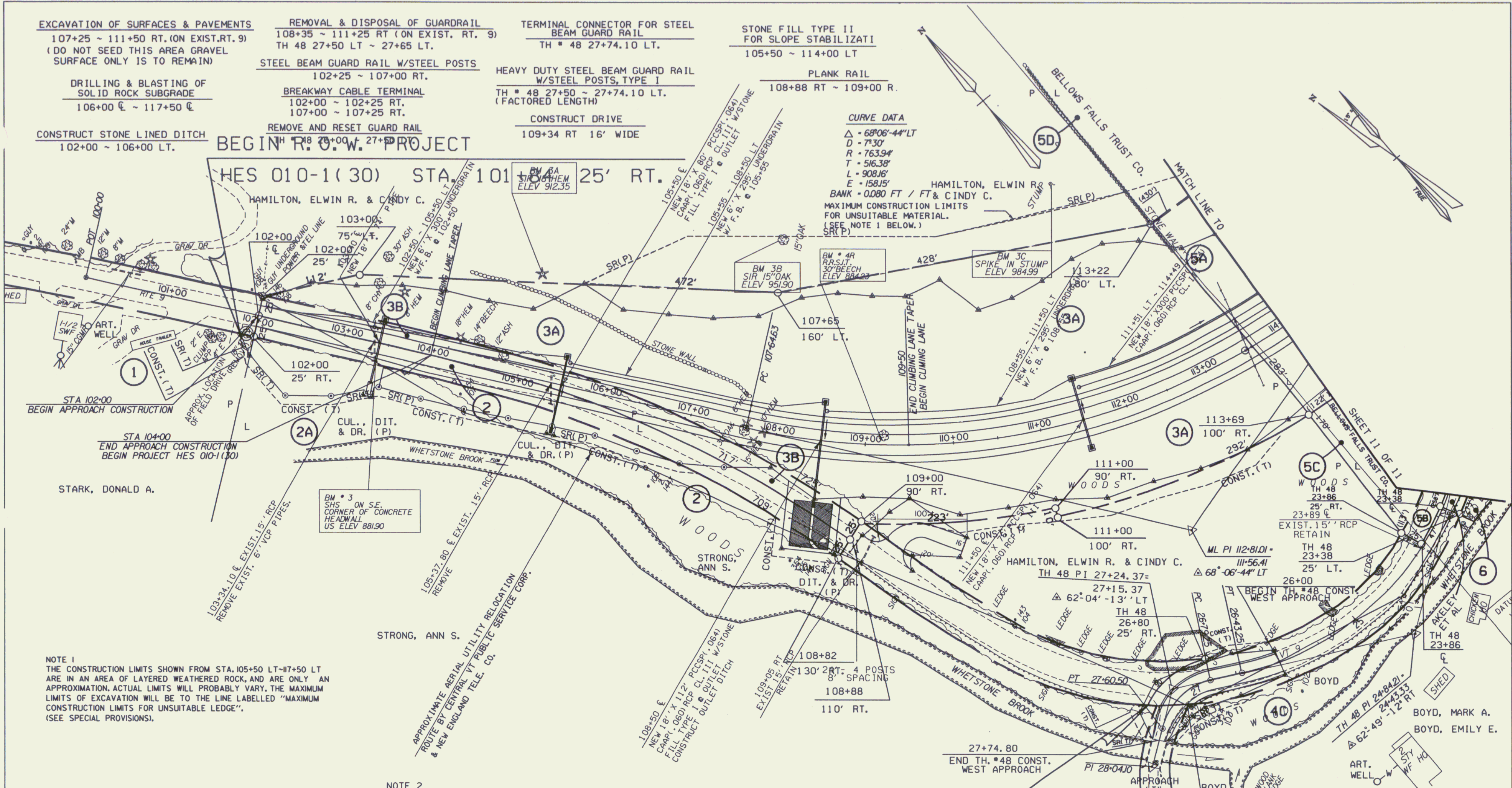

**NOTE 1**  
 THE CONSTRUCTION LIMITS SHOWN FROM STA. 105+50 LT-117+50 LT ARE IN AN AREA OF LAYERED WEATHERED ROCK, AND ARE ONLY AN APPROXIMATION. ACTUAL LIMITS WILL PROBABLY VARY. THE MAXIMUM LIMITS OF EXCAVATION WILL BE TO THE LINE LABELLED "MAXIMUM CONSTRUCTION LIMITS FOR UNSUITABLE LEDGE". (SEE SPECIAL PROVISIONS).

**NOTE 2**  
 EXISTING ROUTE #9 FROM STA 109+00 ~ 111+50 TO BE LEFT AS GRAVEL SURFACE IN PLACE

**DATUM**

VERTICAL	_____
HORIZONTAL	_____

○ DENOTES REMOVAL AND DISPOSAL OF TREES

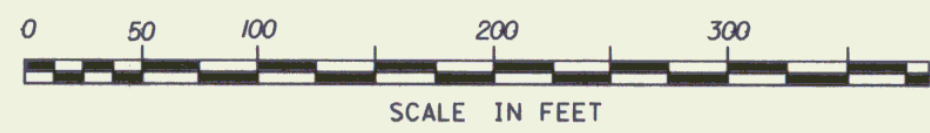

**BEGIN RELINQUISHMENT NO. 1**  
 TH #48 27+42 25' RT.

SURVEYED BY	REED & FALL	DATE 9/86&88
DRAWN BY	MENARD	DATE 10/86
SQUAD LEADER	L. JUNGVAL	
DESIGN FILE NO.	/p/0p/84e070/r0070zzz.dgn	
IPARM FILE	84e070iir	DATE PLOTTED 13-APR-1995

04-07-93	REVISION 20
04-02-93	REVISION 19
11-09-92	REVISION 16

**BRATTLEBORO**  
**HES 010-1 (30)**  
 R. O. W. SHEET 10 OF 11

MAR 20 1996

**EXCAVATION OF SURFACES & PAVEMENTS**  
 TH# 48 23+00 E ~ 118+20 RT (EXIST. RT 9)  
 M 122+50 E ~ 123+50 E

**DRILLING & BLASTING OF SOLID ROCK SUBGRADE**  
 106+00 E ~ 117+50 E

**REMOVE & REPLACE MAILBOX**  
 124+10 LT (MULTIPLE SUPPORT)  
 (NEW MAILBOXES @ 124+31 LT.)

**STEEL BEAM GUARDRAIL**  
 117+50 ~ 123+50 RT  
 125+35 ~ 127+13 LT

**CONSTRUCT DRIVES**  
 118+50 LT (12' WIDE)  
 124+65 LT (30' WIDE)  
 TH # 48 22+25 LT (12' WIDE)

**BREAKWAY CABLE TERMINAL**  
 117+25 ~ 117+50 RT.  
 123+50 ~ 123+75 RT.  
 125+10 ~ 125+35 LT.  
 127+13 ~ 127+38 LT.

**SURV. CURVE DATA**  
 $\Delta = 1511' - 10' LT$   
 $D = 7'30''$   
 $R = 763.95'$   
 $T = 101.84'$   
 $L = 202.48'$   
 $E = 6.76'$   
 BANK = 0.080 FT / FT

**CONSTRUCT STONE LINED DITCH**  
 117+50 ~ 118+26 LT.  
 118+73 ~ 121+25 LT.  
 126+65 ~ 130+00 LT.

**CONSTRUCT PAVED DITCH**  
 125+70 ~ 126+55 LT.

**SCARIFYING PAVEMENT**  
 118+00 E ~ 122+50 E

**END RELINQUISHMENT NO. 1**  
**BEGIN MAINT. AGREE. AREA NO. 1**  
 REV. 115+58 42' RT. LENGTH

OLSON, STEVEN M. & DIANE M.

OLSON, MICHAEL J.

FILION, PETER J. & STALKER, CYNTHIA D.

**REV. CURVE DATA**  
 $\Delta = 16'51'' - 08.3'' LT$   
 $D = 7'30''$   
 $R = 763.95'$   
 $T = 113.71'$   
 $L = 224.70'$   
 $E = 8.34'$   
 BANK = 0.080 FT / FT

McKAY, JOHN E. & CHRISTIE W.

**END R.O.W. PROJECT**  
**HES 010-1(30)**  
**STA. 130+15 15' RT.**

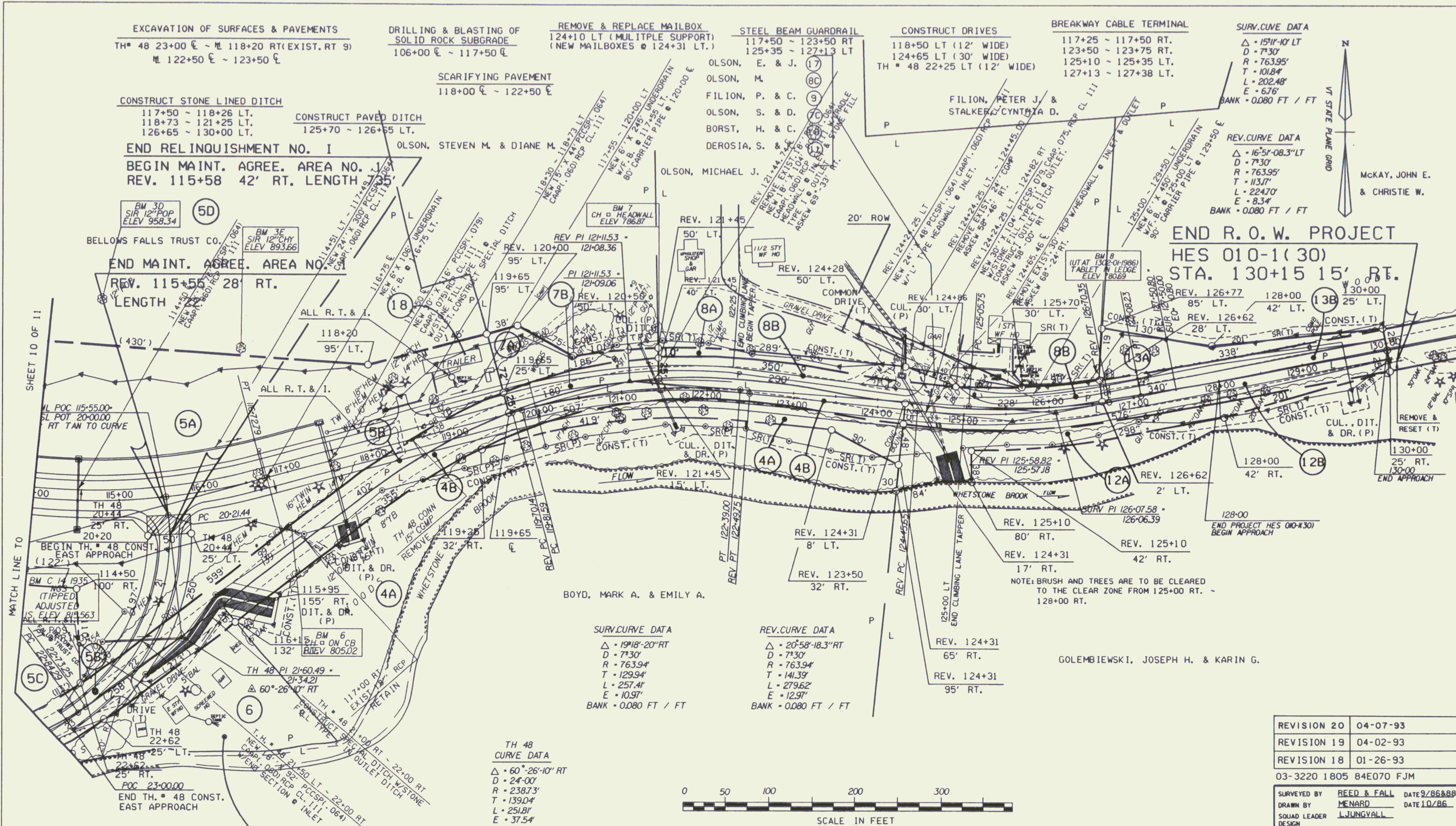

**SURV. CURVE DATA**  
 $\Delta = 19'18'' - 20'' RT$   
 $D = 7'30''$   
 $R = 763.94'$   
 $T = 129.94'$   
 $L = 257.41'$   
 $E = 10.97'$   
 BANK = 0.080 FT / FT

**REV. CURVE DATA**  
 $\Delta = 20'58'' - 18.3'' RT$   
 $D = 7'30''$   
 $R = 763.94'$   
 $T = 141.39'$   
 $L = 279.62'$   
 $E = 12.97'$   
 BANK = 0.080 FT / FT

**TH 48 CURVE DATA**  
 $\Delta = 60' - 26' - 10'' RT$   
 $D = 24' - 00''$   
 $R = 238.73'$   
 $T = 139.04'$   
 $L = 251.81'$   
 $E = 37.54'$

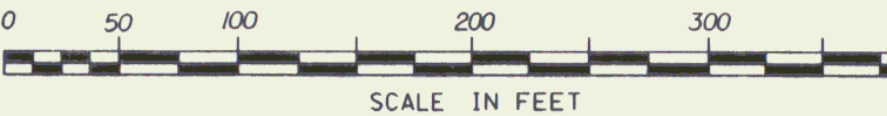

GOLEMBIEWSKI, JOSEPH H. & KARIN G.

REVISION 20	04-07-93
REVISION 19	04-02-93
REVISION 18	01-26-93

03-3220 1805 84E070 FJM  
 SURVEYED BY REED & FALL DATE 9/86 & 88  
 DRAWN BY MENARD DATE 10/86  
 SQUAD LEADER L JUNGVAL  
 DESIGN FILE NO. /usr/zfal/07070.dwg/84e070zz.dgn  
 IPARM FILE 84e070i2r DATE PLOTTED 02-APR-1993

**BRATTLEBORO**  
**HES 010-1(30)**  
 R.O.W. SHEET 11 OF 11

MAR 20 1996

**DATUM**  
 VERTICAL \_\_\_\_\_  
 HORIZONTAL \_\_\_\_\_

AKELEY, MARIAN D.  
 BOYD, EMILY E.  
 STARK, ELIZABETH A.  
 DODGE, ETTA M.