

TOWN HIGHWAY # 48

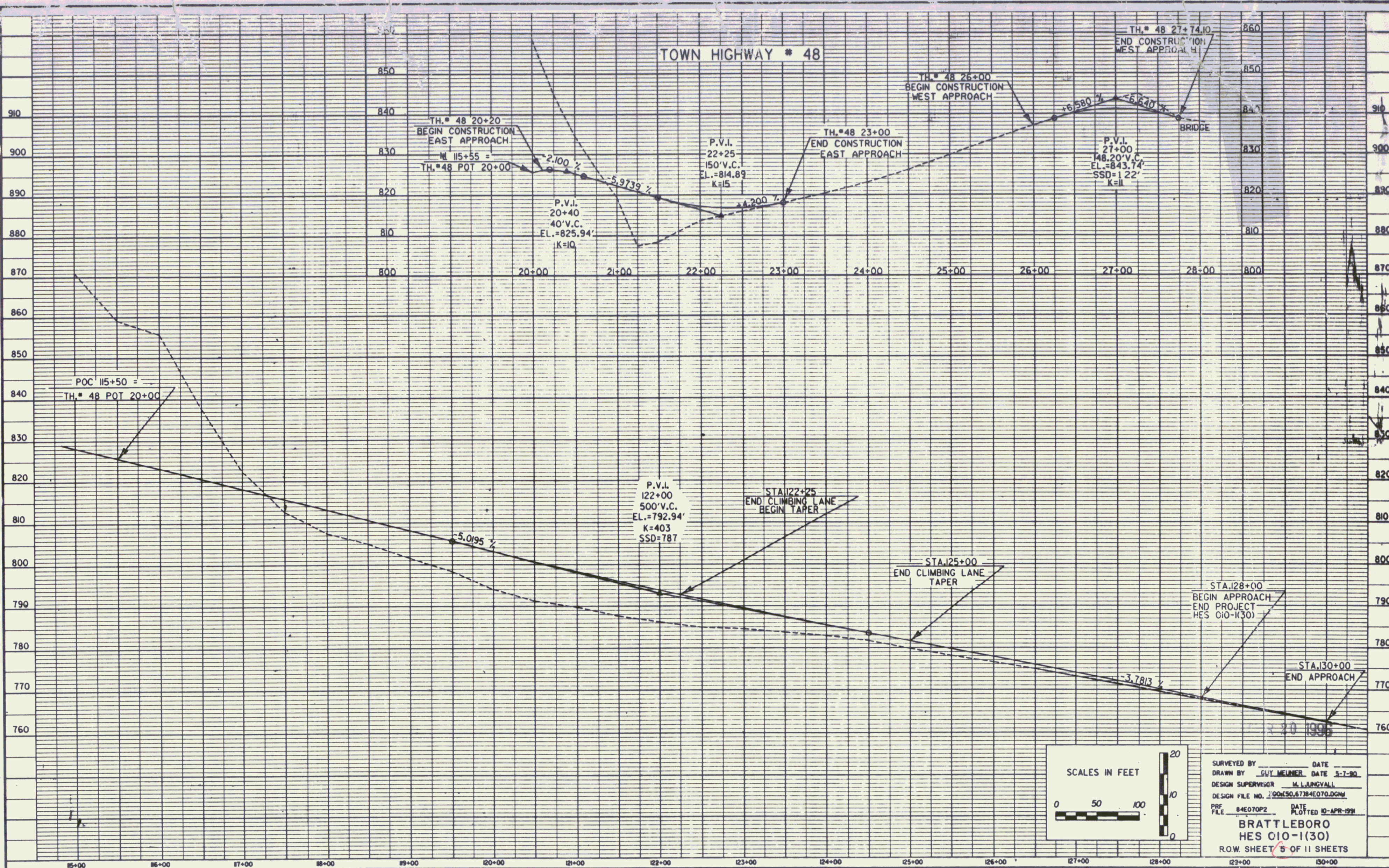

POC 115+50 =  
TH # 48 POT 20+00

TH # 48 20+20  
BEGIN CONSTRUCTION  
EAST APPROACH  
TH # 48 POT 20+00

P.V.I.  
20+40  
40' V.C.  
EL. = 825.94'  
K=10

P.V.I.  
22+25  
150' V.C.  
EL. = 814.89'  
K=15

TH # 48 23+00  
END CONSTRUCTION  
EAST APPROACH

P.V.I.  
27+00  
148.20' V.C.  
EL. = 843.74'  
SSD = 122'  
K=11

TH # 48 27+74.10  
END CONSTRUCTION  
WEST APPROACH

BRIDGE

P.V.I.  
122+00  
500' V.C.  
EL. = 792.94'  
K=403  
SSD=787

STA 122+25  
END CLIMBING LANE  
BEGIN TAPER

STA 125+00  
END CLIMBING LANE  
TAPER

STA 128+00  
BEGIN APPROACH  
END PROJECT  
HES 010-1(30)

STA 130+00  
END APPROACH

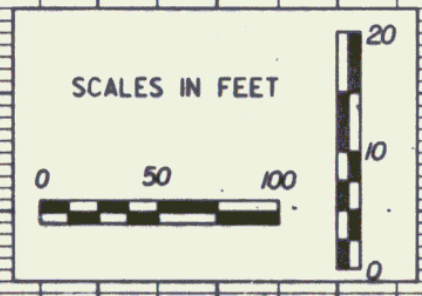

SURVEYED BY \_\_\_\_\_ DATE \_\_\_\_\_  
DRAWN BY GUY MEINER DATE 3-1-90  
DESIGN SUPERVISOR M. L. JUNGVAL  
DESIGN FILE NO. 200130.67184070.DGN  
PRF FILE 84E070P2 DATE PLOTTED 10-APR-1991  
**BRATTLEBORO**  
HES 010-1(30)  
R.O.W. SHEET 5 OF 11 SHEETS