

STATE OF VERMONT
AGENCY OF TRANSPORTATION

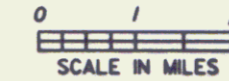

PROPOSED IMPROVEMENT
TOWN OF BRATTLEBORO
COUNTY OF WINDHAM
VT RTE 9 (F.A.P.)

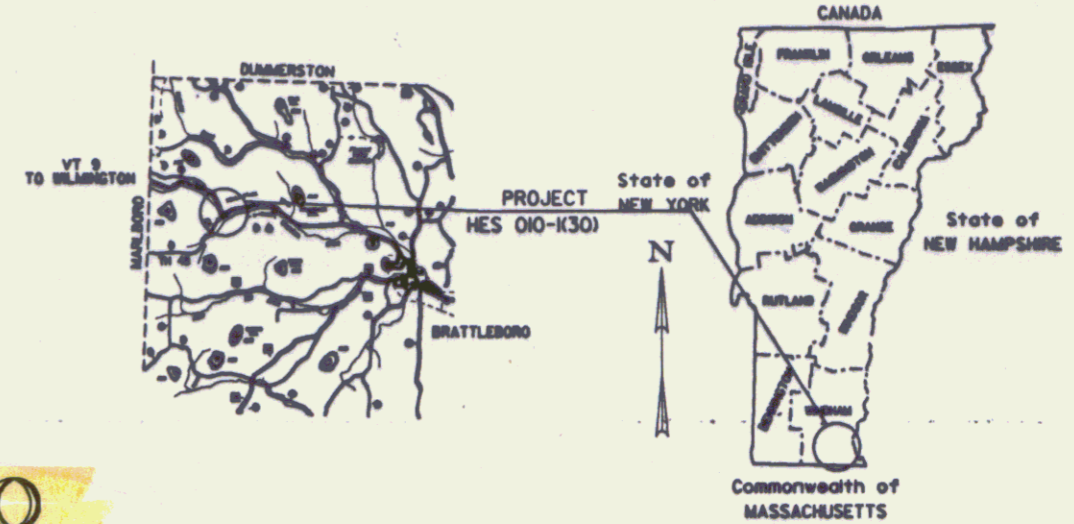

R.O.W. PLANS

BEGINNING AT A POINT ON VT 9 IN BRATTLEBORO
APPROXIMATELY 1.20 MILES EASTERLY OF THE MARLBORO-
BRATTLEBORO TOWN LINE AND EXTENDING EASTERLY FOR
0.454 MILES
LENGTH OF ROADWAY = 2399.20 FEET = 0.454 MILES.
LENGTH OF PROJECT = 2399.20 FEET = 0.454 MILES
LENGTH OF R.O.W. PROJECT = 2830.20 FEET = 0.536 MILES
WORK TO BE DONE UNDER THIS PROJECT INCLUDES
RELOCATION OF A SECTION OF VT RTE 9 WITH
GRADING, DRAINAGE, SUBBASE AND PAVEMENT.

END R.O.W. PROJECT
HES 010-1(30)
STA. 130+15 25' RT.

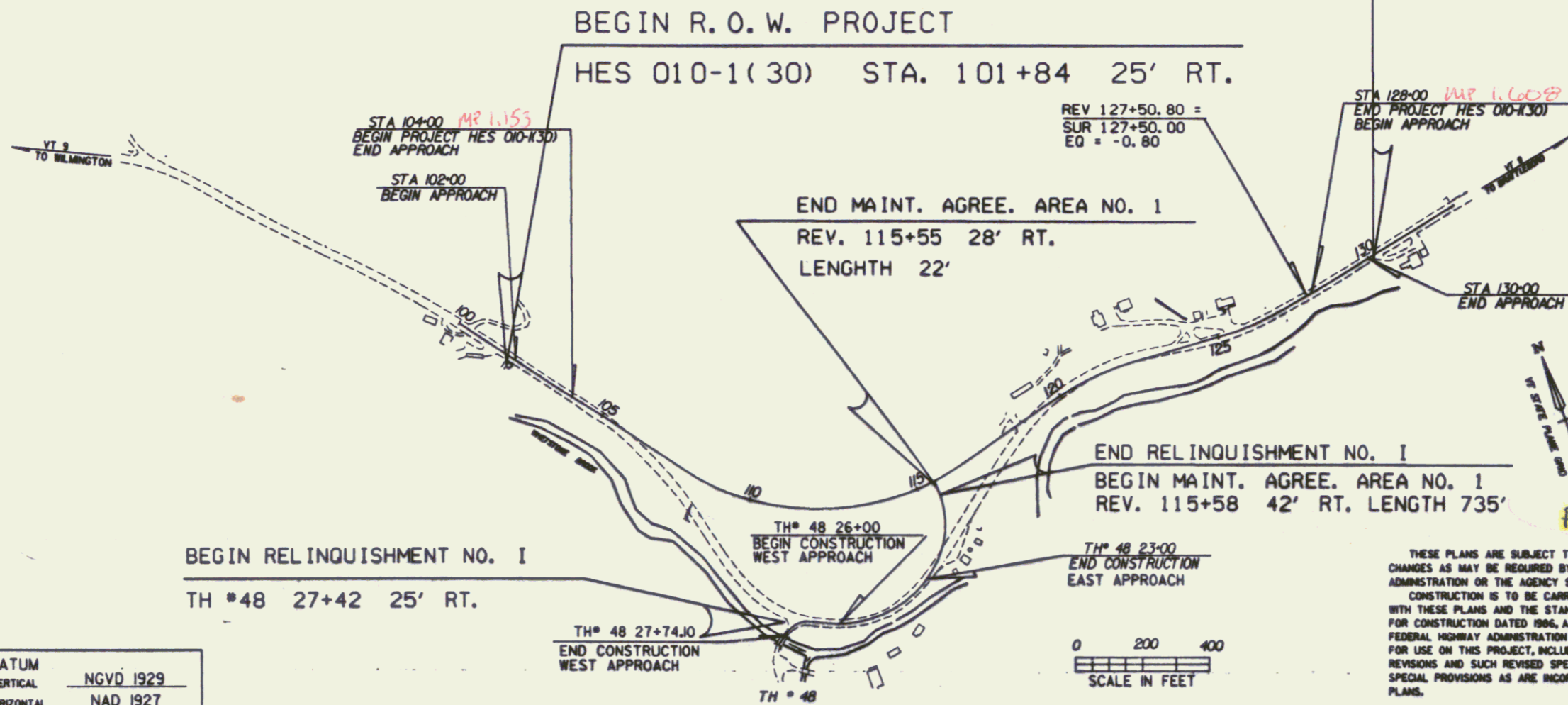

Vt. Rte #9
RIGHT-OF-WAY DIVISION
TOWN FILE
PERPETUAL
Town of BRATTLEBORO
(To Be Returned To R.O.W. Division)

ALL DRIVES AS INDICATED ON PLANS
ARE SUBJECT TO PERMITS PURSUANT
TO TITLE 18, SECTION 11, V.S.A.

Pin # 84E070 MAR 20 1996

CONVENTIONAL SIGNS

COUNTY LINE	---
TOWN LINE	- - - -
LIMITS OF ACCESS	—○—
POINT OF ACCESS	X
FENCE LINE	—X—X—
STONE WALL	—○—○—○—
TRAVELED WAY	— — — —
GUARD RAIL	—▲—▲—▲—
RAILROAD	—+—+—+—
SURVEY LINE	—+—+—+—
CULVERT	—+—+—+—
POWER POLE	—○—
TELEPHONE POLE	—○—
TREES	—●—
CONTROL OF ACCESS	—/—/—/—
PROPERTY LINE	—+—+—+—
R.O.W. TAKING LINE	—+—+—+—
SLOPE RIGHTS	—○—
TOP OF CUT	—▲—
TOE OF SLOPE	—○—

DATUM
VERTICAL NGVD 1929
HORIZONTAL NAD 1927

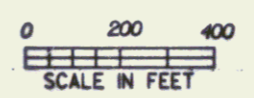

THESE PLANS ARE SUBJECT TO SUCH ENGINEERING
CHANGES AS MAY BE REQUIRED BY THE FEDERAL HIGHWAY
ADMINISTRATION OR THE AGENCY SECRETARY.
CONSTRUCTION IS TO BE CARRIED ON IN ACCORDANCE
WITH THESE PLANS AND THE STANDARD SPECIFICATIONS
FOR CONSTRUCTION DATED 1986, AS APPROVED BY THE
FEDERAL HIGHWAY ADMINISTRATION ON NOVEMBER 2, 1985
FOR USE ON THIS PROJECT, INCLUDING ALL SUBSEQUENT
REVISIONS AND SUCH REVISED SPECIFICATIONS AND
SPECIAL PROVISIONS AS ARE INCORPORATED IN THESE
PLANS.

APPROVED GORDON B. McARTHUR, DATE 9-22-92
Director of Engineering

APPROVED ALLEN N. BLAKE, DATE 9-22-91
Chief of Right-of-Way

PROJECT NO. BRATTLEBORO STP
HES 010-1(30)
R.O.W. SHEET 1 OF 1 SHEETS

17-MAR-1992

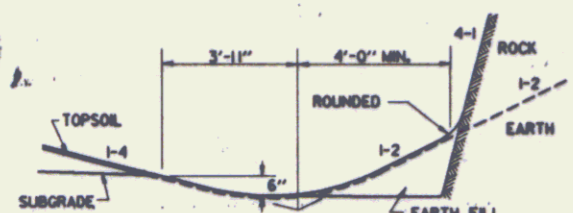

DETAILS OF DITCH AND BACKSLOPE FOR LOW SIDE OF BANK < 0.042 FT/FT WITH CLIMBING LANE

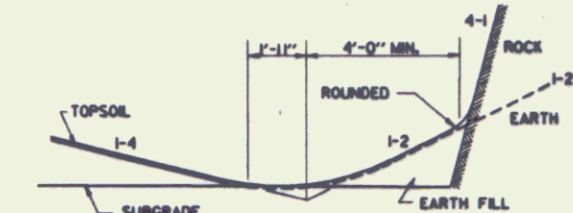

DETAILS OF DITCH AND BACKSLOPE FOR LOW SIDE OF BANK > 0.042 FT/FT WITH CLIMBING LANE

FOR SLOPES IN SOLID ROCK EXCAVATION AND DRILLING AND BLASTING OF SOLID ROCK SUBGRADE, SEE STANDARD SHEET A-62.

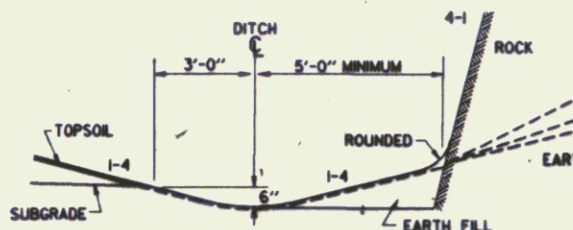

DETAILS OF DITCH AND BACKSLOPE FOR LOW SIDE OF BANK < 0.042 FT/FT WITHOUT CLIMBING LANE

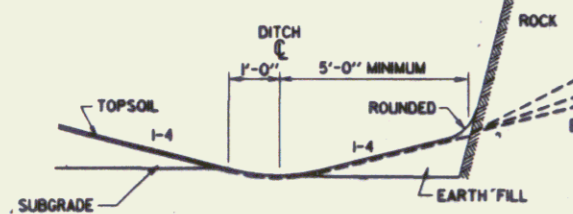

DETAILS OF DITCH AND BACKSLOPE FOR LOW SIDE OF BANK > 0.042 FT/FT WITHOUT CLIMBING LANE

FOR SLOPES IN SOLID ROCK EXCAVATION AND DRILLING AND BLASTING OF SOLID ROCK SUBGRADE, SEE STANDARD SHEET A-60.

DATUM
VERTICAL NGVD 1929
HORIZONTAL NAD 1927

CLIMBING LANE TYPICAL SECTIONS

FOR SEEDING FORMULA & GENERAL NOTES, SEE SHEET 3

3" BITUMINOUS CONCRETE PAVEMENT (TYPE III)
6" BITUMINOUS CONC. PAV'T. (2-3" LIFTS TYPE I BASE COURSE)
24" SUBBASE OF DENSE GRADED CRUSHED STONE
SHOULDERS: 1 1/2" BITUMINOUS CONCRETE PAVEMENT (TYPE III)
12" SAND BORROW (ONLY 3" REQUIRED IN LEDGE CUTS)

MATERIAL ITEM	THICKNESS TOLERANCE
PAVEMENT	± 1/4"
BASE COURSE	± 1/2"
SUBBASE	± 1"
SAND BORROW	± 1"

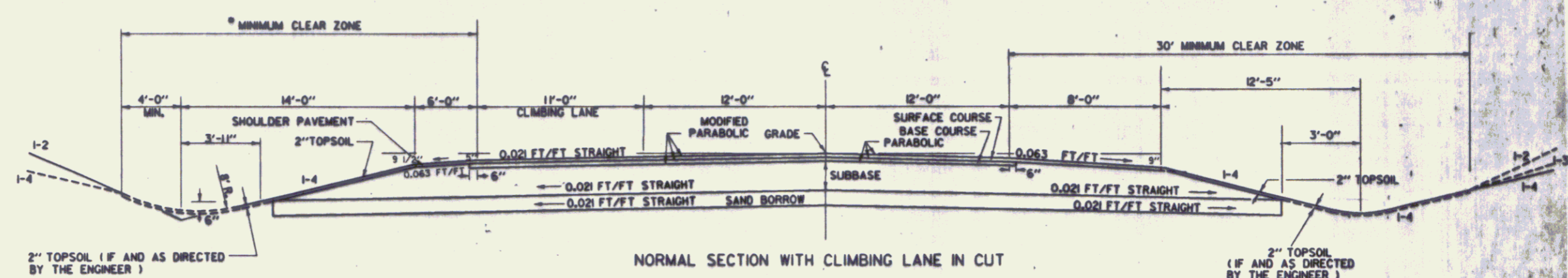

NORMAL SECTION WITH CLIMBING LANE IN CUT

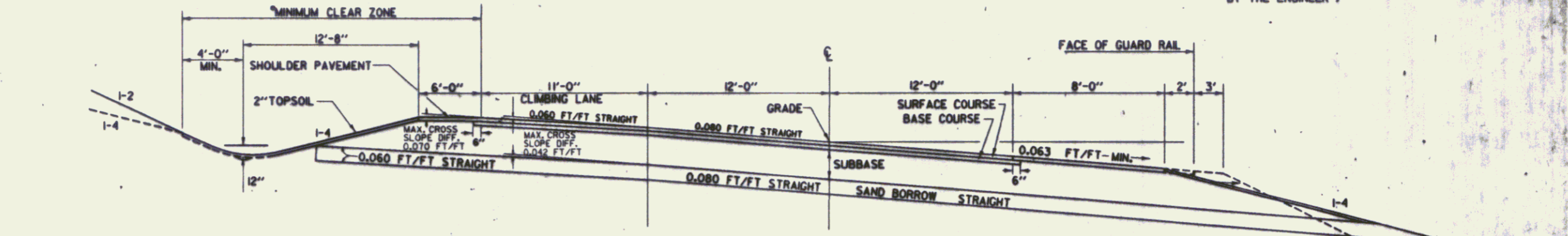

BANKED SECTION WITH CLIMBING LANE (HIGH SIDE) 0.080 FT/FT

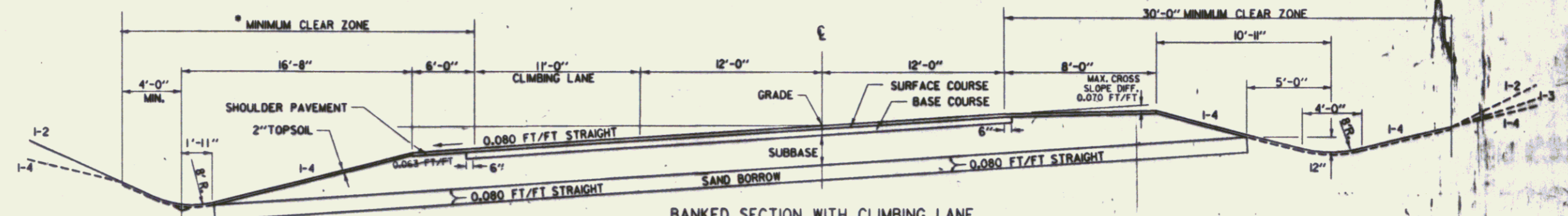

BANKED SECTION WITH CLIMBING LANE (LOW SIDE) 0.080 FT/FT

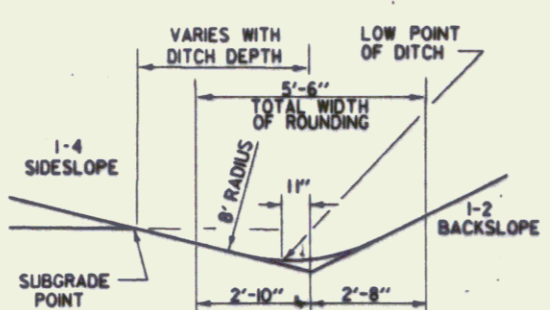

TYPICAL DITCH DETAILS W/ CLIMBING LANE

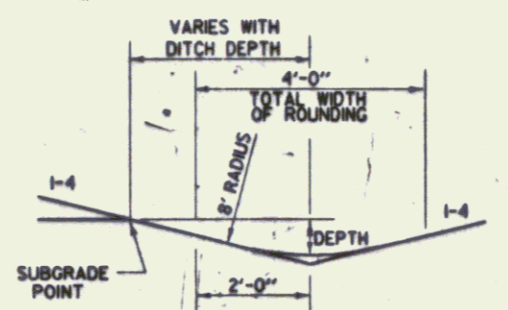

TYPICAL DITCH DETAILS W/O CLIMBING LANE

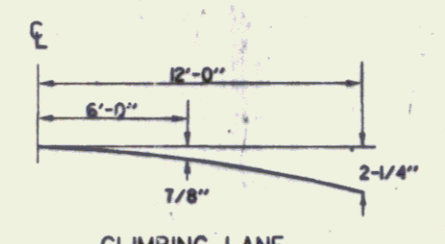

CLIMBING LANE MODIFIED PARABOLIC DETAILS

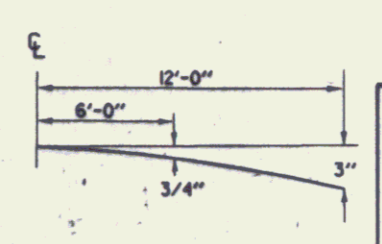

PARABOLIC DETAILS

MAR 20 1990

SURVEYED BY	REDMOND	DATE	9/89
DRAWN BY	LJUNGVALL	DATE	9/89
SOUND LEADER	LJUNGVALL		
DESIGN FILE NO.	ZGOK50.67384EOTO.DGN		
PRF FILE	84E070Y1	DATE PLOTTED	13-SEP-1990
BRATTLEBORO HES 010-1(30)			
R.O.W. SHEET 2 OF 11 SHEETS			

TYPICAL SECTIONS TH 48 CONNECTOR

MATERIAL ITEM	THICKNESS TOLERANCE
PAVEMENT	± 1/4"
SUBBASE	± 1"
GRANULAR BORROW	± 1"
SAND BORROW	± 1"

2 - 1/2" BITUMINOUS CONCRETE PAVEMENT (2 LIFTS 1/4" TYPE III)
18" SUBBASE OF GRAVEL

SHOULDERS : 1 - 1/2" BITUMINOUS CONCRETE PAVE

0" TO 12" GRANULAR BORROW (IN FILLS) } AS INDICATED ON THE PLANS OR
0" TO 12" SAND BORROW (IN CUTS) } AS DIRECTED BY THE ENGINEER

• THE MINIMUM CLEAR ZONE EXTENDS FROM THE EDGE OF THE TRAVEL WAY TO THE BACK OF DITCH.

SEEDING FORMULA RURAL AREAS

% WT.	LBS./A.	NAME	PUR %	GERM %
3.33	2	CROWN VETCH	97	75
50.00	30	CREeping RED FESCUE	98	85
8.33	5	TIMOTHY	99	85
16.67	10	PERENNIAL RYE GRASS (VAR. PENNINE)	95	85
8.34	5	ALFAFA (VAR. SARANAC)	99	85
8.33	5	BIRDFOOT TREFOL (VAR. EMPIRE)	98	85
5.00	3	HIGHLAND BENT GRASS	92	85
100.00	60			

THE SEED MIXTURE SHALL NOT HAVE A WEED CONTENT EXCEEDING 0.40% BY WEIGHT AND SHALL BE FREE OF ALL NOXIOUS WEED SEED.

SEED- TO BE APPLIED PER SEEDING FORMULAS DIRECTED BY THE ENGINEER.
FERTILIZER- FORMULA 10-20-10 TO BE USED WITH SEED, APPLIED AT THE RATE OF 500 LBS./ACRE.

AGRICULTURAL LIMESTONE- TO BE APPLIED AT THE RATE OF 2 TONS/ACRE OR AS DIRECTED BY THE ENGINEER.

HAY MULCH- TO BE PLACED ON EARTH SLOPES AT THE RATE OF 2 TONS/ACRE, OR AS DIRECTED BY THE ENGINEER.

TOPSOIL- TO BE USED WITH SEED AS INDICATED ON THE PLANS, OR AS DIRECTED BY THE ENGINEER.

MARKER POSTS- TO BE PLACED AS DIRECTED BY THE ENGINEER.

SLOPE ROUNDING- ALL CUT SLOPES TO BE ROUNDED IN ACCORDANCE WITH STANDARD SHEET B-5

PAY LIMITS OF SAND BORROW WHEN USED IN CONJUNCTION WITH UNDERDRAIN- SEE STANDARD SHEET D-2.

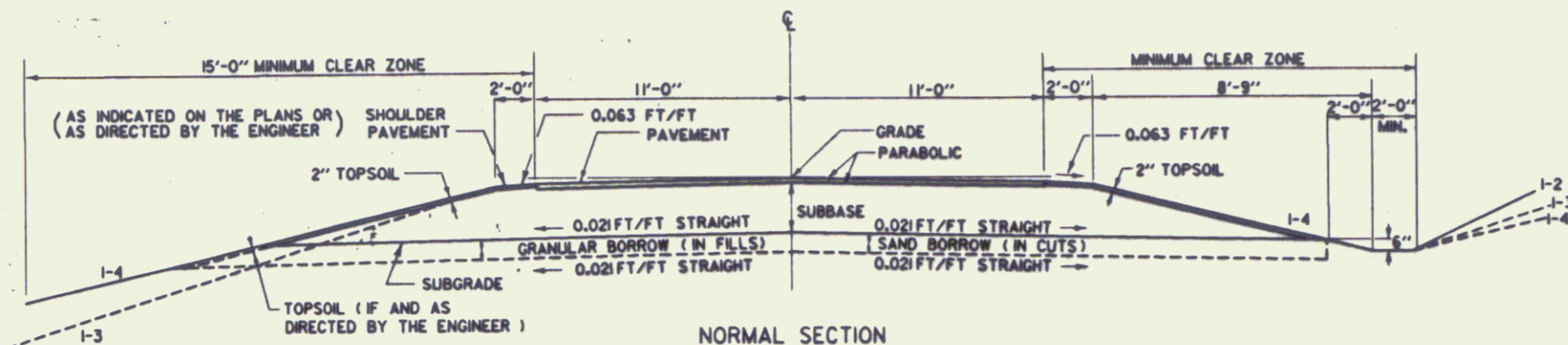

NORMAL SECTION

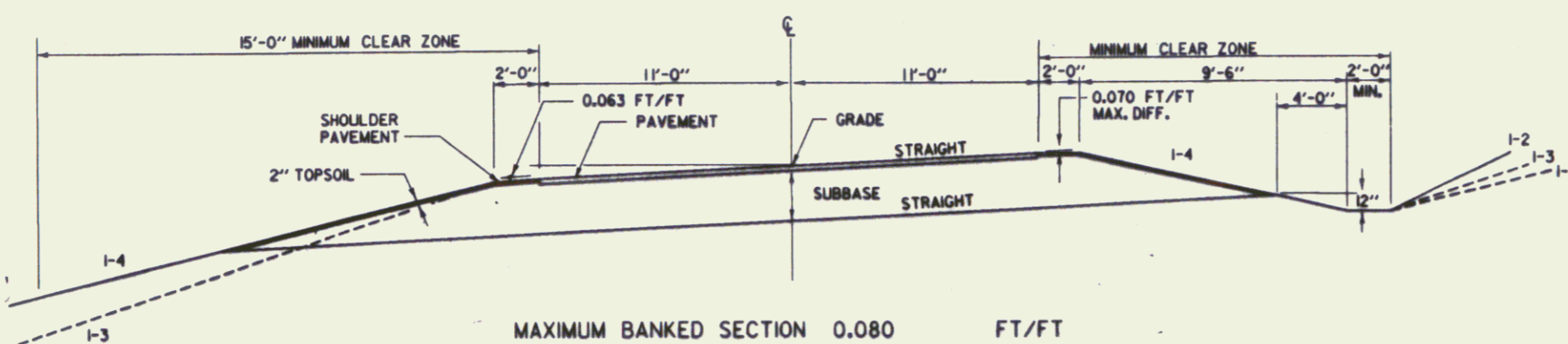

MAXIMUM BANKED SECTION 0.080 FT/FT

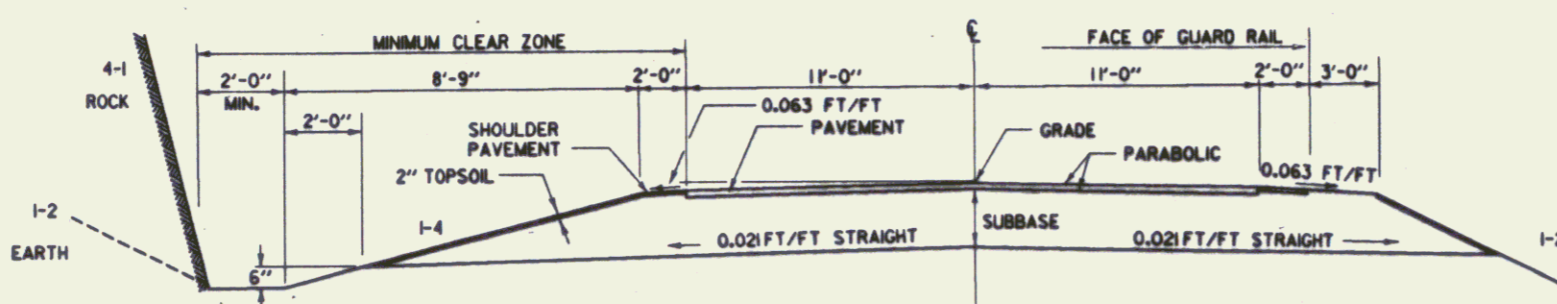

NORMAL SECTION IN ROCK CUT

NORMAL SECTION WITH GUARD RAIL

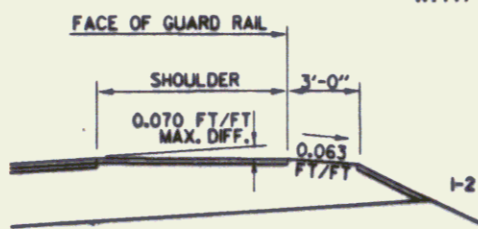

DETAIL OF GUARD RAIL ON HIGH SIDE OF BANKED SECTION

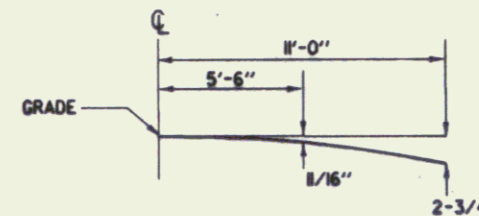

PARABOLIC DETAIL

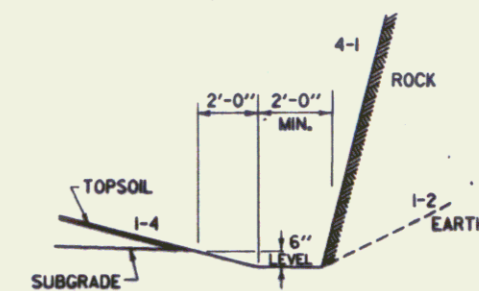

DETAILS OF DITCH AND BACKSLOPE FOR LOW SIDE OF BANK < 0.042 FT/FT

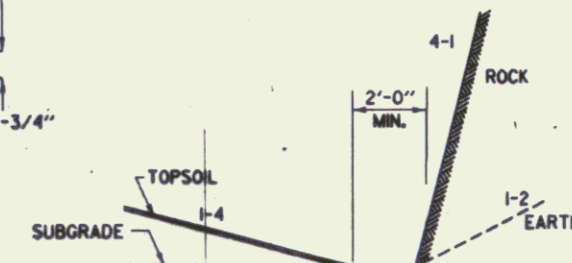

DETAILS OF DITCH AND BACKSLOPE FOR LOW SIDE OF BANK ≥ 0.042 FT/FT

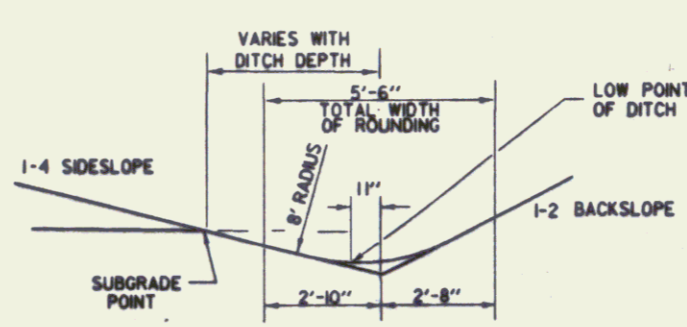

TYPICAL DITCH DETAILS

FOR SLOPES IN SOLID ROCK EXCAVATION AND DRILLING AND BLASTING OF SOLID ROCK SUBGRADE, SEE STANDARD SHEET A-6L.

DATUM
VERTICAL NGVD 1929
HORIZONTAL NAD 1927

MAR 20 1996
SURVEYED BY
DRAWN BY REDMOND
SQUAD LEADER LUNGVALL
DESIGN FILE NO. ZG0450.67284E070.DGN
FILE 84E070TYT DATE PLOTTED 15-JUN-1990
BRATTLEBORO
HES 010-1(30)
R.O.W. SHEET 3 OF 11 SHEETS

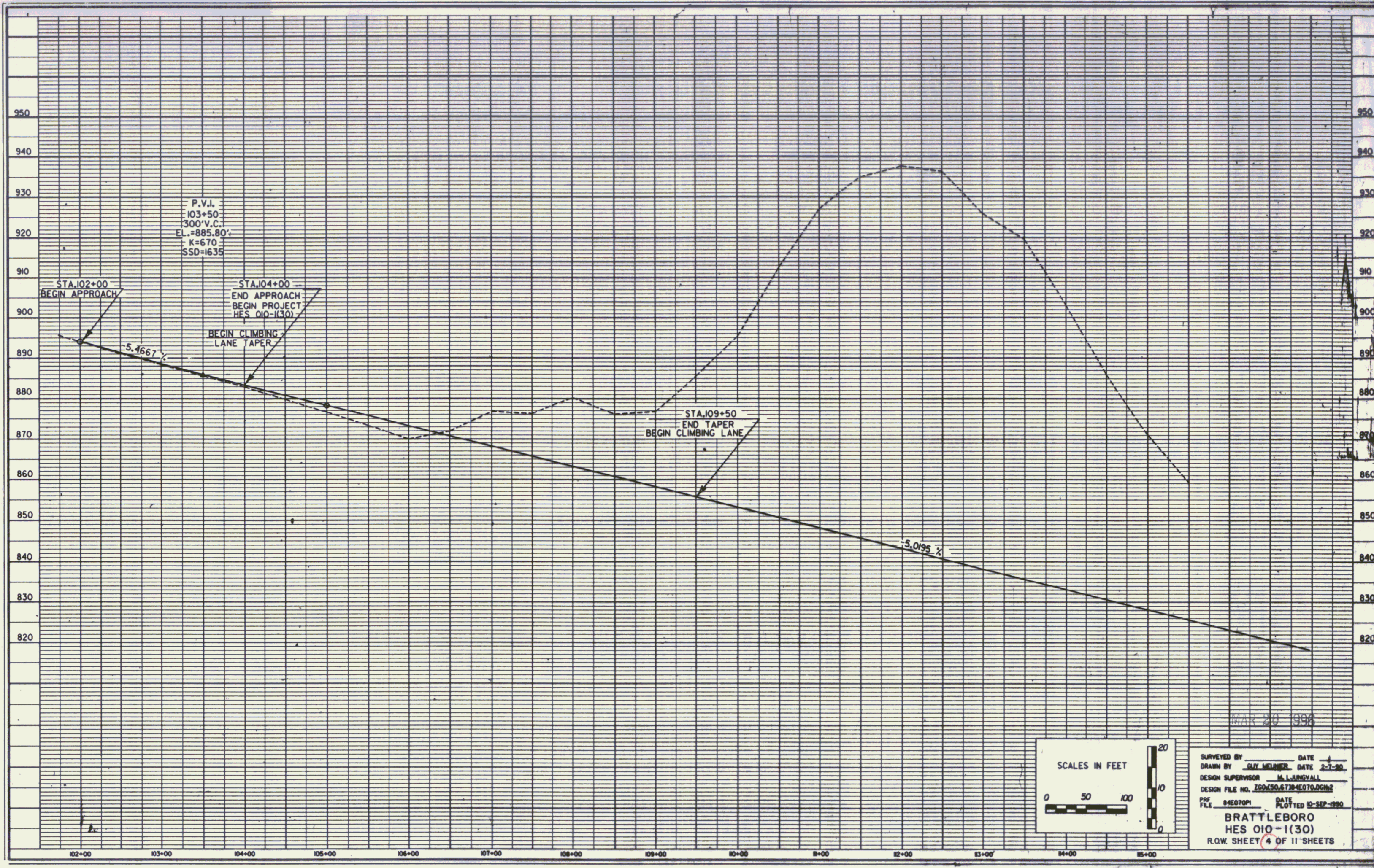

P.V.I.
103+50
300' V.C.
EL.=885.80'
K=670
SSD=1635

STA.102+00
BEGIN APPROACH

STA.104+00
END APPROACH
BEGIN PROJECT
HES 010-1(30)
BEGIN CLIMBING
LANE TAPER

STA.109+50
END TAPER
BEGIN CLIMBING LANE

-5.4667%

-5.095%

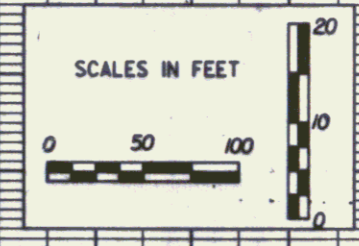

MAR 20 1996

SURVEYED BY _____ DATE _____
 DRAWN BY GUY MEUNIER DATE 2-7-90
 DESIGN SUPERVISOR M. L. JUNGVALL
 DESIGN FILE NO. 200/030.6720/4E010.DWG
 PPR FILE 4/E010P1 DATE PLOTTED 10-SEP-1990

BRATTLEBORO
HES 010-1(30)
 R.O.W. SHEET 4 OF 11 SHEETS

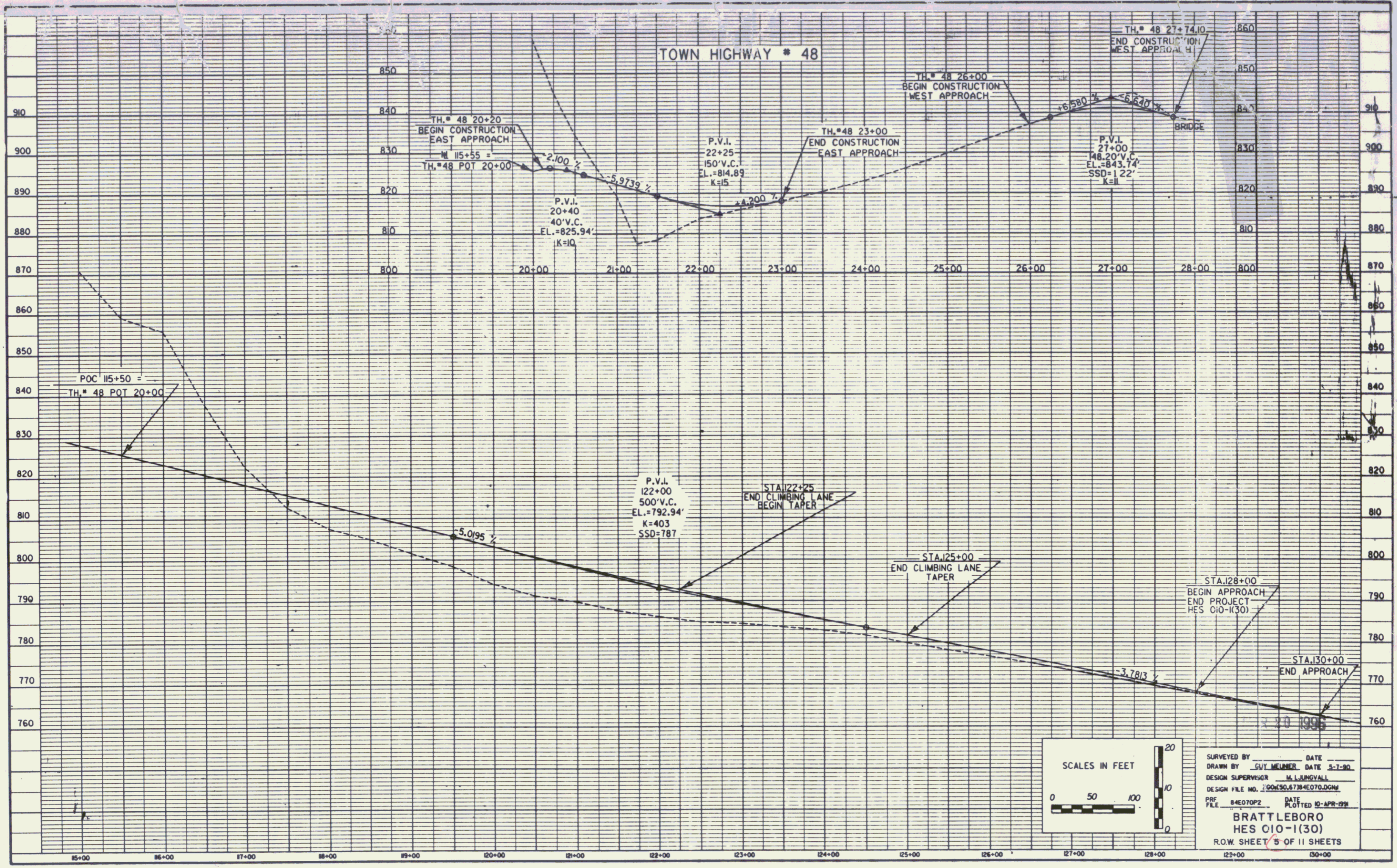

**STATE OF VERMONT
AGENCY OF TRANSPORTATION
RIGHT OF WAY PLANS
DETAIL SHEET**

TABLE OF PROJECT PROPERTY ACQUISITION

PARCEL NO.	GRANTOR	SHEET NO.	BEGINNING STATION	ENDING STATION	TAKING	REM.	RIGHTS	TITLE TAKEN	DATE	TOWN OR CITY RECORDED	BK.	PG.	REMARKS	REVISION NO.	SHEET	DESCRIPTION OF REVISION	DATE	MADE BY	APPROVED BY
1	STARK, DONALD A.	10	101+84 RT. 101+84 RT.	102+02 RT. 102+00 RT.			CONST. (T) 0.01A± SLOPE (T) 0.01A±	AGREE.		BRATTLEBORO			80 S.F.± 150 S.F.±	1	7,10	PARCEL NO. 5 DODGE. ADD DODGE, ETNA M. - LESSEE TO TITLE. PER C.O. 8125.	10-07-91	M. J. R.	L. W. B.
2	STRONG, ANN S.	10	102+00 CL. 102+00 RT. 102+00 RT. 103+50 RT. 105+50 RT. 108+10 RT. 108+25 RT. TH 48 27+40 RT. TH 48 27+42 RT.	108+88 RT. 103+50 RT. 107+10 RT. 107+00 RT. 108+90 RT. 108+75 RT. TH 48 27+65 RT. TH 48 27+80 RT.	0.41A±		ALL R. T. & I. SLOPE (T) 0.13A± CONST. (T) 0.11A± SLOPE (P) 0.10A± CUL., DIT. & DR. (P) CONST. (T) 0.02A± DITCH & DRAINAGE (P) 0.02A± SLOPE (T) 0.01A± CONST. (T) 0.01A±	WD	02-17-93	BRATTLEBORO	233	501	VT. RTE. 9 1000 S.F.± 900 S.F.± 260 S.F.± 400 S.F.±	2	6,10	PARCEL NO. 2 STRONG. ADD ANN S. STRONG TO TITLE. PER C.O. 8124.	10-07-91	M. J. R.	L. W. B.
2A		10	103+40 RT.±				CUL., DIT. & DR. (P)	WDOE	07-21-95	BRATTLEBORO	249	478		3	6,10	PARCEL NO. 3 HAMILTON. CHANGE P/L ALIGNMENT. INCREASE TAKE, REMAINDER AND CHANGE ENDING STATION. PER C.O. 8168.	01-03-91	M. J. R.	F. J. M.
3A	HAMILTON, ELWIN R. & CINDY C.	10	102+00 LT. 109+00 RT. 105+50 LT. 109+60 RT. 113+22 LT.	113+69 RT. 113+69 RT. 113+22 LT. 113+38 RT. 113+10 LT.	4.71A±	2.58A±	SLOPE (P) 0.62A± CONST. (T) 0.12A± ALL R. T. & I.	WD		BRATTLEBORO			STONE WALL	4	7,10	PARCEL NO. 5 DODGE. CHANGE TAKE TO 2.94A± REMAINDER TO 113+69 RT. ADD ALL R.T. & I. FOR STORAGE SHED AT 119+55 LT. ON PARCEL 5B CHANGE STA. 24+80 CL TO 23+86 CL. 0.40A±. ADD WALL, WALK & SHED TOPO. PER C.O. 8167.	01-03-92	M. J. R.	F. J. M.
3B		10	102+00 CL.	109+00 RT.	0.41A±		ALL R. T. & I.							5	7,11	PARCEL NO. 7 OLSON. CHANGE STA. TO REV. 124+28 LT. FOR ALL R.T. & I. IN ROW. PER C.O. 8164.	01-03-92	M. J. R.	F. J. M.
4A	BOYD, MARK A. & BOYD, EMILY A.	11	119+25 RT. 116+15 RT. 116+20 RT. 117+35 RT. 118+25 RT. 118+55 RT. REV. 121+60 RT. REV. 122+50 RT.	REV. 124+31 RT. 117+75 RT. 116+60 RT. 117+65 RT. REV. 124+31 RT. REV. 122+50 RT. REV. 124+12 RT.	0.23A±		CONST. (T) 0.07A± DITCH & DRAINAGE (P) 0.02A± DITCH & DRAINAGE (P) 0.01A± CONST. (T) 0.13A± SLOPE (P) 0.11A± CUL., DIT. & DR. (P) SLOPE (T) 0.06A±	WD		BRATTLEBORO			2934 S.F.± 765 S.F.± 225 S.F.± 2494 S.F.±	6	8,11	PARCEL NO. 8 OLSON. CHANGE STA. TO REVISED 124+28 LT. FOR ALL R.T. & I. IN ROW. CHANGE TAKE LINE NOT TO INCLUDE TOTAL COMMON ROW. REDUCE TAKE TO 0.12A±. PER C.O. 8163.	01-03-92	M. J. R.	F. J. M.
4B	PARCEL 4 CONTINUED ON FOLLOWING SHEET	11	115+95 RT.	REV. 124+31 RT.	0.51A±		ALL R. T. & I.							7	8,11	PARCEL NO. 9 FILION & STALKER. CHANGE STA. TO REV. 124+28 LT. FOR ALL R.T. & I. IN ROW. PER C.O. 8162.	01-03-92	M. J. R.	F. J. M.
														8	8,11	PARCEL NO. 10 BORST. CHANGE STA. TO REV. 124+28 LT. FOR ALL R.T. & I. IN ROW. PER C.O. 8165.	01-03-92	M. J. R.	F. J. M.
														9	8,11	PARCEL NO. 11 DEROSIA. CHANGE STA. TO REV. 124+28 LT. FOR ALL R.T. & I. IN ROW. PER C.O. 8166.	01-03-92	M. J. R.	F. J. M.
														10	7,11	PARCEL NO. 5 DODGE. CHANGE TAKE FROM 2.99 A± TO 2.94A±; CHANGE REMAINDER FROM 0.57A± TO 0.33A±; CHANGE BEGINNING STA. OF REMAINDER FROM 113+38 RT. TO 113+69 RT.; ADD ALL R. T. & I. AT STA. 119+55 LT. FOR STORAGE SHEDS.; ON PARCEL 5B, CHANGE STA. 24+80 CL. TO 23+86 CL. AND AREA FROM 0.45 A± TO 0.40A±; ADD NEW TOPO TO LAYOUT. PER C.O. 8167.	01-03-92	M. J. R.	F. J. M.
														11	7	PARCEL NO. 5 DODGE. REMOVE 'PERSONAL PROPERTY' ON MOBILE HOME. PER C.O. 8177.	01-03-92	M. J. R.	F. J. M.

03-3220 1805 84E070

ACCT. prap
/prap/84e070/rs070d.dgn
DATE PLOTTED 13-APR-1995
84e070d.l

DR. (P)- DRAINAGE RIGHT
DIT. (P)- DITCHING RIGHT
CH. (P)- CHANNEL RT.
DRIVE (T)- DRIVE RIGHT
CUL. (P)- CULVERT RIGHT
W- WATER SOURCES

PRESENT R.O.W.
TAKING WITHOUT ACCESS
TAKING WITHOUT ACCESS ALONG PROPERTY LINE
TAKING WITH ACCESS
PERMANENT EASEMENT
TEMPORARY EASEMENT

LEGEND

.....CZ (P)..... CLEAR ZONE
---CONST. (T)--- CONSTRUCTION EASEMENT
---SR--- SLOPE RIGHTS
---P--- PROPERTY LINE
---L--- TOP OF CUT
---O--- TOE OF SLOPE

REVISED 04-13-95

APPROVED: LAWRENCE BLISS L.S. DATE: 8-26-91
AGENT D. PLANS & TITLES

R. O. W. PLANS

BRATTLEBORO
HES 010-1 (30)
SHEET 6 OF 11

MAR 20 1996

6

**STATE OF VERMONT
AGENCY OF TRANSPORTATION
RIGHT OF WAY PLANS
DETAIL SHEET**

PARCEL NO.	GRANTOR	SHEET NO.	BEGINNING STATION	ENDING STATION	TAKING	REM.	RIGHTS	TITLE TAKEN	DATE	TOWN OR CITY RECORDED	BK.	PG.	REMARKS	REVISION NO.	SHEET	DESCRIPTION OF REVISION	DATE	MADE BY	APPROVED BY
4C	PARCEL 4 CONTINUED FROM PREVIOUS SHEET BOYD, MARK A. & BOYD, EMILY A.	10	TH 48 27+14 LT. TH 48 26+55 LT. TH 48 26+30 LT.	TH 48 27+20 LT. TH 48 27+60 LT. TH 48 27+80 LT.			INSTALL & MAINTAIN (P) SLOPE (T) 0.01A± CONST. (T) 0.02A±						GUARDRAIL 150 S.F. ± 900 S.F. ±	12	9,10	RELINQUISHMENT NO. 1. CHANGE BEG. STA. TO TH 48 27+42 RT. AND REDUCE LENGTH TO 735'. PER C.O. 8194.	01-30-92	M. J. R.	F. J. M.
5A	BELLOWS FALLS TRUST COMPANY	10,11	113+22 LT. 113+22 LT. 117+90 LT. 119+00 LT. 118+50 LT. 119+55 LT. ±	119+65 RT. 113+10 LT.	2.94A±	NONE	ALL R. T. & I. ALL R. T. & I. ALL R. T. & I.	WD	07-07-93	BRATTLEBORO	236	572	STONE WALL ARTESIAN WELL SEPTIC TANK & APPURTENANCE DRIVE 12' GRAVEL M.P. 0147 STORAGE SHEDS	13	9,11	PARCEL NO. 17 OLSON. ADD NEW PARCEL NO. 17 OLSON, EDWARD W. & JOYCE M. PER C.O. 8198.	02-18-92	M. J. R.	F. J. M.
5B		10,11	TH 48 23+86 CL.	119+65 LT.	0.40A±		ALL R. T. & I.						VT RTE. 9	14	7,10	PARCEL NO. 18 DODGE. ADD NEW PARCEL (#18) FOR ETTA M. DODGE, ALL R.T. & I. IN HOUSE TRAILER, 118+85 LT. ~ 119+50 LT. PER C.O. 8205.	03-06-92	M. J. R.	L. W. B.
5C		10,11	113+69 RT.	114+50 RT.	0.33A±									15	7,10	PARCEL NO. 5 DODGE. CHANGE TITLE TO BELLOWS FALLS TRUST COMPANY. REMOVE ALL R. T. & I. IN HOUSE TRAILER. PER C.O. 8206.	03-06-92	M. J. R.	L. W. B.
5D		10,11	113+22 LT.	119+65 LT.	6.73A±									16	6,10	PARCEL NO. 2 STRONG. REMOVE RAYMOND B. STRONG, JR. FROM DETAIL SHEET AND LAYOUT. PER C.O. 8287.	11-09-92	C. C. P.	L. W. B.
6	AKELEY, MARIAN D. BOYD, EMILY E. STARK, ELIZABETH A. DODGE, ETTA M.	10,11	TH 48 23+38 CL. TH 48 22+25 LT. TH 48 22+25 RT.	116+15 RT.	0.15A±		ALL R. T. & I. DRIVE ALL R. T. & I.	WD	10-08-92	BRATTLEBORO	230	668	VT RTE. 9 12' GRAVEL SPRING & APPURTENANCE	17	7,11	PARCEL NO. 5 BELLOWS FALLS TRUST CO. REMOVE ALL R. T. & I. IN RIGHTS COLUMN OF DETAIL SHEET AND ON LAYOUT FOR STORAGE SHEDS AT STA. 119+55 LT. ± PER C.O. 8289.	11-30-92	C. C. P.	L. W. B.
7A	OLSON, STEVEN M. & DIANE M.	11	119+65 LT. REV. 120+00 LT. REV. 120+25 LT. REV. 121+25 LT.	REV. 121+45 LT. REV. 121+45 LT. REV. 121+45 LT.	0.14A±		CONST. (T) 0.03A± DITCH (P) 0.01A± CULVERT (P)	WD		BRATTLEBORO			1237 S.F. ± 423 S.F. ±	18	8,11	PARCEL NO. 8 OLSON. REMOVE CAROL A. OLSON FROM TITLE. ADD PERSONAL PROPERTY, SIGN, AT STA. 124+78 LT. PER C.O. 8312. MYLARS TO DESIGN 03-15-93	01-26-93	M. J. R.	L. W. B.
7B		11	119+65 CL.	REV. 121+45 LT.	0.10A±		ALL R. T. & I.						VT RTE. 9	19	7,10	PARCEL NO. 5 BELLOWS FALLS TRUST COMPANY. ADD PARCELS 5C AND 5D TO DETAIL AND LAYOUT SHEETS. ALSO DELETE REMAINDER LISTED IN PARCEL 5A. PER C.O. 8348.	04-02-93	C. C. P.	L. W. B.
7C		11	REV. 124+28 LT. REV. 124+65 LT.	REV. 125+70 LT.			ALL R. T. & I. DRIVE (T)						20' R.O.W. TO RTE. 9 30' GRAVEL M.P. 0159	20	7,10	PARCEL NO. 5A BELLOWS FALLS TRUST COMPANY. REMOVE SLOPE (P), 0.16A±, STA. 13+10 LT. ~ 117+20 LT. FROM LAYOUT & DETAIL SHEET. PER C.O. 8353.	04-07-93	C. C. P.	L. W. B.
														21	6,10	PARCEL NO. 2 STRONG. ADD NEW SUB-PARCEL 2A WITH 'CUL., DIT. & DR (P)' AT STA. 103+40 RT. ± PER C.O. 8679.	04-13-95	C. C. P.	L. W. B.

MAR 20 1996

<p>03-3220 1805 84E070</p> <p>ACCT. pr op /pr op/84e070/rw070d.dgn DATE PLOTTED 13-APR-1995 84e070d2.1</p>	<p>DR. (P)- DRAINAGE RIGHT DIT. (P)- DITCHING RIGHT CH. (P)- CHANNEL RT. DRIVE (T)- DRIVE RIGHT CUL. (P)- CULVERT RIGHT W- WATER SOURCES</p>	<p>PRESENT R.O.W. TAKING WITHOUT ACCESS TAKING WITHOUT ACCESS ALONG PROPERTY LINE TAKING WITH ACCESS PERMANENT EASEMENT TEMPORARY EASEMENT</p>	<p>LEGEND . . . CZ (P) CLEAR ZONE CONST. (T) CONSTRUCTION EASEMENT SR SR SLOPE RIGHTS P PROPERTY LINE L TOP OF CUT △ TOE OF SLOPE</p>	<p>REVISED 04-13-95</p> <p>APPROVED: LAWRENCE BLISS L.S. DATE: 8-26-91 AGENT D, PLANS & TITLES</p>	<p>R. O. W. PLANS</p> <p>BRATTLEBORO HES 010-1 (30) SHEET 7 OF 11</p>
--	--	--	---	--	---

**STATE OF VERMONT
AGENCY OF TRANSPORTATION
RIGHT OF WAY PLANS
DETAIL SHEET**

TABLE OF PROJECT PROPERTY ACQUISITION

PARCEL NO.	GRANTOR	SHEET NO.	BEGINNING STATION	ENDING STATION	TAKING	REM.	RIGHTS	TITLE TAKEN	DATE	TOWN OR CITY RECORDED	BK.	PG.	REMARKS	REVISION NO.	SHEET	DESCRIPTION OF REVISION	DATE	MADE BY	APPROVED BY
8A	OLSON, MICHAEL J.	11	REV. 121+45 LT. REV. 121+45 LT. REV. 121+45 LT. REV. 124+24 LT. REV. 126+50 LT. REV. 126+50 LT. REV. 124+00 LT. REV. 124+65 LT. REV. 124+78 LT. REV. 125+20 LT.	REV. 125+70 LT. REV. 122+25 LT. REV. 124+00 LT. REV. 126+62 LT. REV. 126+62 LT. REV. 126+62 LT.	0.12A±		SLOPE (T) 0.01A± CONST. (T) 0.04A± CULVERT (P) ALL R. T. & I. SLOPE (T) 0.01A± DRIVE (T) SLOPE (T) 0.01A±	MO		BRATTLEBORO			516 S.F. ± 1885 S.F. ± STONE WALL 102 S.F. ± SIGN - PERSONAL 30' GRAVEL M.P. 0159 SIGN PERSONAL 330 S.F. ±						
8B		11	REV. 121+45 LT.	REV. 126+62 LT.	0.30A±		ALL R. T. & I.						VT RTE. 9						
8C		11	REV. 124+28 LT.	REV. 125+70 LT.			ALL R. T. & I.						20' R.O.W. TO RTE. 9						
9	FILION, PETER J. & STALKER, CYNTHIA D.	11	REV. 124+28 LT. REV. 124+65 LT.	REV. 125+70 LT.			ALL R. T. & I. DRIVE (T)	OCD		BRATTLEBORO			20' R.O.W. TO RTE. 9 30' GRAVEL M.P. 0159						
10	BORST, HARRY W. JR. & CAROLYN E.	11	REV. 124+28 LT. REV. 124+65 LT.	REV. 125+70 LT.			ALL R. T. & I. DRIVE (T)	OCD		BRATTLEBORO			20' R.O.W. TO RTE. 9 30' GRAVEL M.P. 0159						
11	DEROSIA, STEPHEN V. & KRIS A.	11	REV. 124+28 LT. REV. 124+65 LT.	REV. 125+70 LT.			ALL R. T. & I. DRIVE (T)	OCD		BRATTLEBORO			20' R.O.W. TO RTE. 9 30' GRAVEL M.P. 0159						
12A	GOLEMBIJEWSKI, JOSEPH H. & KARIN G.	11	REV. 124+31 RT. REV. 127+25 RT. 128+00 RT. 129+50 RT. 129+80 RT.	130+00 RT. 130+00 RT. 129+70 RT. 130+15 RT.	0.31A±		CONST. (T) 0.06A± SLOPE (T) 0.02A± CUL., DIT. & DR. (P) REMOVE & RESET (T)	MO	02-12-93	BRATTLEBORO	233	433	2701 S.F. ± 981 S.F. ± FENCE						
12B		11	REV. 124+31 RT.	130+00 RT.	0.32A±		ALL R. T. & I.						VT RTE. 9						

MAR 20 1996

03-3220 1805 84E070
ACCT.prp
J:\usr\z\td\070070.d\84e070d.dgn
DATE PLOTTED 27-JAN-1993
84e070d3.1

DR. (P)- DRAINAGE RIGHT
DIT. (P)- DITCHING RIGHT
CH. (P)- CHANNEL RT.
DRIVE (T)- DRIVE RIGHT
CUL. (P)- CULVERT RIGHT
[X]- WATER SOURCES

PRESENT R.O.W.
TAKING WITHOUT ACCESS
TAKING WITHOUT ACCESS ALONG PROPERTY LINE
TAKING WITH ACCESS
PERMANENT EASEMENT
TEMPORARY EASEMENT

LEGEND
... CZ (P) ... CLEAR ZONE
--- CONST. (T) --- CONSTRUCTION EASEMENT
SR SR SLOPE RIGHTS
P PROPERTY LINE
L TOP OF CUT
O O TOE OF SLOPE

REVISED 01-26-93
APPROVED: LAWRENCE BLISS L.S. DATE: 8-26-91
AGENT D, PLANS & TITLES

R. O. W. PLANS
BRATTLEBORO
HES 010-1 (30)
SHEET 8 OF 11

8

**STATE OF VERMONT
AGENCY OF TRANSPORTATION
RIGHT OF WAY PLANS
DETAIL SHEET**

TABLE OF PROJECT PROPERTY ACQUISITION

PARCEL NO.	GRANTOR	SHEET NO.	BEGINNING STATION	ENDING STATION	TAKING	REM.	RIGHTS	TITLE TAKEN	DATE	TOWN OR CITY RECORDED	BK.	PG.	REMARKS	REVISION NO.	SHEET	DESCRIPTION OF REVISION	DATE	MADE BY	APPROVED BY	
13A	MCKAY, JOHN E. & CHRISTIE W.	11	REV. 126+62 LT. REV. 126+77 LT. REV. 128+70 LT.	130+00 LT. 130+00 LT. 130+00 LT.	0.17A*		CONST. SLOPE (T) 0.06A* (T) 0.01A*	MO	01-25-93	BRATTLEBORO	233	104	281.3 S.F. ± 427 S.F. ±							
13B		11	REV. 126+62 LT.	130+00 LT.	0.19A*		ALL R. T. & I.						VT RTE. 9							
14	TOWN OF BRATTLEBORO	10	TH 48 26+73 CL.				APPROACH (T)						TH 48							
15	NEW ENGLAND TELEPHONE COMPANY												UTILITY							
16	CENTRAL VERMONT PUBLIC SERVICE CORP.												UTILITY							
17	OLSON, EDWARD W. & JOYCE M.	11	REV. 124+28 LT. REV. 124+65 LT.	REV. 125+70 LT.			ALL R. T. & I. DRIVE (T)	QCD	01-28-93	BRATTLEBORO	233	211	20' ROW TO RTE. 9 30' GRAVEL MP 0159							
18	DODGE, ETTA M.	11	118+85 LT.	119+50 LT.			ALL R. T. & I.						HOUSE TRAILER							
	RELINQUISHMENT NO. 1	10, 11	TH 48 27+42 RT.	REV. 115+58 RT.									LENGTH 1115' VT. RTE. 9							
	MAINTENANCE AGREE. NO. 1	11	REV. 115+58 RT.	REV. 115+55 RT.									LENGTH 22' NEW T.H. 48							

03-3220 1805 84E070

ACCT. PROP
ZFAK70,70384E0700.DGN
PRF: 84E07004
DATE PLOTTED 6-MAR-1992

DR. (P)- DRAINAGE RIGHT
DIP. (P)- DITCHING RIGHT
CH. (P)- CHANNEL RT.
DRIVE (T)- DRIVE RIGHT
CUL. (P)- CULVERT RIGHT
☒ - WATER SOURCES

PRESENT R.O.W.
TAKING WITHOUT ACCESS
TAKING WITHOUT ACCESS ALONG PROPERTY LINE
TAKING WITH ACCESS
PERMANENT EASEMENT
TEMPORARY EASEMENT

LEGEND
CZ (P) CLEAR ZONE
CONSTR. (T) CONSTRUCTION EASEMENT
SR SLOPE RIGHTS
P PROPERTY LINE
L TOP OF CUT
O TOE OF SLOPE

CLEAR ZONE
CONSTRUCTION EASEMENT
SLOPE RIGHTS
PROPERTY LINE
TOP OF CUT
TOE OF SLOPE

APPROVED: LAWRENCE BLISS L.S. DATE: 8-28-91
AGENT D, PLANS & TITLES

R. O. W. PLANS

BRATTLEBORO
HES 010-1 (30)
SHEET 9 OF 11

MAR 20 1996

EXCAVATION OF SURFACES & PAVEMENTS
 107+25 ~ 111+50 RT. (ON EXIST. RT. 9)
 (DO NOT SEED THIS AREA GRAVEL SURFACE ONLY IS TO REMAIN)

DRILLING & BLASTING OF SOLID ROCK SUBGRADE
 106+00 E ~ 117+50 E

CONSTRUCT STONE LINED DITCH
 102+00 ~ 106+00 LT.

REMOVAL & DISPOSAL OF GUARDRAIL
 108+35 ~ 111+25 RT (ON EXIST. RT. 9)

STEEL BEAM GUARD RAIL W/STEEL POSTS
 102+25 ~ 107+00 RT.

BREAKWAY CABLE TERMINAL
 102+00 ~ 102+25 RT.
 107+00 ~ 107+25 RT.

REMOVE AND RESET GUARD RAIL
 TH # 48 27+00 ~ 27+74.10 LT.

BEGIN R.O.W. PROJECT

TERMINAL CONNECTOR FOR STEEL BEAM GUARD RAIL
 TH # 48 27+74.10 LT.

HEAVY DUTY STEEL BEAM GUARD RAIL W/STEEL POSTS, TYPE I
 TH # 48 27+50 ~ 27+74.10 LT. (FACTORED LENGTH)

CONSTRUCT DRIVE
 109+34 RT 16' WIDE

STONE FILL TYPE II FOR SLOPE STABILIZATION
 105+50 ~ 114+00 LT

PLANK RAIL
 108+88 RT ~ 109+00 R.

CURVE DATA

$\Delta = 68^{\circ}06'44''$ LT
 D = 730'
 R = 763.94'
 T = 516.38'
 L = 908.16'
 E = 158.15'
 BANK = 0.080 FT / FT & CINDY C.
 HAMILTON, ELWIN R. & CINDY C.
 MAXIMUM CONSTRUCTION LIMITS FOR UNSUITABLE MATERIAL. (SEE NOTE 1 BELOW.)

HES 010-1(30) STA 101+84 25' RT.

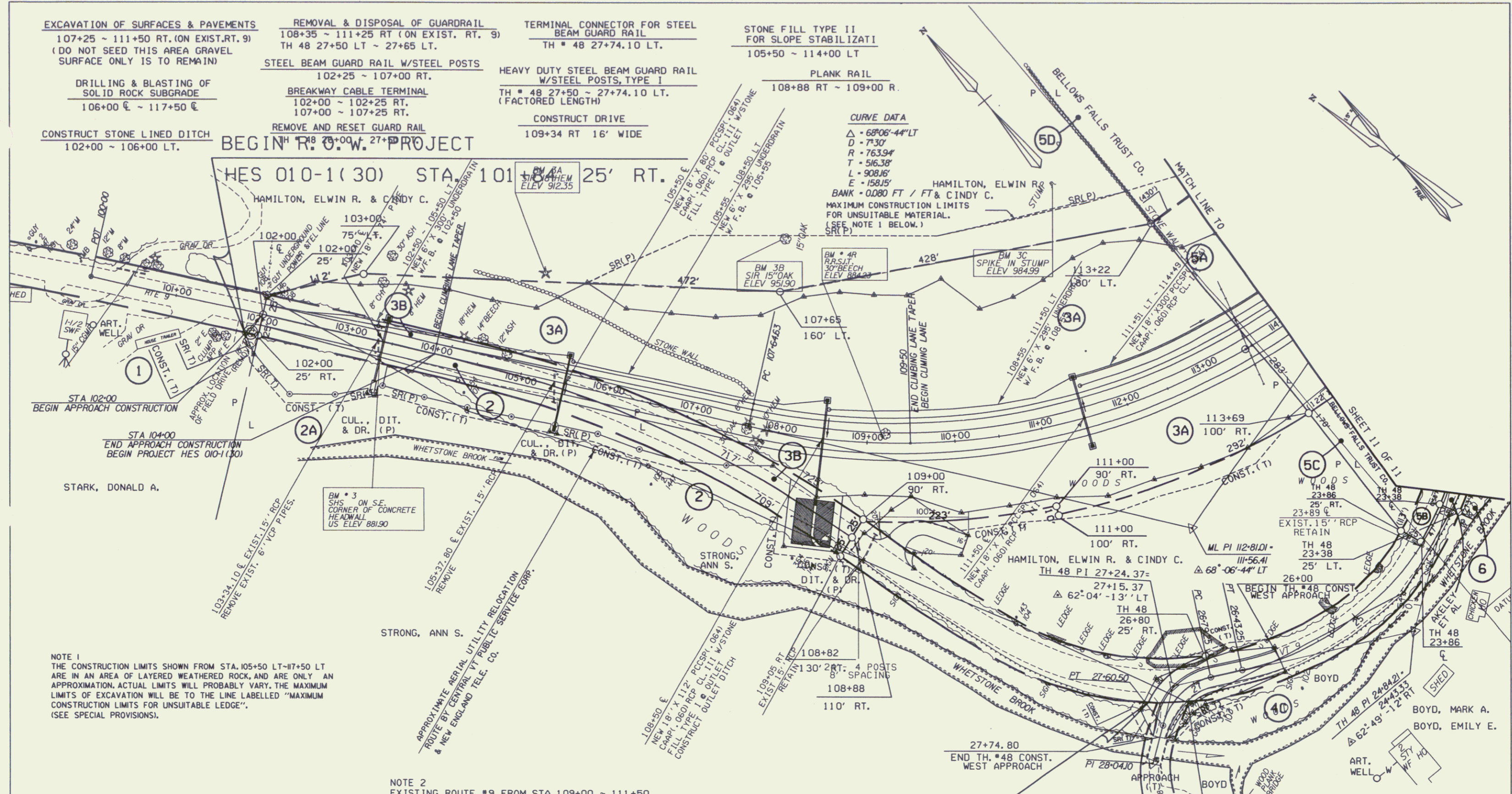

NOTE 1
 THE CONSTRUCTION LIMITS SHOWN FROM STA. 105+50 LT-117+50 LT ARE IN AN AREA OF LAYERED WEATHERED ROCK, AND ARE ONLY AN APPROXIMATION. ACTUAL LIMITS WILL PROBABLY VARY. THE MAXIMUM LIMITS OF EXCAVATION WILL BE TO THE LINE LABELLED "MAXIMUM CONSTRUCTION LIMITS FOR UNSUITABLE LEDGE". (SEE SPECIAL PROVISIONS).

NOTE 2
 EXISTING ROUTE #9 FROM STA 109+00 ~ 111+50 TO BE LEFT AS GRAVEL SURFACE IN PLACE

BEGIN RELINQUISHMENT NO. 1
 TH #48 27+42 25' RT.

DATUM
 VERTICAL _____
 HORIZONTAL _____

○ DENOTES REMOVAL AND DISPOSAL OF TREES

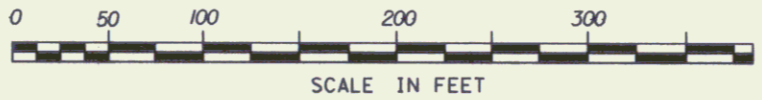

SURVEYED BY	REED & FALL	DATE 9/86&88
DRAWN BY	MENARD	DATE 10/86
SQUAD LEADER	J. JUNGVAL	
DESIGN		
FILE NO.	/prop/84e070/ra070zzz.dgn	
PARM	FILE	DATE
FILE	84e070llr	PLOTTED 13-APR-1995

04-07-93	REVISION 20
04-02-93	REVISION 19
11-09-92	REVISION 16

BRATTLEBORO
HES 010-1(30)
 R. O. W. SHEET 10 OF 11

MAR 20 1996

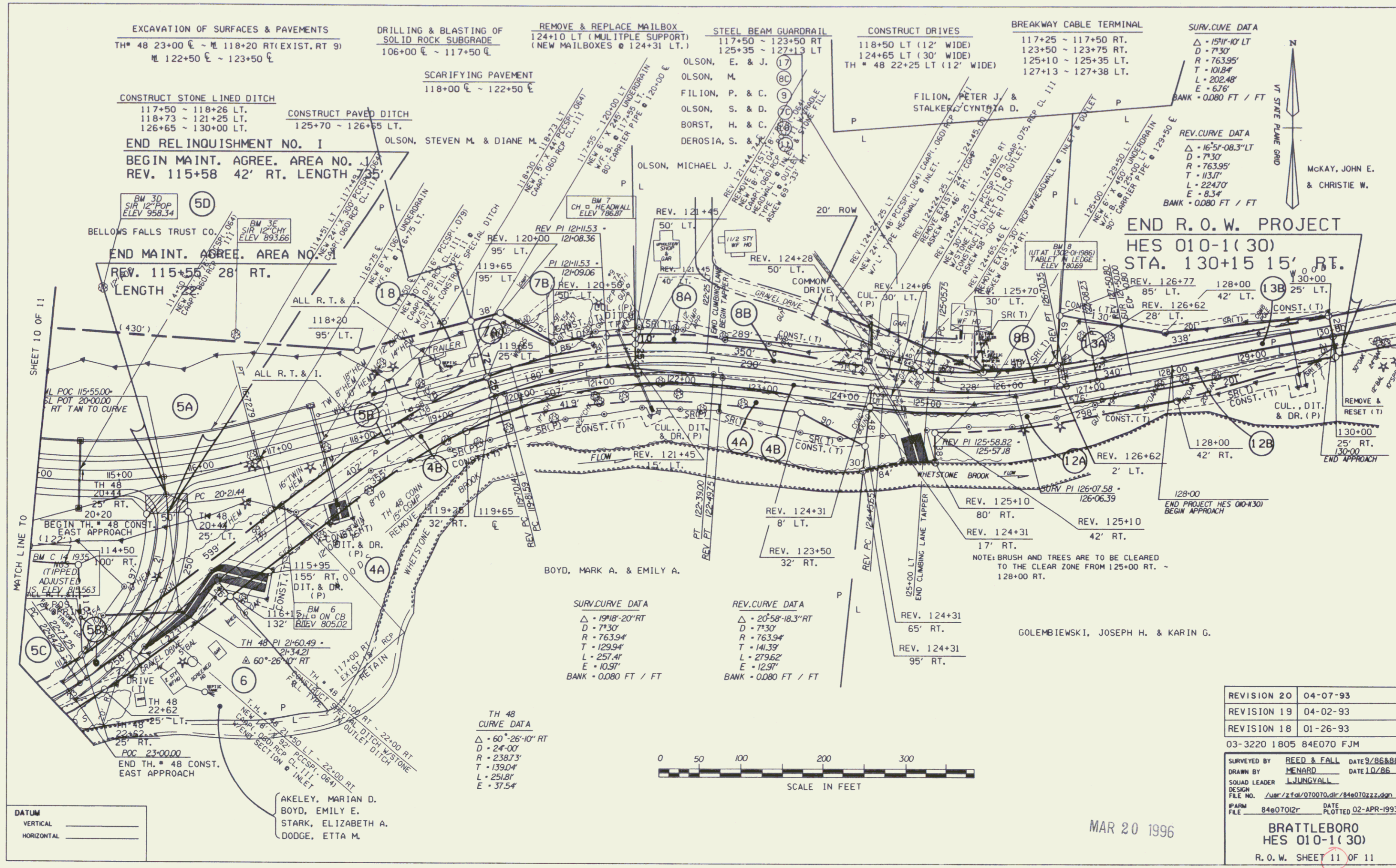

MAR 20 1996

11