

EXCAVATION OF SURFACES & PAVEMENTS
 107+25 ~ 111+50 RT. (ON EXIST. RT. 9)
 (DO NOT SEED THIS AREA GRAVEL
 SURFACE ONLY IS TO REMAIN)

**DRILLING & BLASTING OF
 SOLID ROCK SUBGRADE**
 106+00 E ~ 117+50 E

CONSTRUCT STONE LINED DITCH
 102+00 ~ 106+00 LT.

REMOVAL & DISPOSAL OF GUARDRAIL
 108+35 ~ 111+25 RT (ON EXIST. RT. 9)

STEEL BEAM GUARD RAIL W/STEEL POSTS
 102+25 ~ 107+00 RT.

BREAKWAY CABLE TERMINAL
 102+00 ~ 102+25 RT.
 107+00 ~ 107+25 RT.

REMOVE AND RESET GUARD RAIL
 108+35 ~ 111+25 RT.

BEGIN R.O.W. PROJECT

**TERMINAL CONNECTOR FOR STEEL
 BEAM GUARD RAIL**
 TH # 48 27+74.10 LT.

**HEAVY DUTY STEEL BEAM GUARD RAIL
 W/STEEL POSTS, TYPE I**
 TH # 48 27+50 ~ 27+74.10 LT.
 (FACTORED LENGTH)

CONSTRUCT DRIVE
 109+34 RT 16' WIDE

**STONE FILL TYPE II
 FOR SLOPE STABILIZATION**
 105+50 ~ 114+00 LT

PLANK RAIL
 108+88 RT ~ 109+00 R.

CURVE DATA

$\Delta = 68^{\circ}06'44''$ LT
 D = 730'
 R = 763.94'
 T = 516.38'
 L = 908.16'
 E = 158.15'
 BANK = 0.080 FT / FT & CINDY C.
 HAMILTON, ELWIN R. & CINDY C.
 MAXIMUM CONSTRUCTION LIMITS
 FOR UNSUITABLE MATERIAL.
 (SEE NOTE 1 BELOW.)

HES 010-1(30) STA 101+84 25' RT.

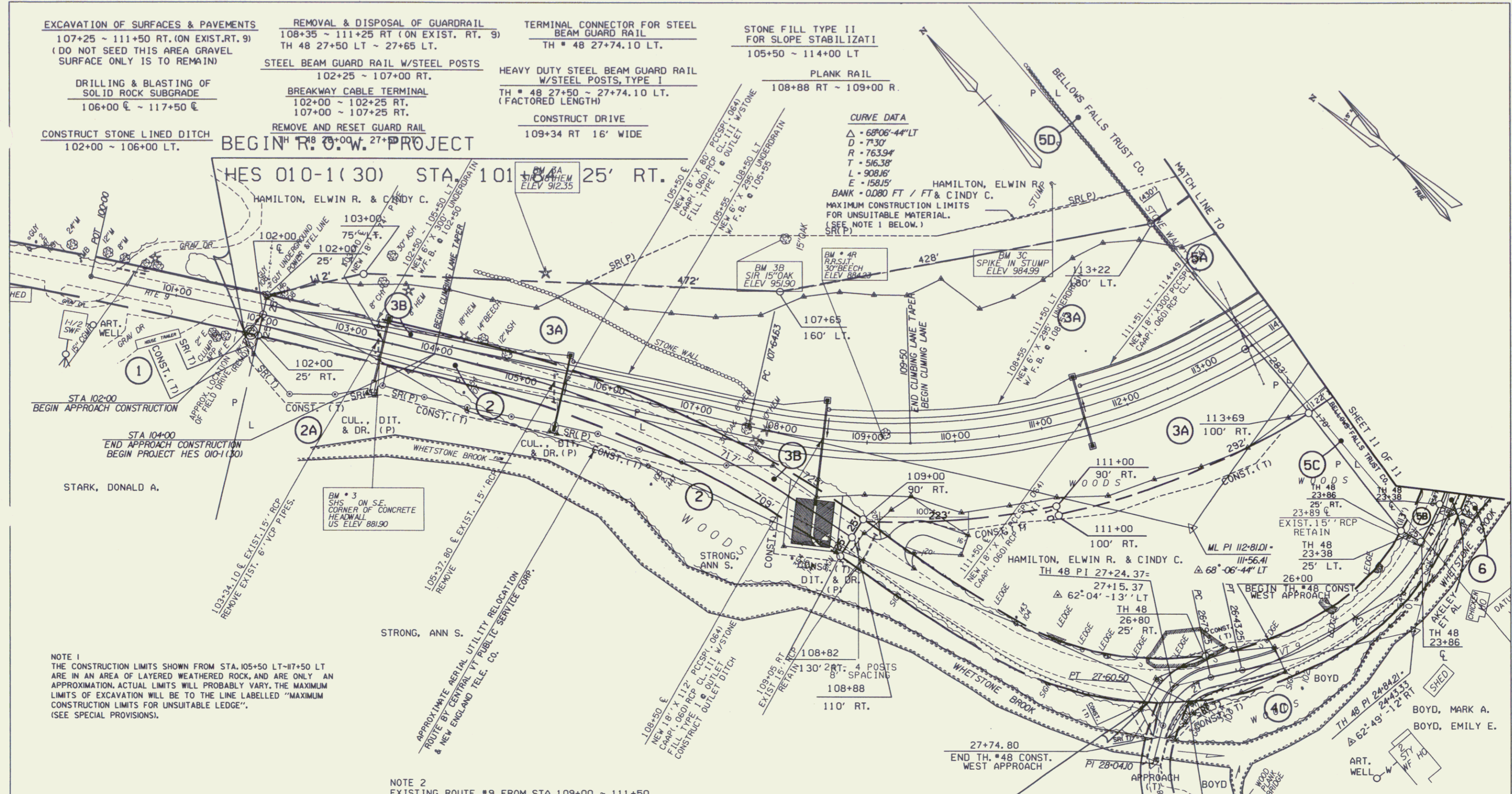

NOTE 1
 THE CONSTRUCTION LIMITS SHOWN FROM STA. 105+50 LT-117+50 LT
 ARE IN AN AREA OF LAYERED WEATHERED ROCK, AND ARE ONLY AN
 APPROXIMATION. ACTUAL LIMITS WILL PROBABLY VARY. THE MAXIMUM
 LIMITS OF EXCAVATION WILL BE TO THE LINE LABELLED "MAXIMUM
 CONSTRUCTION LIMITS FOR UNSUITABLE LEDGE".
 (SEE SPECIAL PROVISIONS).

NOTE 2
 EXISTING ROUTE #9 FROM STA 109+00 ~ 111+50
 TO BE LEFT AS GRAVEL SURFACE IN PLACE

BEGIN RELINQUISHMENT NO. 1
 TH #48 27+42 25' RT.

DATUM
 VERTICAL _____
 HORIZONTAL _____

○ DENOTES REMOVAL AND DISPOSAL OF TREES

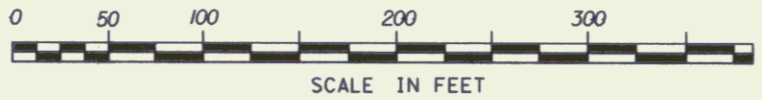

SURVEYED BY	REED & FALL	DATE 9/86&88
DRAWN BY	MENARD	DATE 10/86
SQUAD LEADER	J. JUNGVAL	
DESIGN		
FILE NO.	/prop/84e070/ra070zzz.dgn	
PARM	FILE	DATE
FILE	84e070llr	PLOTTED 13-APR-1995

04-07-93	REVISION 20
04-02-93	REVISION 19
11-09-92	REVISION 16

**BRATTLEBORO
 HES 010-1(30)**
 R. O. W. SHEET 10 OF 11

MAR 20 1996