

RESEARCH Drawer Set

STATE OF VERMONT
AGENCY OF TRANSPORTATION

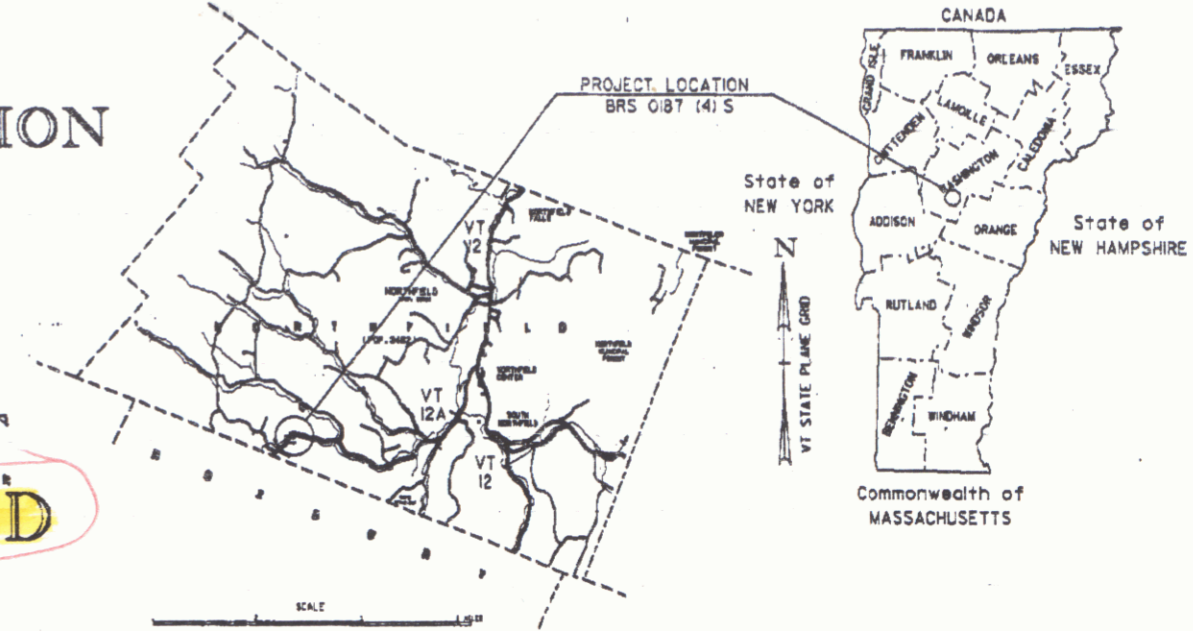

PROPOSED IMPROVEMENT
TOWN OF NORTHFIELD
COUNTY OF WASHINGTON
VT RTE 12A (FAS)



RIGHT-OF-WAY DIVISION
TOWN FILE
PERPETUAL
Town of Northfield VT RTE #12A
(To Be Returned To R.O.W. Division)

R.O.W. PLANS

BEGINNING AT A POINT ON VT 12A IN NORTHFIELD APPROXIMATELY 0.389 MILES
NORTHEASTERLY OF THE ROXBURY-NORTHFIELD TOWN LINE AND EXTENDING NORTH-
EASTERLY FOR 0.190 MILES

LENGTH OF ROADWAY 759.58 FEET = 0.144 MILES
LENGTH OF BRIDGE 90.42 FEET = 0.017 MILES
LENGTH OF PROJECT 850.00 FEET = 0.161 MILES
LENGTH OF R.O.W. PROJECT 989.66 FEET = 0.187 MILES

WORK TO BE PERFORMED UNDER THIS PROJECT INCLUDES THE REPLACEMENT
OF BRIDGE #30 AND RECONSTRUCTION OF HIGHWAY APPROACHES.

BEGIN R.O.W. PROJECT
REV. STA. 18+91 33' LT.

| CONVENTIONAL SIGNS | |
|--------------------|-------------|
| COUNTY LINE | --- |
| TOWN LINE | - - - - |
| LIMITS OF ACCESS | --- |
| POINT OF ACCESS | X |
| FENCE LINE | — · — · — · |
| STONE WALL | — · — · — · |
| TRAVELED WAY | — · — · — · |
| GUARD RAIL | — · — · — · |
| RAILROAD | — · — · — · |
| SURVEY LINE | — · — · — · |
| CULVERT | — · — · — · |
| POWER POLE | — · — · — · |
| TELEPHONE POLE | — · — · — · |
| TREES | — · — · — · |
| CONTROL OF ACCESS | — · — · — · |
| PROPERTY LINE | — · — · — · |
| R.O.W. TAKING LINE | — · — · — · |
| SLOPE RIGHTS | — · — · — · |
| TOP OF CUT | — · — · — · |
| TOE OF SLOPE | — · — · — · |

| | |
|------------|-----|
| DATUM | |
| VERTICAL | N/A |
| HORIZONTAL | N/A |

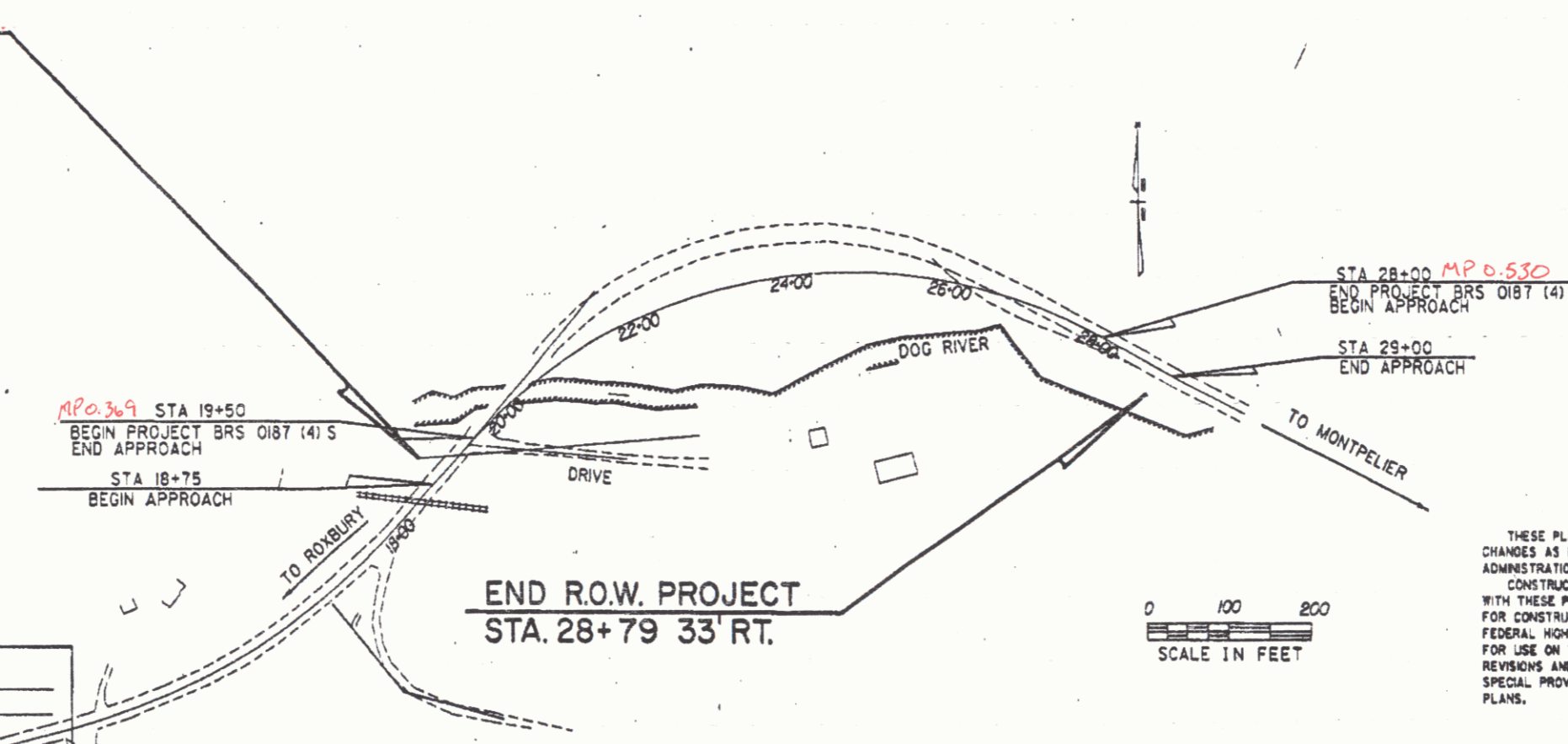

Pin # 84E043

AUG 3 1994

THESE PLANS ARE SUBJECT TO SUCH ENGINEERING
CHANGES AS MAY BE REQUIRED BY THE FEDERAL HIGHWAY
ADMINISTRATION OR THE CHIEF ENGINEER.
CONSTRUCTION IS TO BE CARRIED ON IN ACCORDANCE
WITH THESE PLANS AND THE STANDARD SPECIFICATIONS
FOR CONSTRUCTION DATED 1990 AS APPROVED BY THE
FEDERAL HIGHWAY ADMINISTRATION ON MARCH 15, 1990
FOR USE ON THIS PROJECT, INCLUDING ALL SUBSEQUENT
REVISIONS AND SUCH REVISED SPECIFICATIONS AND
SPECIAL PROVISIONS AS ARE INCORPORATED IN THESE
PLANS.

| | |
|--|--|
| SUBMITTED BY ORDER OF THE STATE TRANSPORTATION BOARD | |
| APPROVED <i>[Signature]</i> DATE <i>[Date]</i> | DIRECTOR OF PLANNING & PRECONSTRUCTION |
| APPROVED <i>[Signature]</i> DATE <i>[Date]</i> | Traffic Chief, Property Administration |
| PROJECT NORTHFIELD | |
| PROJECT BRS 0187 (4) | |
| SHEET (1) OF 7 SHEETS | |