

- REMOVAL AND DISPOSAL OF GUIDE POSTS**  
 STA 12+83, LT & RT
- BREAKAWAY CABLE TERMINALS**  
 STA 16+12 LT - 16+37 LT  
 STA 17+00 RT - 17+25 RT
- STEEL BEAM GUARD RAIL**  
 STA 16+37 LT - 18+50 LT
- CONSTRUCT DRIVE**  
 STA 14+00 LT - 16'w GRAVEL  
 STA 15+50 LT - 16'w GRAVEL
- SCARIFY PAVEMENT**  
 STA 15+00 - 17+15

BEGIN R.O.W. PROJECT  
 BRS 0187(6) REV. STA. 11+50

**DATUM**

VERTICAL	NGVD 1929
HORIZONTAL	N/A

12-05-94 REVISION 3  
 02-10-94 REVISION 1

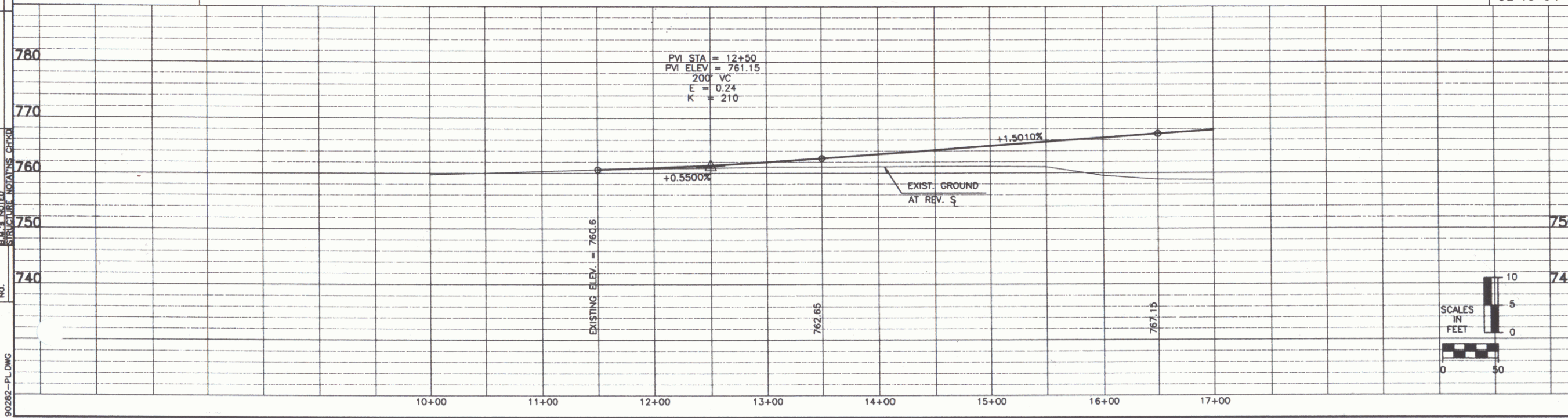

**STATE OF VERMONT  
 AGENCY OF TRANSPORTATION**

Town Of	BRAINTREE	Bridge No.	6
Highway No.	VT. Route 12A	Log Sta.	
		Surv. Sta.	
VT RTE 12A OVER THE THIRD BRANCH OF THE WHITE RIVER			
PLAN AND ELEVATION			
Designed By	J. Warner	Drawn By	N. Spaulding
Checked By	Date	Bridge Design Supervisor	Date

**BRAINTREE  
 BRS 0187(6)**  
 R.O.W. SHEET (9) OF 10 SHEETS