

Research Balanced 6/9/99

Stamped 11-06-01 1999

STATE OF VERMONT AGENCY OF TRANSPORTATION



R.O.W. PLANS

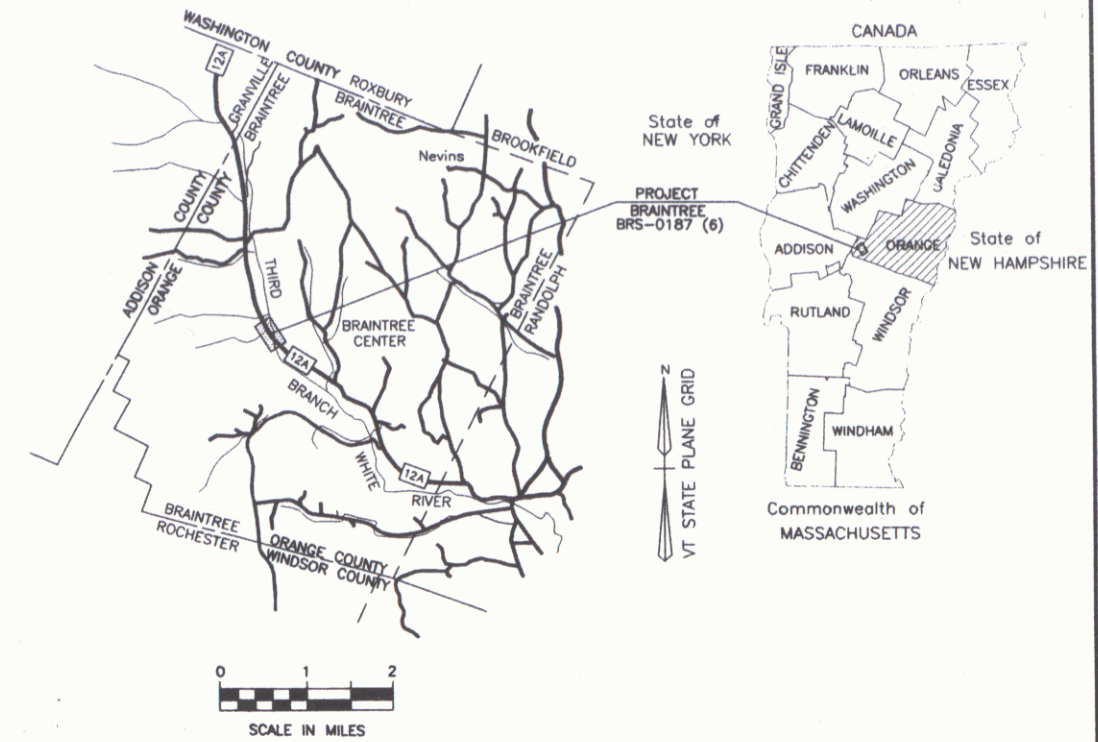

BEGIN R.O.W. PROJECT
BRS 0187(6) REV. STA. 11+50

BEGIN MAINT. AGREE. AREA NO. I
REV. STA. 18+66 15' RT.

PROPOSED IMPROVEMENT TOWN OF BRAintree COUNTY OF ORANGE VT ROUTE 12A (F.A.S.)

PROJECT LOCATION, LENGTH AND DESCRIPTION - "BEGINNING AT A POINT IN THE TOWN OF BRAintree, ON VERMONT ROUTE 12A APPROXIMATELY 3.751 MILES NORTHERLY OF THE RANDOLPH-BRAintree TOWN LINE, AND EXTENDING NORTHERLY 0.237 MILES."

LENGTH OF ROADWAY = 1111.95 FEET = 0.211 MILES
 LENGTH OF BRIDGE = 138.05 FEET = 0.026 MILES
 LENGTH OF PROJECT = 1250.00 FEET = 0.237 MILES
 LENGTH OF R.O.W. PROJECT = 1747.00 FEET = 0.331 MILES

WORK TO BE PERFORMED UNDER THIS PROJECT CONSISTS OF REPLACEMENT OF EXISTING BRIDGE #6 ON VERMONT ROUTE 12A, INCLUDING ALL THE NECESSARY ROADWAY APPROACH WORK.

ALL DRIVES AS INDICATED ON PLANS
ARE SUBJECT TO PERMITS PURSUANT
TO TITLE 19 SECTION IIII, V.S.A.

CONVENTIONAL SIGNS

COUNTY LINE	---
TOWN LINE	- - - -
LIMITS OF ACCESS	o-o
POINT OF ACCESS	X
FENCE LINE	x-x-x
STONE WALL	
TRAVELED WAY	
GUARD RAIL	o-o-o-o
RAILROAD	
SURVEY LINE	---
CULVERT	---
POWER POLE	o
TELEPHONE POLE	o
TREES	*
CONTROL OF ACCESS	///
PROPERTY LINE	---
R.O.W. TAKING LINE	---
SLOPE RIGHTS	SR
TOP OF CUT	▲
TOE OF SLOPE	○

5/18/99
As Builts
Show that Begin
Approach started
at Rev. Sta. 11+38

DATUM

VERTICAL	NGVD 1929
HORIZONTAL	N/A

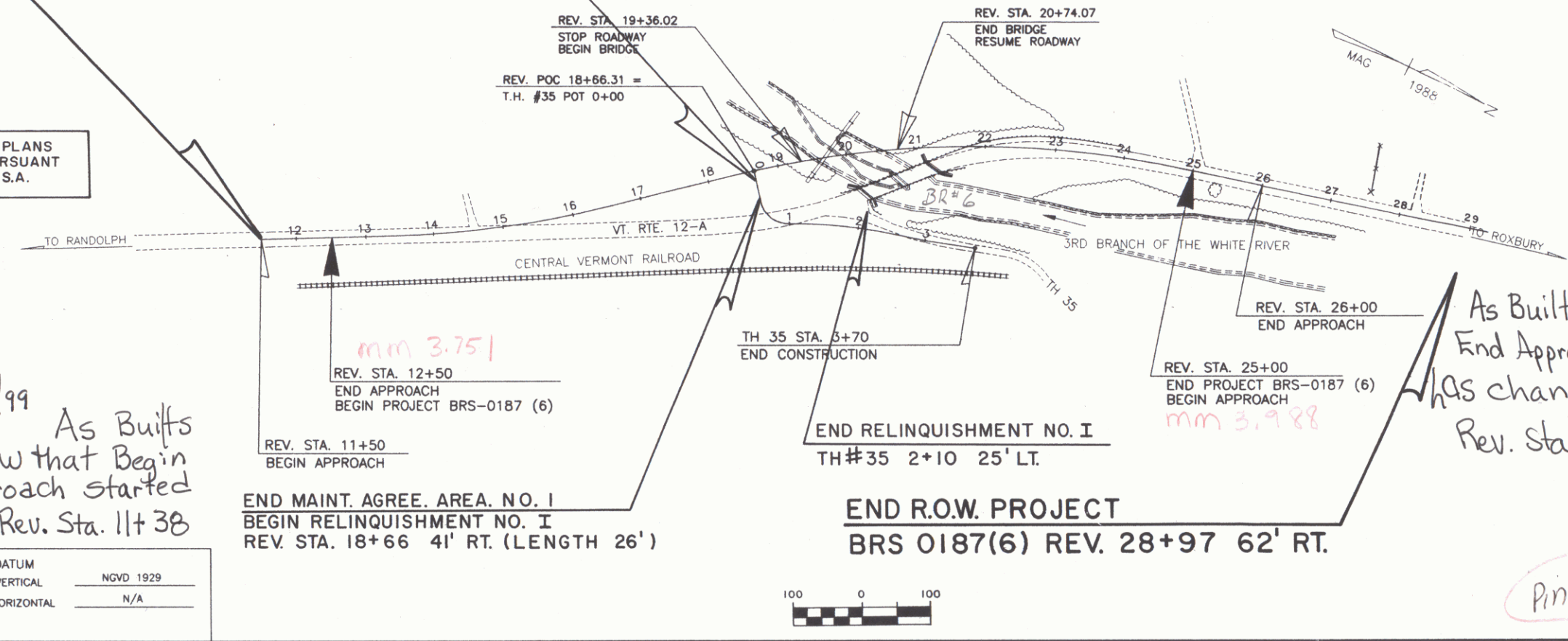

5/18/99
As Builts show that
End Approach station
has changed to
Rev. Sta. 26+55

EXEMPT

THESE PLANS ARE SUBJECT TO SUCH ENGINEERING CHANGES AS MAY BE REQUIRED BY THE FEDERAL HIGHWAY ADMINISTRATION OR THE CHIEF ENGINEER. CONSTRUCTION IS TO BE CARRIED ON IN ACCORDANCE WITH THESE PLANS AND THE STANDARD SPECIFICATIONS FOR CONSTRUCTION DATED 1990, AS APPROVED BY THE FEDERAL HIGHWAY ADMINISTRATION ON MARCH 15, 1990 FOR USE ON THIS PROJECT, INCLUDING ALL SUBSEQUENT REVISIONS AND SUCH REVISED SPECIFICATIONS AND SPECIAL PROVISIONS AS ARE INCORPORATED IN THESE PLANS.

APPROVED: *[Signature]* DATE: 12/12/93
Director of Engineering

APPROVED: *[Signature]* DATE: 12/12/93
Chief, Right of Way

BRAintree
BRS 0187(6)

ROW SHEET 1 OF 10 SHEETS

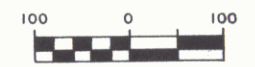

Research Set