

SEE SHEET 2

STATE OF VERMONT
AGENCY OF TRANSPORTATION



PROPOSED IMPROVEMENT
TOWN OF WOODFORD
COUNTY OF BENNINGTON
VT. ROUTE 9 - PRINCIPAL ARTERIAL

BEGINNING AT A POINT 1.206 MILES EAST OF THE BENNINGTON-WOODFORD TOWN LINE AND EXTENDING EASTERLY 0.123 MILES.

WORK TO BE PERFORMED UNDER THIS PROJECT INCLUDES REPLACEMENT AND WIDENING OF BRIDGE NO. II OVER THE ROARING BRANCH OF THE WALLOOMSAC RIVER AND NECESSARY APPROACH WORK GENERALLY ALONG EXISTING ALIGNMENT.

LENGTH OF ROADWAY = 370.92 FEET = 0.070 MILES
LENGTH OF BRIDGE = 279.08 FEET = 0.053 MILES
LENGTH OF PROJECT = 650.00 FEET = 0.123 MILES
LENGTH OF R.O.W. PROJECT = 511.00 FEET = 0.097 MILES

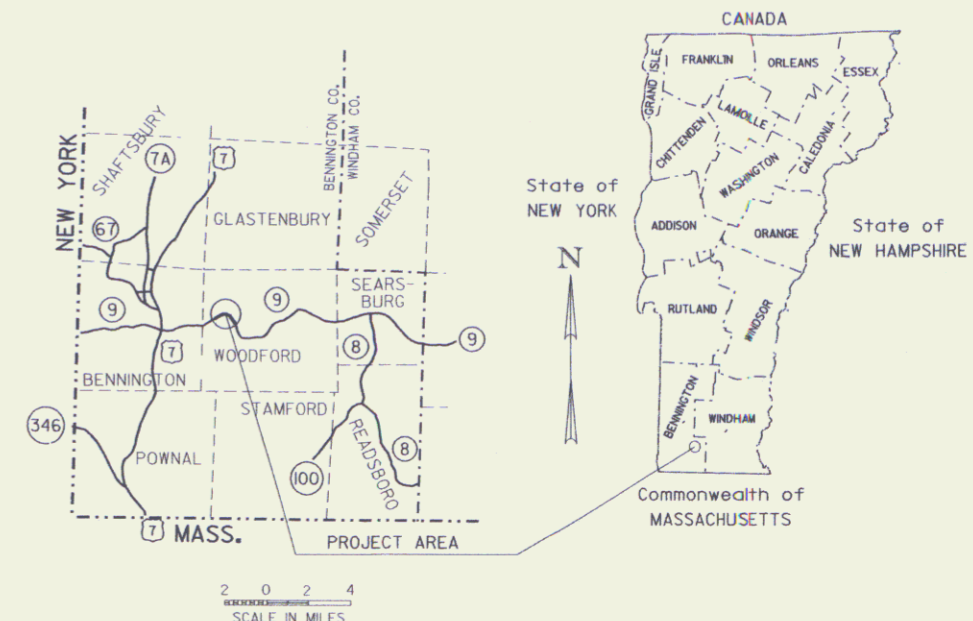

R.O.W. PLANS

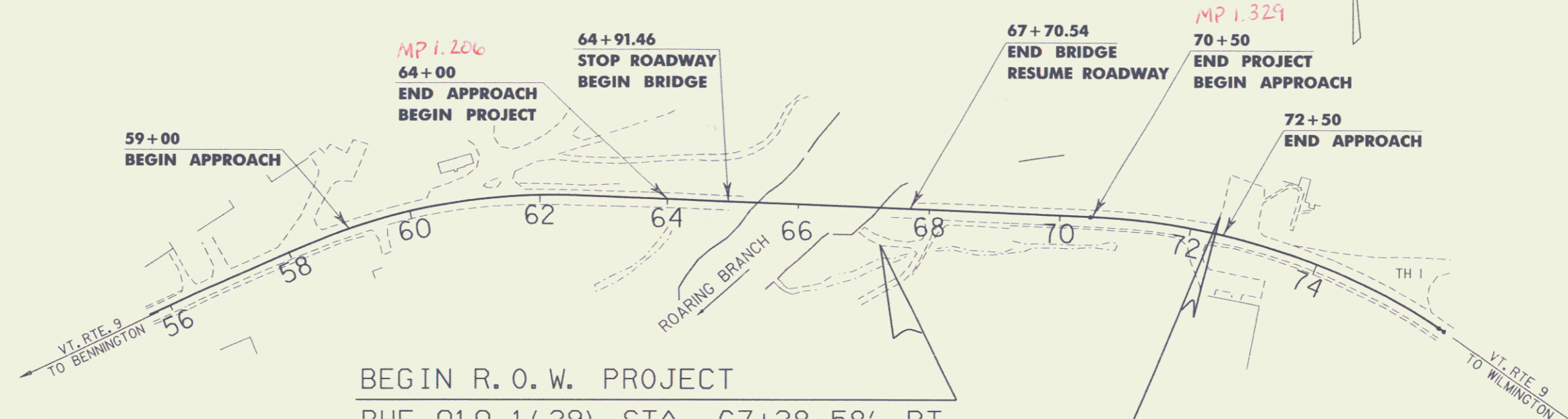

CONVENTIONAL SIGNS

COUNTY LINE	---
TOWN LINE	- - - -
LIMITS OF ACCESS	○ ○ ○ ○
POINT OF ACCESS	X
FENCE LINE	- x - x -
STONE WALL	o o o o o o o o
TRAVELED WAY	—
GUARD RAIL	o o o o o o o o
RAILROAD	—+—+—+—+—
SURVEY LINE	—+—+—+—+—
CULVERT	—+—+—+—+—
POWER POLE	⊕
TELEPHONE POLE	⊕
TREES	⊗
CONTROL OF ACCESS	///
PROPERTY LINE	—
R.O.W. TAKING LINE	— SR —
SLOPE RIGHTS	○ ○ ○ ○
TOP OF CUT	△ △ △ △
TOE OF SLOPE	○ ○ ○ ○

ALL DRIVES AS INDICATED ON PLANS ARE SUBJECT TO PERMITS PURSUANT TO TITLE 19 SECTION III, V.S.A.

DATUM
VERTICAL NGVD 1929
HORIZONTAL N/A

BEGIN R. O. W. PROJECT
BHF 010-1(29) STA. 67+28 58' RT.

END R. O. W. PROJECT
BHF 010-1(29) STA. 72+39 27' LT.

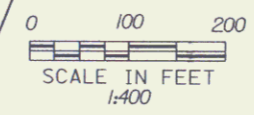

THESE PLANS ARE SUBJECT TO SUCH ENGINEERING CHANGES AS MAY BE REQUIRED BY THE FEDERAL HIGHWAY ADMINISTRATION OR THE CHIEF ENGINEER. CONSTRUCTION IS TO BE CARRIED ON IN ACCORDANCE WITH THESE PLANS AND THE STANDARD SPECIFICATIONS FOR CONSTRUCTION DATED 1990, AS APPROVED BY THE FEDERAL HIGHWAY ADMINISTRATION ON MARCH 15, 1990 FOR USE ON THIS PROJECT, INCLUDING ALL SUBSEQUENT REVISIONS AND SUCH REVISED SPECIFICATIONS AND SPECIAL PROVISIONS AS ARE INCORPORATED IN THESE PLANS.

MAR 27 2008

Pin # 84E039

APPROVED	FRANK EVANS	DATE	6-10-97
	Director of Project Development		
APPROVED	ALLEN N. BLAKE	DATE	6-10-97
	Chief of Right of Way		
WOODFORD			
Proj: BHF 010-1(29)			
R.O.W. SHEET 17 OF 11 SHEETS			

MATERIAL ITEM	THICKNESS TOLERANCE
PAVEMENT (TOTAL DEPTH)	± 1/4"
SUBBASE	± 1"
SAND BORROW	± 1"

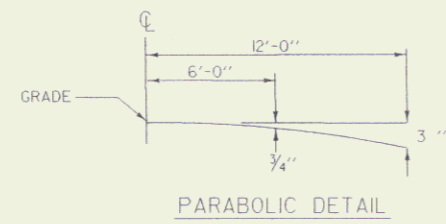

TYPICAL SECTIONS

1/2" BITUMINOUS CONCRETE PAVEMENT, TYPE III
 2" BITUMINOUS CONCRETE PAVEMENT, TYPE II
 5" BITUMINOUS CONCRETE PAVEMENT, TYPE I (TWO LIFTS OF 2 1/2")
 2" SUBBASE OF CRUSHED GRAVEL (COARSE GRADED)
 15" SAND BORROW
 SHOULDERS 3 1/2" BITUMINOUS CONCRETE PAVEMENT (1 1/2" TYPE III OVER 2" TYPE II)

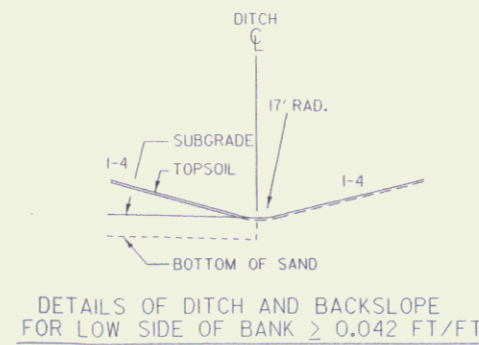
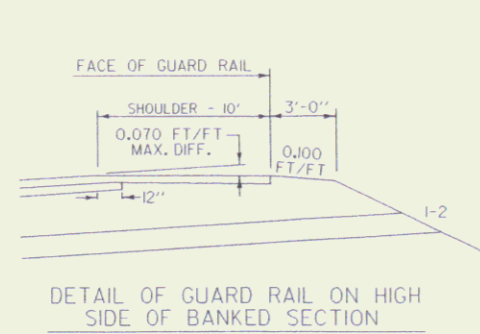
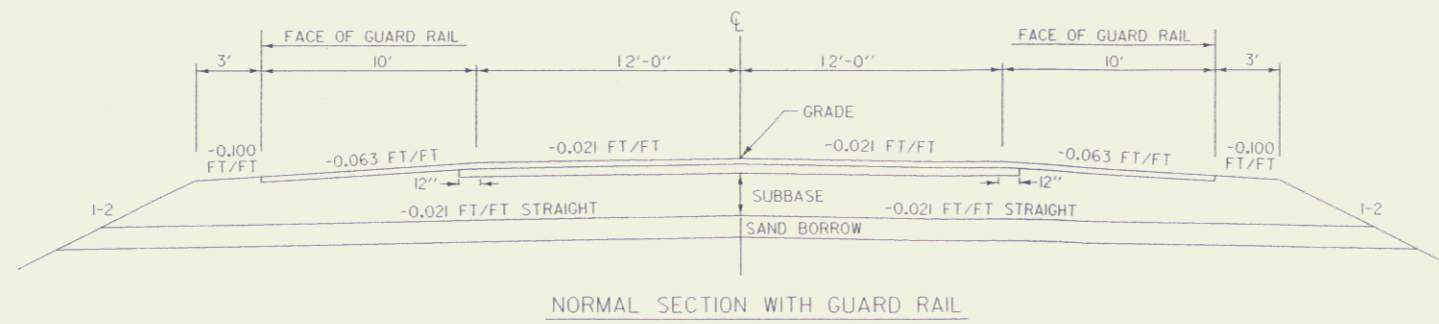
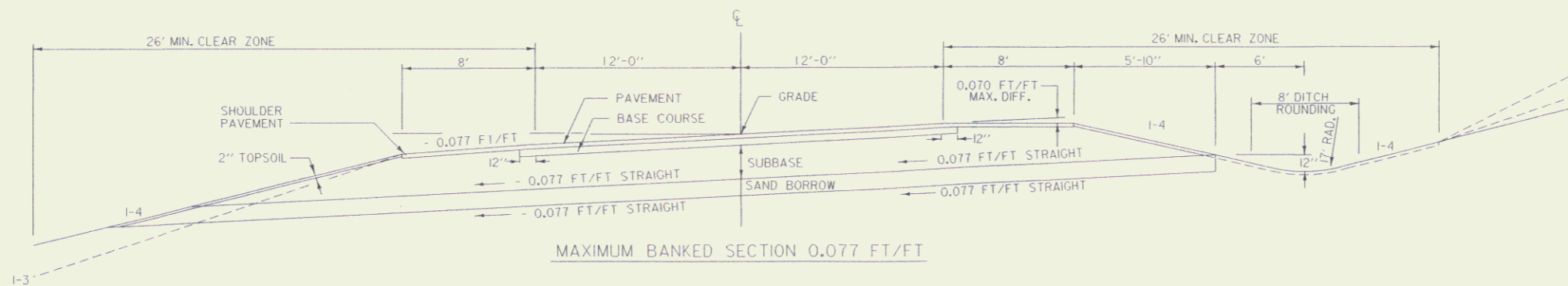
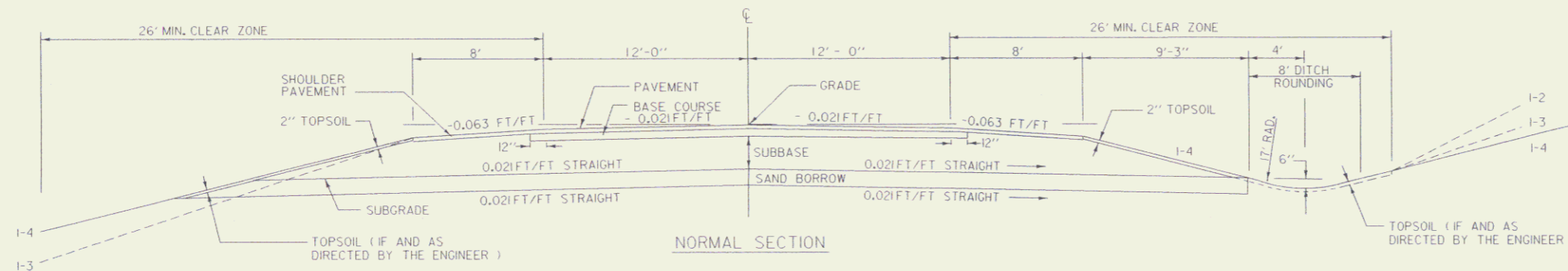

SEEDING FORMULA URBAN AREAS

% WT.	LBS./A.	NAME	PUR %	GERM %
42.5	34.0	CREeping RED FESCUE	98	85
10.0	8.0	PERENNIAL RYE GRASS	95	90
42.5	34.0	KENTUCKY BLUE GRASS	85	85
5.0	4.0	ANNUAL RYE GRASS	95	85
100.00	80.0			

SEEDING FORMULA RURAL AREAS

% WT.	LBS./A.	NAME	PUR %	GERM %
37.5	22.5	CREeping RED FESCUE	98	85
37.5	22.5	TALL FESCUE	95	90
5.0	3.0	RED TOP	95	90
15.0	3.0	BIRD'S-FOOT TREFLOIL	98	85
5.0	3.0	ANNUAL RYEGRASS	95	85
100.0	60.0			

GENERAL NOTES

SEED MIXTURE: SHALL NOT HAVE A WEED CONTENT EXCEEDING 0.40% BY WEIGHT AND SHALL BE FREE OF ALL NOXIOUS SEED.
 SEED: TO BE APPLIED PER SEEDING FORMULAS OR AS DIRECTED BY THE ENGINEER.
 FERTILIZER: FORMULA 10-20-10, TO BE USED WITH SEED, APPLIED AT THE RATE OF 500 LBS./ACRE. (HYDRO SEEDERS MAY USE 19-19-19 FORMULA).
 AGRICULTURAL LIMESTONE: TO BE APPLIED AT THE RATE OF 2 TONS/ACRE, OR AS DIRECTED BY THE ENGINEER.
 HAY MULCH: TO BE PLACED ON EARTH SLOPES AT THE RATE OF 2 TONS/ACRE, OR AS DIRECTED BY THE ENGINEER.
 TOPSOIL: TO BE USED WITH SEED AS INDICATED ON THE PLANS, OR AS DIRECTED BY THE ENGINEER.
 MARKER POSTS: TO BE PLACED AS INDICATED OR AS DIRECTED BY THE ENGINEER.
 SLOPE ROUNDING: ALL CUT SLOPES TO BE ROUNDED IN ACCORDANCE WITH STANDARD SHEET B-5.
 PAY LIMITS OF SAND BORROW: WHEN USED IN CONJUNCTION WITH UNDERDRAIN - SEE STANDARD SHEET D - 2.
 TACK COAT: EMULSIFIED ASPHALT IS TO BE APPLIED AT THE RATE OF 0.015 GAL/SY BETWEEN SUCCESSIVE COURSES OF PAVEMENT AS DIRECTED BY THE ENGINEER.

MAR 27 2008

TYPICAL SHEET

SURVEYED BY	MOREAU	DATE	12/88
DRAWN BY	KJR	DATE	4/92
SQUAD LEADER	NYQUIST		
DESIGN FILE NO.	/prop/840039/re0392frm.dgn		
FILE	re039tyd.i	DATE	PLOTTED 6-JUN-1997
PROJ. NAME	WOODFORD		
PROJ. NO.	BHF 010-1 (29)		
R. O. W.	SHEET 2 OF 11 SHEETS		

N.T.S.

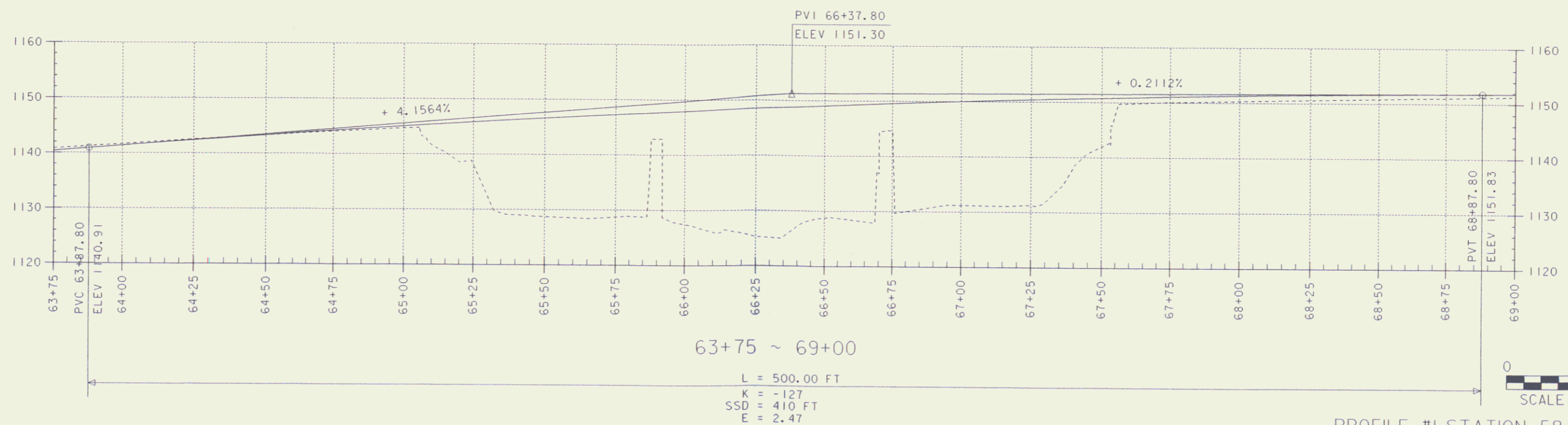
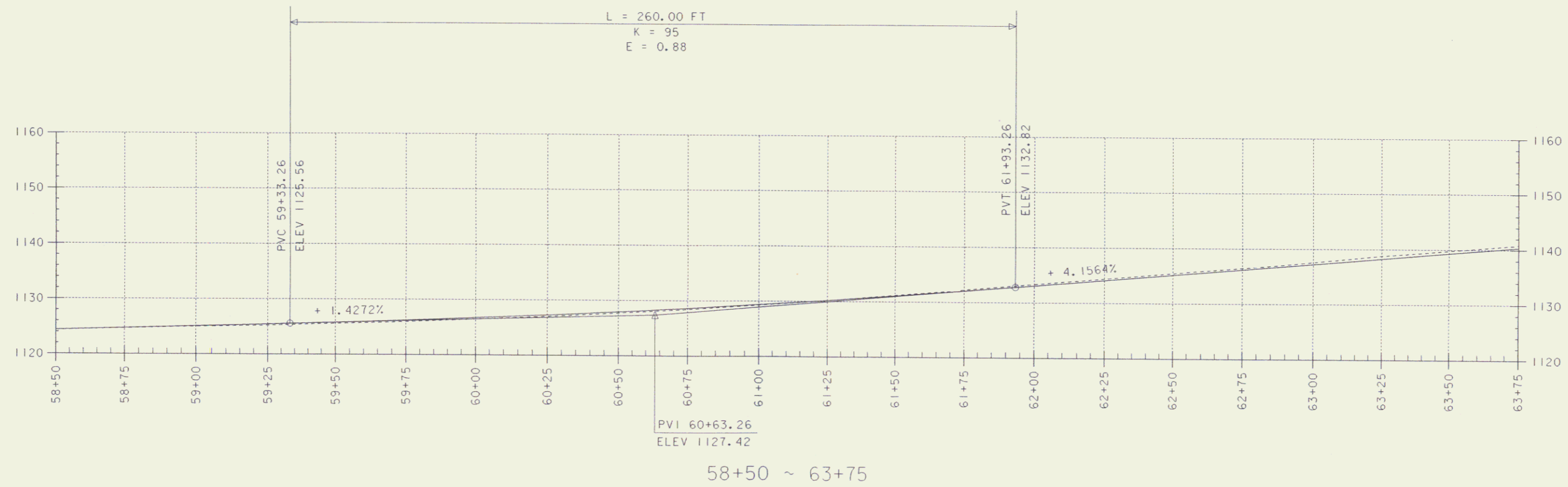

DATUM	
VERTICAL	NGVD 1929
HORIZONTAL	N/A

PROJECT: WOODFORD	PROJECT NO.: BHF 010-K(29)
DESIGN FILE NAME: /sqda/84e039/de039bdr.dgn	PLOT DATE: 8-JUN-1997
IPARM FILE NAME: de039pr1.l	SURVEY DATE: 12-88
SURVEYED BY: MOREAU	DRAWN BY: PJR
SQUAD LEADER: NYOUST	R. O. W. SHEET 3 OF 11 SHEETS

MAR 27 2008 3

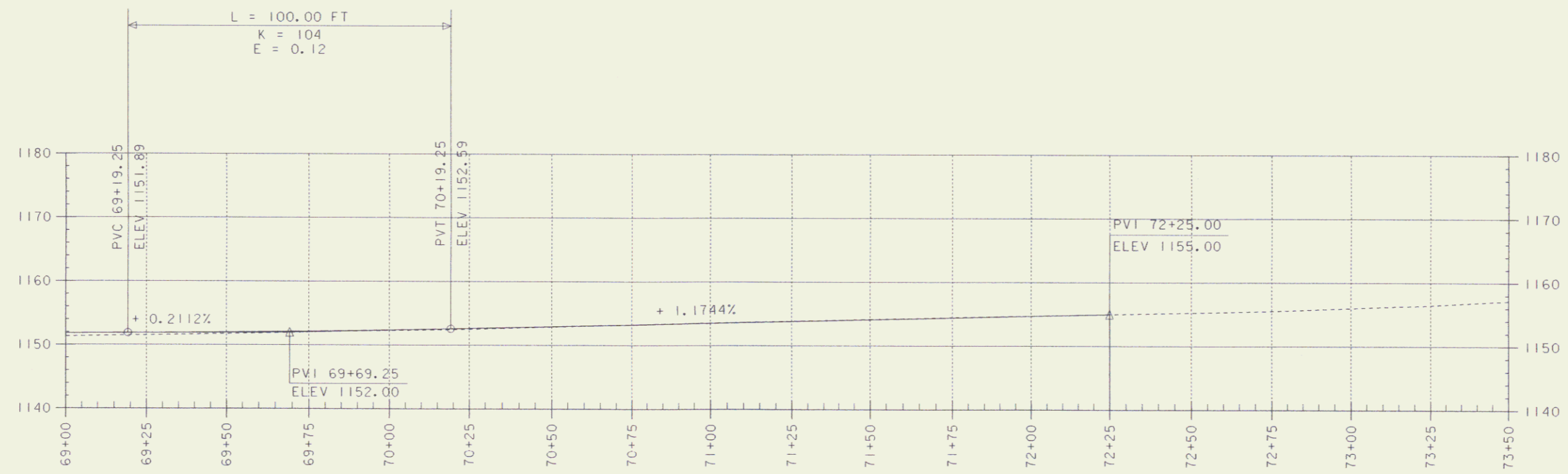

69+00 ~ 73+50

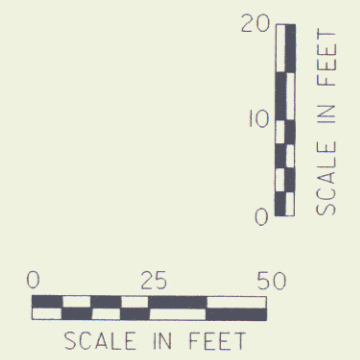

MAR 27 2008

PROFILE #2 STATION 68+50 ~ 73+50

DATUM	
VERTICAL	NGVD 1929
HORIZONTAL	N/A

PROJECT: WOODFORD	PROJECT NO. 1 BHF 010-1(29)
DESIGN FILE NAME: /sqda/84e039/de039bdr.dgn	PLOT DATE: 8-JUN-1997
IPARM FILE NAME: de039pr2	SURVEY DATE: 12-88
SURVEYED BY: MOREAU	DRAWN BY: PJR
SQUAD LEADER: NYQUIST	
R. O. W.	SHEET 4 OF 11 SHEETS

4

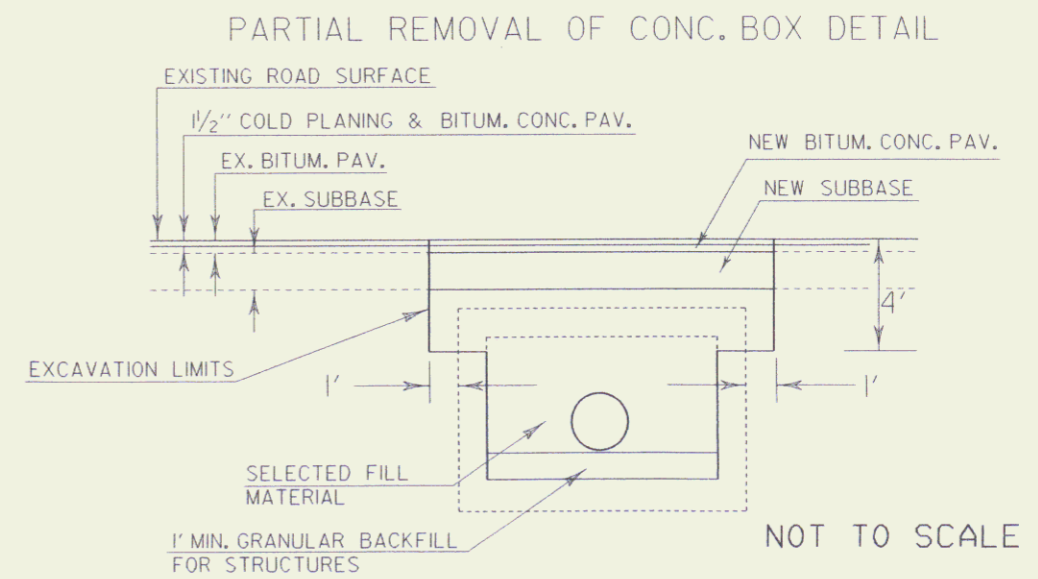
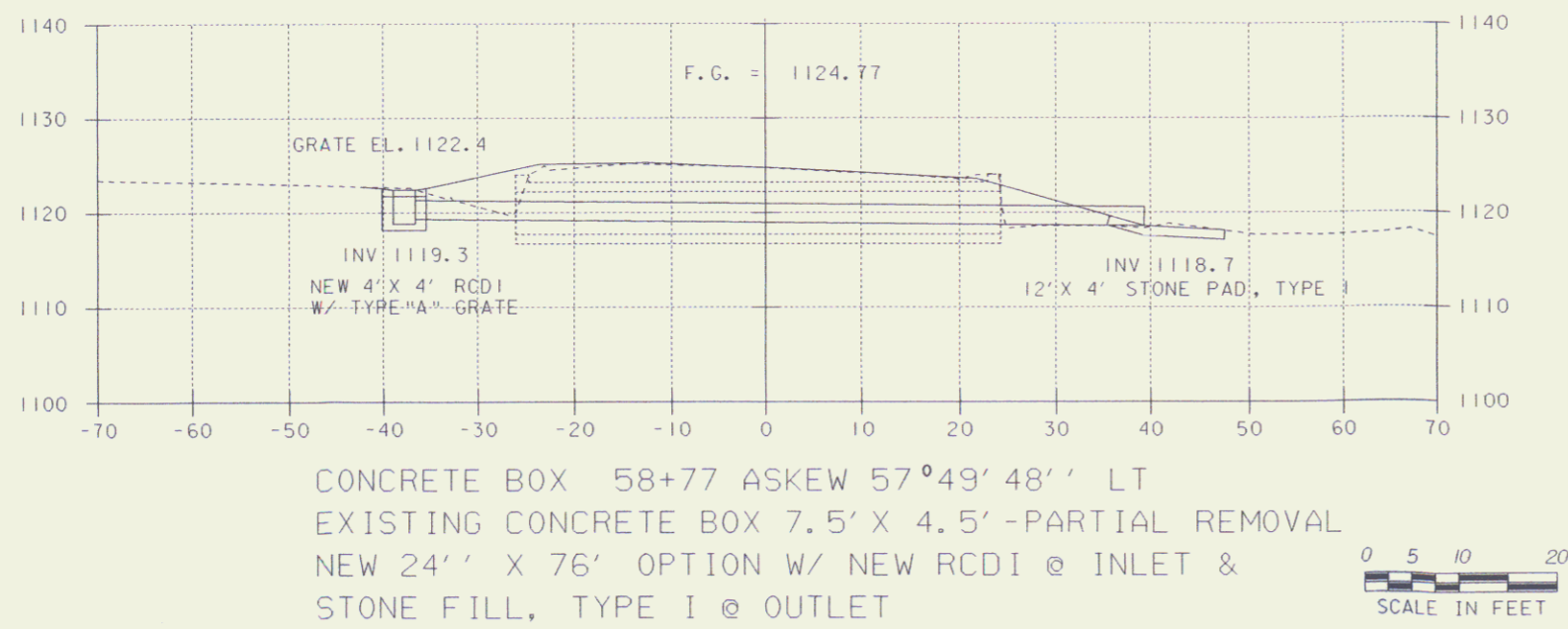
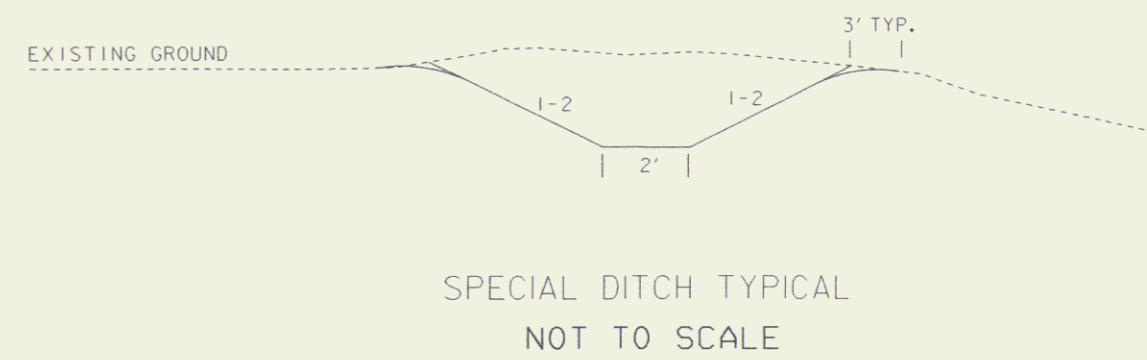
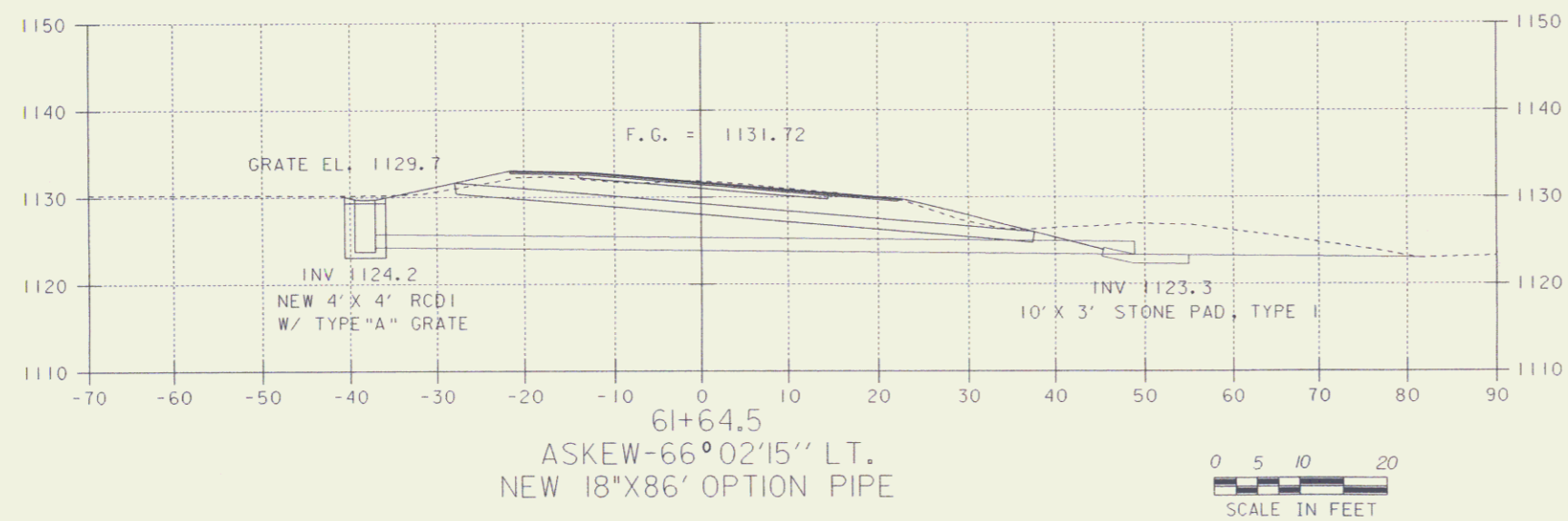

CONSTRUCTION NOTES:

REMOVE CONCRETE BOX TOP AND WALLS TO 4' BELOW EXISTING GRADE, REMOVE ENTIRE WINGWALLS, (TO BE PAID AS REMOVAL OF CONCRETE OR MASONRY).

BACKFILL WITH SELECTED FILL MATERIAL TO BOTTOM OF EXISTING SUBGRADE LINE.

MATCH EXISTING SUBBASE AND BITUMINOUS CONCRETE PAVEMENT THICKNESSES.

DETAIL SHEET W/ ASKEW PIPE SECTIONS

PROJECT:	WOODFORD	PROJECT NO.:	BHF 010-(129)
DESIGN FILE NAME:	/sqda/84e039/de039mul.dgn	PLOT DATE:	6-JUN-1997
IPARM FILE NAME:	de039pcb	SURVEY DATE:	12/88
SURVEYED BY:	MOREAU	DRAWN BY:	PJR
SQUAD LEADER:	BTN		
R.O.W. SHEET 5 OF 11 SHEETS			

MAR 27 2008

5

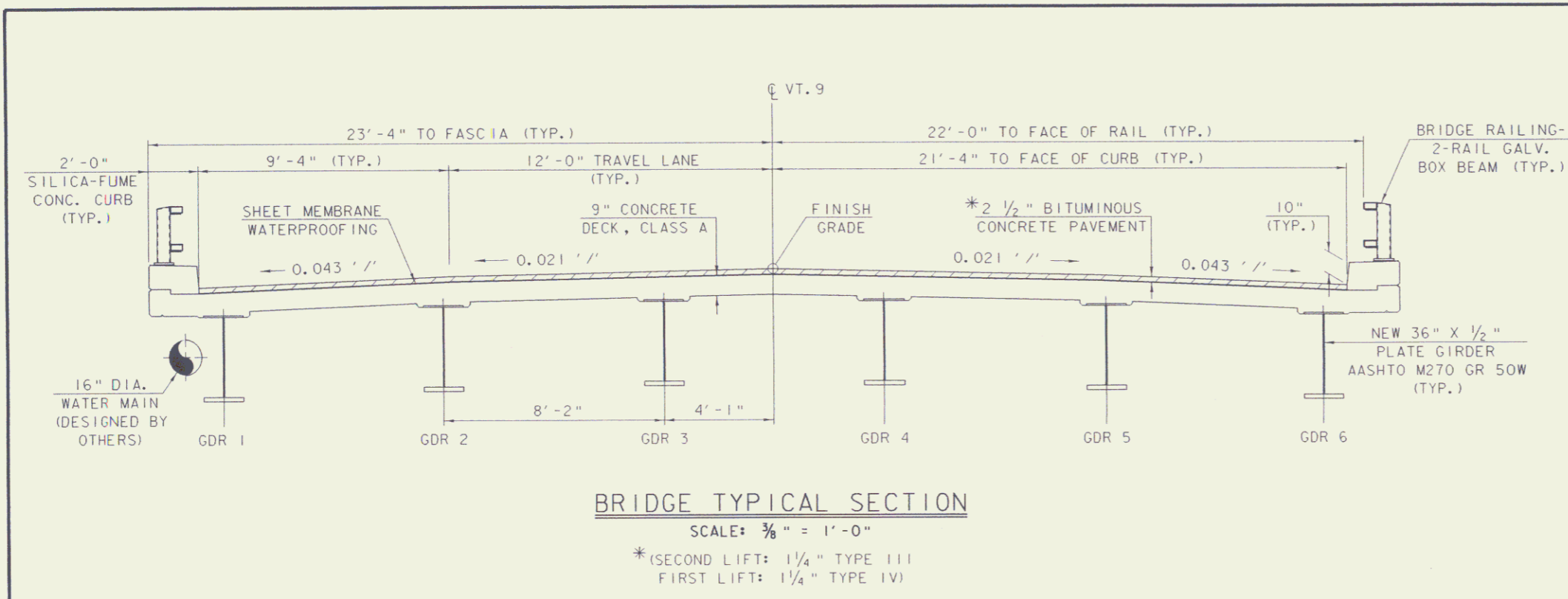

BRIDGE TYPICAL SECTION
SCALE: 3/8" = 1'-0"

*(SECOND LIFT: 1 1/4" TYPE III
FIRST LIFT: 1 1/4" TYPE IV)

NOTES

1. COFFERDAM LIMITS TO BE DETERMINED BY THE CONTRACTOR.
2. FOR PURPOSES OF ESTIMATING EARTHWORK QUANTITIES, THE LIMITS OF COFFERDAM HAVE BEEN ASSUMED TO BE 2'-0" OUTSIDE THE PERIMETER OF THE FOOTING.
3. ONE FOOT UNDERCUT AS DETERMINED NECESSARY BY THE RESIDENT ENGINEER.
4. IF A COFFERDAM IS CONSTRUCTED WHICH IS MORE THAN THE INDICATED MINIMUM DISTANCE OUTSIDE THE FOOTING LIMITS, PAYMENT FOR ALL UNCLASSIFIED CHANNEL EXCAVATION INCLUDING THAT PORTION WHICH IS INSIDE THE COFFERDAM BUT OUTSIDE THE MINIMUM COFFERDAM LIMITS SHOWN WILL BE MADE AT THE CONTRACT UNIT PRICE FOR UNCLASSIFIED CHANNEL EXCAVATION.

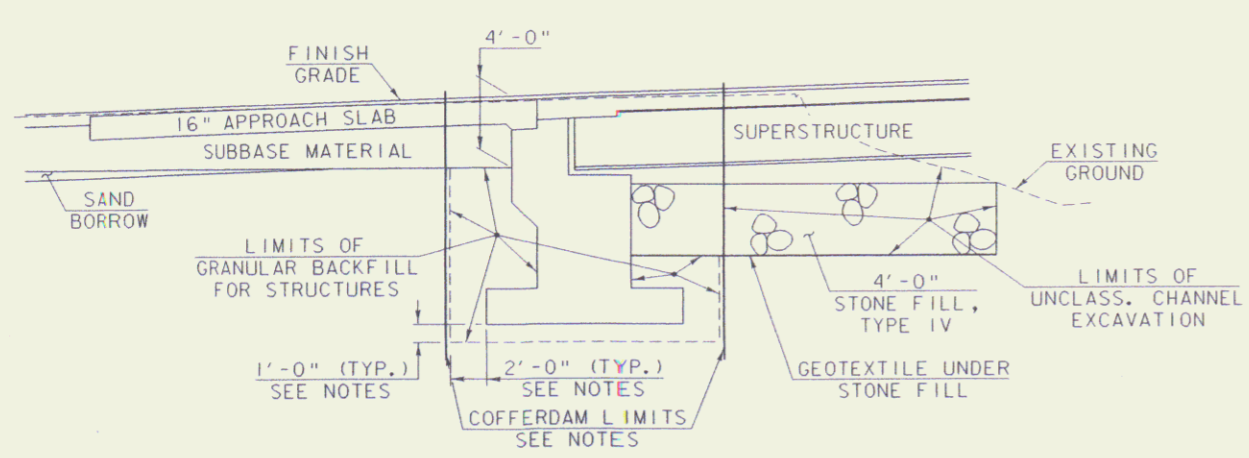

TYPICAL ABUTMENT SECTION
NOT TO SCALE

EXISTING STRUCTURE

1. STRUCTURE TYPE	THREE SPAN STEEL BEAM BRIDGE	OVERALL LENGTH	252 FT	INVENTORY RATING	NA
2. SPAN LENGTH(S) CENTER TO CENTER OF BEARINGS	THREE SPANS: 81'-6" - 81'-11" - 81'-6"				
3. CLEAR SPAN LENGTH(S) NORMAL TO STREAM	THREE SPANS @ 55 FT = 165 FT				
4. WATERWAY AREA OF FULL OPENING (NORMAL TO STREAM)	2000 SQ FT	VERTICAL CLEARANCE ABOVE STREAMBED	11 FT		
5. WATER SURFACE ELEVATION @ Q 2.33	1132.4	WATER SURFACE ELEVATION @ 0.50	1134.5		
6. WATER SURFACE ELEVATION AT FLOOD OF RECORD	NA	YEAR	NA	ESTIMATED DISCHARGE	NA
7. DOES ALL WATER PASS THROUGH EXISTING STRUCTURE? YES IF NOT, AT WHAT FREQUENCY AND ELEVATION DOES RELIEF OCCUR?	N/A				
8. TYPE OF SUBSTRUCTURE FOUNDATION MATERIAL	N/A				
9. DISPOSITION OF STRUCTURE	REHABILITATE				

NEW STRUCTURE

1. STRUCTURE TYPE	THREE SPAN CONTINUOUS PLATE GIRDER BRIDGE	OVERALL LENGTH	279.07 FT
2. SPAN LENGTH(S) CENTER TO CENTER OF BEARINGS	SPAN ONE: 94'-0" SPAN TWO: 84'-0" SPAN THREE: 94'-0"		
3. VERTICAL CLEARANCE ABOVE STREAMBED OR ROAD UNDER	11 FT		
4. CLEAR SPAN LENGTH(S) NORMAL TO STREAM	SPAN ONE: 66'-6" SPAN TWO: 59'-5" SPAN THREE: 66'-6"		
5. WATERWAY AREA OF FULL OPENING (NORMAL TO STREAM)	2150 SQ FT		
6. ARE PROVISIONS TO BE MADE FOR PUBLIC UTILITIES?	YES		

HYDRAULIC DATA:

Q 2.33	2400 CFS	WATER ELEVATION	1132.4	VELOCITY	10.4 FPS
Q 10	4000 CFS	WATER ELEVATION	1133.7	VELOCITY	10.6 FPS
Q 25	5000 CFS	WATER ELEVATION	1134.1	VELOCITY	11.4 FPS
Q 50	6000 CFS	WATER ELEVATION	1134.5	VELOCITY	12.1 FPS
Q 100	7000 CFS	WATER ELEVATION	1134.9	VELOCITY	12.7 FPS

2. DRAINAGE AREA: 37.7 SQ MI CHARACTER OF TERRAIN: HILLY TO MOUNTAINOUS, MOSTLY FORESTED

3. ARE THERE OBJECTIONS TO A PIER IN THE STREAM? YES IS ORDINARY RISE RAPID? YES

4. DOES STREAM REACH ITS MAXIMUM HIGH WATER ELEVATION RAPIDLY? YES IS ORDINARY RISE RAPID? YES

5. NATURE OF NATURAL STREAMBED: WELL ARMORED WITH MEDIUM TO LARGE COBBLES AND BOULDERS

6. ESTIMATED SCOUR DEPTH: 1 FT COMMENT ON: DRIFT MODERATE ICE SLIGHT

7. WILL ALL WATER PASS THROUGH NEW STRUCTURE? YES IF NOT, WHAT FREQUENCY AND ELEVATION WILL RELIEF OCCUR? N/A

8. ADDITIONAL WATERWAY AREA PROVIDED BY RELIEF: N/A

9. VERTICAL CLEARANCE ABOVE O.L.O.: 6.1 FT

10. ALLOWABLE WATER SURFACE ELEVATION: 1141.0 LIMITED BY: BOTTOM OF LOW BEAM ELEVATION

11. IS DESIGN STAGE AFFECTED BY UPSTREAM OR DOWNSTREAM CONDITIONS? NO IF YES, DESCRIBE

12. AVERAGE DAILY FLOW: 80 CFS STREAMBANK OR CHANNEL PROTECTION REQUIRED: STONE FILL, TYPE IV

13. DISTANCE TO EXISTING UPSTREAM STRUCTURE: NA SPAN: NA WATERWAY AREA OF FULL OPENING: NA 0 N/A

14. DISTANCE TO EXISTING DOWNSTREAM STRUCTURE: 1.7 MI SPAN: 209 FT WATERWAY AREA OF FULL OPENING: NA 0 N/A

ALLOWABLE STRESSES:

1. DESIGN LIVE LOAD AASHTO	HS-20-44	ON LEDGE	NA
2. ALLOWABLE LOAD FOR SPREAD FOOTINGS ON SOIL	TYPE	N/A	ESTIMATED LENGTH
3. ALLOWABLE LOAD FOR PILING	N/A	N/A	N/A
4. ALLOWABLE STRESS FOR STRUCTURAL STEEL AASHTO	M270 G50W	TENSION	27000 PSI
5. ALLOWABLE STRESS FOR REINFORCING STEEL GRADE 60 TENSION	24000 PSI	COMPRESSION	20000 PSI
6. ALLOWABLE STRESS FOR CONCRETE CLASS A	f _c 4000 PSI	f _c 1600 PSI	
	CLASS B	f _c 3500 PSI	f _c 1400 PSI
	SILICA-FUME	f _c 5000 PSI	f _c 2000 PSI

TRAFFIC MAINTENANCE:

1. IS TRAFFIC TO BE MAINTAINED? YES IF YES, ON EXISTING STRUCTURE NO OR ON TEMPORARY BRIDGE YES

2. TEMPORARY BRIDGE REQUIREMENTS: ONE OR TWO WAY TWO WAY TRAFFIC CONTROL SIGNALS REQUIRED NA

MINIMUM CLEAR SPAN: 100 FT MINIMUM CLEAR HEIGHT: 8 FT MINIMUM WATERWAY AREA: 800 SQ FT

ARE SIDEWALKS REQUIRED? NO IF SO, ON WHAT SIDE? N/A

NOTE: NA = INFORMATION NOT AVAILABLE N/A = INFORMATION NOT APPLICABLE

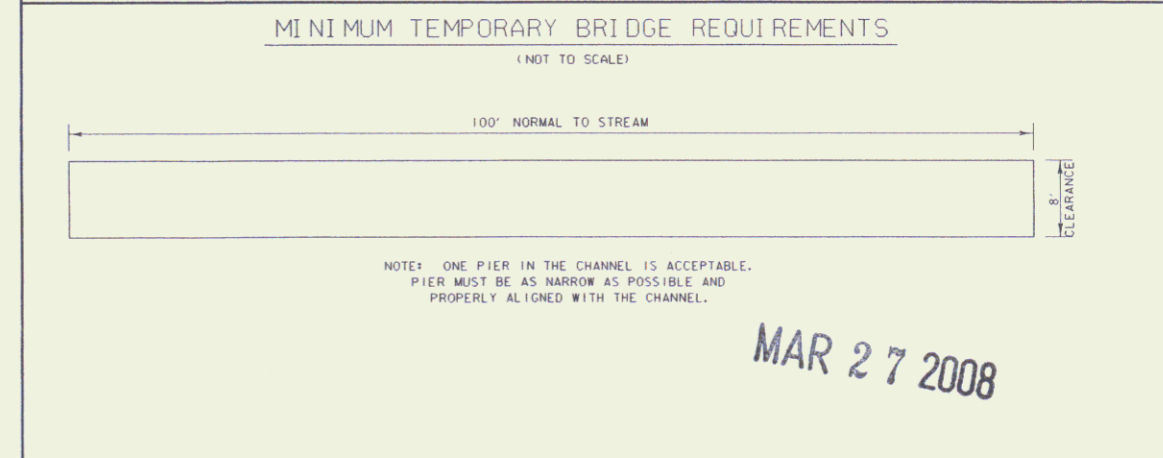

MAR 27 2008

LOAD RATING (TONS)

STRESS LEVELS	TRUCK						
	H	HS	352	6 AXLE	3A, STR.	4A, STR.	5A, SEMI
INVENTORY							
0.55 F _y							
POSTED							
0.67 F _y							
OPERATING							
0.75 F _y							

STATE OF VERMONT
AGENCY OF TRANSPORTATION

Town of **WOODFORD** Bridge No. **11**
Highway No. **VT. 9** Log Sta.
Surv. Sta.

VT. 9 OVER ROARING BRANCH OF WALLOMSAC RIVER

PRELIMINARY INFORMATION

Designed By **T. SCHMELZENBACH** Drawn By **G. ROY**
Checked By **T. SCHMELZENBACH** Bridge Design Supervisor
Date **4/94** J. H. WEAVER Date **4/94**

PROJECT **WOODFORD** PROJECT NO. **BHF 010-M-291**
I.G.C. info. **/proj/846039/ra039pl.dgn** ra039pl

R. O. W. SHEET **6** OF 11 SHEETS

PLOTTED 6 JUN 1997

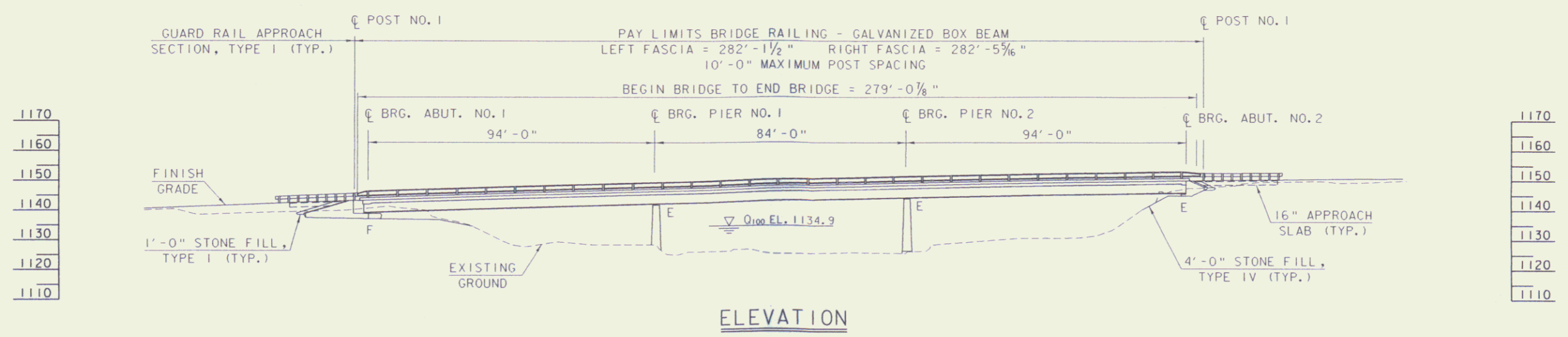
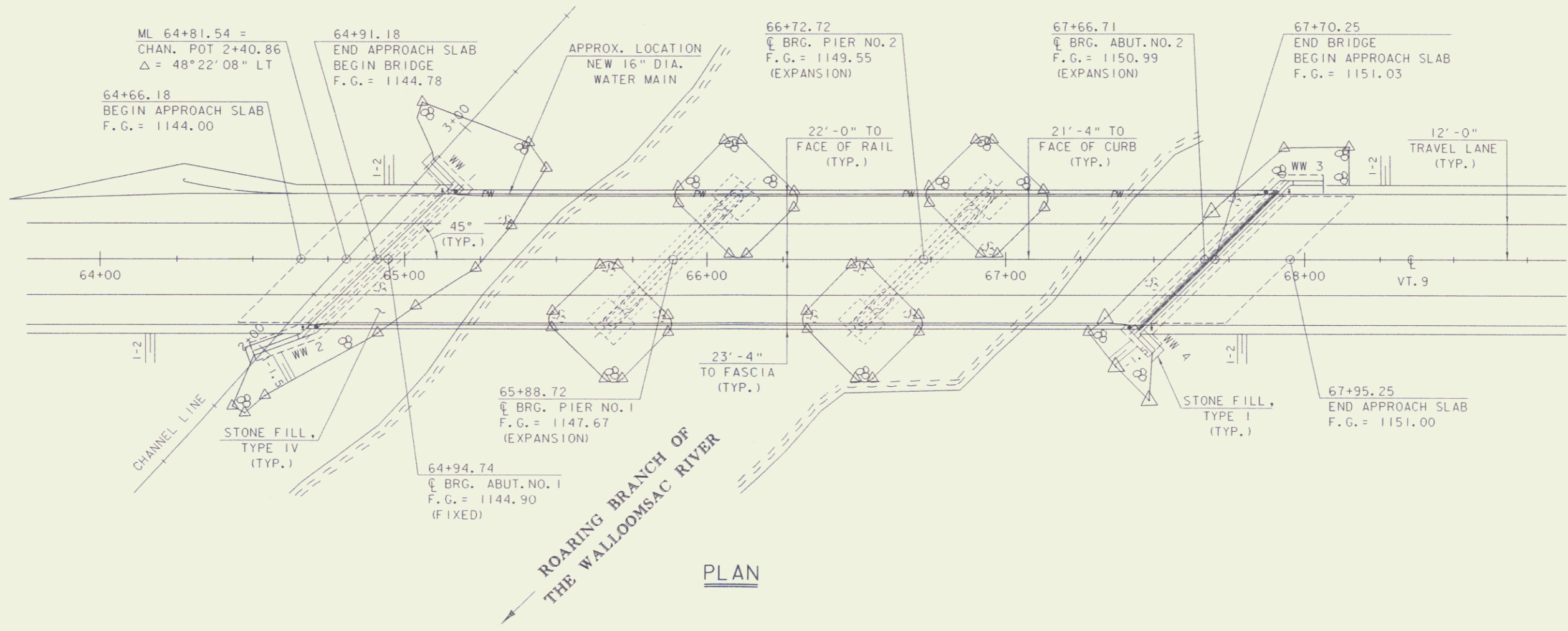

PLAN AND ELEVATION SHEET

DATUM

VERTICAL	NGVD 1929
HORIZONTAL	N/A

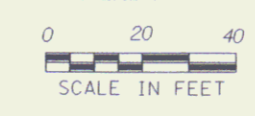

PROJECT: WOODFORD	PROJECT NO.: BHF 010-K29
DESIGN FILE NAME: prop/84e039/re039pe.dgn	PLOT DATE: 6-JUN-1997
IPARM FILE NAME: se039pe.i	SURVEY DATE: 12-88
SURVEYED BY: MOREAU	DRAWN BY: G.ROY
SQUAD LEADER: J.H. WEAVER	R.O.W. SHEET 7 OF 11 SHEETS

MAR 27 2008

MAG 1988

**STATE OF VERMONT
AGENCY OF TRANSPORTATION
RIGHT OF WAY PLANS
DETAIL SHEET**

PARCEL NO.	GRANTOR	SHEET NO.	BEGINNING STATION	ENDING STATION	TAKING	REM.	RIGHTS	TITLE TAKEN	DATE	TOWN OR CITY RECORDED	BK.	PG.	REMARKS	REVISION NO.	SHEET	DESCRIPTION OF REVISION	DATE	MADE BY	APPROVED BY
1	WRIGHT, RONALD F.	9	59+48 RT.										16' GRAVEL MM 0113	1	8,10 11	PARCEL NO. 3 U.S. FOREST SERVICE. DELETE TAKING IN FEE OF 0.56A±. PER C.O. 8968.	05-28-98	M. J. R.	L. W. B.
2	SMITH, PHYLLIS L.	9	61+31 LT.										36' GRAVEL MM 0116	2	8,9	PARCEL NO. 1 WRIGHT. REMOVE THE PROPOSED 86' OPTION PIPE. REMOVE SLOPE (P) AT STA. 61+25 RT. ~ 61+53 RT. REMOVE CUL., DIT. & DR. (P) AT STA. 61+28 RT. CHANGE THE AREA OF CONST. (T) AT STA. 59+58 RT. ~ 64+28 RT. FROM 3590 S.F.± TO 1990 S.F.±. PER C.O. 8994.	09-09-98	M. J. R.	L. W. B.
3	UNITED STATES OF AMERICA U.S. FOREST SERVICE (DEPT. OF AGRICULTURE)	10,11	67+27 RT. 67+64 RT. 69+71 RT. 69+96 RT.	69+29 RT. 69+03 RT. 70+73 RT. 70+76 RT.			CONST. (T) 1640 S.F.± SLOPE (P) 680 S.F.± CONST. (T) 900 S.F.± SLOPE (P) 400 S.F.±							3	8,9	PARCEL NO. 2 SMITH. ADD THE DESIGN OF A 290' OPTION PIPE. CHANGE CULVERT (P) AT STA. 58+94 LT. ~ 58+97 LT. TO STA. 58+94 LT. ~ 59+20 LT. PER C.O. 8995.	09-09-98	M. J. R.	L. W. B.
4	STATE OF VERMONT	11	70+76 RT. 70+69 RT. 70+73 RT. 72+12 RT.	71+70 RT. 71+31 RT. 71+07 RT.	0.06A±			QCD	04-26-99	WOODFORD	33	6&7	2830 S.F.± (FORMERLY TOWN OF BENNINGTON) 21' PAVED MM 0137	4	8,11	PARCEL NO. 4 TOWN OF BENNINGTON. CHANGE OWNER TO STATE OF VERMONT. PER C.O. 9119	05-15-00	S. L. D.	R. P. D.
5	ADVENT CHRISTIAN CHURCH OF WOODFORD (LESSOR) TOWN OF WOODFORD - (LESSEE)	11	71+35 LT. 71+38 LT.	72+76 LT. 72+39 LT.			SLOPE (T) 160 S.F.± CONST. (T) 860 S.F.±							5	1,8 9,10	PARCEL NO. 1 WRIGHT. PROJECT ENVELOPE CHANGED RESULTING IN REDUCTION OF TAKE AND RIGHTS NEEDED. ELIMINATE ALL TAKE AND RIGHTS. LEAVE DRIVE STATIONING AND REMARKS ON DETAIL SHEET. PER C.O. 9146.	09-06-00	S. L. D.	R. P. D.
6	CENTRAL VERMONT PUBLIC SERVICE CORP.												UTILITY	6	1,8 9,10	PARCEL NO. 2 SMITH. PROJECT ENVELOPE CHANGED RESULTING IN NO RIGHTS NEEDED. ELIMINATE ALL RIGHTS. LEAVE DRIVE STATIONING AND REMARKS ON DETAIL SHEET. PER C.O. 9147.	09-06-00	S. L. D.	R. P. D.
7	BELL ATLANTIC - NEW ENGLAND												UTILITY						
8	ADELPHIA CABLE T.V.												UTILITY						
9	TOWN OF BENNINGTON - WATER												UTILITY						

ACCT.mr.yan
IP_PWPsdms06030Vre039d.dgn
DATE PLOTTED 19-MAY-2005

DR. (P)- DRAINAGE RIGHT
DIT. (P)- DITCHING RIGHT
CH. (P)- CHANNEL RT.
DRIVE (T)- DRIVE RIGHT
CUL. (P)- CULVERT RIGHT
[W]- WATER SOURCES

PRESENT R.O.W.
TAKING WITHOUT ACCESS
TAKING WITHOUT ACCESS ALONG PROPERTY LINE
TAKING WITH ACCESS
PERMANENT EASEMENT
TEMPORARY EASEMENT

LEGEND
--- C&T (P) --- CLEARING & TRIMMING
... C&T (P) ... CLEAR ZONE
--- CONST. (T) --- CONSTRUCTION EASEMENT
--- SR --- SLOPE RIGHTS
--- P --- PROPERTY LINE
--- L --- TOP OF CUT
--- O --- TOE OF SLOPE

--- UE (P) --- PERMANENT UTILITY EASEMENT
APPROVED: LAWRENCE W. BLISS DATE: 08-10-97
CHIEF, PLANS & TITLES

R. O. W. PLANS
WOODFORD
BHF 010-1 (29)
R.O.W. SHEET 8 OF 11 SHEETS
SHEET 17 OF 106

MAR 27 2008 8

LINES SHOWN ON THIS PLAN AS EXISTING PROPERTY LINES P/L ARE BELIEVED TO BE ACCURATE BUT SHOULD NOT BE RELIED UPON FOR PURPOSES UNRELATED TO THE STATE OF VERMONT'S ACQUISITION OF LAND AND RIGHTS FOR THIS PROJECT.

**61+75
END APPROACH
BEGIN PROJECT**

**59+00
BEGIN APPROACH**

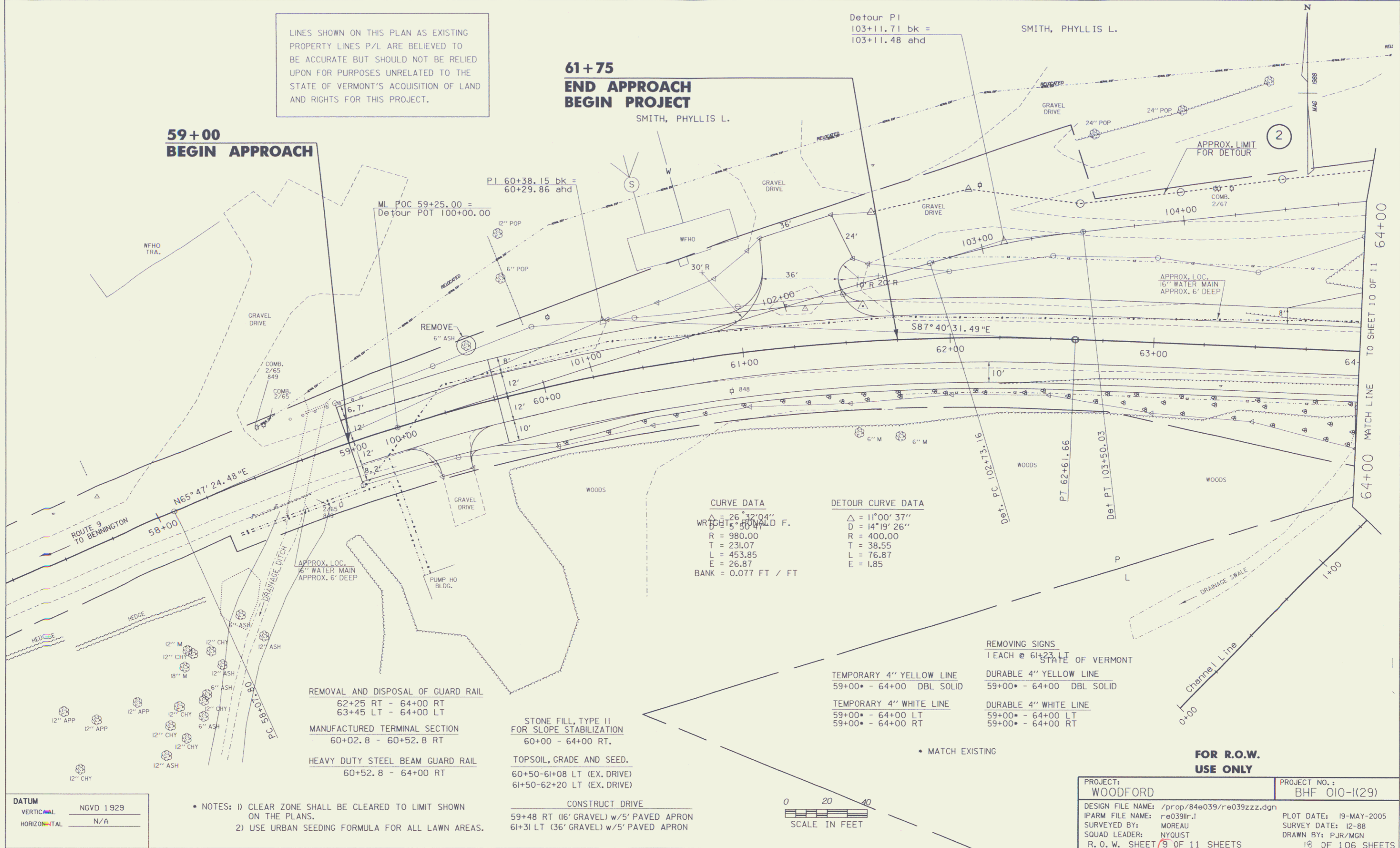

CURVE DATA

WFOH'S DONALD F.

$\Delta = 26^{\circ}32'04''$
 $D = 14^{\circ}19'26''$
 $R = 980.00$
 $T = 231.07$
 $L = 453.85$
 $E = 26.87$
 $BANK = 0.077 \text{ FT / FT}$

DETOUR CURVE DATA

$\Delta = 11^{\circ}00'37''$
 $D = 14^{\circ}19'26''$
 $R = 400.00$
 $T = 38.55$
 $L = 76.87$
 $E = 1.85$

- REMOVAL AND DISPOSAL OF GUARD RAIL
62+25 RT - 64+00 RT
63+45 LT - 64+00 LT
- MANUFACTURED TERMINAL SECTION
60+02.8 - 60+52.8 RT
- HEAVY DUTY STEEL BEAM GUARD RAIL
60+52.8 - 64+00 RT

- STONE FILL, TYPE II FOR SLOPE STABILIZATION
60+00 - 64+00 RT.
- TOPSOIL, GRADE AND SEED.
60+50-61+08 LT (EX. DRIVE)
61+50-62+20 LT (EX. DRIVE)

- CONSTRUCT DRIVE
59+48 RT (16' GRAVEL) w/5' PAVED APRON
61+31 LT (36' GRAVEL) w/5' PAVED APRON

- TEMPORARY 4" YELLOW LINE
59+00* - 64+00 DBL SOLID
- TEMPORARY 4" WHITE LINE
59+00* - 64+00 LT
59+00* - 64+00 RT

- REMOVING SIGNS
1 EACH @ 61+23 LT
STATE OF VERMONT
- DURABLE 4" YELLOW LINE
59+00* - 64+00 DBL SOLID
- DURABLE 4" WHITE LINE
59+00* - 64+00 LT
59+00* - 64+00 RT

DATUM

VERTICAL: NGVD 1929
 HORIZONTAL: N/A

- NOTES: 1) CLEAR ZONE SHALL BE CLEARED TO LIMIT SHOWN ON THE PLANS.
- 2) USE URBAN SEEDING FORMULA FOR ALL LAWN AREAS.

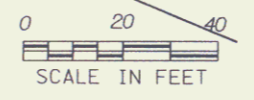

FOR R.O.W. USE ONLY

PROJECT: WOODFORD	PROJECT NO.: BHF 010-K(29)
DESIGN FILE NAME: /prop/84e039/re039zzz.dgn	PLOT DATE: 19-MAY-2005
IPARM FILE NAME: re039lr.l	SURVEY DATE: 12-88
SURVEYED BY: MOREAU	DRAWN BY: PUR/MGN
SQUAD LEADER: NYQUIST	R. O. W. SHEET 9 OF 11 SHEETS

MAR 27 2008

9

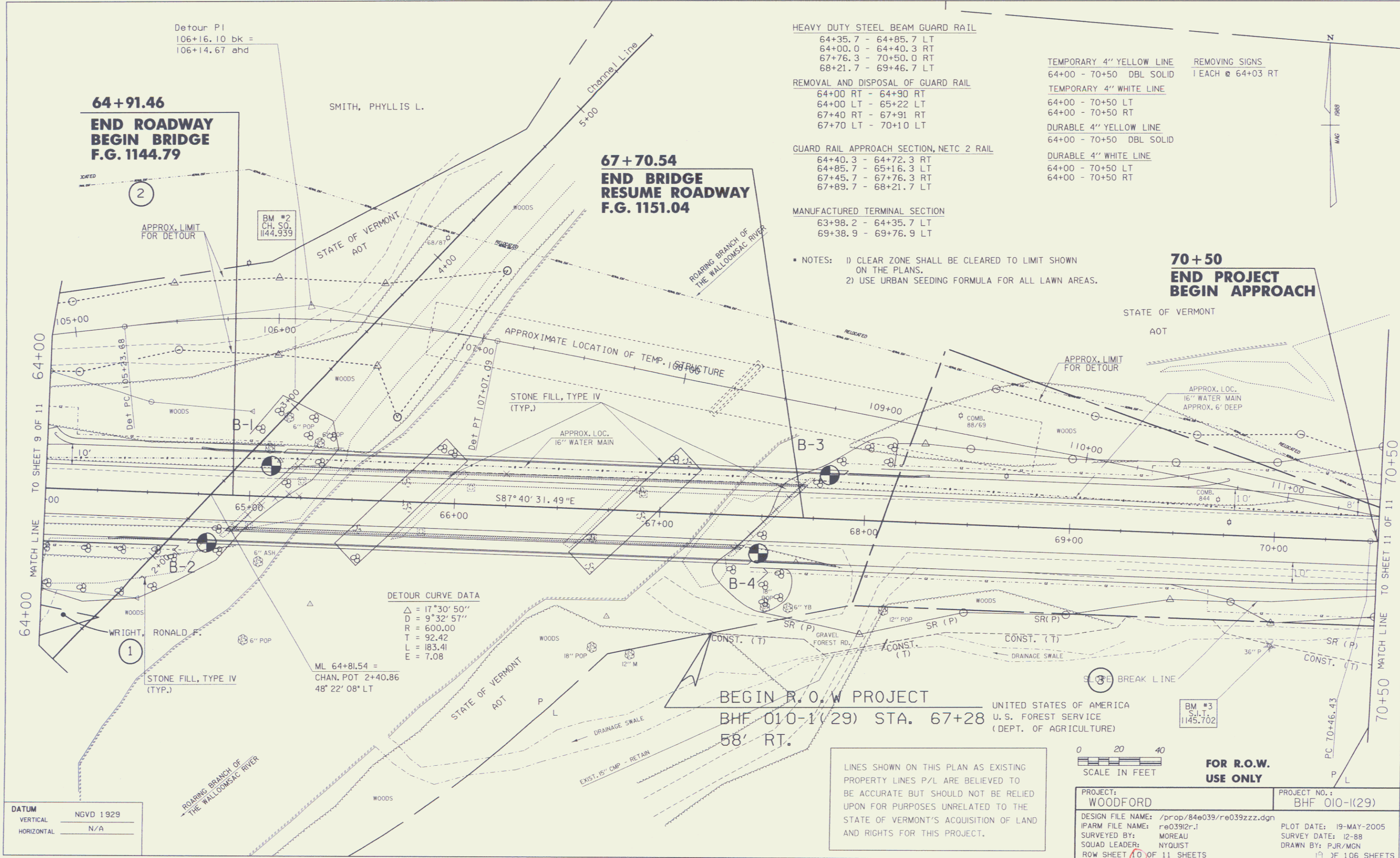

64 + 91.46
END ROADWAY
BEGIN BRIDGE
F.G. 1144.79

67 + 70.54
END BRIDGE
RESUME ROADWAY
F.G. 1151.04

70 + 50
END PROJECT
BEGIN APPROACH

HEAVY DUTY STEEL BEAM GUARD RAIL

- 64+35.7 - 64+85.7 LT
- 64+00.0 - 64+40.3 RT
- 67+76.3 - 70+50.0 RT
- 68+21.7 - 69+46.7 LT

REMOVAL AND DISPOSAL OF GUARD RAIL

- 64+00 RT - 64+90 RT
- 64+00 LT - 65+22 LT
- 67+40 RT - 67+91 RT
- 67+70 LT - 70+10 LT

GUARD RAIL APPROACH SECTION, NETC 2 RAIL

- 64+40.3 - 64+72.3 RT
- 64+85.7 - 65+16.3 LT
- 67+45.7 - 67+76.3 RT
- 67+89.7 - 68+21.7 LT

MANUFACTURED TERMINAL SECTION

- 63+98.2 - 64+35.7 LT
- 69+38.9 - 69+76.9 LT

TEMPORARY 4" YELLOW LINE

64+00 - 70+50 DBL SOLID

TEMPORARY 4" WHITE LINE

64+00 - 70+50 LT

64+00 - 70+50 RT

DURABLE 4" YELLOW LINE

64+00 - 70+50 DBL SOLID

DURABLE 4" WHITE LINE

64+00 - 70+50 LT

64+00 - 70+50 RT

REMOVING SIGNS

1 EACH @ 64+03 RT

- NOTES: 1) CLEAR ZONE SHALL BE CLEARED TO LIMIT SHOWN ON THE PLANS.
 2) USE URBAN SEEDING FORMULA FOR ALL LAWN AREAS.

DETOUR CURVE DATA

- Δ = 17°30'50"
- D = 9°32'57"
- R = 600.00
- T = 92.42
- L = 183.41
- E = 7.08

ML 64+81.54 =
 CHAN. POT 2+40.86
 48' 22" 08" LT

BEGIN R.O.W PROJECT
 BHF 010-1(29) STA. 67+28
 58' RT.

UNITED STATES OF AMERICA
 U.S. FOREST SERVICE
 (DEPT. OF AGRICULTURE)

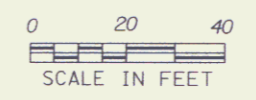

FOR R.O.W. USE ONLY

DATUM	NGVD 1929
VERTICAL	N/A
HORIZONTAL	N/A

PROJECT: WOODFORD	PROJECT NO.: BHF 010-1(29)
DESIGN FILE NAME: /prop/84e039/re0392zz.dgn	PLOT DATE: 19-MAY-2005
IPARM FILE NAME: re0392r.1	SURVEY DATE: 12-88
SURVEYED BY: MOREAU	DRAWN BY: PJR/MGN
SQUAD LEADER: NYQUIST	17 OF 106 SHEETS
ROW SHEET 10 OF 11 SHEETS	

MAR 27 2008

10

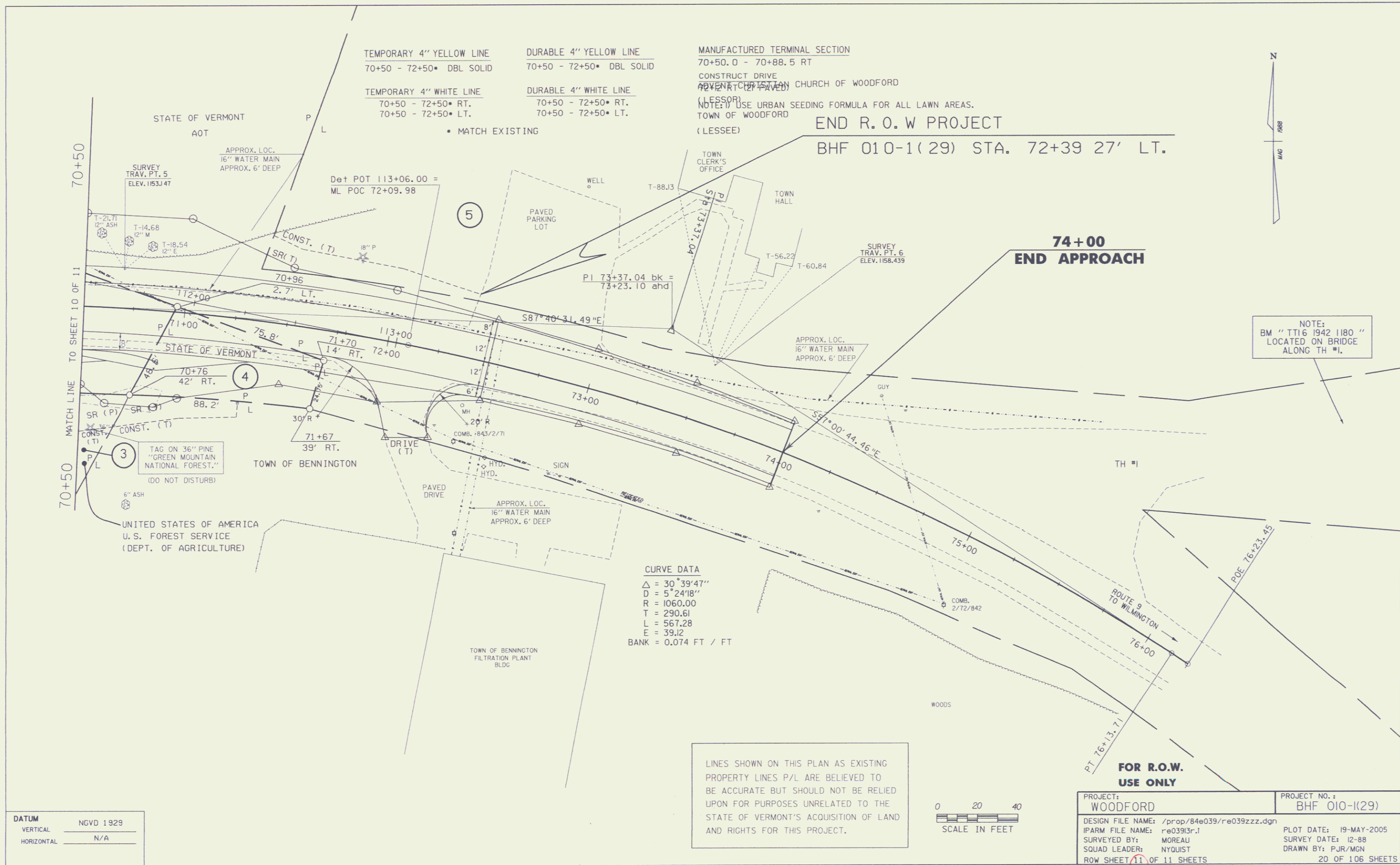

TEMPORARY 4" YELLOW LINE
 70+50 - 72+50 • DBL SOLID
 DURABLE 4" YELLOW LINE
 70+50 - 72+50 • DBL SOLID
 TEMPORARY 4" WHITE LINE
 70+50 - 72+50 • RT.
 70+50 - 72+50 • LT.
 DURABLE 4" WHITE LINE
 70+50 - 72+50 • RT.
 70+50 - 72+50 • LT.

MANUFACTURED TERMINAL SECTION
 70+50.0 - 70+88.5 RT
 CONSTRUCT DRIVE
 CHURCH OF WOODFORD
 (LESSOR)
 (LESSEE)
 NOTE: USE URBAN SEEDING FORMULA FOR ALL LAWN AREAS.
 TOWN OF WOODFORD

END R.O.W PROJECT
BHF 010-1(29) STA. 72+39 27' LT.

74+00
END APPROACH

NOTE:
 BM "TT16 1942 1180"
 LOCATED ON BRIDGE
 ALONG TH #1.

CURVE DATA
 Δ = 30° 39' 47"
 D = 5' 24' 18"
 R = 1060.00
 T = 290.61
 L = 567.28
 E = 39.12
 BANK = 0.074 FT / FT

LINES SHOWN ON THIS PLAN AS EXISTING
 PROPERTY LINES P/L ARE BELIEVED TO
 BE ACCURATE BUT SHOULD NOT BE RELIED
 UPON FOR PURPOSES UNRELATED TO THE
 STATE OF VERMONT'S ACQUISITION OF LAND
 AND RIGHTS FOR THIS PROJECT.

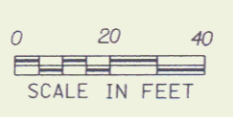

FOR R.O.W.
USE ONLY

DATUM	
VERTICAL	NGVD 1929
HORIZONTAL	N/A

PROJECT: WOODFORD	PROJECT NO. 1: BHF 010-1(29)
DESIGN FILE NAME: /prop/84e039/re039zzz.dgn	PLOT DATE: 19-MAY-2005
IPARM FILE NAME: re03913r.1	SURVEY DATE: 12-88
SURVEYED BY: MOREAU	DRAWN BY: PJR/MGN
SQUAD LEADER: NYQUIST	20 OF 106 SHEETS
ROW SHEET 11 OF 11 SHEETS	

MAR 27 2008

11