

INDEX OF SHEETS  
SEE SHEET 2 of 319  
FOR INDEX OF SHEETS

# STATE OF VERMONT AGENCY OF TRANSPORTATION

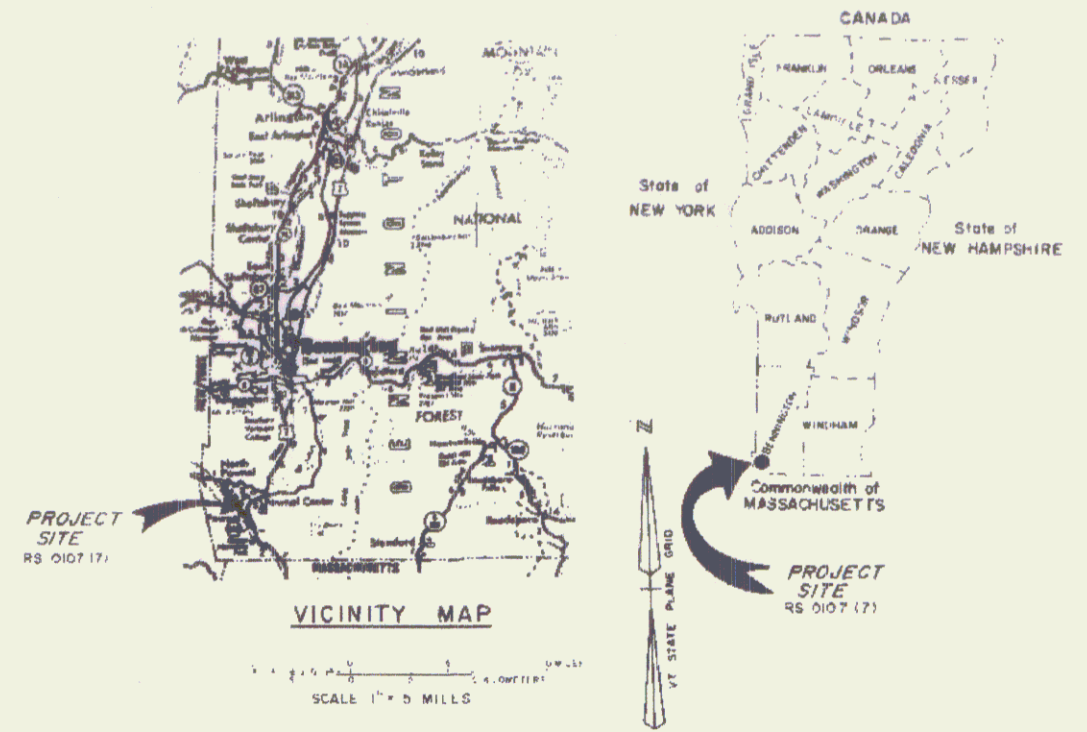

## PROPOSED IMPROVEMENT TOWN OF POWNAL COUNTY of BENNINGTON VT. RT. 346 (F.A.S.)



BEGINNING AT STATION 42+00 ON  
VT. RTE. 346 AND EXTENDING  
NORTH - WESTERLY APPROXIMATELY 3.955 MILES  
PROJECT DESCRIPTION WORK TO BE PERFORMED UNDER  
THIS PROJECT INCLUDES REPLACEMENT OF AN EXISTING  
BRIDGE AND ROADWAY WORK CONSISTING OF GRADING,  
DRAINAGE, SUBBASE, CURBING, PAVEMENT, AND GUARD-  
RAIL ON AN IMPROVED ALIGNMENT AND GRADE  
LENGTH OF ROADWAY 20,822 FEET=3.943 MILES  
LENGTH OF BRIDGE 40.5 FEET=0.008 MILES  
LENGTH OF R.R. CROSSING 20 FEET=0.005 MILES  
LENGTH OF PROJECT 20,862 FEET=3.955 MILES

1990	ADT	- 2190
1990	DHV	- 305
2010	ADT	- 2920
2010	DHV	- 410
	D	- 57%
	T	- 10%
	V	- 50 MPH.*

\* DESIGN SPEED 40 MPH STA. 40+00 - 47+50  
40 MPH STA. 151+00 - 197+00  
35 MPH STA. 197+00 - 207+00

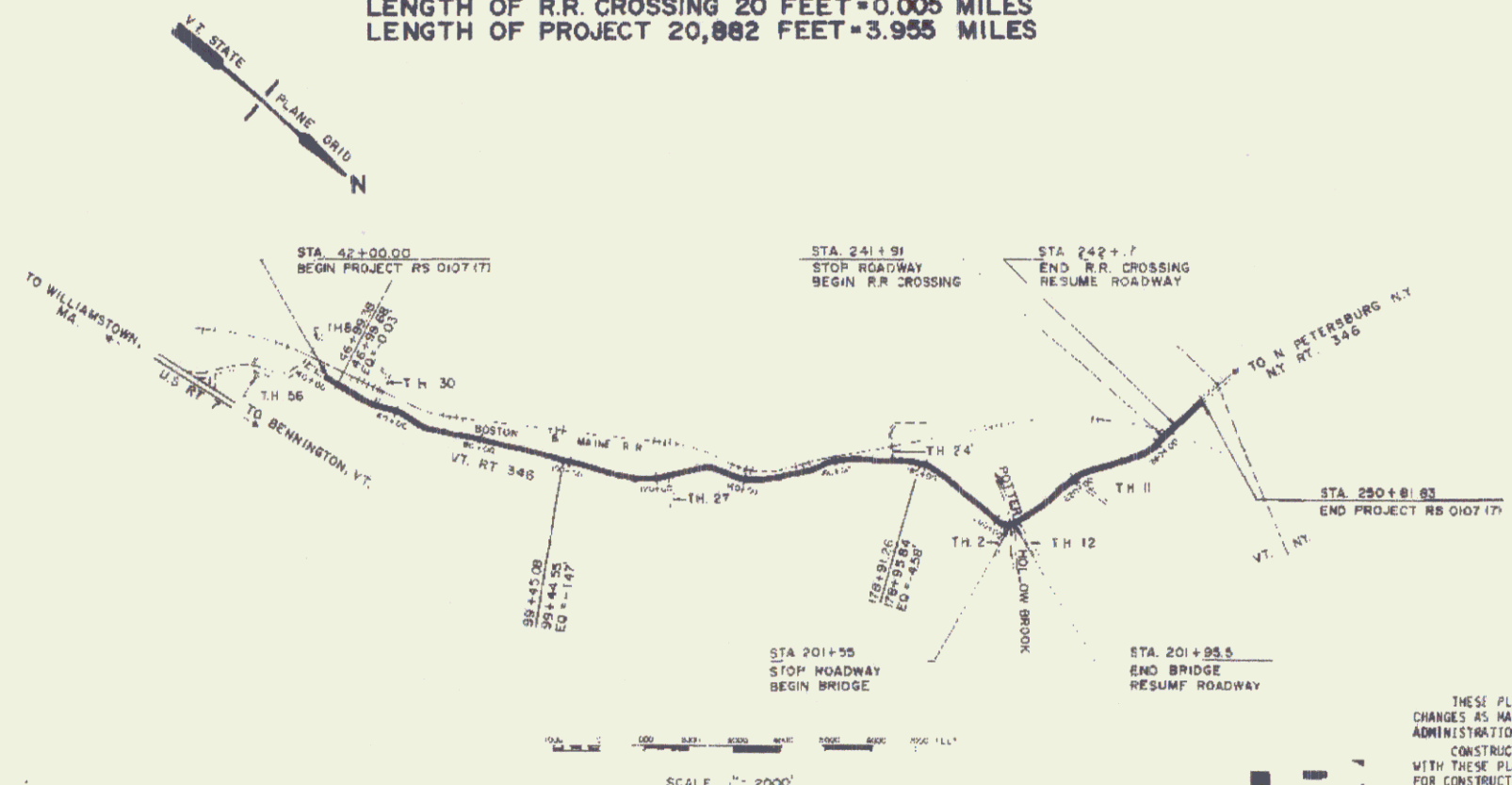

CONVENTIONAL SIGNS

COUNTY LINE	---
TOWN LINE	---
LIMITS OF ACCESS	---
POINT OF ACCESS	X
FENCE LINE	---
STONE WALL	---
TRAVELLED WAY	---
GUARD RAIL EXIST	---
RAILROAD	---
SURVEY LINE	---
CULVERT	---
POWER POLE	○
TELEPHONE POLE	○
TREES	○
CONTROL OF ACCESS	---
PROPERTY LINE	---
ROW TAKING LINE	---
SLOPE RIGHTS	---
TOP OF CUT	---
TOE OF SLOPE	---

CONVENTIONAL SIGNS

PROPOSED GUARDRAIL	---
RETAINING WALL	---
SAW CUT B. MATCH	---
EXISTING BIT. PAVT	---
MAILBOX	---
HYDRANT	---
IRON P.N. FOUND	---
IRON ROD FOUND	---
EXISTING WATER COURSE	---
SILT FENCE	---
BALED HAY	---

DATUM  
VERTICAL NGVD 1929  
HORIZONTAL NAD 1927

SCALE: 1" = 200'

PAPE ENGINEERING CORPORATION  
Engineers - Planners - Landscape Architects  
R. Blackstone Valley Place Lincoln RI 02906  
401-334-4100

THESE PLANS ARE SUBJECT TO SUCH ENGINEERING  
CHANGES AS MAY BE REQUIRED BY THE FEDERAL HIGHWAY  
ADMINISTRATION OR THE CHIEF ENGINEER.  
CONSTRUCTION IS TO BE CARRIED ON IN ACCORDANCE  
WITH THESE PLANS AND THE STANDARD SPECIFICATIONS  
FOR CONSTRUCTION DATED 1986, AS APPROVED BY THE  
FEDERAL HIGHWAY ADMINISTRATION ON NOVEMBER 21, 1986  
FOR USE ON THIS PROJECT, INCLUDING ALL SUBSEQUENT  
REVISIONS AND SUCH REVISED SPECIFICATIONS AND  
SPECIAL PROVISIONS AS ARE INCORPORATED IN  
THESE PLANS.

MP 0.467-0.716  
Pin # 84C808  
Date 1/1/1999

PROJECT PROCESSED UNDER  
SECONDARY ROAD PLAN

SUBMITTED BY ORDER OF THE STATE TRANSPORTATION BOARD

APPROVED: CHIEF ENGINEER DATE \_\_\_\_\_

DEPARTMENT OF TRANSPORTATION  
FEDERAL HIGHWAY ADMINISTRATION

APPROVED: DIVISION ADMINISTRATOR DATE \_\_\_\_\_

PROJECT: POWNAL  
RS-0107(17)

SHEET 1 OF 319 SHEETS

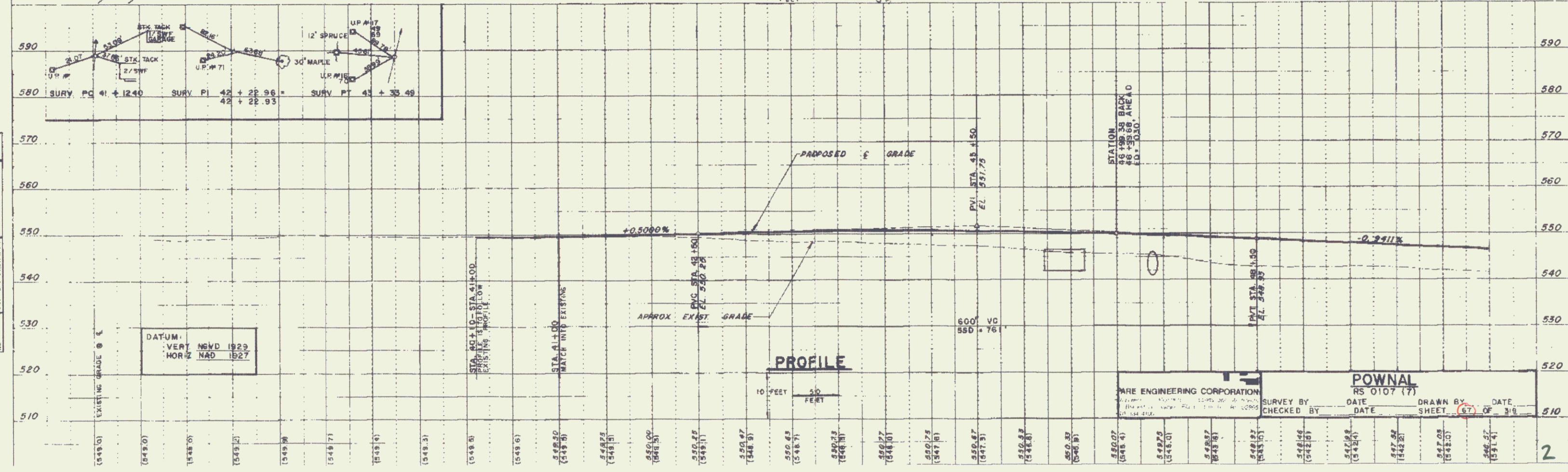
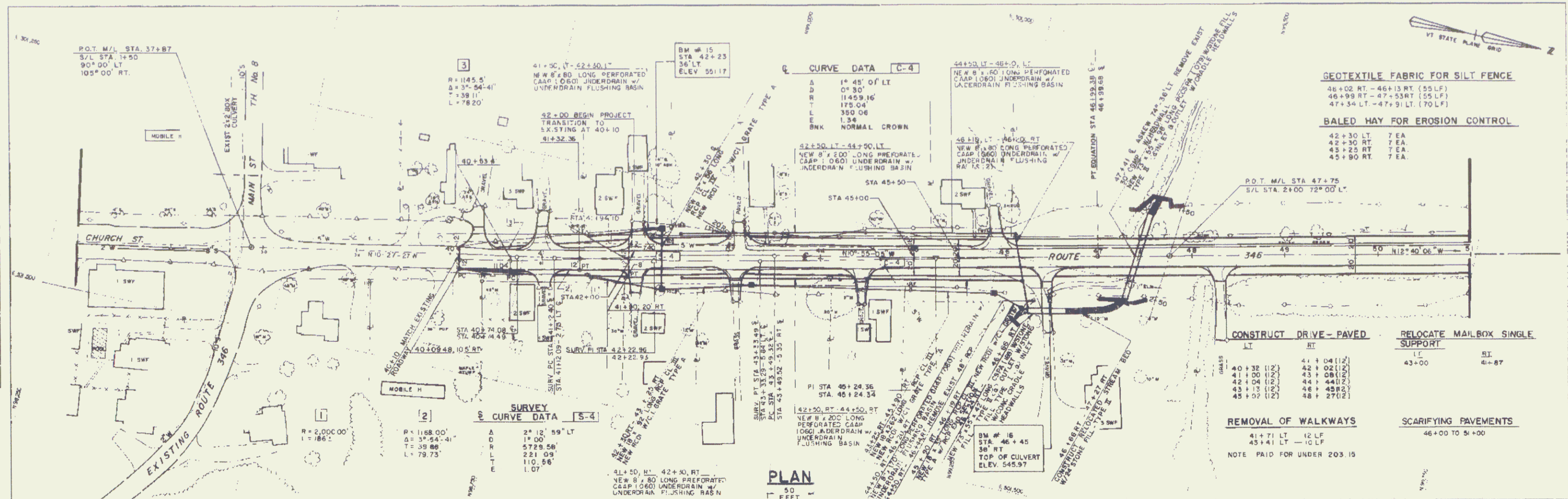

**POWELL ENGINEERING CORPORATION**  
RS 0107 (7)

**SURVEY BY:** DATE  
**CHECKED BY:** DATE

**DRAWN BY:** DATE  
**SHEET 67 OF 318**

**2**