

STATE OF VERMONT
AGENCY OF TRANSPORTATION



PROPOSED IMPROVEMENT
TOWN OF BARTON
COUNTY OF ORLEANS
VT. ROUTE 16, FAS

BEGINNING AT A POINT ON VT. ROUTE 16 APPROXIMATELY 1.437 MILES NORTH OF THE BARTON-GLOVER TOWN LINE AND EXTENDING NORTHERLY 0.303 MILES.

PROJECT CONSISTS OF REPLACEMENT OF SUBBASE, BASE COURSE, DRAINAGE AND PAVEMENT ON EXISTING ALIGNMENT. (REHABILITATION)

LENGTH OF PROJECT 1600.44 FEET = 0.303 MILES.
LENGTH OF ROW PROJECT 1738.00 FEET = 0.329 MILES.

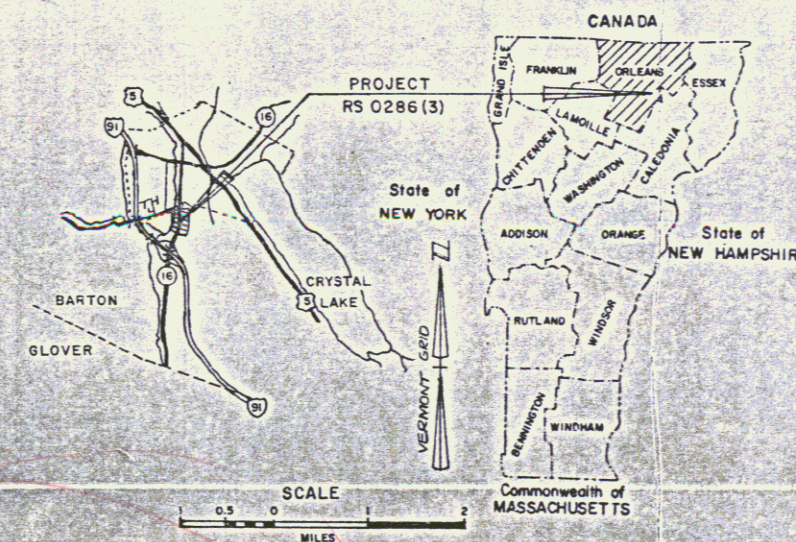

Project RS 0286(3)
Route Vt 16
Date 01/09/1989
P.N.# 83C 085

R.O.W. PLANS

END R.O.W. PROJECT
RS 0286 (3) STA. 38+73 C

BEGIN R.O.W. PROJECT
RS 0286 (3) STA. 21+35 47' RT.

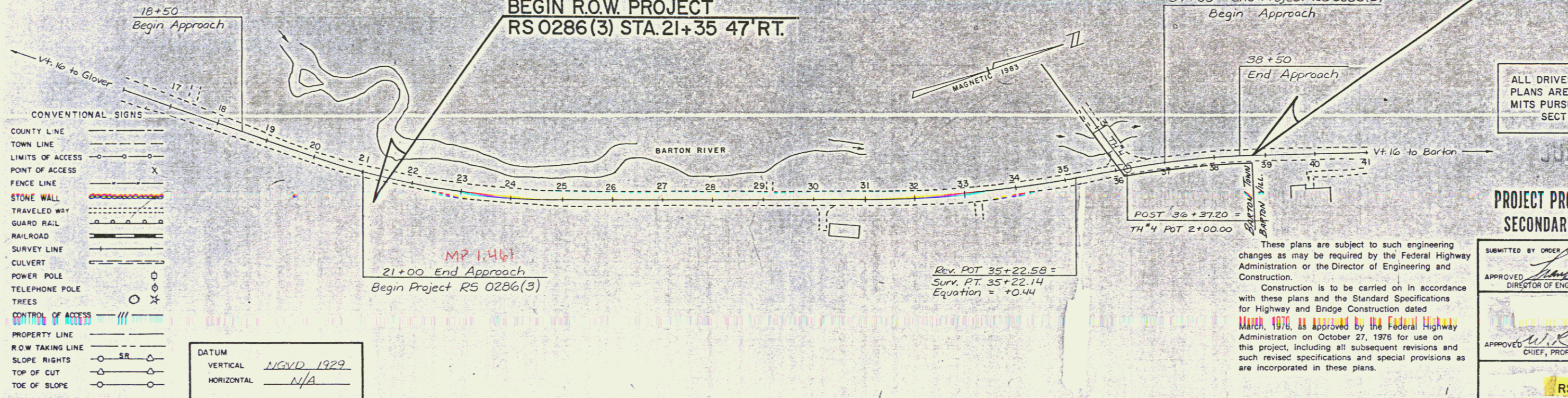

COUNTY LINE	---
TOWN LINE	- - - -
LIMITS OF ACCESS	○
POINT OF ACCESS	X
FENCE LINE	---
STONE WALL	▬▬▬▬▬▬
TRAVELED HWY	▬▬▬▬▬▬
GUARD RAIL	▬▬▬▬▬▬
RAILROAD	▬▬▬▬▬▬
SURVEY LINE	---
CULVERT	▬▬▬▬▬▬
POWER POLE	○
TELEPHONE POLE	○
TREES	○ X
CONTROL OF ACCESS	▬▬▬▬▬▬
PROPERTY LINE	---
ROW TAKING LINE	---
SLOPE RIGHTS	○ SR
TOP OF CUT	○
TOE OF SLOPE	○

DATUM
VERTICAL NGVD 1929
HORIZONTAL N/A

These plans are subject to such engineering changes as may be required by the Federal Highway Administration or the Director of Engineering and Construction.
Construction is to be carried on in accordance with these plans and the Standard Specifications for Highway and Bridge Construction dated March, 1976, as approved by the Federal Highway Administration on October 27, 1976 for use on this project, including all subsequent revisions and such revised specifications and special provisions as are incorporated in these plans.

ALL DRIVES AS INDICATED ON PLANS ARE SUBJECT TO PERMITS PURSUANT TO TITLE 19, SECTION 43, V.S.A.

JUN 07 1989

PROJECT PROCESSED UNDER
SECONDARY ROAD PLAN

SUBMITTED BY ORDER OF THE STATE TRANSPORTATION BOARD
APPROVED *Frank J. Alford* DATE 1-9-89
DIRECTOR OF ENGINEERING AND CONSTRUCTION

APPROVED *W.R. [Signature]* DATE 1-9-89
CHIEF, PROPERTY ADMINISTRATION

BARTON
RS 0286 (3)
1 OF 10