

STATE OF VERMONT AGENCY OF TRANSPORTATION



PROPOSED IMPROVEMENT TOWNS OF WALLINGFORD & MT. HOLLY COUNTY OF RUTLAND VT. RTE. 140 (FAS)



BEGINNING AT A POINT APPROXIMATELY 3.745 MILES EAST-ERLY OF THE US RTE 7 / VT RTE 140 INTERSECTION IN THE TOWN OF WALLINGFORD AND EXTENDING EASTERLY 2.429 MILES TO THE INTERSECTION OF VT RTES 140 & 155N IN THE VILLAGE OF EAST WALLINGFORD.

LENGTH OF PROJECT 12,826.08 FT. 2.429 MILES

WORK TO BE INCLUDED UNDER THIS PROJECT CONSISTS OF LEVELING AND RESURFACING WITH BITUMINOUS CONCRETE OVERLAY, DITCHING, CULVERT REPLACEMENT, WIDENING AND IMPROVING SIGHT DISTANCE AT SPOT LOCATIONS.

END R.O.W PROJECT RS 0138 (8)
STA. 319 + 52 25' LT.

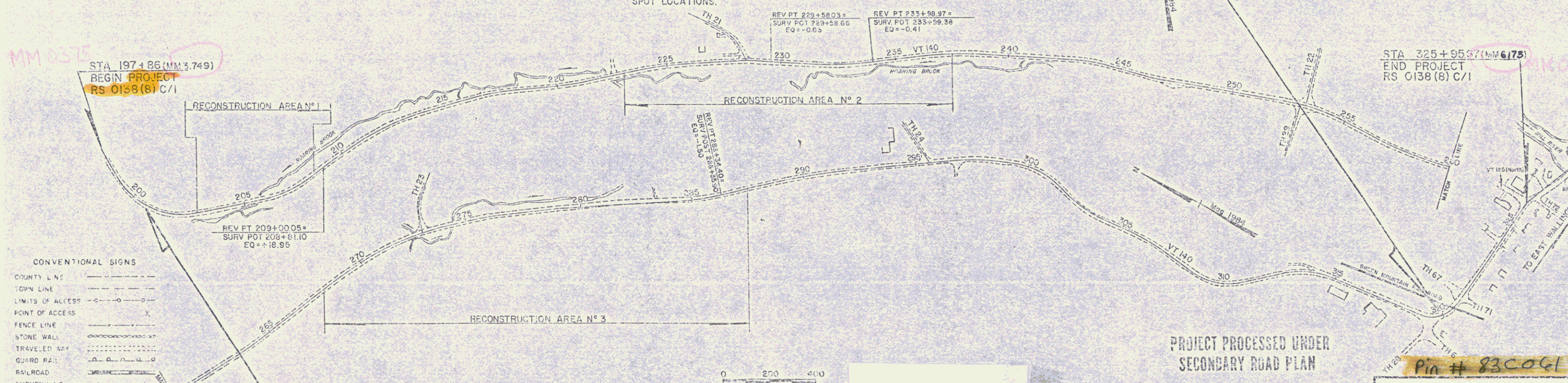

CONVENTIONAL SIGNS

| | |
|-------------------|-----|
| COUNTY LINE | --- |
| TOWN LINE | --- |
| LIMITS OF ACCESS | --- |
| POINT OF ACCESS | X |
| FENCE LINE | --- |
| STONE WALL | --- |
| TRAVELED WAY | --- |
| GUARD RAIL | --- |
| RAILROAD | --- |
| SURVEY LINE | --- |
| CULVERT | --- |
| POWER POLE | --- |
| TELEPHONE POLE | --- |
| TREES | --- |
| CONTROL OF ACCESS | --- |
| PROPERTY LINE | --- |
| ROW TAKING LINE | --- |
| SLOPE RIGHTS | --- |
| TOP OF CUT | --- |
| TOE OF SLOPE | --- |

BEGIN R.O.W. PROJECT RS 0138 (8)
REV. STA. 200 + 52 25' RT.
3.80

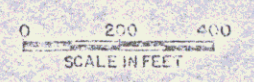

RIGHT-OF-WAY DIVISION
TOWN FILE
PERPETUAL
Towns of Wallingford + Mt. Holly
(To Be Returned To R.O.W. Division)

PROJECT PROCESSED UNDER
SECONDARY ROAD PLAN

THESE PLANS ARE SUBJECT TO SUCH ENGINEERING CHANGES AS MAY BE REQUIRED BY THE FEDERAL HIGHWAY ADMINISTRATION OR THE CHIEF ENGINEER. CONSTRUCTION IS TO BE CARRIED ON IN ACCORDANCE WITH THESE PLANS AND THE STANDARD SPECIFICATIONS FOR CONSTRUCTION DATED 1966, AS APPROVED BY THE FEDERAL HIGHWAY ADMINISTRATION ON NOVEMBER 21, 1965 FOR USE ON THIS PROJECT. INCLUDING ALL SUBSEQUENT REVISIONS AND SUCH REVISED SPECIFICATIONS AND SPECIAL PROVISIONS AS ARE INCORPORATED IN THESE PLANS.

Pin # 83C061

| |
|--|
| APPROVED, <i>[Signature]</i> Date 7/1/87 Director of Engineering & Construction |
| APPROVED, <i>[Signature]</i> Date 7/21/87 Chief, Property Administration |
| WALLINGFORD & MT. HOLLY RS 0138 (8) SHEET 1 OF 22 |

MAR 19 1993

TYPICAL SECTION AT RECONSTRUCTION AREAS

3" Bituminous Concrete Pavement (Item 406.25) (1-1/4" TYPE III over 1-3/4" TYPE II)
 12" Subbase, Crushed Gravel (FINE GRADED) (ITEM 301.26)
 Shoulders: 1-1/4" Bituminous Concrete Pavement (Item 406.25) (TYPE III)
 24" Sand Borrow (Item 203.31)

SEEDING FORMULA, ITEM 651.15 RURAL AREAS

| % WT. | LBS./A. | NAME | PUR % | GERM % |
|--------|---------|------------------------------------|-------|--------|
| 3.33 | 2 | CROWN VETCH | 97 | 75 |
| 50.00 | 30 | CREeping RED FESCUE | 98 | 85 |
| 8.33 | 5 | TIMOTHY | 99 | 85 |
| 16.67 | 10 | PERENNIAL RYE GRASS (VAR. PENNINE) | 95 | 85 |
| 8.33 | 5 | ALFALFA (VAR. SARANAC) | 99 | 85 |
| 8.33 | 5 | BIRDSFOOT TREFOL (VAR. EMPIRE) | 98 | 85 |
| 5.00 | 3 | HIGHLAND BENT GRASS | 92 | 85 |
| 100.00 | 60 | | | |

THE SEED MIXTURE SHALL NOT HAVE A WEED CONTENT EXCEEDING 0.40% BY WEIGHT AND SHALL BE FREE FROM ALL NOXIOUS WEED SEED.

SEEDING FORMULA, ITEM 651.15 URBAN AREAS

| % WT. | LBS./A. | NAME | PUR % | GERM % |
|--------|---------|---------------------|-------|--------|
| 37.50 | 30 | CREeping RED FESCUE | 98 | 85 |
| 31.25 | 25 | KENTUCKY BLUEGRASS | 85 | 75 |
| 31.25 | 25 | PERENNIAL RYE GRASS | 95 | 90 |
| 100.00 | 80 | | | |

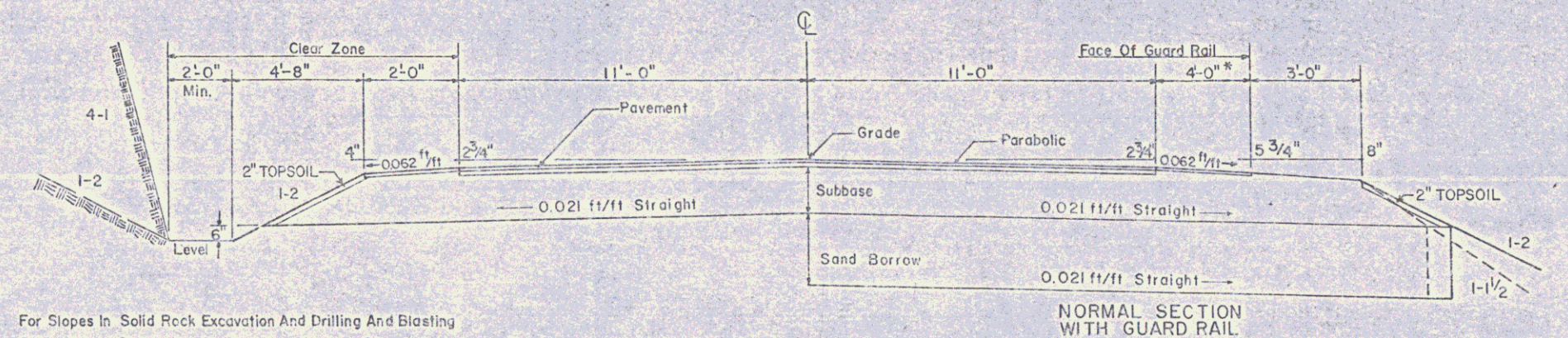
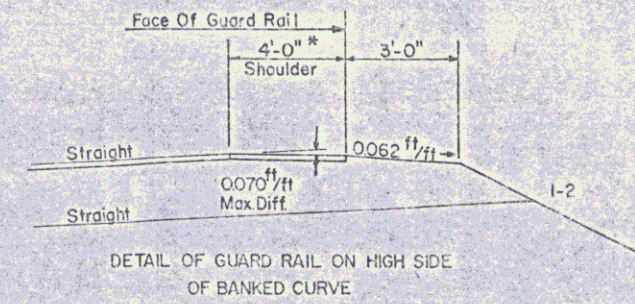
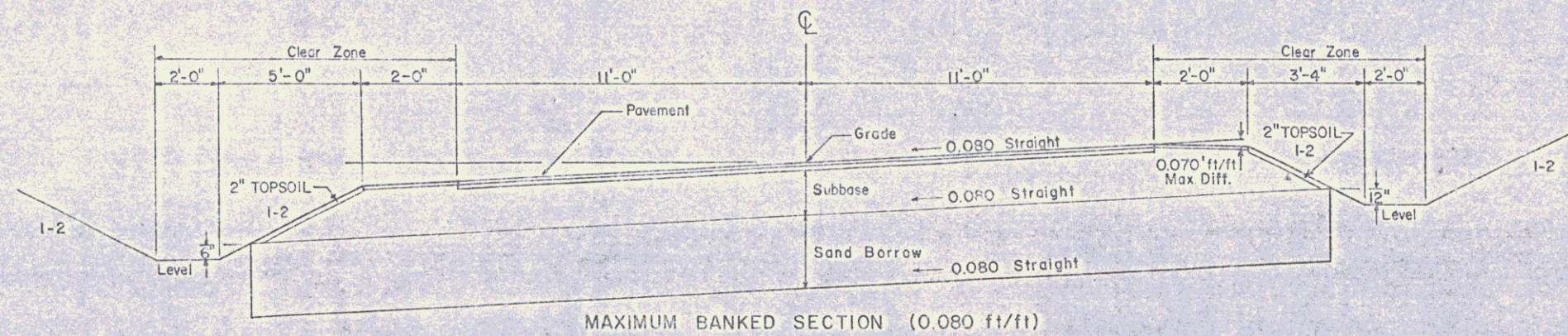
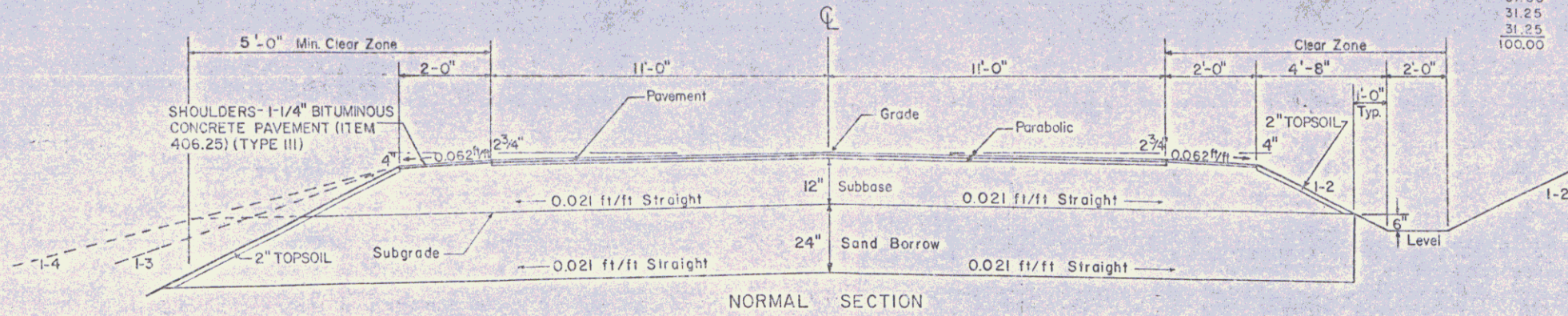
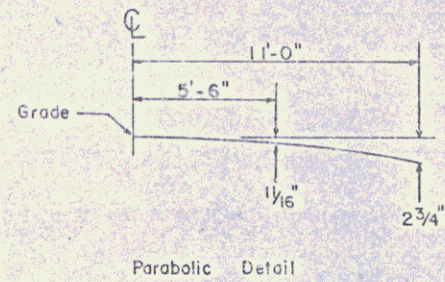

*NOTE: 4'-0" Min. Between Edge of Roadway and Face of Guard Rail, in Locations Where Guard Rail is Used.

For Slopes in Solid Rock Excavation And Drilling And Blasting Of Solid Rock Subgrade, See Standard Sheet A-61.

GENERAL NOTES

- SEED - TO BE APPLIED PER SEEDING FORMULA AS DIRECTED BY THE ENGINEER.
- FERTILIZER - FORMULA 10-20-10 TO BE USED WITH SEED, APPLIED AT THE RATE OF 500 LBS./ACRE.
- AGRICULTURAL LIMESTONE - TO BE APPLIED AT THE RATE OF 2 TONS/ACRE OR AS DIRECTED BY THE ENGINEER.
- HAY MULCH - TO BE PLACED ON EARTH SLOPES AT THE RATE OF 2 TONS/ACRE.
- TOPSOIL - TO BE USED WITH SEED AS INDICATED ON THE PLANS OR AS DIRECTED BY THE ENGINEER.
- MARKER POSTS (WOOD OR STEEL AS SPECIFIED) - TO BE PLACED AS DIRECTED BY THE ENGINEER.
- SLOPE ROUNDING - ALL CUT SLOPES TO BE ROUNDED IN ACCORDANCE WITH STANDARD SHEET B-5.
- PAY LIMITS OF SAND BORROW WHEN USED IN CONJUNCTION WITH UNDERDRAIN - SEE STANDARD SHEET D-2.
- TOP SOIL, ITEM 651.10, TO BE USED WITH SEED, ITEM 651.10 IN RESIDENTIAL AREAS, AS DIRECTED BY THE ENGINEER.

RECONSTRUCTION AREAS

- STA 203+00 - 208+50
 - STA 223+00 - 238+00
 - STA 265+00 - 287+50
- AND/OR AS DIRECTED BY THE ENGINEER.

R.O.W. PLANS

WALLINGFORD & MT. HOLLY
 RS 0138 (8)
 SHEET 2 OF 22

MAR 19 1993

A-22

TYPICAL RESURFACING SECTION

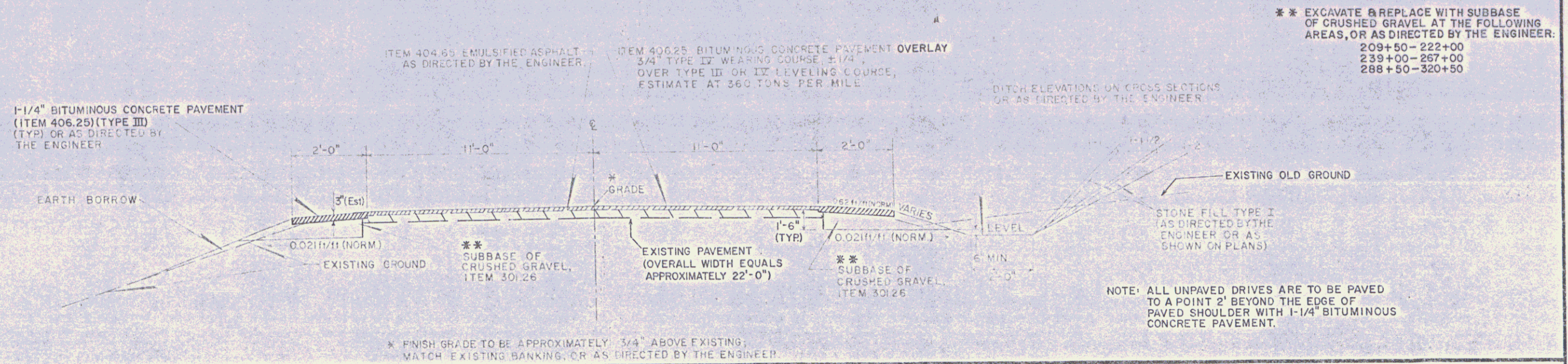

TYPICAL PIPE INSTALLATION DETAIL

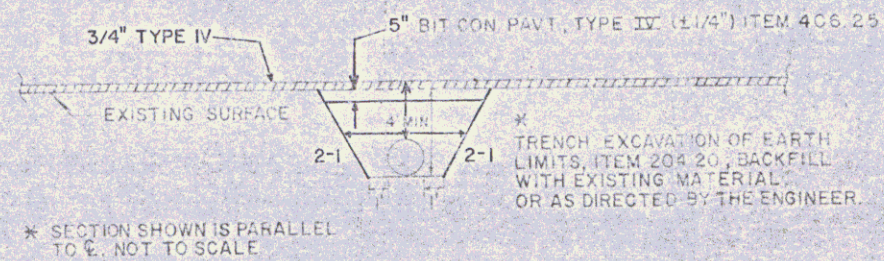

PAVEMENT & SUBBASE TRANSITION DIAGRAM AT RECONSTRUCTION AREAS

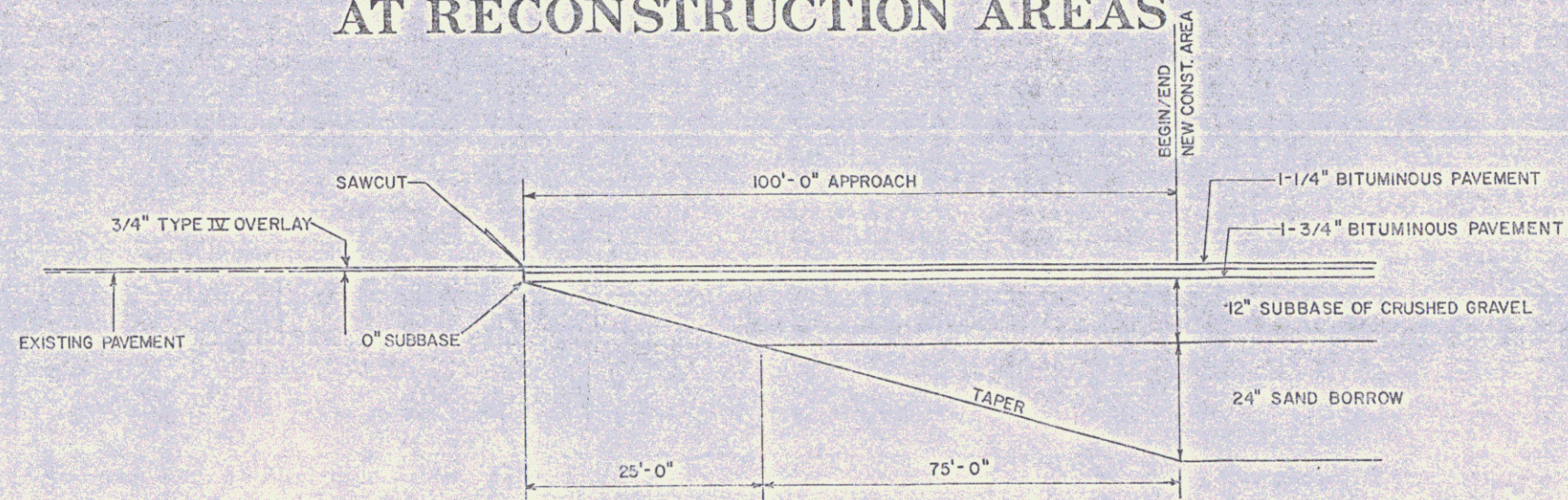

R.O.W. PLANS

WALLINGFORD & MT. HOLLY
RS 0138 (8)
SHEET 3 OF 22

MAR 19 1993 3

STATE OF VERMONT
AGENCY OF TRANSPORTATION
RIGHT OF WAY PLANS
DETAIL SHEET

| PARCEL NO. | GRANTOR | SHEET NO. | BEGINNING STATION | ENDING STATION | TAKING | REM. | RIGHTS | TITLE TAKEN | DATE | TOWN OR CITY RECORDED | BK. | PG. | REMARKS | REVISION NO. | SHEET NO. | DESCRIPTION OF REVISION | DATE | MADE BY | APPROVED BY |
|------------|-----------------------------------|--------------------|---|---|---------|------|--|-------------|---------|-----------------------|-----|------|--|--------------|-------------|---|----------|---------|-------------|
| 1 | WELCH, THOMAS J. & JULIE L. | 10, 11, 12 | REV. 206 + 17 LT. 202 + 72 LT. 203 + 04 LT. 203 + 23 LT. 204 + 20 LT. REV. 205 + 95 LT. REV. 205 + 95 LT. | REV. 209 + 00 LT. 209 + 76 LT. 204 + 04 LT. 209 + 27 LT. REV. 206 + 50 LT. | 0.03 A+ | | CULVERT (P) CONST. EASE. (T) (0.16 A+) SLOPE (P) SLOPE (T) (0.10 A+) CULVERT (P) CHANNEL (P) (0.02 A+) | COND | 7-28-88 | WALLINGFORD | 53 | 44-6 | 1220 S.F. 273 S.F. 1000 S.F. | 1 | 9,22 | Parcel 18 Changed title to ST. of Vt. Lessor Green Mt. RR Lessee Per C.O. # 7039 | 8-21-87 | JOP | LWB |
| 2 | MAEDER, STEPHAN V. & ELIZABETH A. | 10, 11, 12, 13, 15 | REV. 222 + 95 RT. 202 + 10 RT. 202 + 27 RT. 202 + 56 RT. 202 + 76 RT. 204 + 00 RT. 205 + 68 RT. 205 + 90 RT. REV. 208 + 60 RT. REV. 223 + 00 RT. REV. 224 + 30 RT. REV. 225 + 50 RT. | REV. 228 + 40 RT. 222 + 55 RT. 202 + 76 RT. 203 + 50 RT. 206 + 20 RT. REV. 207 + 40 RT. 222 + 15 RT. REV. 228 + 35 RT. REV. 224 + 80 RT. REV. 228 + 40 RT. | 0.07 A+ | | CONST. EASE. (T) (0.44 A+) SLOPE (P) (0.01 A+) CUL. & DR (P) CHANNEL (P) (0.03 A+) CHANNEL (P) (0.09 A+) CULVERT (P) SLOPE (T) (0.01 A+) SLOPE (P) (0.37 A+) CONST. EASE. (T) (0.08 A+) SLOPE (P) (0.02 A+) | COND | 7-28-88 | WALLINGFORD | 53 | 44-6 | 3005 S.F. 697 S.F. 1430 S.F. 4132 S.F. 494 S.F. 3658 S.F. 168 S.F. 840 S.F. | 2 | 22 | Parcel #16 Add sleeves to layout sheets Per C.O. # 6983 | 9-14-87 | JOP | LWB |
| | | | | | | | | | | | | | | 3 | 4 | Parcel # 1 Welch. Add 0.02 A+ AND 1000 S.F. to channel RT. (P) AT STA. REV. 205 + 95 LT. ~ REV. 206 + 50 LT. PER C.O. # 7055 | 9-17-87 | M.J.R. | JOP |
| | | | | | | | | | | | | | | 4 | 18 | Parcel # 14 Add sleeve to water line at Sta. 203+75 E Per C.O. # 7076 | 11-4-87 | M.J.R. | JOP |
| | | | | | | | | | | | | | | 5 | 7,21 | Parcel # 11 Seward. Add Remove & Replace (T) @ STA. 301+10 RT. ~ 301+25 RT. Add NEW UNDERDRAIN CARRIER PIPE @ STA. 301+35 RT. PER C.O. # 7104 | 12-22-87 | M.J.R. | LWB |
| | | | | | | | | | | | | | | 6 | 11,17 | Parcel # 8, 9, Shum Cole. Constructed Drives at STA. 261+25 RT. AND 264+30 RT. so that Adequate access CAN be maintained. Per C.O. # 7096 | 01-19-88 | AST | JOP |
| | | | | | | | | | | | | | | 7 | 11,19,21,22 | Add Drive notes to layout sheets 11, 11, 21, 22, Per C.O. # 7097 | 01-14-88 | AST | JOP |
| 3 | TURGEON, ROBERT J. & RENEE R. | 11, 12 | 210 + 32 LT. 212 + 35 LT. 214 + 75 LT. | 212 + 15 LT. 213 + 55 LT. | | | CONST. EASE. (T) (0.01 A+) DIT. & CULVERT (P) | COND | 7-28-88 | WALLINGFORD | 53 | 44-6 | STONEWALL 600 S.F. | 8 | 6 | Parcel # 8 Shum. PARCEL # 9 Cole. Remove DRIVE (T) from rights. COLLUMN. PER C.O. # 7171 | 1-26-88 | M.J.R. | LWB |
| 4 | KEENER, PHILIP B. | 12, 13 | 215 + 95 LT. 216 + 12 LT. 216 + 45 LT. 216 + 50 LT. | 220 + 50 LT. 216 + 45 LT. 218 + 45 LT. | | | CONST. EASE. (T) (0.09 A+) SLOPE (P) CHANNEL (P) (0.07 A+) DIT. & DR (P) | WD | 4/27/88 | WALLINGFORD | 52 | 367 | 4312 S.F. 225 S.F. 3100 S.F. | 10 | 6 | Parcel no 9 Cole. Added to Detail sheet Culvert (P) at STA 273+00 RT. per C.O. # 7215 | 3-7-88 | AST | LWB |
| 5 | ALLEN, LOUIS G. & JOSEPHINE M. | 13 | 220 + 50 LT. | 222 + 48 LT. | | | CONST. EASE. (T) (0.01 A+) | AGREE | | WALLINGFORD | | | 390 S.F. | 11 | 4,10,12,13 | Parcel # 2 Orouke. Change 1/4 to Maeder, Stephan V. & Elizabeth A. Per C.O. # 7223 | 3-28-88 | MC | LWB |
| | | | | | | | | | | | | | | 12 | 8,21 | Parcel # 15 Seward. Add 6" Underdrain AT STA 304+50 LT. ~ 306+62 LT. per C.O. # 7264 | 4/00/88 | AST | JOP |
| | | | | | | | | | | | | | | 13 | 4,22 | Parcel # 22 Stewart. Create NEW parcel by option only. C.O. # 7306. | 6-28-88 | JOP | JOP |
| | | | | | | | | | | | | | | 14 | 9,22 | Parcel # 18 Green Mt. Railroad. Change Const. Eas. ending STA. to 314+75 LT. Area TO 0.02 A+ Delete SLOPE RIGHTS & ADD DITCH (P) from STA. 314+75 LT. to 320+05 LT. Add New DITCH from 320+20 RT. ~ 320+50 RT. Add CUL(P) 320+05 LT. ~ 320+18 LT. | 6-20-88 | JOP | JOP |

MADE BY: A. JONES DATE 7/23/87
CHECKED BY: M. PROVOST DATE 7/23/87

DR. RT. - DRAINAGE RIGHT
DIT. RT. - DITCHING RIGHT
CH. RT. - CHANNEL RT.
DRIVE RT. - DRIVE RIGHT
CUL. RT. - CULVERT RIGHT
(D) - DEMOLITION OR REMOVAL
(W) - WATER SOURCES

PRESENT R.O.W. TAKING WITHOUT ACCESS
TAKING WITH ACCESS
PERMANENT EASEMENT
TEMPORARY EASEMENT

LEGEND
CONST. EASE. SR SR
P
L
SLOPE RIGHTS
PROPERTY LINE
TOP OF CUT
TOE OF SLOPE

R.O.W. PLANS
APPROVED: DATE: AGENT O. PLANS & TITLES

WALLINGFORD
MT. HOLLY
RS 0138 (8)
SHEET 4 OF 22

MAR 19 1993

STATE OF VERMONT
AGENCY OF TRANSPORTATION
RIGHT OF WAY PLANS
DETAIL SHEET

| PARCEL NO. | GRANTOR | SHEET NO. | BEGINNING STATION | ENDING STATION | TAKING | REM. | RIGHTS | TITLE TAKEN | DATE | TOWN OR CITY RECORDED | BK. | PG. | REMARKS | REVISION NO. | SHEET NO. | DESCRIPTION OF REVISION | DATE | MADE BY | APPROVED BY |
|------------|--|---------------------------|--|--|--------|------|---|-------------|---------|-----------------------|-----|--------|--|--------------|-----------|---|---------|---------|-------------|
| 6 | SMITH, RUSSELL E. | 13, 15 | 222 + 48 LT. 222 + 60 LT. 222 + 82 LT. REV 223 + 65 LT. | REV 225 + 22 LT. REV 223 + 25 LT. REV 225 + 10 LT. | | | CONST. EASE (T) (0.07 A:) SLOPE (P) SLOPE (P) (0.01 A:) | COND | 7-28-88 | WALLINGFORD | 53 | 44-6 | 3005 S.F.: 16' GRAVEL DRIVE MP 0412 106 S.F.: 630 S.F.: | 15 | 9, 22 | MyLARS TO DESIGN 8-10-88 Parcel #22 Stewart Deleted Stewart Joseph C. & Dorothy E. from Project for Co# 7364 | 8-30-88 | ASJ | Luh |
| 7A | JENNINGS, MARY B. JENNINGS, ANNETTE | 13, 14, 15, 16, 17, 19 | REV 228 + 39 RT. REV 228 + 39 RT. 229 + 38 RT. REV 229 + 00 RT. REV 232 + 50 RT. REV 233 + 00 RT. 234 + 00 RT. 234 + 50 RT. 239 + 00 RT. 240 + 80 RT. 241 + 00 RT. 241 + 07 RT. 243 + 50 RT. 246 + 37 RT. 247 + 55 RT. 250 + 60 RT. 252 + 55 RT. 252 + 70 RT. | REV 229 + 58 RT. REV 229 + 50 RT. 252 + 72 RT. 234 + 85 RT. 235 + 00 RT. 241 + 00 RT. 241 + 56 RT. 241 + 00 RT. 241 + 75 RT. 247 + 00 RT. 249 + 50 RT. 252 + 72 RT. | 001 A: | | SLOPE (T) (0.02 A:) CONST. EASE (T) (0.58 A:) CULVERT (P) SLOPE (T) (0.02 A:) CULVERT (P) CHANNEL (P) (0.02 A:) CULVERT (P) CHANNEL (P) (0.18 A:) SLOPE (T) CULVERT (P) DITCH (P) SLOPE (P) (0.05 A:) DIT. & CUL. (P) SLOPE (T) (0.03 A:) SLOPE (P) (0.01 A:) CULVERT (P) INSTALL & MAINT (P) | WD | 4/27/88 | WALLINGFORD | 52 | 508-69 | 171 S.F.: 1020 S.F.: 1070 S.F.: 750 S.F.: 220 S.F.: 2174 S.F.: 1476 S.F.: SIGN | | | | | | |
| 7B | | | REV 228 + 53 LT. REV 228 + 53 LT. 229 + 70 LT. 236 + 00 LT. 236 + 40 LT. 240 + 20 LT. 240 + 80 LT. 241 + 56 LT. 245 + 00 LT. 252 + 67 LT. 251 + 50 LT. | REV 229 + 40 LT. 235 + 65 LT. 234 + 75 LT. 253 + 05 LT. 237 + 75 LT. 241 + 20 LT. 241 + 06 LT. 242 + 36 LT. 249 + 40 LT. 253 + 05 LT. | | | SLOPE (P) (0.01 A:) CONST. EASE (T) (0.17 A:) SLOPE (P) (0.16 A:) CONST. EASE (T) (0.31 A:) SLOPE (P) (0.01 A:) SLOPE (P) (0.01 A:) CHANNEL (P) SLOPE (P) (0.01 A:) SLOPE (P) (0.12 A:) SLOPE (T) | | | | | | 620 S.F.: 7256 S.F.: 6926 S.F.: 13679 S.F.: 609 S.F.: 475 S.F.: 440 S.F.: 5205 S.F.: 204 S.F.: 16' GRAVEL DRIVE MP 0477 | | | | | | |

PARCEL 7C CONTINUED ON NEXT PAGE

MADE BY: A. JONES DATE 7/23/87
CHECKED BY: N. PROVOST DATE 1/23/87

DR. RT. - DRAINAGE RIGHT
DIT. RT. - DITCHING RIGHT
CH. RT. - CHANNEL RT.
DRIVE RT. - DRIVE RIGHT
CUL. RT. - CULVERT RIGHT
(D) - DEMOLITION OR REMOVAL
(W) - WATER SOURCES

PRESENT R.O.W.
TAKING WITHOUT ACCESS

TAKING WITH ACCESS
PERMANENT EASEMENT
TEMPORARY EASEMENT

LEGEND

--- CONST. EASE ---
SR SR SLOPE RIGHTS
P PROPERTY LINE
L TOP OF CUT
O O TOE OF SLOPE

R.O.W. PLANS

APPROVED: Lawrence Blais DATE: 05-88
AGENT D. PLANS & TITLES

WALLINGFORD
MT. HOLLY
RS 0138 (8)
SHEET 5 OF 22

MAR 19 1993

STATE OF VERMONT
AGENCY OF TRANSPORTATION
RIGHT OF WAY PLANS
DETAIL SHEET

| PARCEL NO. | GRANTOR | SHEET NO. | BEGINNING STATION | ENDING STATION | TAKING | REM. | RIGHTS | TITLE TAKEN | DATE | TOWN OR CITY RECORDED | BK. | PG. | REMARKS | REVISION NO. | SHEET NO. | DESCRIPTION OF REVISION | DATE | MADE BY | APPROVED BY | |
|------------|------------------------------|-----------|---|--|---------|------|--|-------------|---------|-----------------------|-----|-------|---|--------------|-----------|-------------------------|------|---------|-------------|--|
| 7C | CONTINUED FROM PREVIOUS PAGE | | 253 +50 LT. 253 +50 LT. 254 +42 LT. 257 +80 LT. 257 +95 LT. 258 +60 LT. 258 +60 LT. 258 +00 LT. 264 +80 LT. 266 +80 LT. 267 +05 LT. REV. 269 +50 LT. REV. 270 +00 LT. REV. 272 +10 LT. REV. 272 +33 LT. REV. 272 +53 LT. | 253 +70 LT. 266 +40 LT. 258 +00 LT. 257 +95 LT. 259 +90 LT. 266 +10 LT. REV. 273 +05 LT. REV. 271 +30 LT. REV. 272 +85 LT. REV. 272 +53 LT. REV. 272 +63 LT. | | | SLOPE (T) CONST. EASE. (T) (0.25 A+) SLOPE (P) (0.07 A+) DITCH (P) CULVERT (P) CHANNEL (P) (0.02 A+) DIT. & CUL. (P) SLOPE (T) (0.07 A+) SLOPE (P) CULVERT & DR. (P) CONST. EASE. (T) (0.15 A+) SLOPE (T) (0.03 A+) CUL. DIT. & DR. (P) (0.01 A+) SLOPE (P) (0.01 A+) CHANNEL (P) CULVERT (P) | | | WALLINGFORD | | | 73 S.F.: 3000 S.F.: 963 S.F.: 3067 S.F.: 390 S.F.: 1185 S.F.: 540 S.F.: 477 S.F.: 330 S.F.: | | | | | | | |
| 7D | | | 253 +30 RT. 253 +30 RT. 257 +00 RT. | 258 +77 RT. 258 +80 RT. 257 +35 RT. | | | SLOPE (P) (0.17 A+) CONST. EASE. (T) (0.13 A+) CHANNEL (P) (143 S.F.) | | | | | | | | | | | | | |
| 8 | SHUM, NORMAN J. & MARIETH | 16,17 | 258 +76 RT. 258 +77 RT. 261 +30 RT. | 263 +75 RT. 263 +75 RT. | | | SLOPE (P) (0.10 A+) CONST. EASE. (T) (0.11 A+) | COND | 7-28-88 | WALLINGFORD | 53 | 44-6 | 20' GRAVEL DRIVE MP 0495 | | | | | | | |
| 9 | COLE, RANDY L. & JANET C | 17,19 | REV. 268 +36 RT. 261 +30 RT. 264 +18 RT. 264 +30 RT. 271 +60 RT. 272 +15 RT. 272 +98 RT. 273 +00 RT. | REV. 273 +60 RT. REV. 273 +90 RT. REV. 273 +80 RT. 271 +70 RT. 272 +90 RT. 274 +20 RT. | 0.08 A+ | | CONST. EASE. (T) (0.23 A+) SLOPE (P) (0.45 A+) INSTALL & MAINT. (P) DITCH (P) (0.01 A+) CHANNEL (P) (0.02 A+) CULVERT (P) | COND | 7-28-88 | WALLINGFORD | 53 | 44-6 | 3650 S.F.: 20' GRAVEL DRIVE MP 0501 GUARD RAIL 400 S.F.: 750 S.F.: | | | | | | | |
| 19 | FAVOR, RICHARD H. & FAYE | 17,19 | REV. 273 +60 LT. REV. 273 +27 LT. REV. 273 +30 LT. REV. 274 +05 LT. REV. 274 +48 LT. REV. 274 +53 LT. | REV. 275 +45 LT. REV. 273 +35 LT. REV. 275 +62 LT. REV. 275 +50 LT. REV. 274 +55 LT. REV. 275 +60 LT. | 0.02 A+ | | SLOPE (P) (45 S.F.:) CONST. EASE. (T) (0.06 A+) SLOPE (P) (0.03 A+) CULVERT (P) CHANNEL (P) (0.08 A+) | WD | 5/05/88 | WALLINGFORD | 52 | 392-3 | 1045 S.F.: 2396 S.F.: 1214 S.F.: 3700 S.F.: | | | | | | | |

MADE BY: A. JONES DATE 7/23/87
CHECKED BY: H. PROVOST DATE 7/23/87

DR. RT. - DRAINAGE RIGHT
DIT. RT. - DITCHING RIGHT
CH. RT. - CHANNEL RT.
DRIVE RT. - DRIVE RIGHT
CUL. RT. - CULVERT RIGHT
(D) - DEMOLITION OR REMOVAL
[W] - WATER SOURCES

PRESENT R.O.W.
TAKING WITHOUT ACCESS

TAKING WITH ACCESS
PERMANENT EASEMENT
TEMPORARY EASEMENT

LEGEND
--- CONST. EASE. ---
SR SR
P
L
- - - - -
SLOPE RIGHTS
PROPERTY LINE
TOP OF CUT
TOE OF SLOPE

LEGEND

--- CONST. EASE. ---
SR SR
P
L
- - - - -
SLOPE RIGHTS
PROPERTY LINE
TOP OF CUT
TOE OF SLOPE

R.O.W. PLANS

APPROVED: *[Signature]* DATE: 7/23/87
AGENT D. PLANS & TITLES

WALLINGFORD
MT. HOLLY
RS 0138 (8)
SHEET 6 OF 22

MAR 19 1993

STATE OF VERMONT
AGENCY OF TRANSPORTATION
RIGHT OF WAY PLANS
DETAIL SHEET

| PARCEL NO. | GRANTOR | SHEET NO. | BEGINNING STATION | ENDING STATION | TAKING | REM. | RIGHTS | TITLE TAKEN | DATE | TOWN OR CITY RECORDED | BK. | Pg. | REMARKS | REVISION NO. | SHEET NO. | DESCRIPTION OF REVISION | DATE | MADE BY | APPROVED BY | | |
|------------|------------------------------|-------------------|--|--|---------|------|--|-------------|---------|-----------------------|-----|--------|--|--------------|-----------|-------------------------|------|---------|-------------|--|--|
| 11 | SEWARD, DOROTHY P. | 17,18,19 20,21 | REV. 278 + 42 RT. REV. 273 + 70 RT. REV. 273 + 85 RT. REV. 274 + 15 RT. REV. 274 + 65 RT. REV. 275 + 55 RT. REV. 281 + 20 RT. REV. 285 + 35 RT. 291 + 50 RT. 296 + 35 RT. 296 + 82 RT. 297 + 27 RT. 301 + 45 RT. 301 + 10 RT. | REV. 286 + 34 RT. REV. 274 + 45 RT. 303 + 05 RT. REV. 274 + 25 RT. REV. 275 + 40 RT. REV. 280 + 33 RT. REV. 283 + 75 RT. 295 + 30 RT. 295 + 45 RT. 296 + 70 RT. 302 + 43 RT. 301 + 25 RT. | 0.11 A± | | CHANNEL (P) (0.04 A±) CONST. EASE (T) (0.69 A±) CULVERT (P) SLOPE (T) (0.01 A±) SLOPE (T) (0.08 A±) SLOPE (P) (0.04 A±) SLOPE (P) (0.32 A±) SLOPE (P) SLOPE (P) (0.16 A±) ALL R.T. & I. REMOVE & REPLACE (T) | WDOE | 4/27/88 | WALLINGFORD | 52 | 365-66 | 4751 S.F.± 1900 S.F.± 420 S.F.± 3658 S.F.± 1668 S.F.± STONEWALL 95 S.F.± 16' PAVED DRIVE MP0563 DRY WELL CELLAR DRAIN | | | | | | | | |
| 12 | PERRY, F.W. | 17,18,19 20 | REV. 275 + 42 LT. REV. 275 + 42 LT. REV. 275 + 50 LT. REV. 275 + 50 LT. REV. 276 + 68 LT. REV. 276 + 78 LT. REV. 278 + 00 LT. REV. 278 + 42 LT. REV. 279 + 00 LT. REV. 281 + 75 LT. | REV. 278 + 42 LT. REV. 275 + 87 LT. REV. 280 + 00 LT. REV. 275 + 75 LT. REV. 278 + 00 LT. REV. 277 + 32 LT. REV. 278 + 98 LT. REV. 279 + 60 LT. | 0.05 A± | | SLOPE (P) CONST. EASE (T) (0.11 A±) CHANNEL (P) (0.01 A±) SLOPE (T) CHANNEL (P) (0.02 A±) CULVERT & DR. (P) SLOPE (T) SLOPE (P) DITCH (P) | COND | 7-28-88 | WALLINGFORD | 53 | 44-6 | 2337 S.F.± 378 S.F.± 618 S.F.± 340 S.F.± 825 S.F.± 165 S.F.± 172 S.F.± | | | | | | | | |
| 13 | CHURCH, KENNETH E. & VERA L. | 18,20 | REV. 281 + 75 LT. REV. 282 + 39 RT. REV. 283 + 38 LT. REV. 283 + 90 LT. REV. 284 + 17 LT. REV. 284 + 52 LT. | REV. 282 + 75 LT. 286 + 50 LT. 296 + 60 LT. | | | DITCH (P) ALL R.T. & I. CONST. EASE. (T) (0.06 A±) SLOPE (T) (0.17 A±) CUL.DIT. & DR (P) | WDOE | 8-26-88 | WALLINGFORD | 53 | 77-78 | WATERLINE 12' GRAVEL DRIVE MP0537 2430 S.F.± | | | | | | | | |
| 14 | SEWARD, JOHN B. | 18,20,21 | 286 + 48 LT. 286 + 50 LT. 286 + 98 LT. 289 + 13 LT. 289 + 60 LT. 293 + 75 LT. 293 + 75 LT. | 290 + 05 LT. 288 + 83 LT. 269 + 88 LT. 293 + 75 RT. | | | CONST. EASE. (T) (0.08 A±) SLOPE (T) (0.12 A±) CUL. DIT. & DR. (P) SLOPE (T) (0.02 A±) CUL. DIT. & DR (P) ALL R.T. & I. | WD | 6-24-88 | WALLINGFORD | 52 | 512 | 3500 S.F.± 776 S.F.± WATERLINE 20' PAVED DRIVE MP 0557 | | | | | | | | |

MADE BY: A. JONES DATE 7/28/87
CHECKED BY: N. PROVOST DATE 7/28/87

DR. RT. - DRAINAGE RIGHT
DIT. RT. - DITCHING RIGHT
CH. RT. - CHANNEL RT.
DRIVE RT. - DRIVE RIGHT
CUL. RT. - CULVERT RIGHT
(D) - DEMOLITION OR REMOVAL
(W) - WATER SOURCES

PRESENT R.O.W.
TAKING WITHOUT ACCESS

TAKING WITH ACCESS
PERMANENT EASEMENT
TEMPORARY EASEMENT

LEGEND

--- CONST. EASE ---
SR SR
P P
- - - SLOPE RIGHTS
- - - PROPERTY LINE
- - - TOP OF CUT
- - - TOE OF SLOPE

R.O.W. PLANS

APPROVED: [Signature] DATE: 8-5-87
AGENT D. PLANS & TITLES

WALLINGFORD
MT. HOLLY
RS 0138 (8)
SHEET 7 OF 22

MAR 19 1993

STATE OF VERMONT
AGENCY OF TRANSPORTATION
RIGHT OF WAY PLANS
DETAIL SHEET

| PARCEL NO. | GRANTOR | SHEET NO. | BEGINNING STATION | ENDING STATION | TAKING | REM. | RIGHTS | TITLE TAKEN | DATE | TOWN OR CITY RECORDED | BK. | PG. | REMARKS | REVISION NO. | SHEET NO. | DESCRIPTION OF REVISION | DATE | MADE BY | APPROVED BY | |
|------------|---|-----------|--|--|--------|------|--|-------------|---------|-----------------------|-----|------|---|--------------|-----------|-------------------------|------|---------|-------------|--|
| 15A | SEWARD, LOWELL W. | 21, 22 | 295 + 65 LT. 300 + 70 LT. 304 + 19 LT. 304 + 52 LT. 306 + 56 LT. 306 + 68 LT. 308 + 50 LT. 309 + 00 LT. 304 + 50 LT. | 309 + 65 LT. 307 + 75 LT. 306 + 68 LT. 309 + 65 LT. 309 + 80 LT. 306 + 62 LT. | | | CONST. EASE. (T) (0.26 A±) CUL. DIT. & DR (P) SLOPE (T) (0.28 A±) DITCH (P) CUL. & DR. (P) SLOPE (T) (0.01 A±) INSTALL (T) | COND | 7-28-88 | WALLINGFORD | 53 | 44-6 | 12' GRAVEL DRIVE MP 0570 STONEWALL 475 S.F.± 6" UNDERDRAIN (BY OPTION ONLY) | | | | | | | |
| 15B | | | 303 + 05 RT. 304 + 20 RT. 304 + 30 RT. 308 + 58 RT. | 311 + 68 RT. 307 + 80 RT. 311 + 86 RT. | | | CONST. EASE. (T) (0.17 A±) SLOPE (P) (0.15 A±) | | | | | | STONEWALL 12' GRAVEL DRIVE MP 0585 | | | | | | | |
| 15C | | | 317 + 74 RT. 317 + 74 RT. 319 + 16 RT | 318 + 78 RT. 318 + 27 RT. | | | CONST. EASE. (T) (0.02 A±) SLOPE (P) INSTALL & MAINT. (P) | | | | | | 900 S.F.± 200 S.F.± SIGN | | | | | | | |
| 16A | SEWARD, ROLAND O., ESTATE SEWARD, THOMAS, ADMIN. | 22 | 309 + 65 LT. 309 + 65 LT. 310 + 08 LT. 310 + 20 LT. 311 + 87 RT. 313 + 20 LT. 314 + 15 LT. | 314 + 15 LT. 312 + 75 LT. 310 + 20 LT. 312 + 15 LT. 313 + 87 RT | | | CONST. EASE. (T) (0.10 A±) SLOPE (P) (0.10 A±) CUL. & DIT. (P) DRAINAGE (P) | COND | 7-28-88 | WALLINGFORD | 53 | 44-6 | SEWAGE LINE SEWAGE LINE 12' GRAVEL DRIVE MP 0595 | | | | | | | |
| 16B | | | 311 + 55 RT. 311 + 70 RT. 316 + 25 RT. 316 + 56 RT. 317 + 25 RT. 317 + 60 RT. | 314 + 83 RT. 314 + 83 RT. 317 + 71 RT. 317 + 71 RT | | | CONST. EASE. (T) (0.07 A±) SLOPE (P) (0.08 A±) CONST. EASE. (T) (0.02 A±) SLOPE (P) | | | | | | 2900 S.F.± 3400 S.F.± 40' PAVED DRIVE MP 0699 815 S.F.± 40' PAVED DRIVE MP 0601 15 S.F.± | | | | | | | |
| 17 | MOUNT MARIAH LODGE NO. 96 F & AM | 22 | 314 + 83 RT. 314 + 83 RT. | 314 + 88 RT. 315 + 00 RT. | | | SLOPE (P) CONST. EASE. (T) | COND | 7-28-88 | WALLINGFORD | 53 | 44-6 | 10 S.F.± 150 S.F.± | | | | | | | |

MADE BY: A. JONES DATE 7/29/87
CHECKED BY: N. PROVOST DATE 7/29/87

DR. RT. - DRAINAGE RIGHT
DIT. RT. - DITCHING RIGHT
CH. RT. - CHANNEL RT.
DRIVE RT. - DRIVE RIGHT
CUL. RT. - CULVERT RIGHT
(D) - DEMOLITION OR REMOVAL
(W) - WATER SOURCES

PRESENT R.O.W.
TAKING WITHOUT ACCESS

TAKING WITH ACCESS
PERMANENT EASEMENT
TEMPORARY EASEMENT

LEGEND
CONST. EASE.
SR SR
P
L
TOP OF CUT
TOE OF SLOPE

R.O.W. PLANS

APPROVED: *[Signature]* DATE: 8-5-87
AGENT D. PLANS & TITLES

WALLINGFORD
MT. HOLLY
RS 0138 (8)
SHEET 8 OF 22

MAR 19 1993

STATE OF VERMONT
AGENCY OF TRANSPORTATION
RIGHT OF WAY PLANS
DETAIL SHEET

| PARCEL NO. | GRANTOR | SHEET NO. | BEGINNING STATION | ENDING STATION | TAKING | REM. | RIGHTS | TITLE TAKEN | DATE | TOWN OR CITY RECORDED | BK. | PG. | REMARKS | REVISION NO. | SHEET NO. | DESCRIPTION OF REVISION | DATE | MADE BY | APPROVED BY | |
|------------|--|-------------------|--|--|--------|------|--|-------------|---------|-----------------------|-----|-----|--|--------------|-----------|-------------------------|------|---------|-------------|--|
| 18 | STATE OF VERMONT LESSOR GREEN MOUNTAIN RAILROAD LESSEE | 22 | 313 + 82 LT. 314 + 75 LT. 316 + 60 LT. 320 + 05 LT. 320 + 20 RT. | 314 + 75 LT. 320 + 05 LT. 317 + 00 LT. 320 + 83 LT. 320 + 50 RT. | | | CONST. EASE. (T) (0.02A±) DITCH (P) CULVERT (P) DITCH (P) | QCDOE | | WALLINGFORD | | | 800 S.F.± CHAIN LINK FENCE | | | | | | | |
| 19A | TOWN OF WALLINGFORD | 13,16,17 21,22 | 228 + 42 LT. | | | | CONST. APPROACH (T) | Q.C.D. | 5/05/88 | | 52 | 389 | TOWN HIGHWAY NO.21 | | | | | | | |
| 19B | | | 253 + 01 RT. | | | | CONST. APPROACH (T) | | | | | | TOWN HIGHWAY NO.29 | | | | | | | |
| 19C | | | 253 + 24 LT. | | | | CONST. APPROACH (T) | | | | | | TOWN HIGHWAY NO.22 | | | | | | | |
| 19D | | | REV. 272 + 95 LT. | | | | CONST. APPROACH (T) | | | | | | TOWN HIGHWAY NO.23 | | | | | | | |
| 19E | | | 295 + 97 LT. | | | | CONST. APPROACH (T) | | | | | | TOWN HIGHWAY NO.24 | | | | | | | |
| 19F | | | 319 + 40 RT. | | | | CONST. APPROACH (T) | | | | | | TOWN HIGHWAY NO.28 | | | | | | | |
| 20 | CENTRAL VERMONT PUBLIC SERVICE CORP | | | | | | | | | | | | UTILITY | | | | | | | |
| 21 | CONTINENTAL TELEPHONE & TELEGRAPH | | | | | | | | | | | | UTILITY | | | | | | | |
| 22 | DELETED | 22 | | | | | | | | | | | FORMELY STEWART, JOSEPH C. & DOROTHY E. | | | | | | | |

MADE BY: A. JONES DATE 7/29/87
CHECKED BY: N. PROVOST DATE 7/29/87

DR. RT.- DRAINAGE RIGHT
DIT. RT.- DITCHING RIGHT
CH. RT.- CHANNEL RT.
DRIVE RT.- DRIVE RIGHT
CUL. RT.- CULVERT RIGHT
ⓓ- DEMOLITION OR REMOVAL
☒- WATER SOURCES

PRESENT R.O.W.
TAKING WITHOUT ACCESS

TAKING WITH ACCESS
PERMANENT EASEMENT
TEMPORARY EASEMENT

LEGEND
--- CONST. EASE ---
SR SR SLOPE RIGHTS
P PROPERTY LINE
L TOP OF CUT
O O TOE OF SLOPE

R.O.W. PLANS
APPROVED: [Signature] DATE: 8-1-87
AGENT D. PLANS & TITLES

WALLINGFORD
MT. HOLLY
RS 0138 (8)
SHEET 9 OF 22

UNCLASSIFIED CHANNEL EXCAVATION
 Rev Lt Rev Rt Rev
 205+95 ~ 206+50 204+00 ~ 206+20
 216+45 ~ 218+30

STEEL BEAM GUARD RAIL
 Rev Lt Rev Rt Rev
 204+00 ~ 206+75 204+00 ~ 206+25

SCARIFYING PAVEMENT
 REV. 204+00 ~ 207+50

STONE FILL TYPE II
 Rev Lt Rev Rt Rev
 205+95 ~ 206+50 204+00 ~ 206+20
 216+45 ~ 218+30

BREAKAWAY CABLE TERMINAL
 Rev Lt Rev Rt Rev
 206+75 ~ 207+00 206+25 ~ 206+50

EROSION MATTING
 Rev Lt Rev Rt Rev
 205+75 ~ Surv 214+00 218+00 ~ 219+00

STONE FILL TYPE I
 Rev Lt Rev Rt Rev
 212+00 ~ 213+50

REV CURVE #1
 Δ 21°14'59"
 D 730' LT
 R 763.94'
 T 143.31'
 L 283.33'
 E 13.33'
 Bank 0.080 F/S

WELCH, THOMAS J. & JULIE L.
 Surv
 Curve #1
 Δ 2°40'52" 30' LT
 D 12°00'
 R 477.47'
 T 105.31'
 L 207.29'
 E 11.48'

3.71' Channel Sp.
 Elev. 1324.32

TURGEON, ROBERT & RENE

KEENER, PHILIP

MAEDER, STEPHAN V. & ELIZABETH A.

REV 208+50
 END RECONSTRUCTION
 AREA #1

TEMP. 4" WHITE LINE
 204+00 ~ 219+00, 11' LT.
 204+00 ~ 219+00, 11' RT.

TEMP. 4" YELLOW LINE
 204+00 ~ 219+00 (Dbl.)

DATUM
 VERTICAL NGVD 1929
 HORIZONTAL N/A

0 50 100
 SCALE IN FEET

R.O.W. PLANS
 REV 204+00 - SURV 219+00

WALLINGFORD - MT. HOLLY
 RS 0138 (3)
 SHEET 12 OF 22

MAR 19 1993

12

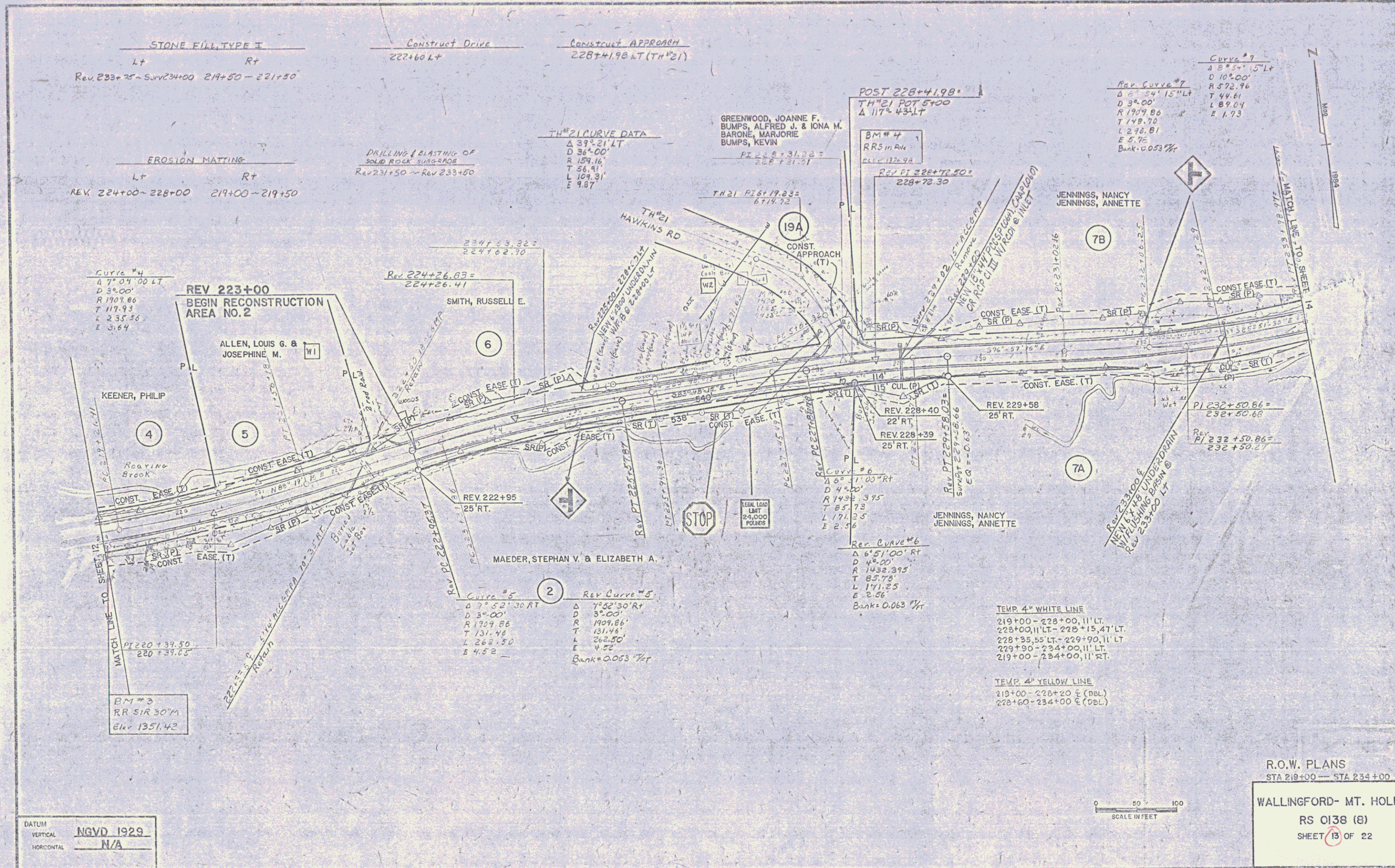

STONE FILL TYPE I
 Lt Rt
 Rev 233+25 - SURV 234+00 219+50 - 221+50

Construct Drive
 222+60 Lt
 Construct Approach
 228+41.98 Lt (TH#21)

EROSION MATTING
 Lt Rt
 REV. 224+00 - 228+00 219+00 - 219+50

DRILLING & BLASTING OF
 SOLID ROCK SURGRADE
 Rev 231+50 - Rev 233+50

TH#21 CURVE DATA
 Δ 39° 21' LT
 D 36° 00'
 R 159.16'
 T 56.41'
 L 104.31'
 E 9.87'

Curve #7
 Δ 5° 51' 15" LT
 D 10° 00'
 R 372.96'
 T 44.61'
 L 87.04'
 E 1.73'
 Bank = 0.053 %

Curve #4
 Δ 7° 31' 00" LT
 D 3° 00'
 R 1909.86'
 T 117.93'
 L 235.56'
 E 3.64'

REV 223+00
 BEGIN RECONSTRUCTION
 AREA NO. 2

Rev 224+26.67 =
 224+26.41

POST 228+41.98 =
 TH#21 POT 5+00
 Δ 117° 43' LT

GREENWOOD, JOANNE F.
 BUMPS, ALFRED J. & IONA M.
 BARONE, MARJORIE
 BUMPS, KEVIN
 PT 228+31.32 =
 228+31.01

TH#21 PI 6+19.23 =
 6+14.72

JENNINGS, NANCY
 JENNINGS, ANNETTE

ALLEN, LOUIS G. &
 JOSEPHINE M.

SMITH, RUSSELL E.

KEENER, PHILIP

REV. 222+95 =
 25 RT.

Rev. Curve #6
 Δ 6° 51' 00" RT
 D 4° 00'
 R 1432.395'
 T 85.75'
 L 171.25'
 E 2.56'
 Bank = 0.063 %

TEMP. 4" WHITE LINE
 219+00 - 228+00, 11' LT.
 228+00, 11' LT - 228+15.47' LT.
 228+35.55' LT - 229+90, 11' LT
 229+90 - 234+00, 11' LT.
 219+00 - 234+00, 11' RT.

TEMP. 4" YELLOW LINE
 219+00 - 228+20 E (DBL)
 228+60 - 234+00 E (DBL)

Curve #5
 Δ 7° 52' 30" RT
 D 3° 00'
 R 1729.86'
 T 131.46'
 L 262.50'
 E 4.52'

Rev Curve #5
 Δ 7° 52' 30" RT
 D 3° 00'
 R 1909.86'
 T 131.46'
 L 262.50'
 E 4.52'
 Bank = 0.053 %

BM #3
 RR SIR 30' M
 Elev. 1351.42

DATUM
 VERTICAL NGVD 1929
 HORIZONTAL N/A

0 50 100
 SCALE IN FEET

R.O.W. PLANS
 STA 219+00 - STA 234+00
 WALLINGFORD- MT. HOLLY
 RS 0138 (8)
 SHEET 13 OF 22

MAR 19 1993

STONE FILL TYPE II
 LT R1
 234+00 ~ 234+60
 246+00 ~ 247+20

EROSION MATTING
 RT
 246+40 ~ 247+75

SPECIAL DITCH (COMMON EXCAVATION)
 RT
 241+07 ~ 241+75

UNCLASSIFIED CHANNEL EXCAVATION
 LT RT
 240+80 ~ 241+06
 234+00 ~ 235+00
 239+00 ~ 241+00

STONE FILL TYPE II
 LT RT
 240+80 ~ 241+06
 234+00 ~ 235+00
 239+00 ~ 241+00

CURVE #10
 46°01'30" LT
 D 66.00'
 R 594.93'
 T 51.09'
 L 102.78'
 E 4.37'

JENNINGS, NANCY
 JENNINGS, ANNETTE

377+0
 RRS/R 2-6-78
 Elev 1392.78

STA 238+00
 END RECONSTRUCTION
 AREA NO. 2

7B

7A

JENNINGS, NANCY
 JENNINGS, ANNETTE

DATUM
 VERTICAL NGVD 1929
 HORIZONTAL N/A

0 50 100
 SCALE IN FEET

R.O.W. PLANS
 STA 234+00 - STA 248+00

WALLINGFORD- MT. HOLLY
 RS 0138 (8)
 SHEET 14 OF 22

MAR 19 1993

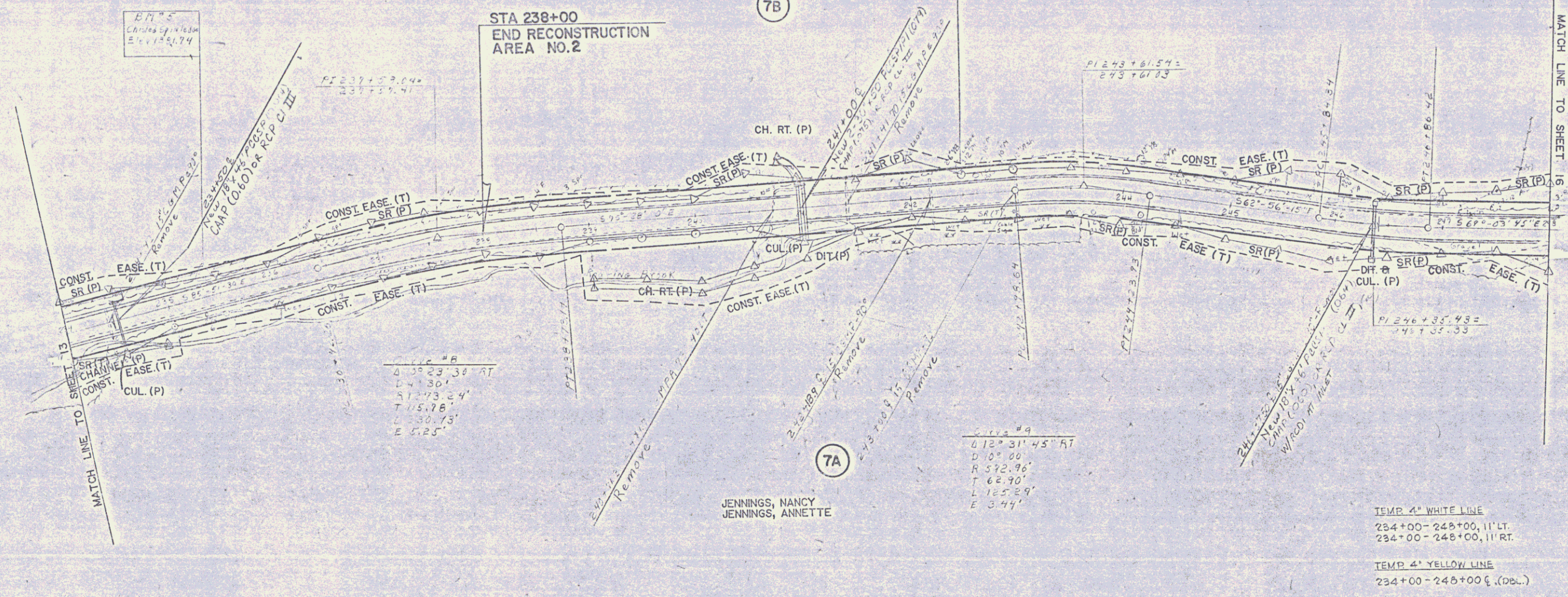

| | |
|----------|--|
| DATE | |
| PROJECT | |
| LOCATION | |
| DESIGNER | |
| CHECKER | |
| DATE | |

| | |
|----------|--|
| DATE | |
| PROJECT | |
| LOCATION | |
| DESIGNER | |
| CHECKER | |
| DATE | |

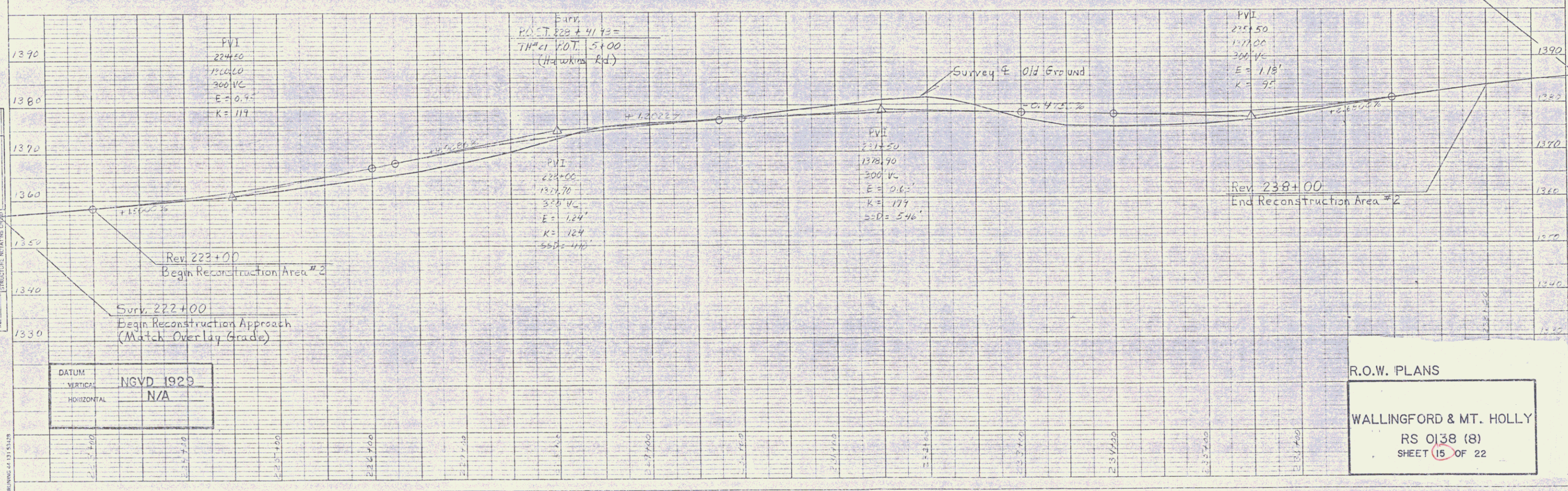

| | |
|------------|-----------|
| DATUM | NGVD 1929 |
| VERTICAL | |
| HORIZONTAL | N/A |

R.O.W. PLANS
 WALLINGFORD & MT. HOLLY
 RS 0138 (8)
 SHEET 15 OF 22

PLATE 1 SINGLE PLAN - PROFILE
 CHARLES BRUNING, ED.

MAR 19 1993

15

| SPECIAL DITCH (Comm. EXCAV.) | | EROSION MATTING | | STONE F.II, TYPE I | |
|------------------------------|-----------------|-----------------|-----------------|--------------------|-----------------|
| LT | RT | LT | RT | LT | RT |
| 256+00 - 257+95 | 256+00 - 257+60 | 254+00 - 256+00 | 253+50 - 256+00 | 256+00 - 257+95 | 256+00 - 257+60 |
| | | | 262+00 - 263+00 | | 262+00 - 263+00 |

| STONE F.II, TYPE II | |
|---------------------|----|
| LT | RT |
| 257+95 - 258+60 | |

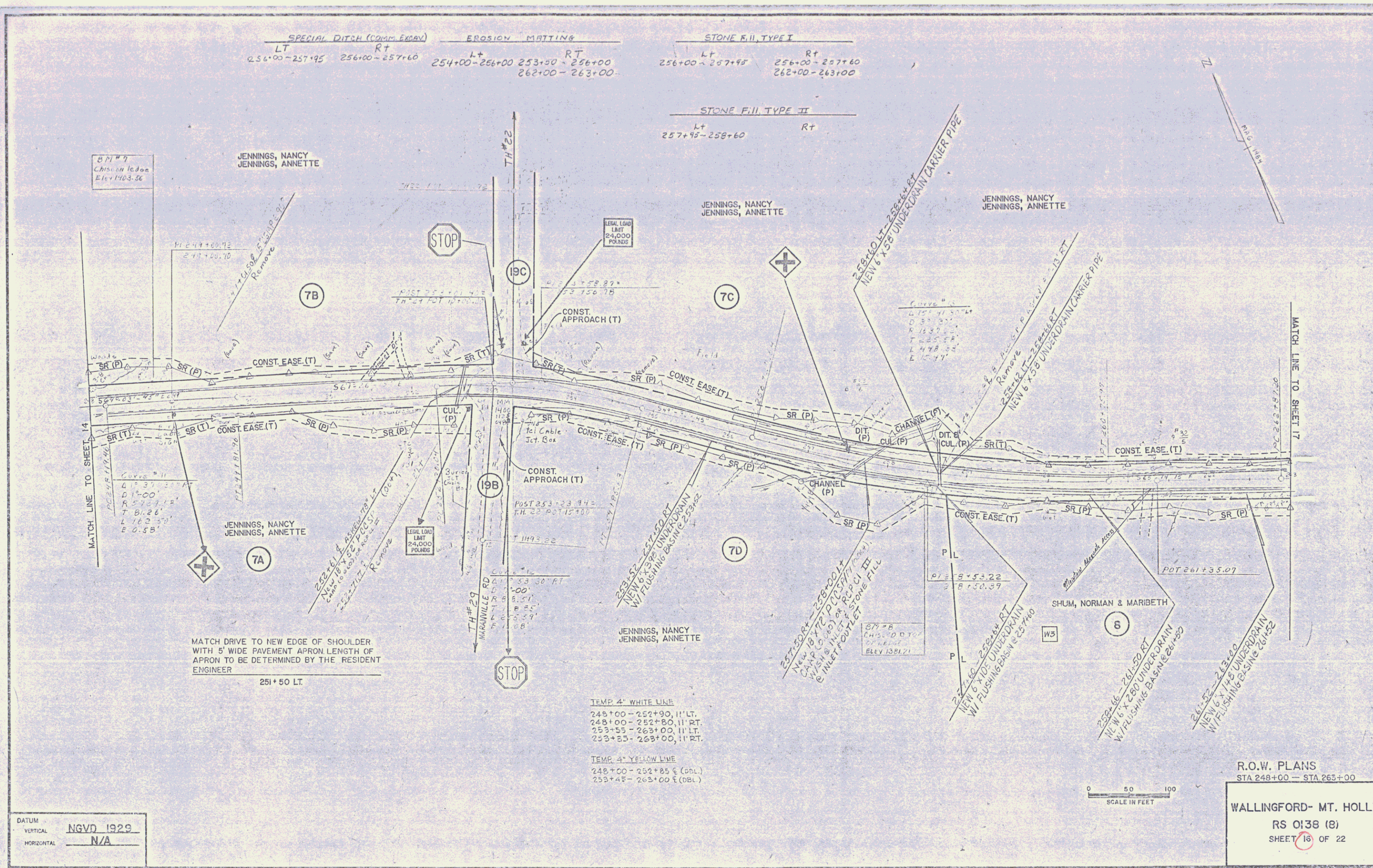

MATCH DRIVE TO NEW EDGE OF SHOULDER WITH 5' WIDE PAVEMENT APRON LENGTH OF APRON TO BE DETERMINED BY THE RESIDENT ENGINEER

251+50 LT

- TEMP. 4" WHITE LINE
- 248+00 - 252+90, 11' LT.
- 248+00 - 252+80, 11' RT.
- 253+55 - 263+00, 11' LT.
- 253+55 - 263+00, 11' RT.
- TEMP. 4" YELLOW LINE
- 248+00 - 252+85 (GDL)
- 253+45 - 263+00 (DBL)

DATUM
VERTICAL NGVD 1929
HORIZONTAL N/A

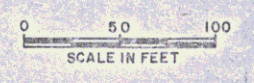

R.O.W. PLANS
STA 248+00 - STA 263+00

WALLINGFORD- MT. HOLLY
RS 0138 (B)
SHEET 16 OF 22

MAR 19 1993

16

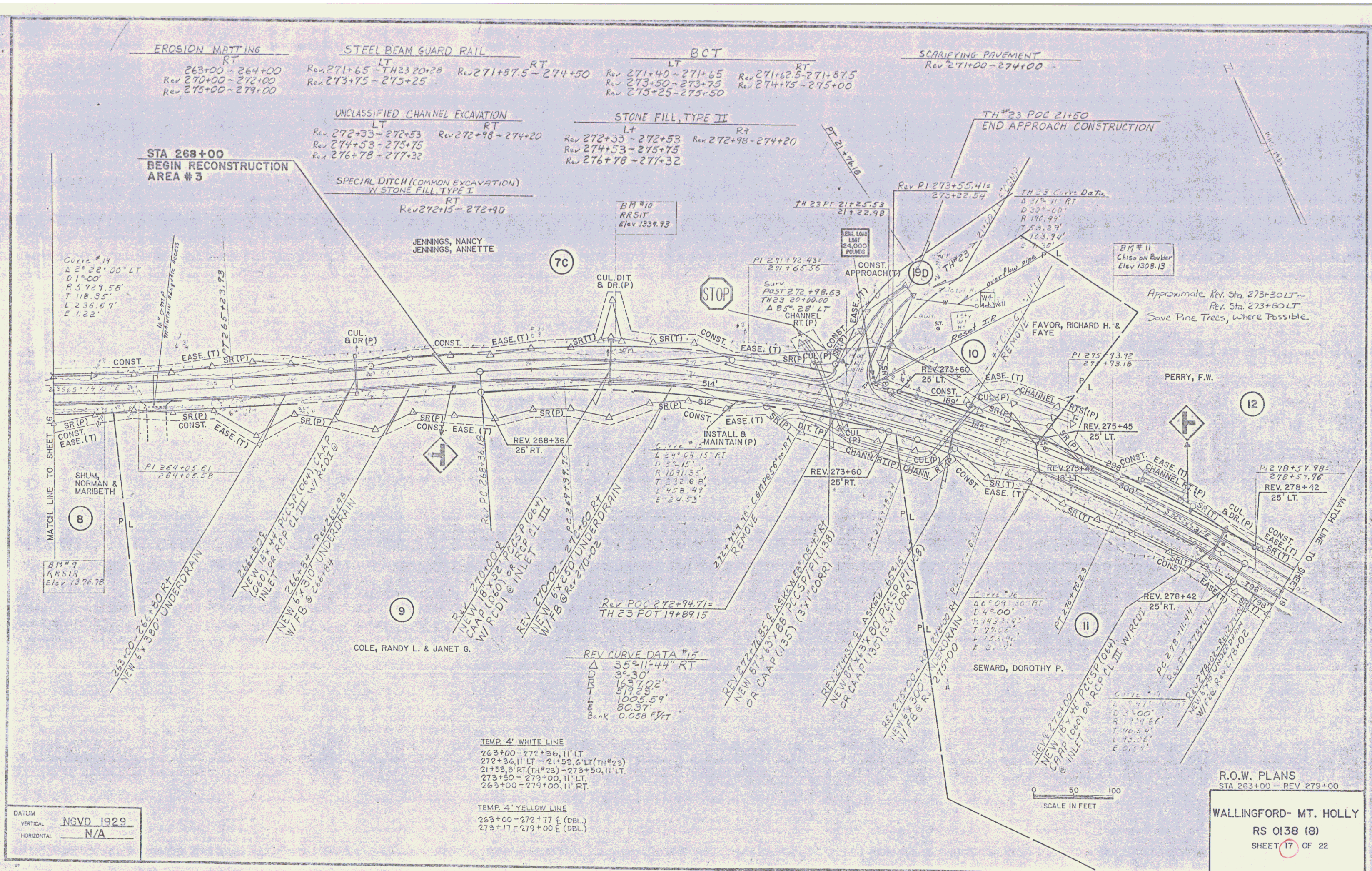

DATUM
 VERTICAL NGVD 1929
 HORIZONTAL N/A

TEMP. 4" WHITE LINE
 263+00 - 272+36, 11' LT.
 272+36, 11' LT - 21+53, 6' LT (TH#23)
 21+53, 6' RT (TH#23) - 273+50, 11' LT.
 273+50 - 279+00, 11' LT.
 263+00 - 279+00, 11' RT.

TEMP. 4" YELLOW LINE
 263+00 - 272+77 ϕ (DBL.)
 273+17 - 279+00 ϕ (DBL.)

REV CURVE DATA #15
 Δ 35° 11' 44" RT
 L 323.30'
 E 163.702'
 T 1005.59'
 B.M. 1003.37
 Bank 0.038 F/YT

0 50 100
 SCALE IN FEET

R.O.W. PLANS
 STA 263+00 - REV 279+00
 WALLINGFORD- MT. HOLLY
 RS 0138 (8)
 SHEET 17 OF 22

MAR 19 1993. 17

SPECIAL DITCH (CONV. E & CAV)
LT
REV 282+25 - 283+20
RT
REV 284+50 - 285+00

CONSTRUCT DRIVE
LT
REV 283+38 (12' W. OF)

EROSION MATTINGS
RT
REV 279+00 - 280+00
291+00 - 294+00

SCARIFYING PAVEMENT
REV 280+50 - 281+50
REV 284+50 - SURV 287+50

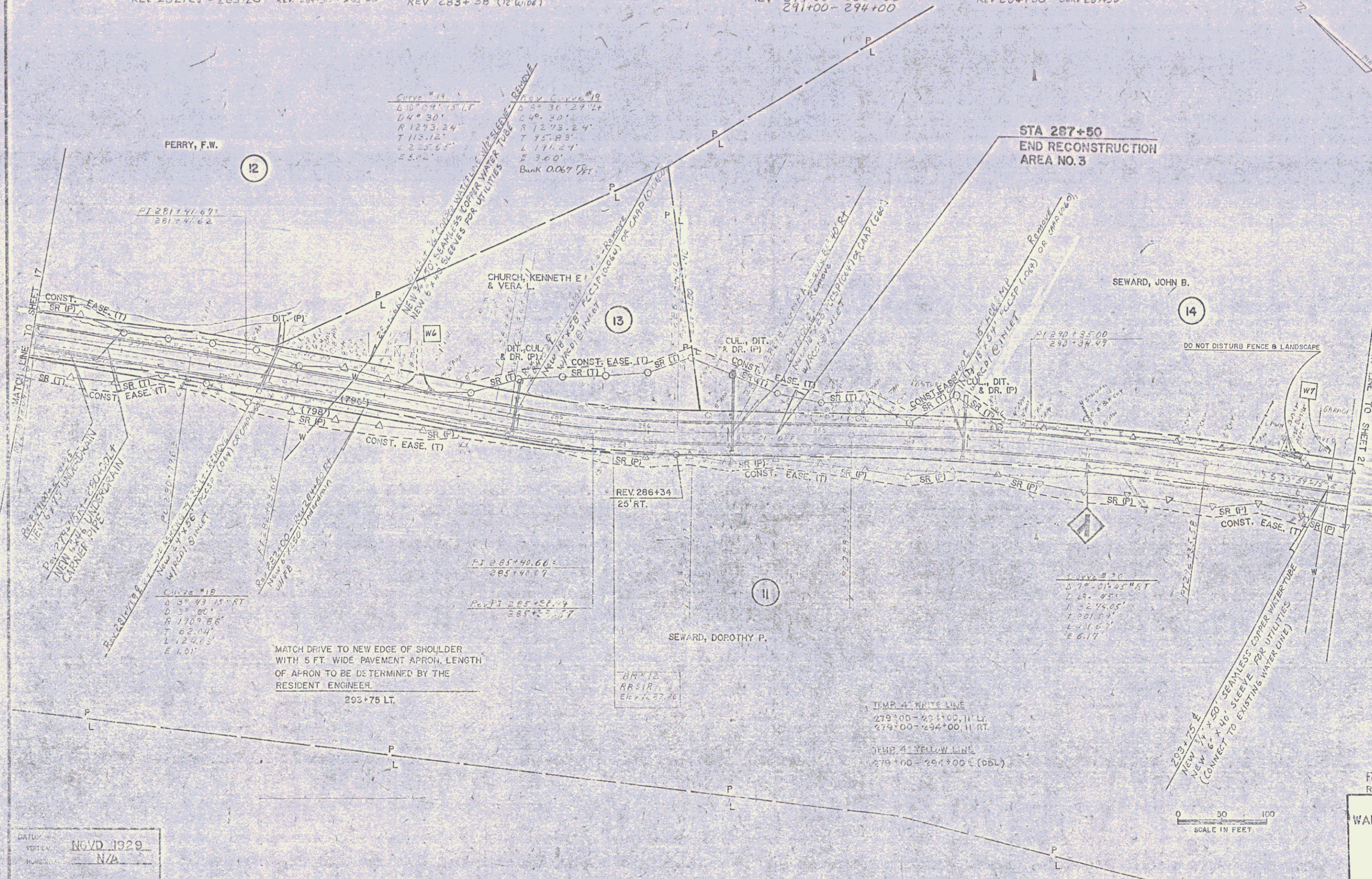

PERRY, F.W.

12

CHURCH, KENNETH E & VERA L.

13

SEWARD, JOHN B.

14

SEWARD, DOROTHY P.

RR #12
RR S.R. #1
E.R. #12, 20

MATCH DRIVE TO NEW EDGE OF SHOULDER WITH 5 FT. WIDE PAVEMENT APRON. LENGTH OF APRON TO BE DETERMINED BY THE RESIDENT ENGINEER.

293+75 LT.

TEMP. 4" WHITE LINE
279+00 - 281+00, 11 LT.
279+00 - 294+00, 11 RT.

TEMP. 4" YELLOW LINE
279+00 - 294+00 (DBL)

0 50 100
SCALE IN FEET

R.O.W. PLANS
REV 278+00 - SURV 294+00

WALLINGFORD - MT. HOLLY

RS 0138 (8)

SHEET 18 OF 22

MAR 19 1993

PLAN
 DATE: _____
 DRAWN BY: _____
 CHECKED BY: _____
 DATE: _____

DATUM
 VERTICAL: NGVD 1929
 HORIZONTAL: N/A

PROFILE
 DATE: _____
 DRAWN BY: _____
 CHECKED BY: _____
 DATE: _____

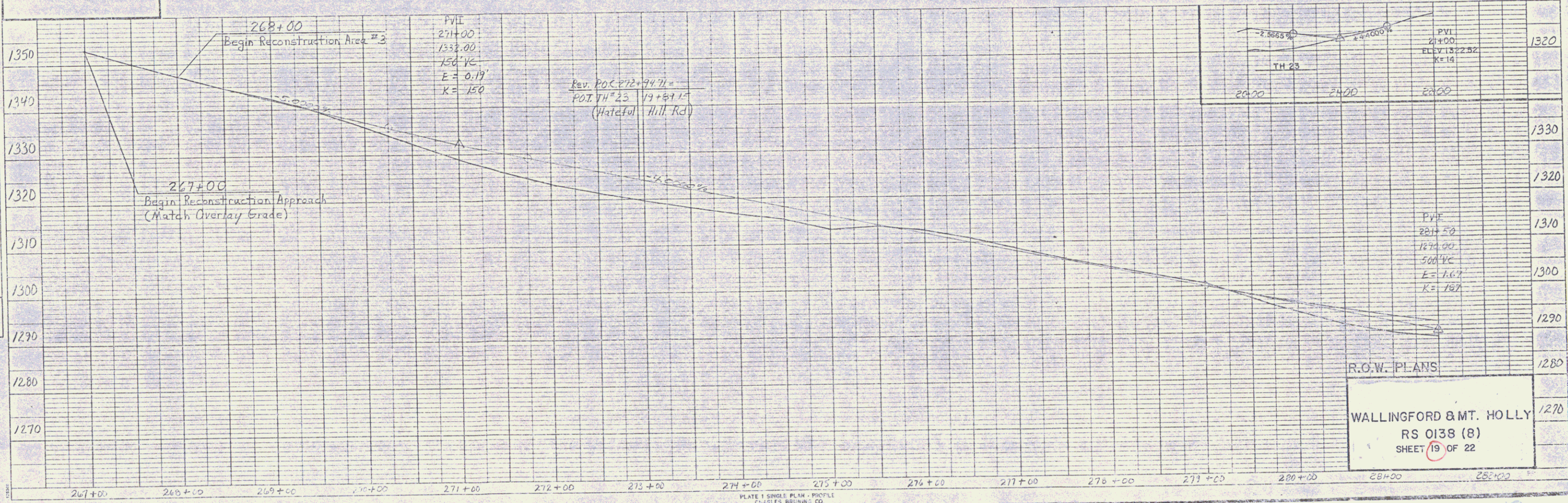

WALLINGFORD & MT. HOLLY
 RS 0138 (B)
 SHEET 19 OF 22

MAR 19 1993

| | |
|----------|------|
| PLAN | DATE |
| APPROVED | |
| NOTED | |
| BY | |
| DATE | |
| NO. | |

| | |
|----------|------|
| PROFILE | DATE |
| APPROVED | |
| NOTED | |
| BY | |
| DATE | |
| NO. | |

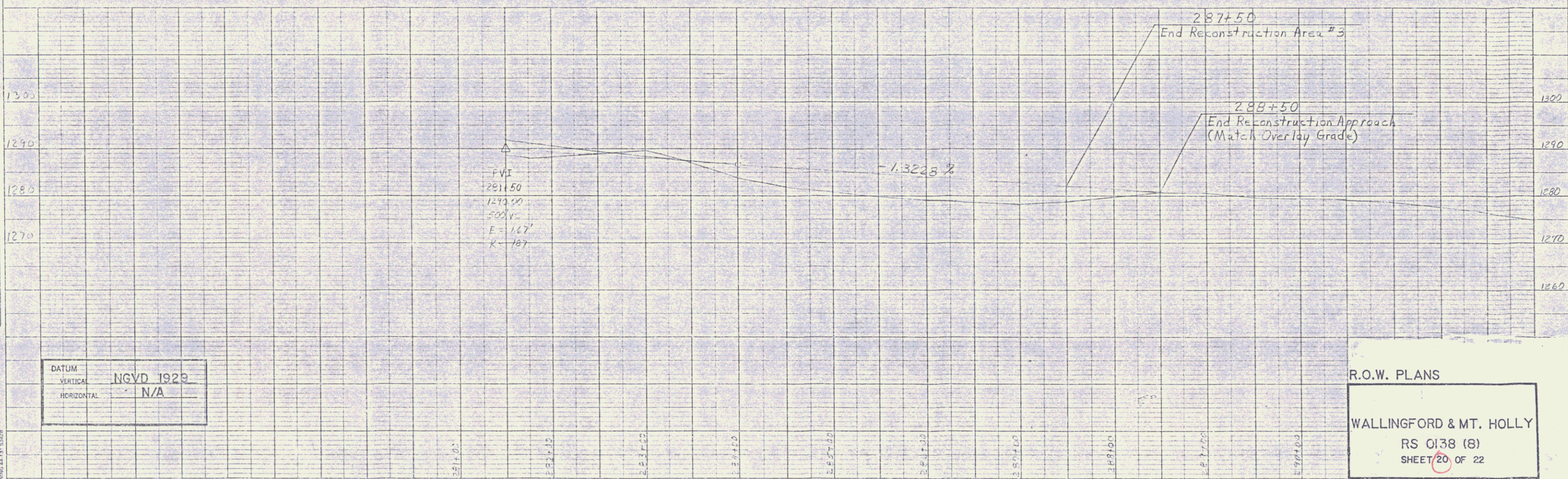

DATUM
 VERTICAL NGVD 1929
 HORIZONTAL N/A

R.O.W. PLANS
 WALLINGFORD & MT. HOLLY
 RS 0138 (8)
 SHEET 20 OF 22

PLATE 1 SINGLE PLAN - PROFILE
 CHARLES BRUNING CO.

MAR 19 1993

SPECIAL DITCH (COMMON EXCAV)
RT
294+00-295+50

EROSION MATTING
RT
294+00-296+00

SEWARD, LOWELL W.

15A

Curve #23
Δ 32°05'30" RT
D 15°00'
R 381.97
T 74.56
L 147.28
E 7.21

Mag 1994

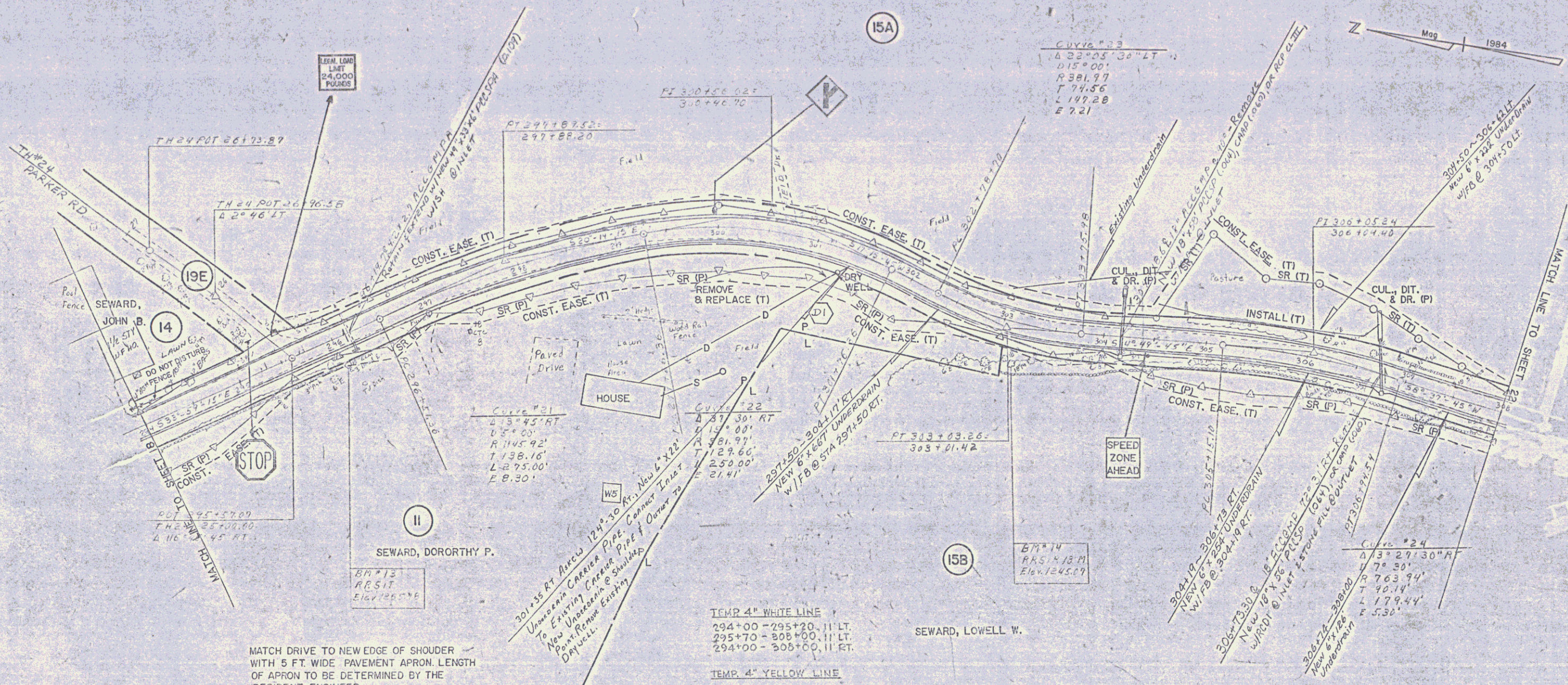

Curve #21
Δ 13°45' RT
D 5°00'
R 1145.92
T 138.16
L 275.00
E 8.30

SEWARD, DOROTHY P.
BR #12
RESIT
Elev 125.56

15B

BM #14
RAS #13 M
Elev 1245.27

MATCH DRIVE TO NEW EDGE OF SHOULDER WITH 5 FT. WIDE PAVEMENT APRON. LENGTH OF APRON TO BE DETERMINED BY THE RESIDENT ENGINEER.
296+82 RT
300+70 LT.

TEMP 4" WHITE LINE
294+00-295+20, 11' LT.
295+70-308+00, 11' LT.
294+00-305+00, 11' LT.

TEMP 4" YELLOW LINE
294+00-295+25 (D&L)
295+65-308+00 (D&L)

DATUM
VERTICAL NGVD 1929
HORIZONTAL N/A

SCALE IN FEET
0 50 100

R.O.W. PLANS
STA 294+00 - STA 308+00
WALLINGFORD- MT. HOLLY
RS 0138 (9)
SHEET 21 OF 22

MAR 19 1993

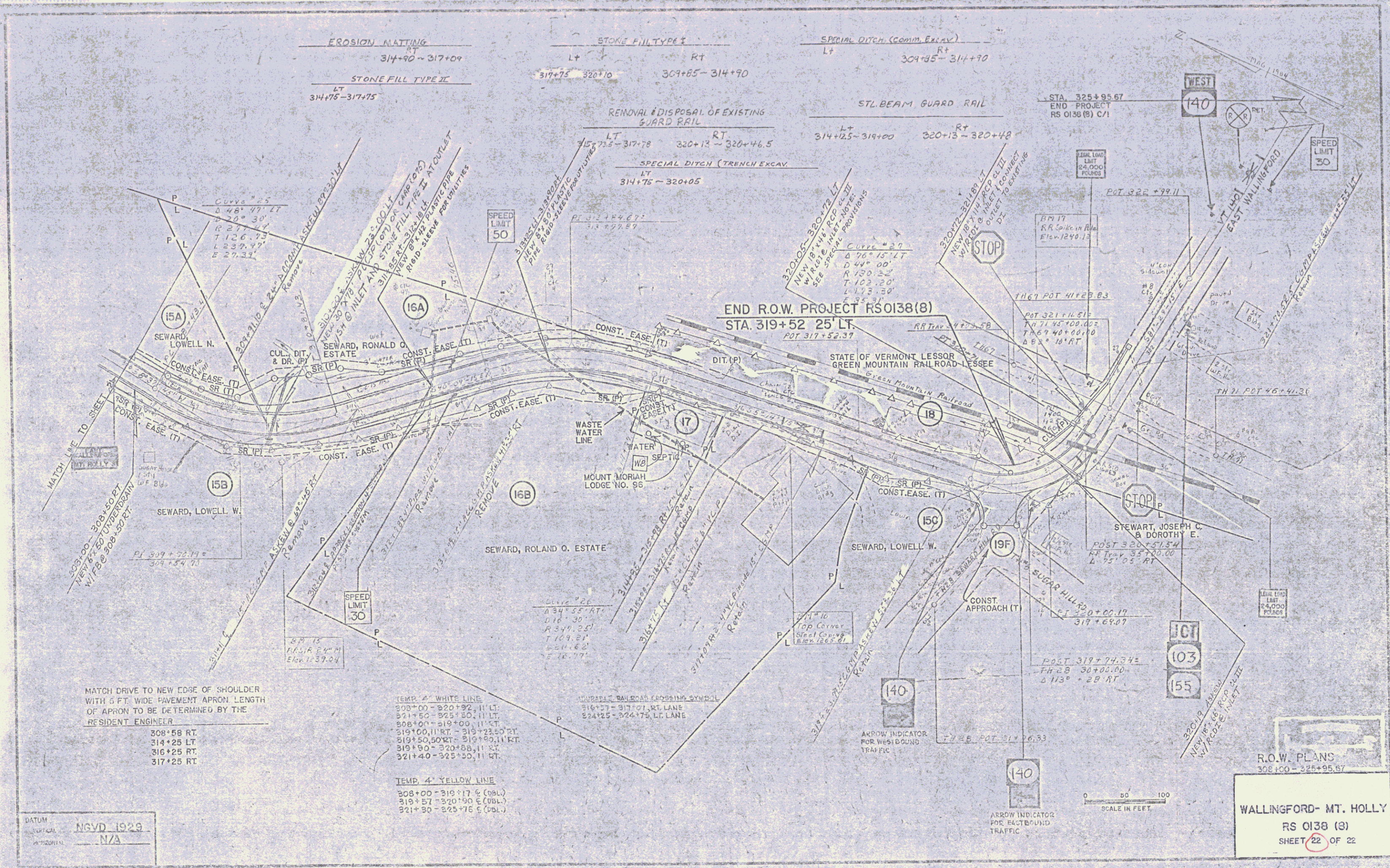

22