

DATE: 7-29-94  
 BY: J. J. THOMAS  
 CHECKED: J. J. THOMAS  
 IN CHARGE: J. J. THOMAS  
 PROJECT: SHOREHAM-BRIDPORT-ADDISON  
 SHEET: 139 OF 165

DATE: 7-29-94  
 BY: J. J. THOMAS  
 CHECKED: J. J. THOMAS  
 IN CHARGE: J. J. THOMAS  
 PROJECT: SHOREHAM-BRIDPORT-ADDISON  
 SHEET: 139 OF 165

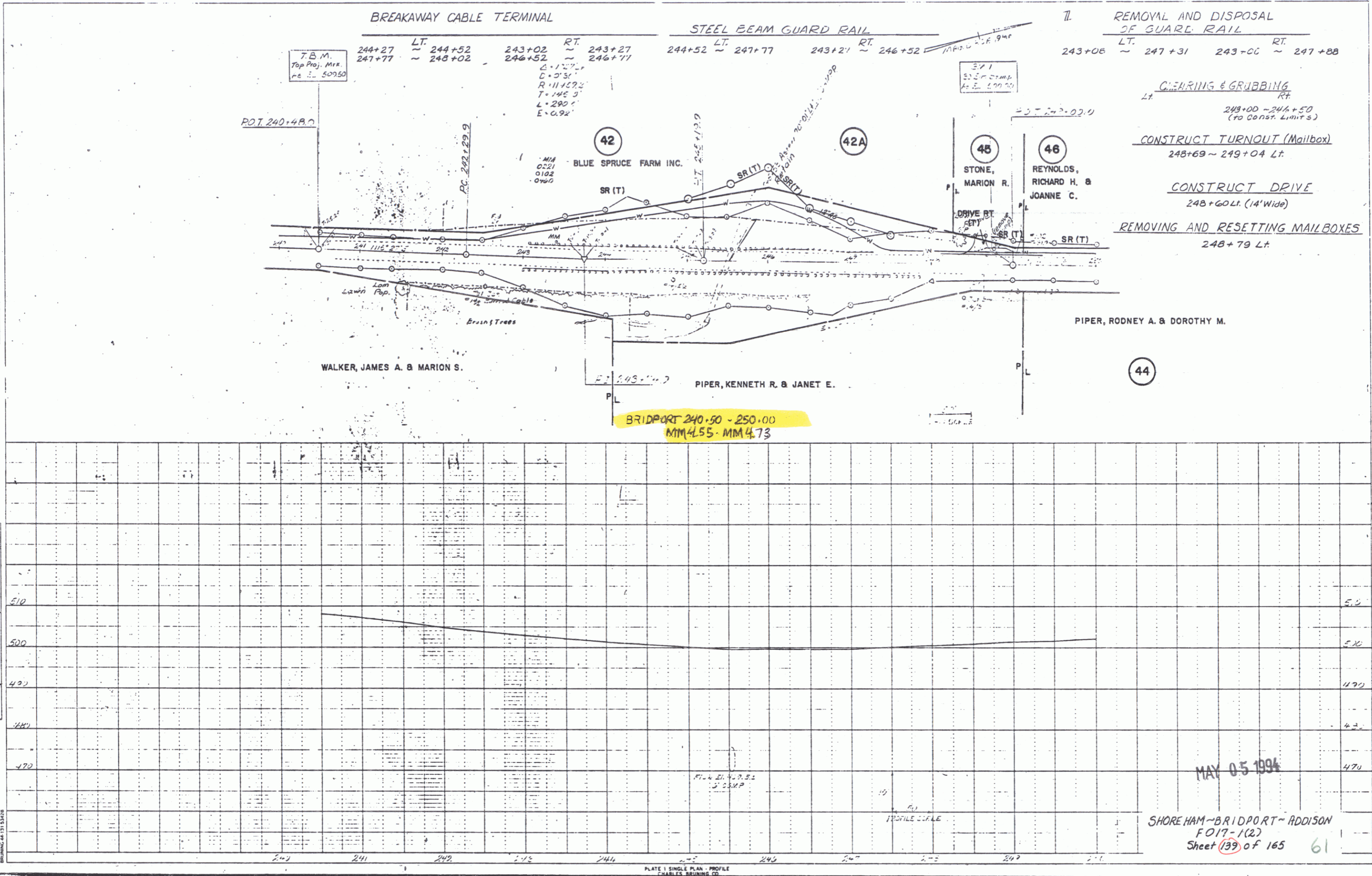

REMOVAL AND DISPOSAL OF GUARD RAIL  
 LT. 243+06 ~ 247+31 RT. 243+06 ~ 247+88  
 CLEARING & GRUBBING  
 RT. 243+00 ~ 246+50 (to Const. Limits)  
 CONSTRUCT TURNOUT (Mailbox)  
 248+69 ~ 249+04 Lt.  
 CONSTRUCT DRIVE  
 248+60 Lt. (14' Wide)  
 REMOVING AND RESETTING MAILBOXES  
 248+79 Lt.

44

MAY 05 1994

SHOREHAM-BRIDPORT-ADDISON  
 FO17-1(2)  
 Sheet 139 of 165 61