

Original Drawing - Ink on polymer meeting the requirements of 27 V.S.A. § 1403

SEE SHEET 2 FOR INDEX OF SHEETS AND LIST OF STANDARDS.

PROJECT LOCATION:  
BEGINNING AT A POINT IN THE TOWN OF WARREN, ON VT ROUTE 100 APPROXIMATELY 5.62 MILES NORTHERLY OF THE GRANVILLE-WARREN TOWN LINE AND EXTENDING NORTHERLY 0.62 MILES.

PROJECT DATA

LENGTH OF ROADWAY = 709.42 FEET  
LENGTH OF BRIDGE = 145.58 FEET  
LENGTH OF PROJECT = 855 FEET  
LENGTH OF ROW PROJECT: 1,002.40 FEET

PROJECT DESCRIPTION:

WORK TO BE PERFORMED UNDER THIS PROJECT INCLUDES REPLACEMENT OF EXISTING BRIDGE #173 ON VT ROUTE 100, A TEMPORARY DETOUR AND ALL NECESSARY ROADWAY AND CHANNEL APPROACH WORK.

# STATE OF VERMONT AGENCY OF TRANSPORTATION



## PROPOSED IMPROVEMENT BRIDGE PROJECT TOWN OF WARREN COUNTY OF WASHINGTON VT ROUTE 100 (MINOR ARTERIAL) - BR NO. 173

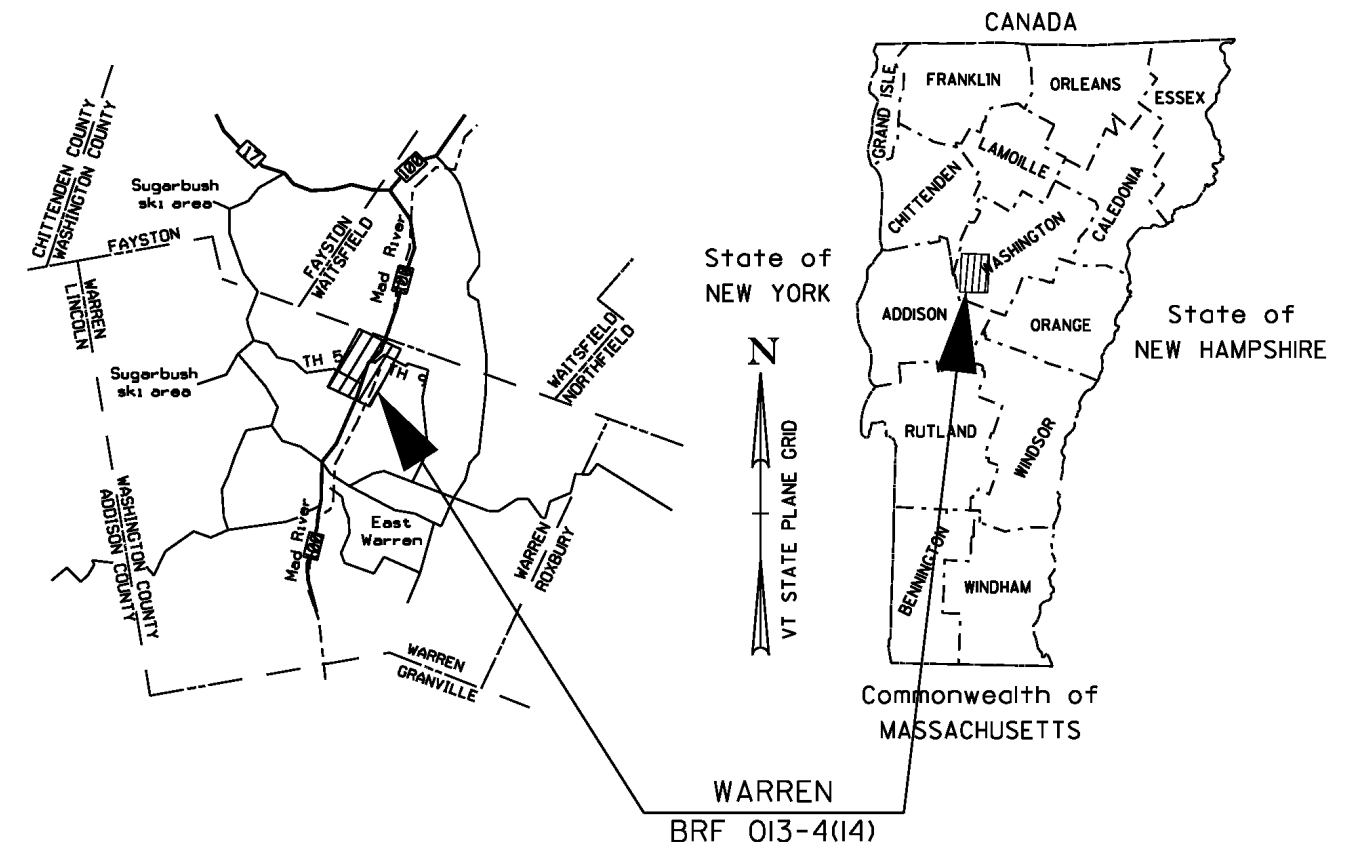

### R.O.W. PLANS

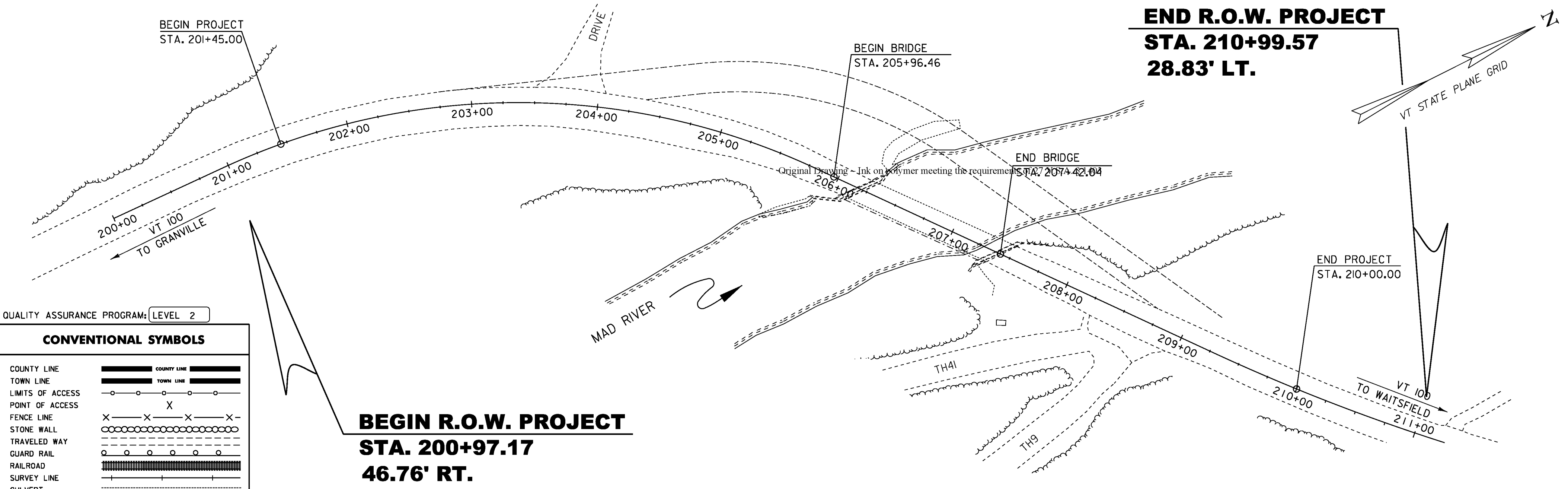

QUALITY ASSURANCE PROGRAM: LEVEL 2

#### CONVENTIONAL SYMBOLS

COUNTY LINE	
TOWN LINE	
LIMITS OF ACCESS	
POINT OF ACCESS	
FENCE LINE	
STONE WALL	
TRAVELED WAY	
GUARD RAIL	
RAILROAD	
SURVEY LINE	
CULVERT	
POWER POLE	
TELEPHONE POLE	
TREES	
CONTROL OF ACCESS	
PROPERTY LINE	
R.O.W. TAKING LINE	
SLOPE RIGHTS	
TOP OF CUT	
TOE OF SLOPE	

**BEGIN R.O.W. PROJECT  
STA. 200+97.17  
46.76' RT.**

SURVEYED BY : R. D. GILMAN  
SURVEYED DATE : NOV. 1995

DATUM  
VERTICAL NAVD 88  
HORIZONTAL NAD 83 (07)

ALL DRIVES AS INDICATED ON PLANS  
ARE SUBJECT TO PERMITS PURSUANT  
TO TITLE 19 V.S.A. 1111

SCALE 1" = 40'-0"  
40 0 40

THESE PLANS ARE SUBJECT TO SUCH ENGINEERING CHANGES AS MAY BE REQUIRED BY THE FEDERAL HIGHWAY ADMINISTRATION OR THE DIRECTOR OF PROGRAM DEVELOPMENT.  
CONSTRUCTION IS TO BE CARRIED ON IN ACCORDANCE WITH THESE PLANS AND THE STANDARD SPECIFICATIONS FOR CONSTRUCTION DATED 2011, AS APPROVED BY THE FEDERAL HIGHWAY ADMINISTRATION ON JULY 20, 2011 FOR USE ON THIS PROJECT, INCLUDING ALL SUBSEQUENT REVISIONS AND SUCH REVISED SPECIFICATIONS AND SPECIAL PROVISIONS AS ARE INCORPORATED IN THESE PLANS.

CHIEF OF RIGHT OF WAY  
APPROVED ROBERT M. WHITE DATE 08-30-11  
PROJECT MANAGER : M. EVANS-MONGEON  
PROJECT NAME : WARREN  
PROJECT NUMBER : BR# 013-4 (14)  
SHEET 1 OF 24 SHEETS



Original Drawing – Ink on polymer meeting the requirements of 27 V.S.A. § 1403

**BOX BEAM GUARDRAIL**  
 STA 201+85.61 TO STA 203+74.12 LT  
 STA 204+06.71 TO STA 205+50.00 LT  
 STA 204+36.31 TO STA 205+44.40 RT

**COLD PLANING, BITUMINOUS PAVEMENT**  
 STA 200+45.00 TO STA 201+45.00

**MANUFACTURED TERMINAL SECTION, TANGENT**  
 STA 204+21.87 TO STA 204+36.31 RT

**DELINEATOR WITH STEEL POST**  
 VT 100 STA 201+85.00 LT (GREEN)  
 VT 100 STA 203+45.00 LT (BLUE)  
 VT 100 STA 204+06.00 LT (GREEN)  
 VT 100 STA 204+22.00 RT (GREEN)

**SPECIAL PROVISION (GUARDRAIL APPROACH SECTION, GALVANIZED 2 RAIL BOX BEAM)**  
 STA 205+44.40 TO STA 205+50.00 RT

**CONSTRUCT DRIVE (BITUMINOUS CONCRETE PAVEMENT)**  
 STA 203+75.00 LT (55'-8" LENGTH x 16'-0" WIDE)

**REMOVAL AND DISPOSAL OF GUARDRAIL**  
 STA 205.38.37 TO STA 205+50.00 LT  
 STA 205+15.49 TO STA 205+50.00 RT

**VT-100 CURVE #1**  
 DELTA = 49° 40' 45"  
 D = 10° 16' 22"  
 R = 557.74'  
 T = 258.18'  
 L = 483.60'  
 E = 56.86'

**TOWN OF WARREN**  
**1A**

**TOWN OF WARREN**  
**1A**

**STATE OF VERMONT**  
**2**

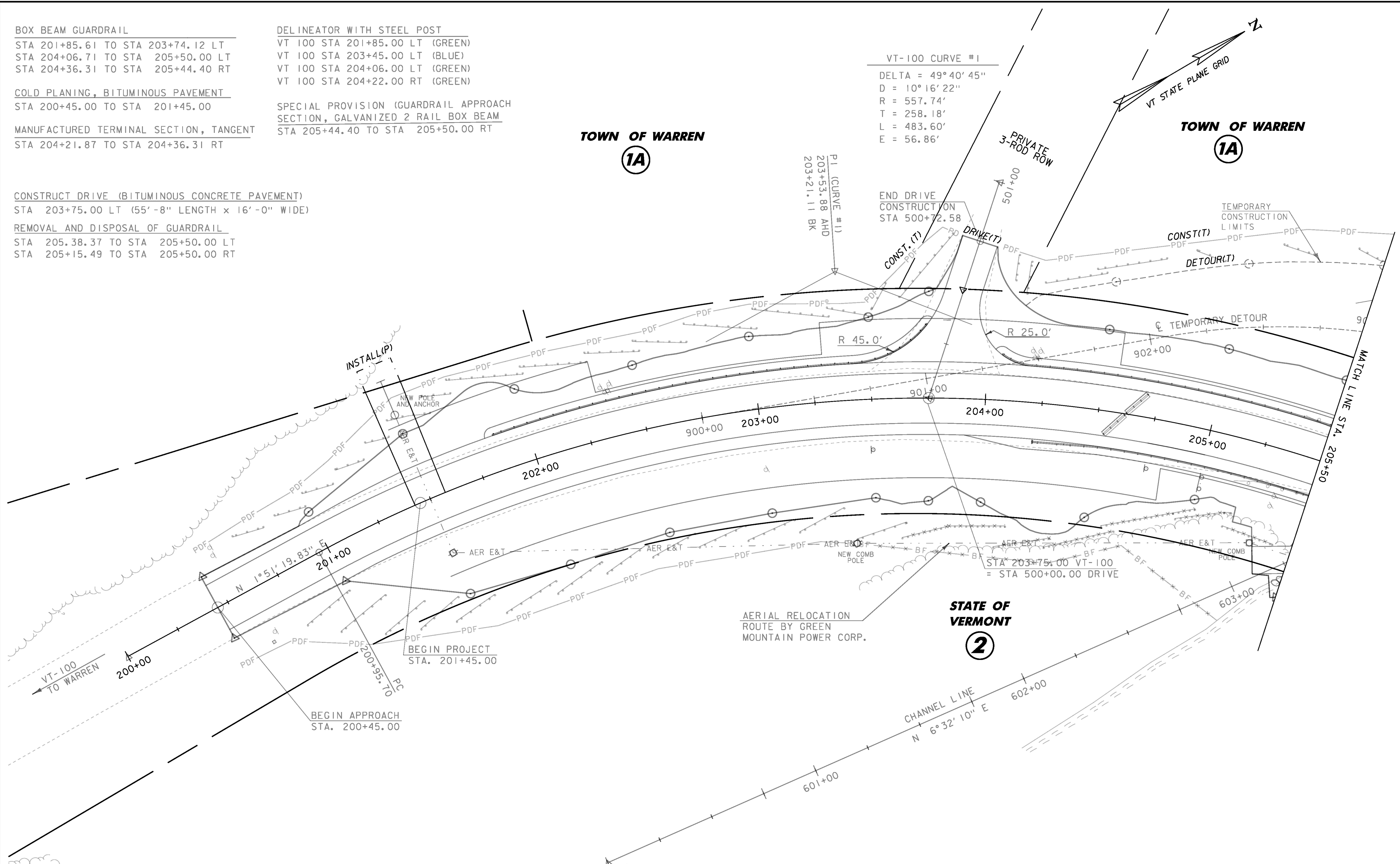

LINES SHOWN ON THIS PLAN AS EXISTING PROPERTY LINES P/L ARE BELIEVED TO BE ACCURATE BUT SHOULD NOT BE RELIED UPON FOR PURPOSES UNRELATED TO THE STATE OF VERMONT'S ACQUISITION OF LAND AND RIGHTS FOR THIS PROJECT.

**FOR R.O.W. USE ONLY**

SCALE 1" = 20'-0"  
 20 0 20

PROJECT NAME: WARREN	PLOT DATE: 31-MAY-2017
PROJECT NUMBER: BRP 013-4 (14)	DRAWN BY: JB
FILE NAME: r78f242lay1.dgn	CHECKED BY: HP
PROJECT LEADER: M. EVANS-MONGEON	SHEET 3 OF 24
DESIGNED BY: U. STANLEY	
R.O.W. LAYOUT SHEET 1 OF 2	

Original Drawing – Ink on polymer meeting the requirements of 27 V.S.A. § 1403

<b>REMOVAL AND DISPOSAL OF GUARDRAIL</b> STA 205+50.00 TO STA 206+50.00 LT STA 205+50.00 TO STA 206+24.00 RT STA 207+53.52 TO STA 210+67.82 LT STA 207+34.59 TO STA 208+07.79 RT  <b>BOX BEAM GUARDRAIL</b> STA 205+50.00 TO STA 205+78.62 LT STA 207+93.10 TO STA 208+97.92 LT STA 207+59.90 TO STA 208+40.06 RT  <b>SPECIAL PROVISION (BRIDGE RAILING, GALVANIZED 2 RAIL BOX BEAM/CURB MOUNTED)</b> STA 206+10.60 TO STA 207+61.10 LT STA 205+77.34 TO STA 207+27.90 RT	<b>SPECIAL PROVISION (GUARDRAIL APPROACH SECTION, GALVANIZED 2 RAIL BOX BEAM)</b> STA 205+78.62 TO STA 206+10.60 LT STA 205+50.00 TO STA 205+77.34 RT STA 207+61.10 TO STA 207+93.10 LT STA 207+27.90 TO STA 207+59.90 RT  <b>MANUFACTURED TERMINAL SECTION, TANGENT</b> STA 208+97.92 TO STA 209+11.93 LT	<b>COLD PLANING, BITUMINOUS PAVEMENT</b> STA 210+00.00 TO STA 211+00.00  <b>RELOCATE MAILBOX, SINGLE SUPPORT</b> TH 41 STA 400+14.00 RT  <b>RELOCATE MAILBOX, MULTIPLE SUPPORT</b> TH 9 STA 300+76.00 RT (2 MAILBOX)	<b>DELINEATOR WITH STEEL POST</b> VT 100 STA 209+12.00 LT (BLUE) VT 100 STA 208+40.00 RT (GREEN) TH 9 STA 300+35.38 25.2 FT LT (WHITE) TH 9 STA 300+45.38 67.1 FT RT (WHITE) TH 41 STA 400+87.00 19.2 FT LT (WHITE) TH 41 STA 400+87.00 17.8 FT RT (WHITE) TH 41 STA 400+78.65 16.1 FT LT (WHITE) TH 41 STA 400+97.00 15.3 FT LT (WHITE)	<b>SOLID ROCK EXCAVATION</b> VT 100 STA 209+00 TO STA 210+00 RT
--	---	---	--	--

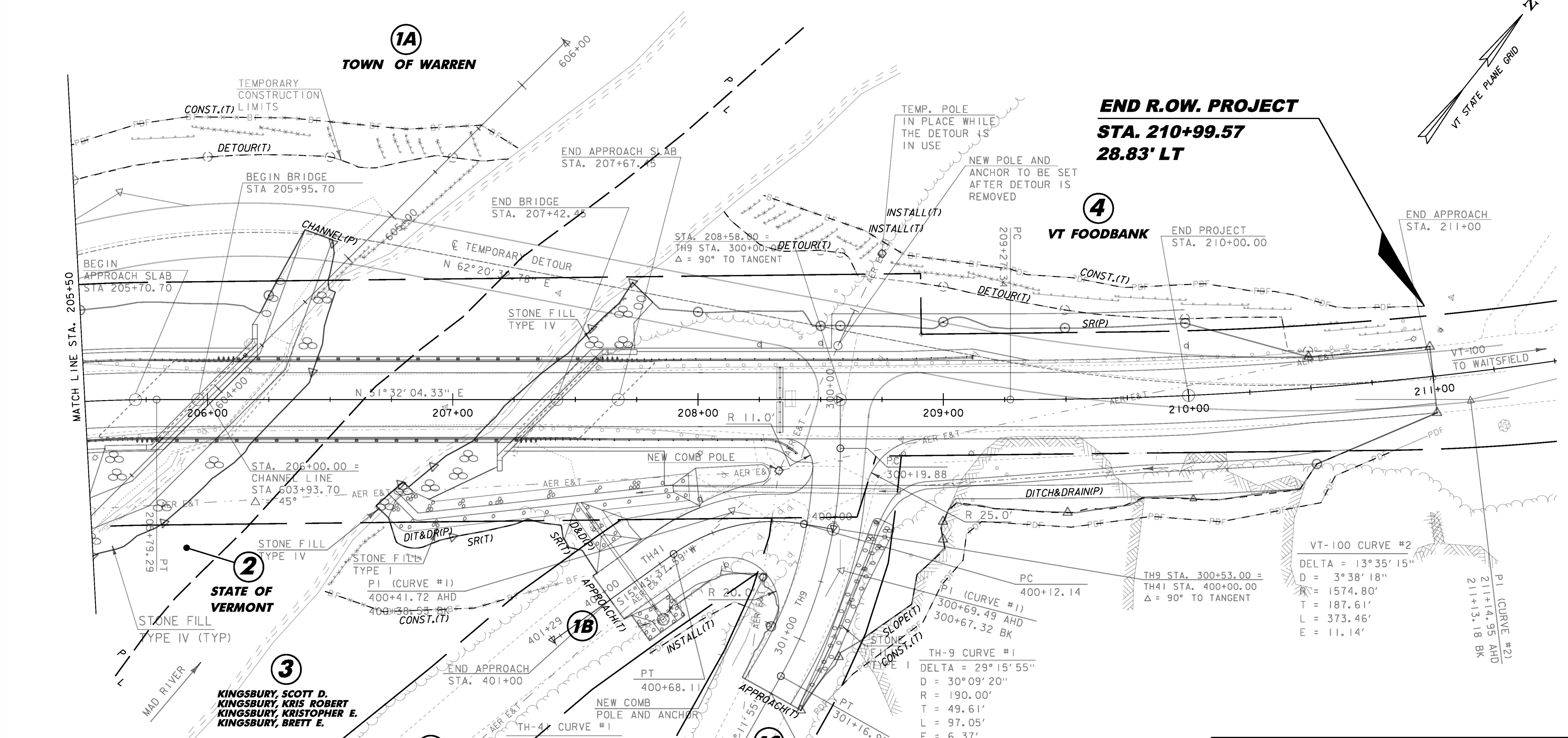

LINES SHOWN ON THIS PLAN AS EXISTING PROPERTY LINES P/L ARE BELIEVED TO BE ACCURATE BUT SHOULD NOT BE RELIED UPON FOR PURPOSES UNRELATED TO THE STATE OF VERMONT'S ACQUISITION OF LAND AND RIGHTS FOR THIS PROJECT.

**FOR R.O.W. USE ONLY**

**3**  
 KINGSBURY, SCOTT D.  
 KINGSBURY, KRIS ROBERT  
 KINGSBURY, KRISTOPHER E.  
 KINGSBURY, BRETT E.

**3**  
 TH-4 CURVE #1  
 DELTA = 45° 48' 43"  
 D = 81° 51' 04"  
 R = 70.00'  
 T = 29.58'  
 L = 55.97'  
 E = 5.99'

**3**  
 TH-9 CURVE #1  
 DELTA = 29° 15' 55"  
 D = 30° 09' 20"  
 R = 190.00'  
 T = 49.61'  
 L = 97.05'  
 E = 6.37'

**3**  
 KINGSBURY, SCOTT D.  
 KINGSBURY, KRIS ROBERT  
 KINGSBURY, KRISTOPHER E.  
 KINGSBURY, BRETT E.

SCALE 1" = 20'-0"  
 20 0 20

PROJECT NAME: WARREN	PROJECT NUMBER: BRP 013-4(14)
FILE NAME: r78f242lay2.dgn	PLOT DATE: 31-MAY-2017
PROJECT LEADER: M. EVANS-MONGEON	DRAWN BY: JB
DESIGNED BY: U. STANLEY	CHECKED BY: HP
R.O.W. LAYOUT SHEET 2 OF 2	SHEET 4 OF 24