

PUBLIC DRIVE DETOUR CURVE (1) PUBLIC DRIVE DETOUR CURVE (2)

$\Delta = 59^{\circ}47'32''$ $\Delta = 43^{\circ}28'16''$
 $D = 116^{\circ}30'11''$ $D = 116^{\circ}25'52''$
 $R = 49.18'$ $R = 49.21'$
 $T = 28.28'$ $T = 19.62'$
 $L = 51.32'$ $L = 37.34'$
 $E = 7.55'$ $E = 3.77'$

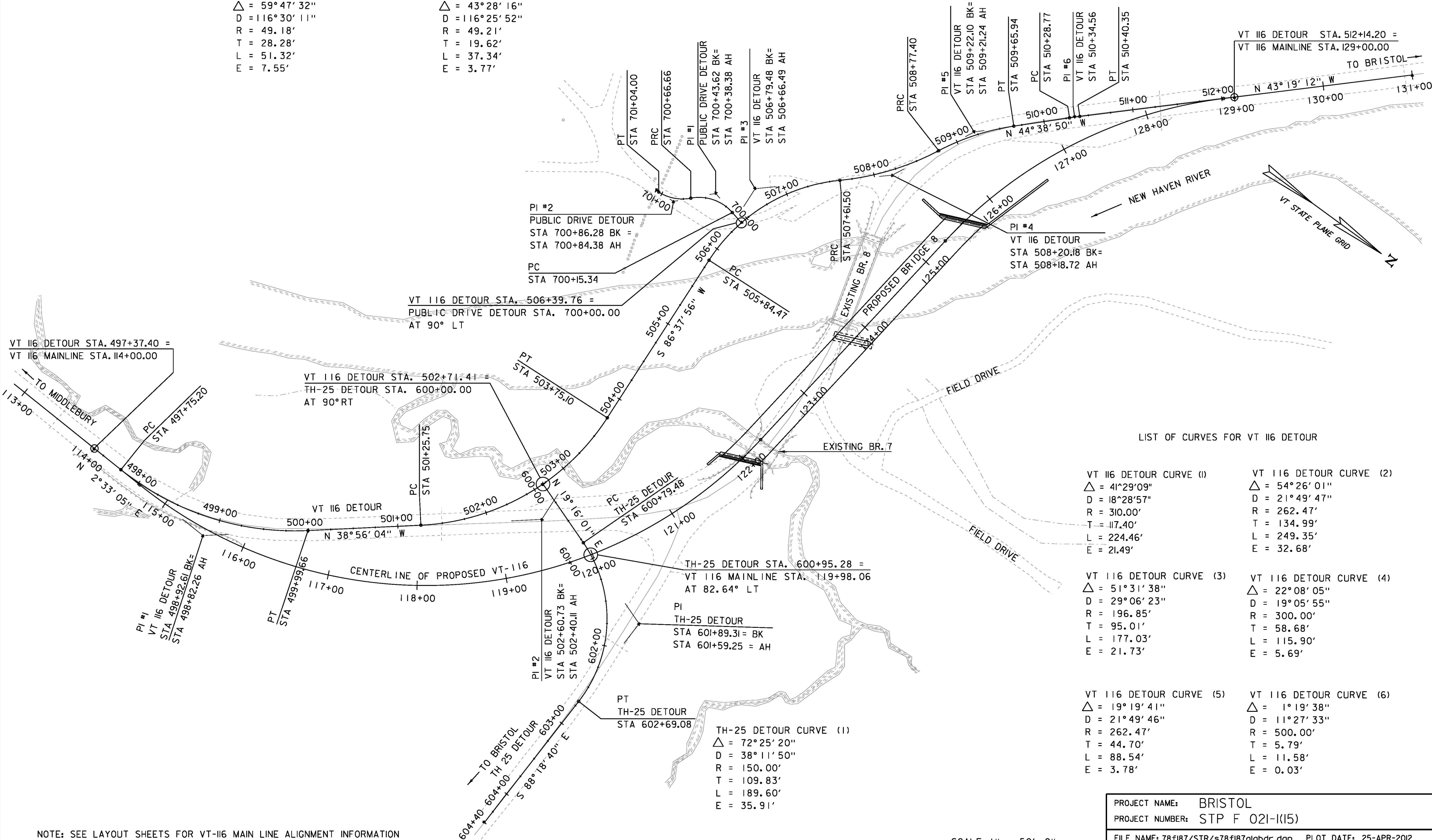

LIST OF CURVES FOR VT 116 DETOUR

VT 116 DETOUR CURVE (1)	VT 116 DETOUR CURVE (2)
$\Delta = 41^{\circ}29'09''$	$\Delta = 54^{\circ}26'01''$
$D = 18^{\circ}28'57''$	$D = 21^{\circ}49'47''$
$R = 310.00'$	$R = 262.47'$
$T = 117.40'$	$T = 134.99'$
$L = 224.46'$	$L = 249.35'$
$E = 21.49'$	$E = 32.68'$
VT 116 DETOUR CURVE (3)	VT 116 DETOUR CURVE (4)
$\Delta = 51^{\circ}31'38''$	$\Delta = 22^{\circ}08'05''$
$D = 29^{\circ}06'23''$	$D = 19^{\circ}05'55''$
$R = 196.85'$	$R = 300.00'$
$T = 95.01'$	$T = 58.68'$
$L = 177.03'$	$L = 115.90'$
$E = 21.73'$	$E = 5.69'$
VT 116 DETOUR CURVE (5)	VT 116 DETOUR CURVE (6)
$\Delta = 19^{\circ}19'41''$	$\Delta = 1^{\circ}19'38''$
$D = 21^{\circ}49'46''$	$D = 11^{\circ}27'33''$
$R = 262.47'$	$R = 500.00'$
$T = 44.70'$	$T = 5.79'$
$L = 88.54'$	$L = 11.58'$
$E = 3.78'$	$E = 0.03'$

TH-25 DETOUR CURVE (1)

$\Delta = 72^{\circ}25'20''$
 $D = 38^{\circ}11'50''$
 $R = 150.00'$
 $T = 109.83'$
 $L = 189.60'$
 $E = 35.91'$

NOTE: SEE LAYOUT SHEETS FOR VT-116 MAIN LINE ALIGNMENT INFORMATION

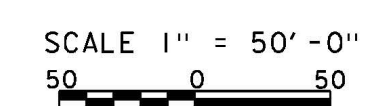

PROJECT NAME:	BRISTOL
PROJECT NUMBER:	STP F 021-1(15)
FILE NAME:	78f187/STR/s78f187algbdr.dgn
PROJECT LEADER:	M.EVANS-MONGEON
DESIGNED BY:	W.PELLETIER
DETOUR ALIGNMENT SHEET	
PLOT DATE:	25-APR-2012
DRAWN BY:	G.ROKES
CHECKED BY:	W.PELLETIER
SHEET	14 OF 37