

VT II6 CURVE 2 DATA
 $\Delta = 39^\circ 59' 25''$
 $D = 11^\circ 14' 04''$
 $R = 510.00'$
 $T = 185.58'$
 $L = 355.96'$
 $E = 32.71'$
 $BANK = 0.060$

COLD PLANING, BITUMINOUS PAVEMENT
 130+25.00 ~ 130+75.00
 ANCHOR FOR STEEL BEAM RAIL
 VT-II6
 128+49.00 RT

STEEL BEAM GUARDRAIL, GALVANIZED
 VT- II6
 127+25.00 ~ 128+53.00 RT
 DELINEATOR WITH STEEL POST
 VT-II6
 128+45.00 RT GREEN
 128+10.00 RT WHITE
 128+20.00 LT WHITE

8
GRIGGS, CHRISTOPHER C.
& CHELSEA S.

9
GRAY, DIANE
& STEVEN E.

3
BARRECA, CHRISTOPHER

DIVERSIONARY BERM
 SEE DIVERSIONARY BERM
 TYPICAL AND LAYOUT
 FOR STATIONING

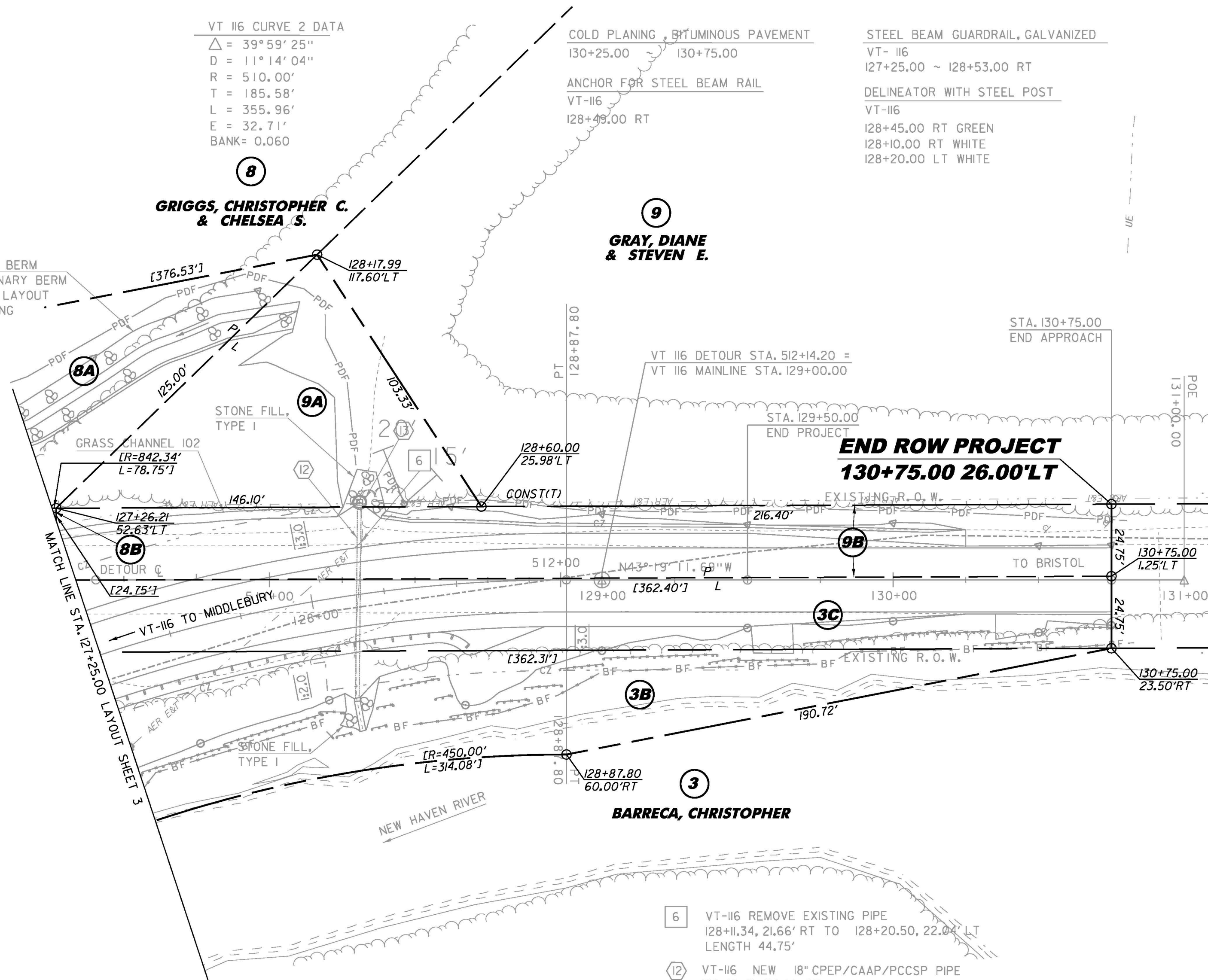

MATCH LINE STA. 127+25.00 LAYOUT SHEET 3

- 6 VT-II6 REMOVE EXISTING PIPE
 128+11.34, 21.66' RT TO 128+20.50, 22.04' LT
 LENGTH 44.75'
- 12 VT-II6 NEW 18" CPEP/CAAP/PCCSP PIPE
 128+10.43, 34.88' RT TO 128+20.40, 29.83' LT
 LENGTH 65.92'
- 13 VT-II6 NEW PRECAST REINFORCED CONCRETE DI WITH CAST IRON GRATE (TYPE A)
 128+20.69, 31.28' LT

LINES SHOWN ON THIS PLAN AS EXISTING
 PROPERTY LINES P/L ARE BELIEVED TO
 BE ACCURATE BUT SHOULD NOT BE RELIED
 UPON FOR PURPOSES UNRELATED TO THE
 STATE OF VERMONT'S ACQUISITION OF LAND
 AND RIGHTS FOR THIS PROJECT.

**FOR R.O.W.
 USE ONLY**

SCALE 1" = 20' - 0"
 20 0 20

PROJECT NAME: BRISTOL	PLOT DATE: 25-APR-2012
PROJECT NUMBER: STP F 021-1(15)	DRAWN BY: E. PIERCE
FILE NAME: r78f187.lay4.dgn	CHECKED BY: E. PIERCE
PROJECT LEADER: M. EVANS-MONGEON	ROW LAYOUT SHEET 4 OF 5
DESIGNED BY: W. PELLETIER	SHEET 7 OF 37