

VT-116 CURVE DATA
 $\Delta = 85^{\circ}51'42''$
 $D = 11^{\circ}14'04''$
 $R = 510.00'$
 $T = 474.43'$
 $L = 764.27'$
 $E = 186.55'$
 $BANK = 0.060$

3

BARRECA, CHRISTOPHER

BEGIN R.O.W. PROJECT
113+00.00 25.18'LT

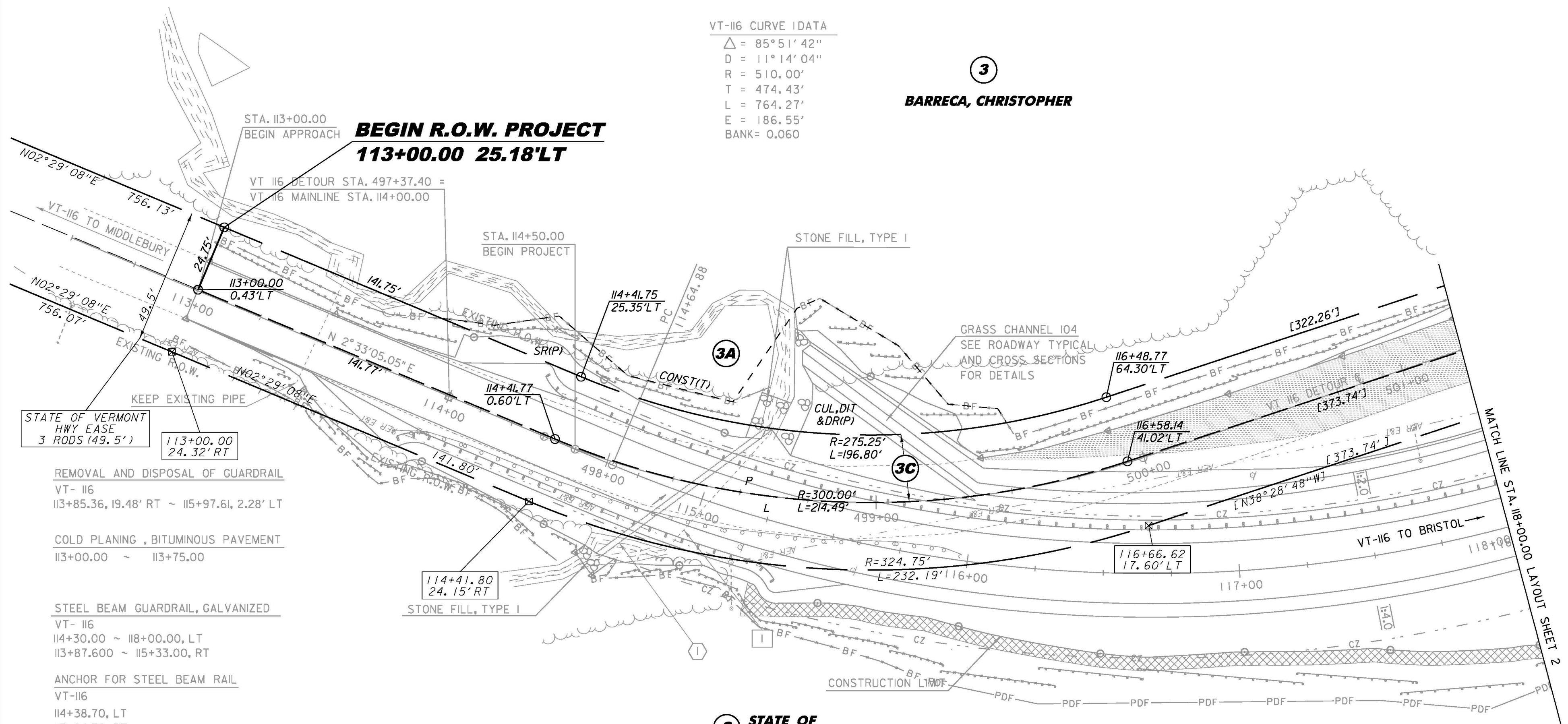

STATE OF VERMONT
 HWY EASE
 3 RODS (49.5')

REMOVAL AND DISPOSAL OF GUARDRAIL
 VT-116
 113+85.36, 19.48' RT ~ 115+97.61, 2.28' LT

COLD PLANING, BITUMINOUS PAVEMENT
 113+00.00 ~ 113+75.00

STEEL BEAM GUARDRAIL, GALVANIZED
 VT-116
 114+30.00 ~ 118+00.00, LT
 113+87.600 ~ 115+33.00, RT

ANCHOR FOR STEEL BEAM RAIL
 VT-116
 114+38.70, LT
 113+94.70, RT
 115+26.40, RT

DELINEATOR WITH STEEL POST
 VT-116
 113+87.60, RT BLUE
 114+71.00, RT WHITE
 114+30.00, LT GREEN
 115+12.00, LT WHITE
 115+33.00, RT GREEN

EXCAVATION OF SURFACES AND PAVEMENTS
 VT-116
 116+00.00 ~ 118+00.00, LT

2 STATE OF VERMONT
 (FORMERLY SARGENT)

☒ CALCULATED POINT

- ① NEW 30" CPEP/CAAP/PCCSP
 114+72.10, 32.80' RT ~ 115+16.76, 33.00 LT
 LENGTH 79.5'
- ① REMOVE EXISTING CSP
 114+93.49, 22.57' RT ~ 115+16.28, 29.00 LT
 LENGTH 56.33'

SCALE 1" = 20'-0"
 20 0 20

LINES SHOWN ON THIS PLAN AS EXISTING
 PROPERTY LINES P/L ARE BELIEVED TO
 BE ACCURATE BUT SHOULD NOT BE RELIED
 UPON FOR PURPOSES UNRELATED TO THE
 STATE OF VERMONT'S ACQUISITION OF LAND
 AND RIGHTS FOR THIS PROJECT.

**FOR R.O.W.
 USE ONLY**

PROJECT NAME: BRISTOL	PLOT DATE: 25-APR-2012
PROJECT NUMBER: STP F 021-1 (15)	DRAWN BY: E. PIERCE
FILE NAME: r78f187.lay1.dgn	CHECKED BY: E. PIERCE
PROJECT LEADER: M. EVANS-MONGEON	SHEET 4 OF 37
DESIGNED BY: W. PELLETIER	
ROW LAYOUT SHEET 1 OF 5	

AREA OF EXCAVATION OF SURFACES AND PAVEMENTS