



- [B1] EXISTING DRAINAGE
STA 10+089.4 RT 12.0m - STA 10+186.3 RT 7.8m
EXISTING 450 CULVERT - REMOVE
- [B2] STA 10+121.7 RT 4.8 m - STA 10+125.6 RT 0.2 m
EXISTING 300 CULVERT - REMOVE
- [B3] NEW DRAINAGE
STA 10+082.0 RT 13.9m - STA 10+113.4 RT 17.9m
NEW 600mm X 28.3m RCP CL. III OR CPEP (SL)
W/ 600mm ES AT INLET AND TYPE I STONE PAD
AT OUTLET
INLET INV. EL. 137.461
OUTLET INV. EL. 137.320
- [B4] STA 10+113.4 RT 17.9m - STA 10+160.0 RT 14.4m
CONSTRUCT GRASS LINED DITCH
- [B5] STA 10+170.1 RT 15.6m - STA 10+186.9 RT 15.0m
NEW 600mm X 15.1m CAAP (1.52) OR LACSP (1.63)
W/ 600mm ES AT INLET
INLET INV. EL. 136.472
OUTLET INV. EL. 136.018
CONSTRUCT 7.3m TYPE I STONE LINED DITCH AT
INLET OF PIPE

CURVE #1 DATA
 PI 10+202.301 BK
 = 10+133.732 AHD
 Δ = 91°33'25" RT
 R = 150.000
 T = 154.132
 L = 239.695
 E = 65.074
 BANK = 0.078

REMOVING AND RESETTING FENCE
 STA 10+082.794 - 10+10+094 RT
 STA 10+094 - 10+104 RT (GATE)
 STA 10+104 - 10+164 RT

**SPECIAL PROVISION
(REMOVABLE METAL HAND I)**
 CHL 50+080 - 50+125 RT

REMOVAL OF EXISTING FENCE
 STA 10+237 - 10+250 LT
 CHL 50+047 - 50+127 RT

BRACING ASSEMBLY FOR CHAIN-LINK FENCE, 2.4m
 STA 10+093 RT
 STA 10+104 RT
 STA 10+160 RT
 STA 10+165 RT

STEEL BEAM GUARDRAIL, GALVANIZED
 STA 10+123.36 - 10+163.61 LT
 STA 10+104.13 - 10+163.05 RT
 STA 10+258.84 - 10+280 LT
 STA 10+259.40 - 10+280 RT

MANUFACTURED TERMINAL SECTION, FLARED
 STA 10+111.93 - 10+123.36 LT
 ANCHOR FOR STEEL BEAM RAIL
 STA 10+104.13 RT

REMOVAL AND DISPOSAL OF GUARDRAIL
 STA 10+098 - 10+175 LT
 STA 10+161 - 10+173 LT
 STA 10+236 - 10+268 RT
 STA 10+236 - 10+256 RT

**LITTLE GRAY RABBIT LLC - LESSOR
K-2 CONSTRUCTION, INC. - LESSEE**

**INSTALL GEOTEXTILE
FOR ROADBED SEPARATOR
PRIOR TO PLACING TEMPORARY
FILL IN WETLAND AREA**

**STATE OF VERMONT
FORMERLY PAYNTER,
ROBERT J. & MARIE B.**

**END BRIDGE
RESUME ROADWAY
STA. 10+250**

**TEMPORARY BRIDGE
SHALL SPAN BROOK AT
NORTH END OF BRIDGE**

WOVEN WIRE FENCE WITH WOOD POSTS
 CHL 50+047 - 50+080 RT

WOOD BRACE FOR WOVEN WIRE FENCE
 CHL 50+047 RT
 CHL 50+080 RT

**CONSTRUCT RECREATION PATH
(SEE CHANNEL SECTIONS)**
 CHL 50+047 - 50+145 LT
 PORTLAND CEMENT CONCRETE SIDEWALK, 125mm
 CHL 50+080 - 50+125 RT

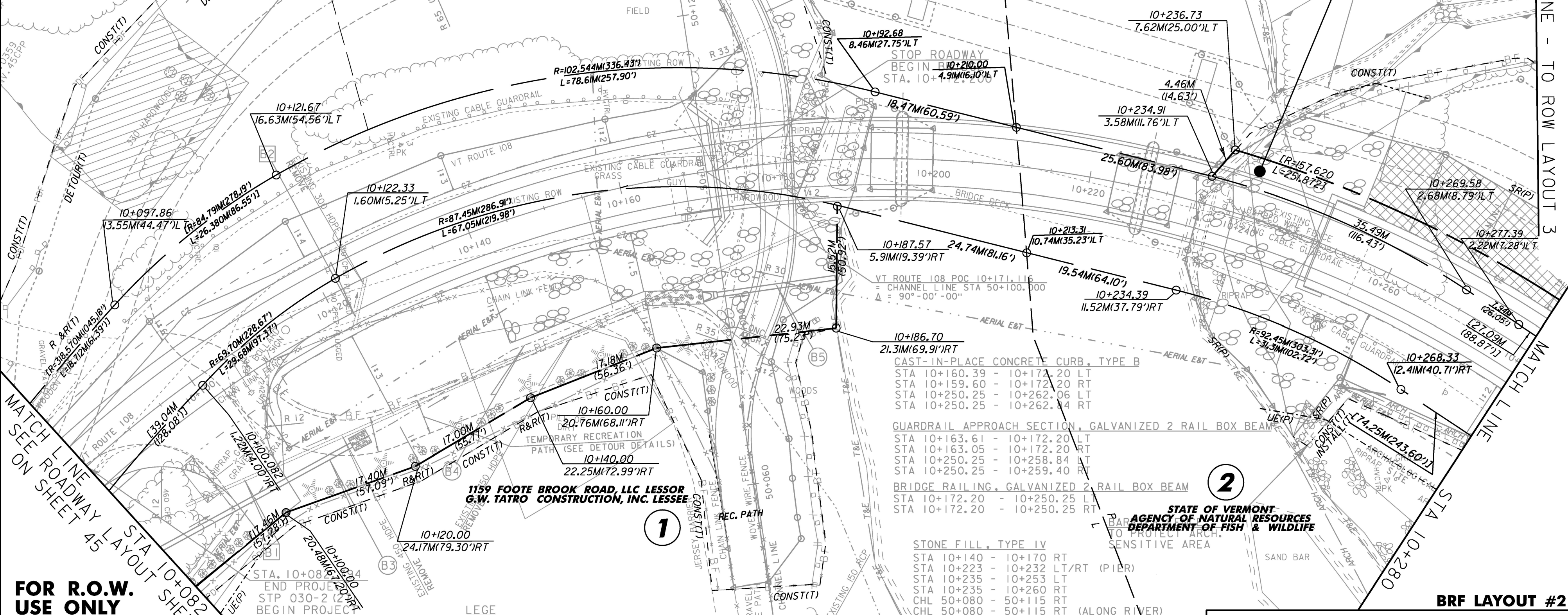

**FOR R.O.W.
USE ONLY**

LINE SHOWN ON THIS PLAN AS EXISTING
PROPERTY LINES P/L ARE BELIEVED TO
BE ACCURATE BUT SHOULD NOT BE RELIED
UPON FOR PURPOSES UNRELATED TO THE
STATE OF VERMONT'S ACQUISITION OF LAND
AND RIGHTS FOR THIS PROJECT.

LEGE

- EVERGREEN TREE (PICEA GLAUCA)
- GROUND COVERS AND VINES (VALIANT GRAPEVINE OR SUMMER GRAPEVINE)



STONE FILL, TYPE IV
 STA 10+140 - 10+170 RT
 STA 10+223 - 10+232 LT/RT (PIER)
 STA 10+235 - 10+253 LT
 STA 10+235 - 10+260 RT
 CHL 50+080 - 50+115 RT
 CHL 50+080 - 50+115 RT (ALONG RIVER)

CONSTRUCT DRIVE
 STA 10+100 RT - 7.0m WIDE,
 17.2 m LONG PAVED

**STATE OF VERMONT
AGENCY OF NATURAL RESOURCES
DEPARTMENT OF FISH & WILDLIFE**

2

**TO PROTECT ARCH.
SENSITIVE AREA**

PROJECT NAME:	CAMBRIDGE	PLOT DATE:	05-JUN-2012
PROJECT NUMBER:	BRF 027-1 (4)	DRAWN BY:	B. FERLAZO
FILE NAME:	r78f163BRFloy2.dgn	DESIGNED BY:	T. FILLBACH
PROJECT LEADER:	M.EVANS-MONGEON	CHECKED BY:	H. PETROVS
R.O.W. BRF LAYOUT SHEET 2		SHEET	185 OF 214

BRF LAYOUT #2

MATCH LINE - TO ROW LAYOUT 3

MATCH LINE SEE ON SHEET 45

STA 10+082.794

STA 10+280