

RIGHT - OF - WAY DETAIL SHEET

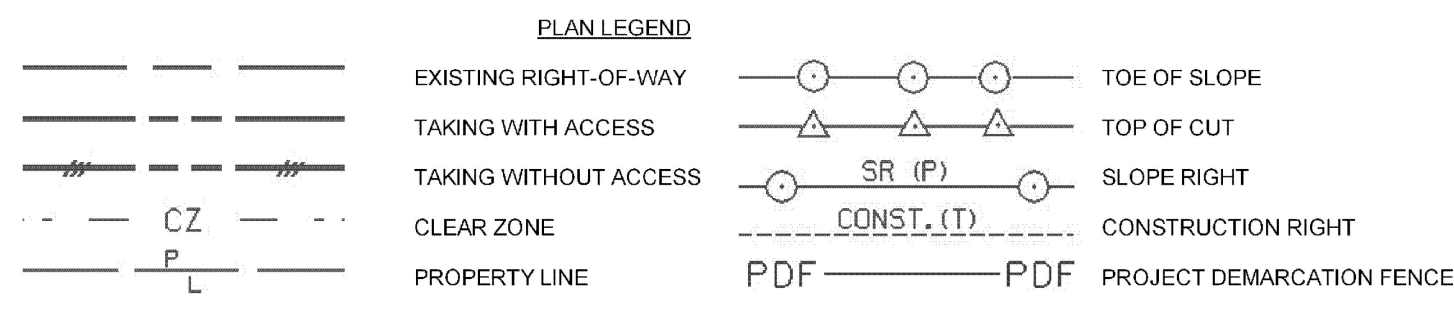

TABLE OF PROPERTY ACQUISITION

TABLE OF REVISIONS

PARCEL NO.	PROPERTY OWNER	SHEET NO.	BEGINNING STATION	ENDING STATION	TAKE	REMAINDER	RIGHT			RECORDING DATA				REMARKS			
							AREA ±	AREA ±	TYPE	(T)/(P)	AREA ±	TITLE	DATE		TOWN / CITY	BOOK	PAGE
1	1159 FOOTE BROOK ROAD, LLC - LESSOR G.W. TATRO CONSTRUCTION, INC - LESSEE	14, 15	10+019.20 RT	10+187.57 RT	2,566.78 SM										0.63 A ±		
			10+008.17 RT	10+100.00 RT												0.13 A ±	
			10+008.73 RT	10+160.00 RT					UTILITY	(P)	519.14 SM	WDIF	4/3/2012	CAMBRIDGE	383	294-296	3,660 SF±; INCL. PDF, BF & EC
			10+075.43 RT	10+164.00 RT					CONST.	(T)	340 SM						FENCE LINE & GATE
			10+160.00 RT	10+186.70 RT					REMOVE & RESET	(T)							4,682 SF± REC PATH, BF, CHAIN LINK FENCE & PLANT GROUND COVER
			10+100.00 RT											7M PAVED, 22.96' DRIVE			
2	STATE OF VERMONT AGENCY OF NATURAL RESOURCES DEPARTMENT OF FISH AND WILDLIFE	15, 16	10+235.00 RT	10+344.06 RT											0.26 A ±		
			10+235.00 RT	10+280.00 RT				UTILITY	(P)	1057.65 SM	EO	7/2/2010	CAMBRIDGE	362	420-422	0.04 A ±	
			10+259.55 RT	10+344.06 RT				SLOPE	(P)	166.58 SM						1,634 SF ±	
			10+260.00 RT	10+344.06 RT				INSTALL	(T)	78.72 SM						BARRIER FENCE	
			10+300.57 RT	10+344.06 RT				CONST.	(T)	151.82 SM						847 SF ± INCL. EROSION CONTROL	
			10+310.00 RT	10+323.50 RT				INSTALL	(P)	13.87 SM						SIDEWALK 148 SF ±	
			10+343.42 RT	10+314.00 RT				INSTALL & MAINT	(P)							GUARDRAIL	
3	CLARKE, PAUL	16, 17	10+400.00 LT	10+449.89 LT	195.99 SM										2.109 SF ±		
			10+400.00 LT	10+436.09 LT					CONST.	(T)	49.50 SM	WD	2/18/2010	CAMBRIDGE	360	68-69	533 SF±; INCL. PDF & EROSION CONTROL
			10+400.00 LT	10+495.00 LT					REMOVE	(T)						FENCE	
			10+449.89 LT	10+492.57 LT					CONST.	(T)	45.76 SM						493 SF±; INCL. PDF & EROSION CONTROL
4	POWELL, JERRY D. & DONNA M.	16	10+346.60 LT	10+400.00 LT	310.63 SM										0.08 ACRE		
			10+344.27 LT	10+400.00 LT					CONST.	(T)	166.61 SM	WD	10/18/2011	CAMBRIDGE	372	237	1,793 SF±; INCL. BF, PDF & EC
			10+345.00 LT	10+394.18 LT					SLOPE	(T)	125.12 SM						1,347 SF ±
5	PAYNTER, ROBERT J. & MARIE B.	15, 16	10+234.91 LT	10+348.17 LT	545.30 SM										0.13 A ±		
			10+236.73 LT	10+345.10 LT					CONST.	(T)	377.02 SM	WD	4/14/2010	CAMBRIDGE	361	35-38	INCL. PDF & EROSION CONTROL;
			10+236.73 LT	10+340.00 LT					DETOUR	(T)	0.16 HA						0.09 A ±
			10+236.73 LT	10+346.80 LT					SLOPE	(P)	822.06 SM						0.40 A ±
			10+256.92 LT	10+329.27 LT					UTILITY	(P)	1030.00 SM						0.2 A ±
			10+325.00 LT						ACCESS	(T)							0.25 A ±
			10+338.00 LT						DRIVE	(T)							INGRESS & EGRESS DETOUR 3.6M (11.8) GRAVEL MM 0921
6	LITTLE GRAY RABBIT LLC - LESSOR K-2 CONSTRUCTION, INC. - LESSEE	14, 15	10+080.77 LT	10+168.06 LT											4.030 SF ± INCL. BF, PDF & EC		
			10+080.77 LT	10+187.10 LT					CONST.	(T)	374.41 SM	GTR	3/20/2012	CAMBRIDGE	383	152-155	0.70 A ±
			10+168.06 LT	10+187.07 LT					CONST.	(T)	441 SM					RECREATIONAL PATH; BF, CHAIN LINK FENCE & HANDRAIL 4,747 SF±	
			10+080.00 LT	10+085.00 LT										5 WOODEN BOLLARDS			
7	CENTRAL VERMONT PUBLIC SERVICE CORPORATION		10+008.17 RT	10+530.00 RT											EXISTING UTILITY EASEMENT WITHIN PROPOSED VERMONT ROUTE 108 RIGHT OF WAY		
8	TELEPHONE OPERATING COMPANY OF VERMONT LLC		10+008.17 RT	10+530.00 RT											EXISTING UTILITY EASEMENTS WITHIN PROPOSED VERMONT ROUTE 108 RIGHT OF WAY		
9	VILLAGE OF JEFFERSONVILLE WATER & SEWER DEPARTMENT		10+008.17 RT	10+530.00 RT											EXISTING UTILITY EASEMENTS WITHIN PROPOSED VERMONT ROUTE 108 RIGHT OF WAY		
10	JEFFERSONVILLE CABLE T.V. CORPORATION		10+008.17 RT	10+530.00 RT											EXISTING UTILITY EASEMENTS WITHIN PROPOSED VERMONT ROUTE 108 RIGHT OF WAY		

REVISION NO.	SHEET NO.	DESCRIPTION	DATE
1	23, 26	PARCEL NO. 3 CLARKE - CORRECTED REMOVE (P) TO REMOVE (T) FOR BARBED WIRE FENCE AND CHANGED ENDING STATION FROM 10+540.00 LT TO 10+495 LT PER C.O. 9554 COMPLETED BY: MT APPROVED BY: HP	02/06/2009
2	23, 26	PARCEL NO. 4 POWELL - REMOVED BARBED WIRE FENCE AND REMOVE (P) PER C.O. 9555 COMPLETED BY: MT APPROVED BY: HP	02/06/2009
		AS OF THIS DATE, THIS PROJECT HAS NOT BEEN GRANTED NECESSITY.	02/10/2009
3	23	PARCEL NO. 1 FOOTE BROOK ROAD - CORRECTED AREA OF 771.25 SM TO 340 SM, 3,660 SF± AND 501 SM TO 435 SM, 4,682 SF± PER C.O. 9571 COMPLETED BY: MT APPROVED BY: HP	10/20/2009
4		PARCEL NO. 1 FOOTE BROOK ROAD. REQUEST TO STRUCTURES TO ADD COMMERCIAL SIGN TO EXISTING TOPO IN THE FIELD. PER C.O. 9586 COMPLETED BY: STRUCTURES APPROVED BY: HP	12/29/2009
5	22, 23	PARCEL NO. 1 FOOTE BROOK ROAD. ADD LAYOUT SHEET 22 FROM THE STP PORTION OF THIS PROJECT, TO THE LIST OF DESIGN SHEETS THAT AFFECT THIS PARCEL. ADD SHEET 22 TO THE PROPERTY OWNER PLAT. ADD REMOVE (T) FOR SIGN AT STA. VT. RTE. 15 20+221.47 LT PER C.O. 9591 COMPLETED BY: MR APPROVED BY: HP	12/29/2009
6	23, 26	PARCEL NO. 2 AGENCY OF NATURAL RESOURCES. ADD REMOVE & RESET (T) FOR FISH & WILDLIFE SIGN AT STA. 10+300.00 RT ADD REMOVE (T) FOR PICNIC SIGN AT STA. 10+313.00 RT PER C.O. 9604 COMPLETED BY: MR APPROVED BY: HP	02/23/2010
7	1, 25, 26 27	CHANGE ENDING STATION OF PROJECT TO 10+530.00, 26.23M; RT CHANGE LENGTH OF ROW PROJECT TO 521.83 M CHANGE RUNNING DISTANCES AS SHOWN ON PLANS. PER C.O. 9603 COMPLETED BY: MR APPROVED BY: HP	02/23/2010
NOTE: DESIGN CHANGED TO A ROTARY AT INTERSECTION WITH VT ROUTE 15 AND 108 IN 2010			
8	16	PARCEL NO. 3 CLARK - NOW TO READ STATE OF VERMONT F/N CLARKE, PAUL. COMPLETED BY: MT C.O. 9711 APPROVED BY: HP	03/31/2011
9	15, 16	PARCEL NO. 5 PAYNTER - NOW TO READ STATE OF VERMONT F/N PAYNTER, ROBERT J. & MARIE B. COMPLETED BY: MT C.O. 9712 APPROVED BY: HP	03/31/2011



- BF - BARRIER FENCE
- EC - EROSION CONTROL
- (P) - PERMANENT
- (T) - TEMPORARY
- DR. - DRAINAGE RIGHT
- DIT. - DITCHING RIGHT
- CH. - CHANNEL RIGHT
- DRIVE - DRIVE RIGHT
- CUL. - CULVERT RIGHT
- C&T - CLEARING & TRIMMING RIGHT
- SR - SLOPE RIGHT
- UE - UTILITY EASEMENT

APPROVED: HARRY PETROYS DATE: 11-19-08
CHIEF, PLANS & TITLES

PROJECT NAME: **CAMBRIDGE**
 PROJECT NUMBER: **BRF 027-1(4)**
 FILE NAME: r78f163BRFdetail.xls PLOT DATE: **4/30/2012**
 PROJECT LEADER: **J. SHULTZ** DRAWN BY: **M. TROTTIER**
 DESIGNED BY: **TUS/SRB** CHECKED BY: **R. FERLAZO**
 R.O.W. DETAIL SHEET SHEET **183** OF **214**