

# STATE OF VERMONT DEPARTMENT OF HIGHWAYS



## PROPOSED IMPROVEMENT BRIDGE PROJECT

TOWN OF JERICHO Pin# 78F334  
COUNTY OF CHITTENDEN

ROUTE NO: Vt. Rte. 15 BRIDGE NO: 10

PROJECT LOCATION: BEGINNING AT A POINT APPROXIMATELY 0.30 MILES NORTHEASTERLY OF THE INTERSECTION OF T.H.#1 AND VT. Rte 15, IN JERICHO, AND EXTENDING NORTHEASTERLY ALONG VT. Rte 15 FOR 0.104 MILES.  
PROJECT DESCRIPTION: REMOVE A PORTION OF THE EXISTING DECK, CURB AND RAIL AND WIDEN TO THE LIMITS SHOWN. WIDEN THE ABUTMENTS, PIERS AND SUPERSTRUCTURE; CONSTRUCT NEW WINGWALLS, ROADWAY APPROACHES AND RELATED CHANNEL WORK.

LENGTH OF STRUCTURE:	114.95	FEET
LENGTH OF PARTICIPATION ROADWAY:	435.05	FEET
LENGTH OF NON-PARTICIPATION ROADWAY:	0.0	FEET
LENGTH OF PROJECT:	550.00	FEET
LENGTH OF R.O.W. PROJECT:	550.00	FEET

TRAFFIC DATA

1977 ADT	4160
1977 DHV	555
1997 ADT	5960
1997 DHV	760
% T	6
% D	65

DESIGN SPEED = 50 MPH.

### R.O.W. PLANS

#### GENERAL NOTES:

1. THE GENERAL NOTE PERTAINING TO SPECIFICATIONS, MATERIALS, AND CONSTRUCTION IS SHOWN ON STANDARD DRAWING SCB-DI-75. OTHER GENERAL NOTES ON THE STANDARD, NOT OTHERWISE SHOWN OR MODIFIED ON THESE PLANS, ARE NOTES 4, 7, 8, 13, & 14.
2. THE EXISTING PORTION OF THE SUPERSTRUCTURE IS CAPABLE OF CARRYING AN H-15 LOADING. THE NEW PORTION OF THE SUPERSTRUCTURE IS DESIGNED FOR AN H-20-44 LOADING.
3. ALL REINFORCING STEEL SHALL BE LAPPED A MINIMUM OF 2'-0" UNLESS OTHERWISE SHOWN.
4. THE EXISTING ABUTMENTS, PIERS, DECK AND CONCRETE RAIL POST SHALL BE REMOVED TO THE LIMITS SHOWN ON THESE PLANS UNDER THE ITEM PARTIAL REMOVAL OF STRUCTURE. CARE SHALL BE TAKEN NOT TO DAMAGE THE REMAINING DECK OR BEAMS.
5. THE EXISTING PAVEMENT ON THE BRIDGE SHALL BE REMOVED UNDER THE ITEM REMOVAL OF BRIDGE PAVEMENT.
6. WATER REPELLENT SHALL BE APPLIED TO ALL EXPOSED CONCRETE SURFACES (NEW AND EXISTING) OF THE ABUTMENTS AND PIERS, AND TO THE FOLLOWING AREAS OF THE SUPERSTRUCTURE: THE CURB AND FASCIA, THE DECK SURF TO THE FASCIA BEAM AND THE EXTERIOR FACE AND BOTTOM OF THE FASCIA BEAMS.
7. IF SPALLED AREAS OF LESS THAN 1/4" DEPTH IN EXISTING CONCRETE DECK, PIERS, AND OR ABUTMENTS, THAT ARE TO REMAIN, ARE FOUND, FILL WITH MORTAR. IF THE DEPTH IS GREATER THAN 1/4", FILL WITH CONCRETE, CLASS A. WHEN CONCRETE IS USED FOR PATCHING, CUT EDGES TO PROVIDE A MINIMUM DEPTH OF 1/4" AND COAT WITH NEAT CEMENT GROUT PRIOR TO POURING NEW CONCRETE. THE ENGINEER SHALL DETERMINE IF PATCHES ARE REQUIRED. AN ESTIMATED 3 CUBIC YARDS OF CONCRETE, CLASS A ARE INCLUDED FOR THIS PURPOSE. MORTAR SHALL ALSO BE PAID UNDER CONCRETE, CLASS A.
8. REMOVAL OF ALL DISINTEGRATED, SPALLED, AND UNSOUND CONCRETE IN THE AREAS INDICATED IN NOTE 7, SHALL BE PAID FOR AS REMOVAL OF EXISTING CONCRETE OR MASONRY. A QUANTITY OF 20 SQUARE YARDS HAS BEEN ESTIMATED FOR THIS WORK.

(GENERAL NOTES ARE CONTINUED ON SHEET 3.)

CONVENTIONAL SIGNS

COUNTY LINE	---
TOWN LINE	---
LIMITS OF ACCESS	---
POINT OF ACCESS	X
FENCE LINE	---
STONE WALL	---
TRAVELED WAY	---
GUARD RAIL	---
RAILROAD	---
SURVEY LINE	---
CULVERT	---
POWER POLE	○
TELEPHONE POLE	○
TREES	○
F.A. IDENTIFICATION SIGNS	▲
PROPERTY LINE	---
R.O.W. TAKING LINE	---
SLOPE RIGHTS	---
TOP OF CUT	---
TOE OF SLOPE	---

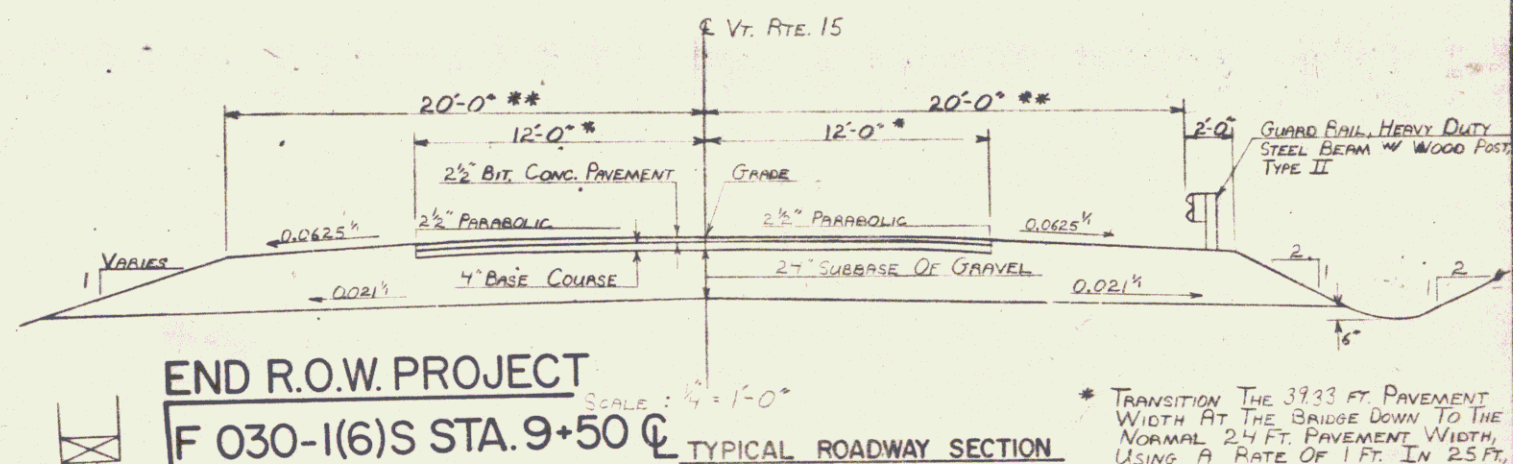
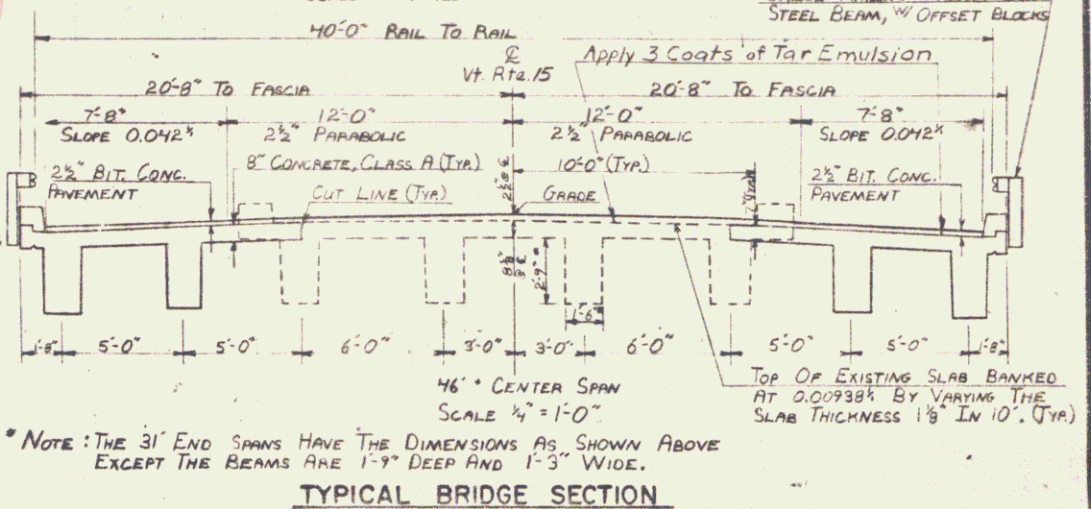
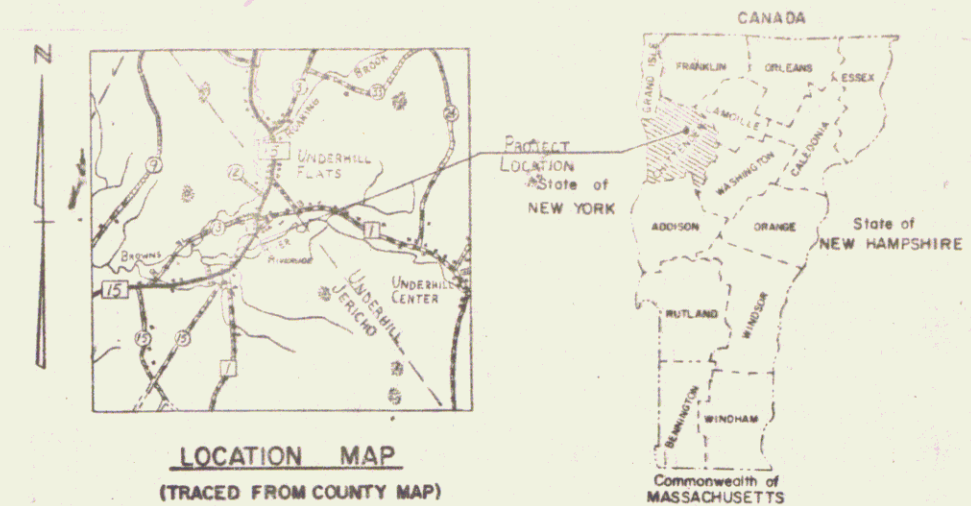
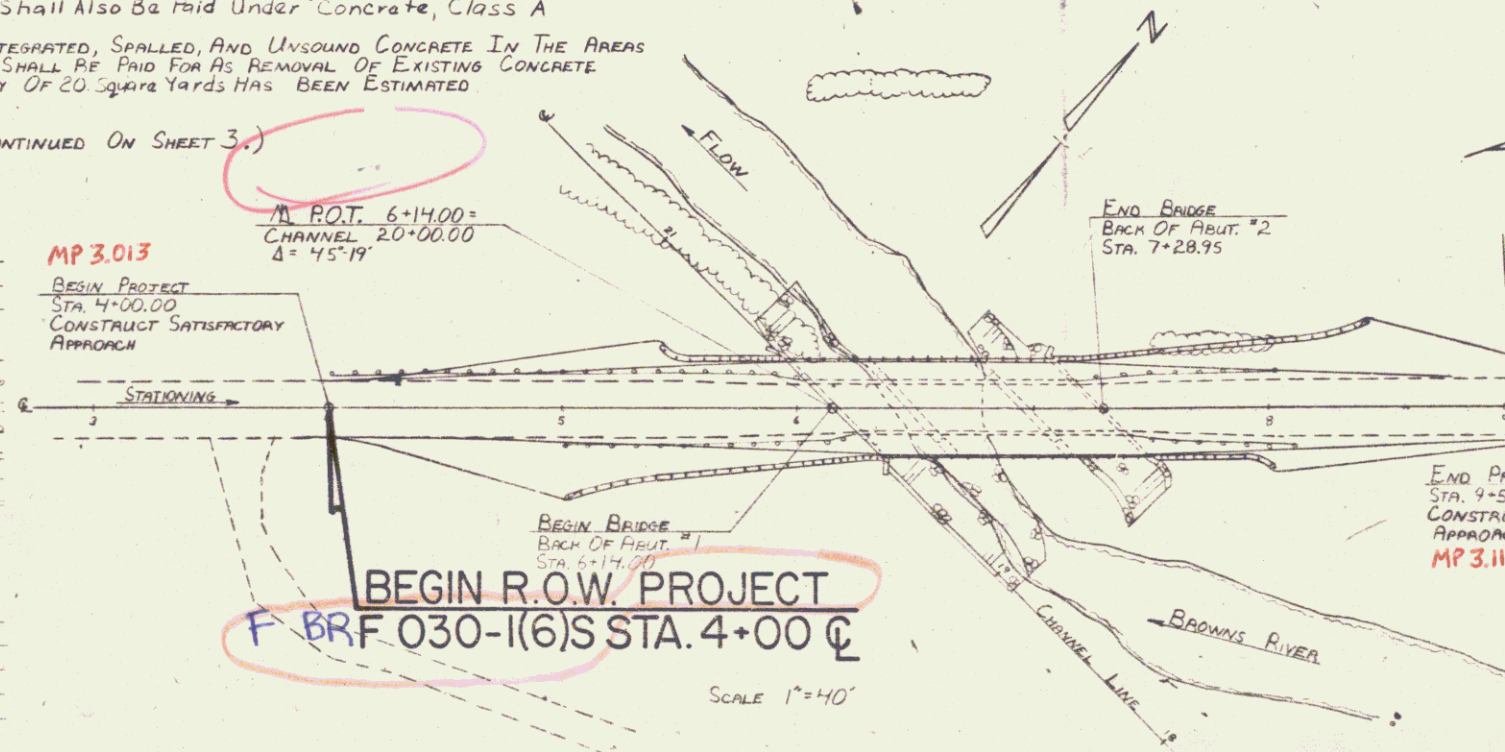

END R.O.W. PROJECT  
F 030-1(6)S STA. 9+50

RIGHT-OF-WAY DIVISION  
TOWN FILE  
PERPETUAL

PROJECT PROCESSED UNDER  
SECONDARY ROAD PLAN

APPROVED: [Signature] DATE: 1-16-79  
CHIEF, PROPERTY ADMINISTRATION

SUBMITTED BY ORDER OF THE STATE HIGHWAY BOARD  
A. J. [Signature] DATE: 1-16-79  
DIRECTOR OF ENGINEERING AND CONSTRUCTION

JERICHO F 030-1(6)S  
1 4 SHEETS

STATE OF VERMONT  
DEPARTMENT OF HIGHWAYS  
RIGHT-OF-WAY PLANS  
DETAIL SHEET

TABLE OF PROJECT PROPERTY ACQUISITION

PARCEL NO.	GRANTOR	SHEET NO.	BEGINNING STATION	ENDING STATION	TAKING	REM.	RIGHTS	TITLE TAKEN	DATE	TOWN OR CITY RECORDED	BK.	PG.	REMARKS
1A	BALCH, DONALD J. & MARY S.	3	4+00 RT.	7+67 RT.	0.12 A±			WD	6/11/81	JERICO	64	333-4	
			4+14 RT.	7+67 RT.			CONST. EASE. (T) (0.08 A±)						(3510 S.F.±)
			4+41 RT.	5+00 RT.			SLOPE (T) (120 S.F.±)						
			6+67 RT.	6+91 RT.			SLOPE (P) (4 S.F.±)						
B			7+67 RT.	7+80 RT.	0.01 A±								(585 S.F.±)
			TOTAL		0.13 A±								
2	VILLENEUVE, RICHARD & ARDELLE	3	4+00 LT.	5+90 LT.	0.04 A±			WD		JERICO			(1900 S.F.±)
3	CAPLITCKA, STANLEY A.	3	6+77 LT.	9+00 LT.	0.04 A±			WD		JERICO			(1920 S.F.±)
			6+54 LT.	8+15 LT.			CONST. EASE. (T) (0.02 A±)						(1070 S.F.±)
4	MILLS, MERTON D. & GRACE A.	3	7+80 RT.	9+50 RT.	0.08 A±			WD		JERICO			(3600 S.F.±)
5	CENTRAL VERMONT PUBLIC SERVICE CORP.												UTILITY
6	NEW ENGLAND TELEPHONE & TELEGRAPH CO.												UTILITY

TABLE OF REVISIONS

REVISION NO.	SHEET NO.	DESCRIPTION OF REVISION	DATE	MADE BY	APPROVED BY
1	3	Parcel #4 Mills, RE PLOTTED EXISTING ROW TAKE LINES TO 7+50-21 RT.; REVISED RUNNING DISTANCES PER C.O. # 4395.	6-6-79	SJB	J.S.
2	2,3	Parcel #3 Caplitcka; reduced const. ease. from 6+54 Lt. = 8+50 Lt. to read 6+54 Lt. = 8+15 Lt. Per C.O. # 4884	8-11-81	JDP	T.P.M.
3	2,3	Parcel #1 Balch, increased size of const. ease. Per C.O. # 4440	4-24-81	JDP	T.P.M.
4	2	Parcel #5, Change in Title Per C.O. # 4942	4-28-81	BAM	T.P.M.

MADE BY: P.J.H. DATE: 1-18-79  
CHECKED BY: W.E.B. DATE: 1-18-79

DR. RT. - DRAINAGE RIGHT  
DIT. RT. - DITCHING RIGHT  
CH. RT. - CHANNEL RIGHT  
DRIVE RT. - DRIVE RIGHT  
CUL. RT. - CULVERT RIGHT  
⊖ - DEMOLITION OR REMOVAL  
W - WATER SOURCES

PRESENT R.O.W.  
--- TAKING WITHOUT ACCESS  
--- P --- TAKING WITHOUT ACCESS ALONG PROPERTY LINES  
--- TAKING WITH ACCESS  
(P) PERMANENT EASEMENT  
(T) TEMPORARY EASEMENT

LEGEND  
--- CONST. EASE --- CONST. EASEMENT  
--- SR --- SR SLOPE RIGHTS  
--- P --- P PROPERTY LINE  
--- Δ --- Δ TOP OF CUT  
--- ○ --- ○ TOE OF SLOPE

APPROVED: Thomas P. May DATE: 1-18-78  
CHIEF OF PLANS & TITLES

PROJECT: JERICO  
NO. F 030-1(6)S  
SHEET 2 OF 4

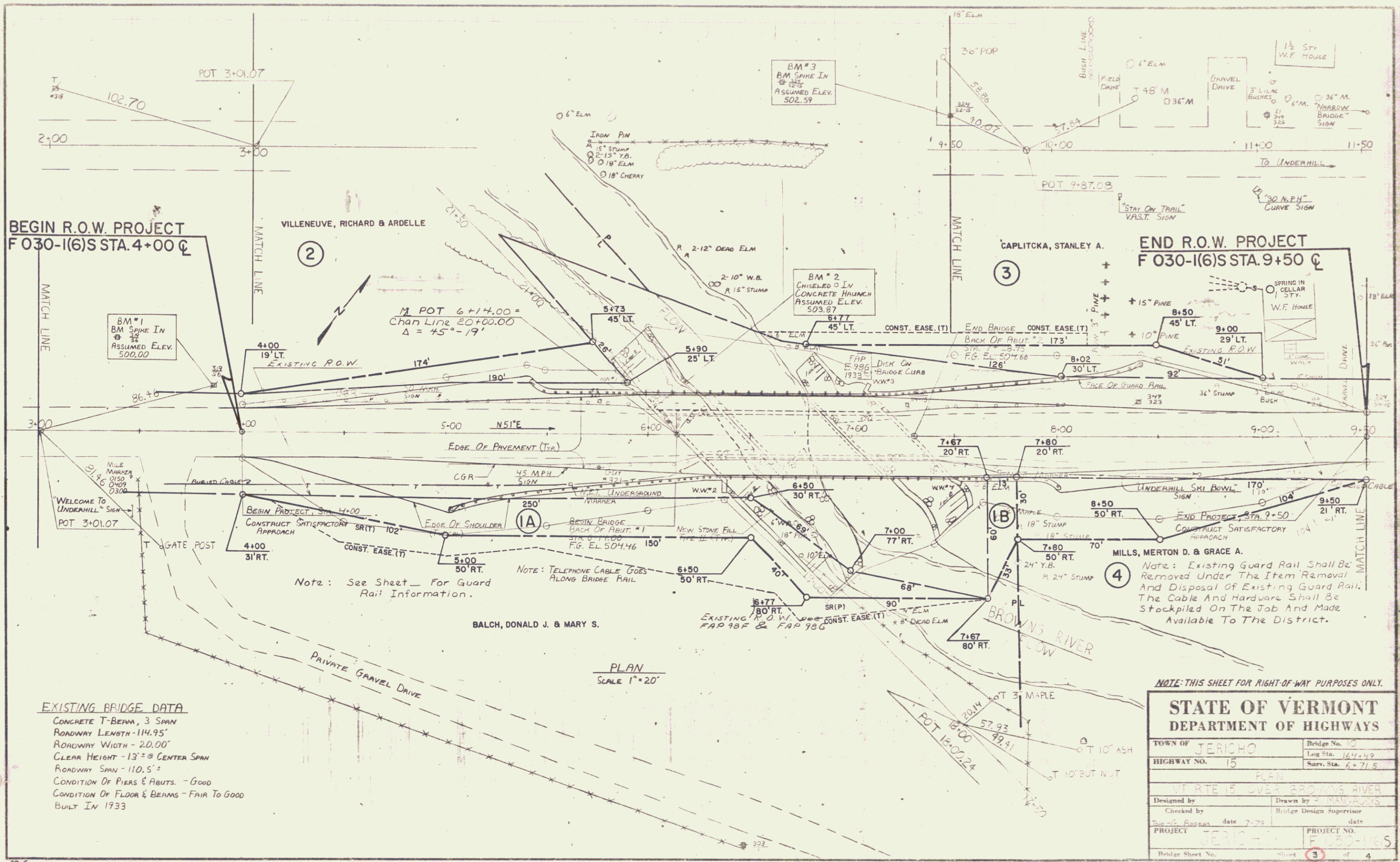

**EXISTING BRIDGE DATA**  
 CONCRETE T-BEAM, 3 SPAN  
 ROADWAY LENGTH - 114.95'  
 ROADWAY WIDTH - 20.00'  
 CLEAR HEIGHT - 13' @ CENTER SPAN  
 ROADWAY SPAN - 110.5'  
 CONDITION OF PIERS & ABUTS. - GOOD  
 CONDITION OF FLOOR & BEAMS - FAIR TO GOOD  
 BUILT IN 1933

NOTE: THIS SHEET FOR RIGHT-OF-WAY PURPOSES ONLY.

**STATE OF VERMONT  
 DEPARTMENT OF HIGHWAYS**

TOWN OF JERICHO	Bridge No. 10
HIGHWAY NO. 15	Log Sta. 164+49
	Surv. Sta. 6+71.5
PLAN	
VT RTE 15 OVER BROWNS RIVER	
Designed by	Drawn by P. MANGRAMS
Checked by	Bridge Design Supervisor
DATE 7-79	date
PROJECT JERICHO	PROJECT NO. F 030-1(6)S
Bridge Sheet No.	Sheet 3 of 4

GENERAL NOTES (CONTINUED FROM SHEET #1)

9. TURF ESTABLISHMENT SHALL BE CONSIDERED SUBSIDIARY TO ALL OTHER ITEMS IN THE CONTRACT. SEE SPECIAL PROVISIONS.
10. TRAFFIC WILL NOT BE ALLOWED ON THE NEW PORTIONS OF THE DECK UNTIL A MINIMUM OF 21 DAYS AFTER THOSE PORTIONS OF THE DECK HAVE BEEN POURED, OR A MINIMUM OF 14 DAYS AFTER PLACEMENT OF CONCRETE CURBS, WHICHEVER IS GREATER.
11. ONE WAY TRAFFIC SHALL BE MAINTAINED OVER THE EXISTING BRIDGE DURING CONSTRUCTION UNDER THE ITEM 'MAINTENANCE OF TRAFFIC FOR BRIDGE PROJECTS.' HOWEVER, THE ONE WAY TRAFFIC WILL BE CONTROLLED BY TRAFFIC CONTROL SIGNALS. TRAFFIC CONTROL SIGNALS, INCLUDING RELATED HARDWARE, EQUIPMENT, AND INCIDENTALS WILL BE FURNISHED, INSTALLED AND MAINTAINED BY STATE FORCES. THE STATE SHALL ALSO BE RESPONSIBLE FOR THE ELECTRIC POWER REQUIRED FOR THE OPERATION OF THE SIGNALS. SEE SPECIAL PROVISIONS.
12. TEMPORARY BARRIER RAIL SHALL BE PLACED AS SHOWN ON SHEET AND SHALL BE PAID UNDER THE ITEM 'TEMPORARY BARRIER RAIL.' SEE SPECIAL PROVISIONS.

DATE	
BY	
REVISION	
NO.	
DESCRIPTION	
DATE	
BY	
REVISION	
NO.	
DESCRIPTION	
DATE	
BY	
REVISION	
NO.	
DESCRIPTION	

DATE	
BY	
REVISION	
NO.	
DESCRIPTION	
DATE	
BY	
REVISION	
NO.	
DESCRIPTION	

NOTE: FINISH GRADE PROFILE SHALL BE FIELD CHECKED AGAINST THE EXISTING BRIDGE DECK PROFILE, AFTER REMOVAL OF EXISTING PAVEMENT, TO INSURE PROPER DEPTH OF NEW PAVEMENT.

