

STATE OF VERMONT DEPARTMENT OF HIGHWAYS



PROPOSED IMPROVEMENT BRIDGE PROJECT

TOWN OF JERICHO Pin# 78F334 COUNTY OF CHITTENDEN

ROUTE NO: Vt. Rte. 15 BRIDGE NO: 10

PROJECT LOCATION: BEGINNING AT A POINT APPROXIMATELY 0.30 MILES NORTHEASTERLY OF THE INTERSECTION OF T.H.#1 AND Vt. Rte 15, IN JERICHO, AND EXTENDING NORTHEASTERLY ALONG Vt. Rte. 15 FOR 0.104 MILES. PROJECT DESCRIPTION: REMOVE A PORTION OF THE EXISTING DECK, CURB AND RAIL AND WIDEN TO THE LIMITS SHOWN. WIDEN THE ABUTMENTS, PIERS AND SUPERSTRUCTURE; CONSTRUCT NEW WINGWALLS, ROADWAY APPROACHES AND RELATED CHANNEL WORK.

Table with 4 columns: LENGTH OF STRUCTURE (114.95 FEET), LENGTH OF PARTICIPATION ROADWAY (435.05 FEET), LENGTH OF NON-PARTICIPATION ROADWAY (0.0 FEET), LENGTH OF PROJECT (550.00 FEET), LENGTH OF R.O.W. PROJECT (550.00 FEET)

TRAFFIC DATA table with columns for Year, ADT, DHV, T, D, and Design Speed (50 MPH)

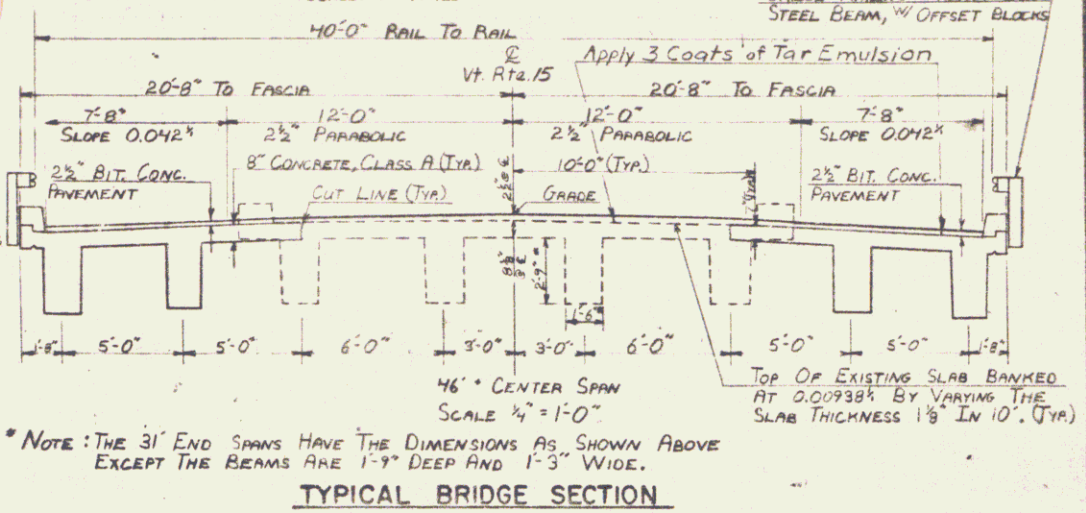
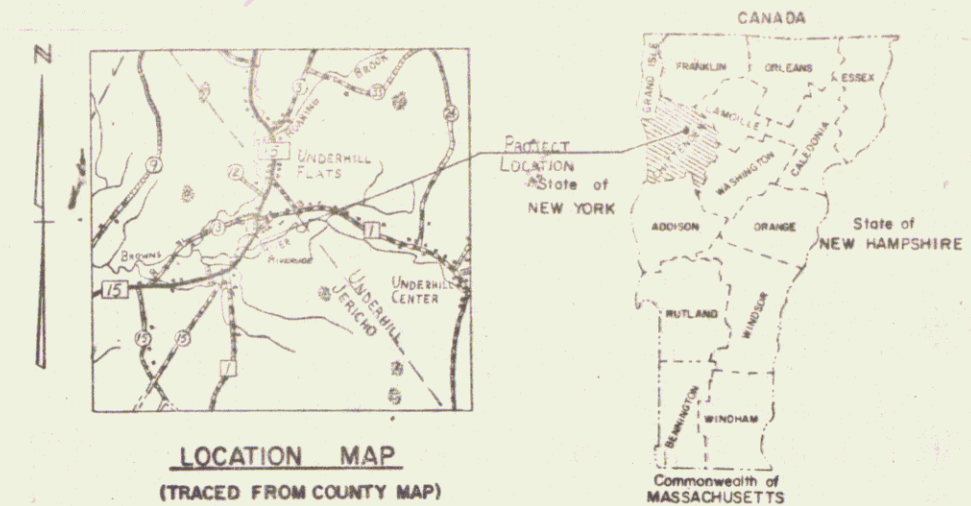

R.O.W. PLANS

GENERAL NOTES:

- 1. THE GENERAL NOTE PERTAINING TO SPECIFICATIONS, MATERIALS, AND CONSTRUCTION IS SHOWN ON STANDARD DRAWING SCB-DI-75. OTHER GENERAL NOTES ON THE STANDARD, NOT OTHERWISE SHOWN OR MODIFIED ON THESE PLANS, ARE NOTES 4, 7, 8, 13, & 14.
2. THE EXISTING PORTION OF THE SUPERSTRUCTURE IS CAPABLE OF CARRYING AN H-15 LOADING. THE NEW PORTION OF THE SUPERSTRUCTURE IS DESIGNED FOR AN H-20-44 LOADING.
3. ALL REINFORCING STEEL SHALL BE LAPPED A MINIMUM OF 2'-0" UNLESS OTHERWISE SHOWN.
4. THE EXISTING ABUTMENTS, PIERS, DECK AND CONCRETE RAIL POST SHALL BE REMOVED TO THE LIMITS SHOWN ON THESE PLANS UNDER THE ITEM 'PARTIAL REMOVAL OF STRUCTURE'. CARE SHALL BE TAKEN NOT TO DAMAGE THE REMAINING DECK OR BEAMS.
5. THE EXISTING PAVEMENT ON THE BRIDGE SHALL BE REMOVED UNDER THE ITEM 'REMOVAL OF BRIDGE PAVEMENT'.
6. WATER REPELLENT SHALL BE APPLIED TO ALL EXPOSED CONCRETE SURFACES (NEW AND EXISTING) OF THE ABUTMENTS AND PIERS, AND TO THE FOLLOWING AREAS OF THE SUPERSTRUCTURE: THE CURB AND FASCIA, THE DECK SURF TO THE FASCIA BEAM AND THE EXTERIOR FACE AND BOTTOM OF THE FASCIA BEAMS.
7. IF SPALLED AREAS OF LESS THAN 1/4" DEPTH IN EXISTING CONCRETE DECK, PIERS, AND ON ABUTMENTS, THAT ARE TO REMAIN, ARE FOUND, FILL WITH MORTAR. IF THE DEPTH IS GREATER THAN 1/4", FILL WITH CONCRETE, CLASS A. WHEN CONCRETE IS USED FOR PATCHING, CUT EDGES TO PROVIDE A MINIMUM DEPTH OF 1/4" AND COAT WITH NEAT CEMENT GROUT PRIOR TO POURING NEW CONCRETE. THE ENGINEER SHALL DETERMINE IF PATCHES ARE REQUIRED. AN ESTIMATED 3 CUBIC YARDS OF CONCRETE, CLASS A ARE INCLUDED FOR THIS PURPOSE. MORTAR SHALL ALSO BE PAID UNDER CONCRETE, CLASS A.
8. REMOVAL OF ALL DISINTEGRATED, SPALLED, AND UNSOUND CONCRETE IN THE AREAS INDICATED IN NOTE 7, SHALL BE PAID FOR AS REMOVAL OF EXISTING CONCRETE OR MASONRY. A QUANTITY OF 20 SQUARE YARDS HAS BEEN ESTIMATED FOR THIS WORK.

CONVENTIONAL SIGNS table listing symbols for County Line, Town Line, Limits of Access, Point of Access, Fence Line, Stone Wall, Traveled Way, Guard Rail, Railroad, Survey Line, Culvert, Power Pole, Telephone Pole, Trees, and various identification signs.

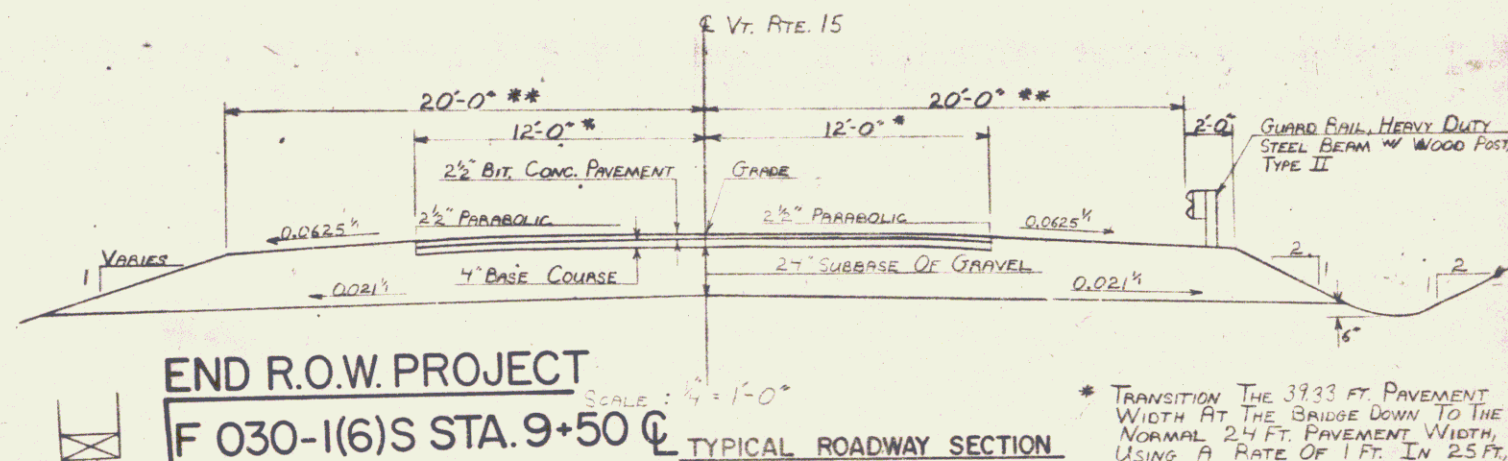
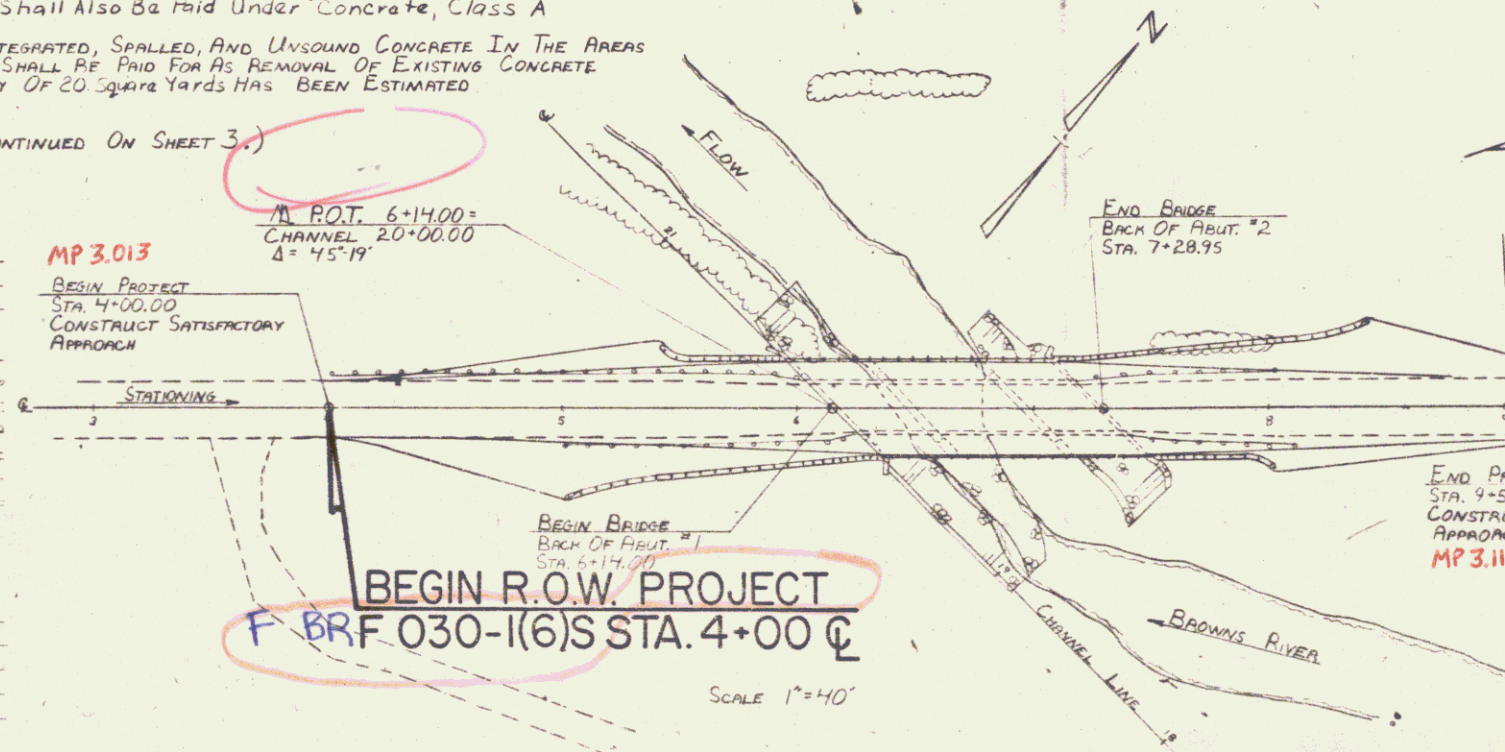

RIGHT-OF-WAY DIVISION TOWN FILE PERPETUAL

PROJECT PROCESSED UNDER SECONDARY ROAD PLAN

APPROVED: [Signature] CHIEF, PROPERTY ADMINISTRATION DATE: 1-15-79

SUBMITTED BY ORDER OF THE STATE HIGHWAY BOARD: [Signature] DATE: 1-16-79 DIRECTOR OF ENGINEERING AND CONSTRUCTION

JERICHO F 030-1(6)S SHEETS 4